

**SIGNING AND STRIPING GENERAL NOTES:**

- SIGNING AND STRIPING INSTALLATIONS SHALL CONFORM TO THE 2012 CALIFORNIA MANUAL ON UNIFORM TRAFFIC CONTROL DEVICES (CA MUTCD), THE STATE OF CALIFORNIA DEPARTMENT OF TRANSPORTATION (CALTRANS) STANDARD PLANS AND SPECIFICATIONS DATED 2010, AND ALL ADDENDUMS THERETO, AND THE CITY OF RIVERSIDE PUBLIC WORKS DEPARTMENT STANDARD DRAWINGS, CURRENT EDITION.
- ALL STRIPING, MARKINGS, AND LEGENDS SHALL BE REFLECTORIZED THERMOPLASTIC UNLESS OTHERWISE NOTED. THE CONTRACTOR SHALL PROVIDE AND INSTALL RAISED PAVEMENT MARKERS FOR ALL STRIPING. STRIPING, MARKINGS AND LEGENDS SHALL CONFORM TO THE LATEST CALTRANS STANDARD PLANS A20A THRU A20D AND A24A THRU A24E.
- PRIOR TO FINAL ACCEPTANCE OF STREET IMPROVEMENTS, ALL PAVEMENT STRIPING AND STENCILING WITHIN THE PERIMETER OF THE CONSTRUCTION AREA SHALL BE RESTORED TO LIKE NEW CONDITION, IN A MANNER MEETING THE APPROVAL OF THE CITY OF RIVERSIDE.
- THE CONTRACTOR SHALL RE-STRIPE EXISTING STRIPING AND CURB MARKINGS OBLITERATED BY NEW CONSTRUCTION, WHETHER OR NOT SHOWN ON THE PLANS FOR REPLACEMENT, AT NO COST TO THE CITY.
- AT LOCATIONS WHERE EXISTING PAINTED CURB IS TO BE RECONSTRUCTED, THE CONTRACTOR SHALL PAINT THE NEW CURB AS SHOWN ON THE PLANS WITHIN 10 WORKING DAYS OF CURB CONSTRUCTION OR AS DIRECTED BY ENGINEER. THE PAINT SHALL BE WATER-BASED WITH 2-YEAR GUARANTEE AGAINST COLOR FADING. PRIOR TO THE START OF CONSTRUCTION, THE CONTRACTOR SHALL SUBMIT TO THE CITY WRITTEN PROOF OF THE MANUFACTURER'S 2-YEAR GUARANTEE.
- ALL NEW STRIPING SHALL BE "CAT TRACKED" AND APPROVED BY THE ENGINEER PRIOR TO FINAL INSTALLATION. THE CONTRACTOR SHALL NOTIFY THE ENGINEER AFTER COMPLETING LAYOUT AND AT LEAST 3 WORKING DAYS BEFORE COMMENCING INSTALLATION OF STRIPING, MARKINGS AND MARKERS.
- TRAFFIC SIGN FACE SHALL BE 3M DIAMOND GRADE DG3 REFLECTIVE SHEETING (ASTM XI) OR APPROVED EQUAL WITH PROTECTIVE GRAFFITI OVERLAY FILM OR AS OTHERWISE NOTED. ALL WARNING SIGNS SHALL HAVE A FLUORESCENT YELLOW BACKGROUND AND SCHOOL SIGNS NOTED SHALL HAVE A FLUORESCENT YELLOW-GREEN BACKGROUND.
- SIGNS SHALL BE STANDARD SIZE UNLESS NOTED OTHERWISE. PRIOR TO INSTALLATION, NEW SIGNS SHALL BE APPROVED BY THE CITY OF RIVERSIDE. EXACT LOCATIONS OF SIGNS SHALL BE DETERMINED BY THE CITY ENGINEER.
- ALL EXISTING SIGNS AND POSTS TO BE REMOVED SHALL BE DELIVERED TO THE CITY OF RIVERSIDE SIGN DEPARTMENT.
- STRIPING SHALL BE APPLIED WITHIN 48 HOURS OF SURFACE COURSE REPLACEMENT ON STREETS OPEN TO THE PUBLIC. IN NO CASE SHALL A NEWLY PAVED STREET OPEN TO THE PUBLIC BE LEFT UNSTRIPED OVER A WEEKEND OR HOLIDAY.
- CONTRACTOR SHALL INSTALL NEW SIGN(S) AND/OR POST(S) PER CITY OF RIVERSIDE STANDARD DRAWING No. 664, SEE SPECIFICATIONS. 13. CONTRACTOR SHALL INSTALL NEW STREET NAME SIGNS AND POST PER CITY OF RIVERSIDE STANDARD DRAWING No. 662, SEE SPECIFICATIONS.
- ALL CONFLICTING STRIPING, PAVEMENT MARKINGS, LEGENDS, AND RAISED PAVEMENT MARKERS SHALL BE REMOVED EVEN IF NOT SHOWN ON PLANS. REMOVALS OF PAINTED STRIPING, PAVEMENT MARKINGS AND LEGENDS SHALL BE DONE BY WET SANDBLASTING. REMOVALS OF THERMOPLASTIC STRIPING, PAVEMENT MARKINGS AND LEGENDS SHALL BE REMOVED BY WET SANDBLASTING, GRINDING OR OTHER APPROVED METHOD AND SHALL NOT DAMAGE THE PAVEMENT. "BLACK OUT" OF EXISTING DELINEATION IS NOT PERMITTED. ALL DAMAGED PAVEMENT DUE TO REMOVALS SHALL BE REPAIRED AS NECESSARY TO MAINTAIN A SMOOTH AND UNIFORM SURFACE OR AS DIRECTED BY THE ENGINEER. ALL STRIPING REMOVALS AND LEGENDS SHALL BE "FOG SEALED".
- WHERE APPLICABLE, OUTBOUND LANE LINE DETAILS SHALL COMMENCE AT THE CROSSWALK, MEANING THE PAINTED PORTION OF THE DETAIL SHALL JOIN THE CROSSWALK.

**SIGNING AND STRIPING LEGEND AND CONSTRUCTION NOTES:**

- [E] EXISTING TO REMAIN.
- # INSTALL CALTRANS STRIPING DETAIL PER NUMBER NOTED, INCLUDING INSTALLATION OF RAISED PAVEMENT MARKERS.
- (PM) INSTALL PAVEMENT MARKING OR ARROW AS NOTED.
- (RP) REMOVE ALL EXISTING CONFLICTING TRAFFIC STRIPING AND MARKINGS AS NOTED, INCLUDING RAISED PAVEMENT MARKERS.
- (1-1) SIGN LOCATION
- (IS) FURNISH AND INSTALL ROADSIDE SIGN(S) OR SNS WITH/WITHOUT POST
- (RS) REMOVE SIGN(S)
- (RL) RELOCATE EXISTING SIGN(S) TO EXISTING POST OR INSTALL POST (IF APPLICABLE)
- △ PROPOSED SIGN (ONE POST)
- ◻ EXISTING STREET NAME SIGN
- SNS STREET NAME SIGN

MATCHLINE - SEE SHEET No. 2

MATCHLINE - SEE SHEET No. 3

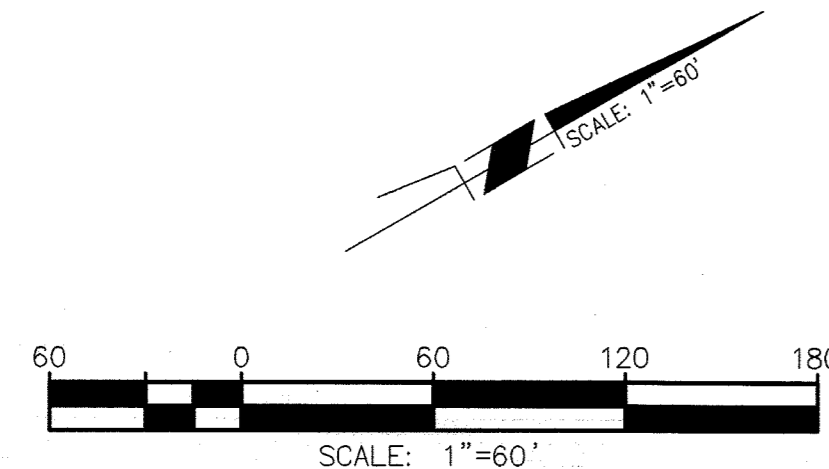
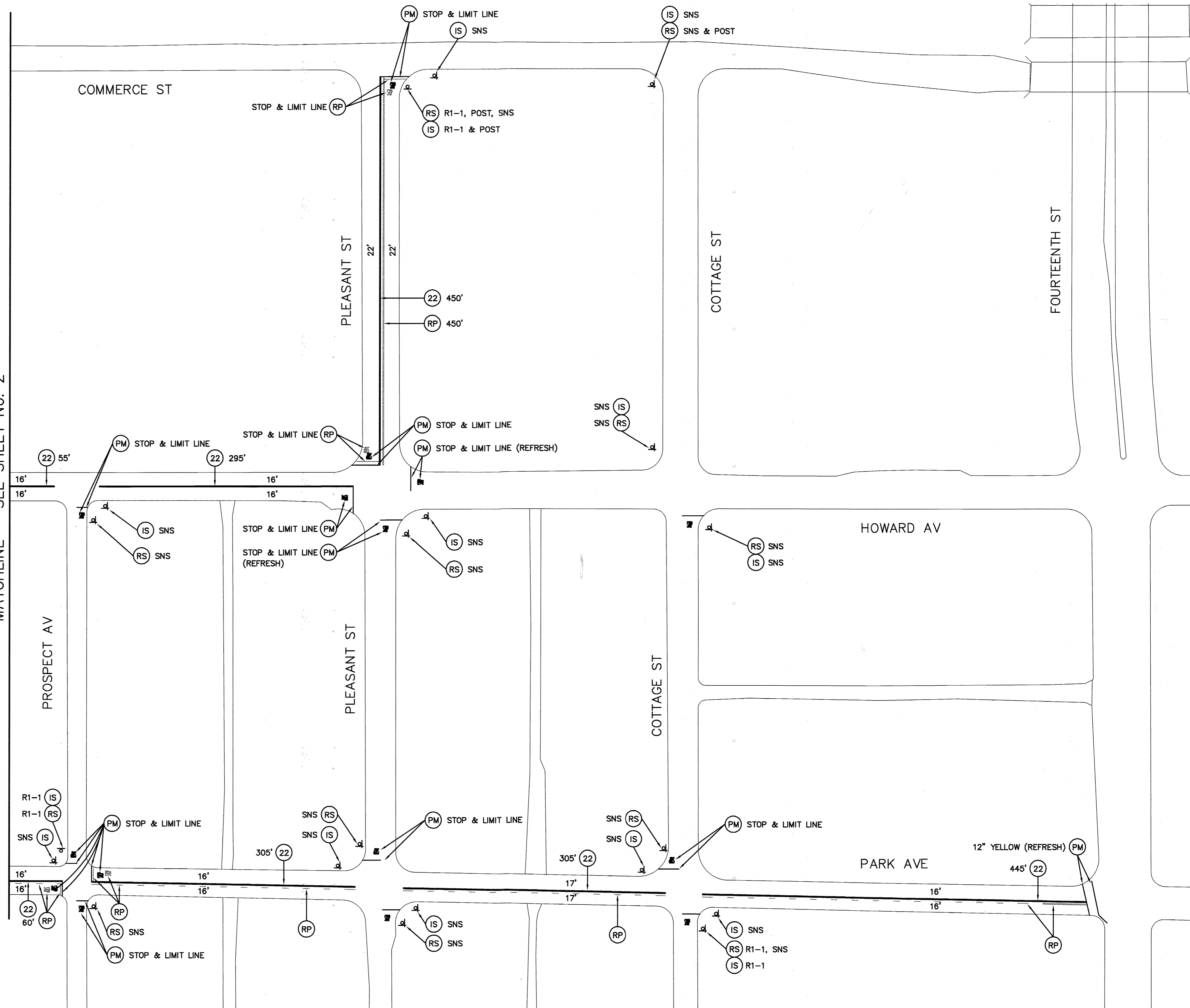

Under Ground Service Alert of Southern California  
Call: TOLL FREE 1-800-227-2600  
TWO WORKING DAYS BEFORE YOU DIG

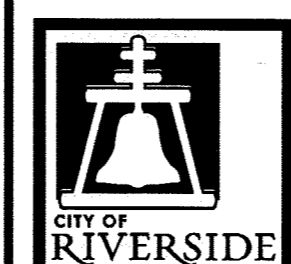

**ENGINEER IN RESPONSIBLE CHARGE**  
GILBERT M. HERNANDEZ  
R.C.E. No. 69170 EXPIRES: 8-30-16  
DATE: 10-29-14

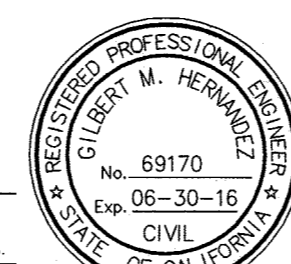

MARK	REVISIONS	APPR.	DATE

DESIGNED BY: GMH DRAWN BY: GMH CHECKED BY: GMH

CITY OF RIVERSIDE, CALIFORNIA DEPARTMENT OF PUBLIC WORKS			
APPROVED BY	BY	DATE	APPROVED BY
ENGINEERING MANAGER	Fm	12/18/14	CITY ENGINEER
TRAFFIC DIVISION	DL	12/18/14	DATE: 12/18/2014
CONSTRUCTION ADMIN.			

SIGNING AND STRIPING PLAN	
2014/2015 MINOR STREETS MAINTENANCE PHASE 1	
SCALE: 1" = 60'	

XL-730  
SHEET 1 OF 13  
FILE NAME: XL-730-1.DWG

**SIGNING AND STRIPING LEGEND AND CONSTRUCTION NOTES:**

- E EXISTING TO REMAIN.
- # INSTALL CALTRANS STRIPING DETAIL PER NUMBER NOTED, INCLUDING INSTALLATION OF RAISED PAVEMENT MARKERS.
- PM INSTALL PAVEMENT MARKING OR ARROW AS NOTED.
- RP REMOVE ALL EXISTING CONFLICTING TRAFFIC STRIPING AND MARKINGS AS NOTED, INCLUDING RAISED PAVEMENT MARKERS.
- 1-1 SIGN LOCATION
- IS FURNISH AND INSTALL ROADSIDE SIGN(S) OR SNS WITH/WITHOUT POST
- RS REMOVE SIGN(S)
- RL RELOCATE EXISTING SIGN(S) TO EXISTING POST OR INSTALL POST (IF APPLICABLE)
- PROPOSED SIGN (ONE POST)
- EXISTING STREET NAME SIGN
- SNS STREET NAME SIGN

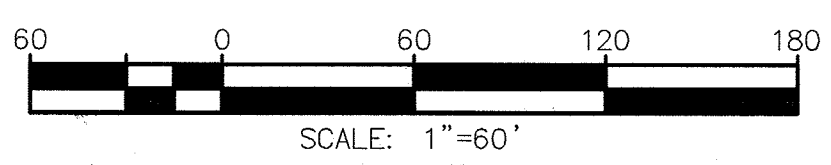
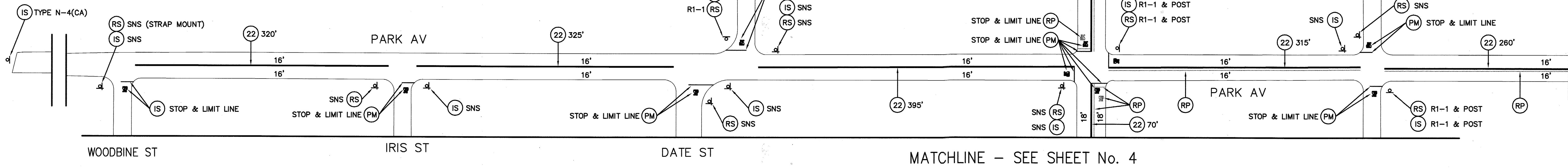
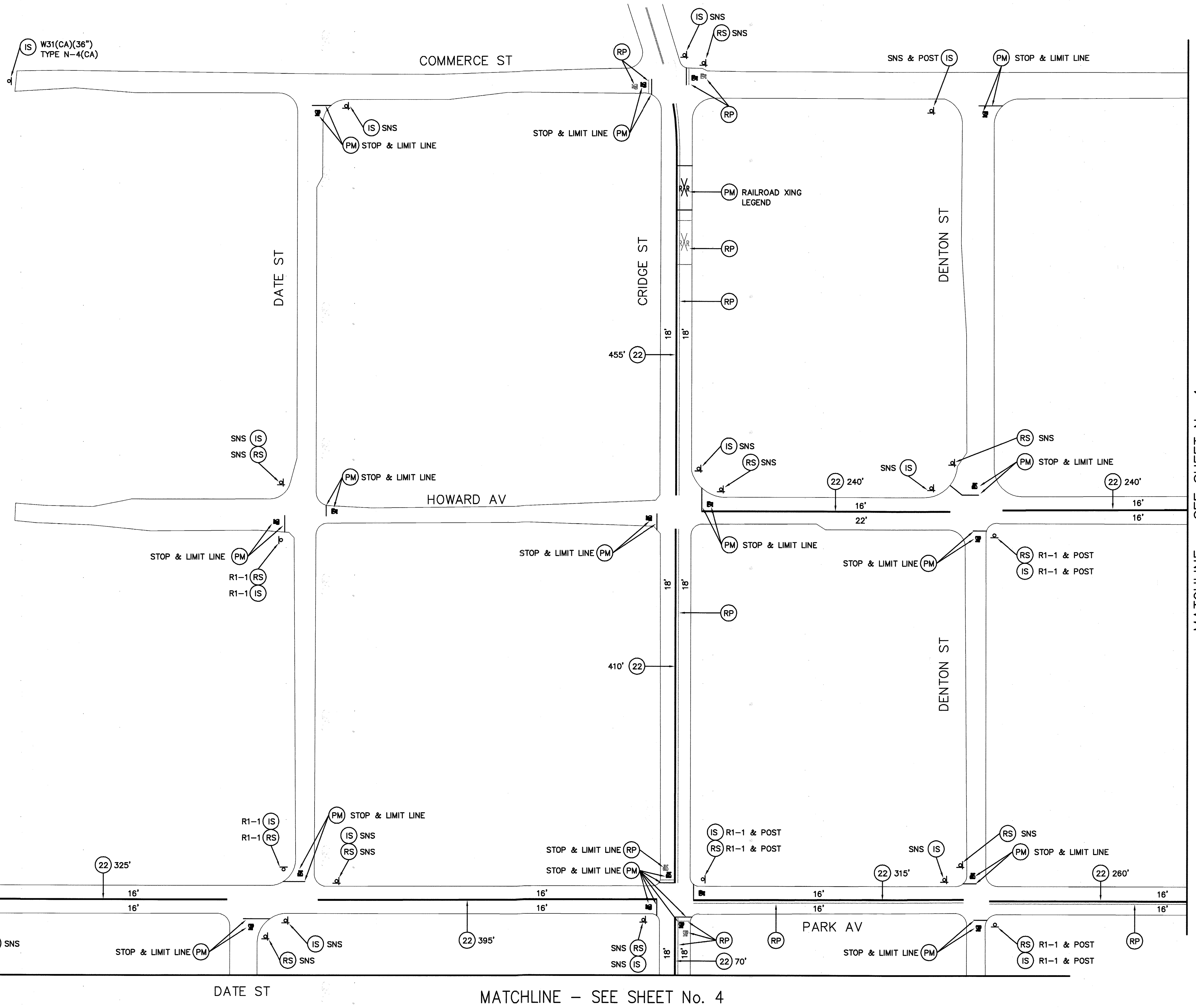

Under Ground Service Alert of Southern California  
 Call: TOLL FREE 1-800-227-2600  
**TWO WORKING DAYS BEFORE YOU DIG**

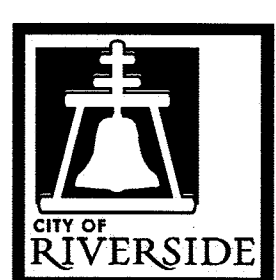

**ENGINEER IN RESPONSIBLE CHARGE**  
 GILBERT M. HERNANDEZ  
 R.C.E. No. 69170 EXPIRES: 8-30-16  
 DATE: 10-29-14



MARK	REVISIONS	APPR.	DATE

**CITY OF RIVERSIDE, CALIFORNIA DEPARTMENT OF PUBLIC WORKS**

APPROVED BY	BY	DATE	APPROVED BY	DATE
ENGINEERING MANAGER	FM	12/12/14	CITY ENGINEER	12/19/14
TRAFFIC DIVISION				
CONSTRUCTION ADMIN.	JL	12/18/14		

DESIGNED BY: GMH DRAWN BY: GMH CHECKED BY: GMH

**SIGNING AND STRIPING PLAN**

2014/2015 MINOR STREETS MAINTENANCE PHASE 1

SCALE: 1" = 60'

**XL-730**

SHEET 2 OF 13

FILE NAME: XL-730-1.DWG

MATCHLINE - SEE SHEET No. 1

MATCHLINE - SEE SHEET No. 4

G:\ADMIN\USER\TRAFFIC\XL-DWGS\XL730-1.DWG

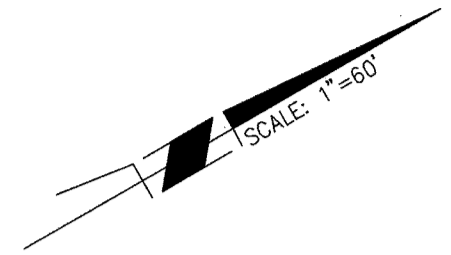

MATCHLINE - SEE SHEET No. 4

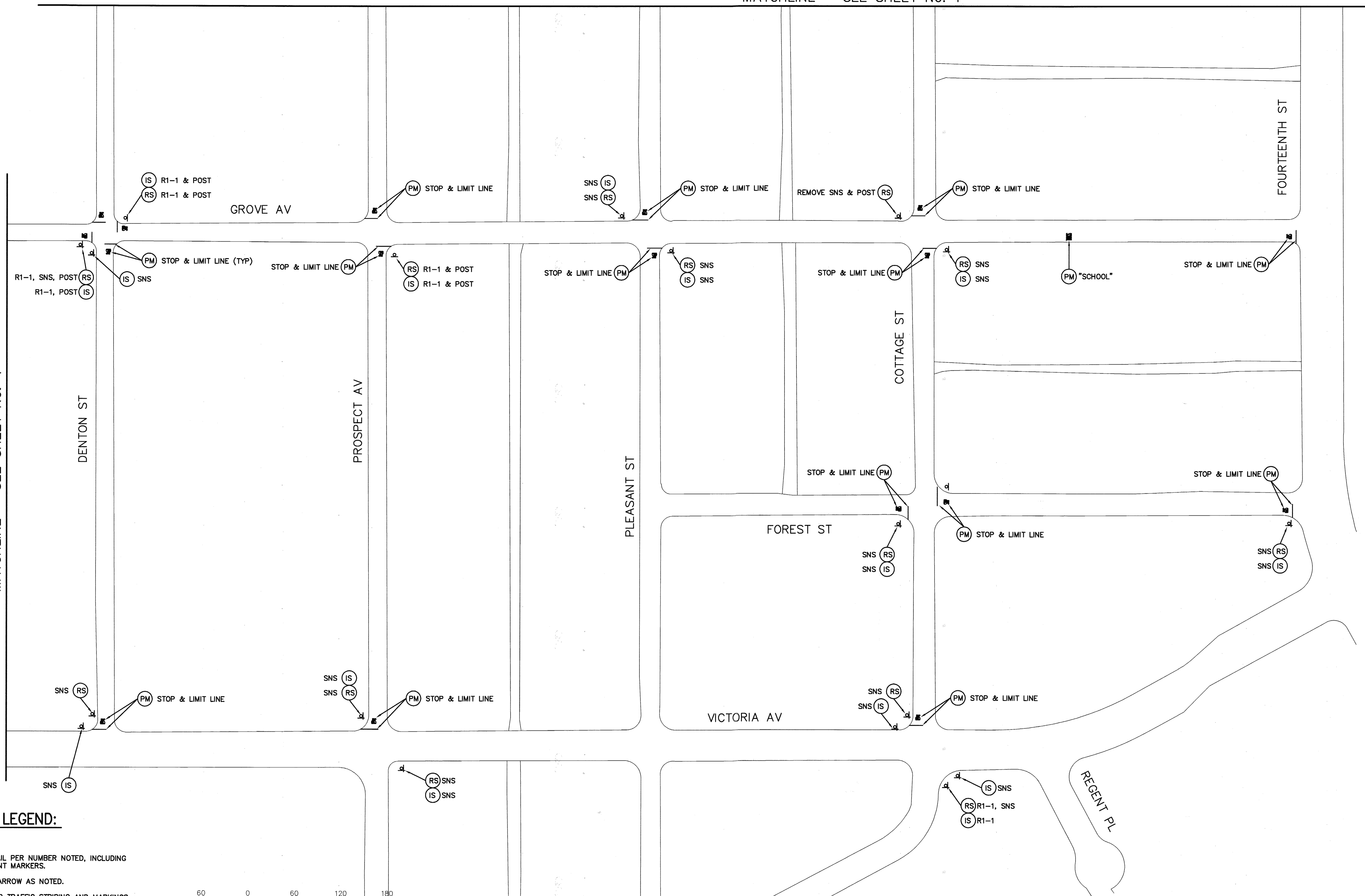

**SIGNING AND STRIPING LEGEND:**

- E EXISTING TO REMAIN.
- # INSTALL CALTRANS STRIPING DETAIL PER NUMBER NOTED, INCLUDING INSTALLATION OF RAISED PAVEMENT MARKERS.
- PM INSTALL PAVEMENT MARKING OR ARROW AS NOTED.
- RP REMOVE ALL EXISTING CONFLICTING TRAFFIC STRIPING AND MARKINGS AS NOTED, INCLUDING RAISED PAVEMENT MARKERS.
- 1-1 SIGN LOCATION
- IS FURNISH AND INSTALL ROADSIDE SIGN(S) OR SNS WITH/WITHOUT POST
- RS REMOVE SIGN(S)
- PROPOSED SIGN (ONE POST)
- ◻ EXISTING STREET NAME SIGN
- SNS STREET NAME SIGN

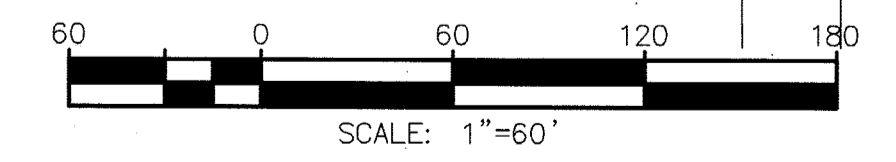

Under Ground  
Service Alert  
of Southern California  
Call: TOLL FREE  
**1-800-227-2600**  
**TWO WORKING DAYS BEFORE YOU DIG**

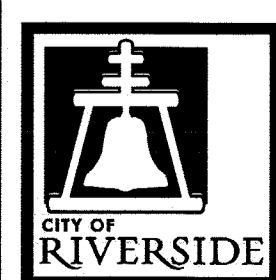

**ENGINEER IN RESPONSIBLE CHARGE**  
*Gilbert M. Hernandez*  
GILBERT M. HERNANDEZ  
R.C.E. No. 69170 EXPIRES: 6-30-16  
CIVIL  
STATE OF CALIFORNIA  
DATE: 10-29-14

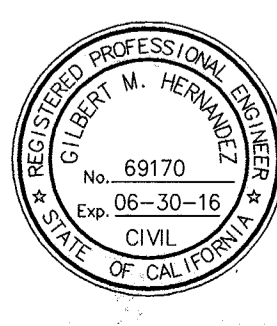

MARK	REVISIONS	APPR.	DATE

DESIGNED BY: GMH DRAWN BY: GMH CHECKED BY: GMH

CITY OF RIVERSIDE, CALIFORNIA DEPARTMENT OF PUBLIC WORKS			
APPROVED BY	BY	DATE	APPROVED BY
ENGINEERING MANAGER	FM	12/18/14	<i>[Signature]</i>
TRAFFIC DIVISION			CITY ENGINEER
CONSTRUCTION ADMIN.	DC	12/18/14	
			DATE: 12/18/14

SIGNING AND STRIPING PLAN
2014/2015 MINOR STREETS MAINTENANCE PHASE 1
SCALE: 1" = 60'

XL-730
SHEET <b>3</b> OF <b>13</b>
FILE NAME: XL-730-1.DWG

MATCHLINE - SEE SHEET No. 2

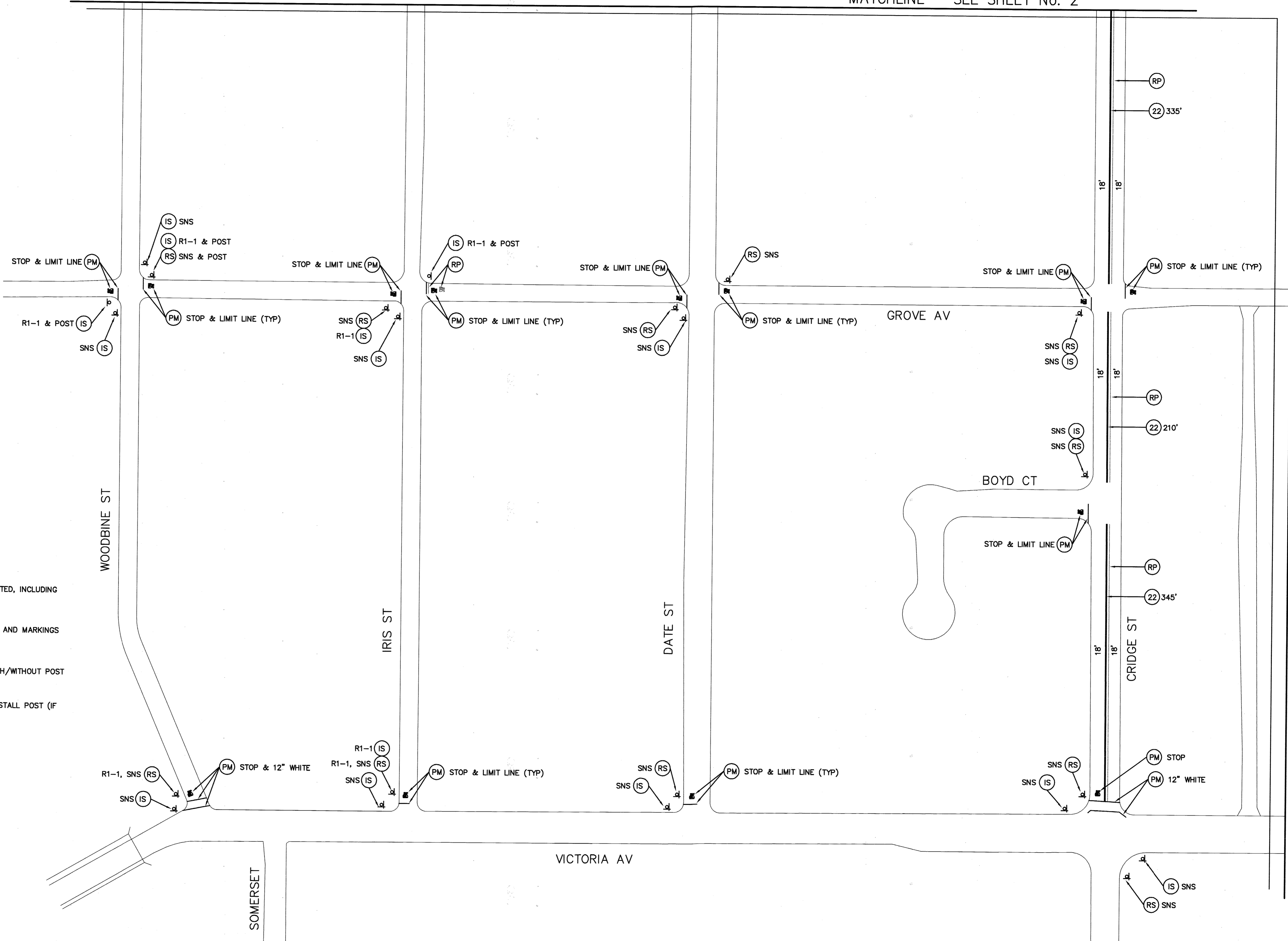

**SIGNING AND STRIPING LEGEND:**

- E EXISTING TO REMAIN.
- # INSTALL CALTRANS STRIPING DETAIL PER NUMBER NOTED, INCLUDING INSTALLATION OF RAISED PAVEMENT MARKERS.
- PM INSTALL PAVEMENT MARKING OR ARROW AS NOTED.
- RP REMOVE ALL EXISTING CONFLICTING TRAFFIC STRIPING AND MARKINGS AS NOTED, INCLUDING RAISED PAVEMENT MARKERS.
- 1-1 SIGN LOCATION
- IS FURNISH AND INSTALL ROADSIDE SIGN(S) OR SNS WITH/WITHOUT POST
- RS REMOVE SIGN(S)
- RL RELOCATE EXISTING SIGN(S) TO EXISTING POST OR INSTALL POST (IF APPLICABLE)
- P PROPOSED SIGN (ONE POST)
- A EXISTING STREET NAME SIGN
- SNS STREET NAME SIGN

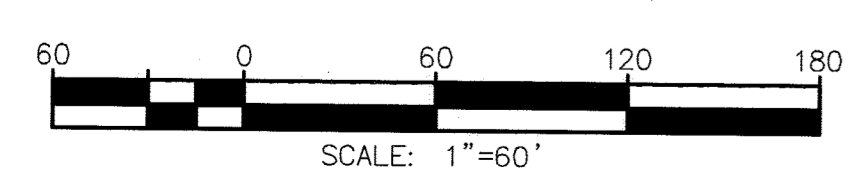
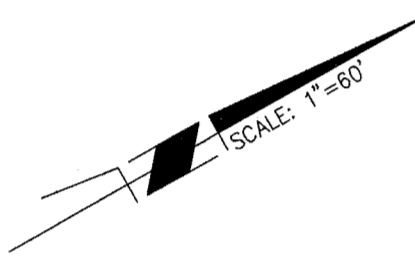

Under Ground Service Alert of Southern California  
 Call: TOLL FREE 1-800-227-2600  
 TWO WORKING DAYS BEFORE YOU DIG

**ENGINEER IN RESPONSIBLE CHARGE**  
 GILBERT M. HERNANDEZ  
 R.C.E. No. 69170 EXPIRES: 6-30-16  
 DATE: 10-29-14

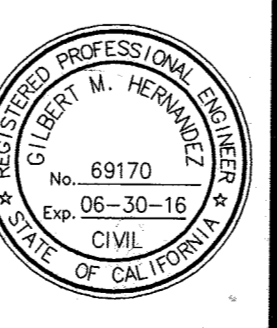

MARK	REVISIONS	APPR.	DATE

<b>CITY OF RIVERSIDE, CALIFORNIA DEPARTMENT OF PUBLIC WORKS</b>			
APPROVED BY	BY	DATE	APPROVED BY
ENGINEERING MANAGER	FM	12/18/14	<i>[Signature]</i>
TRAFFIC DIVISION	DC	12/18/14	CITY ENGINEER
CONSTRUCTION ADMIN.			
DESIGNED BY	GMH	DRAWN BY	GMH
		CHECKED BY	GMH

<b>SIGNING AND STRIPING PLAN</b>	
<b>2014/2015 MINOR STREETS MAINTENANCE PHASE 1</b>	
SCALE: 1" = 60'	

<b>XL-730</b>
SHEET <b>4</b> OF <b>13</b>
FILE NAME: XL-730-1.DWG

MATCHLINE - SEE SHEET No. 3

G:\ADMIN\USER\TRAFFIC\XL-DWGS\XL-730-1.DWG

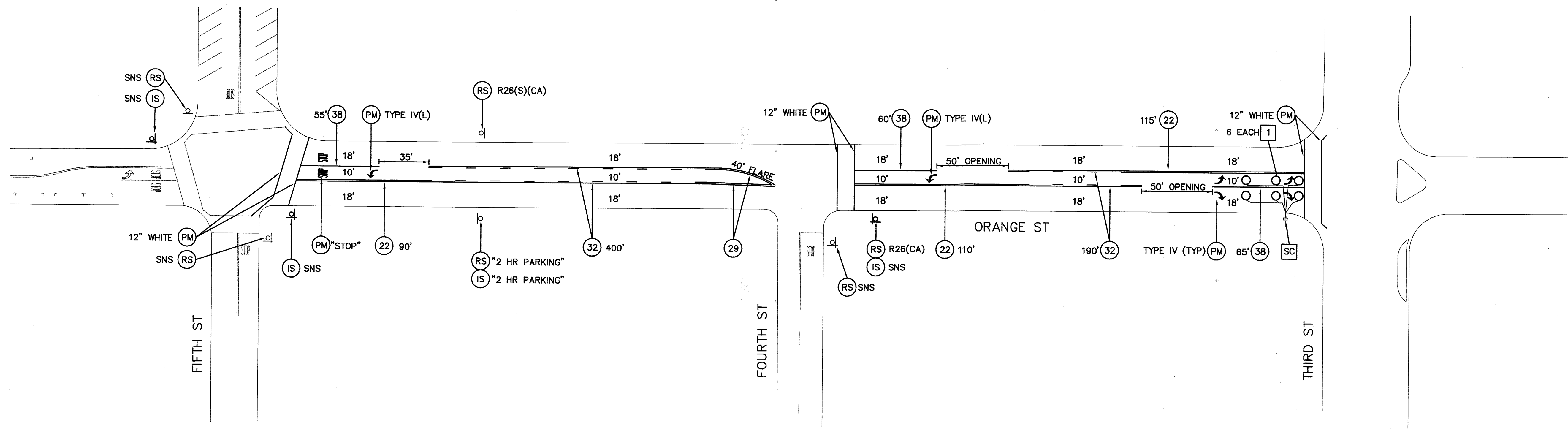

**SIGNING AND STRIPING LEGEND:**

- E EXISTING TO REMAIN.
- I INSTALL LOOP DETECTOR TYPE "E" PER LOOP DETECTOR LAYOUT
- # INSTALL CALTRANS STRIPING DETAIL PER NUMBER NOTED, INCLUDING INSTALLATION OF RAISED PAVEMENT MARKERS.
- PM INSTALL PAVEMENT MARKING OR ARROW AS NOTED.
- RP REMOVE ALL EXISTING CONFLICTING TRAFFIC STRIPING AND MARKINGS AS NOTED, INCLUDING RAISED PAVEMENT MARKERS.
- IS FURNISH AND INSTALL ROADSIDE SIGN(S) OR SNS WITH/WITHOUT POST
- RS REMOVE SIGN(S)
- RL RELOCATE EXISTING SIGN(S) TO EXISTING POST OR INSTALL POST (IF APPLICABLE)
- ◻ PROPOSED SIGN (ONE POST)
- ◻ EXISTING STREET NAME SIGN
- SNS STREET NAME SIGN

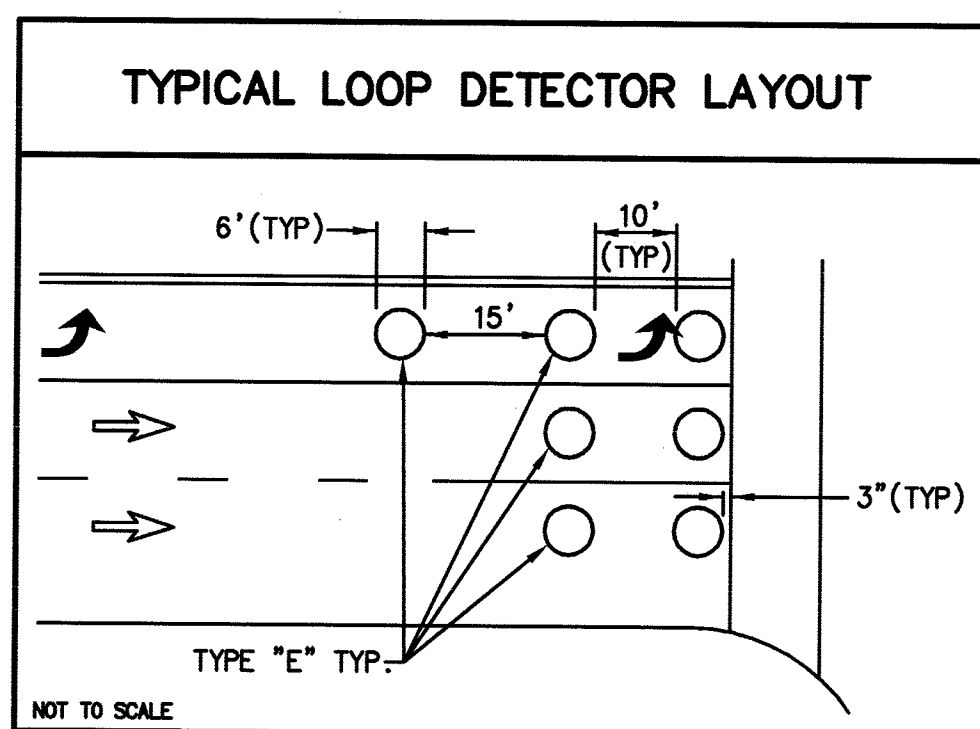
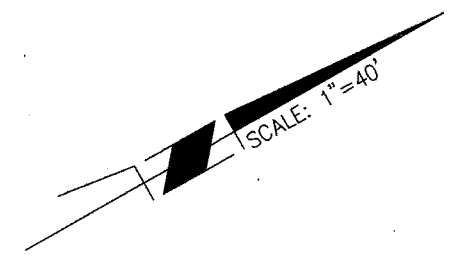

ITEM	DESCRIPTION	QUANTITY					TOTAL	UNIT
		SHEET 1	SHEET 2	SHEET 3	SHEET 4	SHEET 5		
1	DETAIL 22	1915	3030	0	890	315	6150	LF
2	DETAIL 29	0	0	0	0	90	90	LF
3	DETAIL 32	0	0	0	0	590	590	LF
4	12" WHITE/YELLOW	340	410	305	325	340	1720	SF
5	PAVEMENT LEGENDS/MARKINGS	308	510	409	286	134	1647	SF
6	REMOVE PAVEMENT LEGENDS	170	230	0	35	0	435	SF
7	REMOVE LANE LINE STRIPING	1565	1440	0	890	0	3895	LF
8	ROADSIDE SIGN(S) 1 POST	1	5	3	3	0	12	EA
9	ROADSIDE SIGN(S) NO POST	2	2	1	1	1	7	EA
10	REMOVE SIGN	11	15	14	10	6	56	EA
11	STREET NAME SIGN	12	12	11	11	3	49	EA
12	TYPE "E" DETECTOR LOOP	0	0	0	0	6	6	EA
13	SPLICE DETECTOR LOOP CONDUCTORS	0	0	0	0	1	1	EA

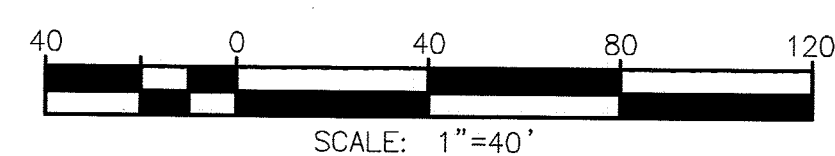

Under Ground Service Alert of Southern California  
 Call: TOLL FREE 1-800-227-2600  
 TWO WORKING DAYS BEFORE YOU DIG

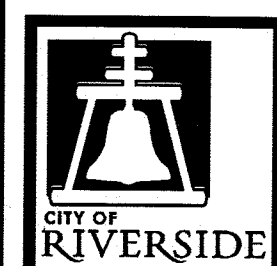

**ENGINEER IN RESPONSIBLE CHARGE**  
 GILBERT M. HERNANDEZ  
 R.C.E. No. 69170 EXPIRES: 6-30-16  
 DATE 10-29-14

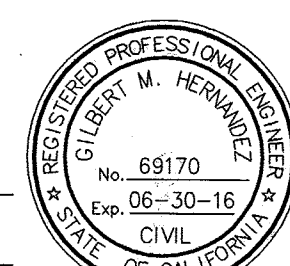

MARK	REVISIONS	APPR.	DATE

DESIGNED BY: GMH DRAWN BY: GMH CHECKED BY: GMH

CITY OF RIVERSIDE, CALIFORNIA DEPARTMENT OF PUBLIC WORKS			
APPROVED BY	BY	DATE	APPROVED BY
ENGINEERING MANAGER	EM	12/18/14	CITY ENGINEER
TRAFFIC DIVISION			
CONSTRUCTION ADMIN.	DC	12/18/14	DATE 12/19/2014

SIGNING AND STRIPING PLAN	
2014/2015 MINOR STREETS MAINTENANCE PHASE 1	
SCALE: 1" = 60'	

XL-730
SHEET 5 OF 13
FILE NAME: XL-730-1.DWG

G:\ADMIN\USER\TRAFFIC\XL-DWGS\XL730-1.DWG

**SIGNING AND STRIPING GENERAL NOTES:**

- SIGNING AND STRIPING INSTALLATIONS SHALL CONFORM TO THE 2012 CALIFORNIA MANUAL ON UNIFORM TRAFFIC CONTROL DEVICES (CA MUTCD), THE STATE OF CALIFORNIA DEPARTMENT OF TRANSPORTATION (CALTRANS) STANDARD PLANS AND SPECIFICATIONS DATED 2010, AND ALL ADDENDUMS THERETO, AND THE CITY OF RIVERSIDE PUBLIC WORKS DEPARTMENT STANDARD DRAWINGS, CURRENT EDITION.
- ALL STRIPING, MARKINGS, AND LEGENDS SHALL BE REFLECTORIZED THERMOPLASTIC UNLESS OTHERWISE NOTED. THE CONTRACTOR SHALL PROVIDE AND INSTALL RAISED PAVEMENT MARKERS FOR ALL STRIPING. STRIPING, MARKINGS AND LEGENDS SHALL CONFORM TO THE LATEST CALTRANS STANDARD PLANS A20A THRU A20D AND A24A THRU A24E.
- PRIOR TO FINAL ACCEPTANCE OF STREET IMPROVEMENTS, ALL PAVEMENT STRIPING AND STENCILING WITHIN THE PERIMETER OF THE CONSTRUCTION AREA SHALL BE RESTORED TO LIKE NEW CONDITION, IN A MANNER MEETING THE APPROVAL OF THE CITY OF RIVERSIDE.
- THE CONTRACTOR SHALL RE-STRIPE EXISTING STRIPING AND CURB MARKINGS OBLITERATED BY NEW CONSTRUCTION, WHETHER OR NOT SHOWN ON THE PLANS FOR REPLACEMENT, AT NO COST TO THE CITY.
- AT LOCATIONS WHERE EXISTING PAINTED CURB IS TO BE RECONSTRUCTED, THE CONTRACTOR SHALL PAINT THE NEW CURB AS SHOWN ON THE PLANS WITHIN 10 WORKING DAYS OF CURB CONSTRUCTION OR AS DIRECTED BY ENGINEER. THE PAINT SHALL BE WATER-BASED WITH 2-YEAR GUARANTEE AGAINST COLOR FADING. PRIOR TO THE START OF CONSTRUCTION, THE CONTRACTOR SHALL SUBMIT TO THE CITY WRITTEN PROOF OF THE MANUFACTURER'S 2-YEAR GUARANTEE.
- ALL NEW STRIPING SHALL BE "CAT TRACKED" AND APPROVED BY THE ENGINEER PRIOR TO FINAL INSTALLATION. THE CONTRACTOR SHALL NOTIFY THE ENGINEER AFTER COMPLETING LAYOUT AND AT LEAST 3 WORKING DAYS BEFORE COMMENCING INSTALLATION OF STRIPING, MARKINGS AND MARKERS.
- TRAFFIC SIGN FACE SHALL BE 3M DIAMOND GRADE D03 REFLECTIVE SHEETING (ASTM XI) OR APPROVED EQUAL WITH PROTECTIVE GRAFFITI OVERLAY FILM OR AS OTHERWISE NOTED. ALL WARNING SIGNS SHALL HAVE A FLUORESCENT YELLOW BACKGROUND AND SCHOOL SIGNS NOTED SHALL HAVE A FLUORESCENT YELLOW-GREEN BACKGROUND.
- SIGNS SHALL BE STANDARD SIZE UNLESS NOTED OTHERWISE. PRIOR TO INSTALLATION, NEW SIGNS SHALL BE APPROVED BY THE CITY OF RIVERSIDE. EXACT LOCATIONS OF SIGNS SHALL BE DETERMINED BY THE CITY ENGINEER.
- ALL EXISTING SIGNS AND POSTS TO BE REMOVED SHALL BE DELIVERED TO THE CITY OF RIVERSIDE SIGN DEPARTMENT.
- STRIPING SHALL BE APPLIED WITHIN 48 HOURS OF SURFACE COURSE REPLACEMENT ON STREETS OPEN TO THE PUBLIC. IN NO CASE SHALL A NEWLY PAVED STREET OPEN TO THE PUBLIC BE LEFT UNSTRIPED OVER A WEEKEND OR HOLIDAY.
- CONTRACTOR SHALL INSTALL NEW SIGN(S) AND/OR POST(S) PER CITY OF RIVERSIDE STANDARD DRAWING No. 664, SEE SPECIFICATIONS. 13. CONTRACTOR SHALL INSTALL NEW STREET NAME SIGNS AND POST PER CITY OF RIVERSIDE STANDARD DRAWING No. 662, SEE SPECIFICATIONS.
- ALL CONFLICTING STRIPING, PAVEMENT MARKINGS, LEGENDS, AND RAISED PAVEMENT MARKERS SHALL BE REMOVED EVEN IF NOT SHOWN ON PLANS. REMOVALS OF PAINTED STRIPING, PAVEMENT MARKINGS AND LEGENDS SHALL BE DONE BY WET SANDBLASTING. REMOVALS OF THERMOPLASTIC STRIPING, PAVEMENT MARKINGS AND LEGENDS SHALL BE REMOVED BY WET SANDBLASTING, GRINDING OR OTHER APPROVED METHOD AND SHALL NOT DAMAGE THE PAVEMENT. "BLACK OUT" OF EXISTING DELINEATION IS NOT PERMITTED. ALL DAMAGED PAVEMENT DUE TO REMOVALS SHALL BE REPAIRED AS NECESSARY TO MAINTAIN A SMOOTH AND UNIFORM SURFACE OR AS DIRECTED BY THE ENGINEER. ALL STRIPING REMOVALS AND LEGENDS SHALL BE "FOG SEALED".
- WHERE APPLICABLE, OUTBOUND LANE LINE DETAILS SHALL COMMENCE AT THE CROSSWALK, MEANING THE PAINTED PORTION OF THE DETAIL SHALL JOIN THE CROSSWALK.

**SIGNING AND STRIPING LEGEND AND CONSTRUCTION NOTES:**

- E** EXISTING TO REMAIN.
- #** INSTALL CALTRANS STRIPING DETAIL PER NUMBER NOTED, INCLUDING INSTALLATION OF RAISED PAVEMENT MARKERS.
- PM** INSTALL PAVEMENT MARKING OR ARROW AS NOTED.
- RP** REMOVE ALL EXISTING CONFLICTING TRAFFIC STRIPING AND MARKINGS AS NOTED, INCLUDING RAISED PAVEMENT MARKERS.
- (1-1)** SIGN LOCATION
- IS** FURNISH AND INSTALL ROADSIDE SIGN(S) OR SNS WITH/WITHOUT POST
- RS** REMOVE SIGN(S)
- RL** RELOCATE EXISTING SIGN(S) TO EXISTING POST OR INSTALL POST (IF APPLICABLE)
- PROPOSED SIGN (ONE POST)
- EXISTING STREET NAME SIGN
- SNS** STREET NAME SIGN

STRIPING/SIGNAGE QUANTITIES					
ITEM	DESCRIPTION	QUANTITY		TOTAL	UNIT
		SHEET 6	SHEET 7		
1	DETAIL 22	100	270	370	LF
2	DETAIL "A"	170	170	340	SF
3	4" WHITE	0	230	230	LF
4	12" WHITE/YELLOW	525	326	851	SF
5	PAVEMENT LEGENDS/MARKINGS	233	303	536	SF
6	ROADSIDE SIGN(S) 1 POST	5	4	9	EA
7	ROADSIDE SIGN(S) NO POST	1	4	5	EA
8	REMOVE SIGN	15	14	29	EA
9	STREET NAME SIGN	7	7	14	EA
10	PAINT WHITE CURB	0	130	130	LF
11	REMOVE PAVEMENT MARKING	0	135	135	SF
12	REMOVE STRIPING	0	10	10	LF

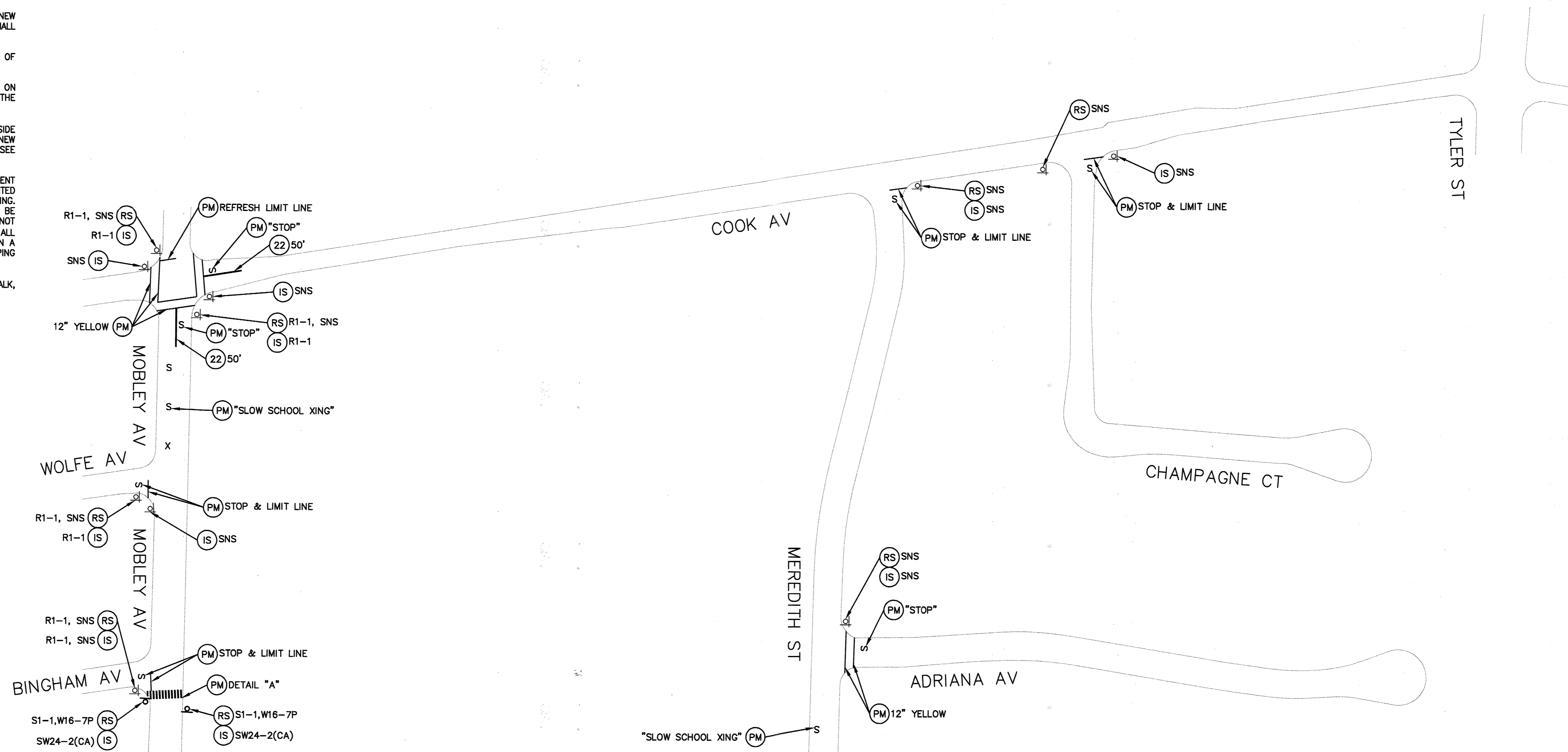
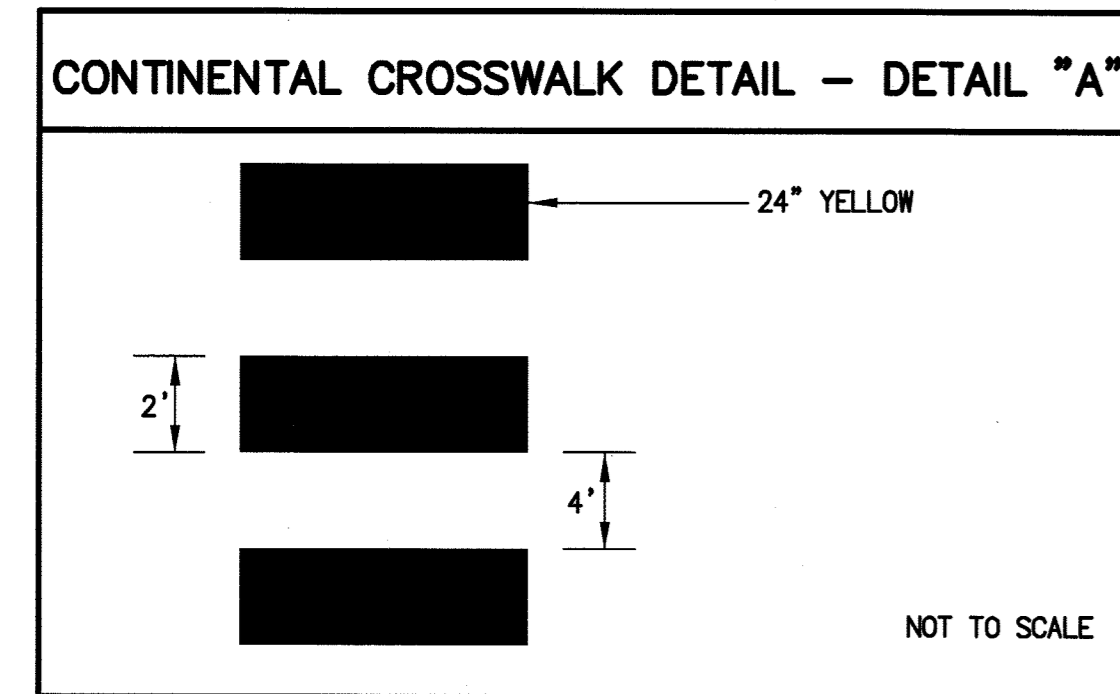

MATCHLINE - SEE SHEET No. 7

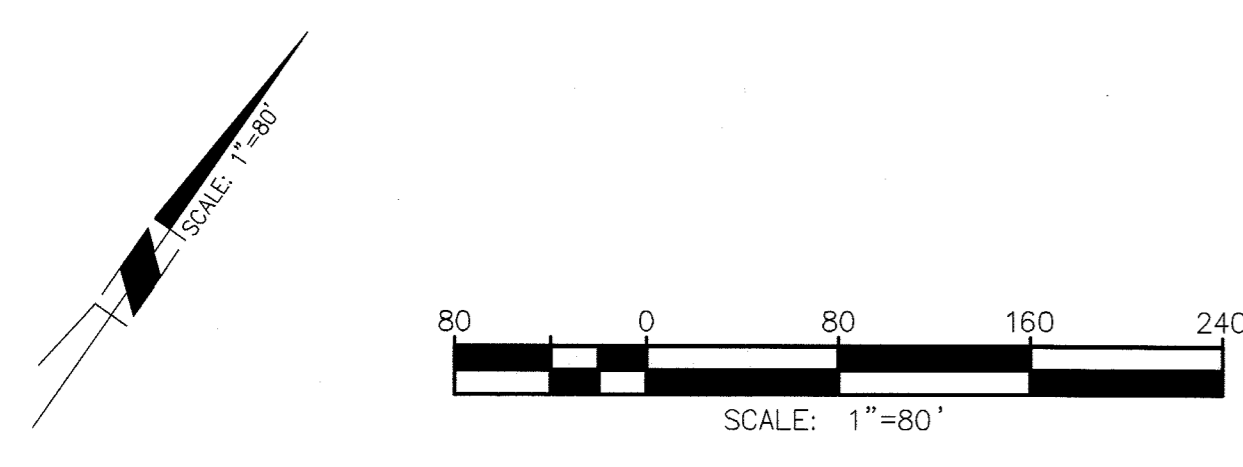

Under Ground Service Alert of Southern California  
Call: TOLL FREE 1-800-227-2600  
TWO WORKING DAYS BEFORE YOU DIG

**ENGINEER IN RESPONSIBLE CHARGE**  
GILBERT M. HERNANDEZ  
R.C.E. No. 69170 EXPIRES: 6-30-16  
DATE: 12-10-14

PROFESSIONAL ENGINEER  
GILBERT M. HERNANDEZ  
No. 69170  
Exp. 06-30-16  
CIVIL  
STATE OF CALIFORNIA

MARK	REVISIONS	APPR.	DATE

DESIGNED BY: MKS DRAWN BY: MKS CHECKED BY: GMH

CITY OF RIVERSIDE, CALIFORNIA  
DEPARTMENT OF PUBLIC WORKS

APPROVED BY	BY	DATE
ENGINEERING MANAGER	Pm	12/17/14
TRAFFIC DIVISION	DC	12/18/14
CONSTRUCTION ADMIN.		

DATE: 12/18/14

**SIGNING AND STRIPING PLAN**  
2014/2015 MINOR STREETS MAINTENANCE PHASE 1  
SCALE: 1" = 80'

XL-730  
SHEET 6 OF 13  
FILE NAME: XL-730-6.DWG

G:\ADMIN\USER\TRAFFIC\XL-0WGS\XL730-6.DWG

**SIGNING AND STRIPING GENERAL NOTES:**

- SIGNING AND STRIPING INSTALLATIONS SHALL CONFORM TO THE 2012 CALIFORNIA MANUAL ON UNIFORM TRAFFIC CONTROL DEVICES (CA MUTCD), THE STATE OF CALIFORNIA DEPARTMENT OF TRANSPORTATION (CALTRANS) STANDARD PLANS AND SPECIFICATIONS DATED 2010, AND ALL ADDENDUMS THERETO, AND THE CITY OF RIVERSIDE PUBLIC WORKS DEPARTMENT STANDARD DRAWINGS, CURRENT EDITION.
- ALL STRIPING, MARKINGS, AND LEGENDS SHALL BE REFLECTORIZED THERMOPLASTIC UNLESS OTHERWISE NOTED. THE CONTRACTOR SHALL PROVIDE AND INSTALL RAISED PAVEMENT MARKERS FOR ALL STRIPING. STRIPING, MARKINGS AND LEGENDS SHALL CONFORM TO THE LATEST CALTRANS STANDARD PLANS A20A THRU A20D AND A24A THRU A24E.
- PRIOR TO FINAL ACCEPTANCE OF STREET IMPROVEMENTS, ALL PAVEMENT STRIPING AND STENCILING WITHIN THE PERIMETER OF THE CONSTRUCTION AREA SHALL BE RESTORED TO LIKE NEW CONDITION, IN A MANNER MEETING THE APPROVAL OF THE CITY OF RIVERSIDE.
- THE CONTRACTOR SHALL RE-STRIP EXISTING STRIPING AND CURB MARKINGS OBLITERATED BY NEW CONSTRUCTION, WHETHER OR NOT SHOWN ON THE PLANS FOR REPLACEMENT, AT NO COST TO THE CITY.
- AT LOCATIONS WHERE EXISTING PAINTED CURB IS TO BE RECONSTRUCTED, THE CONTRACTOR SHALL PAINT THE NEW CURB AS SHOWN ON THE PLANS WITHIN 10 WORKING DAYS OF CURB CONSTRUCTION OR AS DIRECTED BY ENGINEER. THE PAINT SHALL BE WATER-BASED WITH 2-YEAR GUARANTEE AGAINST COLOR FADING. PRIOR TO THE START OF CONSTRUCTION, THE CONTRACTOR SHALL SUBMIT TO THE CITY WRITTEN PROOF OF THE MANUFACTURER'S 2-YEAR GUARANTEE.
- ALL NEW STRIPING SHALL BE "CAT TRACKED" AND APPROVED BY THE ENGINEER PRIOR TO FINAL INSTALLATION. THE CONTRACTOR SHALL NOTIFY THE ENGINEER AFTER COMPLETING LAYOUT AND AT LEAST 3 WORKING DAYS BEFORE COMMENCING INSTALLATION OF STRIPING, MARKINGS AND MARKERS.
- TRAFFIC SIGN FACE SHALL BE 3M DIAMOND GRADE DG3 REFLECTIVE SHEETING (ASTM XI) OR APPROVED EQUAL WITH PROTECTIVE GRAFFITI OVERLAY FILM OR AS OTHERWISE NOTED. ALL WARNING SIGNS SHALL HAVE A FLUORESCENT YELLOW BACKGROUND AND SCHOOL SIGNS NOTED SHALL HAVE A FLUORESCENT YELLOW-GREEN BACKGROUND.
- SIGNS SHALL BE STANDARD SIZE UNLESS NOTED OTHERWISE. PRIOR TO INSTALLATION, NEW SIGNS SHALL BE APPROVED BY THE CITY OF RIVERSIDE. EXACT LOCATIONS OF SIGNS SHALL BE DETERMINED BY THE CITY ENGINEER.
- ALL EXISTING SIGNS AND POSTS TO BE REMOVED SHALL BE DELIVERED TO THE CITY OF RIVERSIDE SIGN DEPARTMENT.
- STRIPING SHALL BE APPLIED WITHIN 48 HOURS OF SURFACE COURSE REPLACEMENT ON STREETS OPEN TO THE PUBLIC. IN NO CASE SHALL A NEWLY PAVED STREET OPEN TO THE PUBLIC BE LEFT UNSTRIPED OVER A WEEKEND OR HOLIDAY.
- CONTRACTOR SHALL INSTALL NEW SIGN(S) AND/OR POST(S) PER CITY OF RIVERSIDE STANDARD DRAWING No. 664, SEE SPECIFICATIONS. 13. CONTRACTOR SHALL INSTALL NEW STREET NAME SIGNS AND POST PER CITY OF RIVERSIDE STANDARD DRAWING No. 662, SEE SPECIFICATIONS.
- ALL CONFLICTING STRIPING, PAVEMENT MARKINGS, LEGENDS, AND RAISED PAVEMENT MARKERS SHALL BE REMOVED EVEN IF NOT SHOWN ON PLANS. REMOVALS OF PAINTED STRIPING, PAVEMENT MARKINGS AND LEGENDS SHALL BE DONE BY WET SANDBLASTING. REMOVALS OF THERMOPLASTIC STRIPING, PAVEMENT MARKINGS AND LEGENDS SHALL BE REMOVED BY WET SANDBLASTING, GRINDING OR OTHER APPROVED METHOD AND SHALL NOT DAMAGE THE PAVEMENT. "BLACK OUT" OF EXISTING DELINEATION IS NOT PERMITTED. ALL DAMAGED PAVEMENT DUE TO REMOVALS SHALL BE REPAIRED AS NECESSARY TO MAINTAIN A SMOOTH AND UNIFORM SURFACE OR AS DIRECTED BY THE ENGINEER. ALL STRIPING REMOVALS AND LEGENDS SHALL BE "FOG SEALED".
- WHERE APPLICABLE, OUTBOUND LANE LINE DETAILS SHALL COMMENCE AT THE CROSSWALK, MEANING THE PAINTED PORTION OF THE DETAIL SHALL JOIN THE CROSSWALK.

**SIGNING AND STRIPING LEGEND AND CONSTRUCTION NOTES:**

- (E) EXISTING TO REMAIN.
- (#) INSTALL CALTRANS STRIPING DETAIL PER NUMBER NOTED, INCLUDING INSTALLATION OF RAISED PAVEMENT MARKERS.
- (PM) INSTALL PAVEMENT MARKING OR ARROW AS NOTED.
- (RP) REMOVE ALL EXISTING CONFLICTING TRAFFIC STRIPING AND MARKINGS AS NOTED, INCLUDING RAISED PAVEMENT MARKERS.
- (1-1) SIGN LOCATION
- (IS) FURNISH AND INSTALL ROADSIDE SIGN(S) OR SNS WITH/WITHOUT POST
- (RS) REMOVE SIGN(S)
- (RL) RELOCATE EXISTING SIGN(S) TO EXISTING POST OR INSTALL POST (IF APPLICABLE)
- (WC) INSTALL WHITE CURB
- (P) PROPOSED SIGN (ONE POST)
- (S) EXISTING STREET NAME SIGN
- (SNS) STREET NAME SIGN

MATCHLINE - SEE SHEET No. 6

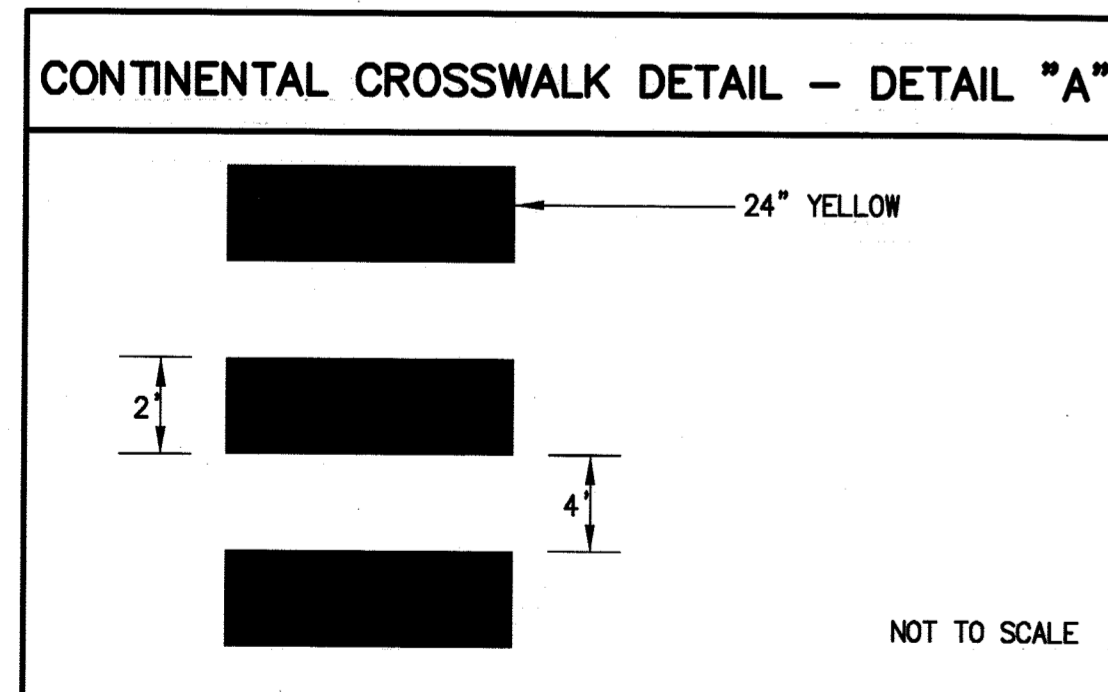
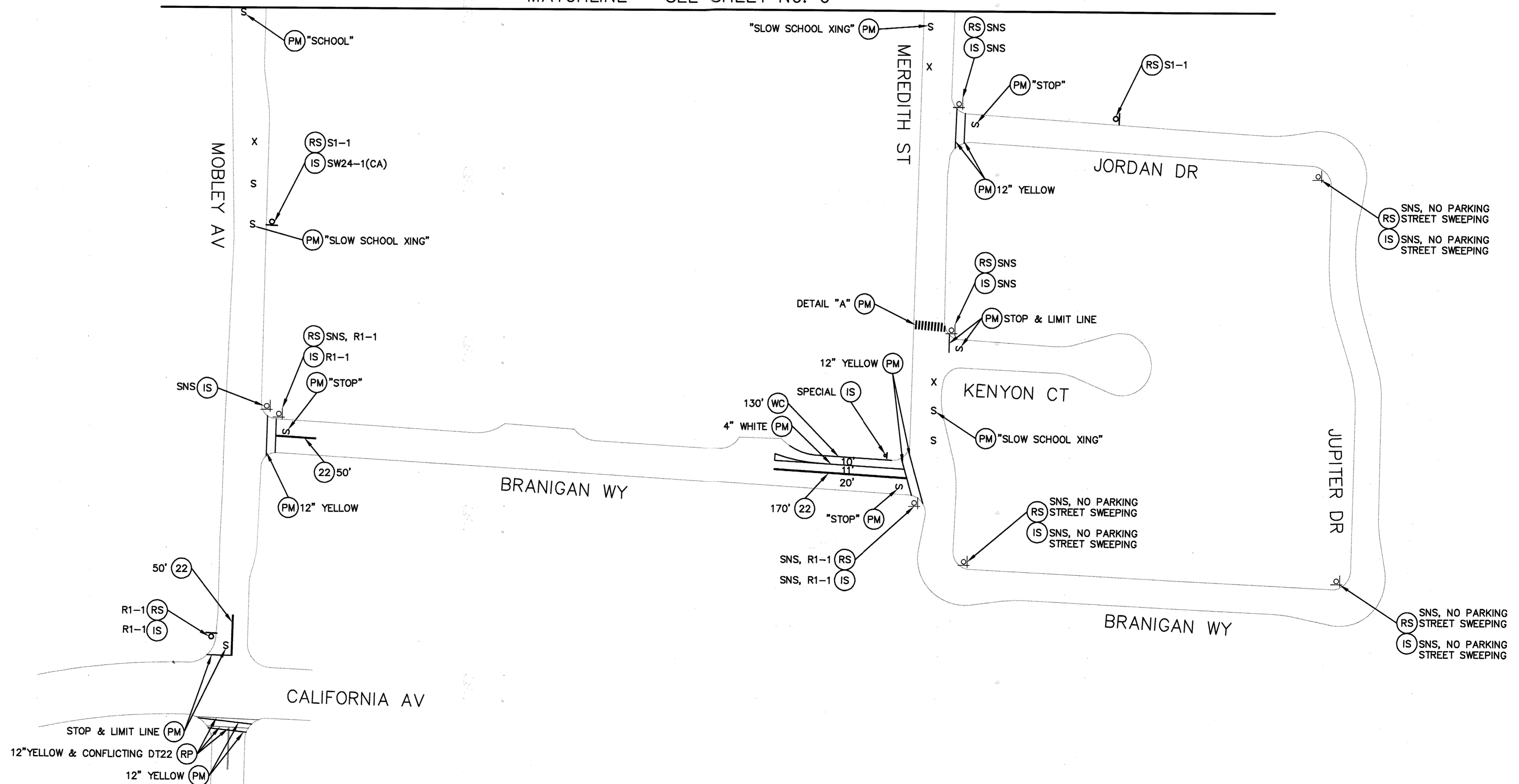

SPECIAL

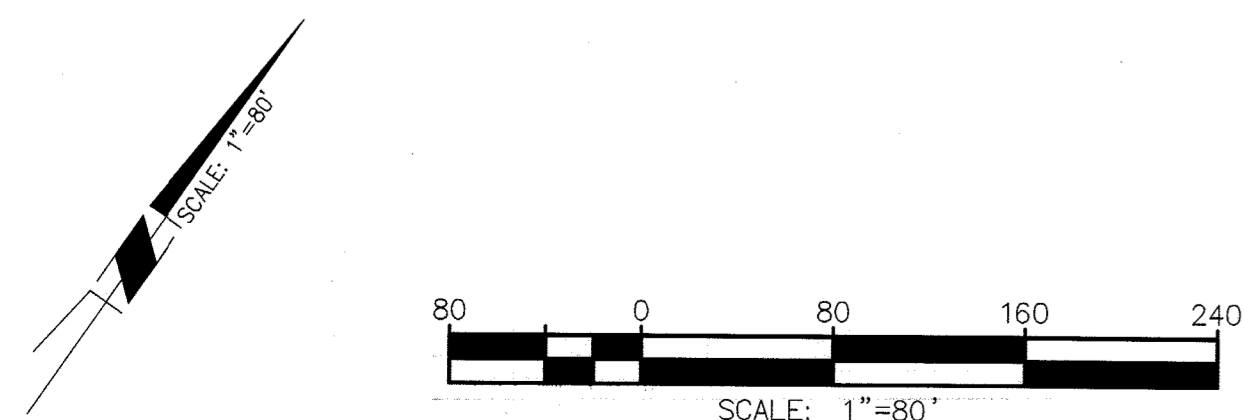

Under Ground Service Alert of Southern California  
Call: TOLL FREE 1-800-227-2600  
TWO WORKING DAYS BEFORE YOU DIG

**ENGINEER IN RESPONSIBLE CHARGE**  
GILBERT M. HERNANDEZ  
R.C.E. No. 69170 EXPIRES: 6-30-16  
DATE: 12-18-14

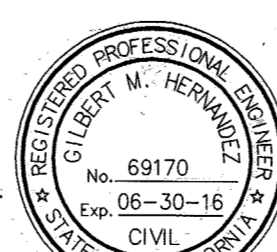

MARK	REVISIONS	APPR.	DATE

CITY OF RIVERSIDE, CALIFORNIA DEPARTMENT OF PUBLIC WORKS			
APPROVED BY	BY	DATE	APPROVED BY
ENGINEERING MANAGER	Fm	12/18/14	[Signature]
TRAFFIC DIVISION	DC	12/18/14	CITY ENGINEER
CONSTRUCTION ADMIN.			
DESIGNED BY	MKS	DRAWN BY	MKS
CHECKED BY			GMH

SIGNING AND STRIPING PLAN	
2014/2015 MINOR STREETS MAINTENANCE PHASE 1	
SCALE: 1" = 80'	

XL-730
SHEET 7 OF 13
FILE NAME: XL-730-6.DWG

G:\ADMIN\USER\TRAFFIC\XL-DWGS\XL730-6.DWG

**SIGNING AND STRIPING GENERAL NOTES:**

- SIGNING AND STRIPING INSTALLATIONS SHALL CONFORM TO THE 2012 CALIFORNIA MANUAL ON UNIFORM TRAFFIC CONTROL DEVICES (CA MUTCD), THE STATE OF CALIFORNIA DEPARTMENT OF TRANSPORTATION (CALTRANS) STANDARD PLANS AND SPECIFICATIONS DATED 2010, AND ALL ADDENDUMS THERETO, AND THE CITY OF RIVERSIDE PUBLIC WORKS DEPARTMENT STANDARD DRAWINGS, CURRENT EDITION.
- ALL STRIPING, MARKINGS, AND LEGENDS SHALL BE REFLECTORIZED THERMOPLASTIC UNLESS OTHERWISE NOTED. THE CONTRACTOR SHALL PROVIDE AND INSTALL RAISED PAVEMENT MARKERS FOR ALL STRIPING. STRIPING, MARKINGS AND LEGENDS SHALL CONFORM TO THE LATEST CALTRANS STANDARD PLANS A20A THRU A20D AND A24A THRU A24E.
- PRIOR TO FINAL ACCEPTANCE OF STREET IMPROVEMENTS, ALL PAVEMENT STRIPING AND STENCILING WITHIN THE PERIMETER OF THE CONSTRUCTION AREA SHALL BE RESTORED TO LIKE NEW CONDITION, IN A MANNER MEETING THE APPROVAL OF THE CITY OF RIVERSIDE.
- THE CONTRACTOR SHALL RE-STRIPE EXISTING STRIPING AND CURB MARKINGS OBLITERATED BY NEW CONSTRUCTION, WHETHER OR NOT SHOWN ON THE PLANS FOR REPLACEMENT, AT NO COST TO THE CITY.
- AT LOCATIONS WHERE EXISTING PAINTED CURB IS TO BE RECONSTRUCTED, THE CONTRACTOR SHALL PAINT THE NEW CURB AS SHOWN ON THE PLANS WITHIN 10 WORKING DAYS OF CURB CONSTRUCTION OR AS DIRECTED BY ENGINEER. THE PAINT SHALL BE WATER-BASED WITH 2-YEAR GUARANTEE AGAINST COLOR FADING. PRIOR TO THE START OF CONSTRUCTION, THE CONTRACTOR SHALL SUBMIT TO THE CITY WRITTEN PROOF OF THE MANUFACTURER'S 2-YEAR GUARANTEE.
- ALL NEW STRIPING SHALL BE "CAT TRACKED" AND APPROVED BY THE ENGINEER PRIOR TO FINAL INSTALLATION. THE CONTRACTOR SHALL NOTIFY THE ENGINEER AFTER COMPLETING LAYOUT AND AT LEAST 3 WORKING DAYS BEFORE COMMENCING INSTALLATION OF STRIPING, MARKINGS AND MARKERS.
- TRAFFIC SIGN FACE SHALL BE 3M DIAMOND GRADE DG3 REFLECTIVE SHEETING (ASTM XI) OR APPROVED EQUAL WITH PROTECTIVE GRAFFITI OVERLAY FILM OR AS OTHERWISE NOTED. ALL WARNING SIGNS SHALL HAVE A FLUORESCENT YELLOW BACKGROUND AND SCHOOL SIGNS NOTED SHALL HAVE A FLUORESCENT YELLOW-GREEN BACKGROUND.
- SIGNS SHALL BE STANDARD SIZE UNLESS NOTED OTHERWISE. PRIOR TO INSTALLATION, NEW SIGNS SHALL BE APPROVED BY THE CITY OF RIVERSIDE. EXACT LOCATIONS OF SIGNS SHALL BE DETERMINED BY THE CITY ENGINEER.
- ALL EXISTING SIGNS AND POSTS TO BE REMOVED SHALL BE DELIVERED TO THE CITY OF RIVERSIDE SIGN DEPARTMENT.
- WHEN PAINT IS SPECIFIED, TRAFFIC STRIPES AND MARKINGS SHALL BE APPLIED IN TWO COATS. A MINIMUM OF SEVEN DAYS SHALL BE PROVIDED BETWEEN FIRST AND SECOND COATS.
- STRIPING SHALL BE APPLIED WITHIN 48 HOURS OF SURFACE COURSE REPLACEMENT ON STREETS OPEN TO THE PUBLIC. IN NO CASE SHALL A NEWLY PAVED STREET OPEN TO THE PUBLIC BE LEFT UNSTRIPED OVER A WEEKEND OR HOLIDAY.
- CONTRACTOR SHALL INSTALL NEW SIGN(S) AND/OR POST(S) PER CITY OF RIVERSIDE STANDARD DRAWING No. 664, SEE SPECIFICATIONS. 13. CONTRACTOR SHALL INSTALL NEW STREET NAME SIGNS AND POST PER CITY OF RIVERSIDE STANDARD DRAWING No. 662, SEE SPECIFICATIONS.
- ALL CONFLICTING STRIPING, PAVEMENT MARKINGS, LEGENDS, AND RAISED PAVEMENT MARKERS SHALL BE REMOVED EVEN IF NOT SHOWN ON PLANS. REMOVALS OF PAINTED STRIPING, PAVEMENT MARKINGS AND LEGENDS SHALL BE DONE BY WET SANDBLASTING. REMOVALS OF THERMOPLASTIC STRIPING, PAVEMENT MARKINGS AND LEGENDS SHALL BE REMOVED BY WET SANDBLASTING, GRINDING OR OTHER APPROVED METHOD AND SHALL NOT DAMAGE THE PAVEMENT. "BLACK OUT" OF EXISTING DELINEATION IS NOT PERMITTED. ALL DAMAGED PAVEMENT DUE TO REMOVALS SHALL BE REPAIRED AS NECESSARY TO MAINTAIN A SMOOTH AND UNIFORM SURFACE OR AS DIRECTED BY THE ENGINEER. ALL STRIPING REMOVALS AND LEGENDS SHALL BE "FOG SEALED".
- WHERE APPLICABLE, OUTBOUND LANE LINE DETAILS SHALL COMMENCE AT THE CROSSWALK, MEANING THE PAINTED PORTION OF THE DETAIL SHALL JOIN THE CROSSWALK.

**SIGNING AND STRIPING LEGEND:**

- E EXISTING TO REMAIN.
- # INSTALL CALTRANS STRIPING DETAIL PER NUMBER NOTED, INCLUDING INSTALLATION OF RAISED PAVEMENT MARKERS.
- PM INSTALL PAVEMENT MARKING OR ARROW AS NOTED.
- RP REMOVE ALL EXISTING CONFLICTING TRAFFIC STRIPING AND MARKINGS AS NOTED, INCLUDING RAISED PAVEMENT MARKERS.
- IS FURNISH AND INSTALL ROADSIDE SIGN(S) OR SNS WITH/WITHOUT POST
- RS REMOVE SIGN(S)
- P PROPOSED SIGN (ONE POST)
- E EXISTING SIGN (ONE POST)
- S EXISTING SIGN (ON STREET LIGHT)
- S EXISTING STREET NAME SIGN
- SNS STREET NAME SIGN
- 12' PROPOSED WIDTH

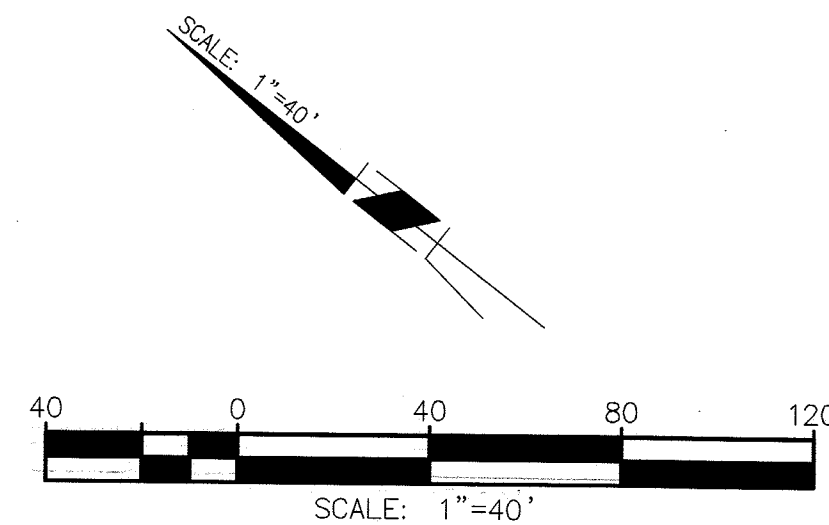

STRIPING/SIGNAGE QUANTITIES - THIS SHEET			
ITEM	DESCRIPTION	QUANTITY	UNIT
1	DETAIL 22	50	LF
2	ROADSIDE SIGN(S) 1 POST	1	EA
3	RELOCATE SIGN	1	EA
4	REMOVE SIGN	9	EA
5	STREET NAME SIGN	9	EA
6	12" SOLID WHITE	160	LF
7	PAVEMENT LEGENDS/MARKINGS	180	SF
8	REMOVE STRIPING	25	LF
9	REMOVE PAVEMENT MARKINGS	22	SF

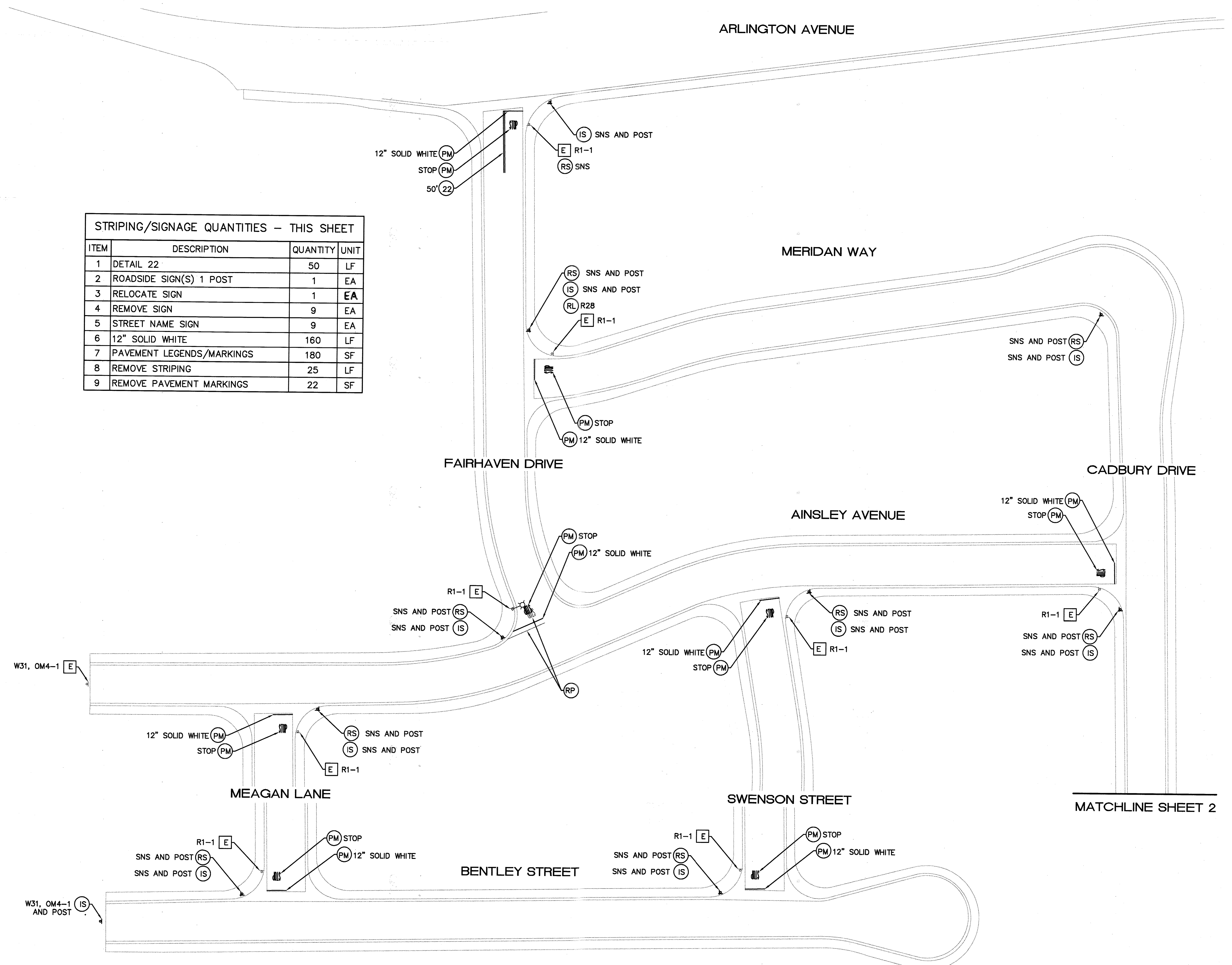

Under Ground Service Alert of Southern California  
Call: TOLL FREE 1-800 227-2600  
TWO WORKING DAYS BEFORE YOU DIG

**ENGINEER IN RESPONSIBLE CHARGE**  
GILBERT M. HERNANDEZ  
R.C.E. No. 69170 EXPIRES: 6-30-16  
DATE: 12-10-14

MARK	REVISIONS	APPR.	DATE

CITY OF RIVERSIDE, CALIFORNIA  
DEPARTMENT OF PUBLIC WORKS

APPROVED BY	BY	DATE	APPROVED BY
ENGINEERING MANAGER	FM	12/18/14	<i>[Signature]</i>
TRAFFIC DIVISION	DC	12/18/14	CITY ENGINEER
CONSTRUCTION ADMIN.			

DESIGNED BY: MAC DRAWN BY: MAC CHECKED BY: GMH

**SIGNING AND STRIPING PLAN**  
2014/2015 MINOR STREETS MAINTENANCE PHASE 1  
SCALE: 1" = 40'

XL-730  
SHEET 8 OF 13  
FILE NAME: XL730-7.DWG

G:\ADMIN\USER\TRAFFIC\XL-DWGS\XL730-7.DWG



ARLINGTON AVENUE

MATCHLINE SHEET 1

MATCHLINE SHEET 3

MATCHLINE SHEET 1  
CADBURY DRIVE

COOLWATER DRIVE

YUCCA DRIVE

BUFFALO DRIVE

PLATTE DRIVE

SPRINGFIELD STREET

12" SOLID WHITE (PM)  
STOP (PM)  
50' (22)  
RS SNS AND POST  
IS SNS AND POST  
E R1-1

R1-1 (E)  
PM 12" SOLID WHITE  
PM STOP (22)

PM SEE SPEED HUMP DETAIL IN THE SPECIAL PROVISIONS

PM SEE SPEED HUMP DETAIL IN THE SPECIAL PROVISIONS  
E WB-1(MOD)

12" SOLID WHITE (PM)  
STOP (PM)  
IS SNS AND POST  
RS SNS AND POST  
E R1-1

12" SOLID WHITE (PM)  
STOP (PM)  
IS SNS AND POST  
E R1-1  
RS SNS

12" SOLID WHITE (PM)  
STOP (PM)  
IS SNS AND POST  
RS SNS AND POST  
E R1-1

SNS AND POST (RS)  
SNS AND POST (IS)  
R1-1 (E)  
PM STOP  
PM 12" SOLID WHITE

SNS AND POST (IS)  
SNS AND POST (RS)  
(22)

(22)  
RP 240'  
RS SNS AND POST  
IS SNS AND POST

YEARLING STREET

STRIPING/SIGNAGE QUANTITIES - THIS SHEET

ITEM	DESCRIPTION	QUANTITY	UNIT
1	DETAIL 22	1440	LF
2	REMOVE SIGN	7	EA
3	STREET NAME SIGN	7	EA
4	12" SOLID WHITE	120	LF
5	PAVEMENT LEGENDS/MARKINGS	132	SF
6	REMOVE STRIPING	240	LF
7	MARKINGS AND RPM'S FOR SPEED HUMP DETAIL	2	EA

SIGNING AND STRIPING LEGEND:

- (E) EXISTING TO REMAIN.
- (#) INSTALL CALTRANS STRIPING DETAIL PER NUMBER NOTED, INCLUDING INSTALLATION OF RAISED PAVEMENT MARKERS.
- (PM) INSTALL PAVEMENT MARKING OR ARROW AS NOTED.
- (RP) REMOVE ALL EXISTING CONFLICTING TRAFFIC STRIPING AND MARKINGS AS NOTED, INCLUDING RAISED PAVEMENT MARKERS.
- (IS) FURNISH AND INSTALL ROADSIDE SIGN(S) OR SNS WITH/WITHOUT POST
- (RS) REMOVE SIGN(S)
- PROPOSED SIGN (ONE POST)
- EXISTING SIGN (ONE POST)
- EXISTING SIGN (ON STREET LIGHT)
- SNS EXISTING STREET NAME SIGN
- 12' STREET NAME SIGN
- PROPOSED WIDTH

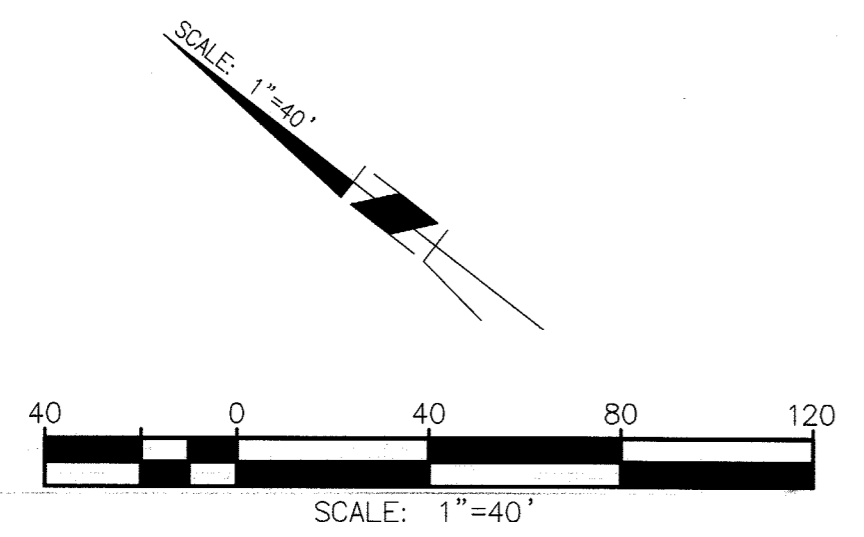

Under Ground Service Alert of Southern California  
Call: TOLL FREE 1-800-227-2600  
TWO WORKING DAYS BEFORE YOU DIG

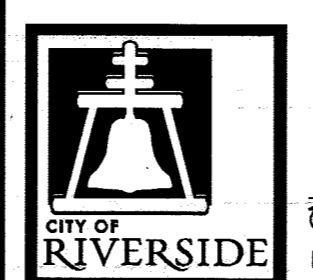

ENGINEER IN RESPONSIBLE CHARGE  
GILBERT M. HERNANDEZ  
R.C.E. No. 69170 EXPIRES: 6-30-16  
DATE: 12-10-14

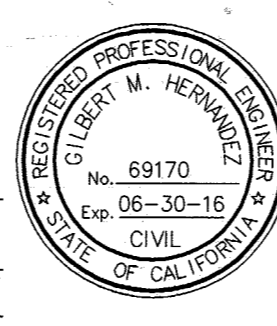

MARK	REVISIONS	APPR.	DATE

CITY OF RIVERSIDE, CALIFORNIA  
DEPARTMENT OF PUBLIC WORKS

APPROVED BY	BY	DATE	APPROVED BY
ENGINEERING MANAGER	Fm	12/18/14	[Signature]
TRAFFIC DIVISION			CITY ENGINEER
CONSTRUCTION ADMIN.	DC	12/18/14	
DESIGNED BY	MAC	DRAWN BY	MAC
CHECKED BY	GMH	DATE	12/9/2014

SIGNING AND STRIPING PLAN  
2014/2015 MINOR STREETS MAINTENANCE PHASE 1  
SCALE: 1" = 40'

XL-730  
SHEET 9 OF 13  
FILE NAME: XL730-7.DWG

C:\ADMIN\USER\TRAFFIC\XL-DWGS\XL730-7.DWG

MATCHLINE SHEET 2

ARLINGTON AVENUE

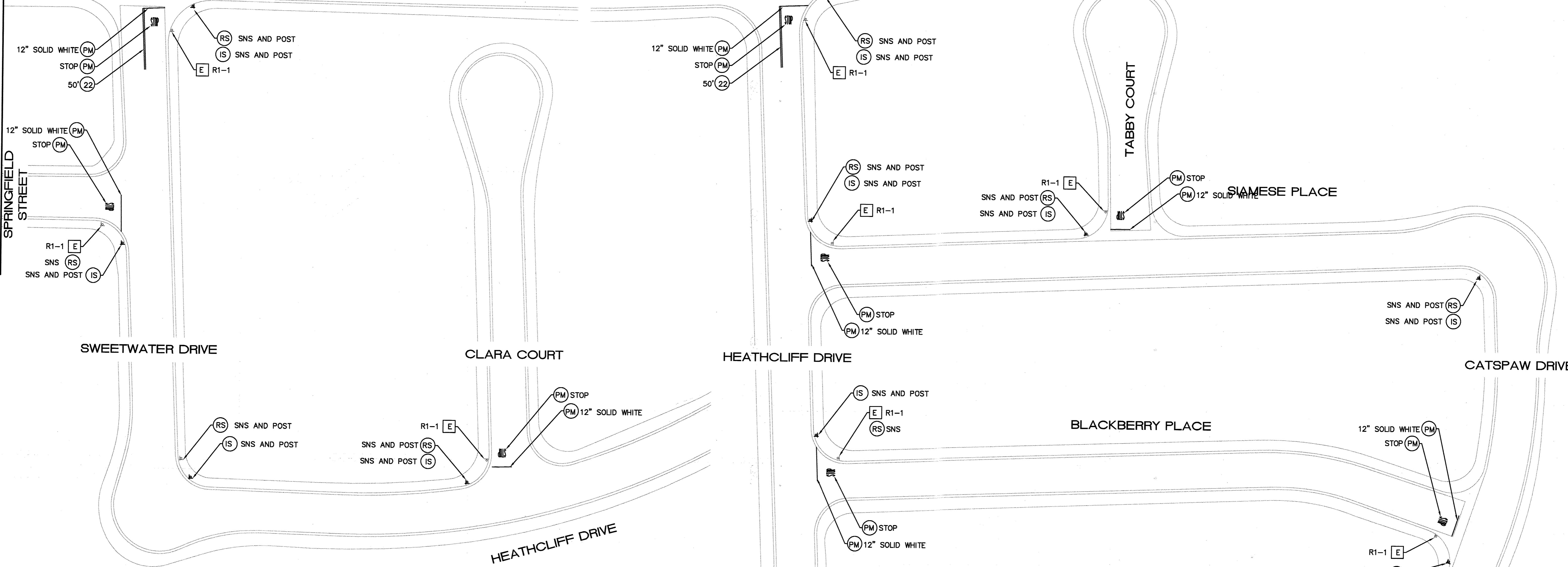

STRIPING/SIGNAGE QUANTITIES - THIS SHEET

ITEM	DESCRIPTION	QUANTITY	UNIT
1	DETAIL 22	100	LF
2	REMOVE SIGN	10	EA
3	RELOCATE SIGN	1	EA
4	STREET NAME SIGN	10	EA
5	12" SOLID WHITE	160	LF
6	PAVEMENT LEGENDS/MARKINGS	180	SF

**SIGNING AND STRIPING LEGEND:**

- E EXISTING TO REMAIN.
- # INSTALL CALTRANS STRIPING DETAIL PER NUMBER NOTED, INCLUDING INSTALLATION OF RAISED PAVEMENT MARKERS.
- PM INSTALL PAVEMENT MARKING OR ARROW AS NOTED.
- RP REMOVE ALL EXISTING CONFLICTING TRAFFIC STRIPING AND MARKINGS AS NOTED, INCLUDING RAISED PAVEMENT MARKERS.
- IS FURNISH AND INSTALL ROADSIDE SIGN(S) OR SNS WITH/WITHOUT POST
- RS REMOVE SIGN(S)
- P PROPOSED SIGN (ONE POST)
- P EXISTING SIGN (ONE POST)
- P EXISTING SIGN (ON STREET LIGHT)
- S EXISTING STREET NAME SIGN
- S STREET NAME SIGN
- 12' PROPOSED WIDTH

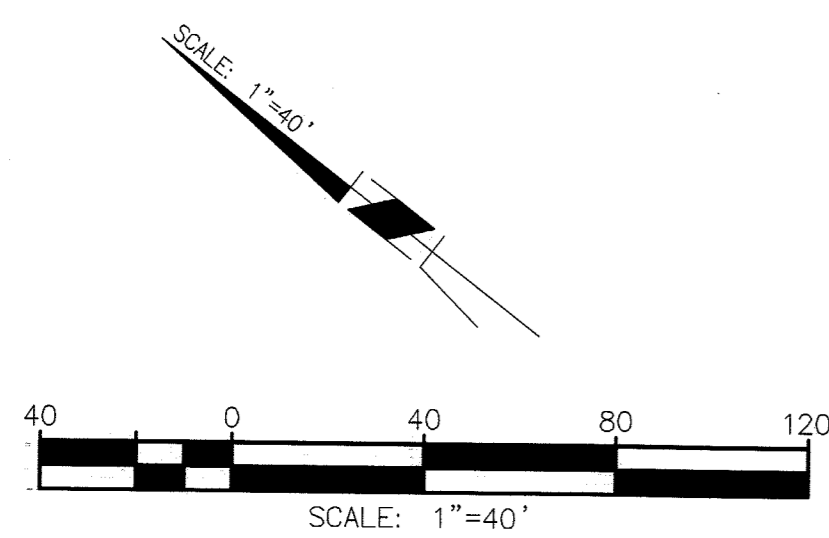

Under Ground Service Alert of Southern California  
 Call: TOLL FREE 1-800-227-2600  
 TWO WORKING DAYS BEFORE YOU DIG

**ENGINEER IN RESPONSIBLE CHARGE**  
 GILBERT M. HERNANDEZ  
 R.C.E. No. 69170 EXPIRES: 6-30-16  
 DATE: 12-10-14

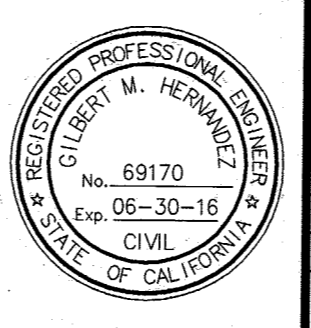

MARK	REVISIONS	APPR.	DATE

CITY OF RIVERSIDE, CALIFORNIA  
 DEPARTMENT OF PUBLIC WORKS

APPROVED BY	BY	DATE	APPROVED BY
ENGINEERING MANAGER	PM	12/18/14	<i>[Signature]</i>
TRAFFIC DIVISION	DC	12/18/14	CITY ENGINEER
CONSTRUCTION ADMIN.			DATE: 12/18/14

**SIGNING AND STRIPING PLAN**  
 2014/2015 MINOR STREETS  
 MAINTENANCE PHASE 1  
 SCALE: 1" = 40'

XL-730  
 SHEET 10 OF 13  
 FILE NAME: XL730-7.DWG

G:\ADMIN\USER\TRAFFIC\XL-DWGS\XL730-7

**SIGNING AND STRIPING GENERAL NOTES:**

- SIGNING AND STRIPING INSTALLATIONS SHALL CONFORM TO THE 2014 CALIFORNIA MANUAL ON UNIFORM TRAFFIC CONTROL DEVICES (CA MUTCD), THE STATE OF CALIFORNIA DEPARTMENT OF TRANSPORTATION (CALTRANS) STANDARD PLANS AND SPECIFICATIONS DATED 2010, AND ALL ADDENDUMS THERETO, AND THE CITY OF RIVERSIDE PUBLIC WORKS DEPARTMENT STANDARD DRAWINGS, CURRENT EDITION.
- ALL STRIPING, MARKINGS, AND LEGENDS SHALL BE REFLECTORIZED THERMOPLASTIC UNLESS OTHERWISE NOTED. THE CONTRACTOR SHALL PROVIDE AND INSTALL RAISED PAVEMENT MARKERS FOR ALL STRIPING. STRIPING, MARKINGS AND LEGENDS SHALL CONFORM TO THE LATEST CALTRANS STANDARD PLANS A20A THRU A20D AND A24A THRU A24E.
- PRIOR TO FINAL ACCEPTANCE OF STREET IMPROVEMENTS, ALL PAVEMENT STRIPING AND STENCILING WITHIN THE PERIMETER OF THE CONSTRUCTION AREA SHALL BE RESTORED TO LIKE NEW CONDITION, IN A MANNER MEETING THE APPROVAL OF THE CITY OF RIVERSIDE.
- THE CONTRACTOR SHALL RE-STRIPE EXISTING STRIPING AND CURB MARKINGS OBLITERATED BY NEW CONSTRUCTION, WHETHER OR NOT SHOWN ON THE PLANS FOR REPLACEMENT, AT NO COST TO THE CITY.
- AT LOCATIONS WHERE EXISTING PAINTED CURB IS TO BE RECONSTRUCTED, THE CONTRACTOR SHALL PAINT THE NEW CURB AS SHOWN ON THE PLANS WITHIN 10 WORKING DAYS OF CURB CONSTRUCTION OR AS DIRECTED BY ENGINEER. THE PAINT SHALL BE WATER-BASED WITH 2-YEAR GUARANTEE AGAINST COLOR FADING. PRIOR TO THE START OF CONSTRUCTION, THE CONTRACTOR SHALL SUBMIT TO THE CITY WRITTEN PROOF OF THE MANUFACTURER'S 2-YEAR GUARANTEE.
- ALL NEW STRIPING SHALL BE "CAT TRACKED" AND APPROVED BY THE ENGINEER PRIOR TO FINAL INSTALLATION. THE CONTRACTOR SHALL NOTIFY THE ENGINEER AFTER COMPLETING LAYOUT AND AT LEAST 3 WORKING DAYS BEFORE COMMENCING INSTALLATION OF STRIPING, MARKINGS AND MARKERS.
- TRAFFIC SIGN FACE SHALL BE 3M DIAMOND GRADE DG3 REFLECTIVE SHEETING (ASTM XI) OR APPROVED EQUAL WITH PROTECTIVE GRAFFITI OVERLAY FILM OR AS OTHERWISE NOTED. ALL WARNING SIGNS SHALL HAVE A FLUORESCENT YELLOW BACKGROUND AND SCHOOL SIGNS NOTED SHALL HAVE A FLUORESCENT YELLOW-GREEN BACKGROUND.
- SIGNS SHALL BE STANDARD SIZE UNLESS NOTED OTHERWISE. PRIOR TO INSTALLATION, NEW SIGNS SHALL BE APPROVED BY THE CITY OF RIVERSIDE. EXACT LOCATIONS OF SIGNS SHALL BE DETERMINED BY THE CITY ENGINEER.
- ALL EXISTING SIGNS AND POSTS TO BE REMOVED SHALL BE DELIVERED TO THE CITY OF RIVERSIDE SIGN DEPARTMENT.
- STRIPING SHALL BE APPLIED WITHIN 48 HOURS OF SURFACE COURSE REPLACEMENT ON STREETS OPEN TO THE PUBLIC. IN NO CASE SHALL A NEWLY PAVED STREET OPEN TO THE PUBLIC BE LEFT UNSTRIPED OVER A WEEKEND OR HOLIDAY.
- CONTRACTOR SHALL INSTALL NEW SIGN(S) AND/OR POST(S) PER CITY OF RIVERSIDE STANDARD DRAWING No. 664, SEE SPECIFICATIONS. 13. CONTRACTOR SHALL INSTALL NEW STREET NAME SIGNS AND POST PER CITY OF RIVERSIDE STANDARD DRAWING No. 662, SEE SPECIFICATIONS.
- ALL CONFLICTING STRIPING, PAVEMENT MARKINGS, LEGENDS, AND RAISED PAVEMENT MARKERS SHALL BE REMOVED EVEN IF NOT SHOWN ON PLANS. REMOVALS OF PAINTED STRIPING, PAVEMENT MARKINGS AND LEGENDS SHALL BE DONE BY WET SANDBLASTING. REMOVALS OF THERMOPLASTIC STRIPING, PAVEMENT MARKINGS AND LEGENDS SHALL NOT BE REMOVED BY WET SANDBLASTING, GRINDING OR OTHER APPROVED METHOD AND SHALL NOT DAMAGE THE PAVEMENT. "BLACK OUT" OF EXISTING DELINEATION IS NOT PERMITTED. ALL DAMAGED PAVEMENT DUE TO REMOVALS SHALL BE REPAIRED AS NECESSARY TO MAINTAIN A SMOOTH AND UNIFORM SURFACE OR AS DIRECTED BY THE ENGINEER. ALL STRIPING REMOVALS AND LEGENDS SHALL BE "FOG SEALED".
- WHERE APPLICABLE, OUTBOUND LANE LINE DETAILS SHALL COMMENCE AT THE CROSSWALK, MEANING THE PAINTED PORTION OF THE DETAIL SHALL JOIN THE CROSSWALK.

**SIGNING AND STRIPING LEGEND AND CONSTRUCTION NOTES:**

- E EXISTING TO REMAIN.
- SC SPLICE TO EXISTING.
- 1 INSTALL LOOP DETECTOR TYPE "E" PER LOOP DETECTOR LAYOUT
- # INSTALL CALTRANS STRIPING DETAIL PER NUMBER NOTED, INCLUDING INSTALLATION OF RAISED PAVEMENT MARKERS.
- PM INSTALL PAVEMENT MARKING OR ARROW AS NOTED.
- RP REMOVE ALL EXISTING CONFLICTING TRAFFIC STRIPING AND MARKINGS AS NOTED, INCLUDING RAISED PAVEMENT MARKERS.
- IS FURNISH AND INSTALL ROADSIDE SIGN(S) OR SNS WITH/WITHOUT POST
- RS REMOVE SIGN(S)
- RL RELOCATE EXISTING SIGN(S) TO EXISTING POST OR INSTALL POST (IF APPLICABLE)
- PROPOSED SIGN (ONE POST)
- ◻ EXISTING STREET NAME SIGN
- SNS STREET NAME SIGN

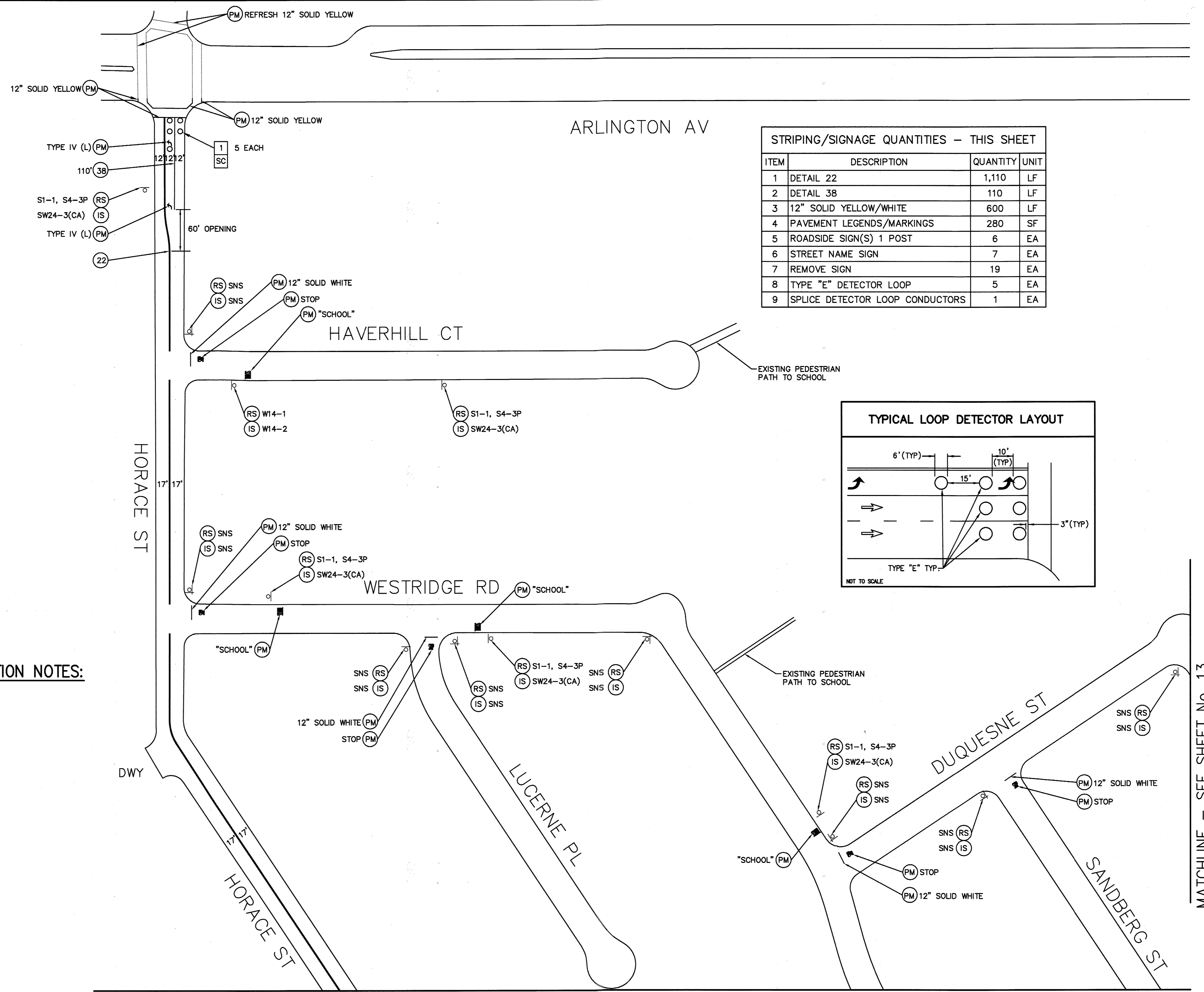
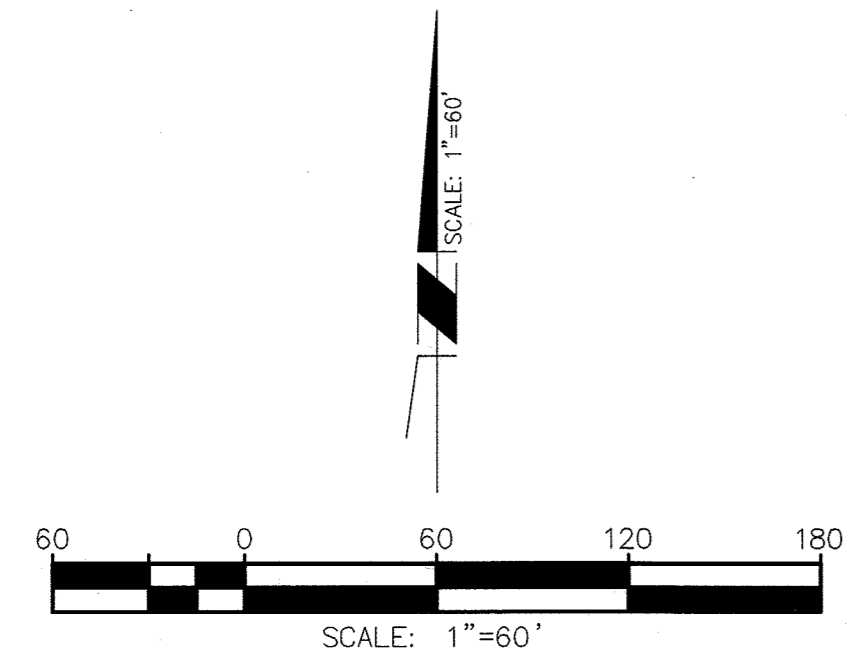

STRIPING/SIGNAGE QUANTITIES - THIS SHEET		
ITEM	DESCRIPTION	QUANTITY UNIT
1	DETAIL 22	1,110 LF
2	DETAIL 38	110 LF
3	12" SOLID YELLOW/WHITE	600 LF
4	PAVEMENT LEGENDS/MARKINGS	280 SF
5	ROADSIDE SIGN(S) 1 POST	6 EA
6	STREET NAME SIGN	7 EA
7	REMOVE SIGN	19 EA
8	TYPE "E" DETECTOR LOOP	5 EA
9	SPLICE DETECTOR LOOP CONDUCTORS	1 EA

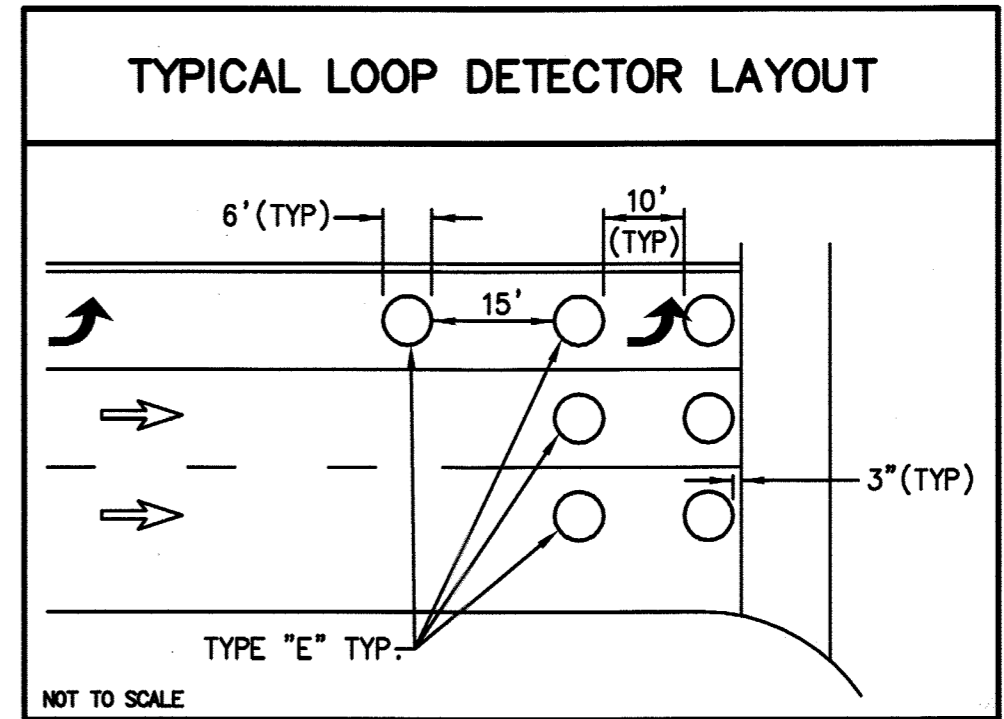

MATCHLINE - SEE SHEET No. 13

MATCHLINE - SEE SHEET No. 12

<p>Under Ground Service Alert of Southern California Call: TOLL FREE 1-800-227-2600 TWO WORKING DAYS BEFORE YOU DIG</p>	<p><b>ENGINEER IN RESPONSIBLE CHARGE</b> GILBERT M. HERNANDEZ R.C.E. No. 69170 EXPIRES: 6-30-16 DATE: 12-18-14</p>	<p><b>CITY OF RIVERSIDE, CALIFORNIA</b> <b>DEPARTMENT OF PUBLIC WORKS</b></p>		<p><b>SIGNING AND STRIPING PLAN</b></p>	<p><b>XL-730</b></p> <p>SHEET 11 OF 13</p> <p>FILE NAME: XL-730-3.DWG</p>
		<p>APPROVED BY: <i>Em</i> DATE: 12/18/14 ENGINEERING MANAGER</p> <p>APPROVED BY: <i>[Signature]</i> DATE: 12/19/2014 CITY ENGINEER</p>		<p>2014/2015 MINOR STREETS MAINTENANCE PHASE 1</p> <p>SCALE: 1" = 60'</p>	
<p>DESIGNED BY: MKS DRAWN BY: MKS CHECKED BY: GMH</p>		<p>TRAFFIC DIVISION: DC CONSTRUCTION ADMIN. DATE: 12/18/14</p>			

**SIGNING AND STRIPING LEGEND AND CONSTRUCTION NOTES:**

- E EXISTING TO REMAIN.
- # INSTALL CALTRANS STRIPING DETAIL PER NUMBER NOTED, INCLUDING INSTALLATION OF RAISED PAVEMENT MARKERS.
- PM INSTALL PAVEMENT MARKING OR ARROW AS NOTED.
- RP REMOVE ALL EXISTING CONFLICTING TRAFFIC STRIPING AND MARKINGS AS NOTED, INCLUDING RAISED PAVEMENT MARKERS.
- IS FURNISH AND INSTALL ROADSIDE SIGN(S) OR SNS WITH/WITHOUT POST
- RS REMOVE SIGN(S)
- RL RELOCATE EXISTING SIGN(S) TO EXISTING POST OR INSTALL POST (IF APPLICABLE)
- o PROPOSED SIGN (ONE POST)
- d EXISTING STREET NAME SIGN
- o EXISTING STREET NAME SIGN (ON STREET LIGHT)
- SNS STREET NAME SIGN

STRIPING/SIGNAGE QUANTITIES - THIS SHEET			
ITEM	DESCRIPTION	QUANTITY	UNIT
1	DETAIL 22	1,775	LF
2	12" SOLID YELLOW/WHITE	150	LF
3	PAVEMENT LEGENDS/MARKINGS	250	SF
4	ROADSIDE SIGN(S) 1 POST	6	EA
5	ROADSIDE SIGN(S) NO POST	1	EA
6	STREET NAME SIGN	8	EA
7	REMOVE SIGN	15	EA

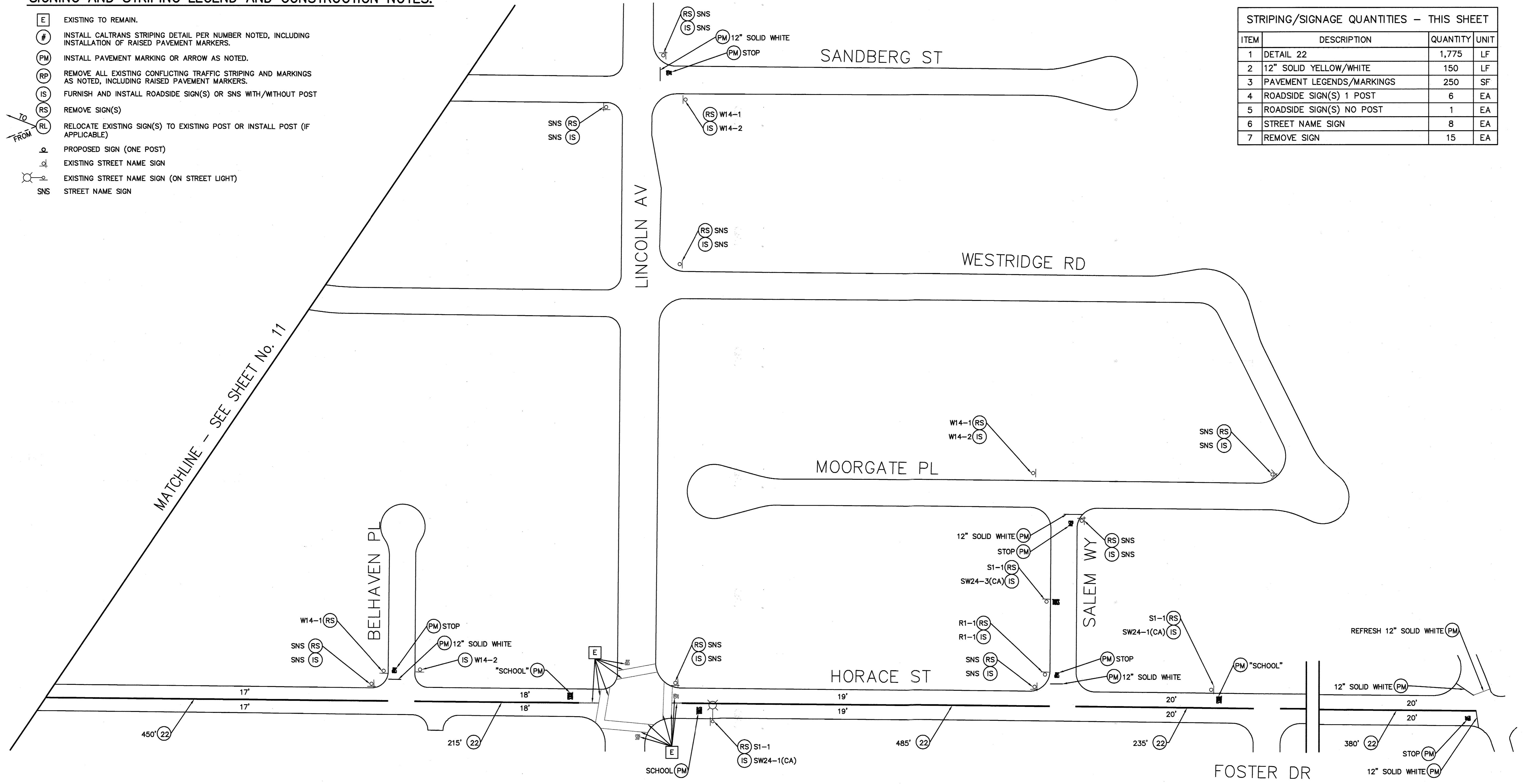

MATCHLINE - SEE SHEET No. 11

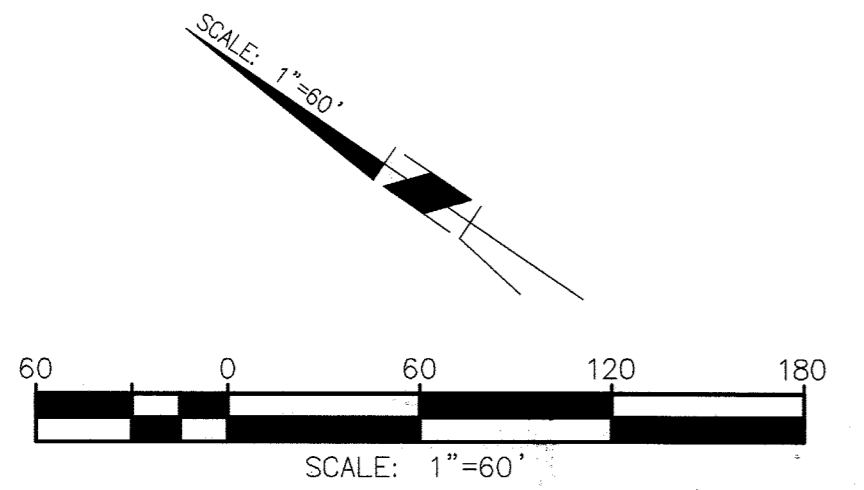

Under Ground Service Alert of Southern California  
 Call: TOLL FREE 1-800-227-2600  
**TWO WORKING DAYS BEFORE YOU DIG**

**ENGINEER IN RESPONSIBLE CHARGE**  
 GILBERT M. HERNANDEZ  
 R.C.E. No. 69170 EXPIRES: 6-30-16  
 DATE: 12-18-14



MARK	REVISIONS	APPR.	DATE

**CITY OF RIVERSIDE, CALIFORNIA DEPARTMENT OF PUBLIC WORKS**

APPROVED BY	BY	DATE	APPROVED BY
ENGINEERING MANAGER	Fm	12/18/14	CITY ENGINEER
TRAFFIC DIVISION	DC	12/18/14	DATE: 12/19/2014
CONSTRUCTION ADMIN.			

**SIGNING AND STRIPING PLAN**  
 2014/2015 MINOR STREETS MAINTENANCE PHASE 1  
 SCALE: 1" = 60'

**XL-730**  
 SHEET 12 OF 13  
 FILE NAME: XL-730-3.DWG

C:\ADMIN\COMMON\TRAFFIC\PROJECTS\2014\GIL\MISC STREET REHABS\PHASE 1\TSANG\EXHIBITS\WARD 3\XL730-3.DWG

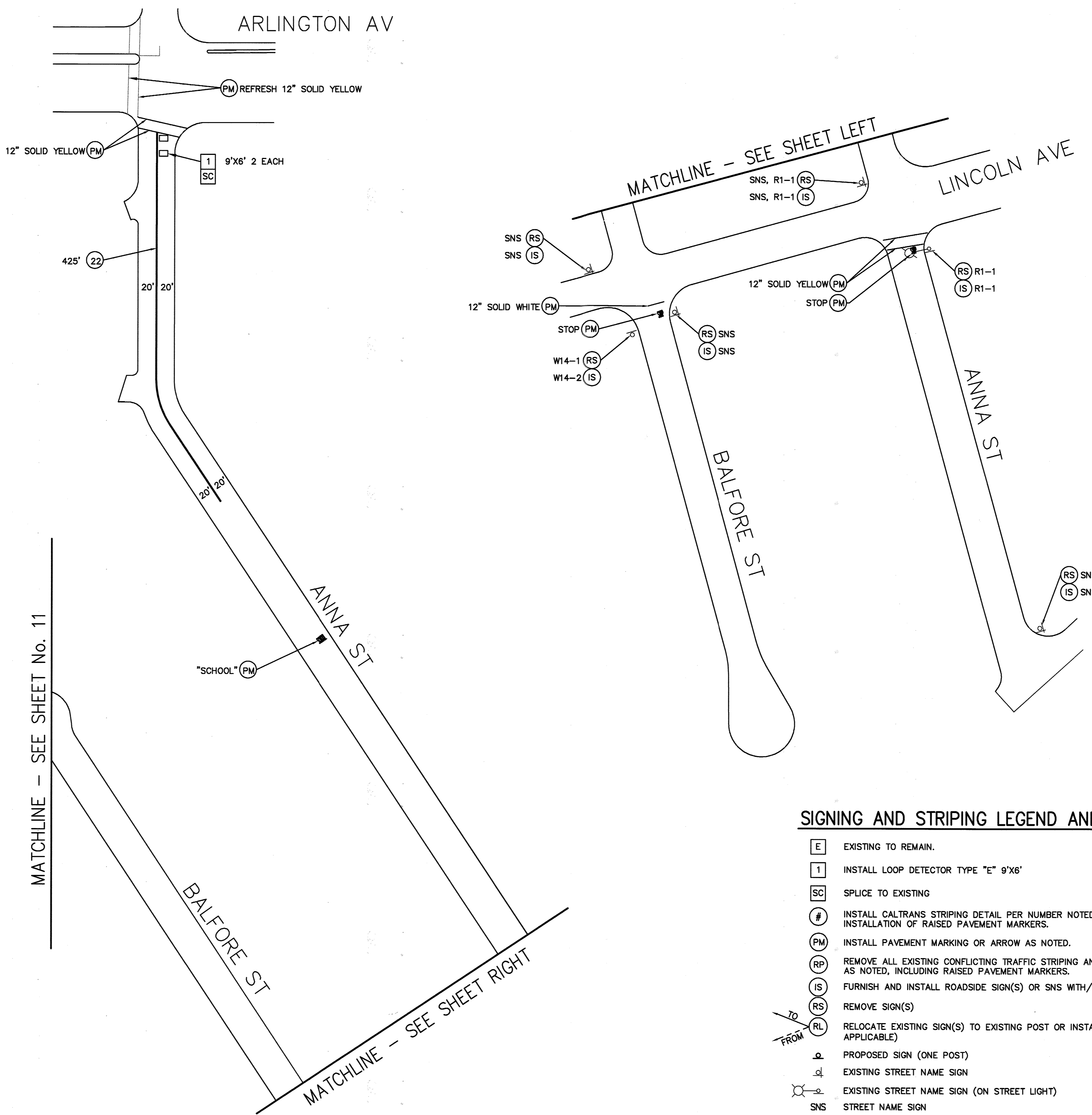

STRIPING/SIGNAGE QUANTITIES - THIS SHEET

ITEM	DESCRIPTION	QUANTITY	UNIT
1	DETAIL 22	425	LF
2	12" SOLID YELLOW/WHITE	315	LF
3	PAVEMENT LEGENDS/MARKINGS	79	SF
4	ROADSIDE SIGN(S) 1 POST	2	EA
5	ROADSIDE SIGN(S) NO POST	1	EA
6	STREET NAME SIGN	4	EA
7	REMOVE SIGN	7	EA
8	9'X6' DETECTOR LOOP	2	EA
9	SPLICE DETECTOR LOOP CONDUCTORS	1	EA

**SIGNING AND STRIPING LEGEND AND CONSTRUCTION NOTES:**

- E EXISTING TO REMAIN.
- 1 INSTALL LOOP DETECTOR TYPE "E" 9'X6'
- SC SPLICE TO EXISTING
- # INSTALL CALTRANS STRIPING DETAIL PER NUMBER NOTED, INCLUDING INSTALLATION OF RAISED PAVEMENT MARKERS.
- PM INSTALL PAVEMENT MARKING OR ARROW AS NOTED.
- RP REMOVE ALL EXISTING CONFLICTING TRAFFIC STRIPING AND MARKINGS AS NOTED, INCLUDING RAISED PAVEMENT MARKERS.
- IS FURNISH AND INSTALL ROADSIDE SIGN(S) OR SNS WITH/WITHOUT POST
- RS REMOVE SIGN(S)
- RL RELOCATE EXISTING SIGN(S) TO EXISTING POST OR INSTALL POST (IF APPLICABLE)
- P PROPOSED SIGN (ONE POST)
- S EXISTING STREET NAME SIGN
- S EXISTING STREET NAME SIGN (ON STREET LIGHT)
- SNS STREET NAME SIGN

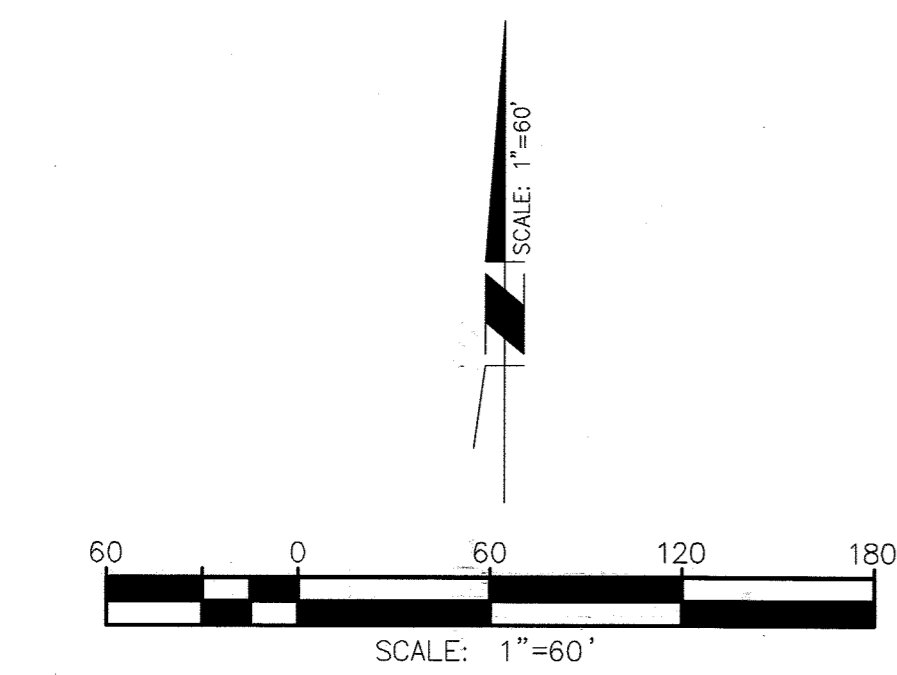

Under Ground Service Alert of Southern California  
 Call: TOLL FREE 1-800-227-2600  
**TWO WORKING DAYS BEFORE YOU DIG**

**ENGINEER IN RESPONSIBLE CHARGE**  
 GILBERT M. HERNANDEZ  
 R.C.E. No. 69170 EXPIRES: 6-30-16  
 DATE: 12-18-14



MARK	REVISIONS	APPR.	DATE

**CITY OF RIVERSIDE, CALIFORNIA DEPARTMENT OF PUBLIC WORKS**

APPROVED BY	BY	DATE	APPROVED BY	DATE
ENGINEERING MANAGER	EM	12/18/14	CITY ENGINEER	12/19/2014
TRAFFIC DIVISION				
CONSTRUCTION ADMIN.	DC	12/18/14		

**SIGNING AND STRIPING PLAN**  
 2014/2015 MINOR STREETS MAINTENANCE PHASE 1  
 SCALE: 1" = 60'

**XL-730**  
 SHEET 13 OF 13  
 FILE NAME: XL-730-3.DWG