

SIGNING AND STRIPING GENERAL NOTES:

- SIGNING AND STRIPING INSTALLATIONS SHALL CONFORM TO THE 2014 CALIFORNIA MANUAL ON UNIFORM TRAFFIC CONTROL DEVICES (CA MUTCD), THE STATE OF CALIFORNIA DEPARTMENT OF TRANSPORTATION (CALTRANS) STANDARD PLANS AND SPECIFICATIONS DATED 2018, AND ALL ADDENDUMS THERETO, AND THE CITY OF RIVERSIDE PUBLIC WORKS DEPARTMENT STANDARD DRAWINGS, CURRENT EDITION.
- ALL STRIPING, MARKINGS, AND LEGENDS SHALL BE REFLECTORIZED THERMOPLASTIC UNLESS OTHERWISE NOTED. THE CONTRACTOR SHALL PROVIDE AND INSTALL RAISED PAVEMENT MARKERS FOR ALL STRIPING. STRIPING, MARKINGS AND LEGENDS SHALL CONFORM TO THE LATEST CALTRANS STANDARD PLANS A20A THRU A20D AND A24A THRU A24E.
- PRIOR TO FINAL ACCEPTANCE OF STREET IMPROVEMENTS, ALL PAVEMENT STRIPING AND STENCILING WITHIN THE PERIMETER OF THE CONSTRUCTION AREA SHALL BE RESTORED TO LIKE NEW CONDITION, IN A MANNER MEETING THE APPROVAL OF THE CITY OF RIVERSIDE.
- THE CONTRACTOR SHALL RE-STRIP EXISTING STRIPING AND CURB MARKINGS OBLITERATED BY NEW CONSTRUCTION, WHETHER OR NOT SHOWN ON THE PLANS FOR REPLACEMENT, AT NO COST TO THE CITY.
- AT LOCATIONS WHERE EXISTING PAINTED CURB IS TO BE RECONSTRUCTED, THE CONTRACTOR SHALL PAINT THE NEW CURB AS SHOWN ON THE PLANS WITHIN 10 WORKING DAYS OF CURB CONSTRUCTION OR AS DIRECTED BY ENGINEER. THE PAINT SHALL BE WATER-BASED WITH 2-YEAR GUARANTEE AGAINST COLOR FADING. PRIOR TO THE START OF CONSTRUCTION, THE CONTRACTOR SHALL SUBMIT TO THE CITY WRITTEN PROOF OF THE MANUFACTURER'S 2-YEAR GUARANTEE.
- ALL NEW STRIPING SHALL BE "CAT TRACKED" AND APPROVED BY THE ENGINEER PRIOR TO FINAL INSTALLATION. THE CONTRACTOR SHALL NOTIFY THE ENGINEER AFTER COMPLETING LAYOUT AND AT LEAST 3 WORKING DAYS BEFORE COMMENCING INSTALLATION OF STRIPING, MARKINGS AND MARKERS.
- TRAFFIC SIGN FACE SHALL BE 3M DIAMOND GRADE D63 REFLECTIVE SHEETING (ASTM XI) OR APPROVED EQUAL WITH PROTECTIVE GRAFTITI OVERLAY FILM OR AS OTHERWISE NOTED. ALL WARNING SIGNS SHALL HAVE A FLUORESCENT YELLOW BACKGROUND AND SCHOOL SIGNS NOTED SHALL HAVE A FLUORESCENT YELLOW-GREEN BACKGROUND.
- SIGNS SHALL BE STANDARD SIZE UNLESS NOTED OTHERWISE. PRIOR TO INSTALLATION, NEW SIGNS SHALL BE APPROVED BY THE CITY OF RIVERSIDE. EXACT LOCATIONS OF SIGNS SHALL BE DETERMINED BY THE CITY ENGINEER.
- ALL EXISTING SIGNS AND POSTS TO BE REMOVED SHALL BE DELIVERED TO THE CITY OF RIVERSIDE SIGN DEPARTMENT.
- WHEN PAINT IS SPECIFIED, TRAFFIC STRIPES AND MARKINGS SHALL BE APPLIED IN TWO COATS. A MINIMUM OF SEVEN DAYS SHALL BE PROVIDED BETWEEN FIRST AND SECOND COATS.
- STRIPING SHALL BE APPLIED WITHIN 48 HOURS OF SURFACE COURSE REPLACEMENT ON STREETS OPEN TO THE PUBLIC. IN NO CASE SHALL A NEWLY PAVED STREET OPEN TO THE PUBLIC BE LEFT UNSTRIPED OVER A WEEKEND OR HOLIDAY.
- CONTRACTOR SHALL INSTALL NEW SIGN(S) AND/OR POST(S) PER CITY OF RIVERSIDE STANDARD DRAWING No. 664, SEE SPECIFICATIONS. CONTRACTOR SHALL INSTALL NEW STREET NAME SIGNS AND POST PER CITY OF RIVERSIDE STANDARD DRAWING No. 662, SEE SPECIFICATIONS.
- ALL CONFLICTING STRIPING, PAVEMENT MARKINGS, LEGENDS, AND RAISED PAVEMENT MARKERS SHALL BE REMOVED EVEN IF NOT SHOWN ON PLANS. REMOVALS OF PAINTED STRIPING, PAVEMENT MARKINGS AND LEGENDS SHALL BE DONE BY WET SANDBLASTING. REMOVALS OF THERMOPLASTIC STRIPING, PAVEMENT MARKINGS AND LEGENDS SHALL BE REMOVED BY WET SANDBLASTING, GRINDING OR OTHER APPROVED METHOD AND SHALL NOT DAMAGE THE PAVEMENT. "BLACK OUT" OF EXISTING DELINEATION IS NOT PERMITTED. ALL DAMAGED PAVEMENT DUE TO REMOVALS SHALL BE REPAIRED AS NECESSARY TO MAINTAIN A SMOOTH AND UNIFORM SURFACE OR AS DIRECTED BY THE ENGINEER. ALL STRIPING REMOVALS AND LEGENDS SHALL BE "FOG SEALED".
- WHERE APPLICABLE, OUTBOUND LANE LINE DETAILS SHALL COMMENCE AT THE CROSSWALK, MEANING THE PAINTED PORTION OF THE DETAIL SHALL JOIN THE CROSSWALK.

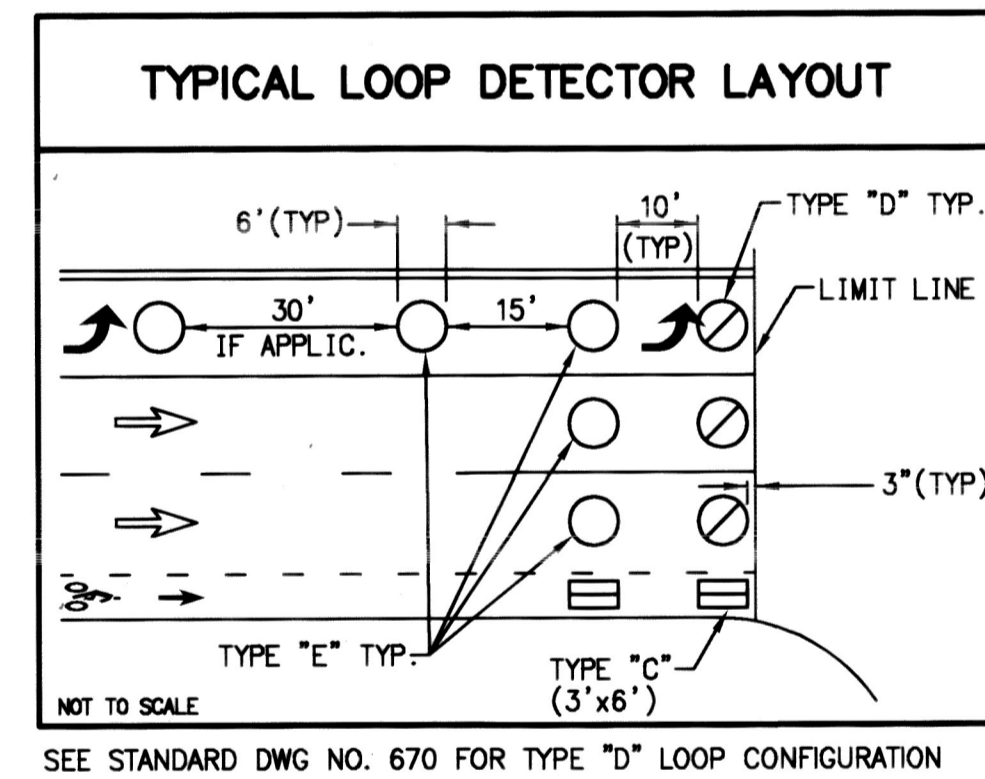
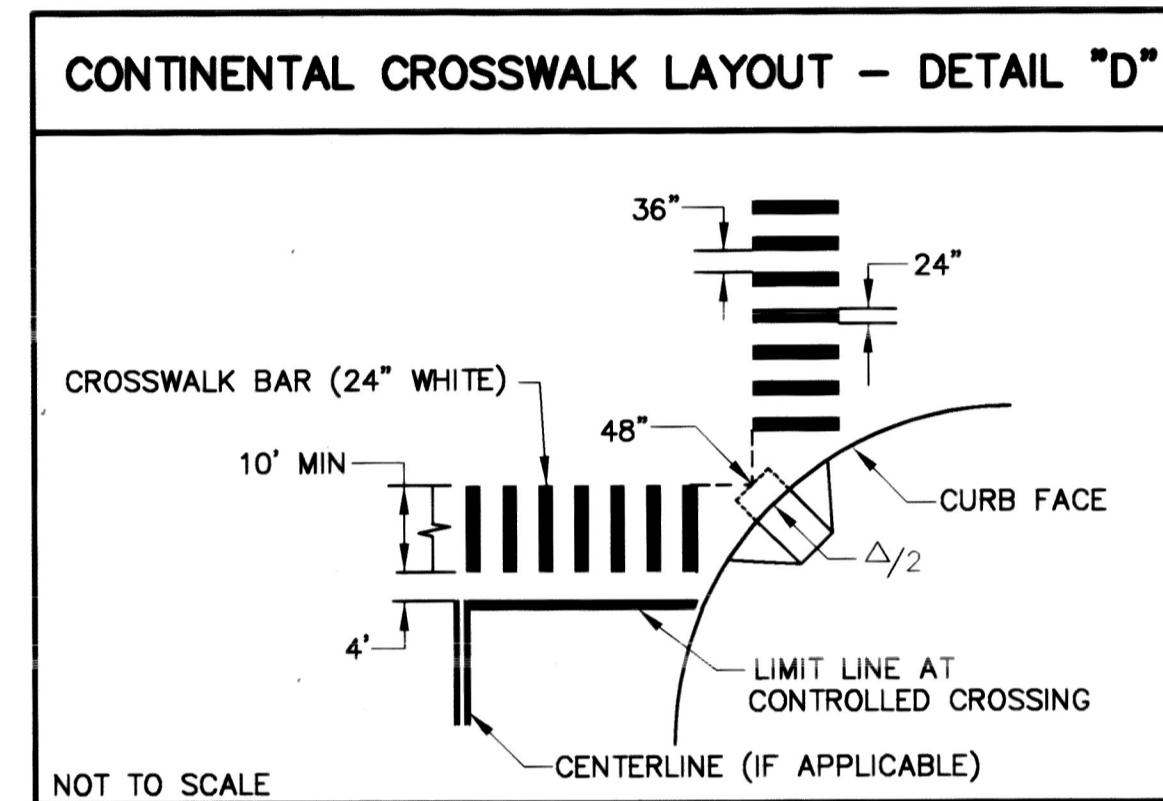
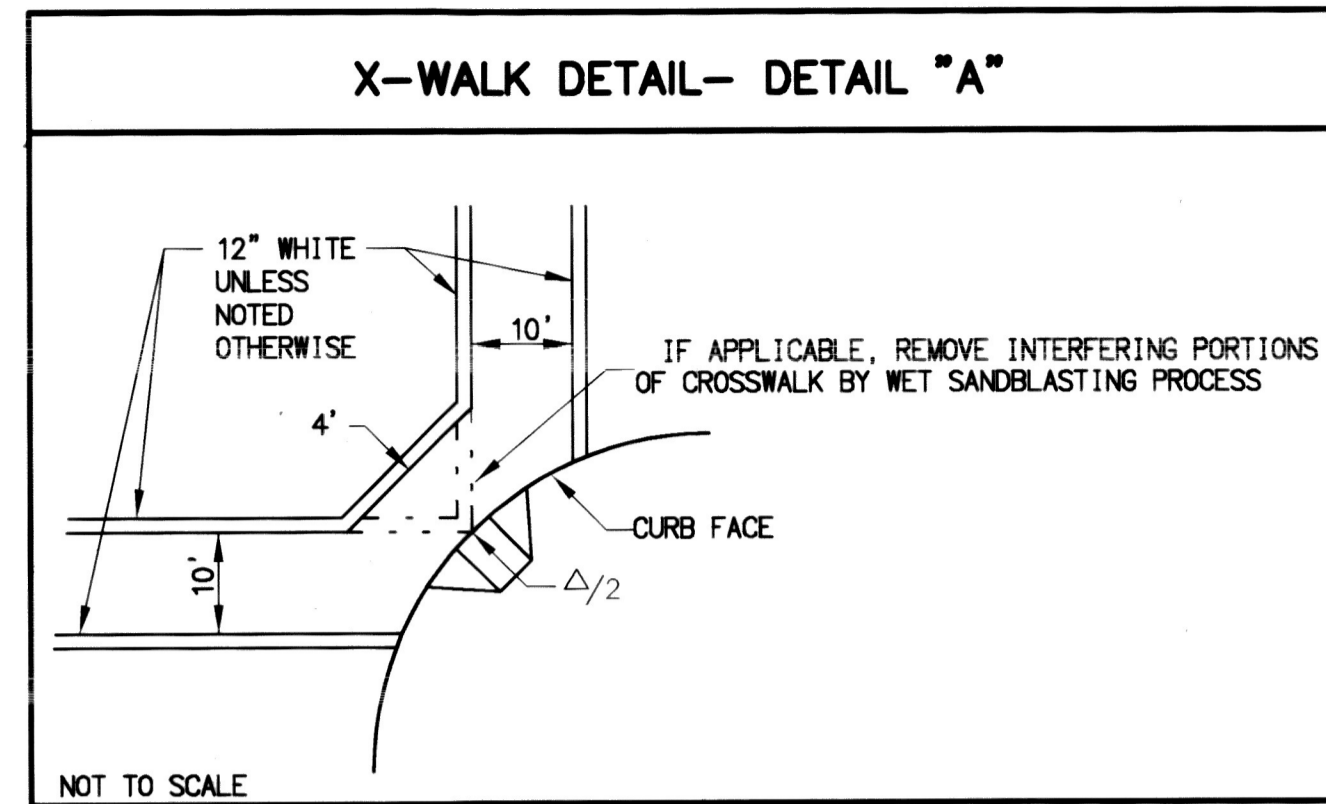

SIGNING AND STRIPING LEGEND AND CONSTRUCTION NOTES:

- E** EXISTING TO REMAIN.
- ME** MATCH EXISTING STRIPING.
- SC** SPLICE TO EXISTING CONDUCTORS.
- SB** SPEED BUMP PER CITY OF RIVERSIDE STANDARD NO. 251, TYPE I.
- I** INSTALL LOOP DETECTOR AS NOTED ON PLAN.
- #** INSTALL CALTRANS STRIPING DETAIL PER NUMBER NOTED, INCLUDING INSTALLATION OF RAISED PAVEMENT MARKERS.
- PM** INSTALL PAVEMENT MARKING OR ARROW AS NOTED.
- RP** REMOVE ALL EXISTING CONFLICTING TRAFFIC STRIPING AND MARKINGS AS NOTED, INCLUDING RAISED PAVEMENT MARKERS.
- RR** REMOVE AND REPLACE EXISTING SIGN POST WITH 2" SQUARE 12 GAUGE PERFORATED POST
- IS** FURNISH AND INSTALL ROADSIDE SIGN(S) OR SNS WITH/WITHOUT POST
- RS** REMOVE SIGN(S) WITH/WITHOUT POST AS NOTED ON PLAN
- RL** RELOCATE EXISTING SIGN(S) TO EXISTING POST OR INSTALL POST (IF APPLICABLE)
- S** EXISTING SIGNALIZED INTERSECTION
- ⊙** PROPOSED SIGN (ONE POST)
- +** PROPOSED STREET NAME SIGN
- ⊙** EXISTING SIGN (ONE POST)
- ⊙** EXISTING/PROPOSED SIGN (ON STREET LIGHT)
- +** EXISTING STREET NAME SIGN
- SNS** STREET NAME SIGN
- (12')** EXISTING WIDTH
- 12'** PROPOSED WIDTH

ROADSIDE SIGNS (STANDARD SIZE):

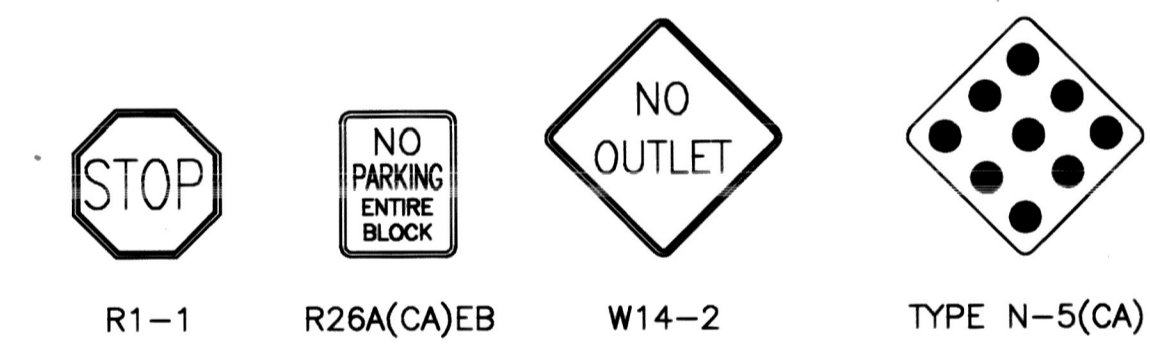

TRAFFIC SIGNAL GENERAL NOTES:

- ALL ITEMS FURNISHED AND ALL WORK TO BE DONE SHALL CONFORM TO THE REQUIREMENTS OF: THE STATE OF CALIFORNIA, DEPARTMENT OF TRANSPORTATION (CALTRANS) STANDARD PLANS AND SPECIFICATIONS, DATED 2018; THE CALIFORNIA MANUAL ON UNIFORM TRAFFIC CONTROL DEVICES ADOPTED 2014; AND THE SPECIAL PROVISIONS.
- UTILITIES SHOWN ON THE PLAN ARE CORRECT AND ACCURATE TO THE EXTENT OF AVAILABLE RECORDS. THE CONTRACTOR IS REQUIRED TO TAKE STEPS TO ASCERTAIN THE EXACT LOCATION OF ALL KNOWN SUBSTRUCTURES PRIOR TO DOING WORK THAT MAY DAMAGE OR INTERFERE WITH SUCH FACILITIES ("UNDERGROUND SERVICE ALERT" (800) 227-2600).
- UNLESS SHOWN OTHERWISE, INDUCTIVE LOOPS SHALL BE MODIFIED TYPE "D" & TYPE "E" WITH 10', 15' AND 30' SPACING IN THE DIRECTION OF TRAVEL. NECESSARY STRIPING SHALL BE LOCATED PRIOR TO POSITIONING LOOPS. LOOPS SHALL BE SEALED WITH HOT MELT SEALANT. SEE DETAIL.
- UNDERGROUND SIGNAL CONDUCTORS SHALL NOT BE SPLICED.
- THE CONTRACTOR SHALL VERIFY WITH THE ENGINEER THE PRECISE FIELD LOCATIONS OF ALL TRAFFIC SIGNAL EQUIPMENT PRIOR TO THE INSTALLATION.
- ALL LANDSCAPING WHICH IS DAMAGED BY CONSTRUCTION ACTIVITIES SHALL BE REPAIRED OR REPLACED TO THE SATISFACTION OF THE CITY AND THE PROPERTY OWNER.
- DAMAGED SIDEWALK CONCRETE SHALL BE REPLACED PER CITY OF RIVERSIDE STANDARD.
- IT SHALL BE THE RESPONSIBILITY OF THE CONTRACTOR TO FURNISH AND INSTALL ANY ADDITIONAL LOAD SWITCHES AND/OR DETECTOR CARDS, IF NECESSARY, FOR THE PROPOSED OPERATION.

(R-4484)

2019/2020 ARTERIAL AND MINOR STREETS MAINTENANCE, PHASE 1

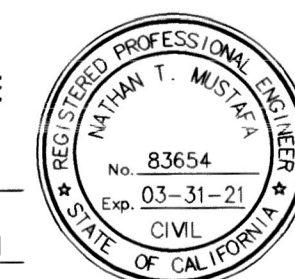

MARK	REVISIONS	APPR.	DATE
DESIGNED BY	EDM	DRAWN BY	EDM
CHECKED BY			NTM

CITY OF RIVERSIDE, CALIFORNIA DEPARTMENT OF PUBLIC WORKS			
APPROVED BY	BY	DATE	APPROVED BY
ENGINEERING MANAGER	FM	1/27/21	CITY ENGINEER
PRINCIPAL ENGINEER			
TRAFFIC DIVISION			
CONSTRUCTION ADMIN.			
			DATE Jan. 28, 2021

SIGNING AND STRIPING PLAN		XL-803
TRAFFIC LEGENDS NOTES, AND DETAILS		
SCALE: 1" = 40'	WORK ORDER #2002496	SHEET 01 OF 12
FILE NAME: XL803.DWG		

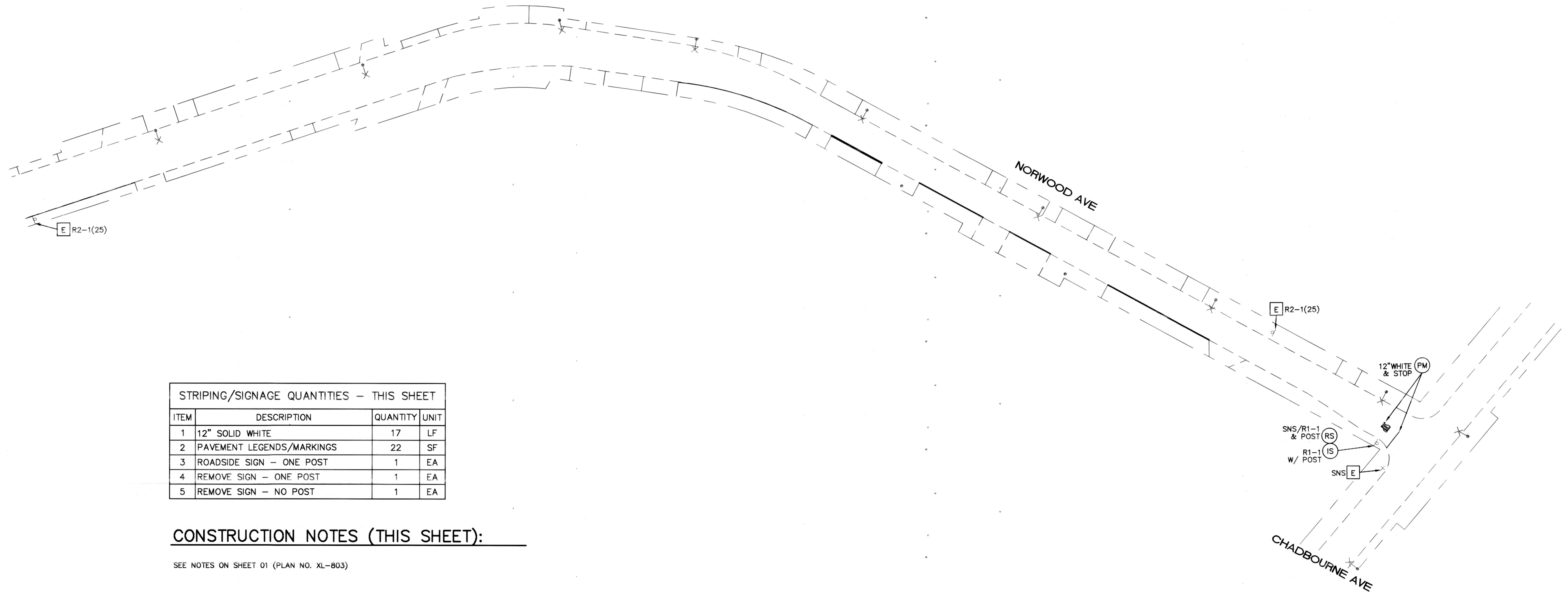

STRIPING/SIGNAGE QUANTITIES - THIS SHEET			
ITEM	DESCRIPTION	QUANTITY	UNIT
1	12" SOLID WHITE	17	LF
2	PAVEMENT LEGENDS/MARKINGS	22	SF
3	ROADSIDE SIGN - ONE POST	1	EA
4	REMOVE SIGN - ONE POST	1	EA
5	REMOVE SIGN - NO POST	1	EA

CONSTRUCTION NOTES (THIS SHEET):

SEE NOTES ON SHEET 01 (PLAN NO. XL-803)

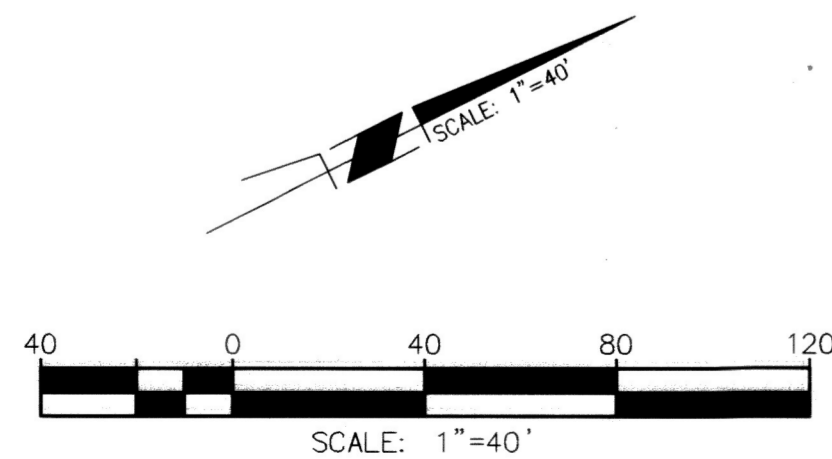

Under Ground Service Alert of Southern California
Call: TOLL FREE 1-800-227-2600
TWO WORKING DAYS BEFORE YOU DIG

ENGINEER IN RESPONSIBLE CHARGE
NATHAN T. MUSTAFA
R.C.E. No. 83654 EXPIRES: 3-31-21
DATE: 1/28/21

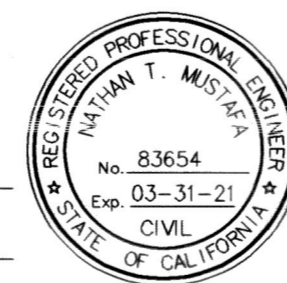

MARK	REVISIONS	APPR.	DATE
DESIGNED BY	FDM	DRAWN BY	FDM
CHECKED BY			NTM

CITY OF RIVERSIDE, CALIFORNIA
DEPARTMENT OF PUBLIC WORKS

APPROVED BY CITY STAFF PER INITIALS ON TITLE SHEET

APPROVED BY THE CITY ENGINEER PER SIGNATURE ON TITLE SHEET

SIGNING AND STRIPING PLAN
2019-2020 ARTERIAL AND MINOR STREETS MAINTENANCE, PHASE 1
LOCATION 1

SCALE: 1" = 40'

WORK ORDER #2002496

XL-803
SHEET 02 OF 12
FILE NAME: XL803.DWG

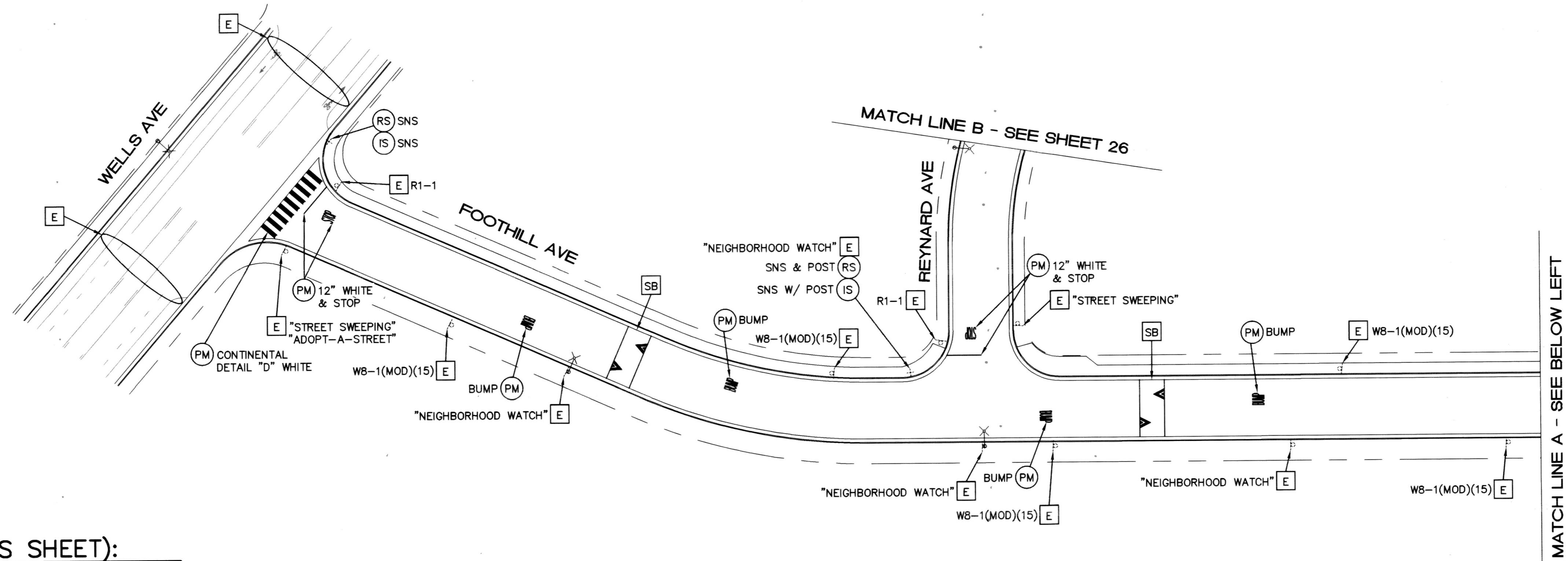

CONSTRUCTION NOTES (THIS SHEET):

SEE NOTES ON SHEET 01 (PLAN NO. XL-803)

STRIPING/SIGNAGE QUANTITIES - THIS SHEET			
ITEM	DESCRIPTION	QUANTITY	UNIT
1	12" SOLID WHITE	95	LF
2	PAVEMENT LEGENDS/MARKINGS	556	SF
3	SNS - ONE POST	2	EA
4	SNS - NO POST	1	EA
5	REMOVE SIGN - ONE POST	2	EA
6	REMOVE SIGN - NO POST	1	EA

SNS DETAILS - THIS SHEET		
INTERSECTION	PANEL No. 1	PANEL No. 2
WELLS AVE & FOOTHILL AVE	Wells Ave 8700	Foothill Ave 5100
FOOTHILL AVE & REYNARD AVE	Foothill Ave 5100	Reynard Ave 8500
FOOTHILL AVE & IVANHOE AVE	Foothill Ave 5000	Ivanhoe Ave 5000

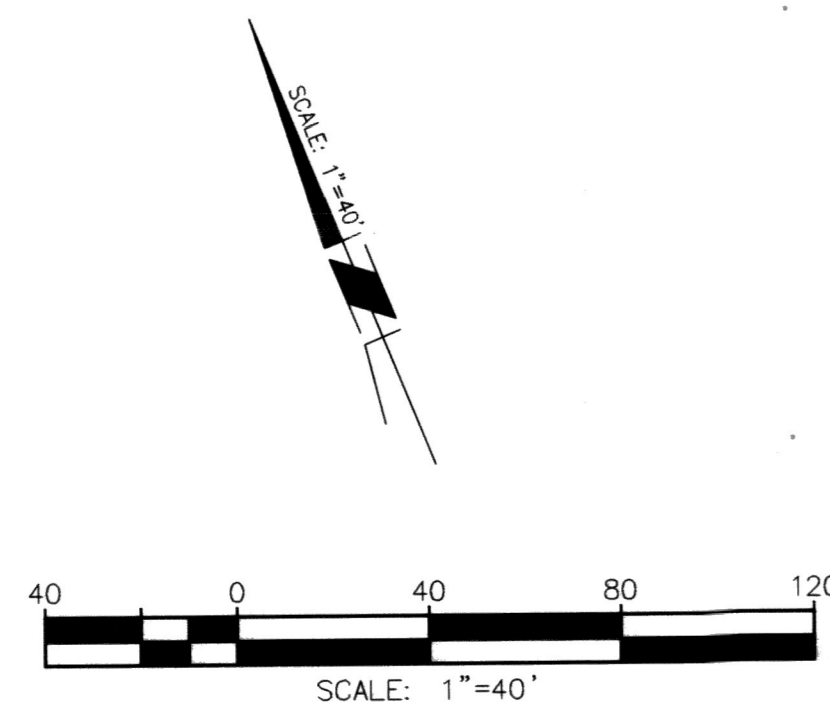
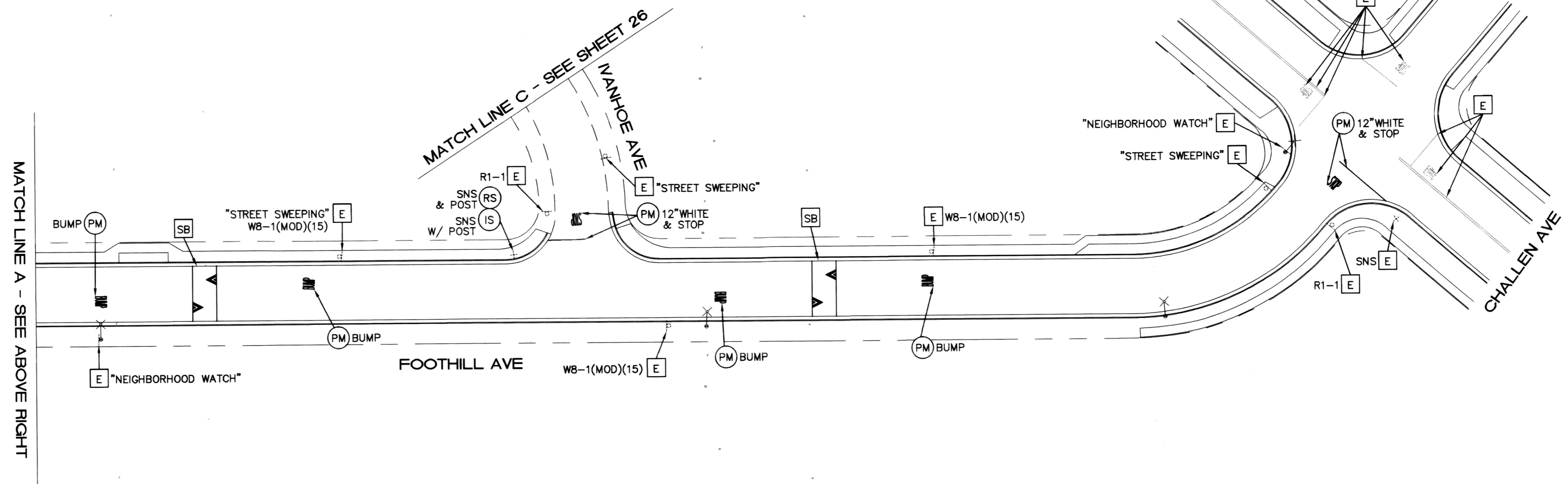

<p>Under Ground Service Alert of Southern California Call: TOLL FREE 1-800-227-2600 TWO WORKING DAYS BEFORE YOU DIG</p>	<p>ENGINEER IN RESPONSIBLE CHARGE</p> <p>NATHAN T. MUSTAFA R.C.E. No. 83654 EXPIRES: 3-31-21 DATE: 1/28/21</p>		<p>CITY OF RIVERSIDE, CALIFORNIA DEPARTMENT OF PUBLIC WORKS</p>		<p>SIGNING AND STRIPING PLAN 2019-2020 ARTERIAL AND MINOR STREETS MAINTENANCE, PHASE 1 LOCATION 2</p>		<p>XL-803 SHEET 03 OF 12 FILE NAME: XL803.DWG</p>
			<p>APPROVED BY CITY STAFF PER INITIALS ON TITLE SHEET</p>	<p>APPROVED BY THE CITY ENGINEER PER SIGNATURE ON TITLE SHEET</p>	<p>SCALE: 1" = 40'</p>	<p>WORK ORDER #2002496</p>	

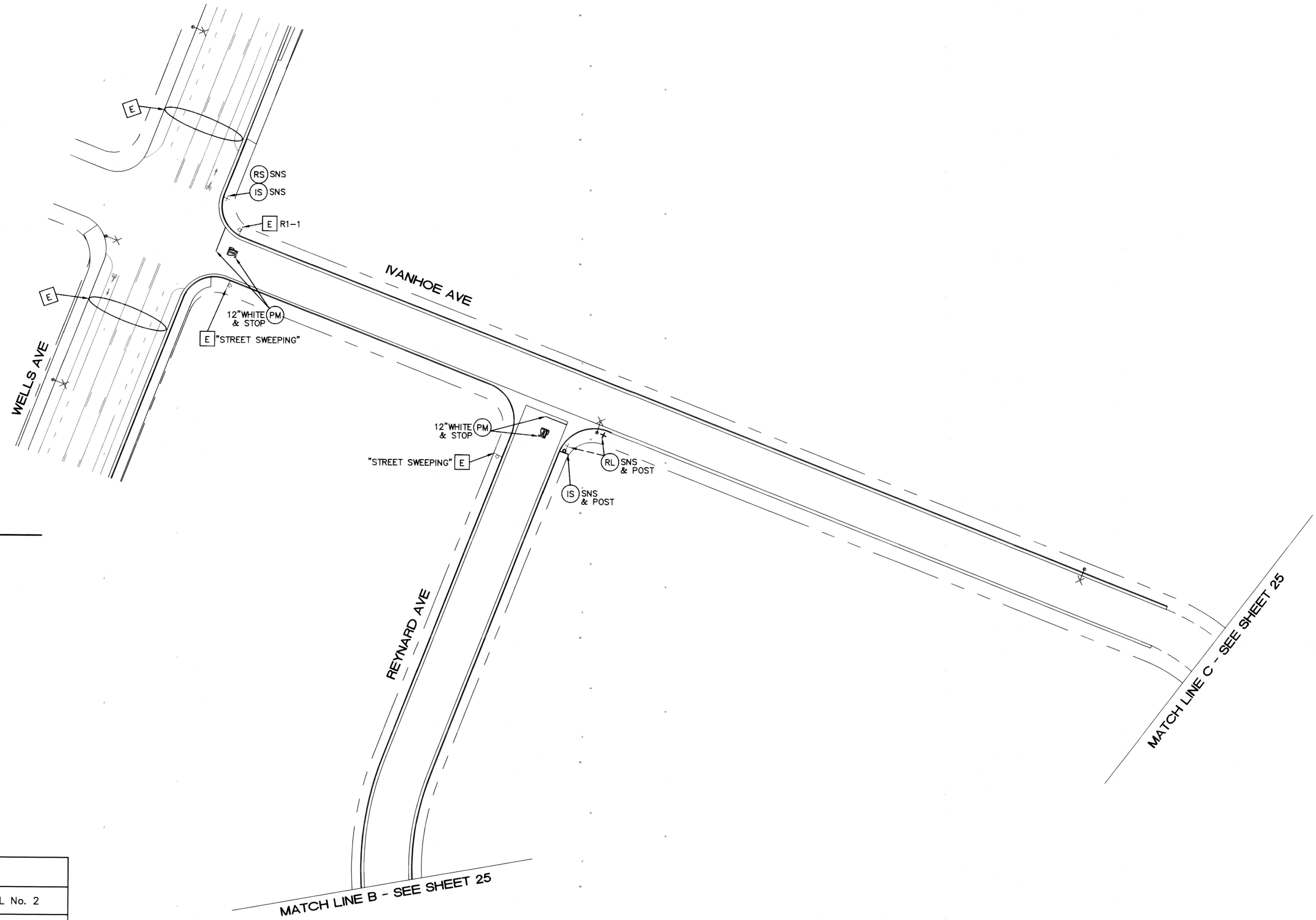

CONSTRUCTION NOTES (THIS SHEET):

SEE NOTES ON SHEET 01 (PLAN NO. XL-803)

STRIPING/SIGNAGE QUANTITIES - THIS SHEET			
ITEM	DESCRIPTION	QUANTITY	UNIT
1	12" SOLID WHITE	34	LF
2	PAVEMENT LEGENDS/MARKINGS	44	SF
3	ROADSIDE SIGN - ONE POST	1	EA
4	SNS - NO POST	1	EA
5	RELOCATE SIGN - ONE POST	1	EA
6	REMOVE SIGN - NO POST	1	EA

SNS DETAILS - THIS SHEET		
INTERSECTION	PANEL No. 1	PANEL No. 2
WELLS AVE & IVANHOE AVE	Wells Ave 8400	Ivanhoe Ave 5200

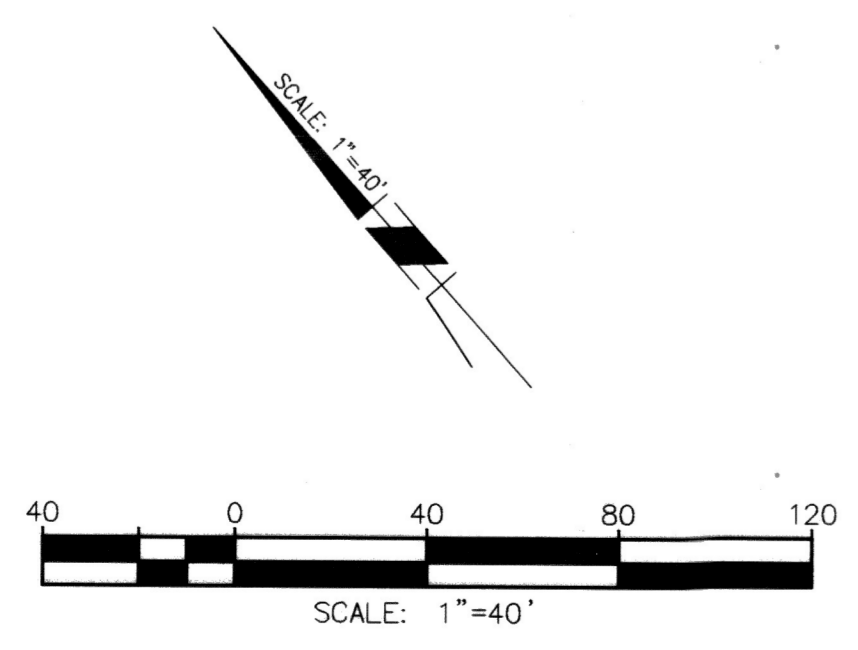

<p>Under Ground Service Alert of Southern California Call: TOLL FREE 1-800-227-2600 TWO WORKING DAYS BEFORE YOU DIG</p>	<p>ENGINEER IN RESPONSIBLE CHARGE NATHAN T. MUSTAFA R.C.E. No. 83654 EXPIRES: 3-31-21 DATE: 1/28/21</p>		<p>CITY OF RIVERSIDE, CALIFORNIA DEPARTMENT OF PUBLIC WORKS</p>		<p>SIGNING AND STRIPING PLAN 2019-2020 ARTERIAL AND MINOR STREETS MAINTENANCE, PHASE 1 LOCATION 2</p>		<p>XL-803 SHEET 04 OF 12 FILE NAME: XL803.DWG</p>
			<p>APPROVED BY CITY STAFF PER INITIALS ON TITLE SHEET</p>	<p>APPROVED BY THE CITY ENGINEER PER SIGNATURE ON TITLE SHEET</p>	<p>SCALE: 1" = 40'</p>	<p>WORK ORDER #2002496</p>	

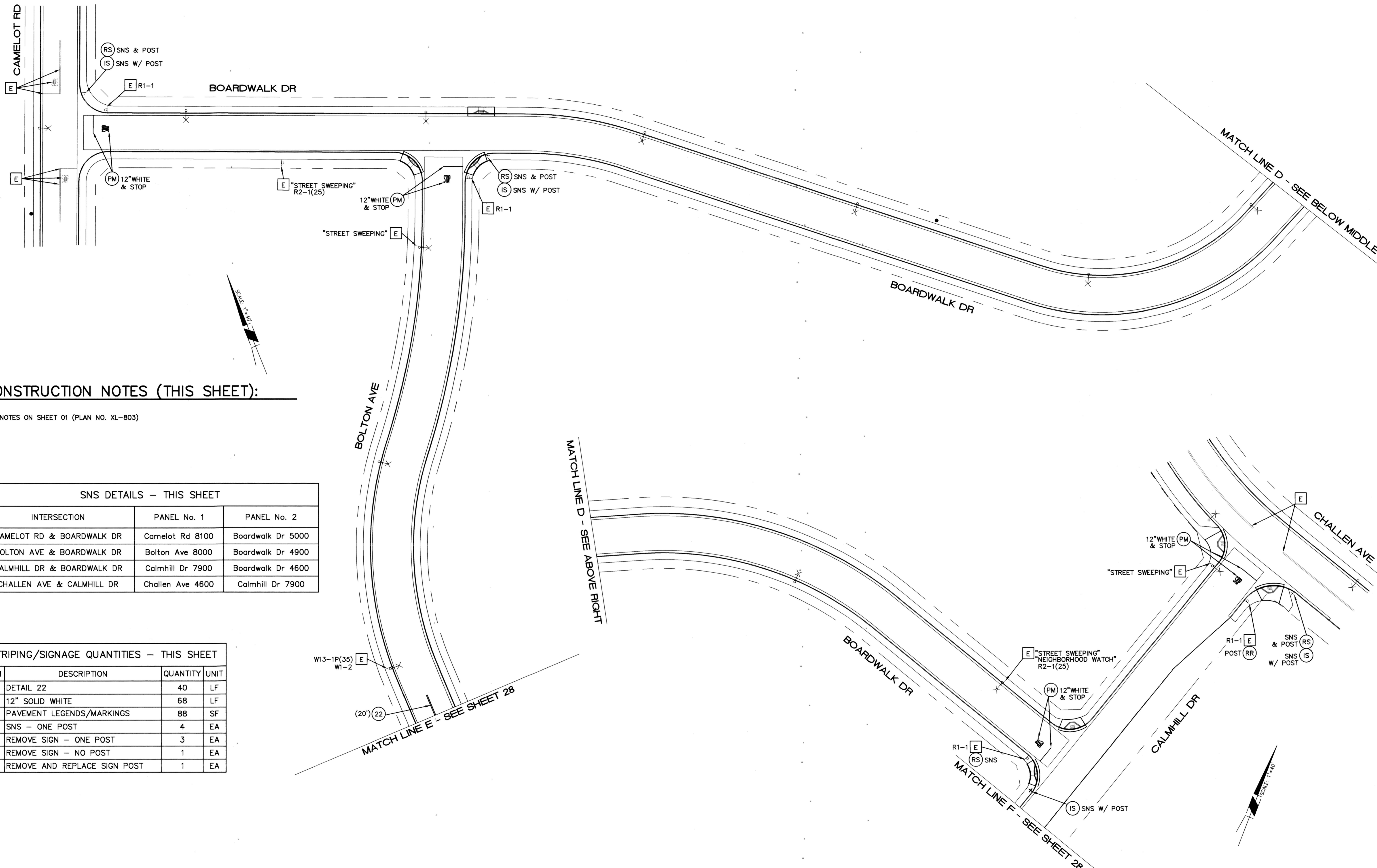

CONSTRUCTION NOTES (THIS SHEET):

SEE NOTES ON SHEET 01 (PLAN NO. XL-803)

SNS DETAILS - THIS SHEET		
INTERSECTION	PANEL No. 1	PANEL No. 2
CAMELOT RD & BOARDWALK DR	Camelot Rd 8100	Boardwalk Dr 5000
BOLTON AVE & BOARDWALK DR	Bolton Ave 8000	Boardwalk Dr 4900
CALMHILL DR & BOARDWALK DR	Calmhill Dr 7900	Boardwalk Dr 4600
CHALLEN AVE & CALMHILL DR	Challen Ave 4600	Calmhill Dr 7900

STRIPING/SIGNAGE QUANTITIES - THIS SHEET			
ITEM	DESCRIPTION	QUANTITY	UNIT
1	DETAIL 22	40	LF
2	12" SOLID WHITE	68	LF
3	PAVEMENT LEGENDS/MARKINGS	88	SF
4	SNS - ONE POST	4	EA
5	REMOVE SIGN - ONE POST	3	EA
6	REMOVE SIGN - NO POST	1	EA
7	REMOVE AND REPLACE SIGN POST	1	EA

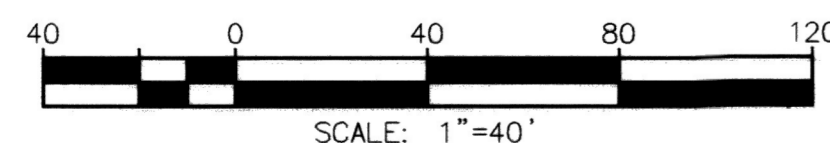

Under Ground Service Alert of Southern California
 Call: TOLL FREE 1-800-227-2600
 TWO WORKING DAYS BEFORE YOU DIG

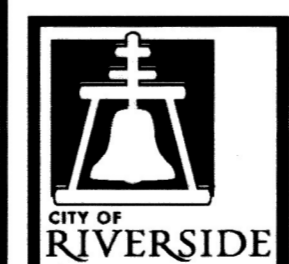

ENGINEER IN RESPONSIBLE CHARGE
 NATHAN T. MUSTAFA
 R.C.E. No. 83654 EXPIRES: 3-31-21
 DATE: 1/28/21



MARK	REVISIONS	APPR	DATE

DESIGNED BY: FDM DRAWN BY: FDM CHECKED BY: NTM

CITY OF RIVERSIDE, CALIFORNIA
 DEPARTMENT OF PUBLIC WORKS

APPROVED BY CITY STAFF
 PER INITIALS ON TITLE SHEET

APPROVED BY THE CITY ENGINEER
 PER SIGNATURE ON TITLE SHEET

SIGNING AND STRIPING PLAN
 2019-2020 ARTERIAL AND MINOR STREETS MAINTENANCE, PHASE 1
 LOCATION 2

SCALE: 1" = 40'

WORK ORDER #2002496

XL-803

SHEET 05 OF 12

FILE NAME: XL803.DWG

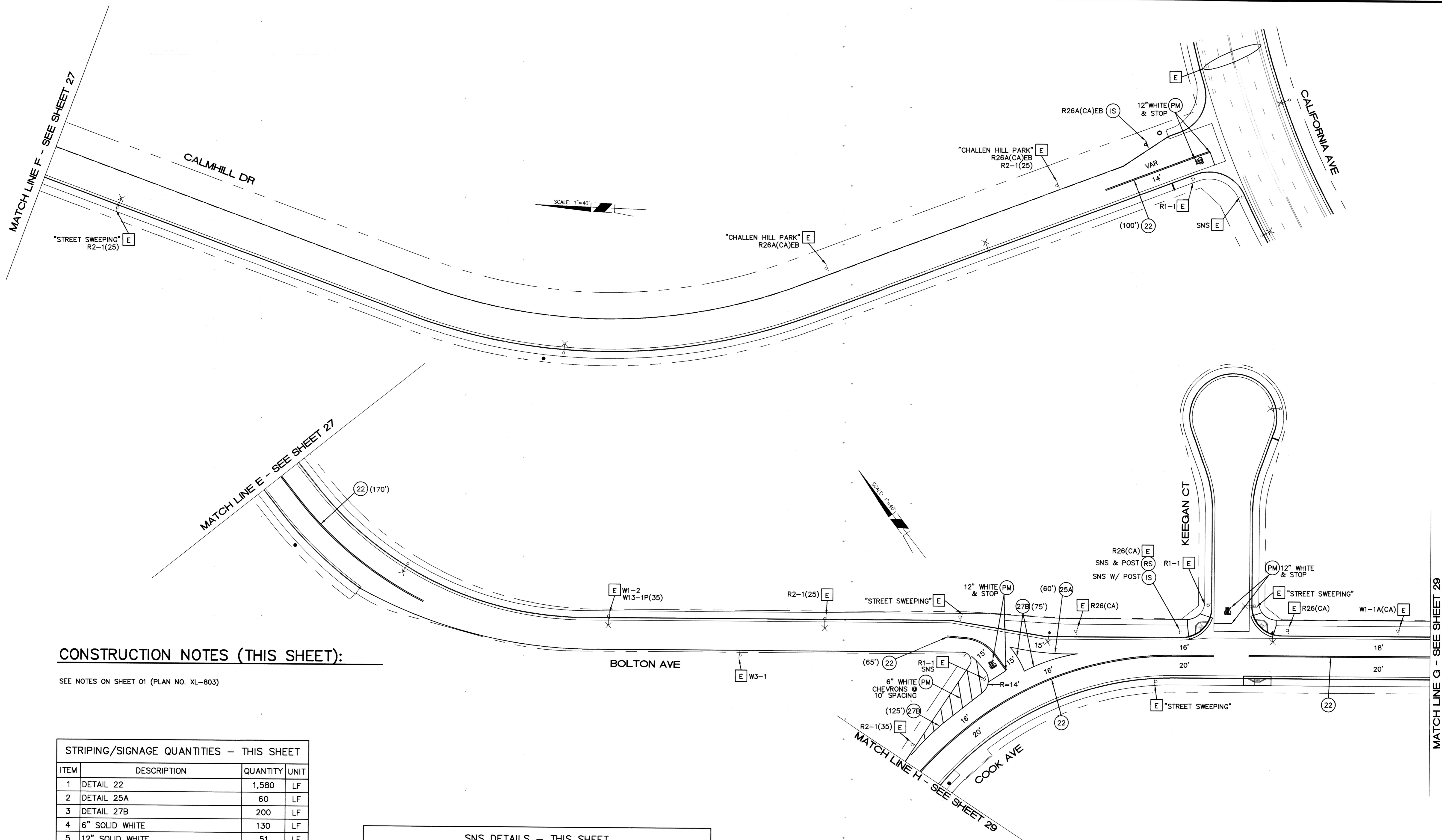

CONSTRUCTION NOTES (THIS SHEET):

SEE NOTES ON SHEET 01 (PLAN NO. XL-803)

STRIPING/SIGNAGE QUANTITIES - THIS SHEET

ITEM	DESCRIPTION	QUANTITY	UNIT
1	DETAIL 22	1,580	LF
2	DETAIL 25A	60	LF
3	DETAIL 27B	200	LF
4	6" SOLID WHITE	130	LF
5	12" SOLID WHITE	51	LF
6	PAVEMENT LEGENDS/MARKINGS	66	SF
7	ROADSIDE SIGN - ONE POST	1	EA
8	SNS - ONE POST	1	EA
9	REMOVE SIGN - ONE POST	1	EA

SNS DETAILS - THIS SHEET

INTERSECTION	PANEL No. 1	PANEL No. 2
BOLTON AVE & KEEGAN CT	Bolton Ave 7800	Keegan Ct 10100

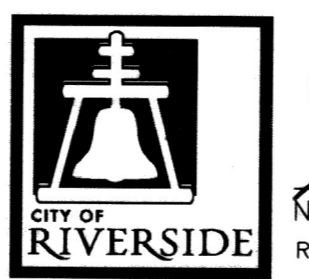
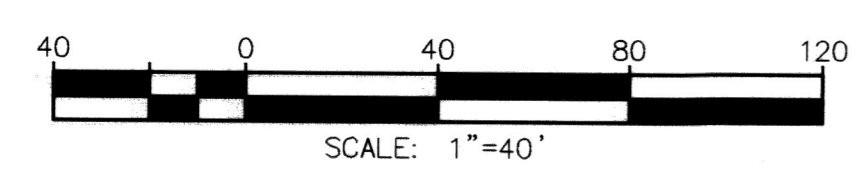

ENGINEER IN RESPONSIBLE CHARGE
 NATHAN T. MUSTAFA
 R.C.E. No. 83654 EXPIRES: 3-31-21
 DATE: 1/28/21



MARK	REVISIONS	APPR	DATE

DESIGNED BY: FDM DRAWN BY: FDM CHECKED BY: NTM

CITY OF RIVERSIDE, CALIFORNIA
 DEPARTMENT OF PUBLIC WORKS

APPROVED BY CITY STAFF
 PER INITIALS ON TITLE SHEET

APPROVED BY THE CITY ENGINEER
 PER SIGNATURE ON TITLE SHEET

SIGNING AND STRIPING PLAN

2019-2020 ARTERIAL AND MINOR
 STREETS MAINTENANCE, PHASE 1

LOCATION 2

SCALE: 1" = 40'

WORK ORDER #2002496

XL-803

SHEET 06 OF 12

FILE NAME: XL803.DWG

CONSTRUCTION NOTES (THIS SHEET):

SEE NOTES ON SHEET 01 (PLAN NO. XL-803)

STRIPING/SIGNAGE QUANTITIES - THIS SHEET			
ITEM	DESCRIPTION	QUANTITY	UNIT
1	DETAIL 22	3,300	LF
2	12" SOLID WHITE	33	LF
3	PAVEMENT LEGENDS/MARKINGS	44	SF
4	SNS - ONE POST	1	EA
5	REMOVE SIGN - ONE POST	1	EA

SNS DETAILS - THIS SHEET		
INTERSECTION	PANEL No. 1	PANEL No. 2
BOLTON AVE & AMITY CT	Bolton Ave 7800	Amity Ct 10100

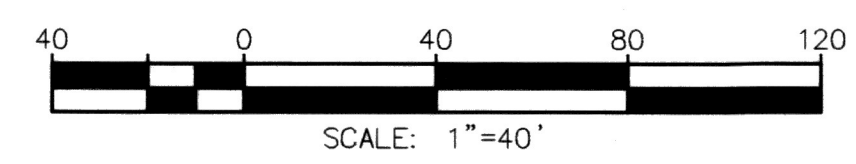
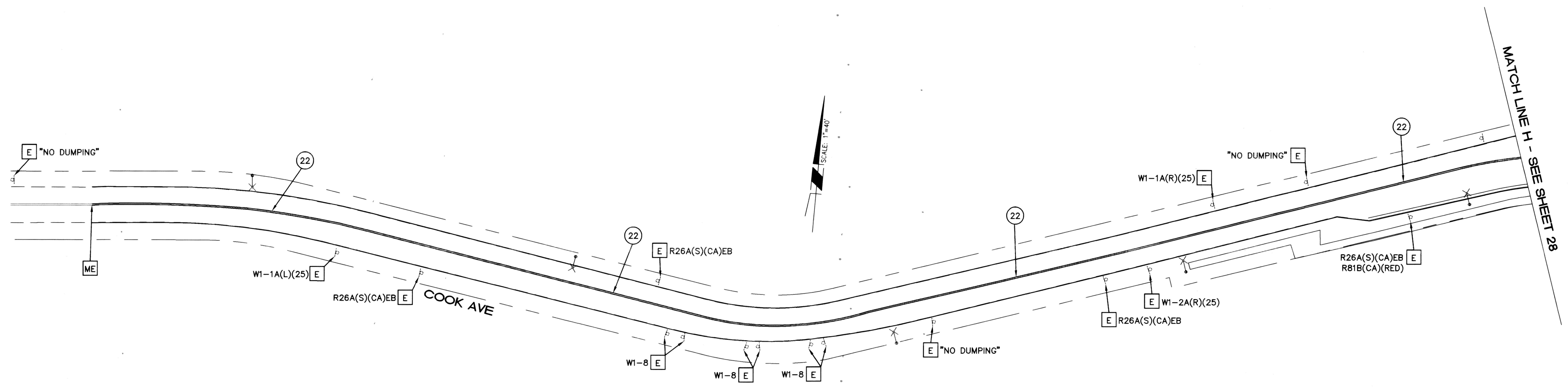
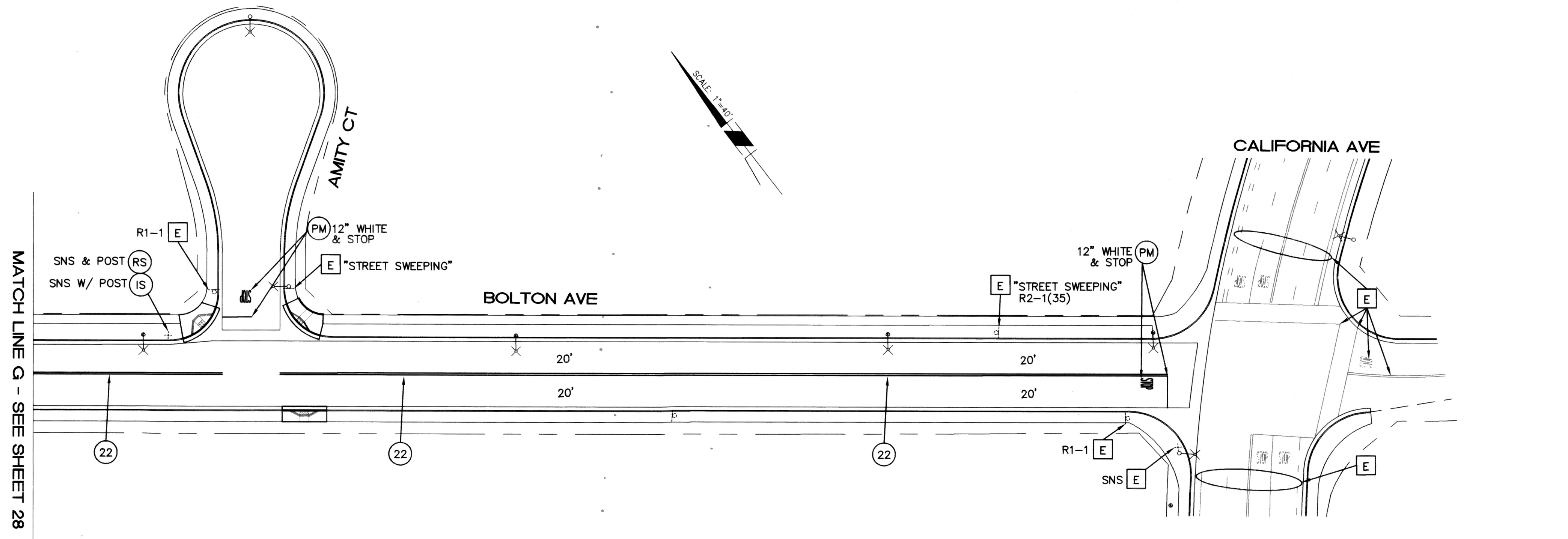

<p>Under Ground Service Alert of Southern California Call: TOLL FREE 1-800-227-2600 TWO WORKING DAYS BEFORE YOU DIG</p>	<p>ENGINEER IN RESPONSIBLE CHARGE</p> <p>NATHAN T. MUSTAFA R.C.E. No. 83654 EXPIRES: 3-31-21 DATE: 1/28/21</p>		<p>CITY OF RIVERSIDE, CALIFORNIA DEPARTMENT OF PUBLIC WORKS</p>		<p>SIGNING AND STRIPING PLAN</p>	<p>XL-803</p>
			<p>APPROVED BY CITY STAFF PER INITIALS ON TITLE SHEET</p>		<p>APPROVED BY THE CITY ENGINEER PER SIGNATURE ON TITLE SHEET</p>	

CONSTRUCTION NOTES (THIS SHEET):

SEE NOTES ON SHEET 01 (PLAN NO. XL-803)

- 1 CONTRACTOR SHALL INSTALL 1 NEW DLCs FOR CHANNEL 8J6L

STRIPING/SIGNAGE QUANTITIES - THIS SHEET			
ITEM	DESCRIPTION	QUANTITY	UNIT
1	DETAIL 22	2,220	LF
2	4" SOLID WHITE	1,260	LF
3	12" SOLID WHITE	96	LF
4	PAVEMENT LEGENDS/MARKINGS	306	SF
5	ROADSIDE SIGN - ONE POST	1	EA
6	SNS - ONE POST	2	EA
7	SNS - NO POST	1	EA
8	REMOVE SIGN - ONE POST	1	EA
9	REMOVE SIGN - NO POST	2	EA
10	TYPE "D" LOOP DETECTOR	1	EA
11	TYPE "E" LOOP DETECTOR	2	EA
12	DLC - DETECTOR LOOP CABLE	155	LF
13	SC - SPLICE NEW TO EXISTING	1	EA

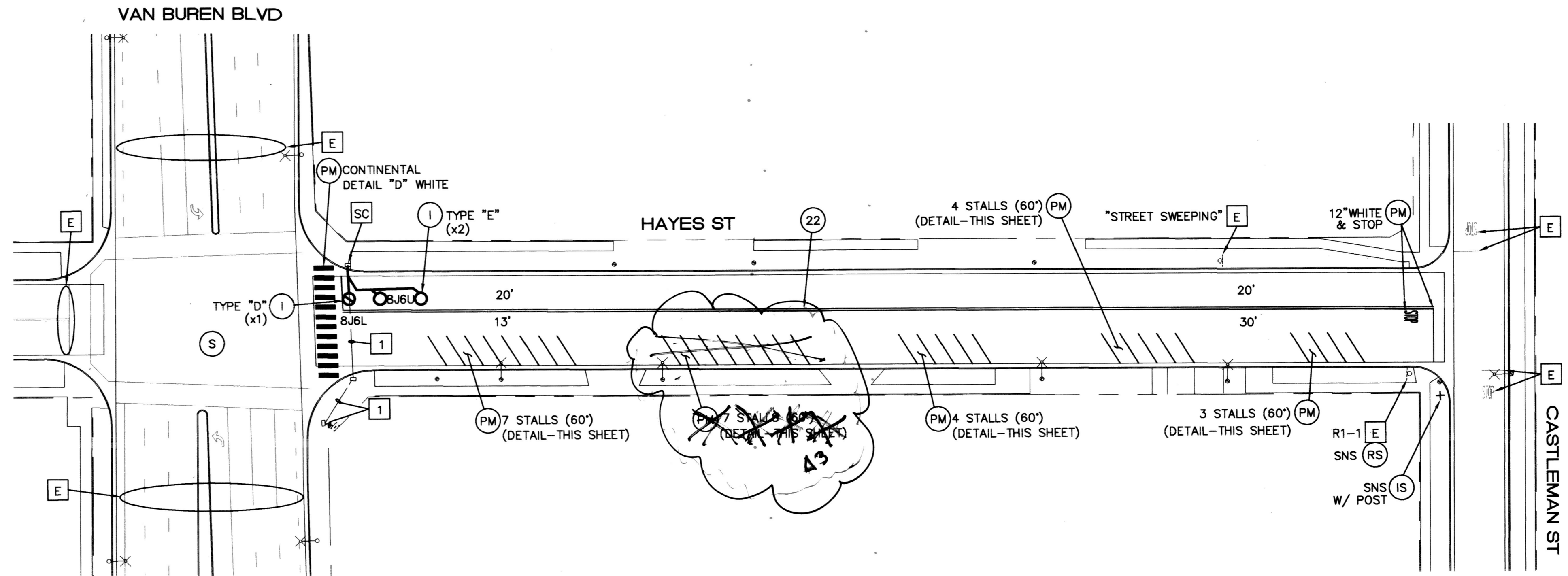

SNS DETAILS - THIS SHEET		
INTERSECTION	PANEL No. 1	PANEL No. 2
VAN BUREN BLVD & MILLER ST	Van Buren Blvd 3800	Miller St 9400
MILLER ST & CASTLEMAN ST	Miller St 9400	Castleman St 3800
HAYES ST & CASTLEMAN ST	Hayes St 9400	Castleman St 3800

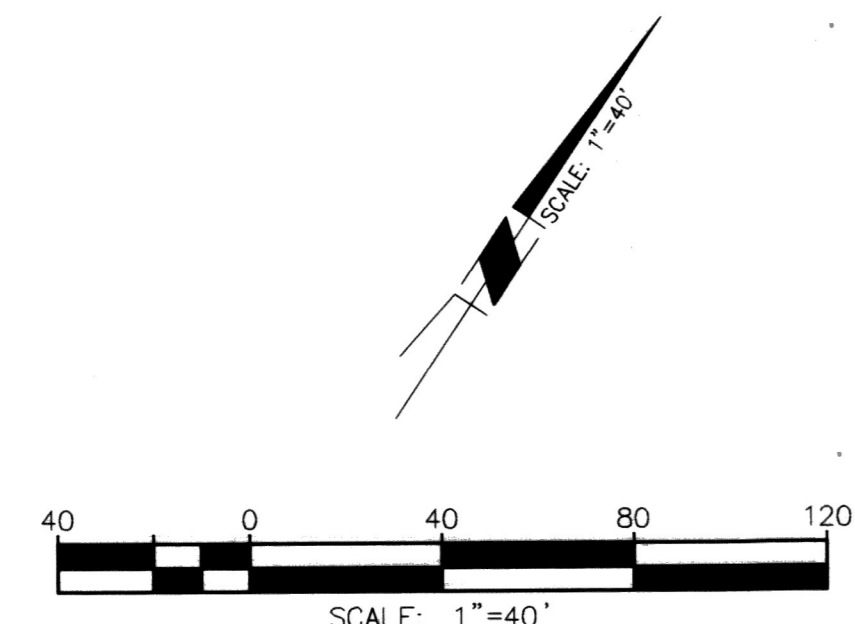
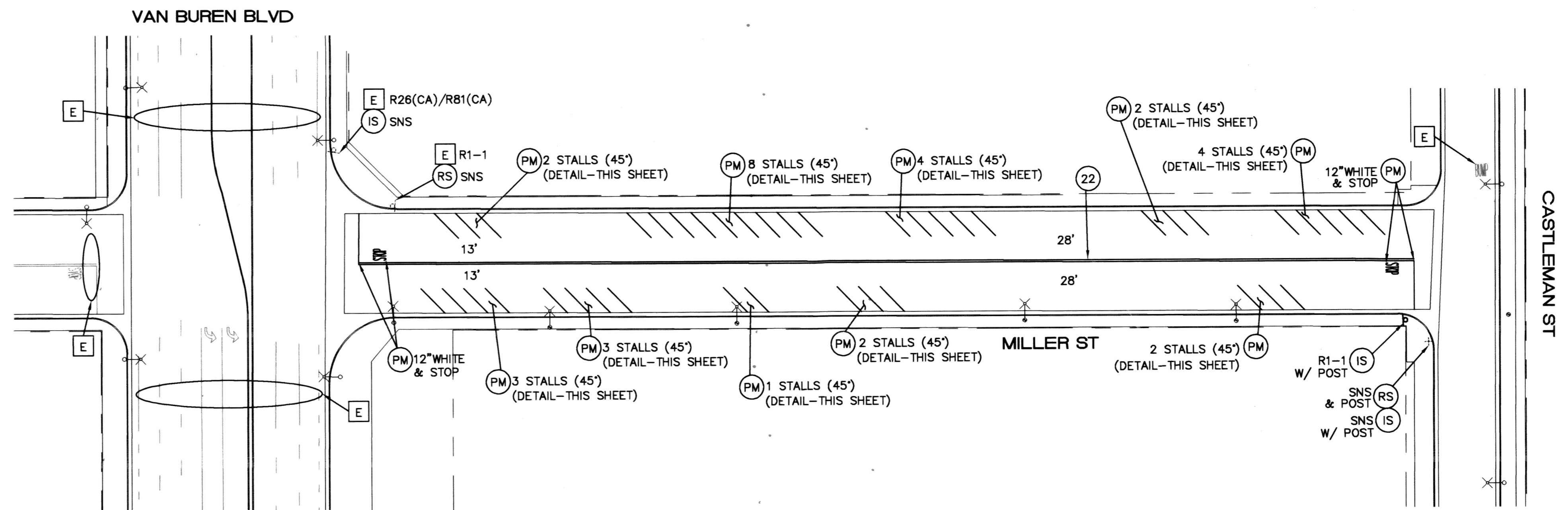
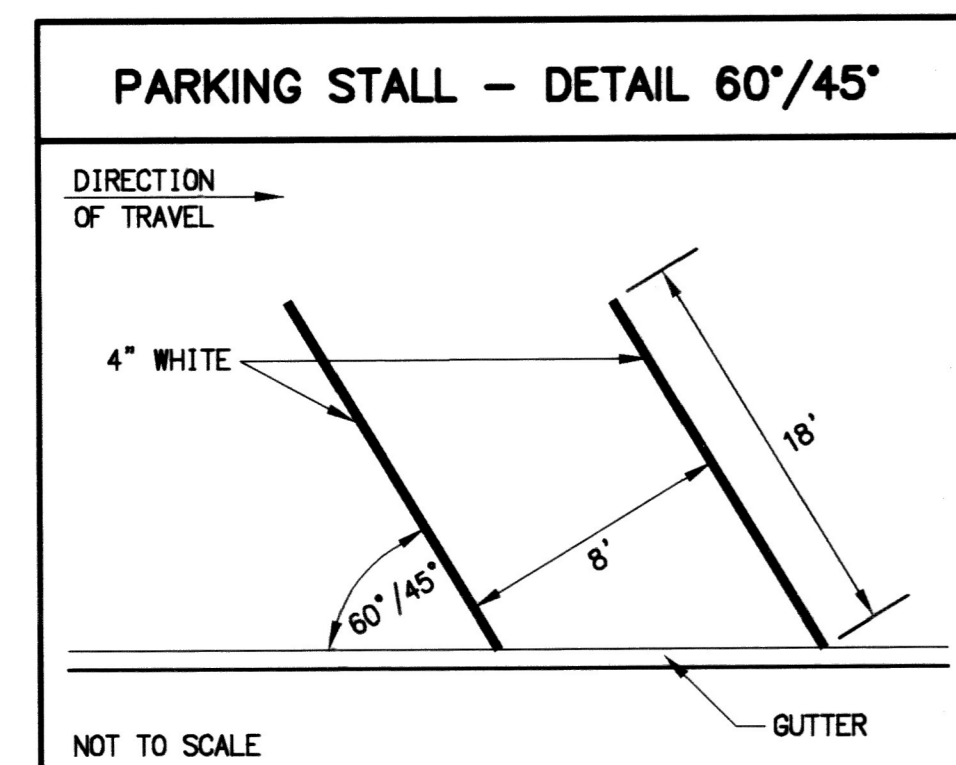

<p>Under Ground Service Alert of Southern California Call: TOLL FREE 1-800 227-2600 TWO WORKING DAYS BEFORE YOU DIG</p>	<p>ENGINEER IN RESPONSIBLE CHARGE NATHAN T. MUSTAFA R.C.E. No. 83654 EXPIRES: 3-31-21 DATE: 1/28/21</p>	<p>APPROVED BY CITY STAFF PER INITIALS ON TITLE SHEET</p> <p>APPROVED BY THE CITY ENGINEER PER SIGNATURE ON TITLE SHEET</p>	<p>CITY OF RIVERSIDE, CALIFORNIA DEPARTMENT OF PUBLIC WORKS</p>	<p>SIGNING AND STRIPING PLAN 2019-2020 ARTERIAL AND MINOR STREETS MAINTENANCE, PHASE 1 LOCATION 3</p>	<p>XL-803 SHEET 08 OF 12 FILE NAME: XL803.DWG</p>

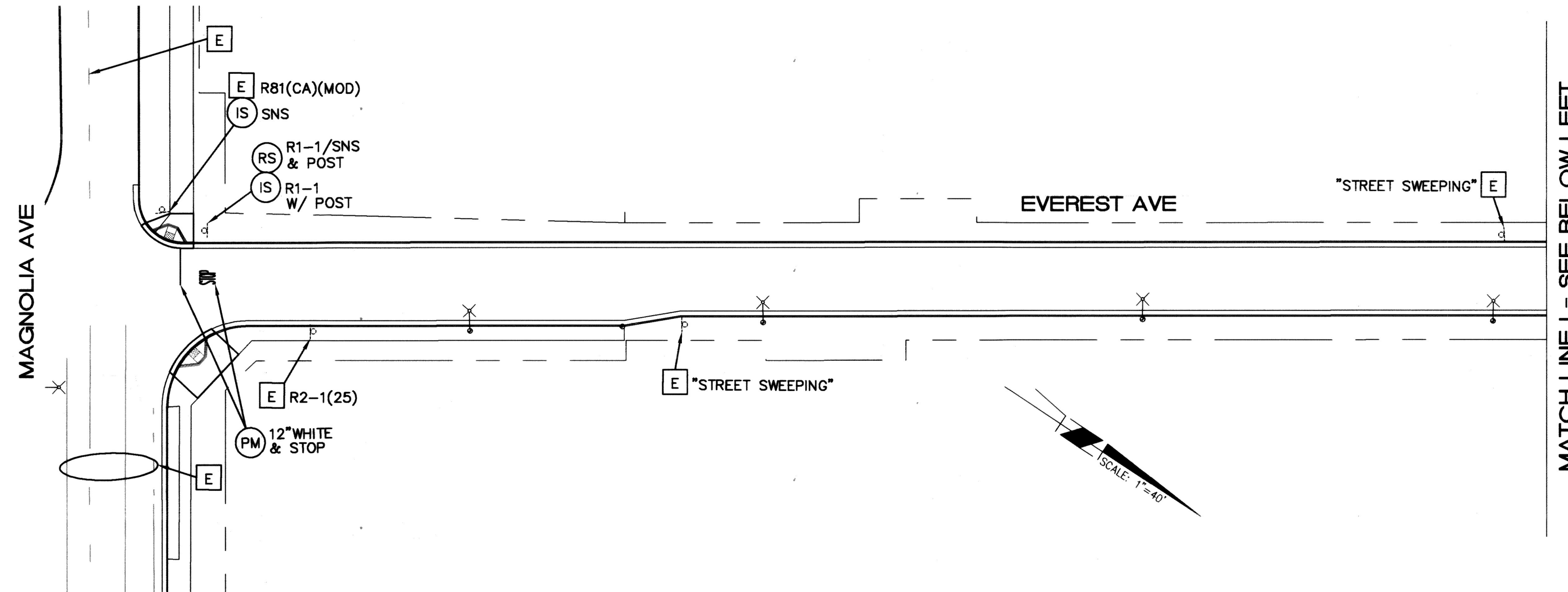

MATCH LINE I - SEE BELOW LEFT

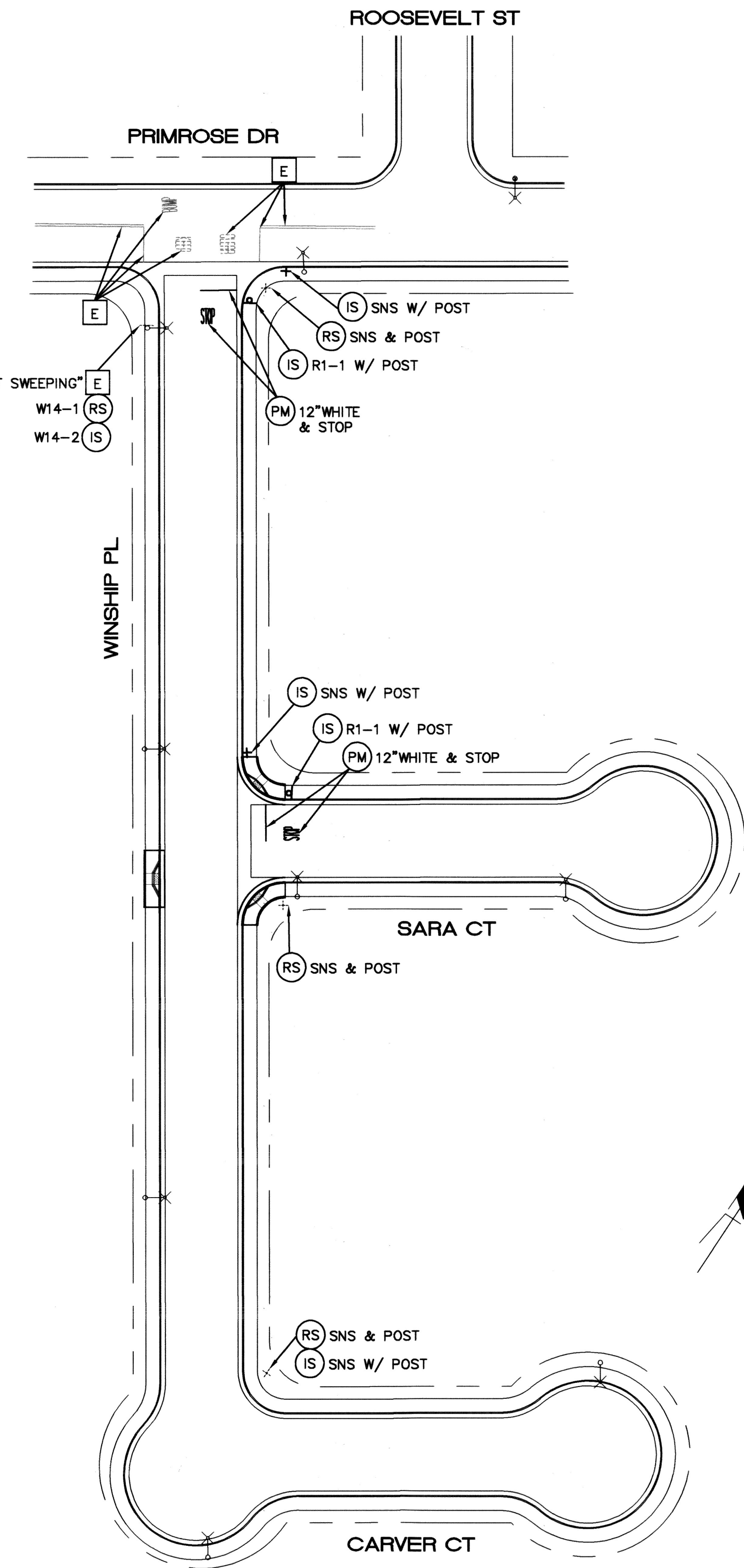

MATCH LINE I - SEE ABOVE RIGHT

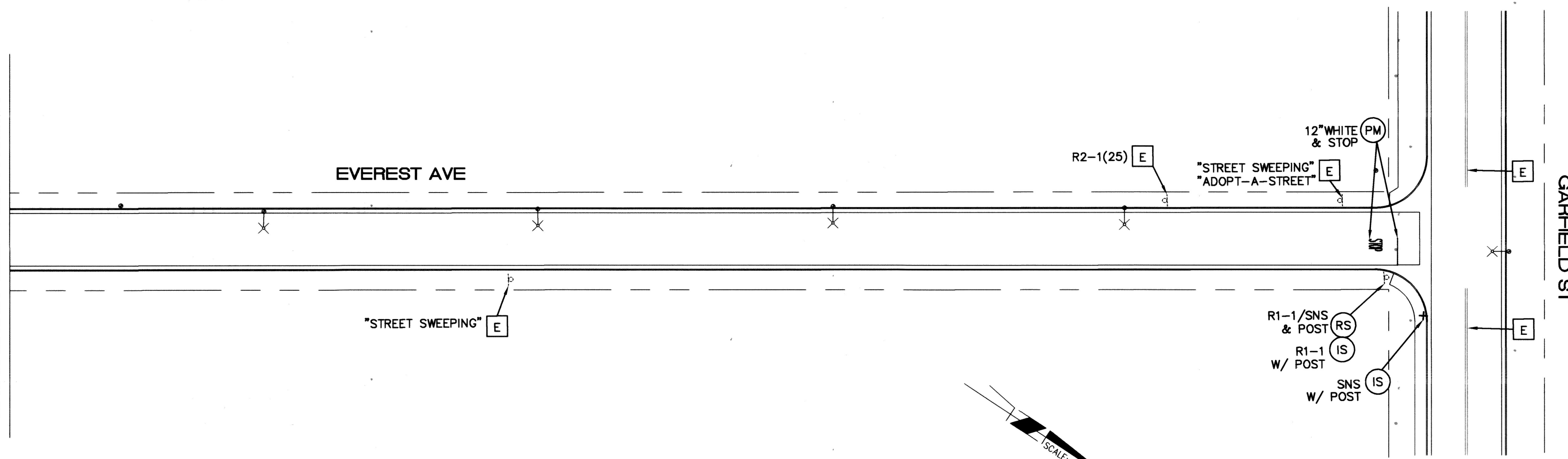

GARFIELD ST

CONSTRUCTION NOTES (THIS SHEET):

SEE NOTES ON SHEET 01 (PLAN NO. XL-803)

STRIPING/SIGNAGE QUANTITIES - THIS SHEET

ITEM	DESCRIPTION	QUANTITY	UNIT
1	12" SOLID WHITE	60	LF
2	PAVEMENT LEGENDS/MARKINGS	88	SF
3	ROADSIDE SIGN - ONE POST	4	EA
4	ROADSIDE SIGN - NO POST	1	EA
5	SNS - ONE POST	4	EA
6	SNS - NO POST	1	EA
7	REMOVE SIGN - ONE POST	5	EA
8	REMOVE SIGN - NO POST	1	EA

SNS DETAILS - THIS SHEET

INTERSECTION	PANEL No. 1	PANEL No. 2
MAGNOLIA AVE & EVEREST AVE	Magnolia Ave 9300	Everest Ave 3800
GARFIELD ST & EVEREST AVE	Garfield St 9200	Everest Ave 3900
WINSHIP PL & PRIMROSE DR	Winship Pl 3500	Primrose Dr 9500
WINSHIP PL & SARA CT	Winship Pl 3500	Sara Ct 9500
WINSHIP PL & CARVER CT	Winship Pl 3500	Carver Ct 9500

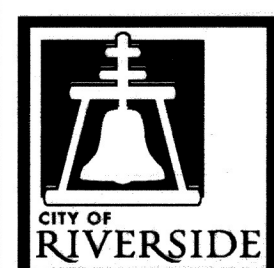
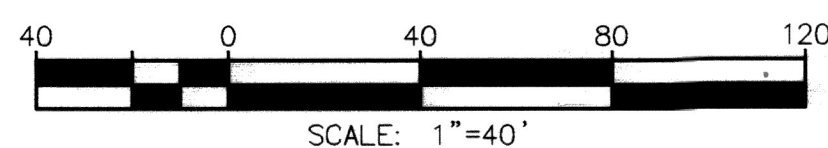

ENGINEER IN RESPONSIBLE CHARGE
 NATHAN T. MUSTAFA
 R.C.E. No. 83654 EXPIRES: 3-31-21
 DATE: 1/28/21



MARK	REVISIONS	APPR.	DATE

DESIGNED BY: FDM DRAWN BY: FDM CHECKED BY: NTM

CITY OF RIVERSIDE, CALIFORNIA
 DEPARTMENT OF PUBLIC WORKS

APPROVED BY CITY STAFF
 PER INITIALS ON TITLE SHEET

APPROVED BY THE CITY ENGINEER
 PER SIGNATURE ON TITLE SHEET

SIGNING AND STRIPING PLAN

2019-2020 ARTERIAL AND MINOR
 STREETS MAINTENANCE, PHASE 1

LOCATION 3

SCALE: 1" = 40'

WORK ORDER #2002496

XL-803

SHEET 09 OF 12

FILE NAME: XL803.DWG

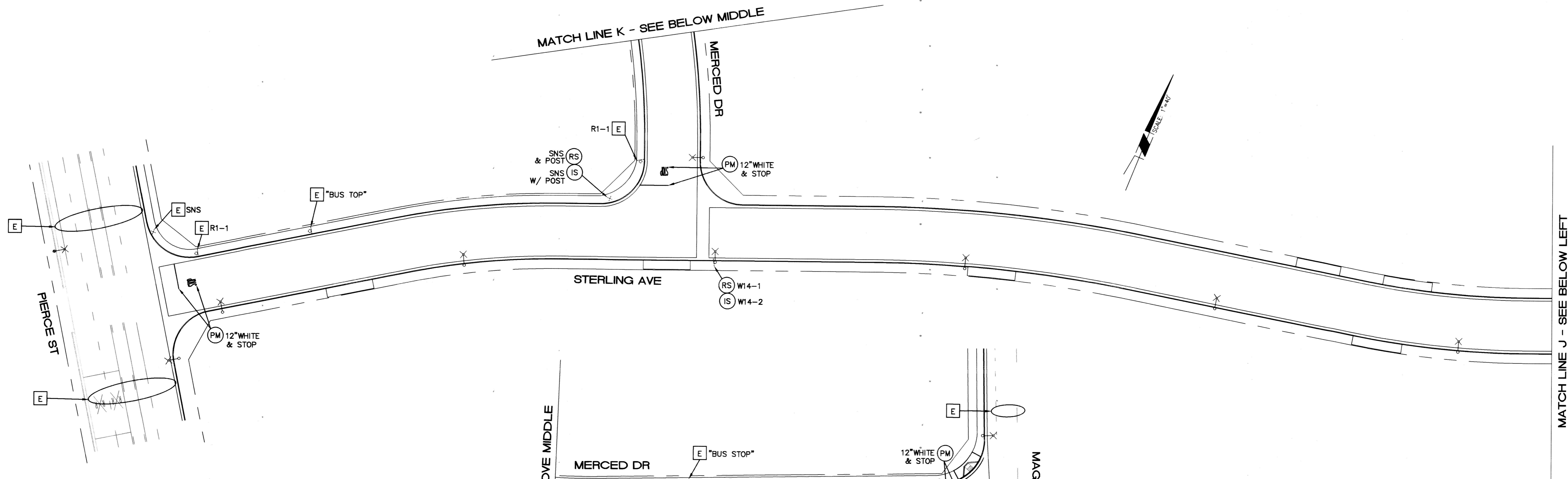

CONSTRUCTION NOTES (THIS SHEET):

SEE NOTES ON SHEET 01 (PLAN NO. XL-803)

STRIPING/SIGNAGE QUANTITIES - THIS SHEET

ITEM	DESCRIPTION	QUANTITY	UNIT
1	12" SOLID WHITE	62	LF
2	PAVEMENT LEGENDS/MARKINGS	66	SF
3	ROADSIDE SIGN - NO POST	1	EA
4	SNS - ONE POST	1	EA
5	REMOVE SIGN - ONE POST	1	EA
6	REMOVE SIGN - NO POST	1	EA
7	REMOVE AND REPLACE SIGN POST	1	EA

SNS DETAILS - THIS SHEET		
INTERSECTION	PANEL No. 1	PANEL No. 2
STERLING AVE & MERCED DR	Sterling Ave 11800	Merced Dr 3700

MATCH LINE J - SEE ABOVE RIGHT

MATCH LINE J - SEE BELOW LEFT

MATCH LINE K - SEE ABOVE MIDDLE

MATCH LINE K - SEE BELOW MIDDLE

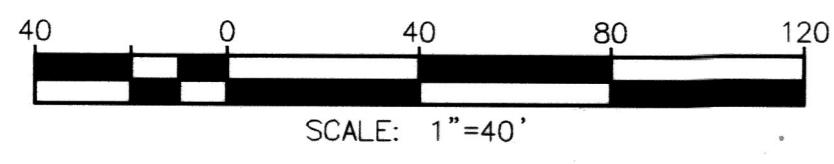

ENGINEER IN RESPONSIBLE CHARGE
 NATHAN T. MUSTAFA
 R.C.E. No. 83654 EXPIRES: 3-31-21
 DATE: 1/28/21

MARK	REVISIONS	APPR.	DATE

DESIGNED BY: FDM DRAWN BY: FDM CHECKED BY: NTM

CITY OF RIVERSIDE, CALIFORNIA
 DEPARTMENT OF PUBLIC WORKS

APPROVED BY CITY STAFF
 PER INITIALS ON TITLE SHEET

SIGNING AND STRIPING PLAN
 2019-2020 ARTERIAL AND MINOR
 STREETS MAINTENANCE, PHASE 1
 LOCATION 4

SCALE: 1" = 40' WORK ORDER #2002496

XL-803
 SHEET 10 OF 12
 FILE NAME: XL803.DWG

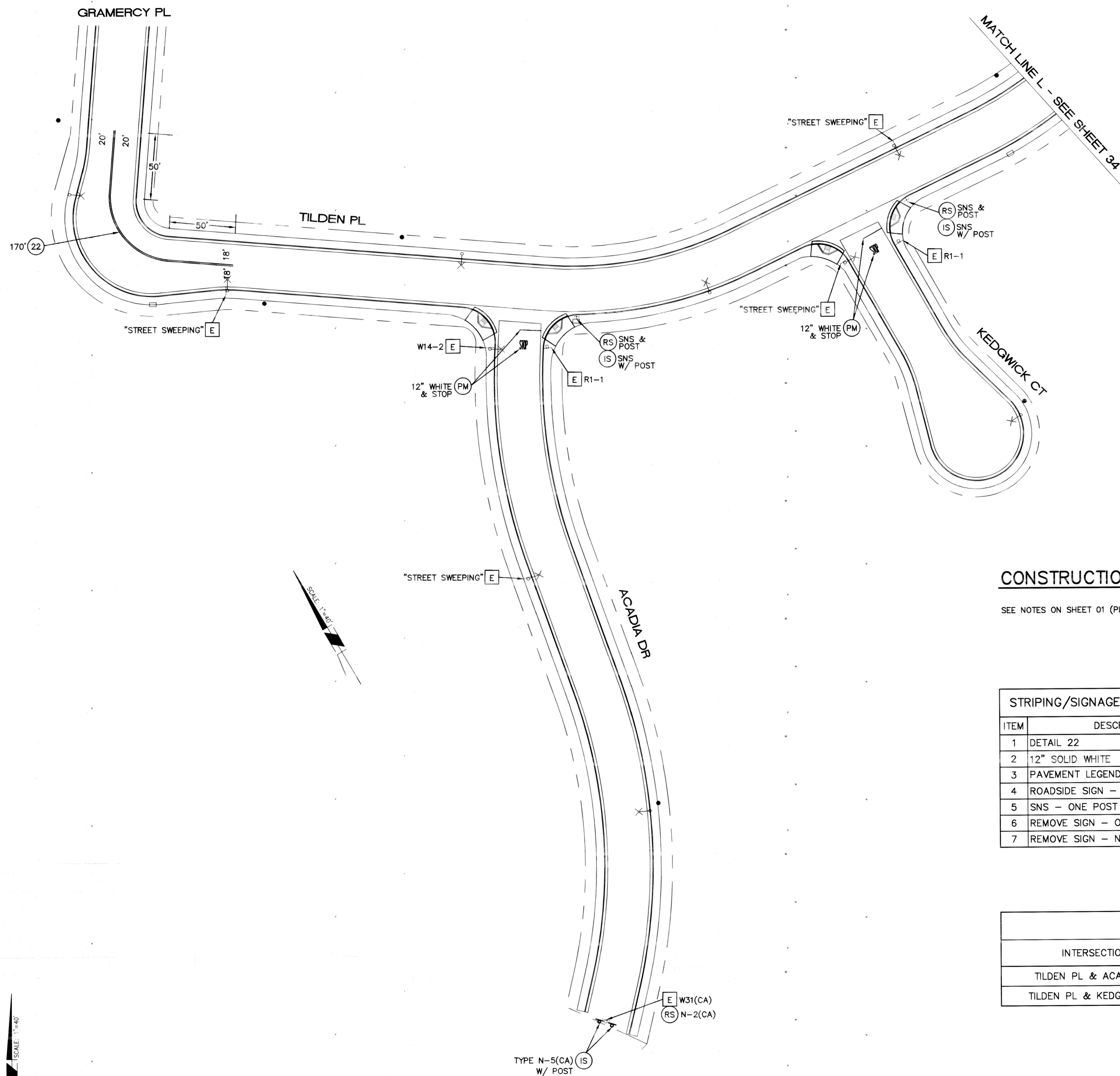

CONSTRUCTION NOTES (THIS SHEET):

SEE NOTES ON SHEET 01 (PLAN NO. XL-803)

STRIPING/SIGNAGE QUANTITIES - THIS SHEET			
ITEM	DESCRIPTION	QUANTITY	UNIT
1	DETAIL 22	340	LF
2	12" SOLID WHITE	32	LF
3	PAVEMENT LEGENDS/MARKINGS	44	SF
4	ROADSIDE SIGN - ONE POST	2	EA
5	SNS - ONE POST	2	EA
6	REMOVE SIGN - ONE POST	2	EA
7	REMOVE SIGN - NO POST	1	EA

SNS DETAILS - THIS SHEET		
INTERSECTION	PANEL No. 1	PANEL No. 2
TILDEN PL & ACADIA DR	Tilden Pl 11900	Acadia Dr 5100
TILDEN PL & KEDGWICK CT	Tilden Pl 11800	Kedgwick Ct 5100

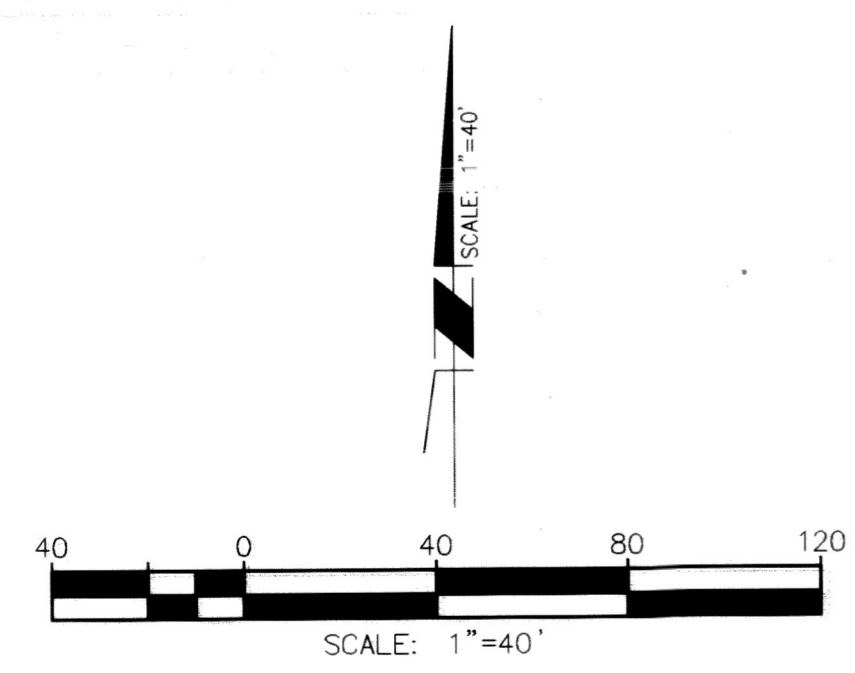

<p>Under Ground Service Alert of Southern California Call: TOLL FREE 1-800-227-2600 TWO WORKING DAYS BEFORE YOU DIG</p>	<p>ENGINEER IN RESPONSIBLE CHARGE NATHAN T. MUSTAFA R.C.E. No. 83654 EXPIRES: 3-31-21 DATE: 1/28/21</p>	<p>CITY OF RIVERSIDE, CALIFORNIA DEPARTMENT OF PUBLIC WORKS</p>	SIGNING AND STRIPING PLAN		XL-803
			<p>2019-2020 ARTERIAL AND MINOR STREETS MAINTENANCE, PHASE 1</p>		
<p>APPROVED BY CITY STAFF PER INITIALS ON TITLE SHEET</p>		<p>APPROVED BY THE CITY ENGINEER PER SIGNATURE ON TITLE SHEET</p>		<p>SCALE: 1" = 40'</p>	<p>WORK ORDER #2002496</p>
<p>DESIGNED BY: FDM DRAWN BY: FDM CHECKED BY: NTM</p>			<p>FILE NAME: XL803.DWG</p>		<p>SHEET 11 OF 12</p>

MATCH LINE L - SEE SHEET 33

MATCH LINE M - SEE ABOVE MIDDLE

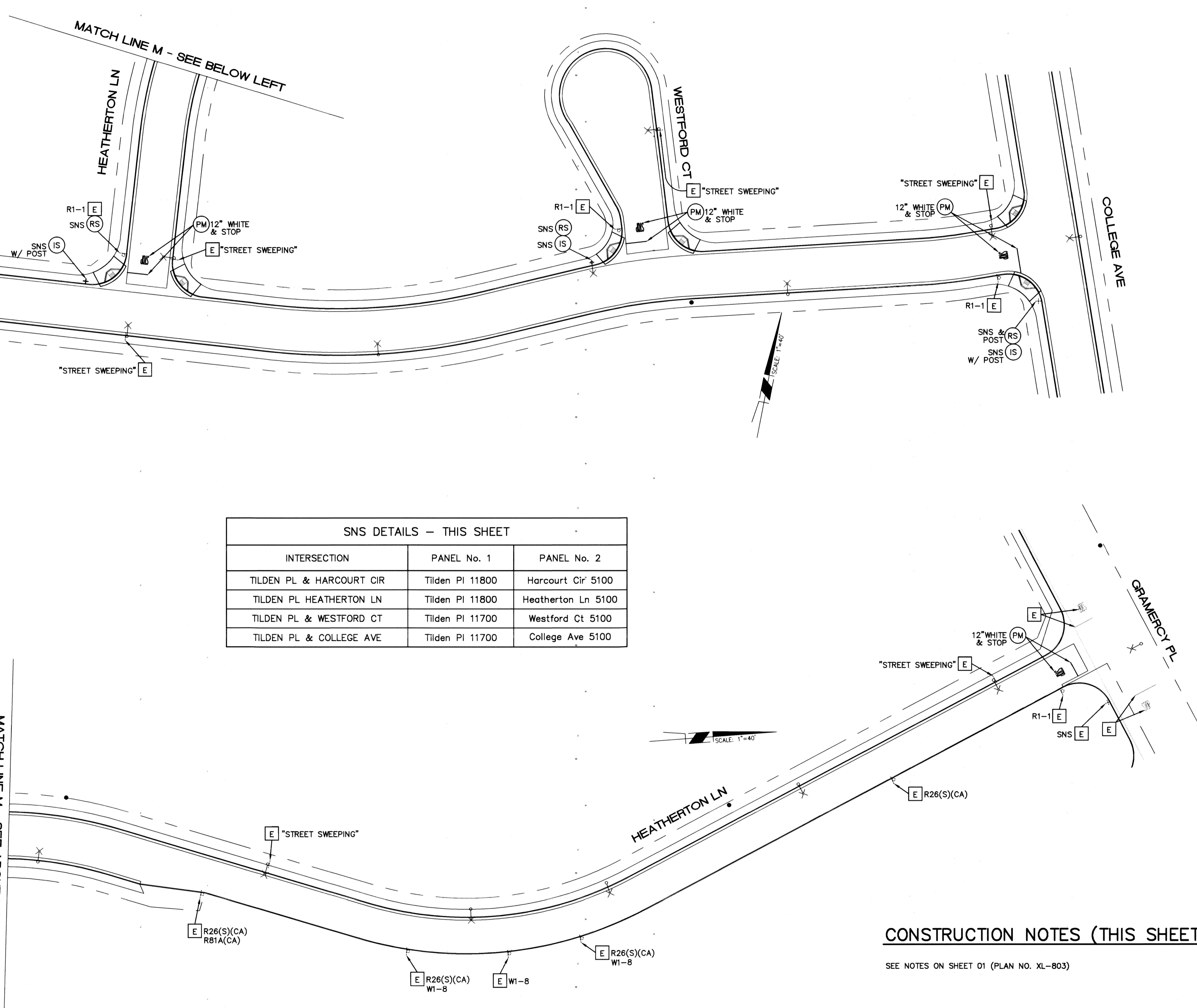

SNS DETAILS - THIS SHEET		
INTERSECTION	PANEL No. 1	PANEL No. 2
TILDEN PL & HARCOURT CIR	Tilden PI 11800	Harcourt Cir 5100
TILDEN PL HEATHERTON LN	Tilden PI 11800	Heatherton Ln 5100
TILDEN PL & WESTFORD CT	Tilden PI 11700	Westford Ct 5100
TILDEN PL & COLLEGE AVE	Tilden PI 11700	College Ave 5100

STRIPING/SIGNAGE QUANTITIES - THIS SHEET			
ITEM	DESCRIPTION	QUANTITY	UNIT
1	12" SOLID WHITE	80	LF
2	PAVEMENT LEGENDS/MARKINGS	110	SF
3	SNS - ONE POST	3	EA
4	SNS - NO POST	1	EA
5	REMOVE SIGN - ONE POST	2	EA
6	REMOVE SIGN - NO POST	2	EA

CONSTRUCTION NOTES (THIS SHEET):
 SEE NOTES ON SHEET 01 (PLAN NO. XL-803)

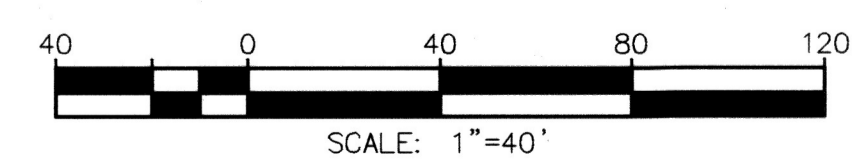

Under Ground Service Alert of Southern California
 Call: TOLL FREE 1-800-227-2600
 TWO WORKING DAYS BEFORE YOU DIG

ENGINEER IN RESPONSIBLE CHARGE
 NATHAN T. MUSTAFA
 R.C.E. No. 83654 EXPIRES: 3-31-21
 DATE 1/28/21



MARK	REVISIONS	APPR.	DATE

DESIGNED BY: FDM DRAWN BY: FDM CHECKED BY: NTM

CITY OF RIVERSIDE, CALIFORNIA
 DEPARTMENT OF PUBLIC WORKS

APPROVED BY CITY STAFF PER INITIALS ON TITLE SHEET

APPROVED BY THE CITY ENGINEER PER SIGNATURE ON TITLE SHEET

SIGNING AND STRIPING PLAN
 2019-2020 ARTERIAL AND MINOR STREETS MAINTENANCE, PHASE 1
 LOCATION 5
 SCALE: 1" = 40'
 WORK ORDER #2002496

XL-803
 SHEET 12 OF 12
 FILE NAME: XL803.DWG