

DOVLING LN

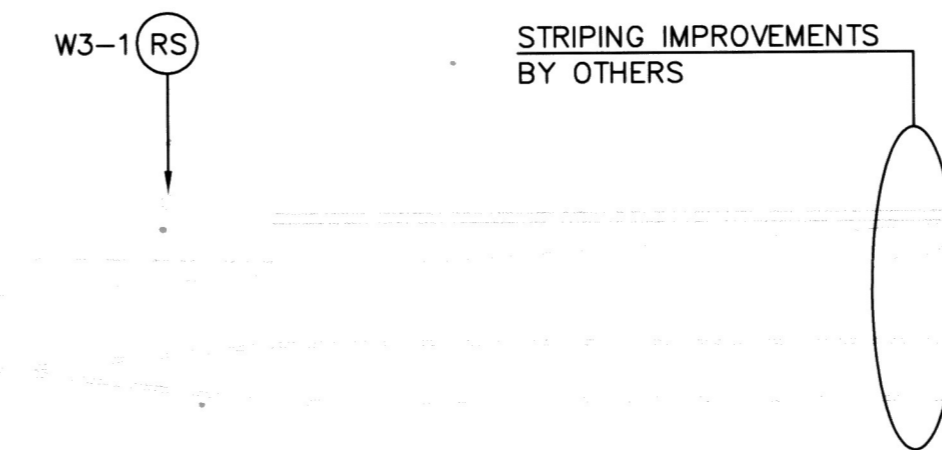
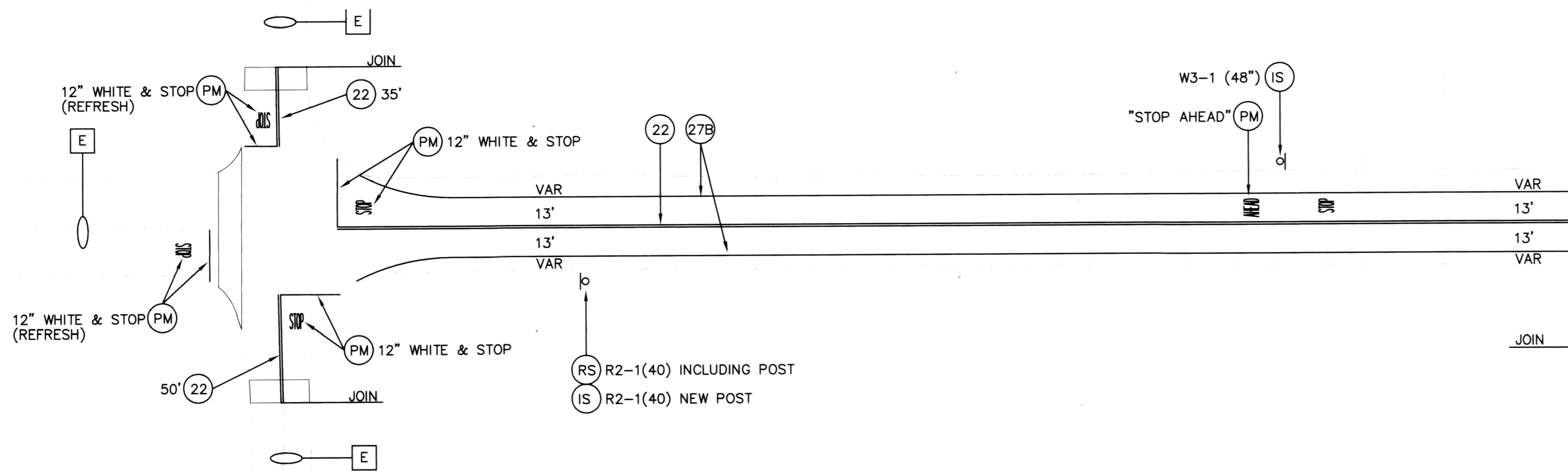

WOOD ROAD

NEWSOME RD

MATCHLINE SEE BELOW LEFT

MARIPOSA AVE

WOODCREST LN

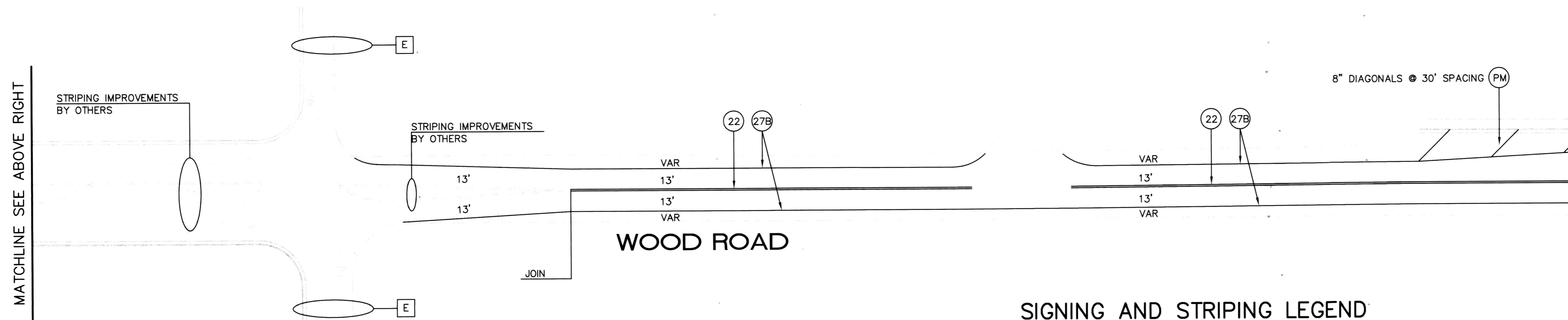

MATCHLINE SEE SHEET No. 2

SIGNING AND STRIPING GENERAL NOTES:

- SIGNING AND STRIPING INSTALLATIONS SHALL CONFORM TO THE 2014 CALIFORNIA MANUAL ON UNIFORM TRAFFIC CONTROL DEVICES (CA MUTCD), THE STATE OF CALIFORNIA DEPARTMENT OF TRANSPORTATION (CALTRANS) STANDARD PLANS AND SPECIFICATIONS DATED 2018, AND ALL ADDENDUMS THERETO, AND THE CITY OF RIVERSIDE PUBLIC WORKS DEPARTMENT STANDARD DRAWINGS, CURRENT EDITION.
- ALL STRIPING, MARKINGS, AND LEGENDS SHALL BE REFLECTORIZED THERMOPLASTIC UNLESS OTHERWISE NOTED. THE CONTRACTOR SHALL PROVIDE AND INSTALL RAISED PAVEMENT MARKERS FOR ALL STRIPING. STRIPING, MARKINGS AND LEGENDS SHALL CONFORM TO THE LATEST CALTRANS STANDARD PLANS A20A THRU A20D AND A24A THRU A24E.
- PRIOR TO FINAL ACCEPTANCE OF STREET IMPROVEMENTS, ALL PAVEMENT STRIPING AND STENCILING WITHIN THE PERIMETER OF THE CONSTRUCTION AREA SHALL BE RESTORED TO LIKE NEW CONDITION, IN A MANNER MEETING THE APPROVAL OF THE CITY OF RIVERSIDE.
- THE CONTRACTOR SHALL RE-STRIP EXISTING STRIPING AND CURB MARKINGS OBLITERATED BY NEW CONSTRUCTION, WHETHER OR NOT SHOWN ON THE PLANS FOR REPLACEMENT, AT NO COST TO THE CITY.
- AT LOCATIONS WHERE EXISTING PAINTED CURB IS TO BE RECONSTRUCTED, THE CONTRACTOR SHALL PAINT THE NEW CURB AS SHOWN ON THE PLANS WITHIN 10 WORKING DAYS OF CURB CONSTRUCTION OR AS DIRECTED BY ENGINEER. THE PAINT SHALL BE WATER-BASED WITH 2-YEAR GUARANTEE AGAINST COLOR FADING. PRIOR TO THE START OF CONSTRUCTION, THE CONTRACTOR SHALL SUBMIT TO THE CITY WRITTEN PROOF OF THE MANUFACTURER'S 2-YEAR GUARANTEE.
- ALL NEW STRIPING SHALL BE "CAT TRACKED" AND APPROVED BY THE ENGINEER PRIOR TO FINAL INSTALLATION. THE CONTRACTOR SHALL NOTIFY THE ENGINEER AFTER COMPLETING LAYOUT AND AT LEAST 3 WORKING DAYS BEFORE COMMENCING INSTALLATION OF STRIPING, MARKINGS AND MARKERS.
- TRAFFIC SIGN FACE SHALL BE 3M DIAMOND GRADE DG3 REFLECTIVE SHEETING (ASTM XI) OR APPROVED EQUAL WITH PROTECTIVE GRAFFITI OVERLAY FILM OR AS OTHERWISE NOTED. ALL WARNING SIGNS SHALL HAVE A FLUORESCENT YELLOW BACKGROUND AND SCHOOL SIGNS NOTED SHALL HAVE A FLUORESCENT YELLOW-GREEN BACKGROUND.
- SIGNS SHALL BE STANDARD SIZE UNLESS NOTED OTHERWISE. PRIOR TO INSTALLATION, NEW SIGNS SHALL BE APPROVED BY THE CITY OF RIVERSIDE. EXACT LOCATIONS OF SIGNS SHALL BE DETERMINED BY THE CITY ENGINEER.
- ALL EXISTING SIGNS AND POSTS TO BE REMOVED SHALL BE DELIVERED TO THE CITY OF RIVERSIDE SIGN DEPARTMENT.
- WHEN PAINT IS SPECIFIED, TRAFFIC STRIPES AND MARKINGS SHALL BE APPLIED IN TWO COATS. A MINIMUM OF SEVEN DAYS SHALL BE PROVIDED BETWEEN FIRST AND SECOND COATS.
- STRIPING SHALL BE APPLIED WITHIN 48 HOURS OF SURFACE COURSE REPLACEMENT ON STREETS OPEN TO THE PUBLIC. IN NO CASE SHALL A NEWLY PAVED STREET OPEN TO THE PUBLIC BE LEFT UNSTRIPED OVER A WEEKEND OR HOLIDAY.
- CONTRACTOR SHALL INSTALL NEW SIGN(S) AND/OR POST(S) PER CITY OF RIVERSIDE STANDARD DRAWING No. 664, SEE SPECIFICATIONS. CONTRACTOR SHALL INSTALL NEW STREET NAME SIGNS AND POST PER CITY OF RIVERSIDE STANDARD DRAWING No. 662, SEE SPECIFICATIONS.
- ALL CONFLICTING STRIPING, PAVEMENT MARKINGS, LEGENDS, AND RAISED PAVEMENT MARKERS SHALL BE REMOVED EVEN IF NOT SHOWN ON PLANS. REMOVALS OF PAINTED STRIPING, PAVEMENT MARKINGS AND LEGENDS SHALL BE DONE BY WET SANDBLASTING. REMOVALS OF THERMOPLASTIC STRIPING, PAVEMENT MARKINGS AND LEGENDS SHALL BE REMOVED BY WET SANDBLASTING, GRINDING OR OTHER APPROVED METHOD AND SHALL NOT DAMAGE THE PAVEMENT. "BLACK OUT" OF EXISTING DELINEATION IS NOT PERMITTED. ALL DAMAGED PAVEMENT DUE TO REMOVALS SHALL BE REPAIRED AS NECESSARY TO MAINTAIN A SMOOTH AND UNIFORM SURFACE OR AS DIRECTED BY THE ENGINEER. ALL STRIPING REMOVALS AND LEGENDS SHALL BE "FOG SEALED".
- WHERE APPLICABLE, OUTBOUND LANE LINE DETAILS SHALL COMMENCE AT THE CROSSWALK, MEANING THE PAINTED PORTION OF THE DETAIL SHALL JOIN THE CROSSWALK.

SIGNING AND STRIPING LEGEND AND CONSTRUCTION NOTES:

- E EXISTING TO REMAIN.
- # INSTALL CALTRANS STRIPING DETAIL PER NUMBER NOTED, INCLUDING INSTALLATION OF RAISED PAVEMENT MARKERS.
- PM INSTALL PAVEMENT MARKING OR ARROW AS NOTED.
- RP REMOVE ALL EXISTING CONFLICTING TRAFFIC STRIPING AND MARKINGS AS NOTED, INCLUDING RAISED PAVEMENT MARKERS.
- RC INSTALL RED CURB AS NOTED
- IS INSTALL/REMOVE SIGN LOCATION
- RS REMOVE SIGN AND POST AS NOTED
- RL RELOCATE SIGN AS NOTED
- o PROPOSED SIGN (ONE POST)
- o EXISTING SIGN (ONE POST)
- o EXISTING SIGN (ON STREET LIGHT)
- o EXISTING STREET NAME SIGN
- SNS STREET NAME SIGN
- 12' PROPOSED LANE WIDTH

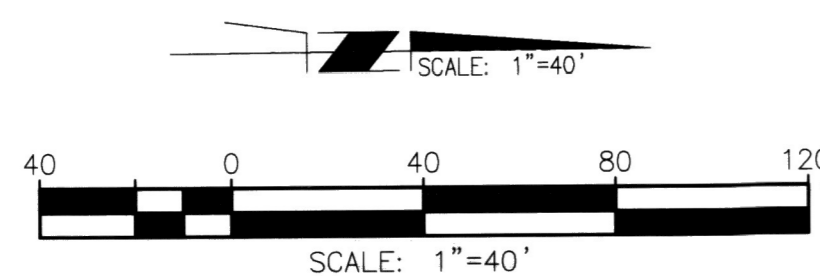

Under Ground Service Alert
of Southern California
Call: TOLL FREE 1-800-227-2600
TWO WORKING DAYS BEFORE YOU DIG

ENGINEER IN RESPONSIBLE CHARGE
NATHAN T. MUSTAFA
R.C.E. No. 83654 EXPIRES: 3-31-23
DATE: 5-13-24



MARK	REVISIONS	APPR.	DATE
DESIGNED BY	XXX	DRAWN BY	XXX
CHECKED BY	GMH		

CITY OF RIVERSIDE, CALIFORNIA DEPARTMENT OF PUBLIC WORKS			
APPROVED BY	BY	DATE	APPROVED BY
ENGINEERING MANAGER			
PRINCIPAL ENGINEER	S.L.	5-12-24	CITY ENGINEER
TRAFFIC DIVISION			
CONSTRUCTION ADMIN.	DC	5/12/24	DATE: MAY 13, 2024

SIGNING AND STRIPING PLAN
WOOD ROAD
MARIPOSA AVENUE TO
ALDERBROOK DRIVE
SCALE: 1" = 40'

XL-816
SHEET 1 OF 2
FILE NAME: XL-816.DWG

TURNBRIDGE LN

HEDGESTONE CT

ALDERBROOK DR

WOOD ROAD

KRAMERIA AVE

MATCHLINE SEE SHEET No. 1

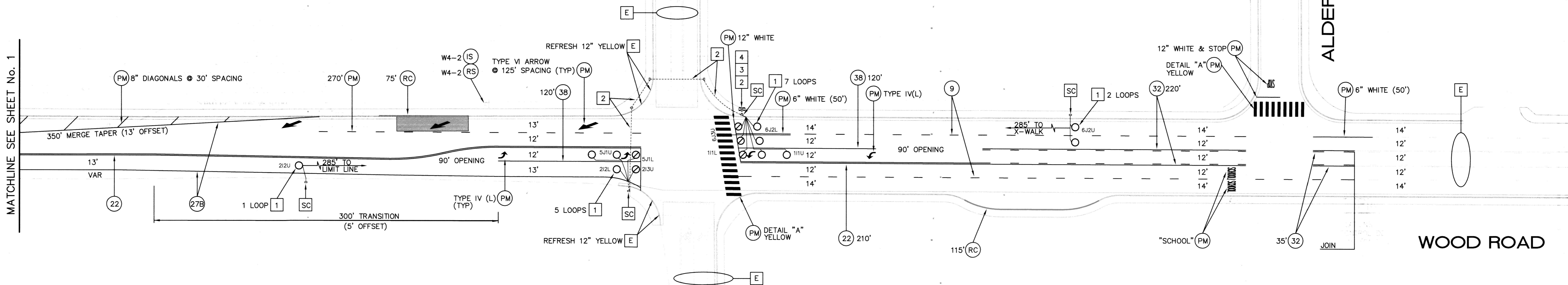

STRIPING/SIGNAGE QUANTITIES - XL-816

ITEM	DESCRIPTION	UNIT	SHEET 1	SHEET 2	SUBTOTAL
1	DETAIL 22	LF	2370	1470	3840
2	DETAIL 27B	LF	2510	780	3290
3	DETAIL 32	LF	0	1020	1020
4	DETAIL 38	LF	0	240	240
5	6" SOLID WHITE	LF	0	100	100
6	8" SOLID WHITE	LF	75	45	120
7	12" SOLID WHITE	LF	95	95	190
8	12" SOLID YELLOW	LF	0	225	225
9	PAVEMENT LEGENDS/MARKINGS - WHITE	LF	141	278	419
10	PAVEMENT LEGENDS CROSSWALK - YELLOW	SF	0	552	552
11	RED CURB	LF	0	190	190
12	ROADSIDE SIGN - ONE POST	EA	2	0	2
13	ROADSIDE SIGN - NO POST	EA	0	1	1
14	REMOVE SIGN - ONE POST	EA	2	0	2
15	REMOVE SIGN - NO POST	EA	0	1	1

LOOP, DLC, AND SPLICE QUANTITIES - THIS SHEET

ITEM	DESCRIPTION	UNIT	SUBTOTAL
1	TYPE "E" LOOP DETECTOR	EA	10
2	TYPE "D" LOOP DETECTOR	EA	5
3	DLC - DETECTOR LOOP CABLE	LF	425
4	SC - SPLICE NEW TO EXISTING	EA	4
5	2-CHANNEL DETECTOR CARD	EA	2

CONSTRUCTION NOTES (THIS SHEET):

- [SC] SPLICE NEW TO EXISTING CONDUCTORS
- [1] CONTRACTOR SHALL INSTALL LOOP DETECTOR AS NOTED.
- [2] CONTRACTOR SHALL INSTALL TWO NEW DLCs FOR 5J1L AND 2I3U
- [3] CONTRACTOR SHALL INSTALL TWO NEW DLCs FOR 111L AND 6J3U
- [4] CONTRACTOR SHALL INSTALL 2-CHANNEL DETECTOR CARD (2 EACH)

SIGNING AND STRIPING LEGEND AND CONSTRUCTION NOTES:

- [E] EXISTING TO REMAIN.
- [#] INSTALL CALTRANS STRIPING DETAIL PER NUMBER NOTED, INCLUDING INSTALLATION OF RAISED PAVEMENT MARKERS.
- [PM] INSTALL PAVEMENT MARKING OR ARROW AS NOTED.
- [RP] REMOVE ALL EXISTING CONFLICTING TRAFFIC STRIPING AND MARKINGS AS NOTED, INCLUDING RAISED PAVEMENT MARKERS.
- [RC] INSTALL RED CURB AS NOTED
- [IS] INSTALL/REMOVE SIGN LOCATION
- [RS] REMOVE SIGN AND POST AS NOTED
- [RL] RELOCATE SIGN AS NOTED
- [#] PROPOSED SIGN (ONE POST)
- [#] EXISTING SIGN (ONE POST)
- [#] EXISTING SIGN (ON STREET LIGHT)
- [#] EXISTING STREET NAME SIGN
- [SNS] STREET NAME SIGN
- [12'] PROPOSED WIDTH

TYPICAL LOOP DETECTOR LAYOUT

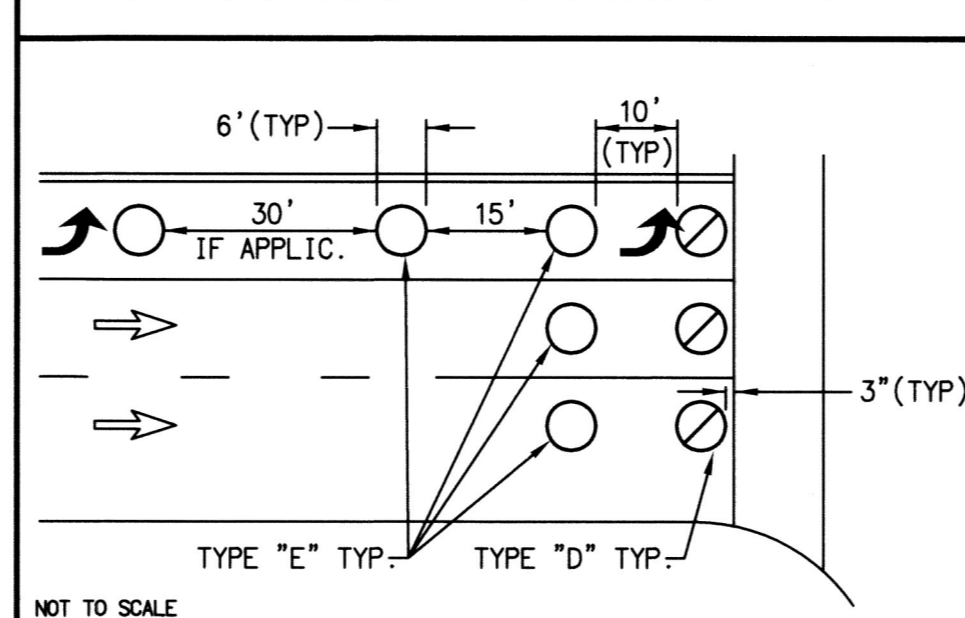

CONTINENTAL CROSSWALK LAYOUT - DETAIL "A"

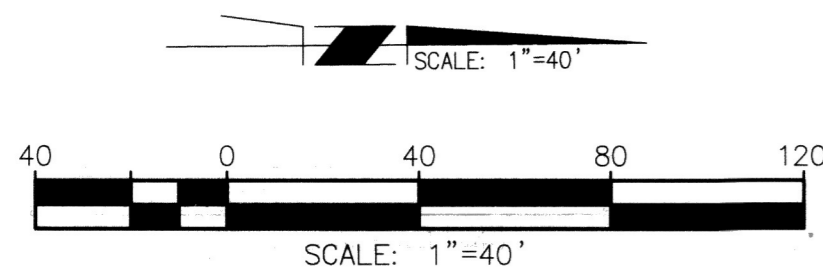
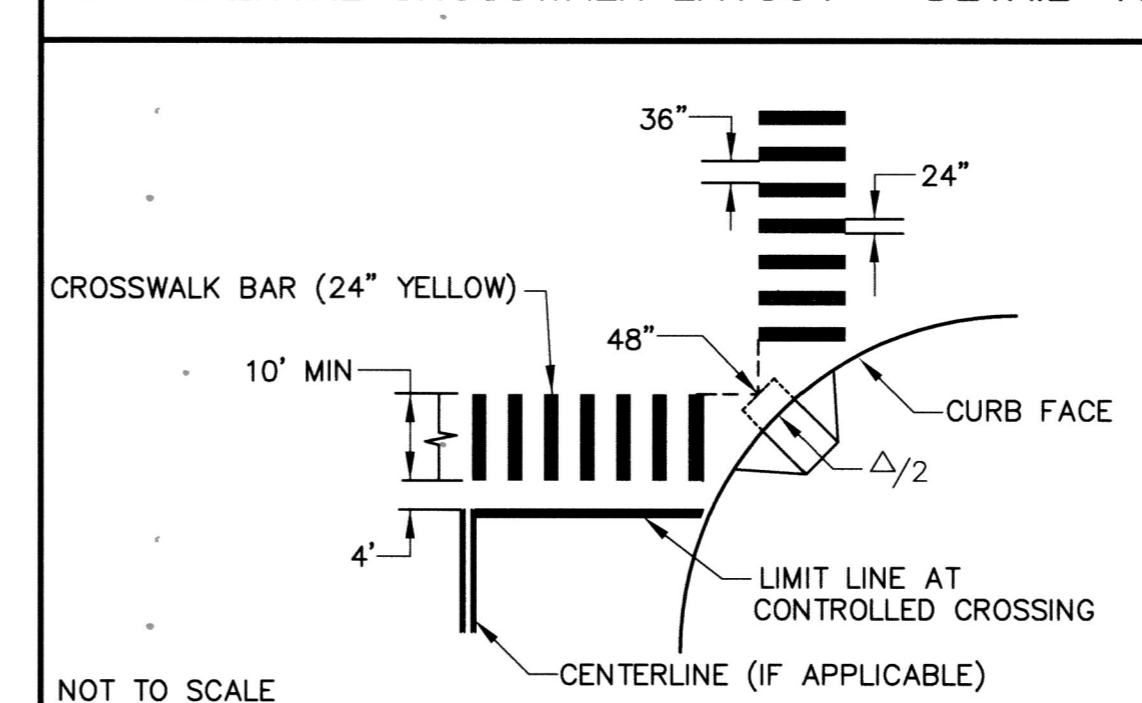

Under Ground Service Alert of Southern California
Call: TOLL FREE 1-800-227-2600
TWO WORKING DAYS BEFORE YOU DIG



ENGINEER IN RESPONSIBLE CHARGE
NATHAN T. MUSTAFA
R.C.E. No. 83654 EXPIRES: 3-31-23
DATE: 5-12-22



MARK	REVISIONS	APPR.	DATE

CITY OF RIVERSIDE, CALIFORNIA
DEPARTMENT OF PUBLIC WORKS

APPROVED BY	BY	DATE	APPROVED BY
ENGINEERING MANAGER	E.L.	5-12-22	CITY ENGINEER
PRINCIPAL ENGINEER			
TRAFFIC DIVISION			
CONSTRUCTION ADMIN.	DL	5/12/22	DATE: MAY 13, 2022

SIGNING AND STRIPING PLAN
WOOD ROAD
MARIPOSA AVENUE TO
ALDERBROOK DRIVE
SCALE: 1" = 40'

XL-816
SHEET 2 OF 2
FILE NAME: XL-816.DWG