

SIGNING AND STRIPING GENERAL NOTES:

- SIGNING AND STRIPING INSTALLATIONS SHALL CONFORM TO THE 2014 CALIFORNIA MANUAL ON UNIFORM TRAFFIC CONTROL DEVICES (CA MUTCD), THE STATE OF CALIFORNIA DEPARTMENT OF TRANSPORTATION (CALTRANS) STANDARD PLANS AND SPECIFICATIONS DATED 2015, AND ALL ADDENDUMS THERETO, AND THE CITY OF RIVERSIDE PUBLIC WORKS DEPARTMENT STANDARD DRAWINGS, CURRENT EDITION.
- ALL STRIPING, MARKINGS, AND LEGENDS SHALL BE REFLECTORIZED THERMOPLASTIC UNLESS OTHERWISE NOTED. THE CONTRACTOR SHALL PROVIDE AND INSTALL RAISED PAVEMENT MARKERS FOR ALL STRIPING. STRIPING, MARKINGS AND LEGENDS SHALL CONFORM TO THE LATEST CALTRANS STANDARD PLANS A20A THRU A20D AND A24A THRU A24E.
- PRIOR TO FINAL ACCEPTANCE OF STREET IMPROVEMENTS, ALL PAVEMENT STRIPING AND STENCILING WITHIN THE PERIMETER OF THE CONSTRUCTION AREA SHALL BE RESTORED TO LIKE NEW CONDITION, IN A MANNER MEETING THE APPROVAL OF THE CITY OF RIVERSIDE.
- THE CONTRACTOR SHALL RE-STRIPE EXISTING STRIPING AND CURB MARKINGS OBLITERATED BY NEW CONSTRUCTION, WHETHER OR NOT SHOWN ON THE PLANS FOR REPLACEMENT, AT NO COST TO THE CITY.
- AT LOCATIONS WHERE EXISTING PAINTED CURB IS TO BE RECONSTRUCTED, THE CONTRACTOR SHALL PAINT THE NEW CURB AS SHOWN ON THE PLANS WITHIN 10 WORKING DAYS OF CURB CONSTRUCTION OR AS DIRECTED BY ENGINEER. THE PAINT SHALL BE WATER-BASED WITH 2-YEAR GUARANTEE AGAINST COLOR FADING. PRIOR TO THE START OF CONSTRUCTION, THE CONTRACTOR SHALL SUBMIT TO THE CITY WRITTEN PROOF OF THE MANUFACTURER'S 2-YEAR GUARANTEE.
- ALL NEW STRIPING SHALL BE "CAT TRACKED" AND APPROVED BY THE ENGINEER PRIOR TO FINAL INSTALLATION. THE CONTRACTOR SHALL NOTIFY THE ENGINEER AFTER COMPLETING LAYOUT AND AT LEAST 3 WORKING DAYS BEFORE COMMENCING INSTALLATION OF STRIPING, MARKINGS AND MARKERS.
- TRAFFIC SIGN FACE SHALL BE 3M DIAMOND GRADE (DG3) REFLECTIVE SHEETING (ASTM XI) OR APPROVED EQUAL WITH PROTECTIVE GRAFFITI OVERLAY FILM OR AS OTHERWISE NOTED. ALL WARNING SIGNS SHALL HAVE A FLUORESCENT YELLOW BACKGROUND AND SCHOOL SIGNS NOTED SHALL HAVE A FLUORESCENT YELLOW-GREEN BACKGROUND.
- SIGNS SHALL BE STANDARD SIZE UNLESS NOTED OTHERWISE. PRIOR TO INSTALLATION, NEW SIGNS SHALL BE APPROVED BY THE CITY OF RIVERSIDE. EXACT LOCATIONS OF SIGNS SHALL BE DETERMINED BY THE CITY ENGINEER.
- ALL EXISTING SIGNS AND POSTS TO BE REMOVED SHALL BE DELIVERED TO THE CITY OF RIVERSIDE SIGN DEPARTMENT.
- WHEN PAINT IS SPECIFIED, TRAFFIC STRIPES AND MARKINGS SHALL BE APPLIED IN TWO COATS. A MINIMUM OF SEVEN DAYS SHALL BE PROVIDED BETWEEN FIRST AND SECOND COATS.
- STRIPING SHALL BE APPLIED WITHIN 48 HOURS OF SURFACE COURSE REPLACEMENT ON STREETS OPEN TO THE PUBLIC. IN NO CASE SHALL A NEWLY PAVED STREET OPEN TO THE PUBLIC BE LEFT UNSTRIPED OVER A WEEKEND OR HOLIDAY.
- CONTRACTOR SHALL INSTALL NEW SIGN(S) AND/OR POST(S) PER CITY OF RIVERSIDE STANDARD DRAWING No. 664; SEE SPECIFICATIONS. CONTRACTOR SHALL INSTALL NEW STREET NAME SIGNS AND POST PER CITY OF RIVERSIDE STANDARD DRAWING No. 662. SEE SPECIFICATIONS.
- ALL CONFLICTING STRIPING, PAVEMENT MARKINGS, LEGENDS, AND RAISED PAVEMENT MARKERS SHALL BE REMOVED EVEN IF NOT SHOWN ON PLANS. REMOVALS OF PAINTED STRIPING, PAVEMENT MARKINGS AND LEGENDS SHALL BE DONE BY WET SANDBLASTING; REMOVALS OF THERMOPLASTIC STRIPING, PAVEMENT MARKINGS AND LEGENDS SHALL BE REMOVED BY WET SANDBLASTING, GRINDING OR OTHER APPROVED METHOD AND SHALL NOT DAMAGE THE PAVEMENT. "BLACK OUT" OF EXISTING DELINEATION IS NOT PERMITTED. ALL DAMAGED PAVEMENT DUE TO REMOVALS SHALL BE REPAIRED AS NECESSARY TO MAINTAIN A SMOOTH AND UNIFORM SURFACE OR AS DIRECTED BY THE ENGINEER. ALL STRIPING REMOVALS AND LEGENDS SHALL BE "FOG SEALED".
- WHERE APPLICABLE, OUTBOUND LANE LINE DETAILS SHALL COMMENCE AT THE CROSSWALK, MEANING THE PAINTED PORTION OF THE DETAIL SHALL JOIN THE CROSSWALK.

SIGNING AND STRIPING LEGEND AND CONSTRUCTION NOTES:

- [E] EXISTING TO REMAIN.
- # INSTALL CALTRANS STRIPING DETAIL PER NUMBER NOTED, INCLUDING INSTALLATION OF RAISED PAVEMENT MARKERS.
- (PM) INSTALL PAVEMENT MARKING OR ARROW AS NOTED.
- (RP) REMOVE ALL EXISTING CONFLICTING TRAFFIC STRIPING AND MARKINGS AS NOTED, INCLUDING RAISED PAVEMENT MARKERS.
- (1-1) SIGN LOCATION
- (IS) FURNISH AND INSTALL ROADSIDE SIGN(S) OR SNS WITH/WITHOUT POST DETAIL AS NOTED.
- (RS) REMOVE SIGN(S)
- (RL) RELOCATE EXISTING SIGN(S) TO EXISTING POST OR INSTALL POST (IF APPLICABLE)
- (S) EXISTING SIGNALIZED INTERSECTION
- PROPOSED SIGN (ONE POST)
- EXISTING SIGN (ONE POST)
- EXISTING SIGN (ON STREET LIGHT)
- EXISTING STREET NAME SIGN
- SNS STREET NAME SIGN
- (12') EXISTING WIDTH
- 12' PROPOSED WIDTH
- △ ANGLE POINT

SIGN QUANTITIES - THIS SHEET

SIGN NUMBER	SIGN CODE	PANEL SIZE (IN)	INSTALL ROADSIDE SIGN(S)			INSTALL STREET NAME SIGN		RELOCATE ROADSIDE SIGN(S)		REMOVE SIGN(S)
			NO POST	ONE POST	TWO POST	NO POST	ONE POST	NO POST	ONE POST	
1-1	R5-1	36X36								
	R5-1a	36X24								
1-2	R5-1	36X36								
	R5-1a	36X24							1	
1-3	R1-1	30X30	1							
	R1-1	-								1
	SNS	-								
	R1-1	3X30		1						
	SNS	9"				1				
GRAND TOTAL:				1		1		2	1	

SEE CITY OF RIVERSIDE STD DWG NO. 664 FOR ROADSIDE SIGNS
 SEE CITY OF RIVERSIDE STD DWG NO. 662 FOR STREET NAME SIGNS
 SNS = STREET NAME SIGN
 * = THE SIZE SHALL MATCH THE EXISTING

STREET NAME SIGN DETAILS - THIS SHEET

ITEM	INTERSECTION	PANEL #1	PANEL #2
1	KANSAS AVE AT LINDEN ST	Kansas Ave 3500	Linden St 2000

STRIPING/SIGNAGE QUANTITIES - THIS SHEET

ITEM	DESCRIPTION	QUANTITY	UNIT
1	12" SOLID WHITE	10	LF
2	12" SOLID YELLOW	230	LF
3	PAVEMENT LEGENDS/MARKINGS	120	SF
4	4" LANE LINE STRIPING REMOVALS	30	LF
5	12" SOLID STRIPING REMOVALS	105	LF
6	PAVEMENT LEGENDS REMOVALS	22	SF

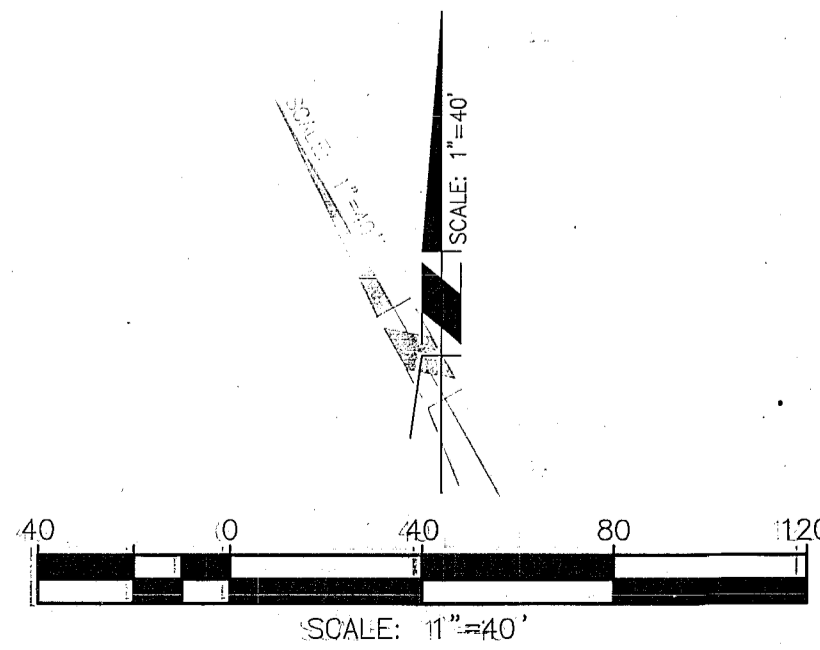
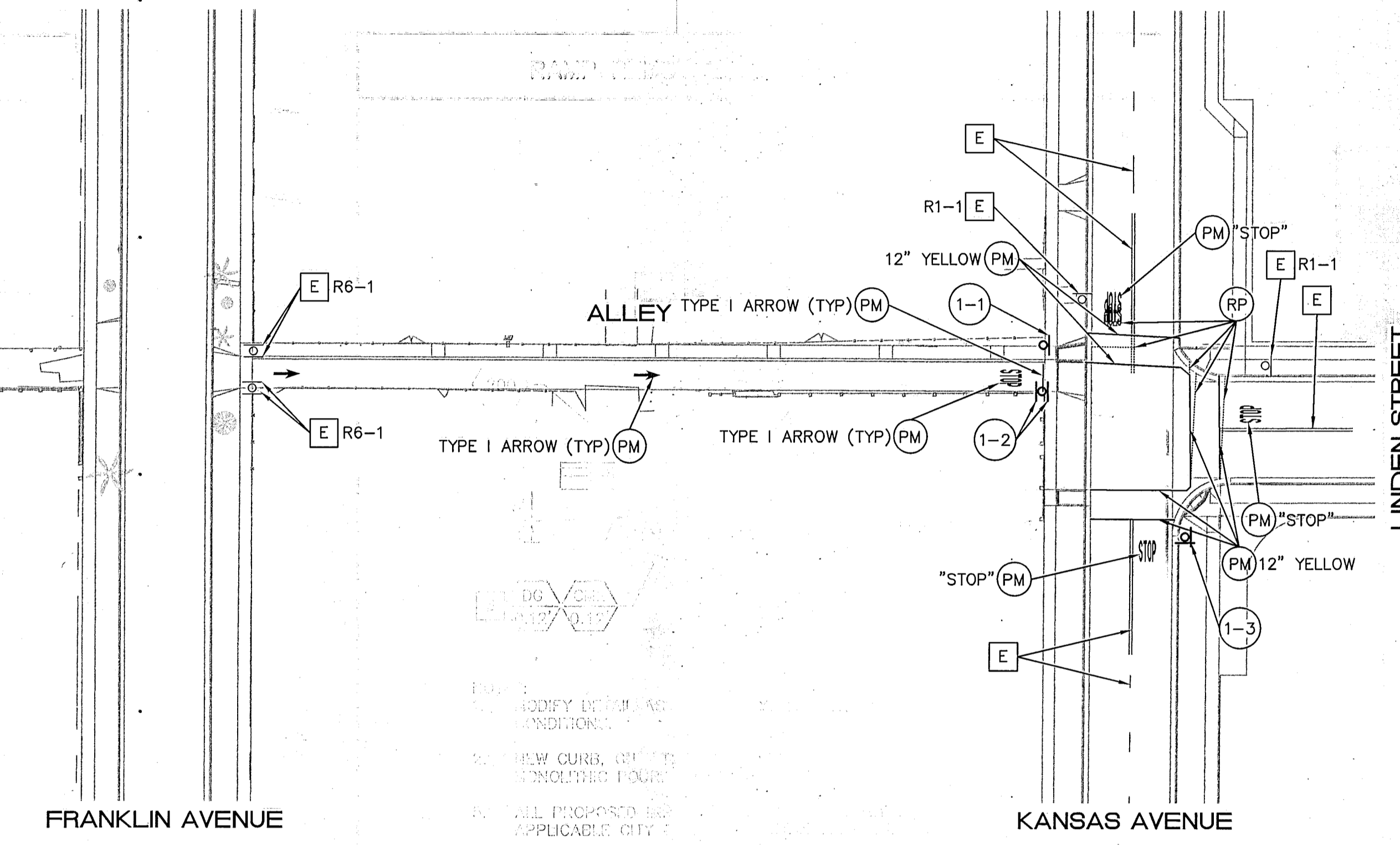
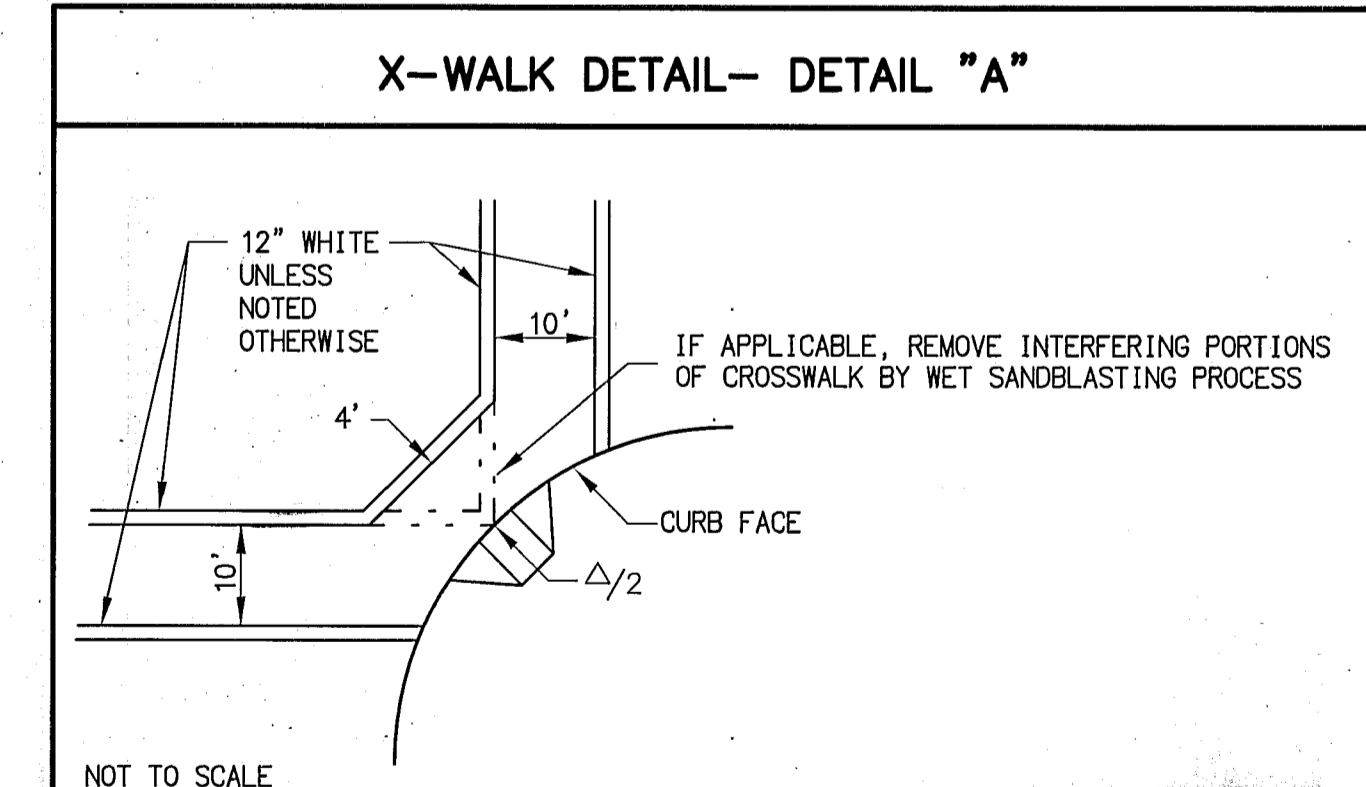

Under Ground Service Alert of Southern California
 Call: TOLL FREE 1-800-227-2600
 TWO WORKING DAYS BEFORE YOU DIG

ENGINEER IN RESPONSIBLE CHARGE
 GILBERT M. HERNANDEZ
 R.C.E. No. 69170, EXPIRES 6-30-18
 DATE: 3-6-18

DESIGNED BY: MAB
 DRAWN BY: MAB
 CHECKED BY: CMH

CITY OF RIVERSIDE, CALIFORNIA
 DEPARTMENT OF PUBLIC WORKS

APPROVED BY: [Signature]
 ENGINEERING MANAGER: Em 3/8/18
 PRINCIPAL ENGINEER: [Signature]
 TRAFFIC DIVISION: [Signature] 3/12/18
 CONSTRUCTION ADMIN. [Signature]
 PUBLIC UTILITIES: [Signature]

SIGNING AND STRIPING PLAN
 KANSAS AVENUE AND LINDEN STREET
 SCALE: 1" = 40'

XL-771
 SHEET 1 OF 1
 FILE NAME: XL-771.DWG