

CONDUCTOR TABLE

CONTROL FUNCTION	CONDUCTORS	CONDUCTOR RUNS									
		1	2	3	4	5	6	7	8	9	10
VEHICLE & PEDESTRIAN HEADS, PEDESTRIAN PUSH BUTTONS, SPARES & COMMONS	12 WIRE IMSA 9 WIRE IMSA 5 WIRE IMSA 3 WIRE IMSA	1	2	3	4	5	6	7	8	9	10
DETECTOR CABLE	#16/2	1	1	1	1	1					
PHASE 1						1					
PHASE 2						2					
PHASE 3											
PHASE 4						1	1	1			
PHASE 5											
PHASE 6		2	2	2	2	2					
PHASE 7											
PHASE 8						2	2	2	2	2	
I.I.S.N.S.	#12	2	2	2	2	2	2	2	2	2	2
LUMINAIRES	#8	2	2	2	2	2	2	2	2	2	2
SIGNAL SERVICE	#6	2	2	2	2						

CONDUIT SIZE	2"	2"	2"	2"	2-3"	2"	2"	2"	2"	1.5"
	(E)	(E)	(E)	(E)	(N)	(E)	(E)	(E)	(E)	(E)

- NOTE:
- SIGNAL SYSTEM SHALL HAVE NEW CABLES AND CONDUCTORS; SEE CONTRACT SPECIAL PROVISIONS FOR ADDITIONAL INFORMATION ON I.M.S.A. CABLE.
 - CABLES FOR 11U, 212U, 212L, 5J1U, 6J2U AND 6J2L SHALL BE REUSED.

POLE SCHEDULE

No.	TYPE	STANDARD		LUM. HPSV	I.I.S.N.S. LECEND	SIGNAL HEAD	SIGNAL MOUNTING		PPB PHASE	REMARKS
		HGT	SIG. M.A.				VEHICLE	PED		
(A)	TYPE 19	30'	30'	10'	200W	1W3C(PV) 1W3C(12") 1W3C(8")	MAS MAS SV-1-T	SP-1-T	4	ROTATE PED. SIGNAL AS INDICATED.
(B)	1A	10'				1W3C(N)	TV-1-T(N)	SP-1-T	6	ROTATE PED. SIGNAL AS INDICATED.
(C)	68J10	30'		10'	200W	1W3C(N)	SV-1-T(N)	SP-1-T	6	ROTATE PED. SIGNAL AS INDICATED.
(D)	1A	10'				1W3C(N)	TV-1-T(N)	SP-1-T	8	ROTATE PED. SIGNAL AS INDICATED.
(E)	26-4-80(N)	30'	40'(N)	12'(N)	200W(R)	1W3C(N) 1W3C(R) 1W3C(N)	MAS(N) MAS(R) SV-1-T(N)	SP-1-T(R)	8(N)	RELOCATE EQUIP. TO NEW POLE AS INDICATED. REMOVE AND SALVAGE ALL OTHER EQUIPMENT.
(F)	TYPE 1	10'				1W3C(8")	TV-1-T	SP-1-T	2	ROTATE PED. SIGNAL AS INDICATED.
(G)	68J10	30'	18'(*)	10'	200W	1W3C(N) 1W3C(8")	MAS(N) SV-1-T	SP-1-T	2	18" SIGNAL MAST ARM SHALL BE CITY FURNISHED. ROTATE PED. SIGNAL AS INDICATED.
(H)	TYPE 1	10'				1W3C(12")	TV-1-T	SP-1-T	4	ROTATE PED. SIGNAL AS INDICATED.

- NEW VEHICULAR HEADS SHALL HAVE ALL 12" LENSES.
 - NEW LEFT-TURN HEADS SHALL HAVE ALL ARROWS.
 - EQUIPMENT NOT TO BE REUSED SHALL BE SALVAGED.
 - (N) = NEW, AND (R) = RELOCATED. ALL OTHER EQUIPMENT, UNLESS OTHERWISE INDICATED, EXISTS AND SHALL REMAIN IN PLACE.
- * 18" MASTARM WILL BE CITY FURNISHED.

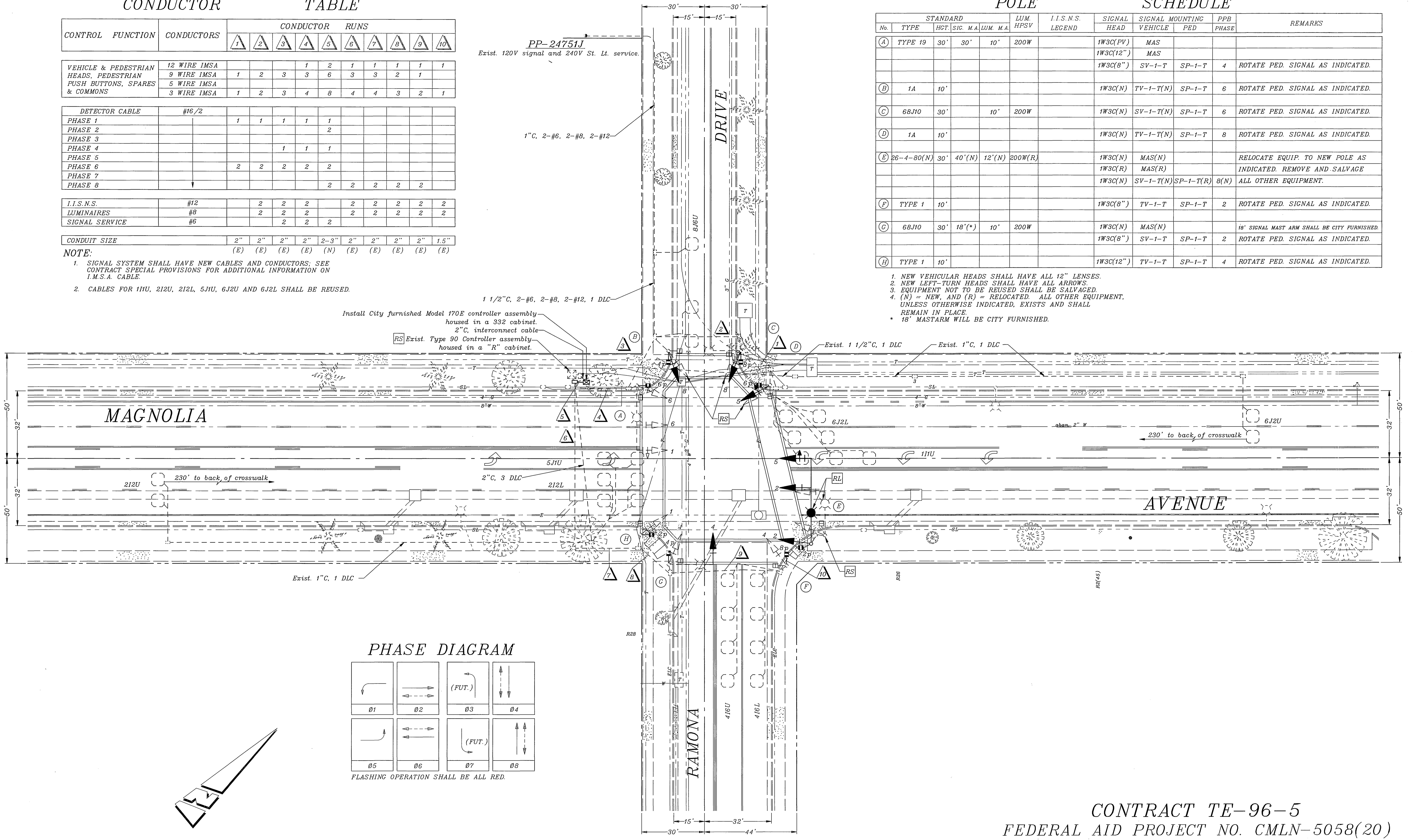

PHASE DIAGRAM

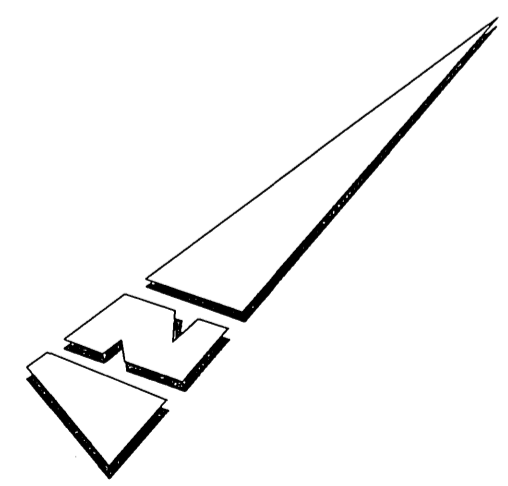
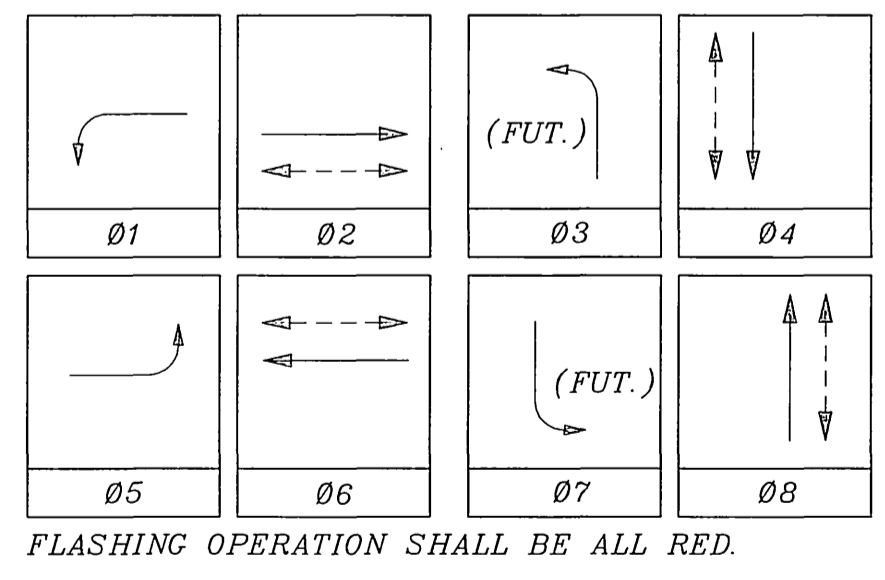

IMPORTANT NOTICE
 Section 4216/4217 of the Government Code requires a Dig Alert Identification Number to be issued before a "Horn to Excavate" will be valid. For your Dig Alert I.D. Number call CALL TOLL FREE TWO WORKING DAYS BEFORE YOU DIG UNDERGROUND SERVICE ALERT 1-800-227-2600

ENGINEER IN RESPONSIBLE CHARGE
 RICHARD D. McGRATH
 R.C.E. No. 31952 expires 12-31-96
 DATE 5-20-96



MARK	REVISIONS	APPR	DATE

CITY OF RIVERSIDE, CALIFORNIA
 DEPARTMENT OF PUBLIC WORKS
 APPROVED BY: [Signature]
 PRINCIPAL ENGINEER: [Signature]
 P.W. INSPECTION: [Signature]
 TRAFFIC DIVISION: [Signature]
 CHIEF P.W. ENGR: [Signature]
 PUBLIC UTILITIES: [Signature]

TRAFFIC SIGNAL MODIFICATION
MAGNOLIA AVENUE @ RAMONA DRIVE

ACCT. NO. 0230-541600-440223-35045
X-202
 SHEET 1 OF 1
 FILE NAME: X202.DWG

CONTRACT TE-96-5
 FEDERAL AID PROJECT NO. CMLN-5058(20)
 CONTRACTOR'S LICENSE REQUIREMENTS "A" OR "C-10"

SCALE: 1" = 20'

Conductor Schedule

Control Function	Conductors Size Insulations	Conduit Runs									
		1	2	3	4	5	6	7	8	9	10
Vehicle Heads	#14 T.W.	3						3	3	3	3
ΦA1		6	3	3	3	3	3				
ΦA2		6	3	3	3	3					
ΦA3		6	3	3	3						
ΦB1 (Future)											
ΦB2		6	3	3		3					
Pedestrian Heads								2	2	2	
ΦA1W		2						2	2	2	
ΦA2W		2	2	2	2	2					
ΦA3W		4	2	2	2	2	2	2	2	2	2
Ped. Push Button											
ΦA3		4	2	2	1	1	1	2	1	1	1
Spares		3	3	3	3	3	3	3	3	3	3
Detector Cable	#12 P.E.										
ΦA3		3	2	2	2	2		1	1		
ΦB2		1						1	1	1	1
12V Common	#12 T.W.	1	1	1	1	1	1	1	1	1	1
120V Common	#10	1	1	1	1	1	1	1	1	1	1
Signal Service	#8	2						2	2		
Luminaires	T.H.W.	2	2	2	2	2	2				
Totals	#14 T.W.	36	18	18	14	14	9	21	14	14	9
	#12 P.E.	4	2	2	2	2		2	2	1	1
	#12 T.W.	1	1	1	1	1	1	1	1	1	1
	#10	1	1	1	1	1	1	1	1	1	1
	#8	2						2	2		
Conduit size	T.H.W.	3"	2"	2"	2"	2"	2"	1 1/2"	2"	2"	2"

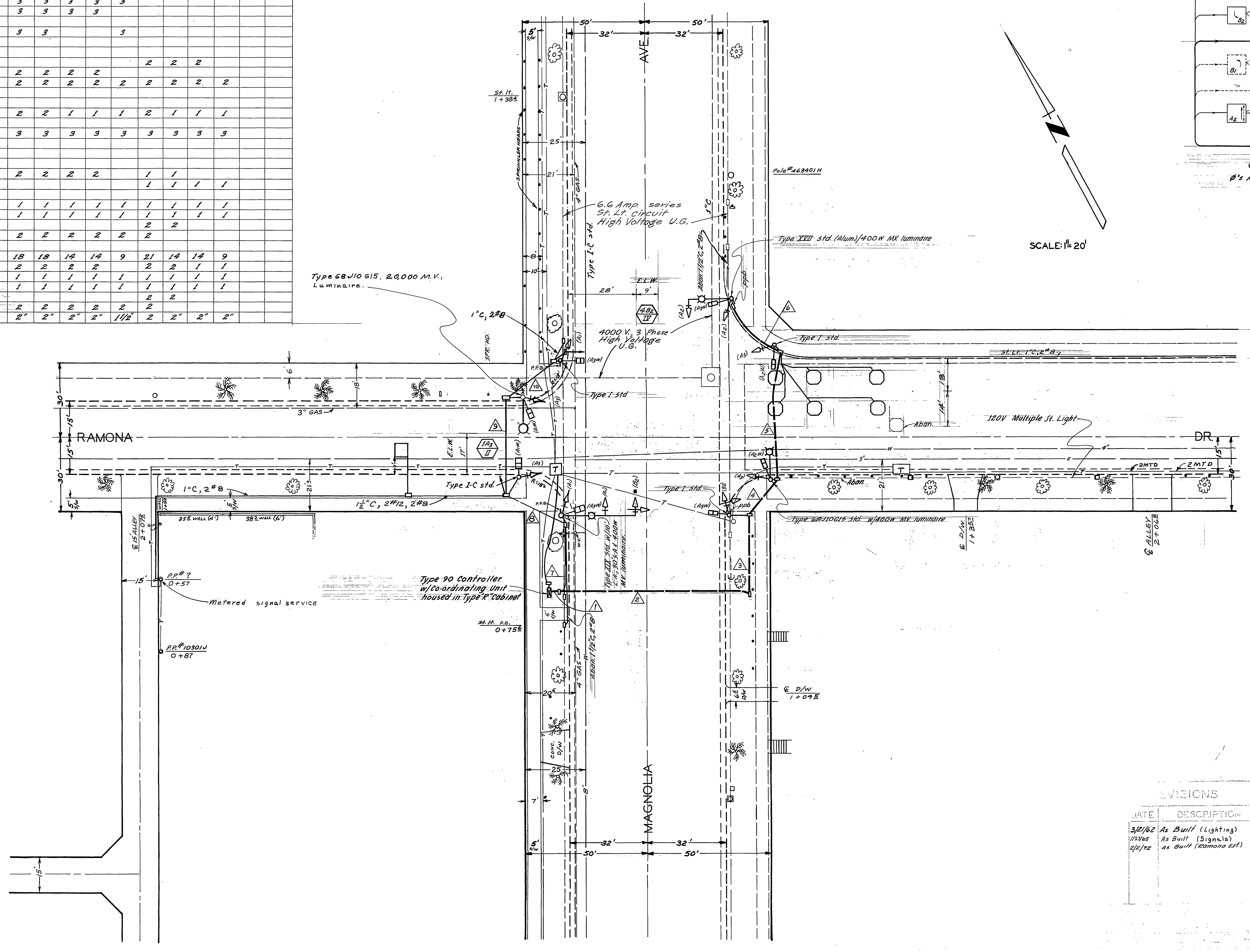
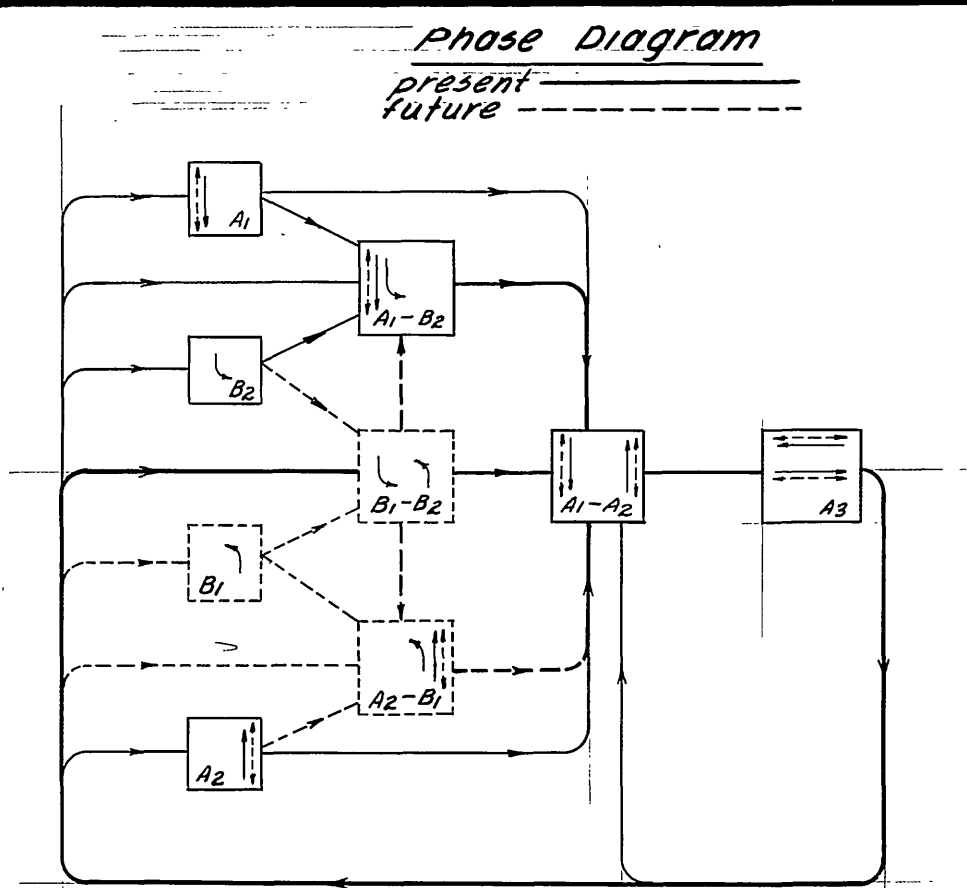

SCALE: 1" = 20'

REVISIONS		CITY OF RIVERSIDE DEPARTMENT OF PUBLIC WORKS
DATE	DESCRIPTION	
3/21/62	As Built (Lighting)	ADD
1/24/65	As Built (Signals)	RAD
2/6/72	As Built (Ramona Ext.)	JMW

TRAFFIC SIGNALS

MAGNOLIA AVE.
&
RAMONA DR.