

- ### GENERAL NOTES
- DETECTOR LOOPS SHALL BE INSTALLED IN THE PRESENCE OF THE TRAFFIC ENGINEER OR HIS REPRESENTATIVE.
 - ALL PAVEMENT DELINEATION REQUIREMENTS SHALL BE COMPLETED AT LEAST ONE DAY PRIOR TO TURN ON.
 - TYPICAL DETECTOR LOOP SPACING: 10' AND 15' (WHERE APPLICABLE).
- RS — REMOVE AND SALVAGE
 - AB — ABANDON EXISTING CONDUIT
 - 1 — MODEL 170E/332 TRAFFIC SIGNAL CONTROLLER ASSEMBLY.

DETAIL "A"
NO SCALE

- ### PAVEMENT DELINEATION
- INDICATES STRIPING AND PAVEMENT MARKINGS TO BE INSTALLED.
 - INDICATES STRIPING AND PAVEMENT MARKINGS TO REMAIN.
 - INDICATES STRIPING AND PAVEMENT MARKINGS TO BE REMOVED.
- NOTE: ALL STRIPING ON THIS PLAN FOR REFERENCE ONLY. SEE PLAN XD-018 FOR PAVEMENT DELINEATIONS.

EQUIPMENT SCHEDULE

NO.	SIGNAL STANDARD	LUMINAIRE	SIGNAL MOUNTINGS	PPB				
	TYPE	H'GHT	M.A.	L.A.	H.P.S.V.	VEHICLE	PEDESTRIAN	
1	1A	10'				TV-1-T(N)	SP-2-T	1
2	88J10	30'	12'	200W			SP-1-T	1
3	1A	7'				TP-1-T		1
4	66J12	30'	12'	200W			SP-1-T	1
5	24-4-80(N)	30'	36"(N) 12"(N)	250W(N)		2-MAS(N)	SP-2-T(N)	6, 8
6	28-4-80	30'	46'	12'	200W	MAS	SP-1-T	1
7	1A	10'				TV-1-T	SP-1-T	1
8	24-4-80(N)	30'	36"(N) 12"(N)	250W(N)		SV-1-T(N)	SP-1-T(N)	2
9	1A	10'				TV-1-T	SP-1-T	1
10	24-4-80	30'	35'	12'	200W	MAS	SP-1-T(N)	1
11	27-4-80(N)	17'	40"(N)			2-MAS(N)	SP-1-T(N)	
12	17-2-80	30'	20'	12'	200W	MAS(RS)	SP-1-T	1
13	1A	10'				TV-2-T		
14	1A	10'				TV-1-T		
15	1A	7'				TP-1-T		1
16	TYPE II	17'	18'			MAS	SP-2-T	1
17	66D8	30'	8'	200W		SV-1-T	SP-2-T	2
18	TYPE II	17'	18'			MAS	SP-1-T	1
19	1A	7'				LP-2-T		

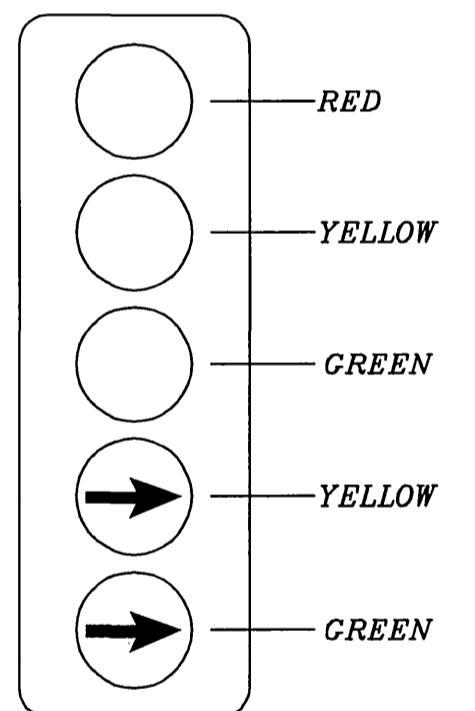

DETAIL "B"

PHASE DIAGRAM

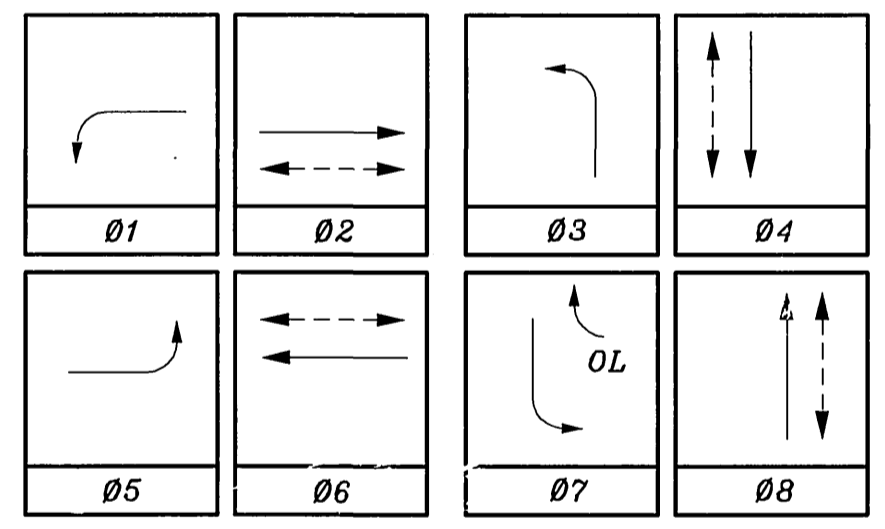

CONDUCTOR SCHEDULE

CONTROL FUNCTION	CONDUCTORS	CONDUCTOR RUNS																														
		1	2	3	4a	4	5	6	7	8	9	10	11	12	13	14	15	16	17	18	19	20	21	22	23	24	25	26	27	28		
VEHICLE & PEDESTRIAN HEADS, PEDESTRIAN PUSH BUTTONS, SPARES & COMMONS	12 WIRE IMSA 9 WIRE IMSA 5 WIRE IMSA 3 WIRE IMSA	-	-	-	-	1	1	1	-	2	4	1	-	-	-	-	1	-	-	-	1	1	-	-	1	1	-	-	1	1	-	-
DETECTOR CABLE	#16/2	-	-	-	-	-	-	-	-	-	-	-	-	-	-	-	-	-	-	-	-	-	-	-	-	-	-	-	-	-	-	
PHASE 1		-	-	-	-	1	-	-	-	-	-	-	-	-	-	-	-	-	-	-	-	-	-	-	-	-	-	-	-	-	-	
PHASE 2		-	-	-	-	-	-	-	-	2	2	2	-	-	-	-	-	-	-	-	-	-	-	-	-	-	-	-	-	-	-	
PHASE 3		-	-	-	-	-	-	-	-	-	-	-	-	-	-	-	-	-	-	-	-	-	-	-	-	-	-	-	-	-	-	
PHASE 4		-	-	-	-	-	-	-	-	-	-	-	-	-	-	-	-	-	-	-	-	-	-	-	-	-	-	-	-	-	-	
PHASE 5		-	-	-	-	-	-	-	-	-	-	-	-	-	-	-	-	-	-	-	-	-	-	-	-	-	-	-	-	-	-	
PHASE 6		-	-	-	-	-	-	-	-	-	-	-	-	-	-	-	-	-	-	-	-	-	-	-	-	-	-	-	-	-	-	
PHASE 7		-	-	-	-	-	-	-	-	-	-	-	-	-	-	-	-	-	-	-	-	-	-	-	-	-	-	-	-	-	-	
PHASE 8		-	-	-	-	-	-	-	-	-	-	-	-	-	-	-	-	-	-	-	-	-	-	-	-	-	-	-	-	-	-	
INTERCONNECT CABLE	#19	-	-	-	-	-	-	-	-	-	-	-	-	-	-	-	-	-	-	-	-	-	-	-	-	-	-	-	-	-	-	
L.I.S.N.S.	#12	-	-	-	-	-	-	-	-	-	-	-	-	-	-	-	-	-	-	-	-	-	-	-	-	-	-	-	-	-	-	
LUMINAIRES	#8	2	2	2	2	-	-	-	-	-	-	-	-	-	-	-	-	-	-	-	-	-	-	-	-	-	-	-	-	-	-	
SIGNAL SERVICE	#6	-	-	-	-	-	-	-	-	-	-	-	-	-	-	-	-	-	-	-	-	-	-	-	-	-	-	-	-	-	-	
CONDUIT SIZE		1.5"	2"	2"	1.5"	1.5"	2"	3"	3"	3"	2-3"	1.5"	1.5"	2.5"	1.5"	2"	2"	2.5"	2.5"	2.5"	1.5"	1.5"	2.5"	2"	1.5"	2"	1.5"	1.5"	3"	1.5"		

1. SYSTEM SHALL HAVE ALL NEW CABLES AND CONNECTORS.

NOTE: TRAFFIC SIGNAL POLES AND ARMS ARE CITY FURNISHED. CONTRACTOR SHALL FURNISH ALL OTHER EQUIPMENT AND APURTENANCES. CONTRACTOR SHALL CONTACT SIGNAL MAINTENANCE FOR ANCHOR BOLT AND BASE INFORMATION.

IMPORTANT NOTICE
Section 4216/4217 of the Government Code requires a Dig Alert identification Number to be issued before a Permit to Excavate will be voided. For your Dig Alert ID, Number call **CALL TOL FREE** TWO WORKING DAYS BEFORE YOU DO UNDERGROUND SERVICE ALERT **1-800-227-2600**

ENGINEER IN RESPONSIBLE CHARGE
THOMAS J. BOYD
R.C.E. No. 36170 expires
DATE

REGISTERED PROFESSIONAL ENGINEER
THOMAS JOHN BOYD
No. 36170
Exp. 06-30-2006
CIVIL
STATE OF CALIFORNIA

MARK	REVISIONS	APPR.	DATE

CITY OF RIVERSIDE, CALIFORNIA
DEPARTMENT OF PUBLIC WORKS
APPROVED BY: [Signature]
PRINCIPAL ENGINEER
P.W. INSPECTION: [Signature]
TRAFFIC DIVISION: [Signature]
CHIEF P.W. ENGR.
PUBLIC UTILITIES

TRAFFIC SIGNAL MODIFICATION
MAGNOLIA AVENUE
BROCKTON/CENTRAL AVE.
ACCT. NO. 958-671C2-44022300
X-210C
SHEET 1 OF 1
FILE NAME: X210C.DWG
SCALE: 1" = 20'

CONSTRUCTION NOTES

1. Install City furnished Model 170E/332 traffic signal controller assembly.
 2. Modify existing planter wall as indicated and as directed by the Engineer; new slumpstone bricks and caps shall match in kind. See details.
 3. Interlocking pavers shall be removed for the construction of handicap ramps and traffic signal facility installations. Re-install said pavers in area of construction excepting handicap ramps, pullboxes, and pole caps.
 4. Remove planter wall footing to accommodate pavers installations.
- 200 III Construct Type III curb per City of Riverside Standard Drawing No. 200. Curb height to match existing.
- R Remove existing median and repair pavement as required and as directed in the field.
- 304 Construct wheelchair ramp per City of Riverside Standard Drawing No. 304.
- 304 M Construct modified wheelchair ramp per City of Riverside Standard Drawing No. 304. A=2', D=5'
- ABB C Construct wheelchair ramp per Caltrans Standard Drawing No. ABB, case C.

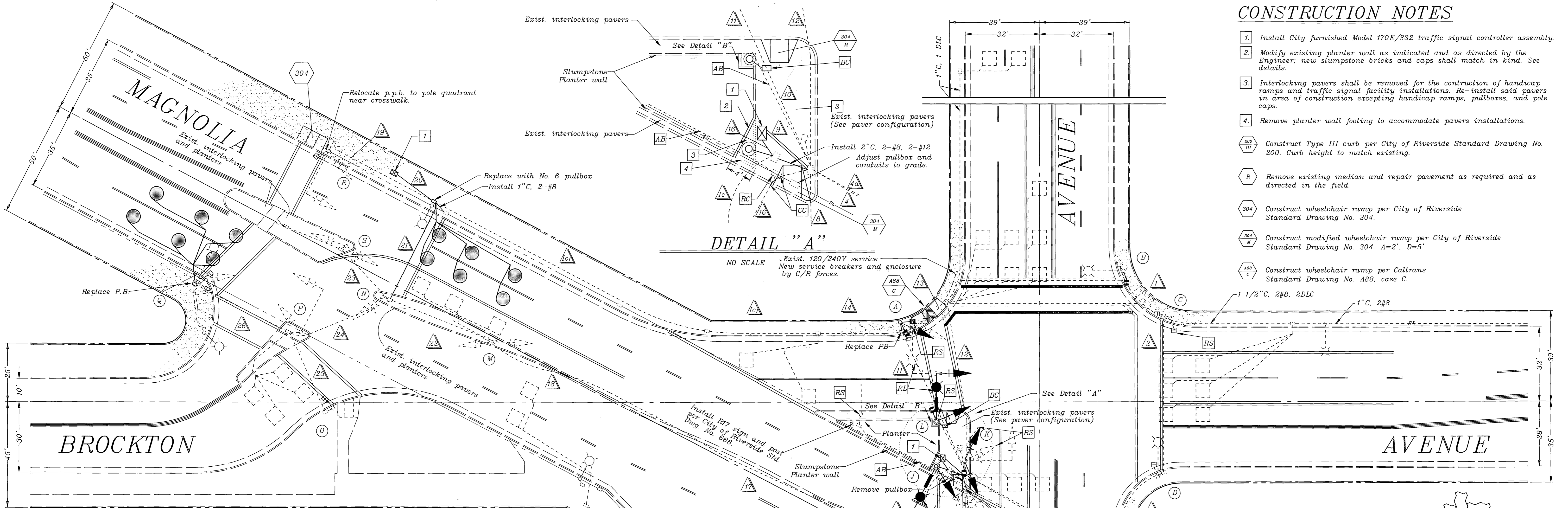

DETAIL "A"

NO SCALE
 Exist. 120/240V service
 New service breakers and enclosure
 by C/R forces.

DETAIL "B"

NO SCALE

EQUIPMENT SCHEDULE

NO.	SIGNAL STANDARD TYPE	HEIGHT	M.A.	L.A.	H.P.S.V.	SIGNAL MOUNTINGS		PPB
						VEHICLE	PEDESTRIAN	
Q	1A(N)	10'				TV-1-T(N)	SP-2-T(N)	1(N)
B	68J10	30'	12'	200W			SP-1-T(N)	1
C	1A	7'				TP-1-T		1
D	56J12	30'	12'	200W			SP-1-T	1
E	68J5C1B	30'	18'	15'	200W	MAS	SV-2-T(N)	1
F	26-4-80(N)	30'	45'(N)12'(N)	200W(R)		MAS(N)	SP-1-T(N)	1(N)
G	1A	10'				TV-1-T	SP-1-T	1
H	56DB	30'	8'	200W		SV-1-T	SP-1-T	1
I	1A(N)	10'				TV-1-T(N)	SP-1-T(N)	1(N)
J	24-4-80(N)	30'	35'(N)12'(N)	200W(R)		MAS(N)	SP-1-T(N)	1(N)
K	TYPE II	17'	18'			MAS	SV-2-T(N)	1
L	17-2-80(N)	30'	20'(N)12'(N)	200W(R)		MAS(N)	SP-1-T(N)	1(N)
M	1A	10'				TV-2-T		
N	1A	10'				TV-1-T		
O	1A	7'				TP-1-T		1
P	TYPE II	17'	18'			MAS	SV-1-T	1
Q	56DB	30'	8'	200W		SV-1-T	SP-2-T	2
R	TYPE II	17'	18'			MAS	SV-1-T	1
S	1A	7'				LT-2-T		

Construct 2 course (4"x6"x16") slumpstone planter wall with (1"x8"x16") cap.
 See Note 2

Install removed interlocking pavers.
 See Note 3

CONDUCTOR SCHEDULE

CONTROL FUNCTION	CONDUCTORS	CONDUCTOR RUNS																											
		1	2	3	4	5	6	7	8	9	10	11	12	13	14	15	16	17	18	19	20	21	22	23	24	25	26	27	28
VEHICLE & PEDESTRIAN HEADS, PEDESTRIAN PUSH BUTTONS, SPARES & COMMONS	12 WIRE IMSA 9 WIRE IMSA 5 WIRE IMSA 3 WIRE IMSA	-	-	-	-	-	-	-	-	-	-	-	-	-	-	-	-	-	-	-	-	-	-	-	-	-	-	-	-
DETECTOR CABLE	#16/2	-	-	-	-	-	-	-	-	-	-	-	-	-	-	-	-	-	-	-	-	-	-	-	-	-	-	-	-
PHASE 1		-	-	-	-	-	-	-	-	-	-	-	-	-	-	-	-	-	-	-	-	-	-	-	-	-	-	-	-
PHASE 2		-	-	-	-	-	-	-	-	-	-	-	-	-	-	-	-	-	-	-	-	-	-	-	-	-	-	-	-
PHASE 3		-	-	-	-	-	-	-	-	-	-	-	-	-	-	-	-	-	-	-	-	-	-	-	-	-	-	-	-
PHASE 4		-	-	-	-	-	-	-	-	-	-	-	-	-	-	-	-	-	-	-	-	-	-	-	-	-	-	-	-
PHASE 5		-	-	-	-	-	-	-	-	-	-	-	-	-	-	-	-	-	-	-	-	-	-	-	-	-	-	-	-
PHASE 6		-	-	-	-	-	-	-	-	-	-	-	-	-	-	-	-	-	-	-	-	-	-	-	-	-	-	-	-
PHASE 7		-	-	-	-	-	-	-	-	-	-	-	-	-	-	-	-	-	-	-	-	-	-	-	-	-	-	-	-
PHASE 8		-	-	-	-	-	-	-	-	-	-	-	-	-	-	-	-	-	-	-	-	-	-	-	-	-	-	-	-
INTERCONNECT CABLE	#19 I.I.S.N.S.	-	-	-	-	-	-	-	-	-	-	-	-	-	-	-	-	-	-	-	-	-	-	-	-	-	-	-	-
LUMINAIRES	#8	-	-	-	-	-	-	-	-	-	-	-	-	-	-	-	-	-	-	-	-	-	-	-	-	-	-	-	-
SIGNAL SERVICE	#8	-	-	-	-	-	-	-	-	-	-	-	-	-	-	-	-	-	-	-	-	-	-	-	-	-	-	-	-
CONDUIT SIZE		1.5"	2"	2"	1.5"	1.5"	2"	3"	2"	3"	2-3"	1.5"	1.5"	2.5"	1.5"	2"	2"	2.5"	2.5"	1.5"	2-3"	2.5"	2"	1.5"	2"	1.5"	1.5"	3"	1.5"

- NOTES:**
1. Poles to be removed and salvaged exist as follows:
 2 ea. 56 marbelite
 1 ea. Type II (steel)
 2 ea. 1A
 2 ea. Ped. Post
 2. Relocate priority pre-emption detector to new pole; applies to poles A and J. Installation is on signal mastarm.
 3. Existing signs on salvaged 56 marbelite poles shall be relocated to new poles.
 4. (N)=new; (R)=equipment to be relocated; all other equipment exists.
 5. Rotate existing pedestrian signal at pole K, as shown.
 6. Poles F, J and L shall have I.I.S.N.S. for Central Ave., block no.'s to be provided by the Engineer.

IMPORTANT NOTICE
 Section 4216/4217 of the Government Code requires a Dig Alert Identification Number to be issued before a "Permit to Excavate" will be valid for your Dig Alert ID Number call.
 CALL TOLL FREE
 TWO WORKING DAYS BEFORE YOU DIG
UNDERGROUND SERVICE ALERT
 1-800-227-2600

ENGINEER IN RESPONSIBLE CHARGE

 RICHARD D. McGRATH
 R.C.E. No. 31952 expires 12-31-96
 DATE 7-11-96

MARK REVISIONS APPR. DATE
 DESIGNED BY: [Signature] DRAWN BY: MAC CHECKED BY: [Signature]

CITY OF RIVERSIDE, CALIFORNIA
 DEPARTMENT OF PUBLIC WORKS
 APPROVED BY: [Signature] DATE: 7/11/96
 PRINCIPAL ENGINEER
 P.W. INSPECTION
 TRAFFIC DIVISION
 CHIEF P.W. ENGR
 PUBLIC UTILITIES

TRAFFIC SIGNAL MODIFICATION
MAGNOLIA AVENUE @ BROCKTON CENTRAL AVE.
 SCALE: 1" = 20'
 ACCT. NO. 0430-541600-440125-35060
X-210A
 SHEET 1 OF 1
 FILE NAME: X210A.DWG

PAVER CONFIGURATION

NO SCALE

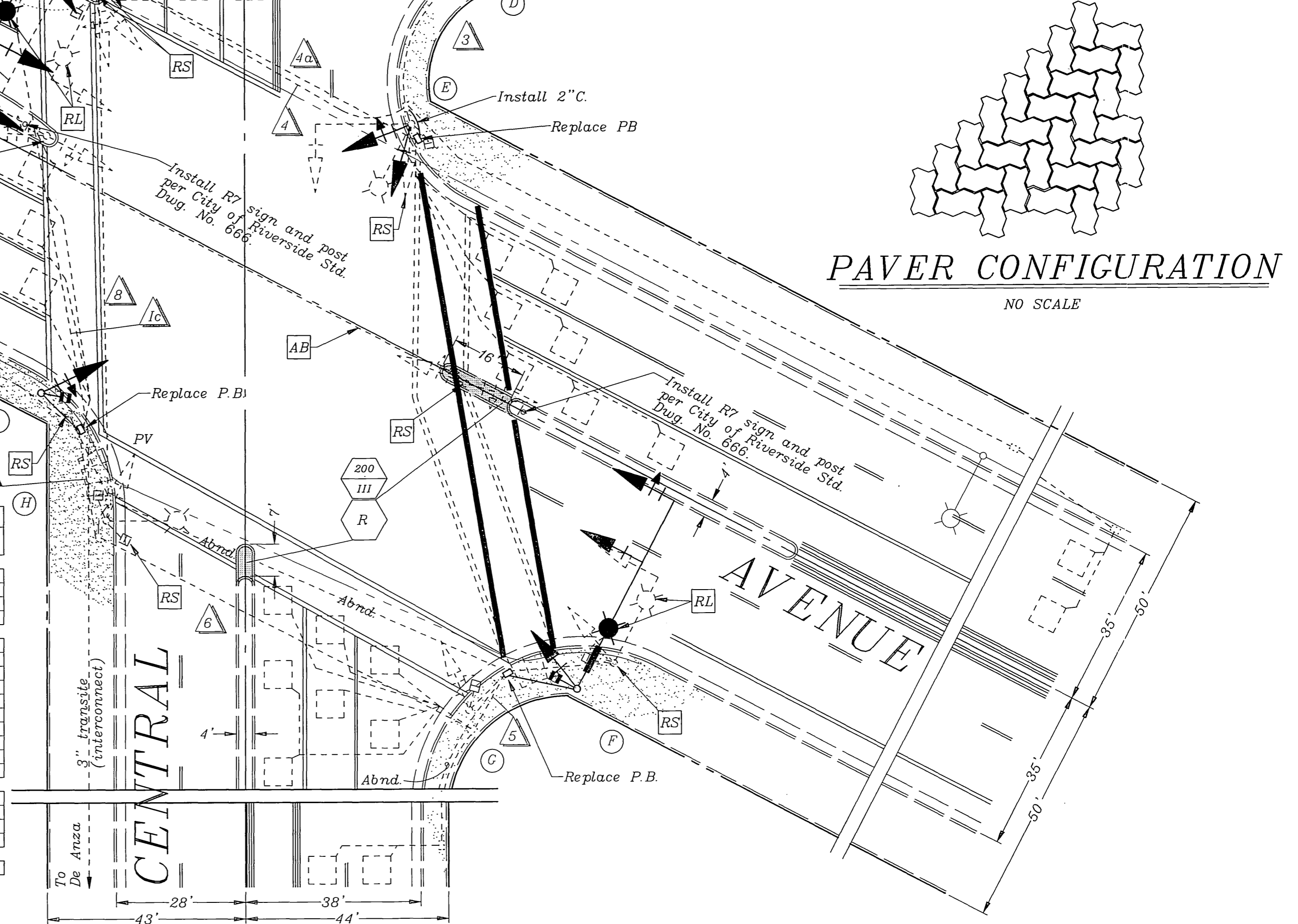

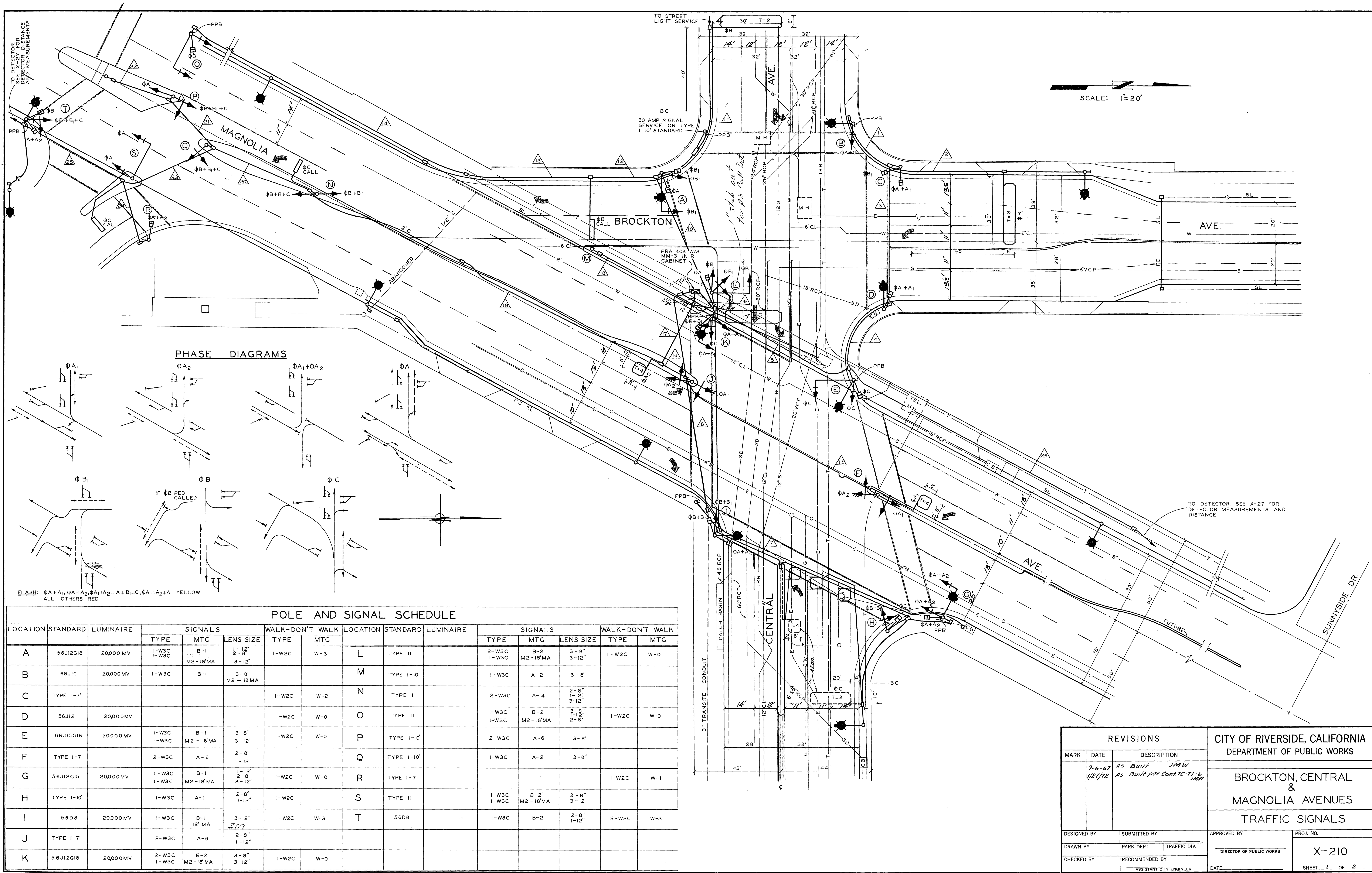

PHASE DIAGRAMS

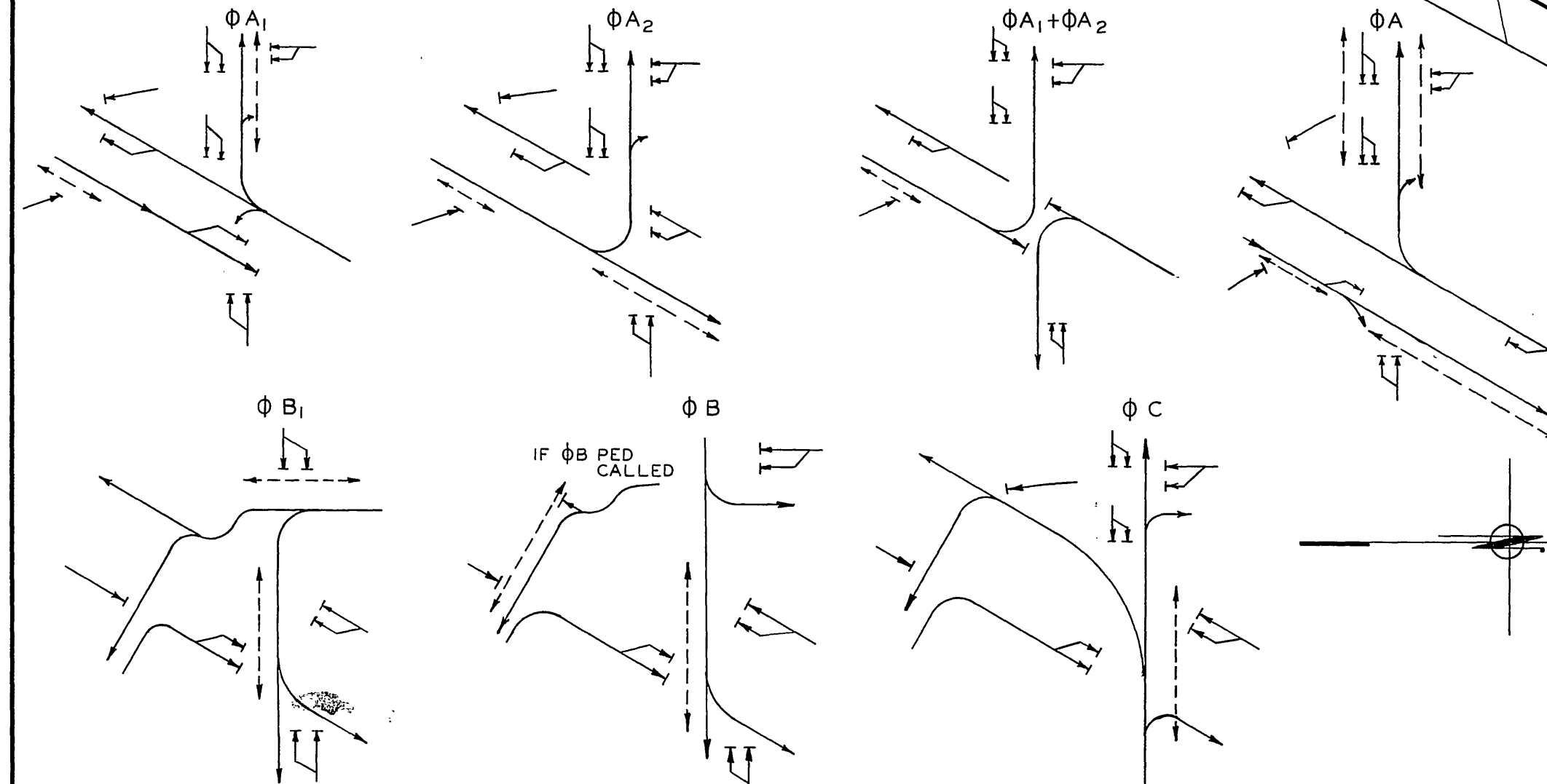

FLASH: φA + A1, φA + A2, φA1 + A2 + A + B1 + C, φA1 + A2 + A
 ALL OTHERS RED

POLE AND SIGNAL SCHEDULE

LOCATION	STANDARD	LUMINAIRE	SIGNALS			WALK-DON'T WALK		LOCATION	STANDARD	LUMINAIRE	SIGNALS			WALK-DON'T WALK	
			TYPE	MTG	LENS SIZE	TYPE	MTG				TYPE	MTG	TYPE	MTG	LENS SIZE
A	56J12G18	20000 MV	1-W3C 1-W3C	B-1 M2-18'MA	1-12" 2-8" 3-12"	1-W2C	W-3	L	TYPE II		2-W3C 1-W3C	B-2 M2-18'MA	3-8" 3-12"	1-W2C	W-0
B	68J10	20000 MV	1-W3C	B-1	3-8" M2-18'MA			M	TYPE I-10		1-W3C	A-2	3-8"		
C	TYPE 1-7'					1-W2C	W-2	N	TYPE I		2-W3C	A-4	2-8" 1-12" 3-12"		
D	56J12	20000 MV				1-W2C	W-0	O	TYPE II		1-W3C 1-W3C	B-2 M2-18'MA	3-8" 1-12" 2-8"	1-W2C	W-0
E	68J15G18	20000 MV	1-W3C 1-W3C	B-1 M2-18'MA	3-8" 3-12"	1-W2C	W-0	P	TYPE I-10'		2-W3C	A-6	3-8"		
F	TYPE 1-7'		2-W3C	A-6	2-8" 1-12"			Q	TYPE I-10'		1-W3C	A-2	3-8"		
G	56J12G15	20000 MV	1-W3C 1-W3C	B-1 M2-18'MA	1-12" 2-8" 3-12"	1-W2C	W-0	R	TYPE I-7					1-W2C	W-1
H	TYPE 1-10'		1-W3C	A-1	2-8" 1-12"	1-W2C		S	TYPE II		1-W3C 1-W3C	B-2 M2-18'MA	3-8" 3-12"		
I	56D8	20000 MV	1-W3C	B-1 12' MA	3-12" 3-12"	1-W2C	W-3	T	56D8		1-W3C	B-2	2-8" 1-12"	2-W2C	W-3
J	TYPE 1-7'		2-W3C	A-6	2-8" 1-12"										
K	56J12G18	20000 MV	2-W3C 1-W3C	B-2 M2-18'MA	3-8" 3-12"	1-W2C	W-0								

REVISIONS			CITY OF RIVERSIDE, CALIFORNIA DEPARTMENT OF PUBLIC WORKS
MARK	DATE	DESCRIPTION	
	9-6-67	As Built JMW	BROCKTON, CENTRAL & MAGNOLIA AVENUES TRAFFIC SIGNALS
	1/27/72	As Built per Cont. 71-6 JMW	
DESIGNED BY	SUBMITTED BY	APPROVED BY	PROJ. NO.
DRAWN BY	PARK DEPT. TRAFFIC DIV.	DIRECTOR OF PUBLIC WORKS	X-210
CHECKED BY	RECOMMENDED BY	DATE	SHEET 1 OF 2