

EQUIPMENT SCHEDULE

NO.	SIGNAL STANDARD			LUMINAIRE		I.I.S.N.S.		SIGNAL MOUNTINGS			PPB PHASE
	TYPE	H'GHT	M.A.	L.A.	H.P.S.V.	LEGEND	VEHICLE	PEDESTRIAN	AUDIBLE		
(A)	26A-4-80	35'	50'	15'	400W	MAGNOLIA AVE 6200	MAS, MAS (PV)	SV-1-T	SP-1-T	((IC))	6
(B)	1A	10'					TV-2-T	SP-1-T	((IP))		8
(C)	24A-4-70	35'	35'	15'	400W	ARLINGTON AVE 6200	MAS, MAS (PV)	SV-1-T	SP-1-T	((IC))	8
(D)	1A	10'					TV-2-T	SP-1-T	((IP))		2
(E)	26A-4-70	35'	40'	15'	400W	MAGNOLIA AVE 7000	MAS, MAS (PV)	SV-1-T	SP-2-T	((C,P))	2 & 4
(F)	27-4-80	17'	50'			SEE DETAIL	MAS, MAS (PV)	SV-2-T			
(G)	TYPE 15	35'		15'	400W		SV-2-T	SP-2-T	((P,C))		4 & 6

NOTES:
 1. ((IC)) OR ((IP)) - INDICATES AUDITORY PEDESTRIAN SIGNAL TO BE INSTALLED.
 ((IC)) INDICATES CUCKOO SOUND; ((IP)) INDICATES PEEP-PEEP SOUND.
 2. PEDESTRIAN PUSH BUTTONS SHALL BE INSTALLED ON THE POLE IN THE QUADRANT NEAREST THE CROSSWALK SERVING THE PHASE.
 3. ALL EQUIPMENT IS EXISTING.

GENERAL NOTES

- 1 - DETECTOR LOOPS SHALL BE INSTALLED IN THE PRESENCE OF THE TRAFFIC ENGINEER OR HIS REPRESENTATIVE.
- 2 - TYPICAL DETECTOR LOOP SPACING: 10', 15' & 30'. LOOPS ARE TO BE 6" DIA. TYPE "E".
- 3 - CONTRACTOR IS RESPONSIBLE FOR ANY DAMAGE TO EXISTING TRAFFIC FACILITY EQUIPMENT DURING CONSTRUCTION.

CONSTRUCTION NOTES

1. ABANDON EXISTING EQUIPMENT
2. INSTALL NEW EQUIPMENT AS NOTED.
3. SPLICE NEW TO EXISTING CONDUCTORS
4. REMOVE AND SALVAGE EXISTING 3-SECTION HEAD TO CITY YARD. INSTALL NEW 5-SECTION INDICATION. SEE DETAIL "A"
5. INSTALL 1 NEW DLC APPROX. 620' TO EXISTING CONTROLLER FOR NEW LOOPS (213L).
6. CONTRACTOR SHALL USE SPARE CONDUCTORS TO CONNECT THE NEW 5-SECTION INDICATION. CONTRACTOR SHALL CONTACT TRAFFIC SIGNAL MAINT. DEPT. (951)463-7826 FOR TRAFFIC SIGNAL OPERATIONAL CHANGES.
7. INSTALL DETAIL 40 AS PER CALTRANS 2006 STANDARD PLANS. APPLICATION TO BE THERMOPLASTIC.

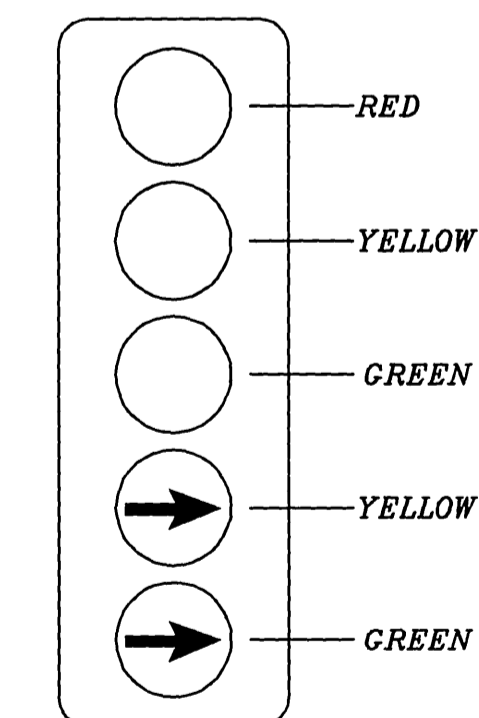
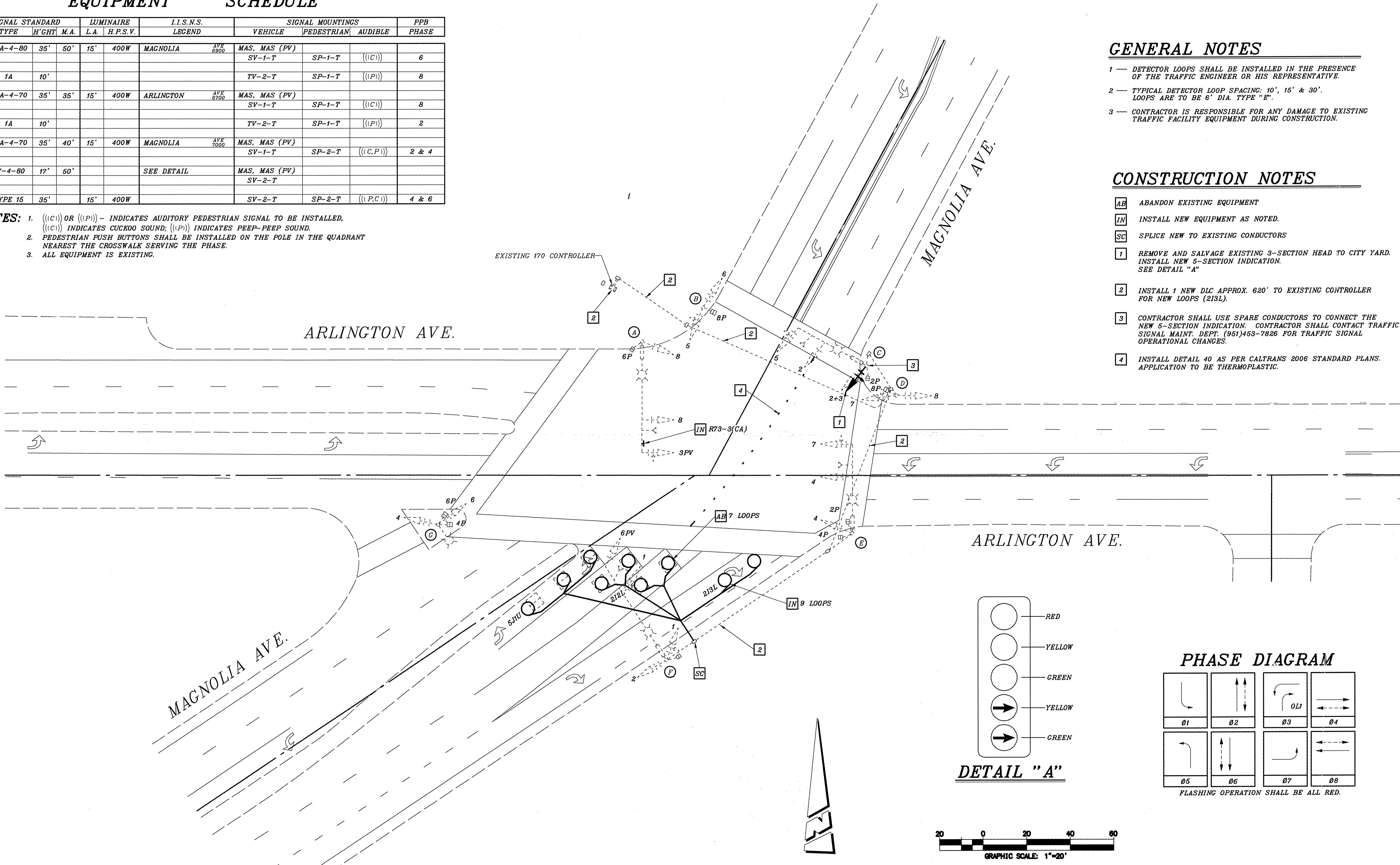

DETAIL "A"

PHASE DIAGRAM

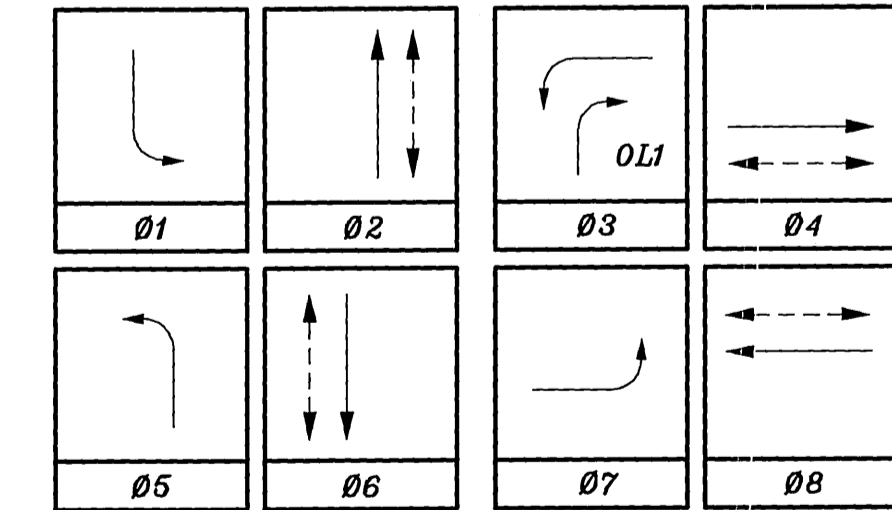

FLASHING OPERATION SHALL BE ALL RED.

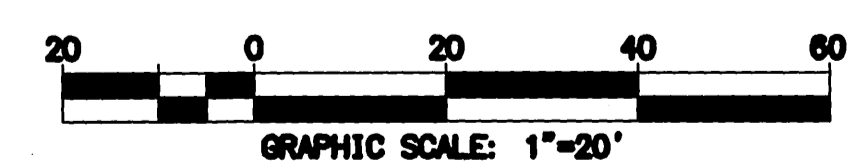

IMPORTANT NOTICE
 Section 4216.4217 of the Government Code requires a Dig Alert identification Number to be issued before a "Permit to Excavate" will be valid. For your Dig Alert ID Number call CALL TOLL FREE TWO WORKING DAYS BEFORE YOU DIG UNDERGROUND SERVICE ALERT 1-800-227-2600

ENGINEER IN RESPONSIBLE CHARGE
 GILBERT M. HERNANDEZ
 R.C.E. No. 69170 expires 6-30-08
 DATE 2-27-07



MARK	REVISIONS	APPR.	DATE

CITY OF RIVERSIDE, CALIFORNIA DEPARTMENT OF PUBLIC WORKS
 APPROVED BY: [Signature]
 TRAFFIC DIVISION: [Signature]
 DATE: 6/27/07

TRAFFIC SIGNAL ARLINGTON AVE. @ MAGNOLIA AVE.
 SCALE: 1" = 20'

ACCT. NO. X-212A
 SHEET 1 OF 1
 FILE NAME: X212A.DWG

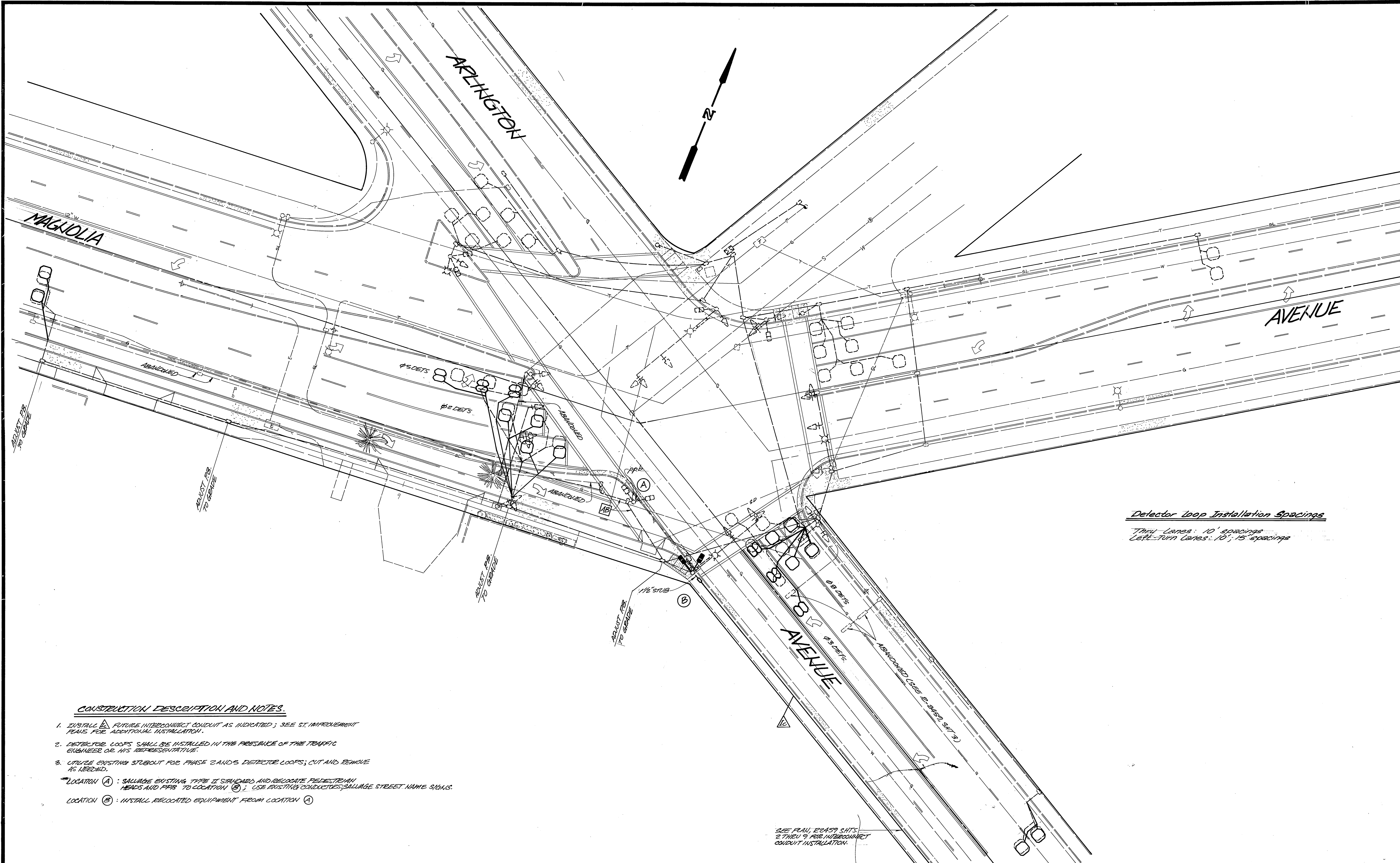

Detector Loop Installation Spacings
 Thru Lanes: 10' spacings
 Left-Turn Lanes: 10'; 15' spacings

CONSTRUCTION DESCRIPTION AND NOTES.

1. INSTALL Δ FUTURE INTERCONNECT CONDUIT AS INDICATED; SEE ST. IMPROVEMENT PLANS FOR ADDITIONAL INSTALLATION.
 2. DETECTOR LOOPS SHALL BE INSTALLED IN THE PRESENCE OF THE TRAFFIC ENGINEER OR HIS REPRESENTATIVE.
 3. UTILIZE EXISTING STUBOUT FOR PHASE 2 AND 5 DETECTOR LOOPS; CUT AND REMOVE AS NEEDED.
- LOCATION (A) : SALVAGE EXISTING TYPE II STANDARD AND RELOCATE PEDESTRIAN HEADS AND PPS TO LOCATION (B); USE EXISTING CONDUITORS; SALVAGE STREET NAME SIGNS.
- LOCATION (B) : INSTALL RELOCATED EQUIPMENT FROM LOCATION (A)

SEE PLAN, P2459 SHITS 2 THRU 9 FOR INTERCONNECT CONDUIT INSTALLATION.

	APPROVED BY	CITY OF RIVERSIDE		TRAFFIC SIGNAL REVISION		ACC. No. 30-575-323
	CITY TRAFFIC ENGINEER	PUBLIC WORKS DEPARTMENT		ARLINGTON AVENUE AT MAGNOLIA AVENUE		ACCOUNT NO. 30-575-314-01
DATE 3-28-88	MARK	REVISIONS	APPR. DATE	APPROVED BY	DATE	X-212
DESIGNED BY	DRAWN BY	CHECKED BY	DATE	PUBLIC WORKS DIRECTOR	DATE	SHEET 19 OF 21
			DEPUTY PW DIR	DATE	HORIZ. SCALE: 1" = 20'	VERT. SCALE: 1" =

PHASE DIAGRAM
Flashing Indications: All Red

NOTE:
Spores in Run Δ & ∇ used
for ϕB_2 S. median.

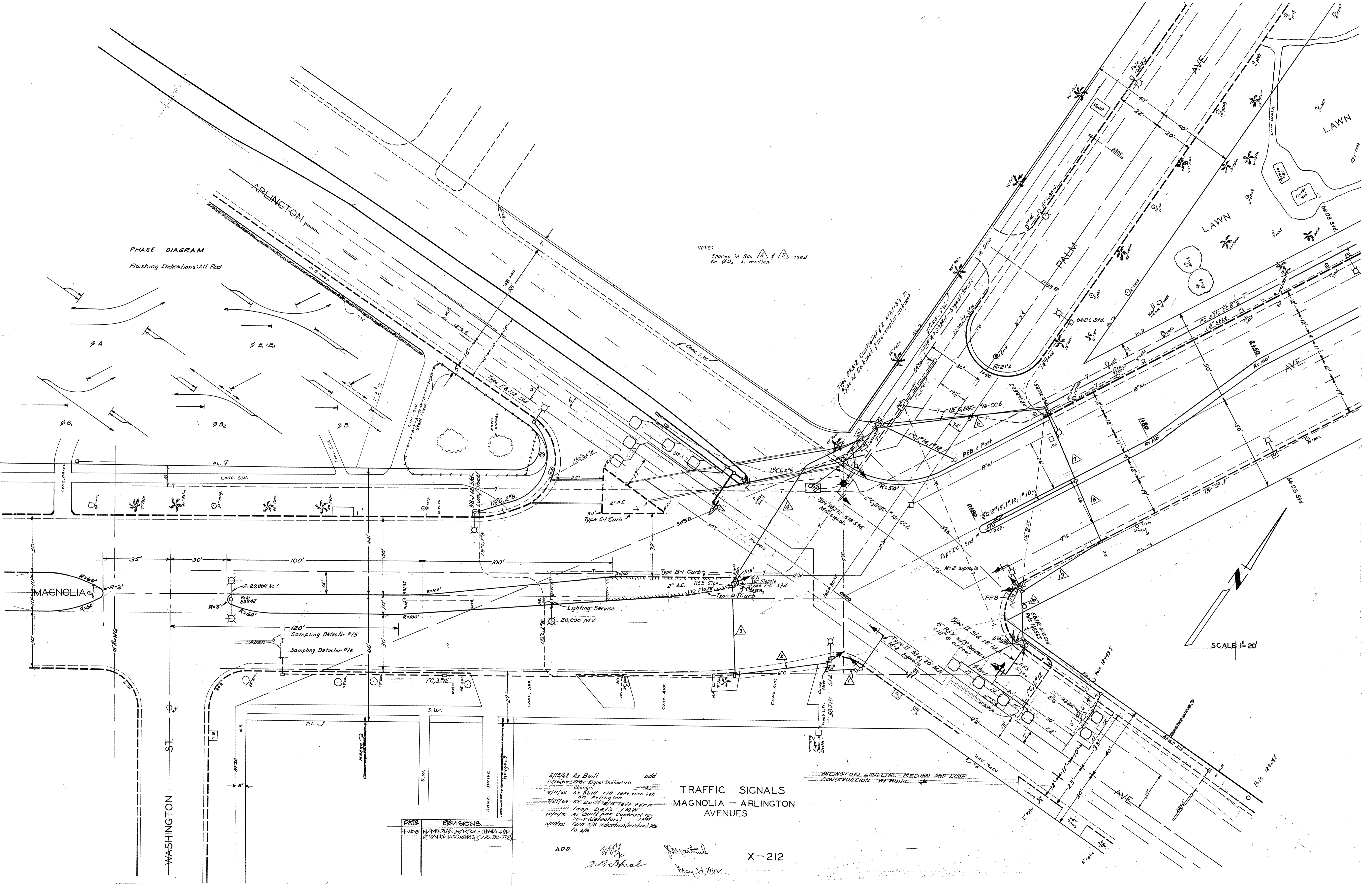

MAGNOLIA

WASHINGTON ST.

ARLINGTON

PALM

LAWN

LAWN

SCALE 1" = 20'

5/15/62 As Built add
10/26/66 ϕB_2 signal indication change MS
8/11/68 As Built ϕB_2 left turn det on Arlington MS
1/25/69 As Built ϕB_2 left turn loop det's JMW
12/10/70 As Built per Contract 70-2 (detectors) JMW
4/29/72 Turn NB indication (median) det to ϕB_2

TRAFFIC SIGNALS
MAGNOLIA - ARLINGTON
AVENUES

DATE	REVISIONS
4-23-30	1. MEDIAN S. W. C. - INSTALLED
	2. VANES LOCATED (WA. 80-7-2)

A.D.D. *W. J. ...* *J. ...*
May 24, 1962

X-212

ARLINGTON LEVELING - MEDIAN AND LOOP
CONSTRUCTION - AS BUILT