

**CONDUCTOR TABLE** SR-91/I-215 NB ON-RAMP

CONTROL FUNCTION	CONDUCTORS	CONDUCTOR RUNS									
		1	2	3	4	5	6	7	8	9	10
VEHICLE & PED HEADS, PED PUSH BUTTONS, SPARES & COMMONS	12 WIRE IMSA 9 WIRE IMSA 5 WIRE IMSA 3 WIRE IMSA	1	2	3	4	5	6	7	8	9	10
DETECTOR CABLE	#16/2	-	-	-	-	-	-	-	-	-	-
PHASE 1		-	1	1	1	1	1	1	1	1	1
PHASE 2		-	-	-	-	-	3	3	1	-	-
PHASE 4		3	3	3	3	3	-	-	-	-	-
PHASE 5		-	-	-	-	-	1	1	-	-	-
PHASE 6		-	2	2	2	2	-	-	-	-	-
PHASE 8		-	-	1	1	1	-	-	-	-	-
INTERCONNECT CABLE	#19	-	-	-	-	-	-	-	-	1	1
I.I.S.N.S.	#12	2	2	2	2	2	-	-	-	-	-
LUMINAIRES	#8	2	2	2	2	2	-	-	-	-	-
SIGNAL SERVICE	#6	-	-	2	2	2	-	-	-	-	-
CONDUIT SIZE		2"	2.5"	2"	3"	2"	2-3"	2.5"	2"	1.5"	1.5"

NOTE: 1. SIGNAL SYSTEM SHALL HAVE NEW CABLES AND CONDUIT; SEE CONTRACT SPECIAL PROVISIONS FOR ADDITIONAL INFORMATION ON I.M.S.A. CABLE.  
 2. (E) = EXISTING CONDUIT  
 3. SERVICE RUN, (2"C) PARALLEL RUN 4, AND RUN 4 SHALL BE PLACED IN COMMON TRENCH.

**DETECTOR SCHEDULE**

LOOP DESIGNATION	NUMBER OF LOOPS	FEATURES
11U	3	
212U	2	
212L	4	
213U	2	
4J6U	1	
4J6L	3	
4J7U	2	▲
5J1U	3	
6J2U	2	
6J2L	4	
8J6U	3	

▲ DELAY  
 Detectors shall be 2-channel rack-mounted.

**EQUIPMENT SCHEDULE**

NO.	SIGNAL STANDARD			LUMINAIRE		I.I.S.N.S.		SIGNAL MOUNTINGS			PPB PHASE
	TYPE	H'GHT	M.A.	L.A.	H.P.S.V.	LEGEND	VEHICLE	PEDESTRIAN	AUDIBLE		
(A)	24-4-80	30'	35'	12'	250W	E. LA CADENA DR 1150	MAS				
							MAS				
							SV-2-TD	SP-1-T			
(B)	17-2-80	30'	20'	12'	250W	COLUMBIA AV 1800	MAS				
							SV-2-TD	SP-1-T			8
(C)	26-4-80	30'	45'	12'	250W	E. LA CADENA DR 1200	MAS				
							SV-1-T	SP-1-T			8
(D)	1A	10'					TV-1-T	SP-1-T			2
(E)	17-2-80	30'	20'	12'	250W	COLUMBIA AV 1900	MAS				
							SV-1-T	SP-1-T			2
(F)	1A	10'					TV-1-T	SP-1-T			
(G)	1A	14'					TV-1-T	SP-1-T			

NOTES: 1. ALL VEHICULAR HEADS SHALL HAVE 12" LENSES.  
 2. ALL LEFT TURN HEADS SHALL HAVE ALL ARROWS.  
 3. PEDESTRIAN PUSH BUTTONS SHALL BE INSTALLED ON THE POLE IN THE QUADRANT NEAREST THE CROSSWALK SERVING THE PHASE.

**PHASE DIAGRAM**

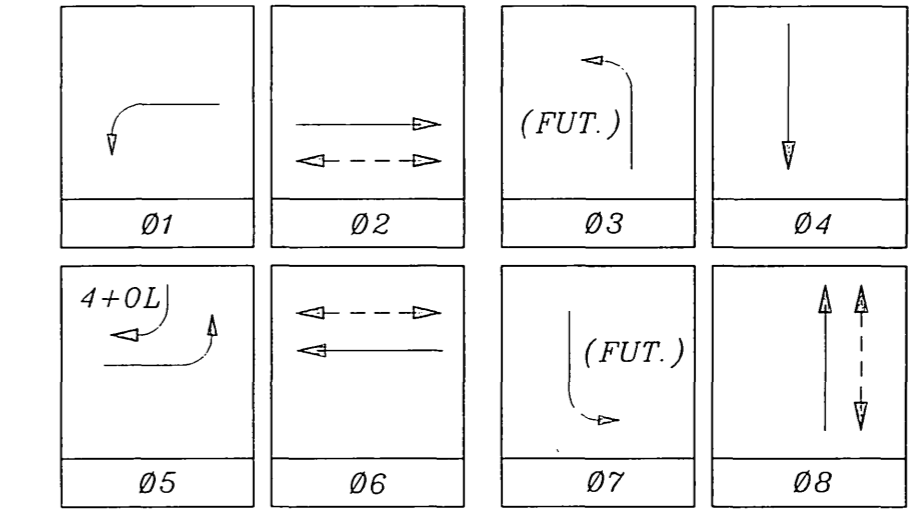

FLASHING OPERATION SHALL BE ALL RED.

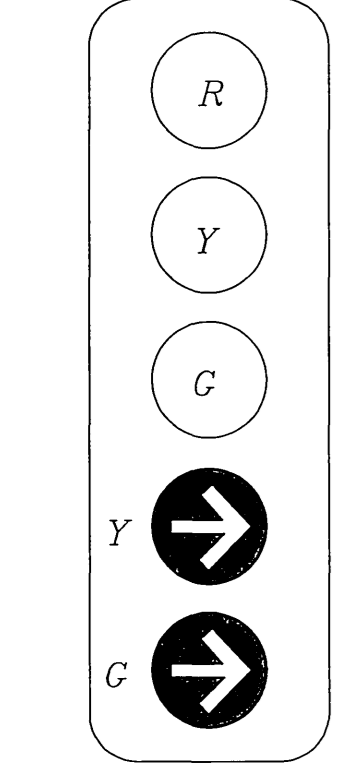
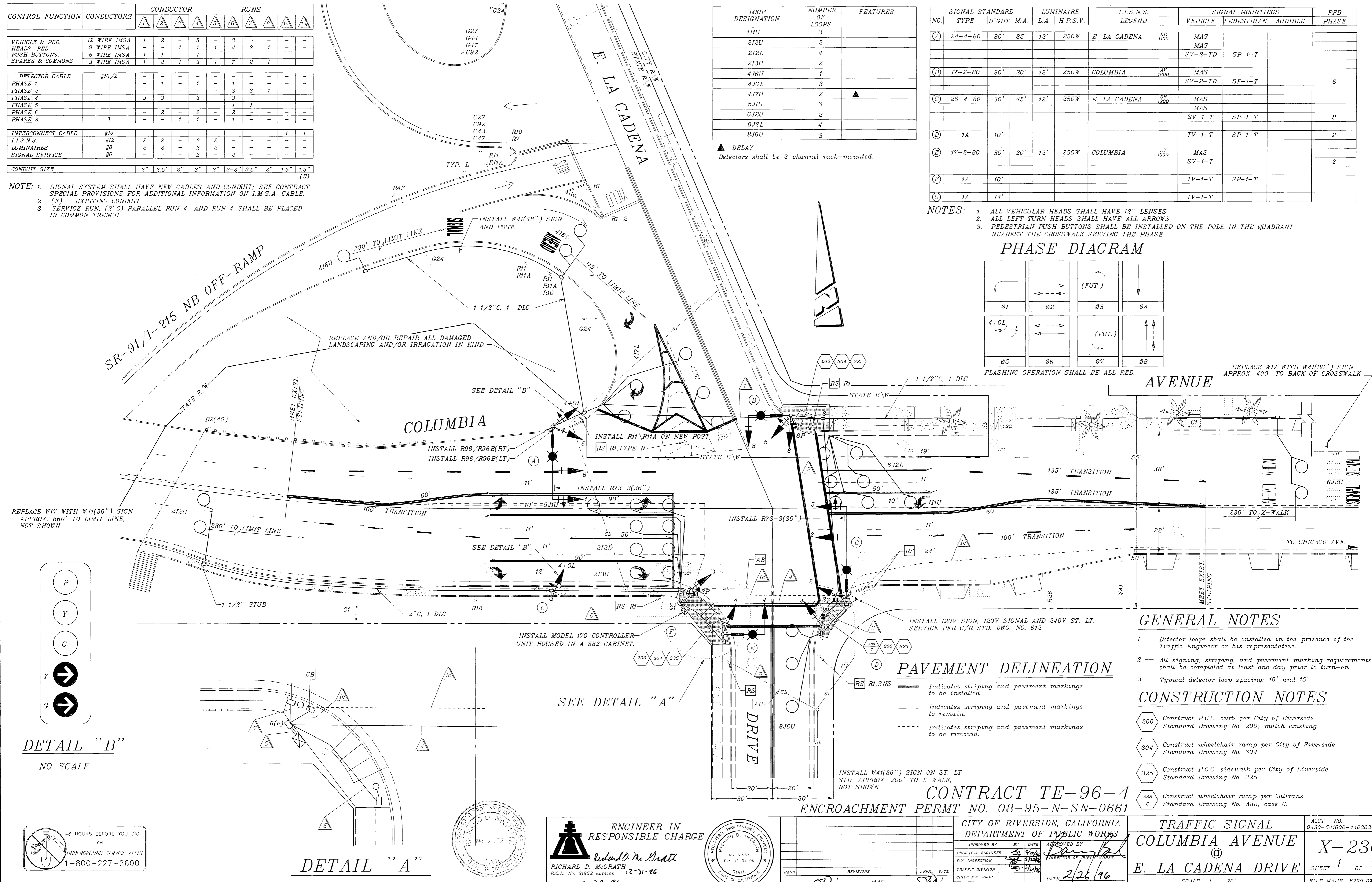

**DETAIL "B"**  
 NO SCALE

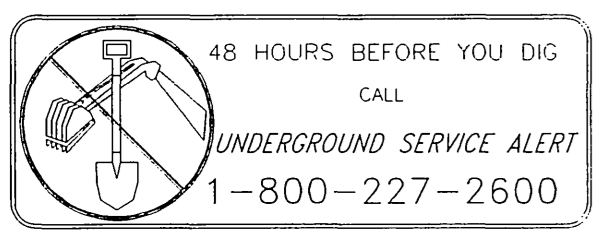

**DETAIL "A"**



**ENGINEER IN RESPONSIBLE CHARGE**  
 RICHARD D. McGRATH  
 R.C.E. No. 31952 expires 12-31-96  
 DATE 2-23-96



**CONTRACT TE-96-4**  
**ENCROACHMENT PERMT NO. 08-95-N-SN-0661**

**PAVEMENT DELINEATION**

- Indicates striping and pavement markings to be installed.
- Indicates striping and pavement markings to remain.
- Indicates striping and pavement markings to be removed.

**GENERAL NOTES**

- Detector loops shall be installed in the presence of the Traffic Engineer or his representative.
- All signing, striping, and pavement marking requirements shall be completed at least one day prior to turn-on.
- Typical detector loop spacing: 10' and 15'.

**CONSTRUCTION NOTES**

- 200 Construct P.C.C. curb per City of Riverside Standard Drawing No. 200; match existing.
- 304 Construct wheelchair ramp per City of Riverside Standard Drawing No. 304.
- 325 Construct P.C.C. sidewalk per City of Riverside Standard Drawing No. 325.
- ABB Construct wheelchair ramp per Caltrans Standard Drawing No. ABB, case C.

CITY OF RIVERSIDE, CALIFORNIA  
 DEPARTMENT OF PUBLIC WORKS  
 APPROVED BY: [Signature]  
 DATE: 2/26/96

**TRAFFIC SIGNAL**  
**COLUMBIA AVENUE**  
**@**  
**E. LA CADENA DRIVE**

ACCT. NO. 0430-541600-440303-30212  
**X-230**  
 SHEET 1 OF 1  
 FILE NAME: X230.DWG

SCALE: 1" = 20'