

CONDUCTOR		TABLE					
CONTROL FUNCTION	CONDUCTORS	CONDUCTOR RUNS					
		1	2	3	4	5	6
VEHICLE & PEDESTRIAN HEADS, PEDESTRIAN PUSH BUTTONS, SPARES & COMMONS	12 CONDUCTOR IMSA	1	1	1	2	4	1
	9 CONDUCTOR IMSA	-	-	-	-	-	-
	5 CONDUCTOR IMSA	-	-	-	-	-	-
DETECTOR CABLE	#16/2	-	-	-	-	-	-
PHASE 2		-	-	-	-	2	2
PHASE 4		-	1	1	1	1	-
PHASE 6		-	-	-	2	2	-
TOTALS		-	1	1	3	5	2
EVPE CABLE	#20/4	2	2	2	2	2	-
ISNS	#12	2	2	2	2	-	2
LUMINAIRES	#8	2	2	2	2	-	-
SIGNAL SERVICE	#6	-	-	-	2	2	-
CONDUIT SIZE		2"	3"	3"	3"	2-3"	2"

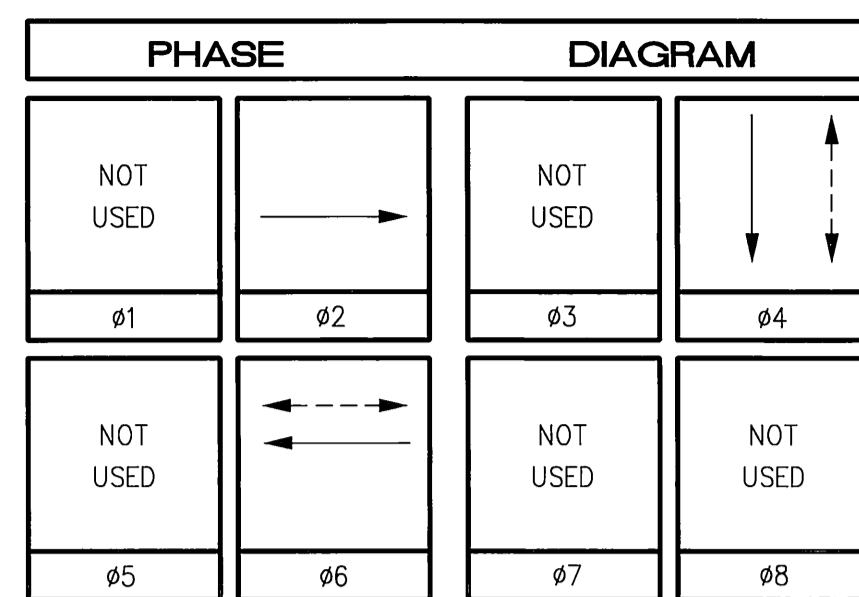

PP #30789J

RISER DETAIL

INSTALL 120V SIGNAL, 120V SIGN AND 240V STREET LIGHT SERVICE PER STANDARD DWG. NO. 612. REMOVE EXISTING 120V FLASHING BEACON SERVICE.

No.	TYPE	POLE				SCHEDULE				REMARKS		
		STANDARD	HGT.	SIG. M.A.	LUM. M.A.	SIGNAL MOUNTING			PPB PHASE			
						LUMINAIRE HPS	ISNS LEGEND	VEHICLE			PED	AUDIBLE
1	17-2-80	30'	20'	12'	250W	Wohlstetter ST ₅₃₀₀	-	MAS	SV-2-T	SP-1-T	((P))	-
2	PPB POST	3'10"	-	-	-	-	-	-	-	-	-	Ø6
3	PPB POST	3'10"	-	-	-	-	-	-	-	-	-	Ø6
4	1-A	7'	-	-	-	-	-	-	-	TP-2-T	((C))/((P))	Ø4
5	17-2-80	30'	20'	12'	250W	-	-	MAS	SV-1-T	SP-1-T	((C))	Ø4
6	16-2-80	17'	20'	-	-	Wells ^{Ave} ₈₂₀₀	-	MAS	SV-1-T	-	-	-

NOTE: ALL POLES AND MAST ARMS WILL BE CITY-FURNISHED.
 ((C)) OR ((P)) - INDICATES AUDITORY PEDESTRIAN SIGNAL TO BE INSTALLED.
 ((C)) INDICATES CUCKOO SOUND; ((P)) INDICATES PEEP-PEEP SOUND.

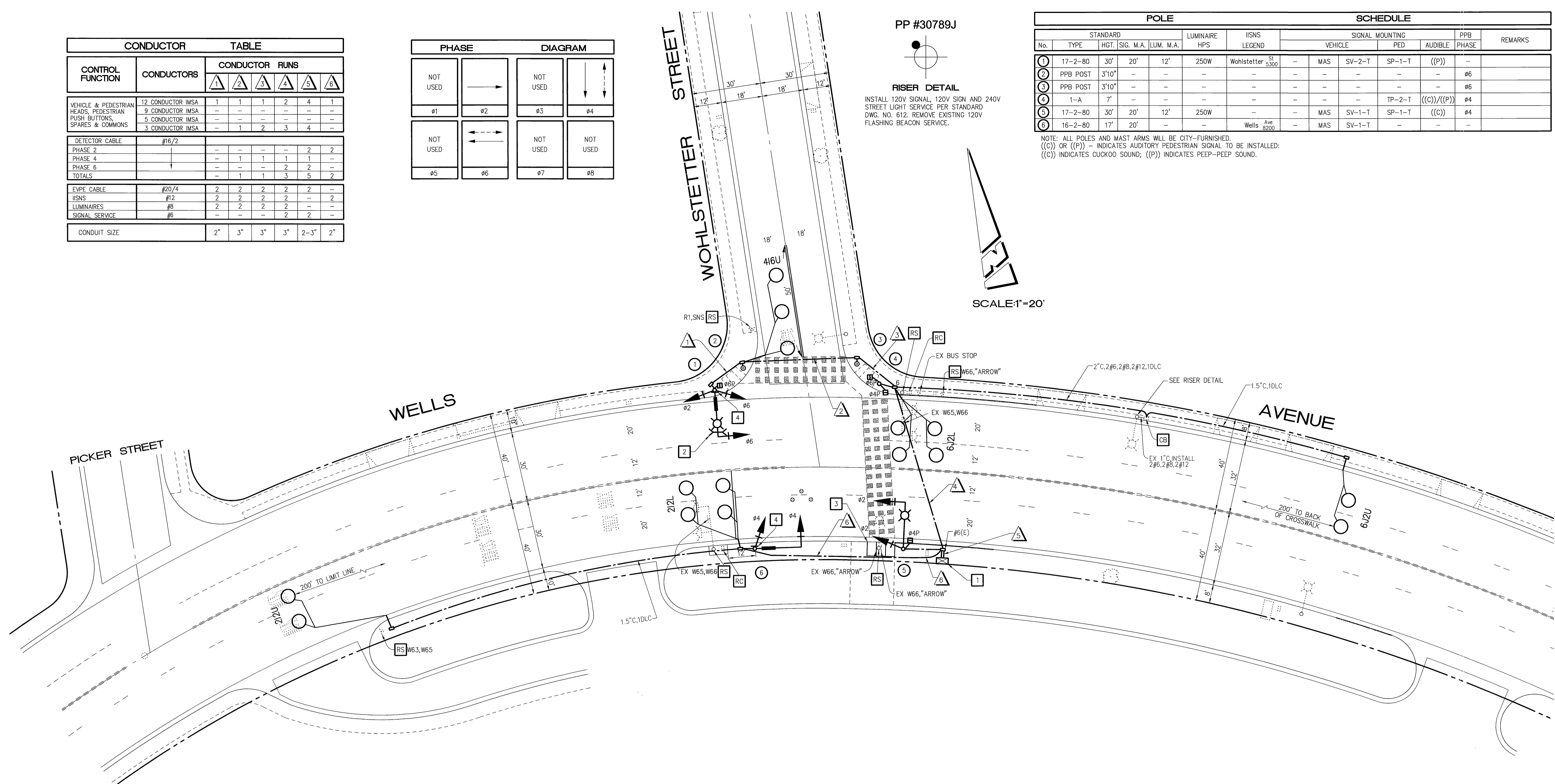

GENERAL NOTES:

- DETECTOR LOOPS SHALL BE INSTALLED IN THE PRESENCE OF THE TRAFFIC ENGINEER OR HIS REPRESENTATIVE.
- ALL SIGNING, STRIPING, AND PAVEMENT MARKINGS REQUIREMENTS SHALL BE COMPLETED AT LEAST ONE DAY PRIOR TO TURN-ON.
- TYPICAL DETECTOR LOOP SPACING: 10', 15', 30' (WHERE APPLICABLE).
- PAVEMENT DELINEATION SHOWN HEREON IS FOR REFERENCE ONLY. CITY FORCES SHALL PERFORM ALL PERMANENT PAINTING (INSTALLATION AND REMOVALS) WORK.
- ALL VEHICLE HEADS SHALL HAVE 12" LENSES WITH RED, YELLOW, AND GREEN 'LED' TYPE INDICATIONS.
- PEDESTRIAN SIGNAL HEADS SHALL HAVE 'LED' TYPE INDICATIONS.
- PEDESTRIAN PUSH BUTTONS SHALL BE ADA APPROVED TYPE.

CONSTRUCTION NOTES (THIS SHEET):

- INSTALL CITY-FURNISHED MODEL 170 CONTROLLER ASSEMBLY WITH MODEL 332 CABINET. INSTALL 3M OPTICOM PHASE SELECTOR MODULE.
- INSTALL 3M OPTICOM DETECTOR MODEL 722 ON MAST ARM BY CLAMPING METHOD. EXACT LOCATION OF DETECTOR TO BE DETERMINED BY ENGINEER IN THE FIELD.
- CONSTRUCT P.C.C. CURB RAMP PER CITY STD. (1 EA.).
- INSTALL R96 SIGN.



TRAFFIC No. 0860
 DATE: 6-22-01
 AGA Job No. : 134-003
 AGA File Name: WELWOHSG
 Print Date : 6/21/01
 Last Revision : 6/21/01

ALBERT GROVER & ASSOCIATES
 TRANSPORTATION CONSULTING ENGINEERS
 211 E. Imperial Hwy., Suite 208 Fullerton, CA 92835

Underground Service Alert
 Call: TOLL FREE
 1-800
 227-2600
 TWO WORKING DAYS BEFORE YOU DIG

CITY OF RIVERSIDE, CALIFORNIA DEPARTMENT OF PUBLIC WORKS				TRAFFIC SIGNAL PLAN		ACCOUNT NO.
APPROVED BY		DATE	BY	APPROVED BY		X-243
PRINCIPAL ENGINEER		8/24/01	AG	R. M. S. with		
INSPECTION		8/15/01	AG	PUBLIC WORKS DIRECTOR		SHEET -- OF --
TRAFFIC DIVISION		8/15/01	AG			
CHIEF P. W. ENGINEER		8/15/01	AG	DATE 8-20-2001		HORIZ. SCALE: 1" = 20' VERT. SCALE: 1" = --
PUBLIC UTILITIES		8/20/01	AG			
MARK	REVISIONS	APPR.	DATE			
DESIGNED BY	DRAWN BY	CHECKED BY				

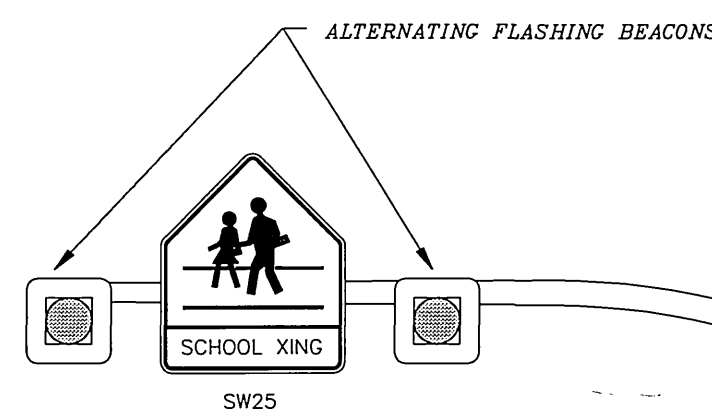

FLASHING BEACON CONTROL ASSEMBLY ENCLOSURE DETAIL

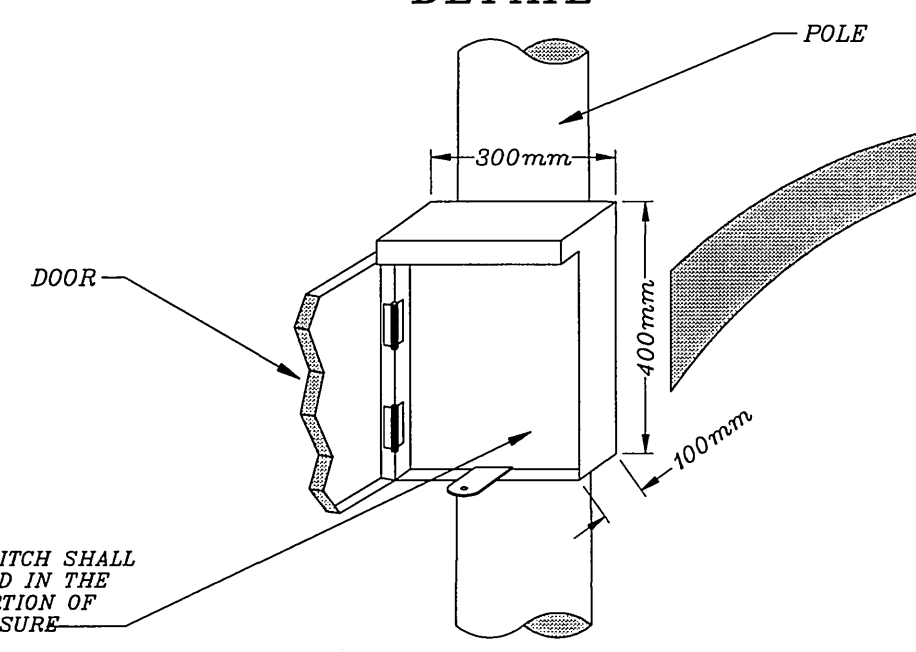

TOGGLE SWITCH SHALL BE LOCATED IN THE LOWER PORTION OF THE ENCLOSURE

NOTE: CIRCUITRY SHALL NOT BE EXPOSED BY OPENING OF DOOR ENCLOSURE. REMOVABLE ALUMINUM SHEET SHALL BE PROVIDED FOR MOUNTING THE TOGGLE SWITCH

CALTRANS STD. PLAN ES-9A (TYPE 9A FRAME DETAIL)

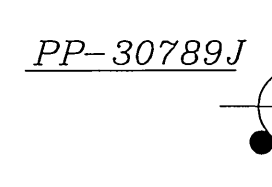
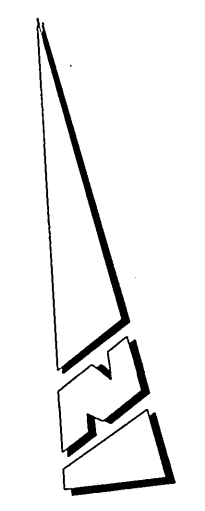

RISER DETAIL

PP-30789J

INSTALL 120V SERVICE TO FLASHING BEACON PER CITY OF RIVERSIDE STANDARD DRAWING NO. 612.

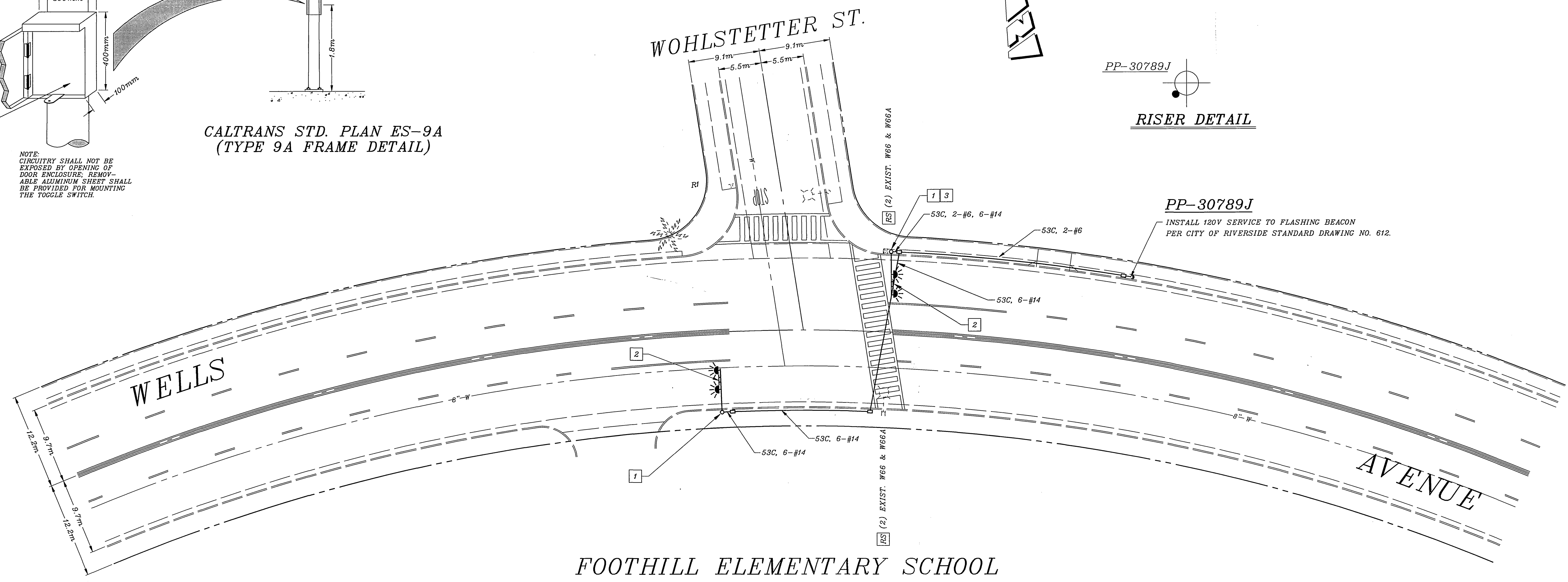

FOOTHILL ELEMENTARY SCHOOL

CONSTRUCTION NOTES

- 1 INSTALL CANTILEVER FLASHING BEACON (300mm LENS) PER CALTRANS STANDARD PLAN ES-9A.
- 2 INSTALL SW25 SIGN (W66 & W66A FABRICATED AS A SINGLE UNIT) PER CALTRANS STANDARD PLAN ES-9A TYPE 9A FRAME DETAILS.
- 3 INSTALL FLASHING BEACON CONTROL ASSEMBLY ON POLE. CIRCUITRY AND COMPONENTS SHALL CONFORM TO CALTRANS STANDARD PLAN ES-9C. OTHER REQUIREMENTS ARE AS FOLLOWS:
 - A. THE ASSEMBLY ENCLOSURE SHALL BE WEATHERPROOF.
 - B. MATERIAL: ANODIZED ALUMINUM, 0.125" THICKNESS.
 - C. DOOR SHALL BE LOCKABLE BY PADLOCK.
 - D. CIRCUITRY SHALL INCORPORATE A SOLID STATE TIMER AND TOGGLE SWITCH FOR PROGRAMMING AND MANUAL OPERATIONS, RESPECTIVELY. SEE DETAIL FOR PLACEMENT OF TOGGLE SWITCH.
 - E. CIRCUITRY SHALL PROVIDE FOR ALTERNATING FLASHING OF THE BEACONS.
 - F. SEE DETAIL REGARDING ALUMINUM SHEETING.



IMPORTANT NOTICE
 Section 4216/4217 of the Government Code requires a Dig Alert identification Number to be issued before a Permit to Excavate will be issued. For your Dig Alert I.D. Number call CALL TOLL FREE TWO WORKING DAYS BEFORE YOU DIG UNDERGROUND SERVICE ALERT 1-800-227-2600

ENGINEER IN RESPONSIBLE CHARGE
 Richard D. McGrath
 R.C.E. NO. 31952 EXPIRES 12-31-2000
 DATE 6-17-98



MARK	REVISIONS	APPR	DATE

CITY OF RIVERSIDE, CALIFORNIA
 DEPARTMENT OF PUBLIC WORKS
 APPROVED BY: [Signature] BY DATE: 6/17/98
 PRINCIPAL ENGINEER
 P.W. INSPECTION: [Signature] 6/17/98
 TRAFFIC DIVISION: [Signature] 6/17/98
 CHIEF P.W. ENGR.
 PUBLIC UTILITIES: [Signature] 6/17/98

FLASHING BEACON
 WELLS AVE.
 @
 WOHLSTETTER ST.
 SCALE 1:300

ACCT. NO. 230-541600-440223-35098
 X-243
 SHEET 1 OF 1
 FILE NAME: X243.DWG

CONTRACT TE-97-10

RIVERSIDE

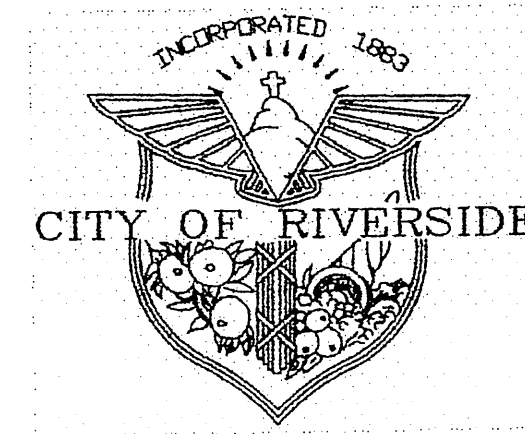

CALIFORNIA

PUBLIC WORKS DEPARTMENT TRAFFIC ENGINEERING DIVISION

CONTRACT TE-01-01

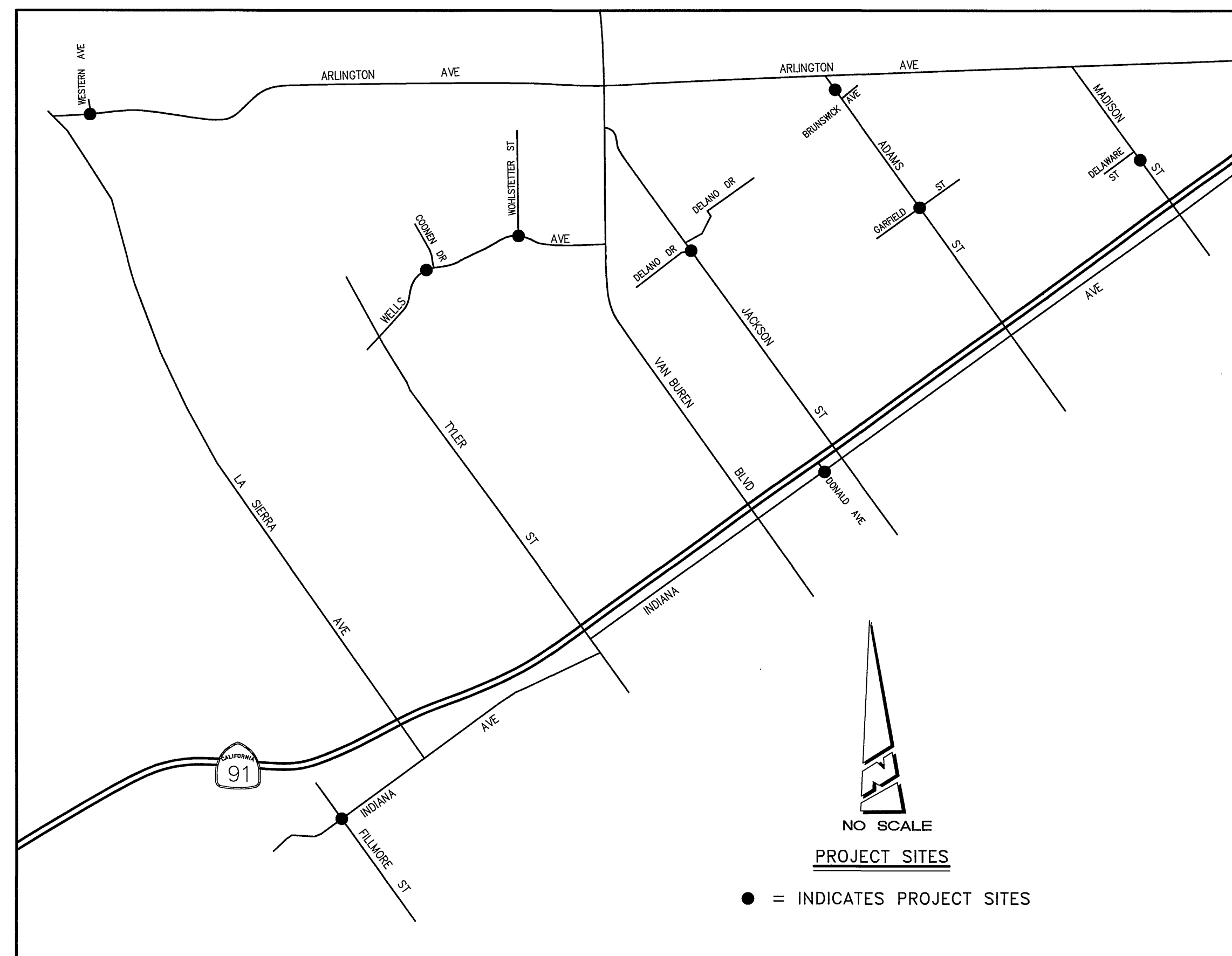

INDEX OF SHEETS

DRAWING NO.	LOCATION	SCHOOL	SHEET
-	COVER SHEET		1
X-392	ADAMS ST AND BRUNSWICK AVE	ADAMS	2
X-247	ADAMS ST AND GARFIELD ST	MONROE	3
X-252	ARLINGTON AVE AND WESTERN AVE	LOMA VISTA	4
X-248	INDIANA AVE AND DONALD AVE	HAWTHORNE	5
X-253	INDIANA AVE AND FILLMORE AVE	ORRENMA	6
X-238	JACKSON AVE AND DELANO DR	JACKSON	7
X-479	MADISON AVE AND DELAWARE ST	MADISON	8
X-250	WELLS AVE AND COONEN DR	WELLS	9
X-243	WELLS AVE AND WOHLSTETTER ST	FOOTHILL	10



TRAFFIC No. 0860
DATE: 7-12-01
AGA Job No. : 134-003
AGA File Name: RIV17_TS
Print Date : 7/12/01
Last Revision : 7/12/01

ALBERT GROVER & ASSOCIATES
TRANSPORTATION CONSULTING ENGINEERS
211 E. Imperial Hwy., Suite 208 Fullerton, CA 92835
(714) 992-2990
FAX 928-2883

CITY OF RIVERSIDE, CALIFORNIA DEPARTMENT OF PUBLIC WORKS				TRAFFIC SIGNAL PLANS		ACCOUNT NO.
APPROVED BY		DATE	BY	APPROVED BY		
PRINCIPAL ENGINEER		8/14/01	AG	R. Mc. [Signature]		
INSPECTION		8/14/01	AG	PUBLIC WORKS DIRECTOR		
TRAFFIC DIVISION		8/13/01	AG			
CHIEF P. W. ENGINEER		8/14/01	AG			
PUBLIC UTILITIES		8/20/01	AG	DATE 8-20-2001		
MARK	REVISIONS	APPR.	DATE	HORIZ. SCALE: 1" = -		VERT. SCALE: 1" = -
DESIGNED BY	DRAWN BY	CHECKED BY				SHEET 1 OF 10