

CONDUCTOR		TABLE			
CONTROL FUNCTION	CONDUCTORS	CONDUCTOR RUNS			
		1	2	3	4
VEHICLE & PEDESTRIAN HEADS, PEDESTRIAN PUSH BUTTONS, SPARES & COMMONS	12 CONDUCTOR IMSA	1	1	2	1
	9 CONDUCTOR IMSA	-	-	-	-
	5 CONDUCTOR IMSA	-	1	2	-
	3 CONDUCTOR IMSA	-	1	2	-
DETECTOR CABLE	#16/2	-	1	2	-
PHASE 2		-	1	2	-
TOTALS		-	1	2	-
IIISNS	#12	-	-	-	-
LUMINAIRES	#8	2	2	-	2
EVPE CABLE	#20/4	-	-	1	1
SIGNAL SERVICE	#6	-	-	2	2
CONDUIT SIZE		2"	3"	2-3"	2"

PHASE	DIAGRAM		
NOT USED		NOT USED	
Ø1	Ø2	Ø3	Ø4
NOT USED	NOT USED	NOT USED	NOT USED
Ø5	Ø6	Ø7	Ø8

POLE							SCHEDULE					
No.	TYPE	HGT.	SIG. M.A.	LUM. M.A.	LUMINAIRE HPS	IIISNS LEGEND	SIGNAL MOUNTING			PPB PHASE	REMARKS	
							VEHICLE	PED	AUDIBLE			
1	19-2-80	30'	25'	12'	250W	-	-	MAS	SV-1-T	-	-	-
2	1-A	7'	-	-	-	-	-	-	-	TP-1-T	((C))	Ø4
3	19-2-80	30'	25'	12'	250W	-	-	MAS	SV-1-T	-	-	-
4	1-A	7'	-	-	-	-	-	-	-	TP-1-T	((C))	Ø4

NOTE: ALL POLES AND MAST ARMS WILL BE CITY-FURNISHED. THE CONTRACTOR SHALL PROVIDE ALL ANCHOR BOLTS, HARDWARE AND OTHER APPURTENANCES REQUIRED FOR THE INSTALLATION OF CITY-FURNISHED POLES.
 ((C)) OR ((P)) - INDICATES AUDITORY PEDESTRIAN SIGNAL TO BE INSTALLED; ((C)) INDICATES CUCKOO SOUND; ((P)) INDICATES PEEP-PEEP SOUND.

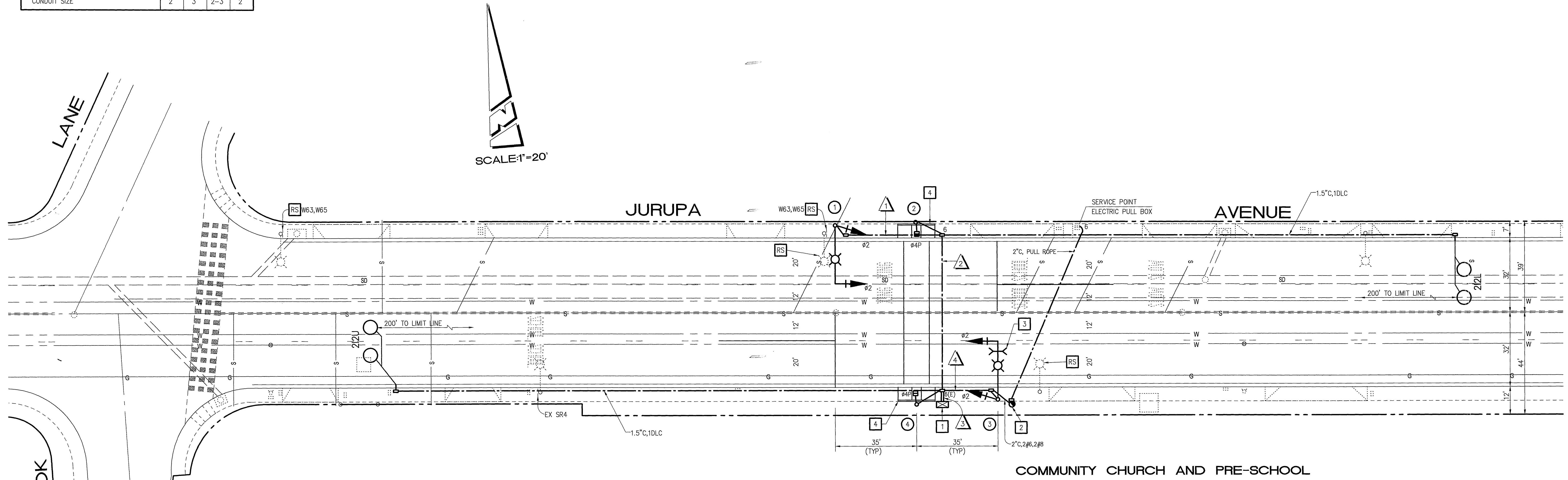

GENERAL NOTES:

- DETECTOR LOOPS SHALL BE INSTALLED IN THE PRESENCE OF THE TRAFFIC ENGINEER OR HIS REPRESENTATIVE.
- ALL SIGNING, STRIPING, AND PAVEMENT MARKINGS REQUIREMENTS SHALL BE COMPLETED AT LEAST ONE DAY PRIOR TO TURN-ON.
- TYPICAL DETECTOR LOOP SPACING: 10', 15', 30' (WHERE APPLICABLE).
- PAVEMENT DELINEATION SHOWN HEREON IS FOR REFERENCE ONLY. CITY FORCES SHALL PERFORM ALL PERMANENT PAINTING (INSTALLATION AND REMOVALS) WORK.
- ALL VEHICLE HEADS SHALL HAVE 12" LENSES WITH RED, YELLOW, AND GREEN 'LED' TYPE INDICATIONS.
- PEDESTRIAN SIGNAL HEADS SHALL HAVE 'LED' TYPE INDICATIONS.
- PEDESTRIAN PUSH BUTTONS SHALL BE ADA APPROVED TYPE.

CONSTRUCTION NOTES (THIS SHEET):

- INSTALL CITY-FURNISHED MODEL 170 CONTROLLER ASSEMBLY WITH MODEL 332 CABINET. INSTALL 3M OPTICOM PHASE SELECTOR MODULE.
- INSTALL 120V SIGNAL AND 240V STREET LIGHT SERVICE PER STANDARD DWG. NO. 667.
- INSTALL 3M OPTICOM DETECTOR MODEL 722 ON MAST ARM BY CLAMPING METHOD. EXACT LOCATION OF DETECTOR TO BE DETERMINED BY ENGINEER IN THE FIELD.
- CONSTRUCT P.C.C. CURB RAMP PER CITY STD. (2 EA.)



TRAFFIC No. 1575
 DATE: 6-13-01
 ACA Job No.: 134-003
 ACA File Name: JURMEASG
 Print Date: 6/13/01
 Last Revision: 6/13/01

ALBERT GROVER & ASSOCIATES
 TRANSPORTATION CONSULTING ENGINEERS
 311 E. Imperial Hwy., Suite 208 Fullerton, CA 92835
 (714) 992-2000
 FAX 992-2883

Underground Service Alert
 Call TOLL FREE
 1-800
 227-2600
 TWO WORKING DAYS BEFORE YOU DIG

CITY OF RIVERSIDE, CALIFORNIA DEPARTMENT OF PUBLIC WORKS				TRAFFIC SIGNAL PLAN		ACCOUNT NO.
APPROVED BY	DATE	BY	APPROVED BY	DATE	BY	
PRINCIPAL ENGINEER	8/14/01	R.M. Grover	R.M. Grover	8-20-2001		
INSPECTION	8/14/01	R.M. Grover	PUBLIC WORKS DIRECTOR			
TRAFFIC DIVISION	8/13/01	R.M. Grover				
CHIEF P. W. ENGINEER	8/13/01	R.M. Grover				
PUBLIC UTILITIES	8/13/01	R.M. Grover				
DESIGNED BY	DRAWN BY	CHECKED BY	HORIZ. SCALE: 1" = 20'		VERT. SCALE: 1" = -	
			JURUPA AVENUE E/O MEADOWBROOK LANE		X-251	
					SHEET ___ OF ___	