

CONDUCTOR		TABLE							
CONTROL FUNCTION	CONDUCTORS	CONDUCTOR RUNS							
		1	2	3	4	5	6	7	8
VEHICLE & PEDESTRIAN HEADS, PEDESTRIAN PUSH BUTTONS, SPARES & COMMONS	12 CONDUCTOR IMSA	1	1	2	3	7	3	2	1
	3 CONDUCTOR IMSA	-	1	2	3	6	2	1	-
DETECTOR CABLE	#16/2	-	-	-	-	1	1	1	1
PHASE 1		-	-	-	2	2	-	-	-
PHASE 2		-	-	-	1	1	-	-	-
PHASE 4		-	-	-	1	1	-	-	-
PHASE 5		-	-	1	1	-	-	-	-
PHASE 6		-	-	-	2	2	2	2	2
PHASE 8		-	1	1	1	1	-	-	-
TOTALS		-	1	1	4	8	4	3	3
EVPE CABLE	#20/4	1	1	2	2	4	1	1	-
IISNS	#12	2	2	2	2	-	2	2	-
LUMINAIRES	#8	2	2	2	2	-	2	2	-
SIGNAL SERVICE	#6	-	-	-	2	2	-	-	-
CONDUIT SIZE		2"	3"	3"	3.5"	2-3.5"	3.5"	3"	2"

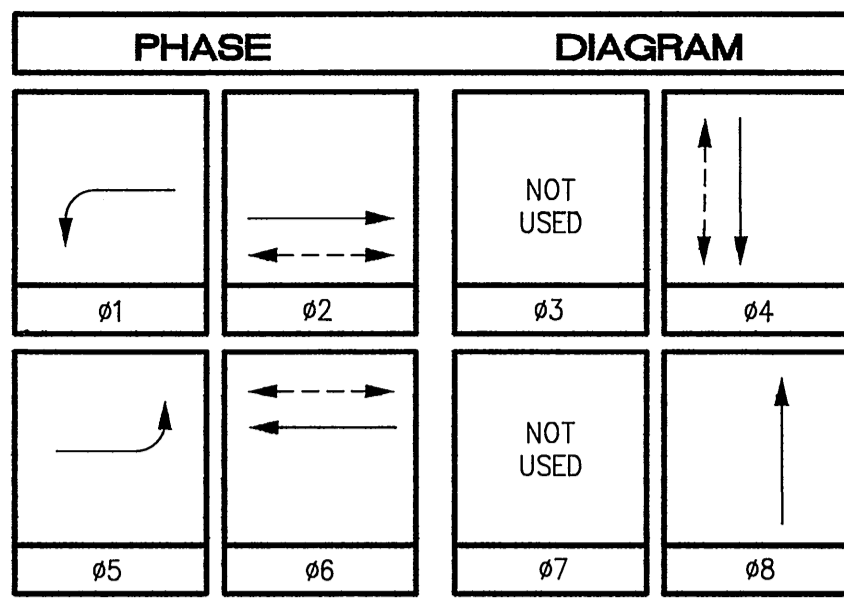

POLE		SCHEDULE											
No.	TYPE	STANDARD				LUMINAIRE HPS	IISNS LEGEND	SIGNAL MOUNTING				PPB PHASE	REMARKS
		HGT.	SIG. M.A.	LUM. M.A.	VEHICLE			VEHICLE	VEHICLE	VEHICLE			
1	26-4-129	30'	45'	12'	250W	Chapala Ave 5100	MAS	MAS	SV-1-T	SP-1-T	((P))	φ4	
2	1-A	7'	-	-	-	-	-	-	-	-	((C))	φ6	
3	17-2-129	30'	20'	12'	250W	Central Ave 1100	-	MAS	SV-1-T	-	-	-	φ6
4	1-A	10'	-	-	-	-	-	-	TV-1-T	SP-1-T	((P))	-	
5	26-4-129	30'	45'	12'	250W	Chapala Ave 5200	MAS	MAS	SV-1-T	SP-1-T	((P))	-	
6	PPB POST	40"	-	-	-	-	-	-	-	-	-	φ2	
7	17-2-129	30'	20'	12'	250W	Central Ave 1200	-	MAS	SV-1-T	SP-1-T	((C))	φ2	
8	1-A	10'	-	-	-	-	-	-	TV-1-T	SP-1-T	((P))	φ4	

((C)) OR ((P)) - INDICATES AUDITORY PEDESTRIAN SIGNAL TO BE INSTALLED; ((C)) INDICATES CUCKOO SOUND; ((P)) INDICATES PEEP-PEEP SOUND.

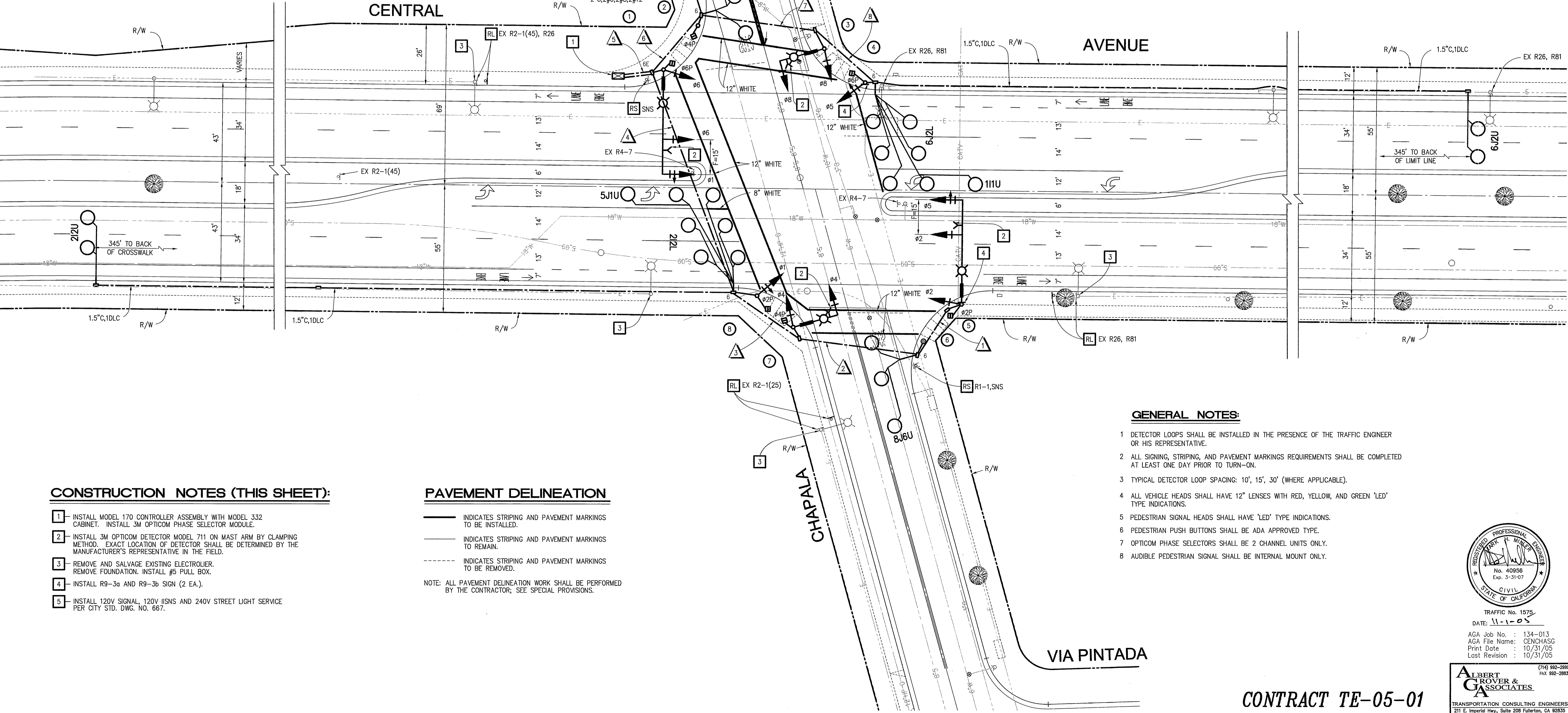

CONSTRUCTION NOTES (THIS SHEET):

- 1 - INSTALL MODEL 170 CONTROLLER ASSEMBLY WITH MODEL 332 CABINET. INSTALL 3M OPTICOM PHASE SELECTOR MODULE.
- 2 - INSTALL 3M OPTICOM DETECTOR MODEL 711 ON MAST ARM BY CLAMPING METHOD. EXACT LOCATION OF DETECTOR SHALL BE DETERMINED BY THE MANUFACTURER'S REPRESENTATIVE IN THE FIELD.
- 3 - REMOVE AND SALVAGE EXISTING ELECTROLIER. REMOVE FOUNDATION. INSTALL #5 PULL BOX.
- 4 - INSTALL R9-3a AND R9-3b SIGN (2 EA.).
- 5 - INSTALL 120V SIGNAL, 120V IISNS AND 240V STREET LIGHT SERVICE PER CITY STD. DWG. NO. 667.

PAVEMENT DELINEATION

- INDICATES STRIPING AND PAVEMENT MARKINGS TO BE INSTALLED.
 - INDICATES STRIPING AND PAVEMENT MARKINGS TO REMAIN.
 - - - - INDICATES STRIPING AND PAVEMENT MARKINGS TO BE REMOVED.
- NOTE: ALL PAVEMENT DELINEATION WORK SHALL BE PERFORMED BY THE CONTRACTOR; SEE SPECIAL PROVISIONS.

GENERAL NOTES:

- 1 DETECTOR LOOPS SHALL BE INSTALLED IN THE PRESENCE OF THE TRAFFIC ENGINEER OR HIS REPRESENTATIVE.
- 2 ALL SIGNING, STRIPING, AND PAVEMENT MARKINGS REQUIREMENTS SHALL BE COMPLETED AT LEAST ONE DAY PRIOR TO TURN-ON.
- 3 TYPICAL DETECTOR LOOP SPACING: 10', 15', 30' (WHERE APPLICABLE).
- 4 ALL VEHICLE HEADS SHALL HAVE 12" LENSES WITH RED, YELLOW, AND GREEN 'LED' TYPE INDICATIONS.
- 5 PEDESTRIAN SIGNAL HEADS SHALL HAVE 'LED' TYPE INDICATIONS.
- 6 PEDESTRIAN PUSH BUTTONS SHALL BE ADA APPROVED TYPE.
- 7 OPTICOM PHASE SELECTORS SHALL BE 2 CHANNEL UNITS ONLY.
- 8 AUDIBLE PEDESTRIAN SIGNAL SHALL BE INTERNAL MOUNT ONLY.



TRAFFIC No. 1575
 DATE: 11-1-05
 AGA Job No. : 134-013
 AGA File Name: CENCHASG
 Print Date : 10/31/05
 Last Revision : 10/31/05

ALBERT GROVER & ASSOCIATES
 TRANSPORTATION CONSULTING ENGINEERS
 211 E. Imperial Hwy., Suite 208 Fullerton, CA 92835
 (714) 992-2990
 FAX 992-2883

CONTRACT TE-05-01



CITY OF RIVERSIDE, CALIFORNIA DEPARTMENT OF PUBLIC WORKS		TRAFFIC SIGNAL PLAN		ACCOUNT NO.
APPROVED BY: <i>Allen Boyd</i> DATE: 12/12/05 TRAFFIC DIVISION: 12/15/05 PUBLIC UTILITIES: 12/12/05		APPROVED BY: <i>Allen Boyd</i> DATE: 12/14/05 CITY ENGINEER		X-280
DESIGNED BY: IS DRAWN BY: IS CHECKED BY: JAT		HORIZ. SCALE: 1" = 20' VERT. SCALE: N/A		SHEET 1 OF 1