

CONDUCTOR TABLE

CONTROL FUNCTION	CONDUCTORS	CONDUCTOR RUNS									
		1	2	3	4	5	6	7	8	9	
VEHICLE & PEDESTRIAN HEADS, PEDESTRIAN PUSH BUTTONS, SPARES & COMMONS	12 WIRE IMSA 9 WIRE IMSA 5 WIRE IMSA 3 WIRE IMSA	2	2	1	1	1	1	1	3	2	1
DETECTOR CABLE	#16/2										
PHASE 1		1	1		1	1					
PHASE 2		1	1	1							
PHASE 3											
PHASE 4		1	1								
PHASE 5		1	1	1							
PHASE 6		2	2		2						
PHASE 7											
PHASE 8		1	1		1	1	1				
I.I.S.N.S.	#12		2	2	2	2	2	2	2		
LUMINAIRES	#8		2	2	2	2	2	2	2		
SIGNAL SERVICE	#6	2									

CONDUIT SIZE	3"	2.5"	1.5"	2.5"	2.5"	2"	1.5"	1.5"	2"
	(E)	(E)	(E)	(E)	(E)	(E)	(E)	(E)	(N)

NOTE:
SIGNAL SYSTEM SHALL HAVE NEW CABLES AND CONDUCTORS; SEE CONTRACT SPECIAL PROVISIONS FOR ADDITIONAL INFORMATION ON I.M.S.A. CABLE.

POLE SCHEDULE

No.	TYPE	STANDARD		LUM HPSV	I.I.S.N.S. LEGEND	SIGNAL HEAD	SIGNAL MOUNTING VEHICLE	PPF PHASE	REMARKS
		HGT.	SIG. M.A.						
(A)	24-4-80(N)	30'	35'(N)	12'(N)	250W(R)CORTEZ(N)	ST 3700 1W3C(N)	MAS(N)		
						1W3C(N)	MAS(N)		
						2W3C(N)	SV-2-TD(N)		
(B)	1A(E)	10'				1W3C(N)	TV-1-T(N)	SP-1-T(E)	6(E)
(C)	17-2-80(N)	30'	20'(N)	12'(N)	200W(N)MAGNOLIA(N)	AV 7600 1W3C(N)	MAS(N)		
						1W3C(N)	SV-2-TD(N)	SP-2-T(N)	6,8(N)
(D)	26-4-80(N)	30'	45'(N)	12'(N)	250W(R)CORTEZ(N)	ST 3700 1W3C(N)	MAS(N)		
						1W3C(N)	MAS(N)		
						1W3C(N)	SV-1-T(N)	SP-1-T(N)	8(N)
(E)	TYPE 1(E)	10'				1W3C(E)	TV-1-T(E)	SP-1-T(E)	2(E)
									ROTATE PED. SIGNAL AS INDICATED.
(F)	17-2-80(N)	30'	20'(N)	12'(N)	200W(R)MAGNOLIA(N)	AV 7700 1W3C(N)	MAS(N)		
						1W3C(N)	SV-1-T(N)	SP-1-T(N)	2(N)
(G)	1A(N)	10'				1W3C(N)	TV-1-T(N)	SP-1-T(N)	

1. NEW VEHICULAR HEADS SHALL HAVE ALL 12" LENSES.
2. NEW LEFT-TURN HEADS SHALL HAVE ALL ARROWS.
3. EQUIPMENT NOT TO BE REUSED SHALL BE SALVAGED.
4. (N) = NEW, (E) = EXISTING AND (R) = RELOCATED.

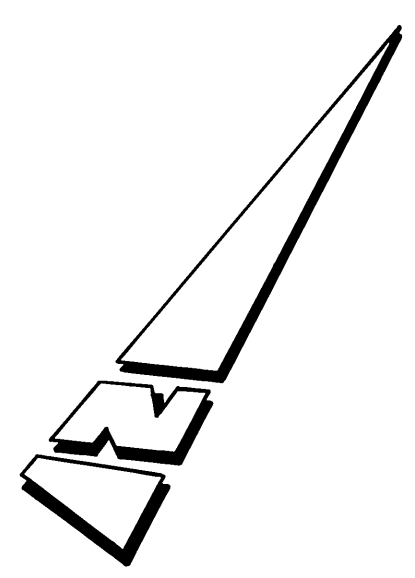

RAMONA HIGH SCHOOL PARKING LOT

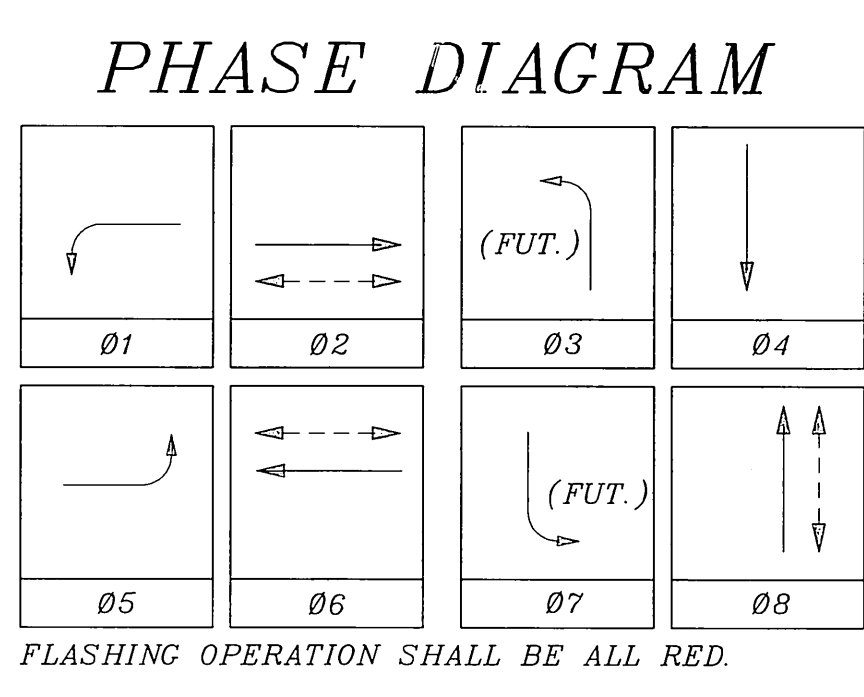
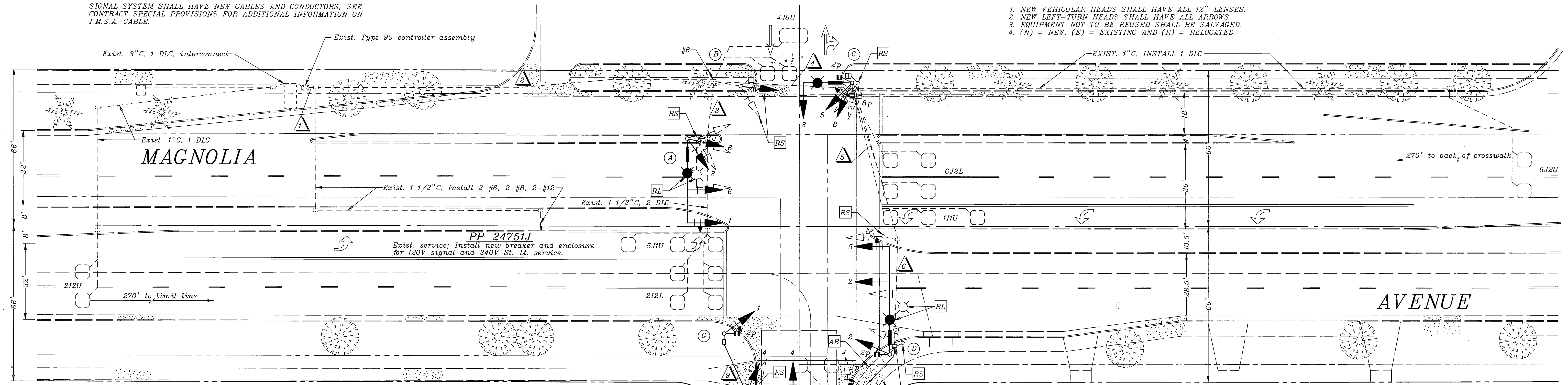

CONTRACT TE-96-5
FEDERAL AID PROJECT NO. CMLN-5058(20)
CONTRACTOR'S LICENSE REQUIREMENTS "A" OR "C-10"

IMPORTANT NOTICE
Section 4216/4217 of the Government Code requires a Dig Alert Identification Number to be issued before a "Permit to Excavate" will be valid. For your Dig Alert ID, Number call CALL TOLL FREE TWO WORKING DAYS BEFORE YOU DIG UNDERGROUND SERVICE ALERT 1-800-227-2600

ENGINEER IN RESPONSIBLE CHARGE
Richard D. McGrath
R.C.E. No. 31952 expires 12-31-96
DATE 5-30-96

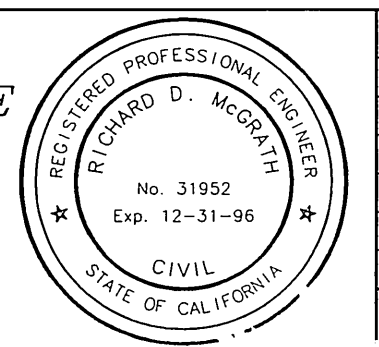

MARK	REVISIONS	APPR.	DATE

CITY OF RIVERSIDE, CALIFORNIA
DEPARTMENT OF PUBLIC WORKS
APPROVED BY: [Signature]
PRINCIPAL ENGINEER: [Signature]
P.W. INSPECTOR: [Signature]
TRAFFIC DIVISION CHIEF P.W. ENGR: [Signature]
PUBLIC UTILITIES: [Signature]

TRAFFIC SIGNAL MODIFICATION
MAGNOLIA AVENUE @ CORTEZ STREET
SCALE: 1" = 20'

ACCT. NO. 0430-541600-440125-35060
X-301A
SHEET 1 OF 1
FILE NAME: X301A.DWG

CONDUCTOR SCHEDULE

CONDUCTOR RUN	1				2				3				4				5				6				7				8				9							
CONDUCTORS	8	10	12	14	8	10	12	14	8	10	12	14	8	10	12	14	8	10	12	14	8	10	12	14	8	10	12	14	8	10	12	14	8	10	12	14				
Ø A																																								
Ø A, W-DW																																								
Ø B																																								
Ø B, W-DW																																								
SPARES																																								
120 V. NEUTRAL																																								
Ø B P.P.B.																																								
Ø B DET.																																								
12 V. NEUTRAL																																								
LUMINAIRES																																								
TOTAL CONDUCTORS	2	1	5	25	2	1	3	19	2	1	3	18	2	1	3	14	2	1	2	8	2	1	2	8	2	1	2	8	2	1	2	8	2	1	2	8	2	1	2	8
CONDUIT SIZE	2 1/2" C				2 1/2" C				2 1/2" C				2" C				1 1/2" C				1 1/2" C				1 1/2" C				1 1/2" C											

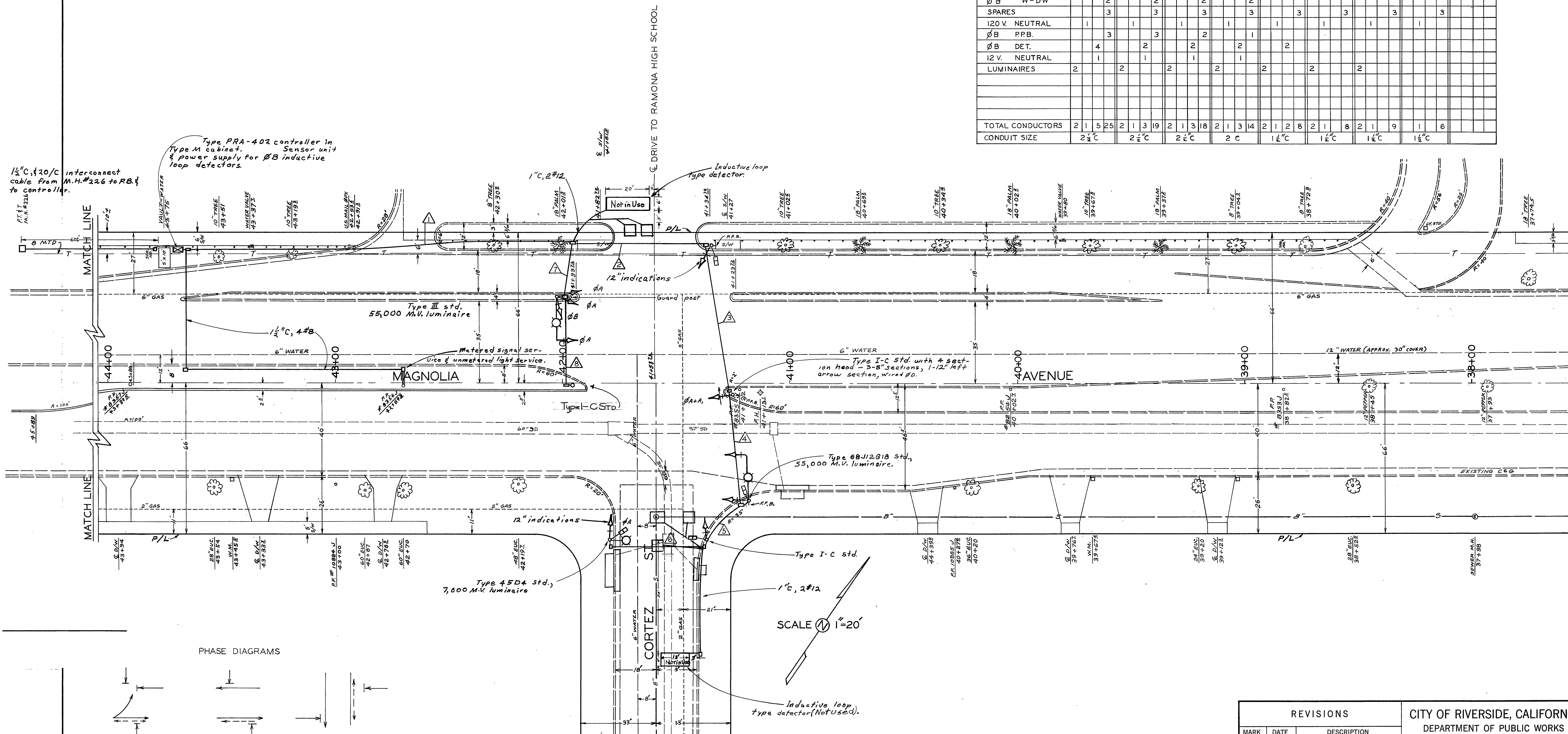

PHASE DIAGRAMS

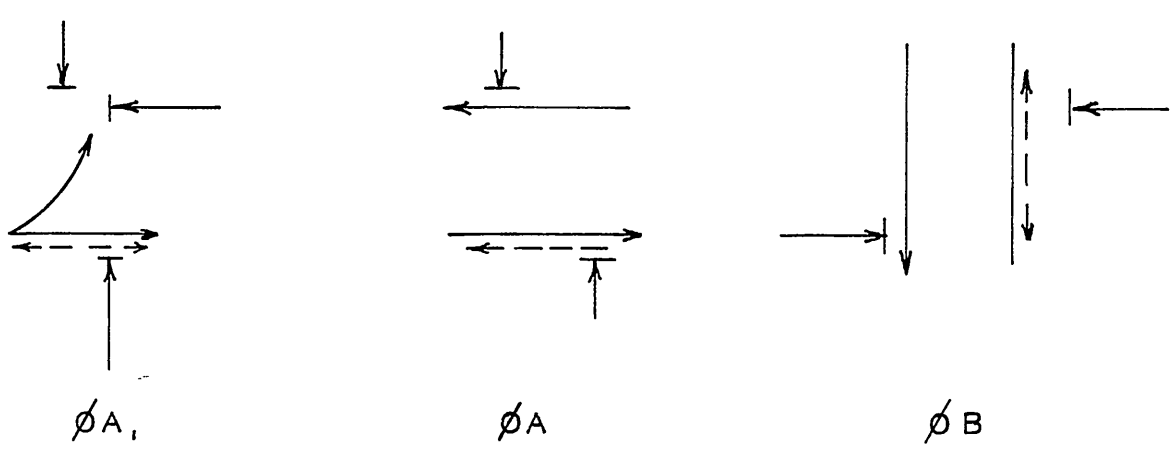

FLASHING INDICATIONS
ØA-YELLOW, ØB-RED

REVISIONS			CITY OF RIVERSIDE, CALIFORNIA DEPARTMENT OF PUBLIC WORKS	
MARK	DATE	DESCRIPTION		
	2/18/65	As Built	A.B.D.	
	6/20/72	Remove w/s mechan	J.M.W.	
	7/1/74	Loop modification	P.L.B.	
	3/7/77	As Built - STORM DRAIN		
DESIGNED BY		SUBMITTED BY		APPROVED BY
DRAWN BY <i>RK</i>		PARK DEPT. TRAFFIC DIV.		DIRECTOR OF PUBLIC WORKS
CHECKED BY		RECOMMENDED BY		ASSISTANT CITY ENGINEER
			DATE	PROJ. NO. X-301A
				SHEET OF

MAGNOLIA AVE.
& CORTEZ ST.
TRAFFIC SIGNALS

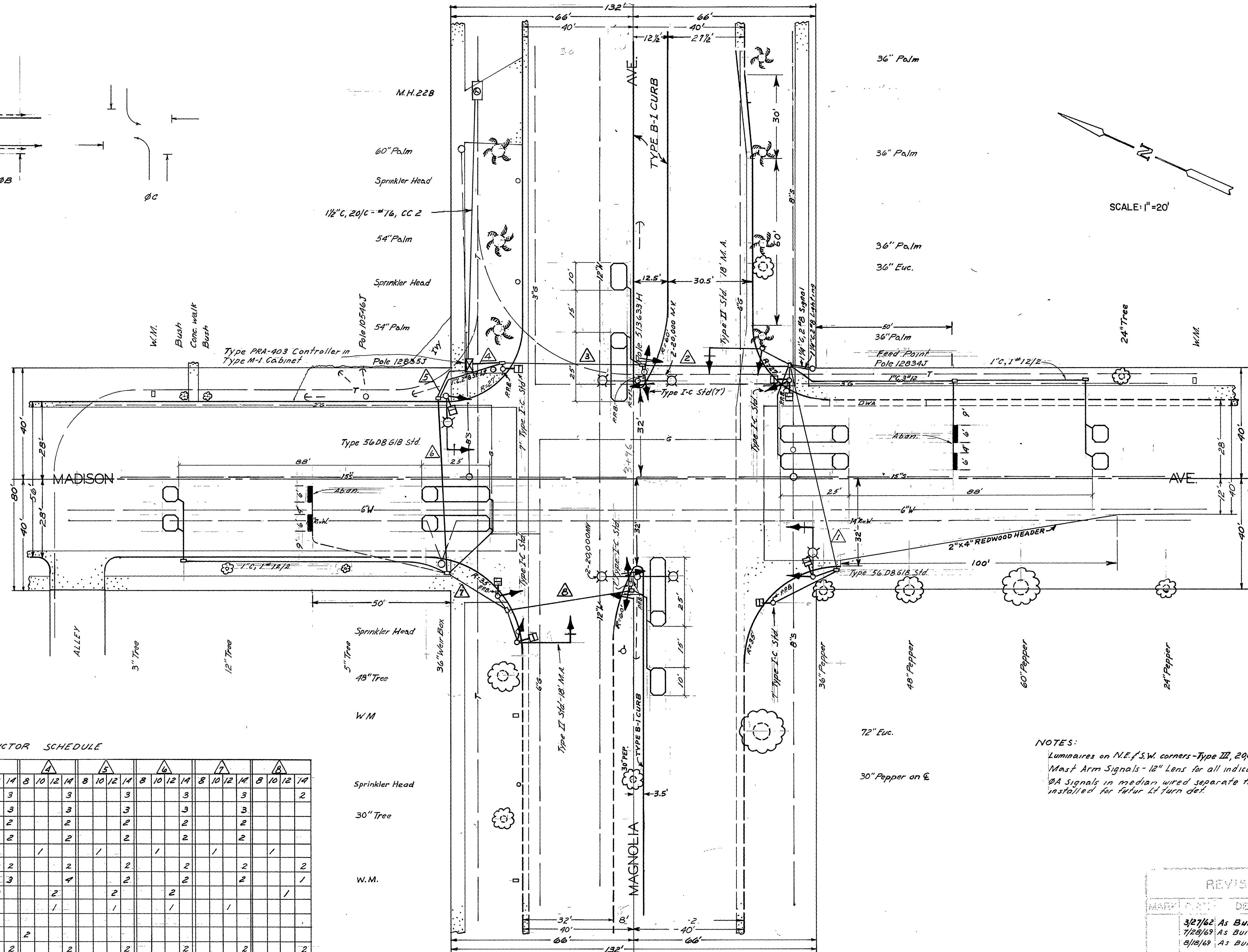
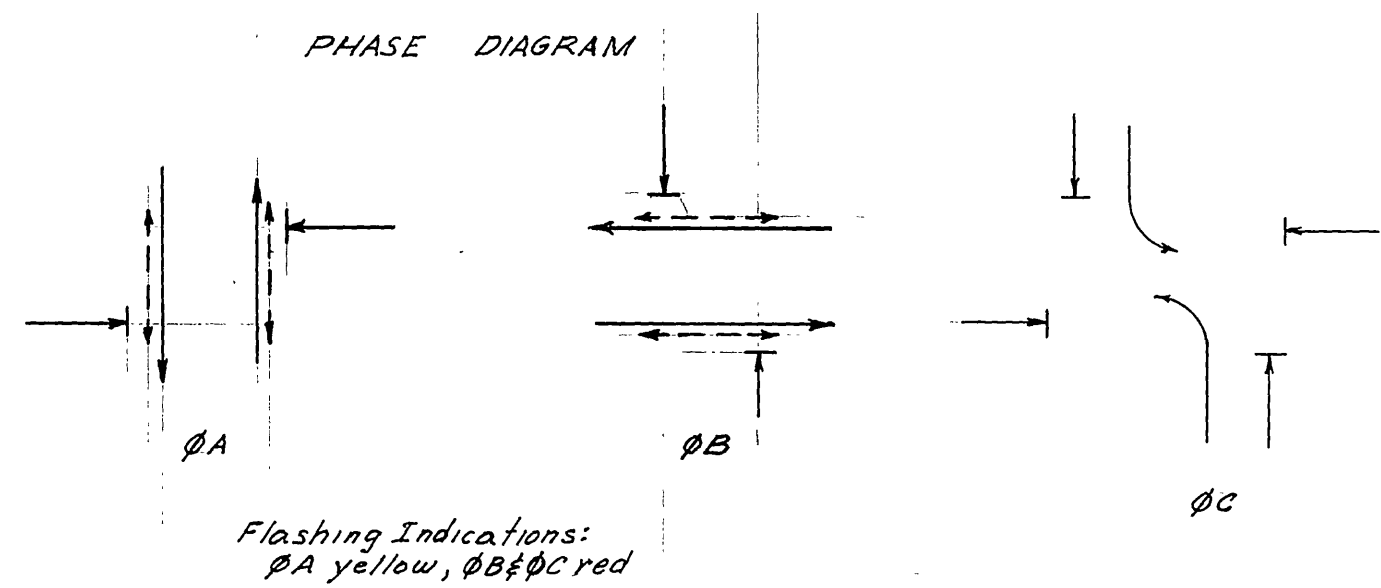

SCALE: 1"=20'

CONDUCTOR SCHEDULE

CONDUCTOR RUN	1			2			3			4			5			6			7			8		
	8	10	14	8	10	14	8	10	14	8	10	14	8	10	14	8	10	14	8	10	14	8	10	14
ØA																								
ØB			3			3			3			3			3			3			3			3
ØA W-DW			2			2			2			2			2			2			2			2
ØB W-DW			2			2			2			2			2			2			2			2
110 V Neutral	1			1			1			1			1			1			1			1		
Spares			3			3			2			2			2			2			2			2
ØB P.P.B.			1			2			3			4			2			2			2			1
ØB Det.						2			2			2			2			2			2			1
12 V Neutral	1			1			1			1			1			1			1			1		
Luminaires	2			2			2			2			2			2			2			2		
Signal Service			2			2			2			2			2			2			2			2
ØC Lt. Turn Det.									2			2			2			2			2			2
ØC									3			3			3			3			3			3
TOTAL CONDUCTORS	2	1	11	4	1	15	4	1	4	20	2	1	4	19	1	4	19	1	2	19	1	2	10	
CONDUIT SIZE	1 1/2"			2"			2"			2"			2"			2"			2"			1 1/2"		

NOTES:
Luminaires on N.E. & S.W. corners - Type III, 29000 lumen, multiple, built-in ballast.
Mast Arm Signals - 12" Lens for all indications.
ØA Signals in median wired separate from other ØA signals & conductors installed for future Lt. Turn det.

REVISIONS		CITY
DATE	DESCR. / FIG.	DEPT.
3/27/62	As Built	ADD
7/28/69	As Built (Loop Det.)	JMW
8/18/69	As Built (ØC Signal)	JMW

TRAFFIC SIGNALS
MAGNOLIA AVE. — MADISON AVE.

APPROVED BY: [Signature]
DRAWN BY: [Signature]
CHECKED BY: [Signature]

4/5/62

X-301