

CONDUCTOR SCHEDULE

CONTROL FUNCTION	CONDUCTORS SIZE INSULATION	CONDUIT RUN							
		1	2	3	4	5	6	7	8
Vehicle Heads	#14								
ØA		3	3	3	3	6	6		
ØB			3	3	3	9	9	3	
ØC (Future)					3	6	6	3	3
Pedestrian Heads									
ØA (W-OH)			2	2	2	6	6	2	
ØB (W-OH)		2	2	2	2	6	6	2	
Fed. Push Buttons									
Ø B		1	1	2	3	6	6	2	1
Detector Cable	#12/2								
1Ø			1	1	1	1	1		
2Ø								1	
ØC (Future)					1	2	2	1	1
Spares	#14	3	3	3	3	6	6	3	3
120V Common	#10	1	1	1	1	2	2	1	1
12V Common	#12	1	1	1	1	2	2	1	1
Luminaire	#8	2	2	2	2	2	2	2	2
Signal Service						2	2	2	2
Totals	#14	9	14	15	19	45	45	15	7
	#12/2	1	1	2	3	4	1	1	
	#12	1	1	1	1	2	2	1	1
	#10	1	1	1	1	2	2	1	1
	#8	2	2	2	2	2	2	4	4
Conduit size		2"	2"	2"	2 1/2"	3"	3"	2"	2"

PHASE DIAGRAM

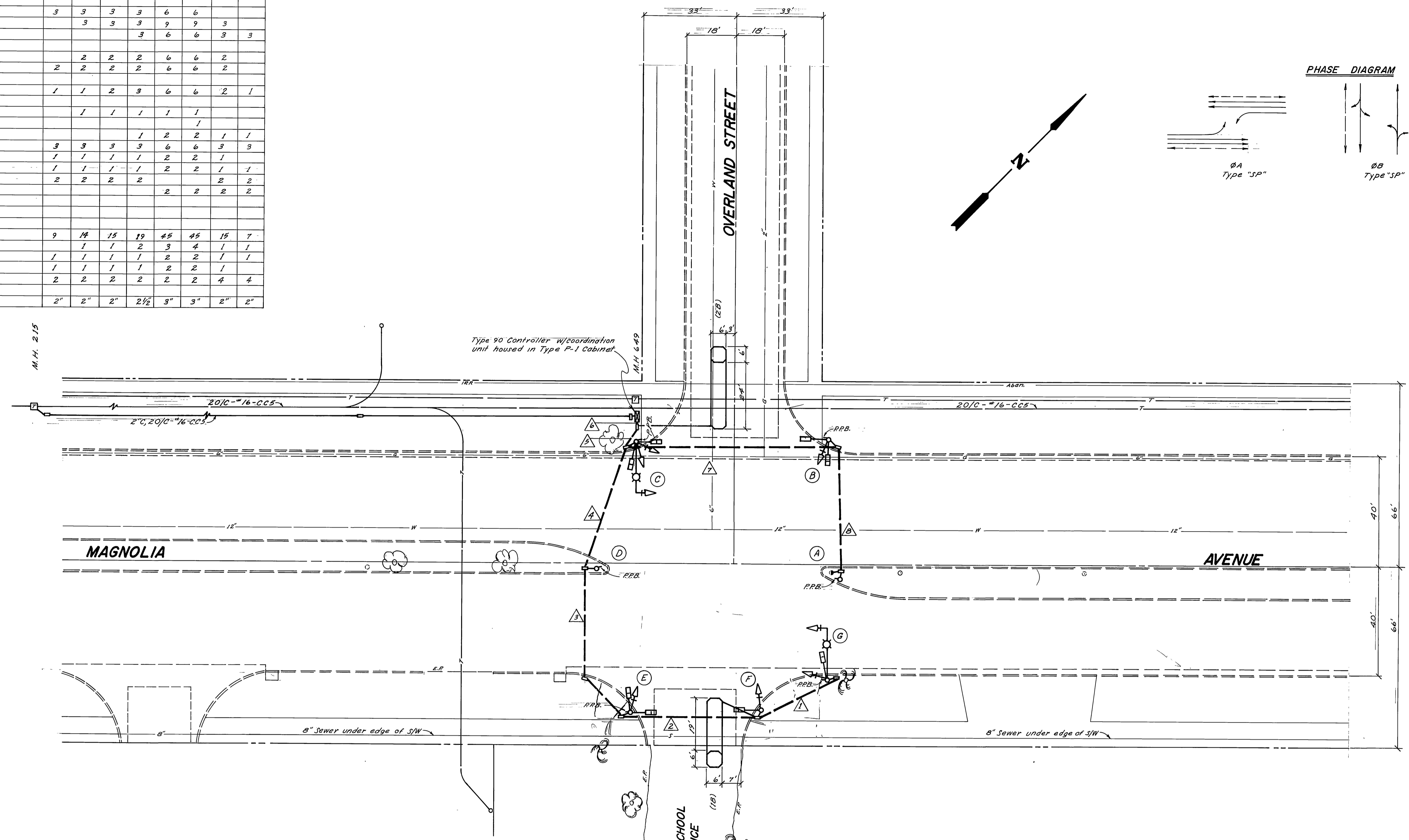
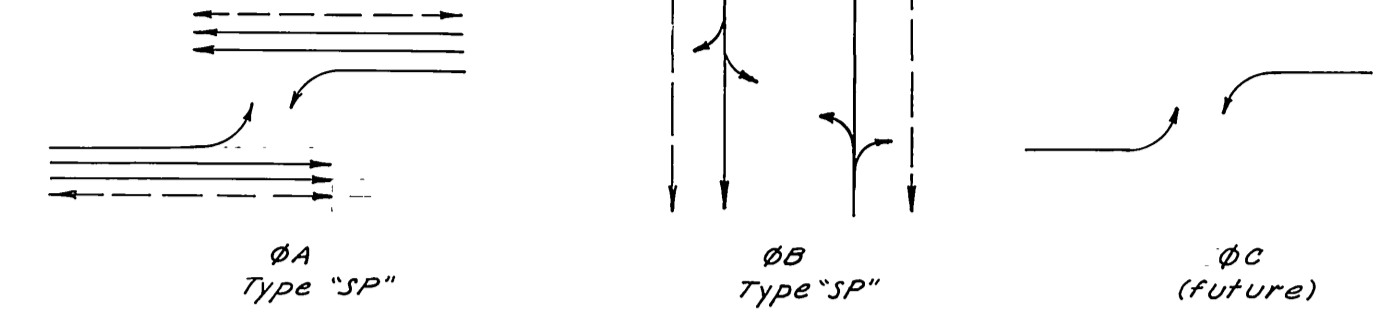

EQUIPMENT SCHEDULE

LOC.	STD.	VEHICLE EQUIPMENT				PEDESTRIAN EQUIPMENT			LUMINAIRES
		HEADS	MTG.	BK. PLATE	LOUVER	HEADS	MTG.	PPB'S	
A	P.B. Post								
B	Type -1	1-W3C(12)	A-1	1		2-W2C	W-3	1	
	(Alum.)								
C	PUMCO	1-W3C(12)	M-2	1				400 watts	
	TC-7010	2-W3C(8)	B-2	1		2-W2C	W-3	1	
D	P.B. Post								
E	Type -1	1-W3C	A-1	1		2-W2C	W-3	1	
	(Alum.)								
F	Type -1	1-W3C(12)	A-1	1		1-W2C	W-0		
	(Alum.)								
G	PUMCO	1-W3C(12)	M-2	1				400 watts	
	TC-7010	1-W3C	B-1	1		1-W2C	W-0	1	

CITY OF RIVERSIDE, CALIFORNIA PUBLIC WORKS DEPARTMENT				TRAFFIC SIGNALS		ACCOUNT NO.
APPROVED BY: _____ BY: _____ DATE: _____				APPROVED BY: _____		DRAWING NUMBER
DESIGNED BY: _____ DRAWN BY: JMW CHECKED BY: _____				DATE: _____		X-306
MARK: _____ REVISIONS: _____ APPR. DATE: _____				CHIEF PUB. WKS. ENGR. _____		SHEET 1 OF 1
				SCALE: 1" = 20'		