

CONDUCTOR SCHEDULE												
AWG	CONDUCTOR	CONDUIT RUN										
		1	2	3	4	5	6	7	8	9	10	11
#14	Ø1	3	3	3	3	3	3	3	3	3	3	3
	Ø2											
	Ø3	3	3	3	3	3	3	3	6	3	3	3
	Ø4											
	Ø5											
	Ø6	3	3	3	3	3	3	3	3	3	3	3
	Ø2PED											
	Ø3PED											
	Ø4PED	2	2	2	2	2	2	2	2	2	2	2
	Ø6PED	2	2	2	2	2	2	2	2	2	2	2
	Ø2 BIKE PB											
	Ø3PPB											
	Ø4PPB	1	1	1	2	2	2	2	2	2	2	2
	Ø6PPB	1	1	1	1	1	1	1	1	1	1	1
PPB COMMON	1	1	1	1	1	1	1	1	1	1	1	
SPARE	3	3	3	3	3	3	3	6	3	3	3	
TOTAL #14	10	19	19	23	27	30	38	54	16	16	16	
#12	I.S.N.S.		2	2	2	2	2	2	2	2	2	
#10	SIGNAL COMMON	1	1	1	1	1	1	1	2	1	1	
#8	LUMINAIRE		2	2	2	2	2	2				
#6	SERVICE								2			
DLC	Ø1								3	3		
	Ø2											
	Ø3											
	Ø4	3	3	3	3	3	3	3	3	3	3	
	Ø5											
	Ø6									4	4	
	Ø6 BIKE									1	1	
TOTAL DLC	3	3	6	10	10	12	12	20	8	5		
INTERCONNECT CABLE												
CONDUIT SIZE		2 1/2"	2 1/2"	3"	3 1/2"	3 1/2"	3 1/2"	2-3"	3"	2 1/2"	2"	

POLE SCHEDULE												
NO.	POLE	TYPE	HEIGHT	MAST ARM LENGTH		SIGNAL MOUNTING			PPB	H.P.S.	I.S.N.S. LEGEND	REMARKS
				SIGNAL	LUMINAIRE	MA	POLE	PED				
(A)	29A-5-80	35'	55'	15'	3-MAS	SV-1-T	SP-1-T	Ø4	2	400 W.	Hole St 3800	
(B)	TYPE 30	35'		15'		SV-1-T	SP-1-T	Ø4	2	400 W.		Ø2 BIKE PUSH BUTTON
(C)	19A-3-80	35'	25'	15'	MAS	TV-1-T	SP-1-T	Ø2	1	400 W.	Magnolia Ave 10100	
(D)	TYPE 30	35'		15'		SV-1-T		Ø2	1	400 W.		
(E)	29A-5-80	35'	55'	15'	3-MAS	SV-1-T	SP-1-T	Ø3	4	400 W.	Hughes Ave 3700	Ø3 FUTURE PED. PUSH BUTTON
(F)	18-2-80	18'	20'		MAS	SV-2-TB	SP-1-T	Ø6	1	400 W.	Magnolia Ave 10000	Ø3 FUTURE PED. PUSH BUTTON
(G)	1-A	10'				TV-1-T	SP-1-T	Ø6	3			

EXACT POLE LOCATION TO BE DETERMINED IN THE FIELD BY THE ENGINEER
 INSTALL ALL NEW POLES AND EQUIPMENT, REMOVE AND SALVAGE ALL EXISTING
 TYPE 1-A SHALL BE SPUN ALUMINUM

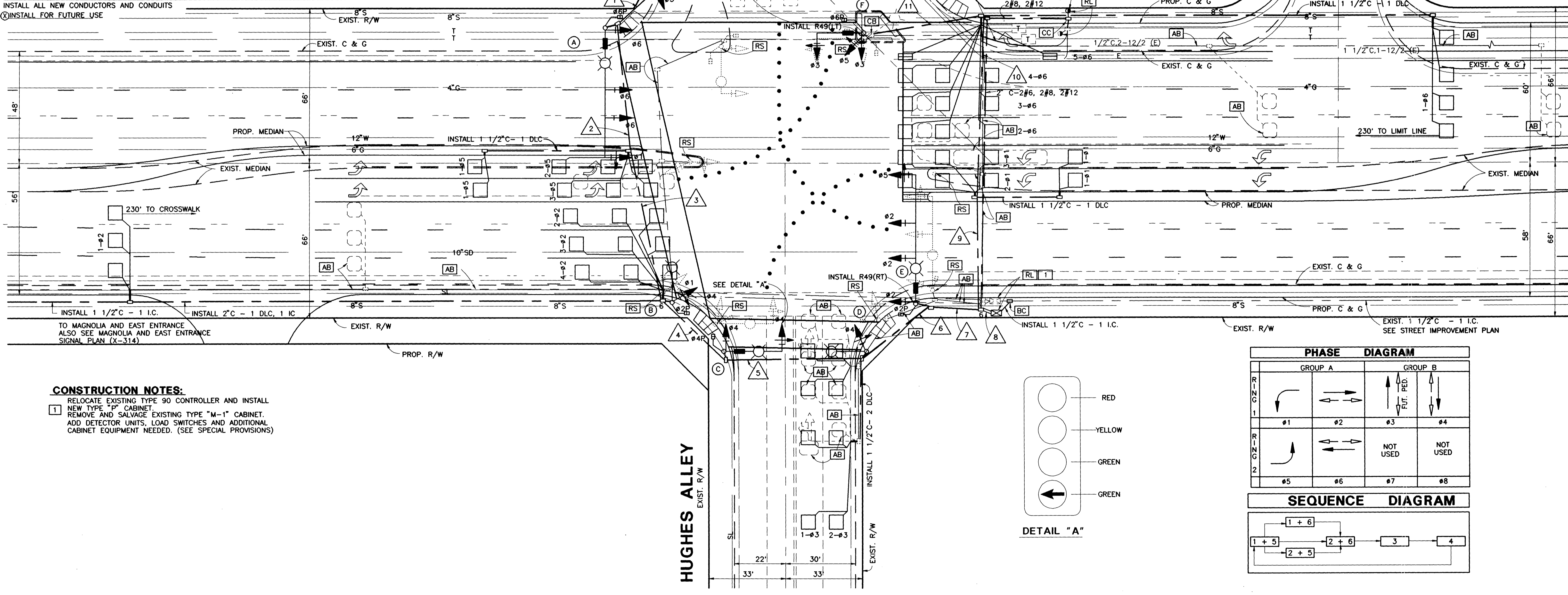
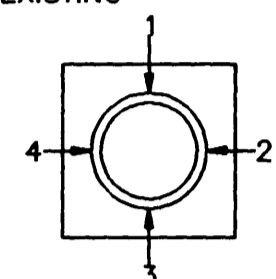

CONSTRUCTION NOTES:
 1 RELOCATE EXISTING TYPE 90 CONTROLLER AND INSTALL NEW TYPE "P" CABINET.
 REMOVE AND SALVAGE EXISTING TYPE "M-1" CABINET.
 ADD DETECTOR UNITS, LOAD SWITCHES AND ADDITIONAL CABINET EQUIPMENT NEEDED. (SEE SPECIAL PROVISIONS)

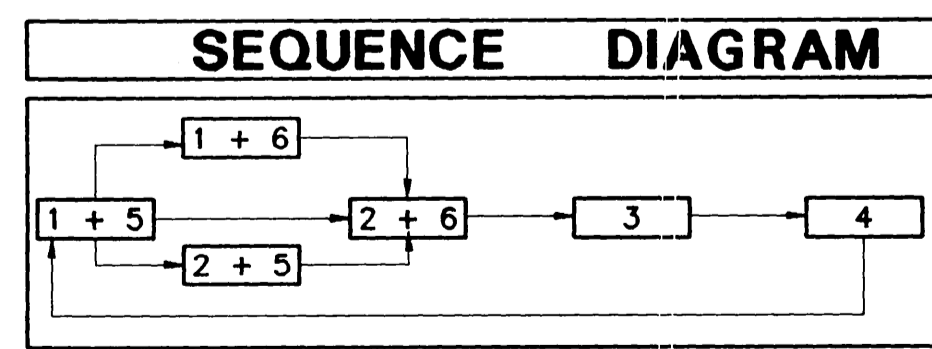
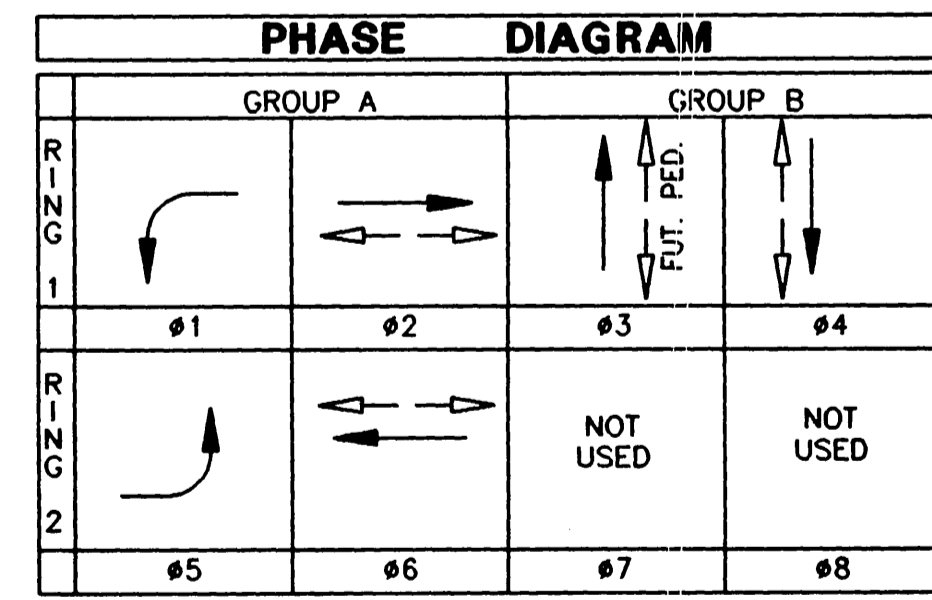
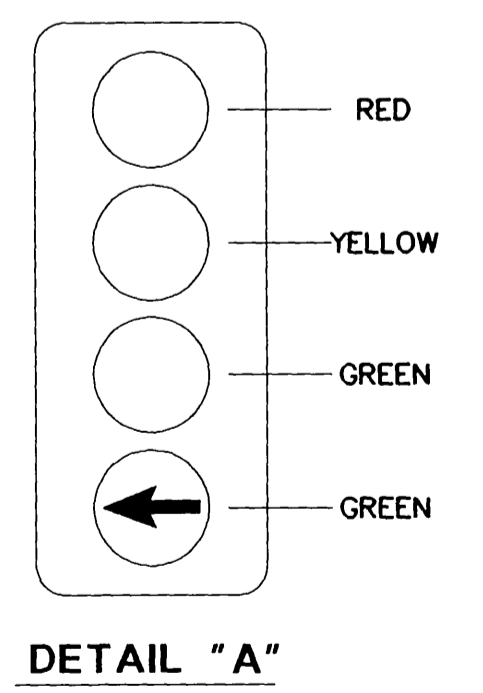

Underground Service Alert
 Call: TOLL FREE
 1 - 800
 422 - 4133
 TWO WORKING DAYS BEFORE YOU DIG

PRIVATE ENGINEERING NOTE
 CONSTRUCTION CONTRACTOR AGREES THAT IN ACCORDANCE WITH GENERALLY ACCEPTED CONSTRUCTION PRACTICES, CONSTRUCTION CONTRACTOR WILL BE REQUIRED TO ASSUME SOLE AND COMPLETE RESPONSIBILITY FOR JOB SITE CONDITIONS DURING THE COURSE OF CONSTRUCTION OF THE PROJECT, INCLUDING SAFETY OF ALL PERSONS AND PROPERTY; THAT THIS REQUIREMENT SHALL BE MADE TO APPLY CONTINUOUSLY AND NOT BE LIMITED TO NORMAL WORKING HOURS, AND CONSTRUCTION CONTRACTOR FURTHER AGREES TO DEFEND, INDEMNIFY AND HOLD DESIGN PROFESSIONAL HARMLESS FROM ANY AND ALL LIABILITY, REAL OR ALLEGED, IN CONNECTION WITH THE PERFORMANCE OF WORK ON THIS PROJECT, EXCEPTING LIABILITY ARISING FROM THE SOLE NEGLIGENCE OF DESIGN PROFESSIONAL.

PREPARED UNDER THE DIRECTION OF
 REGISTERED CIVIL ENGINEER NO. 12977
 EXPIRATION DATE: 3/31/93 DATE:
 RECOMMENDED BY:
 James B. Dobbins DATE: 12-19-90

J.F. Davidson Associates, Inc.
 ENGINEERING PLANNING SURVEYING
 ARCHITECTURE LANDSCAPE ARCHITECTURE
 MUNICIPAL ENGINEERING DIVISION
 3426 TENTH STREET
 RIVERSIDE, CA 92502
 (714) 683-0209 FAX (714) 686-5807
 SCALE: 1" = 20'-0" BENCH MARK:
 DATE: NOVEMBER, 90

DESIGNED BY: K.T.O. DRAWN BY: KTO/RDW CHECKED BY: [Signature]

CITY OF RIVERSIDE, CALIFORNIA
 DEPARTMENT OF PUBLIC WORKS
 APPROVED BY: [Signature] BY: DATE: 12/20/90
 PRINCIPAL ENGINEER
 INSPECTION: [Signature]
 TRAFFIC DIVISION: [Signature]
 PUBLIC UTILITIES: [Signature]

TYLER MALL EXPANSION
 C.F.D. # 90-2 IMPROVEMENTS
 TRAFFIC SIGNAL MODIFICATION PLAN
MAGNOLIA AVENUE
 AND
HUGHES ALLEY, HOLE AVE
 HORIZ SCALE: 1" VERT. SCALE: 1"

PROJECT NO.
X-313
 SHEET 1 OF 1
 FILE NO:
 8911175

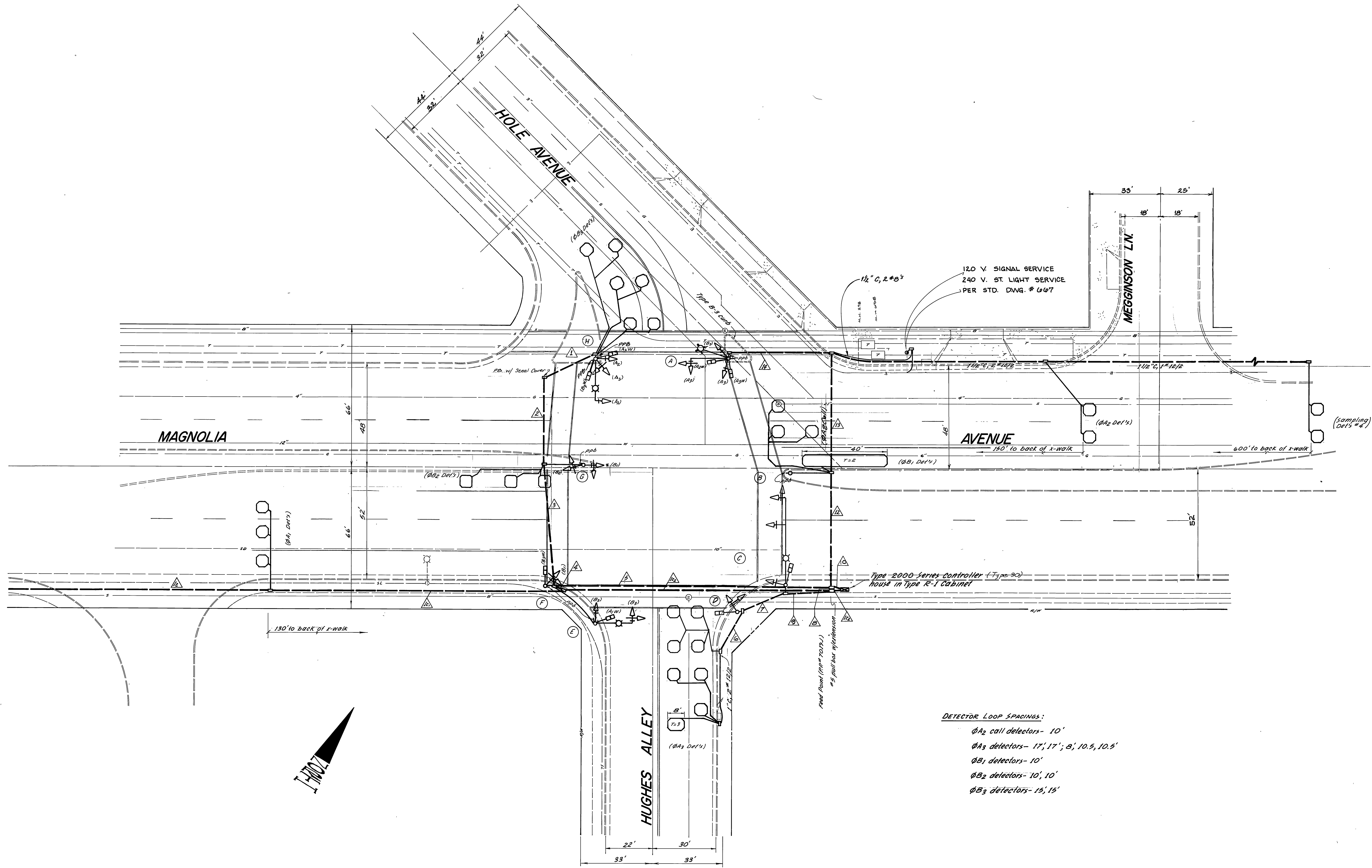

120 V. SIGNAL SERVICE
 240 V. ST. LIGHT SERVICE
 PER STD. DWG. # 607

DETECTOR LOOP SPACINGS:
 ϕA_2 call detectors- 10'
 ϕA_3 detectors- 17', 17'; 8', 10.5, 10.5'
 ϕB_1 detectors- 10'
 ϕB_2 detectors- 10', 10'
 ϕB_3 detectors- 15', 15'

Replaced damaged loops with Magnolia AS BUILT PER KELCO. S/E CORNER AS BUILT PER TRAF. DIVISION. COURSE AS BUILT PER CONTRACT TE-70-8		1/15/80 1/23/80 1/17/80 6-29-79	CITY OF RIVERSIDE, CALIFORNIA PUBLIC WORKS DEPARTMENT		TRAFFIC SIGNALS HUGHES ALLEY, HOLE & MAGNOLIA AVENUES	ACCOUNT No. DRAWING NUMBER X-313 SHEET 1 OF 2
APPROVED BY PRINCIPAL ENGINEER PARK DEPARTMENT TRAFFIC DIVISION CHIEF PUB. WKS. ENGR.	BY DATE	APPROVED BY DIRECTOR OF PUBLIC WORKS DATE	SCALE: 1" = 20'			

CONDUCTOR SCHEDULE

Control Function	Conductors		Conduit Run																	
	Size	Insulation	1	2	3	4	5	6	7	8	9	10	11	12	13	14	1c	1c1	1c2	1c3
Vehicle Heads	#14	T.W.																		
φA ₁											3	3								
φA ₂			3	3	3					3										
φA ₃			3	3	3					3			6	3	3	3	3			
φB ₁					3					3										
φB ₂					3					3										
φB ₃					3	3	3			3	6			6	3	3	3	3		
Pedestrian Heads																				
φA ₁								2	2	2										
φA ₂			2	2	2			2				4	2	2	2	2				
φA ₃												2	4	2	2	2	2			
φB ₁			2	2	2			2												
φB ₂																				
φB ₃																				
Ped. Push Button																				
φA ₁												2	1	1	1	1				1
φA ₂			1	1	1	1														1
φA ₃																				
φB ₁			1	1	2	3						1	3	2	2	1	1			3
Detector Cable	#12/2	U.S.E. or U.F.																		
φA ₁																				
φA ₂ + φA ₃ coil												2	2	2	1					
φA ₃												2								
φB ₁												1	1	1						
φB ₂					1	1														1
φB ₃			2	2	2	2														2
Sampling Det #4													1	1	1	1				
Spares	#14	T.W.	3	3	3	3	3	3			3	3	3	3	3	3				3
12V Common	#12		1	1	1		1	1	1			1	1	1	1	1				
120V Common	#10		1	1	1		1	1	1			1	1	1	1	1				
Luminaires	#8		2	2	2	2							2	2	2	2				2
Signal Service													2	2	2	2				
Interconnect	#10	R.E.																1	1	1
Totals	#14	T.W.	15	15	22	7	24	9	25		12	47	15	15	14	14				8
	#12	U.S.E. or U.F.	2	2	3	3						6	4	4	2					4
	#10	T.W.	1	1	1		1	1	1			1	1	1	1	1				
	#8		1	1	1		1	1	1			1	1	1	1	1				
	#6		2	2	2	2														2
	#10	R.E.																		1
Conduit Size			1 1/2"	2"	2"	1 1/2"	2"	2"	2"	1 1/2"	2"	3"	3"	3"	3"	2"	2"	2"	2 1/2"	

EQUIPMENT SCHEDULE

Location	Standard	Vehicle Equipment			Ped. Equipment		Luminaire
		Heads	Mtg's	Base Note	Heads	Mtg's	
A	6B/10	2W3C	B-2	2	2W2C	W-3	2 400W
		1W3C(12")	M-2	1			
B	PPB Post						1
C	Type III	1W3C	B-1	1	1W2C	W-0	1 400W
		1W3C(12")	M-2	1			
		1W3C*	M-2	1			
D	Type I	1W3C(12")	A-1	1	1W2C	W-0	1
E	6B/10	1W3C	B-1	1	1W2C	W-0	1 400W
		1W3C(12")	M-2	1			
F	Type I	1W3C(12")	A-1	1	1W2C	W-0	1
G	Type I	1W3C(12")	A-6	1	2		1
		1W3C*					
H	Type III	1W3C	B-1	1	1W2C	W-0	2 400W
		1W3C(12")	M-2	1	1W2C	W-0	
		1W3C(12")	A-1				

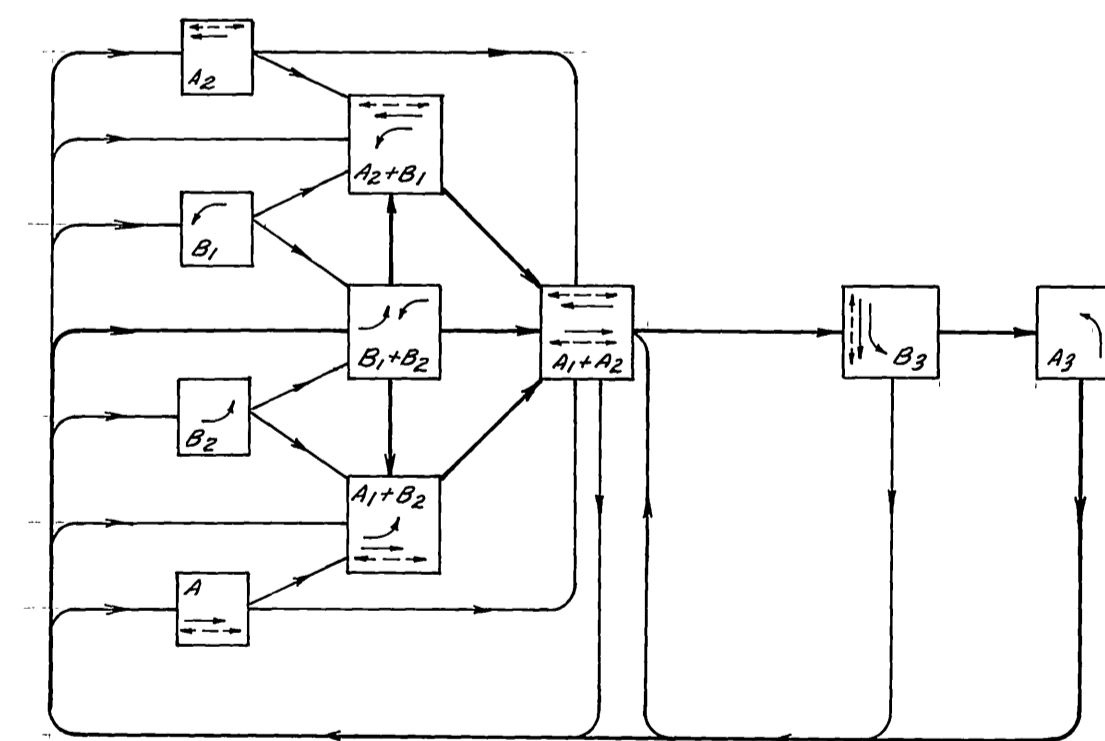

PHASE DIAGRAM

Flashing Indications: φ's A₁ & A₂ - Yellow; All others φ's - Red

- φ's A₁ & A₂ - Type DP Module
- φ's A₃ & B₃ - Type SP Module
- φ's B₁ & B₂ - Type S Module

AS BUILT (SEE SHT. 1)		MAL	1/23/80	CITY OF RIVERSIDE, CALIFORNIA PUBLIC WORKS DEPARTMENT		EQUIPMENT & CONDUCTOR SCHEDULE		ACCOUNT No.
AS BUILT		DA	1/20/77	APPROVED BY		HUGHES ALLEY, HOLE & MAGNOLIA AVENUES		DRAWING NUMBER
As Built per Contract 74-70-B		JMM	6-29-77	BY DATE		DIRECTOR OF PUBLIC WORKS		X-313
MARK	REVISIONS	APPR.	DATE	CHIEF PUB. WKS. ENGR.		DATE		SHEET 2 OF 2
DESIGNED BY	DRAWN BY JMM	CHECKED BY				SCALE: None		