

CONDUCTOR		TABLE																			
CONTROL FUNCTION	CONDUCTORS	CONDUCTOR RUNS																			
		1	2	3	4	5	6	7	8	9	10										
VEHICLE & PEDESTRIAN HEADS, PEDESTRIAN PUSH BUTTONS, SPARES & COMMONS	12 CONDUCTOR IMSA	1	2	4	4	5	10	2	1	1											
	3 CONDUCTOR IMSA	-	1	3	3	3	4	7	1	-	-	-	-	-	-	-	-	-	-	-	-
DETECTOR CABLE #16/2																					
PHASE 1																					
PHASE 2																					
PHASE 3																					
PHASE 4																					
PHASE 5																					
PHASE 6																					
PHASE 7																					
PHASE 8																					
TOTALS																					
EVPE CABLE #20/4																					
ISNS #12																					
LUMINAIRES #8																					
INTERCONNECT SIC																					
SIGNAL SERVICE #6																					
CONDUIT SIZE		2"	2"	2"	2.5"	3"	3"	3-3"(N)	2.5"	2"	2"										

ALL CONDUIT IS EXISTING UNLESS OTHERWISE INDICATED AS (N) NEW. ALL CONDUCTORS ARE NEW. EXISTING CONDUCTORS SHALL BE REMOVED AND NOT REUSED UNLESS OTHERWISE NOTED.

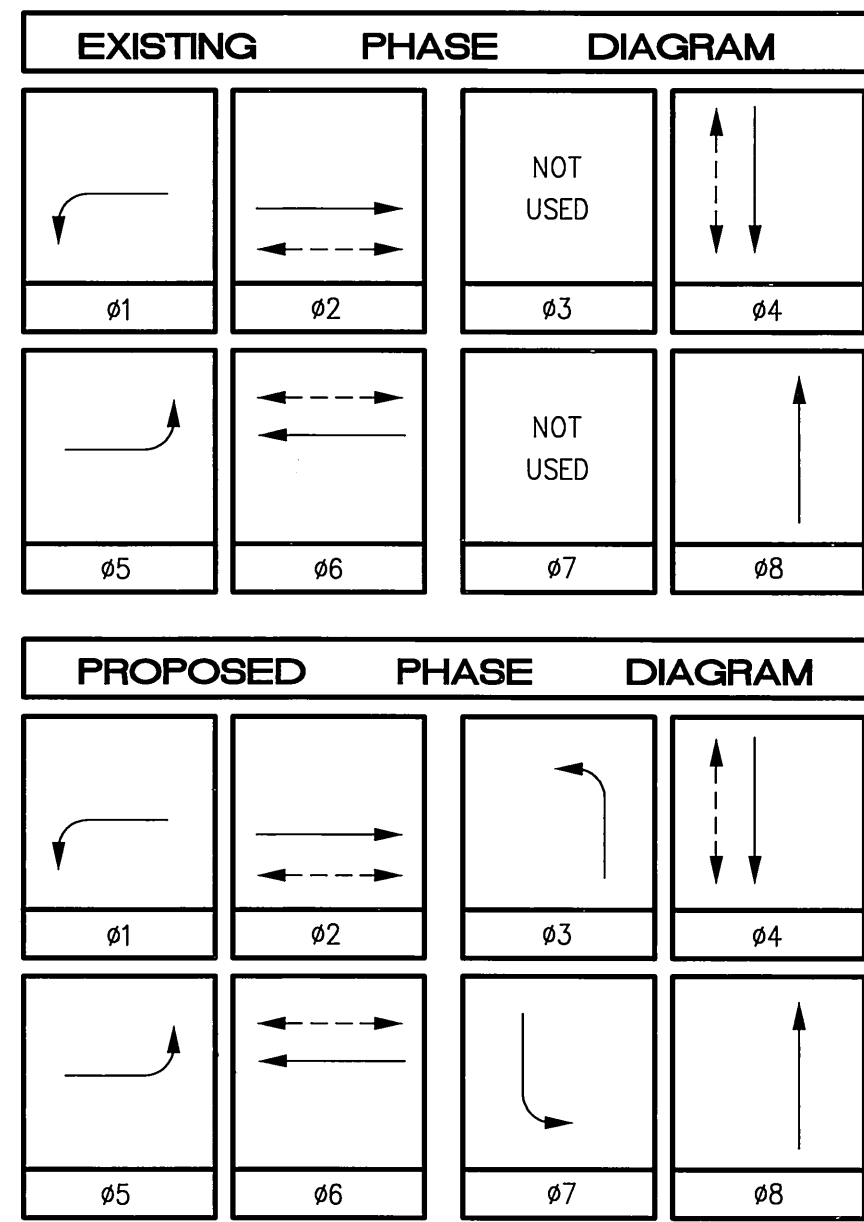

NO.	POLE						SCHEDULE					REMARKS	
	STANDARD TYPE	HGT.	SIG. M.A.	LUM. M.A.	LUMINAIRE HPS	SNS LEGEND	SIGNAL MOUNTING			PPB PHASE			
							VEHICLE	PED	AUDIBLE				
1	19-2-70	30'	30'	15'	400W	* (N)	-	MAS	SV-1-T(N)	SP-1-T	((C))(N)	#4	
2	1-A	10'	-	-	-	-	-	-	TV-2-T(N)	SP-1-T	((P))(N)	#6	
3	24-4-129(N)	30'	35'(N)	12'(N)	250W(N)	Magnolia Ave 10600(N)	MAS(N)	MAS(N)	SV-1-T(N)	-	-	#6(N)	
4	1-A	10'	-	-	-	-	-	-	TV-1-T(N)	SP-1-T	((C))(N)	-	
5	1-A	10'	-	-	-	-	-	-	TV-1-T(N)	-	-	-	
6	19-2-70	30'	30'	15'	400W	* (N)	-	MAS	SV-1-T(N)	SP-1-T	((C))(N)	-	
7	1-A	10'	-	-	-	-	-	-	TV-2-T(N)	-	-	#2	
8	24-4-129(N)	30'	35'(N)	12'(N)	250W(N)	Magnolia Ave 10700(N)	MAS(N)	MAS(N)	SV-1-T(N)	SP-1-T(N)	((P))(N)	#2(N)	
9	1-A	10'	-	-	-	-	-	-	TV-1-T(N)	SP-1-T	((C))(N)	#4	
10	1-A	10'	-	-	-	-	-	-	TV-1-T(N)	SP-1-T	((P))(N)	#4	

ALL EQUIPMENT IS EXISTING UNLESS OTHERWISE NOTED AS (N) NEW.
((C)) OR ((P)) - INDICATES AUDITORY PEDESTRIAN SIGNAL TO BE INSTALLED; ((C)) INDICATES CUCKOO SOUND; ((P)) INDICATES PEEP-PEEP SOUND.
* INSTALL ISNS WITH BLANK SIGN PANEL.
● REFLECTORIZED STREET NAME SIGN PER CITY SPECIFICATIONS.

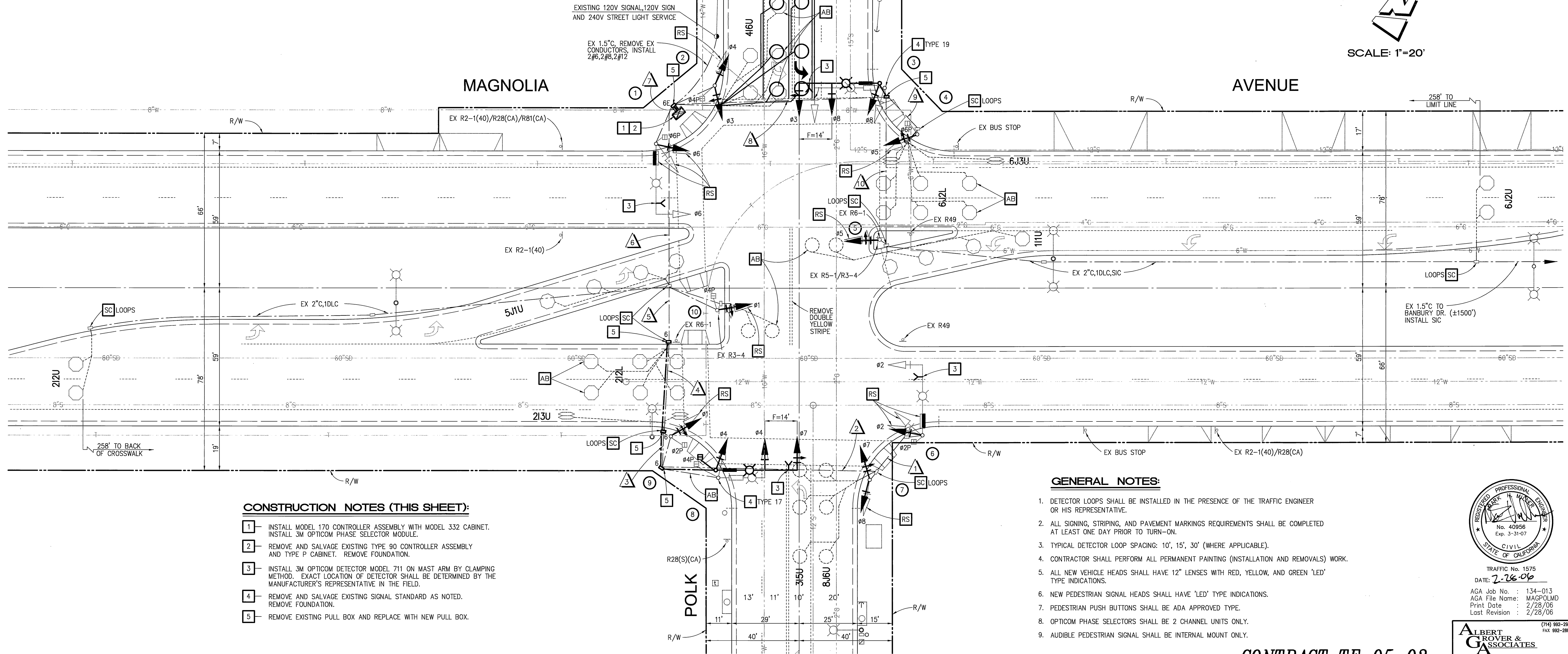
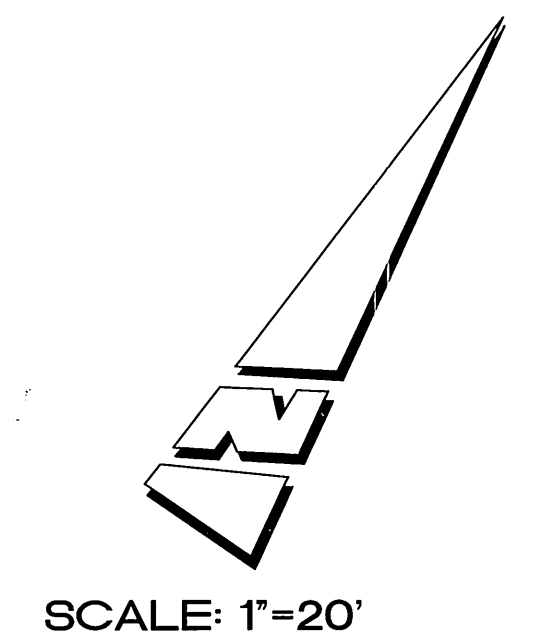

CONSTRUCTION NOTES (THIS SHEET):

- 1 - INSTALL MODEL 170 CONTROLLER ASSEMBLY WITH MODEL 332 CABINET. INSTALL 3M OPTICOM PHASE SELECTOR MODULE.
- 2 - REMOVE AND SALVAGE EXISTING TYPE 90 CONTROLLER ASSEMBLY AND TYPE P CABINET. REMOVE FOUNDATION.
- 3 - INSTALL 3M OPTICOM DETECTOR MODEL 711 ON MAST ARM BY CLAMPING METHOD. EXACT LOCATION OF DETECTOR SHALL BE DETERMINED BY THE MANUFACTURER'S REPRESENTATIVE IN THE FIELD.
- 4 - REMOVE AND SALVAGE EXISTING SIGNAL STANDARD AS NOTED. REMOVE FOUNDATION.
- 5 - REMOVE EXISTING PULL BOX AND REPLACE WITH NEW PULL BOX.

GENERAL NOTES:

1. DETECTOR LOOPS SHALL BE INSTALLED IN THE PRESENCE OF THE TRAFFIC ENGINEER OR HIS REPRESENTATIVE.
2. ALL SIGNING, STRIPING, AND PAVEMENT MARKINGS REQUIREMENTS SHALL BE COMPLETED AT LEAST ONE DAY PRIOR TO TURN-ON.
3. TYPICAL DETECTOR LOOP SPACING: 10', 15', 30' (WHERE APPLICABLE).
4. CONTRACTOR SHALL PERFORM ALL PERMANENT PAINTING (INSTALLATION AND REMOVALS) WORK.
5. ALL NEW VEHICLE HEADS SHALL HAVE 12" LENSES WITH RED, YELLOW, AND GREEN 'LED' TYPE INDICATIONS.
6. NEW PEDESTRIAN SIGNAL HEADS SHALL HAVE 'LED' TYPE INDICATIONS.
7. PEDESTRIAN PUSH BUTTONS SHALL BE ADA APPROVED TYPE.
8. OPTICOM PHASE SELECTORS SHALL BE 2 CHANNEL UNITS ONLY.
9. AUDIBLE PEDESTRIAN SIGNAL SHALL BE INTERNAL MOUNT ONLY.



TRAFFIC No. 1575
DATE: 2.26.06
AGA Job No. : 134-013
AGA File Name: MAGPOLMD
Print Date : 2/28/06
Last Revision : 2/28/06

ALBERT GROVER & ASSOCIATES
TRANSPORTATION CONSULTING ENGINEERS
211 E. Imperial Hwy., Suite 208 Fullerton, CA 92635
(714) 992-2999
FAX: 992-2993

CONTRACT TE-05-03



CITY OF RIVERSIDE, CALIFORNIA DEPARTMENT OF PUBLIC WORKS		TRAFFIC SIGNAL PLAN		ACCOUNT NO.	
APPROVED BY: <i>[Signature]</i> DATE: 4/4/06		MAGNOLIA AVENUE AND POLK STREET		X-322A	
PRINCIPAL ENGINEER		CITY ENGINEER		SHEET 1 OF 1	
TRAFFIC DIVISION		DATE: 4/4/06		HORIZ. SCALE: 1" = 20' VERT. SCALE: N/A	
PUBLIC UTILITIES					
DESIGNED BY: JAT DRAWN BY: RP CHECKED BY: JAT					

CONDUCTOR SCHEDULE

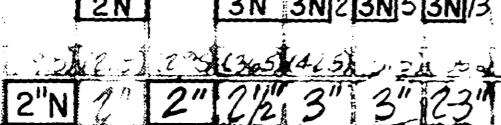
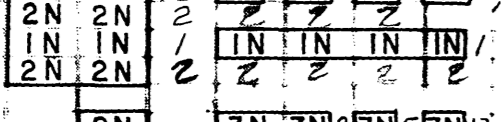
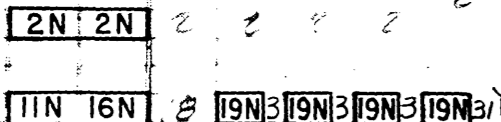
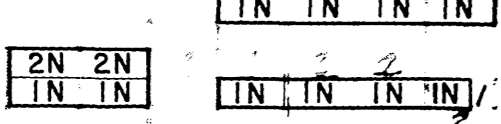
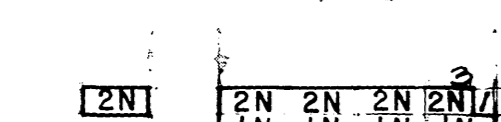
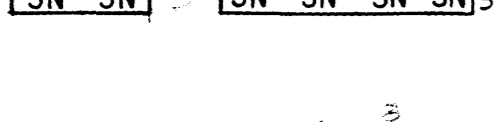
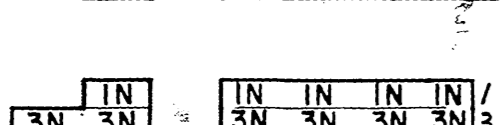
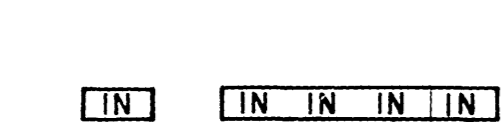
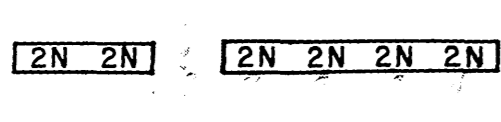
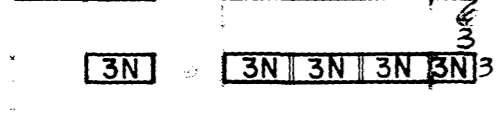
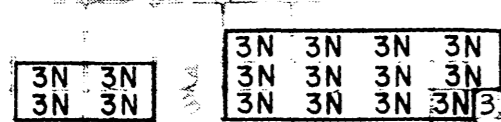
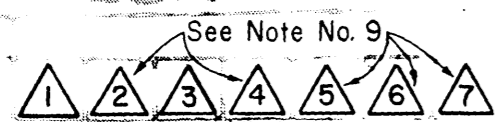

See Note No. 8

NOTES

1. THE CONTRACTOR SHALL FURNISH ALL MATERIALS AND SHALL PERFORM ALL LABOR IN ACCORDANCE WITH THE REQUIREMENTS OF THE STATE OF CALIFORNIA DEPARTMENT OF TRANSPORTATION STANDARD SPECIFICATIONS, DATED JULY 1984, AND STANDARD PLANS, DATED JULY 1984, UNLESS NOTED OTHERWISE ON THE PLAN.
2. IT SHALL BE THE RESPONSIBILITY OF THE CONTRACTOR TO VERIFY THE EXISTENCE AND LOCATION OF ALL UNDERGROUND FACILITIES, PUBLIC OR PRIVATE, AND TO PROTECT THEM FROM DAMAGE. THE CONTRACTOR SHALL BEAR THE TOTAL EXPENSE OF REPAIR OR REPLACEMENT OF ANY UNDERGROUND FACILITIES DAMAGED BY HIS OPERATIONS.
3. THE CONTRACTOR SHALL VERIFY WITH THE CITY ENGINEER THE PRECISE INSTALLATION LOCATIONS OF ALL TRAFFIC SIGNAL EQUIPMENT PRIOR TO INSTALLATION.
4. THE EXISTING TRAFFIC SIGNAL SHALL BE KEPT IN OPERATION IN CONFORMANCE WITH THE REQUIREMENTS OF SECTION 86-1.05, "MAINTAINING EXISTING AND TEMPORARY ELECTRICAL SYSTEMS," OF THE STANDARD SPECIFICATIONS. SIGNAL SHUTDOWN WILL BE PERMITTED ONLY BETWEEN THE HOURS OF 8:30 A.M. AND 3:30 P.M. ON WEEKDAYS. THE CONTRACTOR SHALL NOTIFY THE CITY ENGINEER AT LEAST 24 HOURS IN ADVANCE OF SIGNAL SHUTDOWN.
5. ABANDON AND DISCONNECT THE EXISTING SA12 AND SA14 DETECTOR LOOPS. INSTALL NEW SA12, SA14, AND SA16 DETECTOR LOOPS. UNLESS NOTED OTHERWISE, THE NEW DETECTOR LOOPS SHALL BE CENTERED IN THE LANE AND SHALL BE 6 FEET BY 6 FEET, SPACED 10 FEET APART. THE FIRST LOOP SHALL BE INSTALLED 3 FEET INSIDE THE CROSSWALK. DETECTOR LEAD-IN CABLE SHALL BE 2 NO. 12, AND DETECTOR LOOP WIRE SHALL BE TYPE 1.
6. AT LOCATIONS B, C, AND D, RELOCATE THE EXISTING POLES AND ASSEMBLIES TO NEW LOCATIONS BEHIND THE NEW CURB RETURNS.
7. REMOVE THE EXISTING PULL BOX. SPLICE THE NEW AND EXISTING CONDUIT. NEW CONDUIT SHALL MATCH IN SIZE AND MATERIAL THE EXISTING CONDUIT.
8. ABANDON EXISTING RUNS NO. 1 AND NO. 3, AND REMOVE ALL EXISTING CONDUCTORS. INSTALL A NEW RUN NO. 1 WITH NEW CONDUCTORS.
9. IN RUNS NO. 2, 4, 5, 6, AND 7, REMOVE AND REPLACE WITH NEW CONDUCTORS, AS IDENTIFIED IN THE CONDUCTOR SCHEDULE WITH THE LETTER N.
10. MODIFY THE CABINET WIRING, AS REQUIRED, TO ACCOMMODATE THE NEW SA16 DETECTOR LOOPS. INSTALL AN ADDITIONAL SENSOR UNIT FOR THOSE LOOPS.
11. STRIPING AND SIGNING SHALL BE DONE BY OTHERS. THE STRIPING CONTRACTOR SHALL REMOVE THE ONLY AND THE RIGHT-TURN ARROW PAVEMENT MARKINGS AND SHALL PAINT THE LEFT-TURN ARROW PAVEMENT MARKINGS, AS SHOWN ON THE PLAN. THE STRIPING CONTRACTOR SHALL COORDINATE HIS WORK WITH THE STREET IMPROVEMENT PROJECT. (SEE THE STRIPING AND SIGNING PLANS.)

PROJECT LOCATION MAP

Magnolia

Avenue

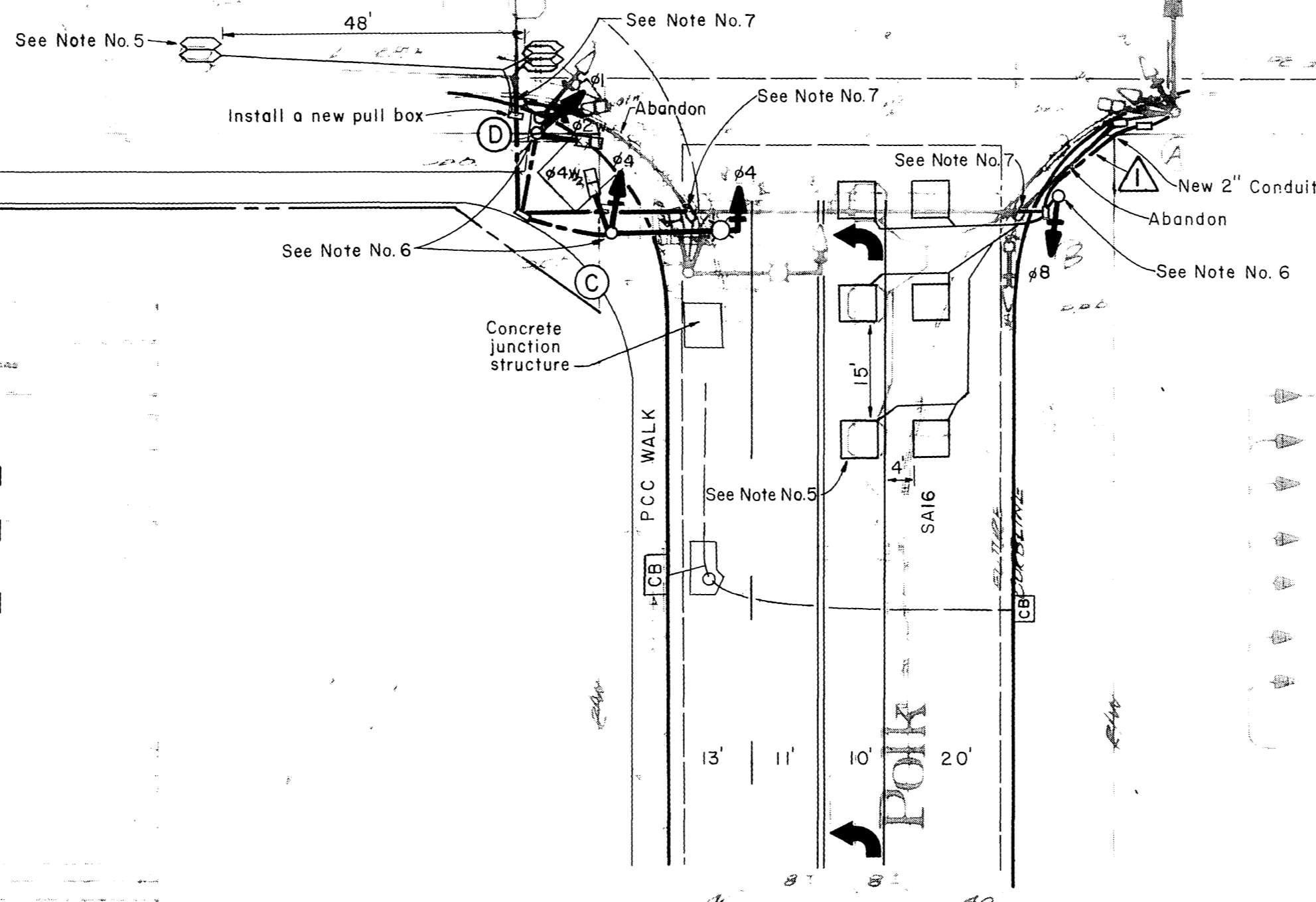

PHASE DIAGRAM



EQUIPMENT SCHEDULE

NO.	DESCRIPTION	QUANTITY	REMARKS
1	TRAFFIC SIGNAL CABINET	1	See Note No. 6
2	TRAFFIC SIGNAL CABINET	1	See Note No. 6
3	TRAFFIC SIGNAL CABINET	1	See Note No. 6
4	TRAFFIC SIGNAL CABINET	1	See Note No. 6
5	TRAFFIC SIGNAL CABINET	1	See Note No. 6
6	TRAFFIC SIGNAL CABINET	1	See Note No. 6
7	TRAFFIC SIGNAL CABINET	1	See Note No. 6
8	TRAFFIC SIGNAL CABINET	1	See Note No. 6
9	TRAFFIC SIGNAL CABINET	1	See Note No. 6
10	TRAFFIC SIGNAL CABINET	1	See Note No. 6
11	TRAFFIC SIGNAL CABINET	1	See Note No. 6
12	TRAFFIC SIGNAL CABINET	1	See Note No. 6
13	TRAFFIC SIGNAL CABINET	1	See Note No. 6
14	TRAFFIC SIGNAL CABINET	1	See Note No. 6
15	TRAFFIC SIGNAL CABINET	1	See Note No. 6
16	TRAFFIC SIGNAL CABINET	1	See Note No. 6
17	TRAFFIC SIGNAL CABINET	1	See Note No. 6
18	TRAFFIC SIGNAL CABINET	1	See Note No. 6
19	TRAFFIC SIGNAL CABINET	1	See Note No. 6
20	TRAFFIC SIGNAL CABINET	1	See Note No. 6

DONALD FRISCHER & ASSOCIATES
 14431 HAMLIN STREET
 VAN NUYS, CALIFORNIA 91401
 PLAN PREPARED UNDER THE SUPERVISION OF:
 Donald Frischer 01/23/85
 DONALD FRISCHER, REGISTERED CIVIL ENGINEER NO. 9141 DATE

NO.	DATE	DESCRIPTION
1	10/23/85	PLAN REVISED
2	11/19/85	AS BUILT FOR SIGNALIZATION TR-801
3	1/21/86	REVISION

CITY OF RIVERSIDE PUBLIC WORKS DEPARTMENT			
APPROVED BY	BY	DATE	APPROVED BY
PRINCIPAL ENGINEER	WLF	2/21/86	William D. Haggan
PARK DEPARTMENT			PUBLIC WORKS DIRECTOR
TRAFFIC DIVISION			
CHIEF P. W. ENGINEER			
DATE		2-21-86	

TRAFFIC SIGNAL MODIFICATION MAGNOLIA AVENUE AND POLK STREET		ACCOUNT NO. X-32
HORIZ. SCALE: 1" = 20'		SHEET L
VERT. SCALE: 1" = 20'		FILE NO.

CONDUCTOR SCHEDULE		CONDUIT RUN																			
CONTROL FUNCTION	CONDUCTORS	1	2	3	4	5	6	7	8	9	10	11	12	13	14	15	16	17	18	19	20
Vehicle Head	#14 THW																				
Pod Head	#14 THW																				
Pod Pushbutton	#14 THW																				
Pod Common Spares	#14 THW																				
Pod Cables	#14 THW																				
Pod Signal	#14 THW																				
Pod Signal Service	#14 THW																				
Totals	#14 THW	11	16	18	22	22	22	22	10	8	0										
#14 (EQUIV.)		105	125	145	165	185	205	225	105	85	0										
CONDUIT SIZE		2"	2"	2"	2"	2"	2"	2"	2"	2"	2"										

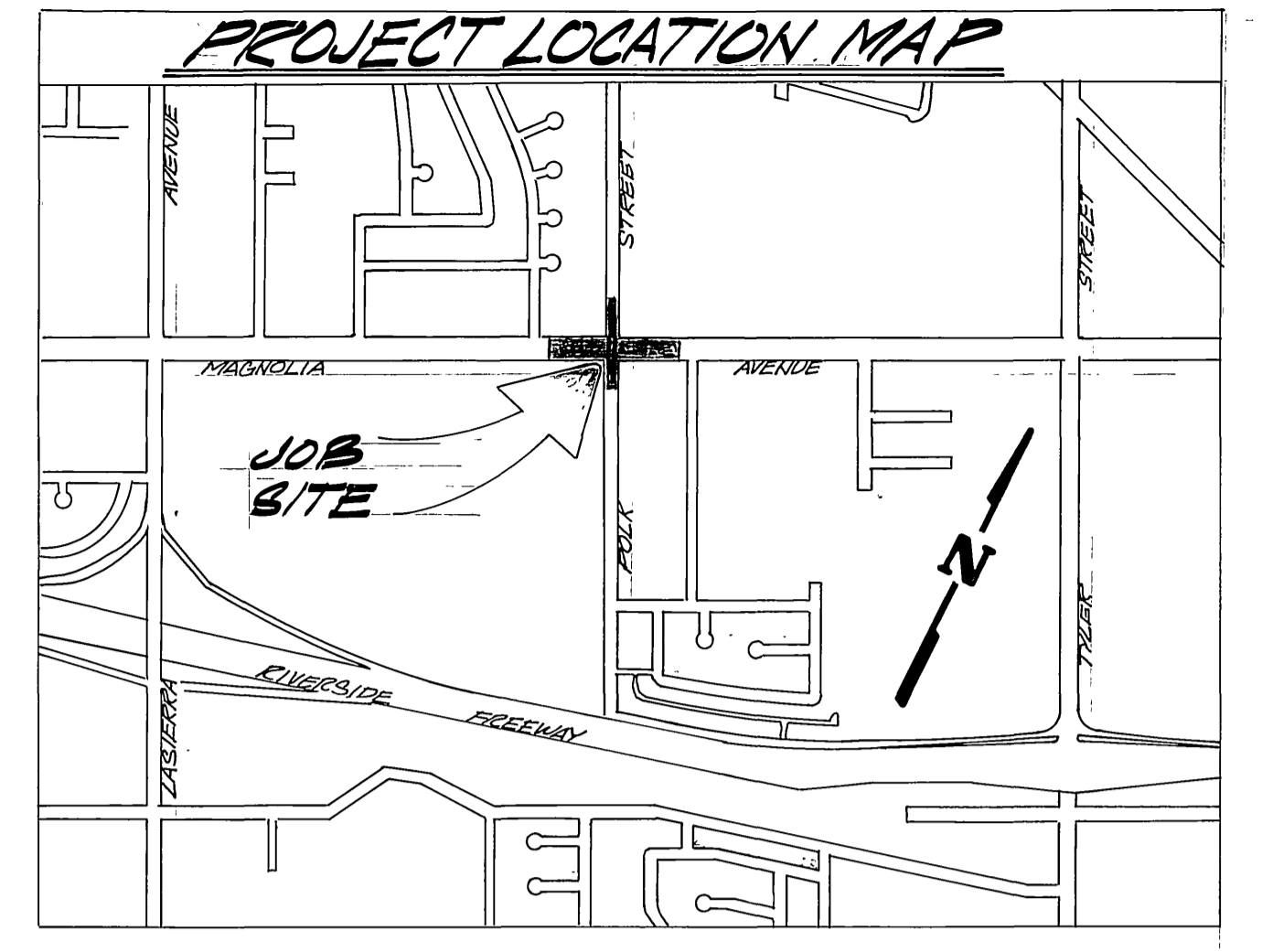

SIGNING REQUIREMENT
 MAGNOLIA AVE. - WAIS ON WOOD POSTS 500' EAST AND WEST OF POLK ST.
 POLK ST. - WAIS ON WOOD POSTS 250' NORTH & SOUTH OF MAGNOLIA AVE.

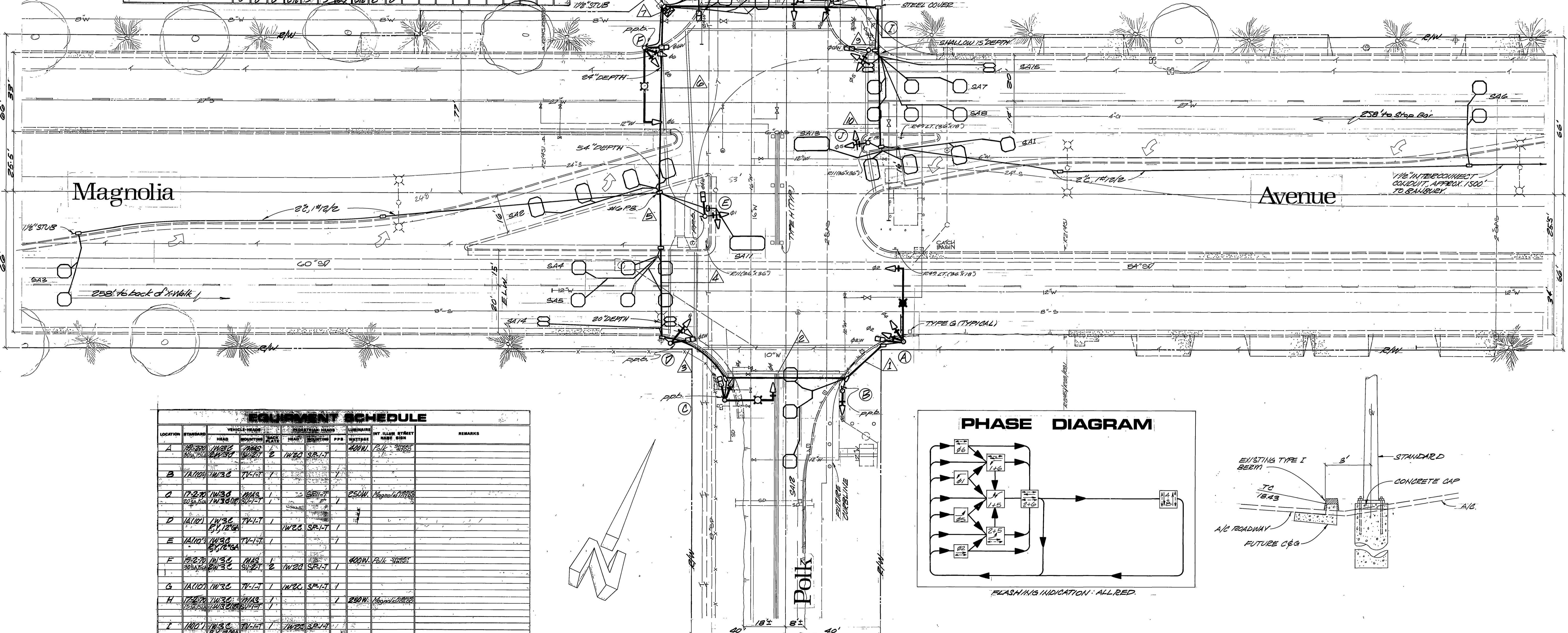

EQUIPMENT SCHEDULE							
LOCATION	STANDARD	VEHICLE HEADS	POD HEADS	POD PUSHBUTTONS	POD COMMON SPARES	LUMINAIRE	REMARKS
A	1A120	1A120	1A120	1A120	1A120	1A120	400W Polk Street
B	1A100	1A100	1A100	1A100	1A100	1A100	250W Magnolia Street
C	1A120	1A120	1A120	1A120	1A120	1A120	400W Polk Street
D	1A100	1A100	1A100	1A100	1A100	1A100	250W Magnolia Street
E	1A100	1A100	1A100	1A100	1A100	1A100	250W Magnolia Street
F	1A120	1A120	1A120	1A120	1A120	1A120	400W Polk Street
G	1A100	1A100	1A100	1A100	1A100	1A100	250W Magnolia Street
H	1A120	1A120	1A120	1A120	1A120	1A120	400W Polk Street
I	1A100	1A100	1A100	1A100	1A100	1A100	250W Magnolia Street
J	1A100	1A100	1A100	1A100	1A100	1A100	250W Magnolia Street

ALL TYPE 1A STANDARDS ARE ALUMINUM.

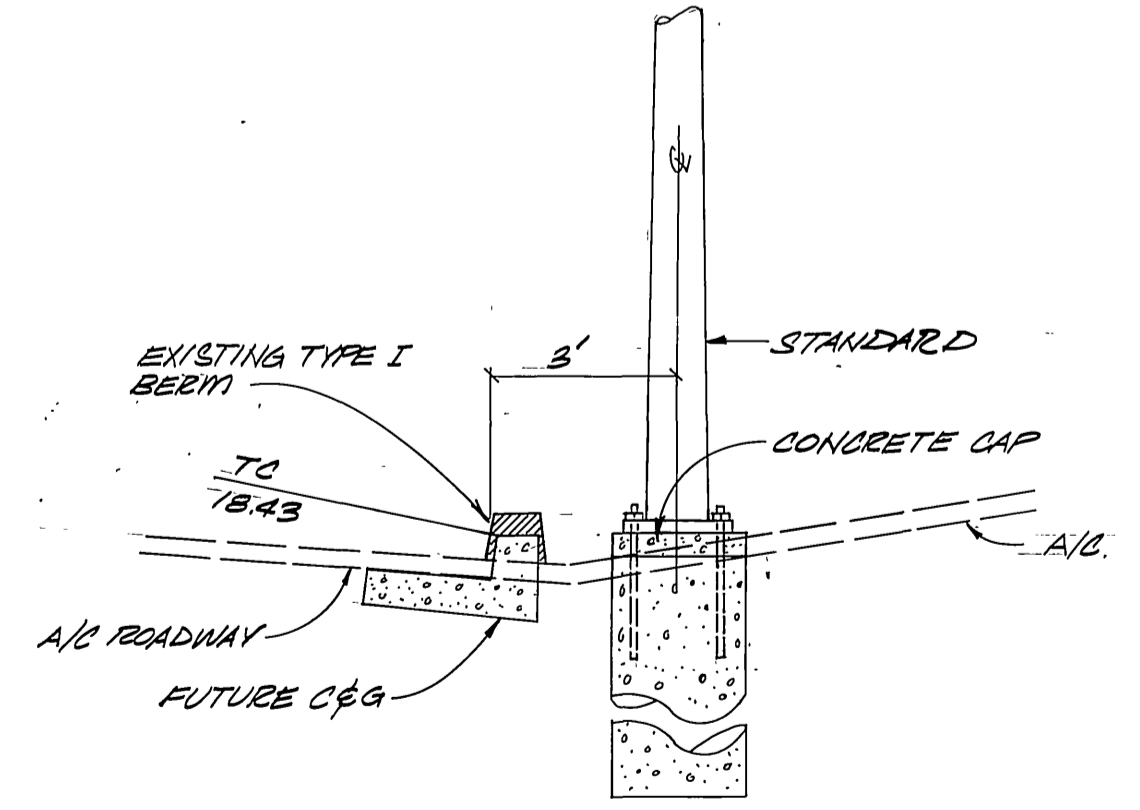
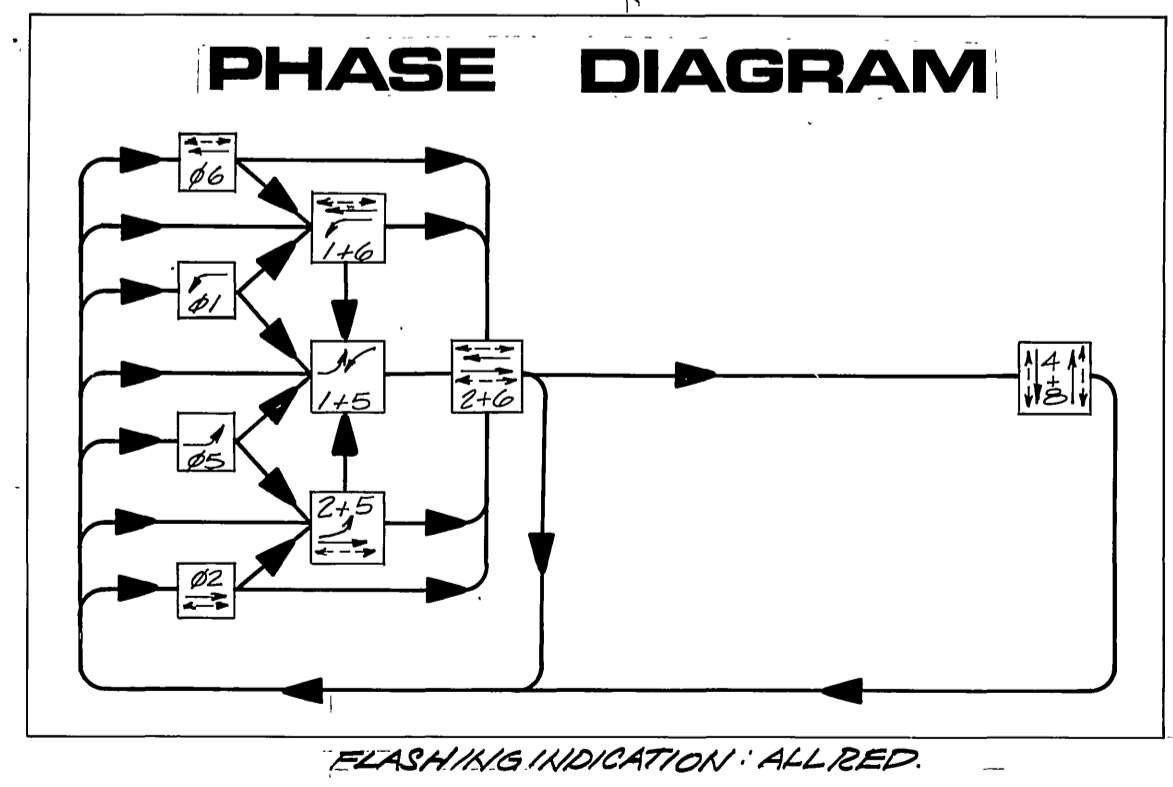

CITY OF RIVERSIDE PUBLIC WORKS DEPARTMENT		TRAFFIC SIGNAL Magnolia Avenue at Polk Street		ACCOUNT NO. 80576-38377
APPROVED BY PRINCIPAL ENGINEER <i>[Signature]</i>	APPROVED BY PUBLIC WORKS DIRECTOR <i>[Signature]</i>	DATE 7/22/02	SHEET 1 OF 1	FILE NO.
AS BUILT PER SIGNIFICATION 12-821, MR. A. A. B.				
DESIGNED BY <i>[Signature]</i>	DRAWN BY <i>[Signature]</i>	CHECKED BY <i>[Signature]</i>	DATE 7/22/02	HORIZ. SCALE: 1" = 20' VERT. SCALE: 1" = 1"

CONDUCTOR SCHEDULE

CONTROL FUNCTION	CONDUCTORS	CONDUIT RUN																			
		1	2	3	4	5	6	7	8	9	10	11	12	13	14	15	16	17	18	19	20
Vehicle Head	#1/4 TW	3	3	3	3	3	3	3	3	3											
Pod Head	#2	2	2	2	2	2	2	2	2	2											
Pod Pushbutton	#2	1	1	1	1	1	1	1	1	1											
TV Cannon Spares	#1/2 TW	3	3	3	3	3	3	3	3	3											
Dist. Cables	#1/2 PE																				
#2 BICYCLE	#1/2 TW																				
#2 BICYCLE	#1/2 TW																				
St. Name Sign	#1/2 TW	2	2	2	2	2	2	2	2	2											
Signal/Service Luminaires	#1/2 TW	1	1	1	1	1	1	1	1	1											
Totals	#1/4 TW	11	11	11	11	11	11	11	11	11											
	#1/2 TW	3	3	3	3	3	3	3	3	3											
	#1/2 PE	1	1	1	1	1	1	1	1	1											
	#1/2 TW	1	1	1	1	1	1	1	1	1											
#1/4 (EQUIV.)		105	105	105	105	105	105	105	105	105											
CONDUIT SIZE		2"	2"	2"	2"	2"	2"	2"	2"	2"											

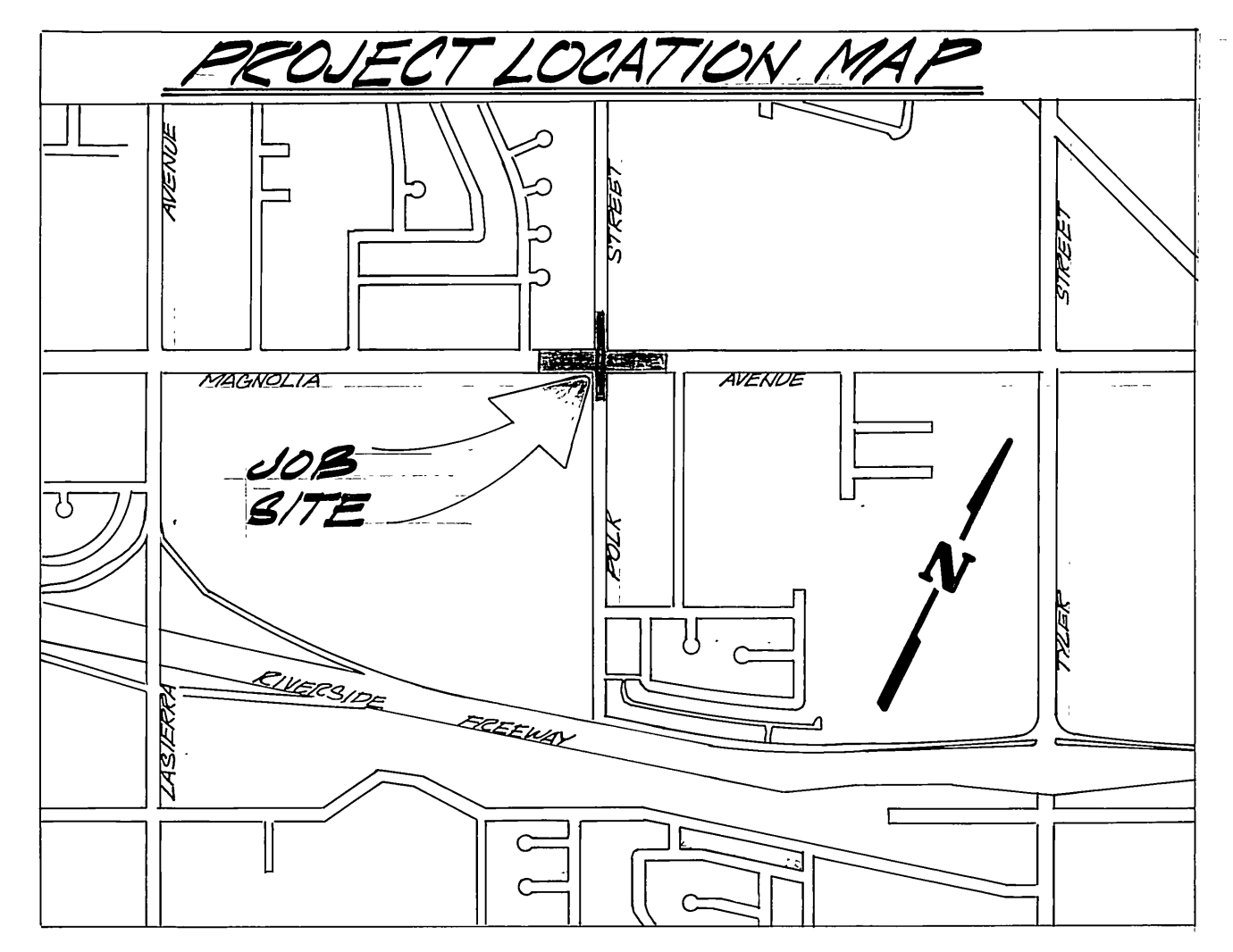

SIGNING REQUIREMENT

MAGNOLIA AVE. - WA'S ON WOOD POSTS
500' EAST AND WEST OF POLK ST.

POLK ST. - WA'S ON WOOD POSTS
250' NORTH & SOUTH OF MAGNOLIA AVE.

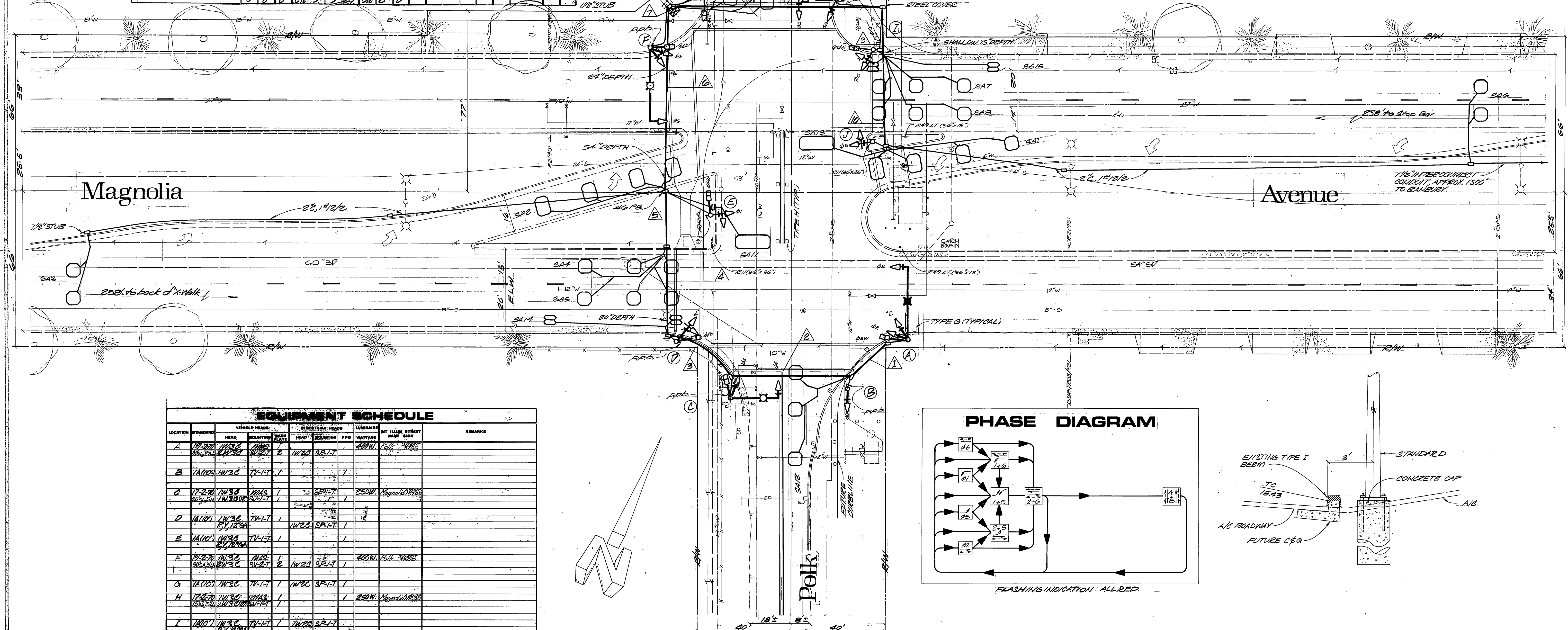

EQUIPMENT SCHEDULE

LOCATION	STANDARD	VEHICLE HEADS	POD HEADS	POD PUSHBUTTONS	LUMINAIRE	MT. ILLUM. STREET NAME SIGN	REMARKS
A	1A	1A	1A	1A	1A	1A	
B	1A	1A	1A	1A	1A	1A	
C	1A	1A	1A	1A	1A	1A	
D	1A	1A	1A	1A	1A	1A	
E	1A	1A	1A	1A	1A	1A	
F	1A	1A	1A	1A	1A	1A	
G	1A	1A	1A	1A	1A	1A	
H	1A	1A	1A	1A	1A	1A	
I	1A	1A	1A	1A	1A	1A	
J	1A	1A	1A	1A	1A	1A	

ALL TYPE 1A STANDARDS ARE ALUMINUM.

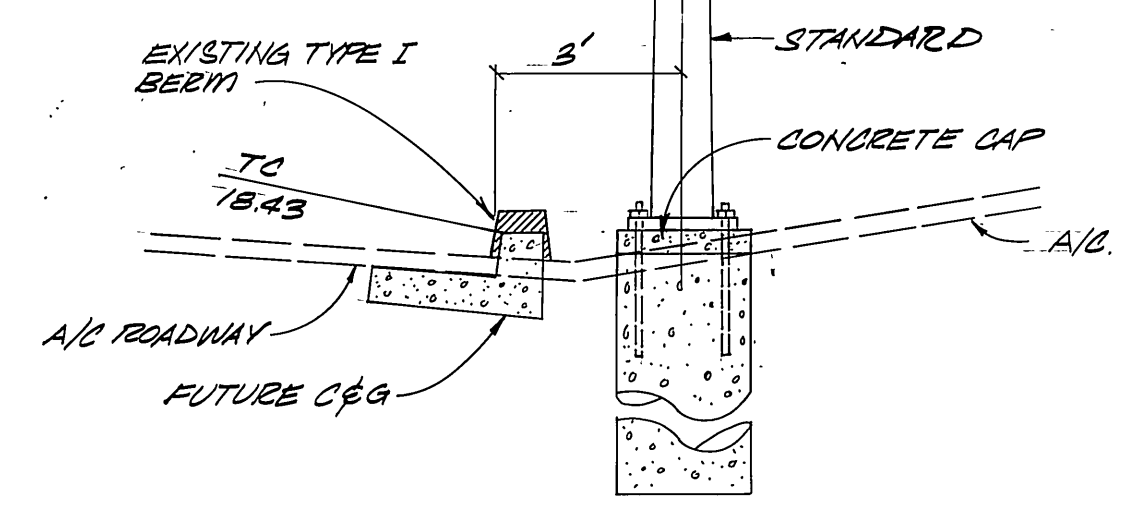
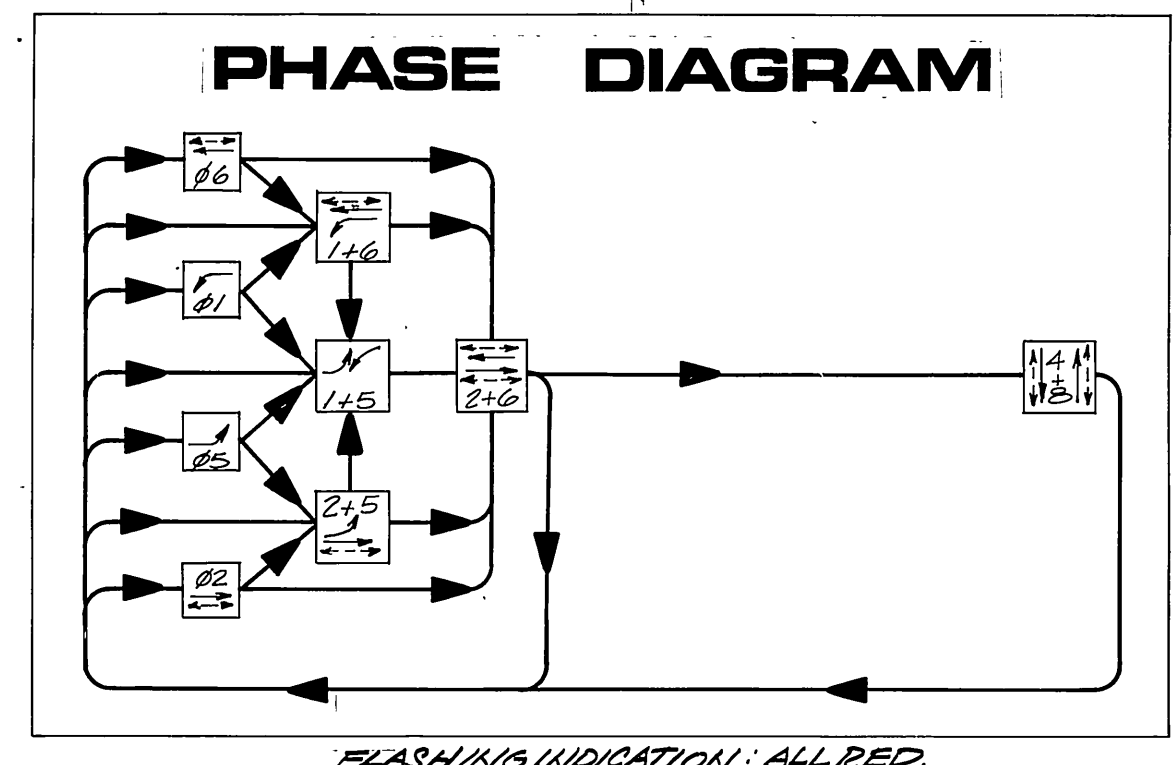

CITY OF RIVERSIDE PUBLIC WORKS DEPARTMENT		TRAFFIC SIGNAL Magnolia Avenue at Polk Street	ACCOUNT NO. 30526-38707 X-322 SHEET 1 OF 1 FILE NO.
APPROVED BY: [Signature] PRINCIPAL ENGINEER DATE: 7/22/02	APPROVED BY: [Signature] PUBLIC WORKS DIRECTOR DATE: 7/22/02	DESIGNED BY: [Signature] DRAWN BY: [Signature] CHECKED BY: [Signature]	