

A.W.G. SIZE OR CABLE SIZE		PHASE NO.	POLE OR CIRCUIT	RUNS										
				1	2	3	4	5	6	7	8			
12	1.6 6P	4	POLE (A)		1	1	1							
	8 4P	6	POLE (B)		1	1	1							
	8 4P	6	POLE (C)		1	1	1							
	8 6P	6	POLE (D)	1	1	1	1							
	2.5 8P	8	POLE (E)		1	1	1	1	1	1	1	1	1	1
	8 6P	2	POLE (F)		1	1	1	1	1	1	1	1	1	1
	4 4P	2	POLE (G)		1	1	1	1	1	1	1	1	1	1
	1 2P	4	POLE (H)		1	1	1	1	1	1	1	1	1	1
TOTAL CABLES 12C/3C				1	2	8	4	4	3	2	1	1	1	1
#12	L.I.S.N.S.			-	2	2	-	2	2	2	2	2	2	
#8	LUMINAIRES			-	2	2	-	2	2	2	2	2	2	
#8	SIGNAL SERVICE			2	2	2	-	-	-	-	-	-	-	
TYPE B D.L.C.	#1 DETECTOR			1	1	1								
	#2 DETECTOR						2	2	2					
	#5 DETECTOR						1	1	1					
	#6 DETECTOR			2	2	2								
	#8 DETECTOR						3	3	3	3	3	3	3	
	TOTAL DLC			3	3	9	6	6	3	3	-	-	-	-
* #4 VIDEO CABLE				-	-	1	1	1	1	-	-	-	-	
CONDUIT SIZE (IN.)				(E)	(E)	(N)	(E)	(E)	(E)	(E)	(E)	(E)	(E)	
				2	3	2-4	3	3	3	3	2	2	2	

NOTES: 1. (N)=NEW (E)=EXISTING
 2. ALL CONDUCTORS, DLC'S AND CABLES SHALL BE NEW.
 * BELDEN 8281 COAXIAL VIDEO CABLE OR AS SPECIFIED BY THE VIDEO DETECTION VENDOR.

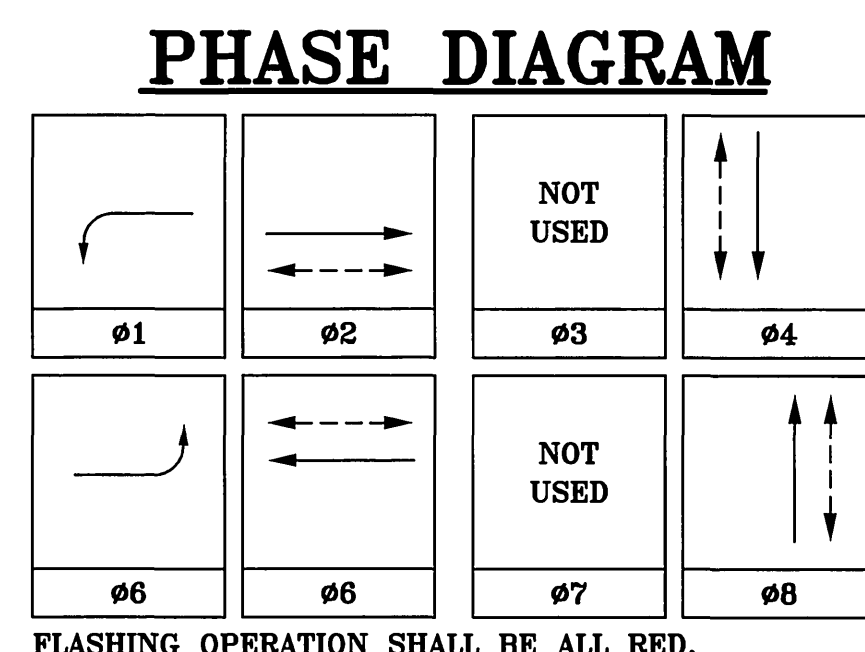

FLASHING OPERATION SHALL BE ALL RED.

POLE AND EQUIPMENT SCHEDULE

POLE NO.	DESCRIPTION	SIGNAL STANDARD		PLACEMENT DIMENSIONS		SIGNAL MOUNTING			PED PUSH BUTTONS		HPSV LUMINAIRE	I.L.S.N.S. LEGEND	
		POLE HEIGHT	SIGNAL MAST ARM	LUMINAIRE MAST ARM	"A"	"B"	POLE VEHICLE	MAST ARM VEHICLE	POLE PEDESTRIAN	Ø			ARROW
(A)	24-4-80	30'	35'	12'	EX.	EX.	SV-1-T	2-MAS	SP-1-T	4	←	E	250 W Washington ST 3400
(B)	1-A	7'	-	-	EX.	EX.	-	-	TP-1-T	8	←	S	- - -
(C)	17-2-80	30'	20'	18'	EX.	EX.	SV-1-T	1-MAS	SP-1-T	6	←	S	200 W Indiana AVE 7000
(D)	1-A	10'	-	-	EX.	EX.	TV-1-T	-	SP-1-T	8	←	W	- - -
(E)	24-4-80	30'	35'	12'	EX.	EX.	SV-1-T	2-MAS	SP-1-T	8	←	W	200 W Washington ST 3300
(F)	1-A	7'	-	-	EX.	EX.	-	-	TP-1-T	2	←	N	- - -
(G)	17-2-80	30'	18'	12'	EX.	EX.	SV-1-T	1-MAS	SP-1-T	2	←	N	250 W Indiana AVE 7100
(H)	1-A	10'	-	-	EX.	EX.	TV-1-T	-	SP-1-T	4	←	E	- - -

* =INSTALL NEW PED PUSH BUTTON

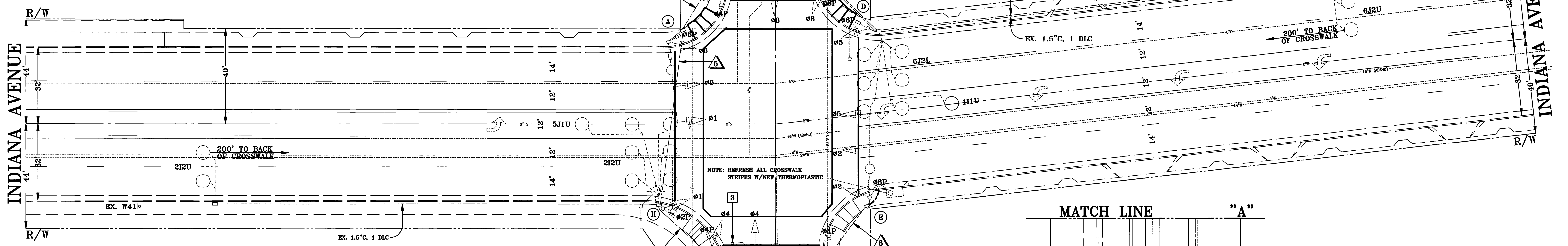

CONSTRUCTION NOTES

- Construct new foundation for a 332 cabinet. Install the salvaged controller and 332 cabinet on the new foundation.
 Furnish and install ITERIS VANTAGE II detection unit for #4 operation, monitor/video detection and programming unit and other necessary equipment devices in accordance with manufacturer's specifications. All equipment shall be tested by Republic Electric prior to installation.
 Furnish and install a CLARY CORPORATION SP SERIES 1250PD/RN plus uninterrupted power supply (UPS) or approved equal. The UPS battery shall be installed in a CLARY cabinet, externally mounted on the 332 cabinet.
- Furnish and install concrete filled bumper posts.
- Install VANTAGE EDGE TYPE II video detection system and camera assembly on luminaire mast arm per manufacturer's specifications. The Contractor shall make the necessary improvements in the controller cabinet to run the video equipment.

DETECTOR SCHEDULE

LOOP DESIGNATION	NUMBER OF LOOPS	FEATURES
111U	3	
212U	2	● ■
212L	4	
511U	3	
6J2U	2	● ■
6J2L	4	
416U	-	VIDEO DETECTION
8J6U	3	
8J6L	3	
8J7U	1	QUEUE

● SAMPLING (future)
 ■ CALL-HOLD (extension)
 DETECTORS SHALL BE 2-CHANNEL RACK-MOUNTED.

MATCH LINE "A"

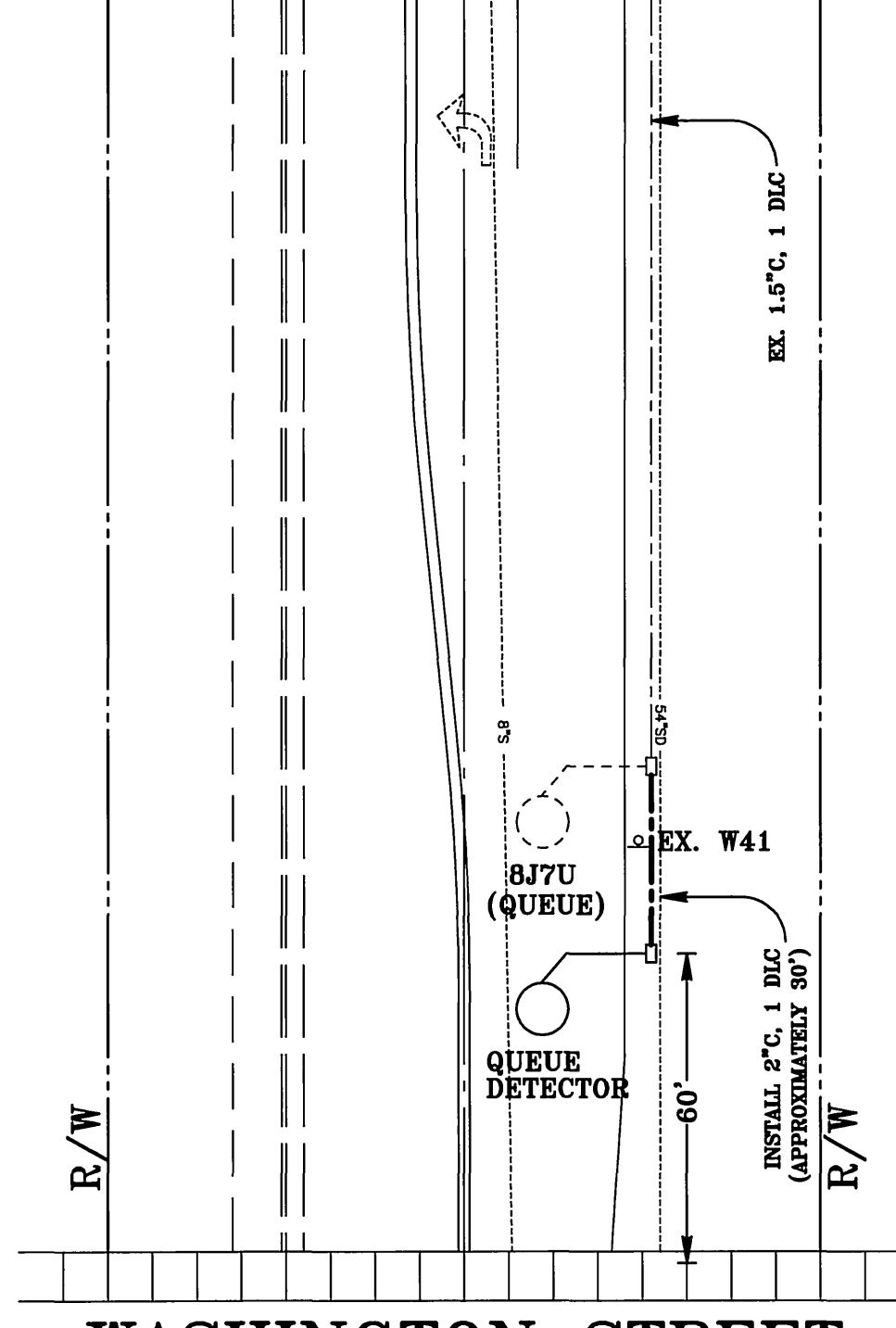

WASHINGTON STREET

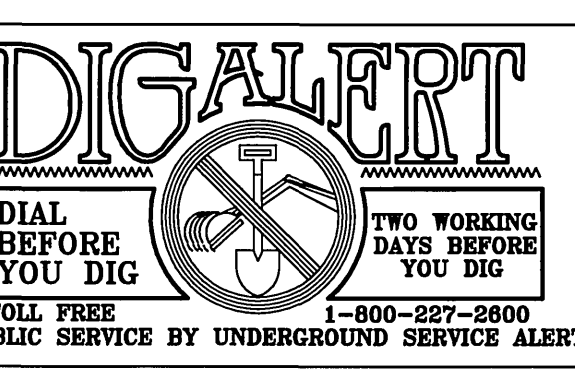
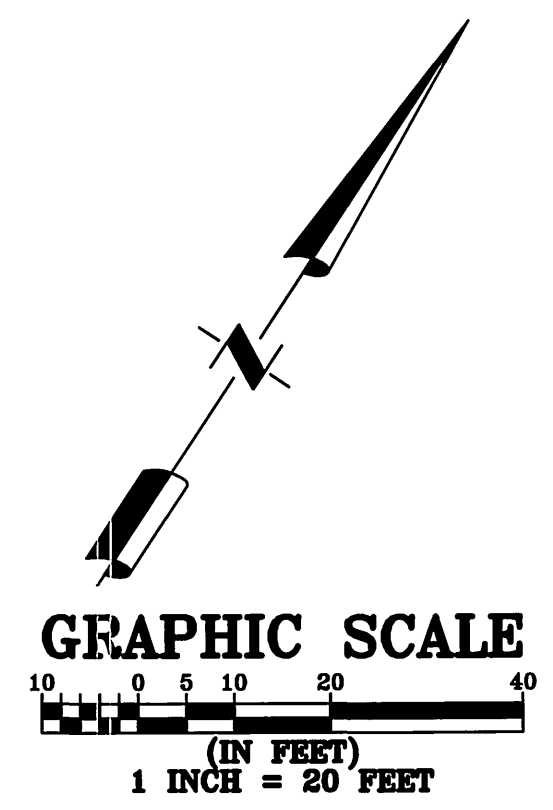

PRIVATE ENGINEERING NOTE
 CONTRACTOR AGREES THAT IN ACCORDANCE WITH GENERALLY ACCEPTED CONSTRUCTION PRACTICES, CONSTRUCTION CONTRACTOR WILL BE RESPONSIBLE FOR ASSESSING AND COMPLETING RESPONSIBILITY FOR JOB SITE CONDITIONS DURING THE COURSE OF CONSTRUCTION OF THE PROJECT, INCLUDING SAFETY OF ALL PERSONS AND PROPERTY. THAT THIS RESPONSIBILITY SHALL BE MADE TO APPLY CONTINUOUSLY AND NOT BE LIMITED TO NORMAL WORKING HOURS, AND CONSTRUCTION CONTRACTOR FURTHER AGREES TO DEFEND, INDEMNIFY AND HOLD DESIGN PROFESSIONAL HARMLESS FROM ANY AND ALL LIABILITY, REAL OR ALLEGED, IN CONNECTION WITH THE PERFORMANCE OF WORK ON THIS PROJECT, EXCEPTING LIABILITY ARISING FROM THE SOLE NEGLIGENCE OF DESIGN PROFESSIONAL.

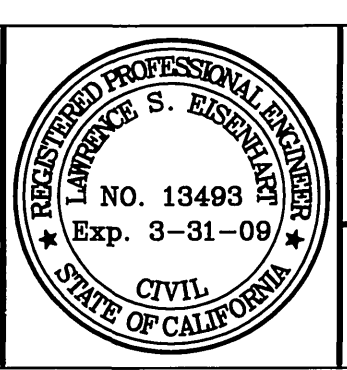

ENGINEER IN RESPONSIBLE CHARGE:
 Lawrence S. Eisenhart
 LAWRENCE S. EISENHART RCE NO. 13493
 EXPIRATION DATE: 3-31-07

LAWRENCE S. EISENHART
 CONSULTING ENGINEER
 2070 Locust Court
 San Bernardino, California 92404
 Tel: (909) 864-5406 Fax: (909) 864-5047
 SCALE: 1"=20'
 DATE: 12/26/06

MARK	REVISIONS	APPR.	DATE

CITY OF RIVERSIDE
 PUBLIC WORKS DEPARTMENT
 APPROVED BY: [Signature] DATE: 2/2/07
 PRINCIPLE ENGR.
 TRAFFIC DIVISION
 APPROVED BY: [Signature] DATE: 2/2/07
 CITY ENGINEER
 DATE: 2/2/07

TRAFFIC SIGNAL MODIFICATION PLAN
INDIANA AVENUE
WASHINGTON STREET
 SCALE: 1"=20'

PROJECT NO:
X-323A
 SHEET **1** OF **1**
 FILE NAME: 323A.DWG

CONDUCTOR TABLE

CONTROL FUNCTION	CONDUCTORS	CONDUCTOR RUNS							
		1	2	3	4	5	6	7	8
VEHICLE & PEDESTRIAN HEADS, PEDESTRIAN PUSH BUTTONS, SPARES & COMMONS	12 WIRE IMSA 9 WIRE IMSA 5 WIRE IMSA 3 WIRE IMSA	1	1	4	3	2	2	1	1
DETECTOR CABLE	#16/2	1	1	1					
PHASE 1				2	2	2			
PHASE 2				2	2	2			
PHASE 4				1					
PHASE 5				1	1	1			
PHASE 6		2	2	2					
PHASE 8				3	3	3	3	3	
I.I.S.N.S.	#12	2		2	2	2	2	2	2
LUMINAIRES	#8	2		2	2	2	2	2	2
SIGNAL SERVICE	#6	2		2	2	2	2	2	2
CONDUIT SIZE		2"	3"	2-3"	3"	3"	3"	3"	2"

NOTES:
 1. SEE SPECIAL PROVISIONS FOR ADDITIONAL INFORMATION ON I.M.S.A. CABLE.
 2. CONTRACTOR SHALL INSTALL 1 1/2" CONDUIT FOR FUTURE INTERCONNECT; CONDUIT PARALLELS CONDUCTOR RUNS 1, 2, 3, AND 6J2U ADVANCE DETECTOR RUN.
 3. WHEN APPLICABLE, PARALLELING CONDUITS SHALL BE PLACED IN COMMON TRENCH.

PP-472208H

RISER DETAIL

INSTALL 120V SIGNAL, 120V SIGN, AND 240V STREET LIGHT SERVICE PER STANDARD DRAWING NO. 612

INSTALL 2" C. WITH 2 #6, 2 #8, 2 #12

INSTALL MODEL 170 CONTROLLER UNIT HOUSED IN A 332 CABINET.

EQUIPMENT SCHEDULE

NO.	SIGNAL STANDARD TYPE	H'GHT	M.A.	L.A.	H.P.S.V.	I.I.S.N.S. LEGEND	SIGNAL MOUNTINGS			PPB PHASE
							VEHICLE	PEDESTRIAN	AUDIBLE	
(A)	24-4-80	30'	35'	12'	250W	WASHINGTON ST 3400	MAS	MAS		
							SV-1-T	SP-1-T	N/A	4
(B)	1A	7'						TP-1-T	N/A	6
(C)	17-2-80	30'	20'	12'	200W	INDIANA AV 7000	MAS	SV-1-T	SP-1-T	N/A
(D)	1A	10'					TV-1-T	SP-1-T	N/A	8
(E)	24-4-80	30'	35'	12'	250W	WASHINGTON ST 3300	MAS	MAS		
							SV-1-T	SP-1-T	N/A	8
(F)	1A	7'						TP-1-T	N/A	2
(G)	17-2-80	30'	18'	12'	200W	INDIANA AV 7100	MAS	SV-1-T	SP-1-T	N/A
(H)	1A	10'					TV-1-T	SP-1-T	N/A	4

NOTES:
 1. ALL VEHICULAR HEADS SHALL HAVE 12" LENSES.
 2. ALL LEFT TURN HEADS SHALL HAVE ALL ARROWS.
 3. PEDESTRIAN PUSH BUTTONS SHALL BE INSTALLED ON THE POLE IN THE QUADRANT NEAREST THE CROSSWALK SERVING THE PHASE.

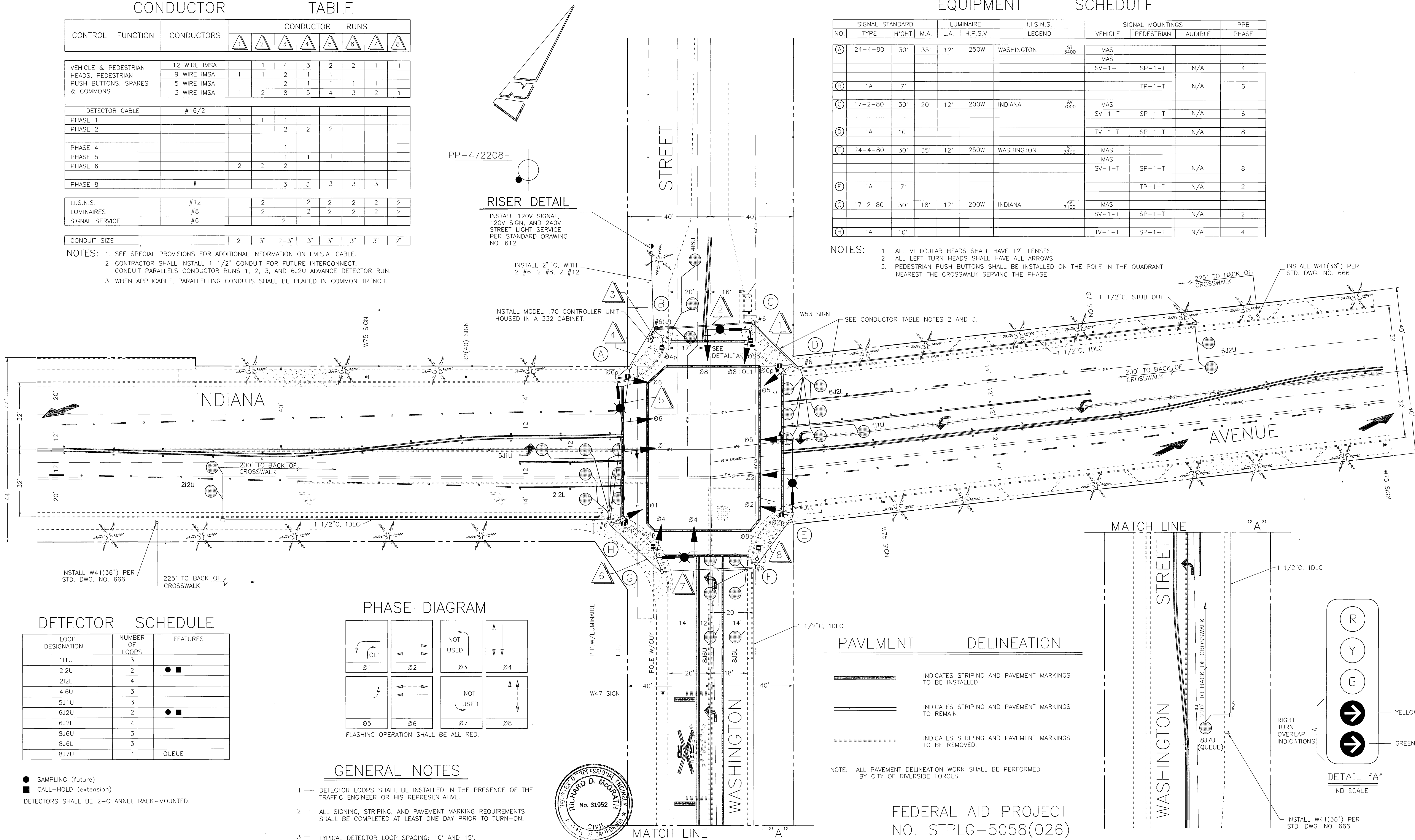

DETECTOR SCHEDULE

LOOP DESIGNATION	NUMBER OF LOOPS	FEATURES
111U	3	
212U	2	● ■
212L	4	
416U	3	
5J1U	3	
6J2U	2	● ■
6J2L	4	
8J6U	3	
8J6L	3	
8J7U	1	QUEUE

● SAMPLING (future)
 ■ CALL-HOLD (extension)
 DETECTORS SHALL BE 2-CHANNEL RACK-MOUNTED.

PHASE DIAGRAM

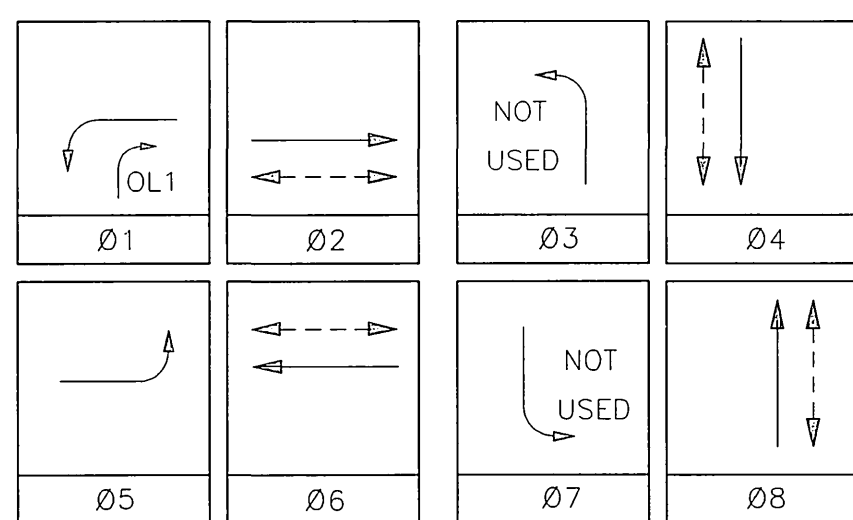

FLASHING OPERATION SHALL BE ALL RED.

GENERAL NOTES

- DETECTOR LOOPS SHALL BE INSTALLED IN THE PRESENCE OF THE TRAFFIC ENGINEER OR HIS REPRESENTATIVE.
- ALL SIGNING, STRIPING, AND PAVEMENT MARKING REQUIREMENTS SHALL BE COMPLETED AT LEAST ONE DAY PRIOR TO TURN-ON.
- TYPICAL DETECTOR LOOP SPACING: 10' AND 15'.
- SEE CITY OF RIVERSIDE DRAWING XL-338 FOR ALL SIGNING, STRIPING, AND PAVEMENT MARKING REQUIREMENTS.
- SEE CITY OF RIVERSIDE DRAWING R-3355 FOR ALL STREET IMPROVEMENT CONSTRUCTION.

PAVEMENT DELINEATION

- INDICATES STRIPING AND PAVEMENT MARKINGS TO BE INSTALLED.
- INDICATES STRIPING AND PAVEMENT MARKINGS TO REMAIN.
- INDICATES STRIPING AND PAVEMENT MARKINGS TO BE REMOVED.

NOTE: ALL PAVEMENT DELINEATION WORK SHALL BE PERFORMED BY CITY OF RIVERSIDE FORCES.

FEDERAL AID PROJECT NO. STPLG-5058(026)



ENGINEER IN RESPONSIBLE CHARGE
 Richard D. McGrath
 RICHARD D. McGRATH
 R.C.E. No. 31952 expires 12-31-96
 DATE 5-5-95

CITY OF RIVERSIDE, CALIFORNIA DEPARTMENT OF PUBLIC WORKS			
APPROVED BY	BY	DATE	APPROVED BY
PRINCIPAL ENGINEER	[Signature]	5/8/95	[Signature]
P.W. INSPECTION	[Signature]	5/8/95	[Signature]
TRAFFIC DIVISION	[Signature]	5/8/95	[Signature]
CHIEF P.W. ENGR.	[Signature]	5/8/95	[Signature]
PUBLIC UTILITIES	[Signature]	5/8/95	[Signature]

TRAFFIC SIGNAL		ACCT. NO.
INDIANA AVENUE @ WASHINGTON STREET		230-541500-440223-30338
SCALE: 1" = 20'		X-323
SHEET 1 OF 1		FILE NAME: X323.DWG

