

GENERAL NOTES

- ALL WORK, MATERIALS, AND EQUIPMENT SHALL CONFORM TO THE REQUIREMENTS OF THE STATE OF CALIFORNIA, DEPARTMENT OF TRANSPORTATION (CALTRANS) STANDARD PLANS AND SPECIFICATIONS DATED JANUARY 1988, CITY OF RIVERSIDE SPECIFICATIONS AND STANDARD DRAWINGS.
- UTILITIES SHOWN ON THESE PLANS ARE CORRECT AND ACCURATE TO THE EXTENT OF AVAILABLE RECORDS AND KNOWLEDGE. THE CONTRACTOR, HOWEVER, IS REQUIRED TO TAKE STEPS TO ASCERTAIN THE EXACT LOCATION OF UNDERGROUND FACILITIES PRIOR TO DOING THE WORK THAT MAY DAMAGE SUCH FACILITIES OR INTERFERE WITH THEIR SERVICE.
- THE CONTRACTOR SHALL NOTIFY UNDERGROUND SERVICE ALERT (USA) (1-800-422-4133) 48 HOURS PRIOR TO BEGINNING EXCAVATION.
- THE CONTRACTOR SHALL RESTORE OR REPLACE IN KIND ALL EXISTING IMPROVEMENTS DISTURBED DURING CONSTRUCTION INCLUDING, BUT NOT LIMITED TO STREET STRIPING, LANDSCAPING, AND SIGNS.
- THE STREETS SHOULD BE OPEN AT THE END OF EACH WORKING DAY.
- A "STREET OPENING" PERMIT OBTAINED AT THE PUBLIC WORKS COUNTER IS REQUIRED FOR THIS WORK; THE RATE FOR INSPECTION TO BE CHARGED AGAINST THIS PERMIT IS \$29.35 PER HOUR.
- SEE PLAN R- FOR STREET IMPROVEMENTS.
- THE PRIVATE ENGINEER SIGNING THIS PLAN IS RESPONSIBLE FOR THE ACCURACY AND ACCEPTABILITY OF THE WORK SHOWN HEREON. IN THE EVENT OF DISCREPANCIES ARISING DURING CONSTRUCTION, THE PRIVATE ENGINEER SHALL BE RESPONSIBLE FOR DETERMINING AN ACCEPTABLE SOLUTION AND REVISING THIS PLAN FOR APPROVAL BY THE CITY.

- ALL SALVAGED TRAFFIC SIGNAL EQUIPMENT AND POLES, NOT REUSED OR RELOCATED TO OTHER DESIGNATED LOCATIONS, SHALL BE RETURNED TO THE CITY OF RIVERSIDE.

CONSTRUCTION NOTES

- INSTALL NEW POLES AND EQUIPMENT AS INDICATED.
- CENTER NEW I.D.'S IN LANE UNLESS OTHERWISE SPECIFIED.
- DETECTOR LOOPS SHALL BE INSTALLED IN THE PRESENCE OF THE TRAFFIC ENGINEER OR HIS REPRESENTATIVE.
- SIGNALS SHALL REMAIN IN OPERATION.
- INSTALL NEW CONDUCTORS FROM CONTROLLER TO POLES H & I THRU A, B, & C; SPLICING SHALL NOT BE ALLOWED.

CIRCUIT	RUN NUMBER											
	1	2	3	4	5	6	7	8	9	10	11	12
1												
2												
3												
4												
5												
6												
7												
8												
2P												
4P												
6P												
8P												
2PPB												
4PPB												
6PPB												
8PPB												
PPB COMMON												
SPARES												
TOTAL												
#12												
ISNS												
SIGNAL & SIGN COM.												
LUMINAIRES												
TOTAL												
#8												
#1												
#2												
#3												
#4												
#5												
#6												
#7												
#8												
TOTAL												
2-#20 IC CABLE												
CONDUIT SIZE												

NUMBER OF NEW/NUMBER OF EXISTING
 ▲ = 1 EXISTING, 1 NEW FOR FUTURE USE
 (N)=NEW

POLE SCHEDULE												
NO.	POLE DATA		SIGNAL M. A.	H.P. SOD. VAP. M.A. WATTS	SIGNAL MOUNTING			PED.PUSH BUTTON			ILLUMINATED SIGN MESSAGE (dbl.face)	
	TYPE	HEIGHT			VEH.	M.A.	PED.	TYPE	PHASE	QUAD		
(A)	19A-2-70	35'	30'	15'	400	SV-1-T	MAS	SP-1-T				Pierce St. 3700
(B)	1A	10'				TV-2-T			B	6P	E	
(C)	24A-4-70	35'	35'	15'	400	SV-1-T	2-MAS	SP-1-T	B	6P	W	Magnolia Ave. 11900
(D)	1A	10'				TV-1-T		SP-1-T	B	4P	S	
(E)	1A	10'				TV-1-T			B	4P	N	
(F)	19A-2-70	35'	30'	15'	400	SV-1-T	MAS	SP-1-T	B	4P	N	Pierce St. 9800
(G)	1A	10'				TV-2-T		SP-1-T	B	2P	W	
(H)	29-5-80(N)	30'	50'(N)	15'(N)	400(R)	SV-1-T(R)	2-MAS(R)		B(R)	2P	E	Magnolia Ave. 11800
(I)	1A(N)(A)	10'				TV-1-T(R)		SP-1-T(R)				
(J)	1A	10'				TV-1-T						

(N)=NEW
 (R)=RELOCATED
 (A)=ALUMINUM POLE

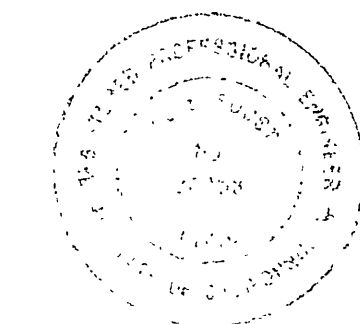

---AFA File: MAGPIE.DWG 1:32 PM 07/03/90

SO. CALIF. GAS CO.	PACIFIC BELL	CITY OF RIVERSIDE ELECT. DEPT.	CITY OF RIVERSIDE DOM. WATER DEPT.	CITY OF RIVERSIDE FIRE DEPT.
BY: _____	BY: _____	BY: _____	BY: _____	BY: _____
DATE: _____	DATE: _____	DATE: _____	DATE: _____	DATE: _____

AUSTIN-FOUST ASSOCIATES, INC.
 TRAFFIC ENGINEERING AND TRANSPORTATION PLANNING
 2020 NORTH TUSTIN AVENUE SANTA ANA, CALIFORNIA 92701
 TELEPHONE (714) 667-0496 FAX (714) 667-7952
 DATE: 7-3-90
 JOE E. FOUST, RCE 20258 EXPIRE 9-30-93

BENCH MARK			
MARK	REVISIONS	APPROPRIATE	
DESIGNED BY: JFOUST	DRAWN BY: JHARTER	CHECKED BY: _____	

CITY OF RIVERSIDE PUBLIC WORKS DEPARTMENT			
APPROVED BY	DATE	BY	APPROVED BY
PRINCIPAL ENGINEER	10/9/90	lca	Barry Beck
PARK DEPARTMENT			PUBLIC WORKS DIRECTOR
TRAFFIC DIVISION	10-3-90	JB	
CHIEF P.W. ENGINEER	10-12-90	RAC	
			DATE: 10/12/90

TRAFFIC SIGNAL PLAN	X-324A
MAGNOLIA AVENUE AND PIERCE STREET	
HORIZ. SCALE: 1" = 20'	SHEET 1 of 1

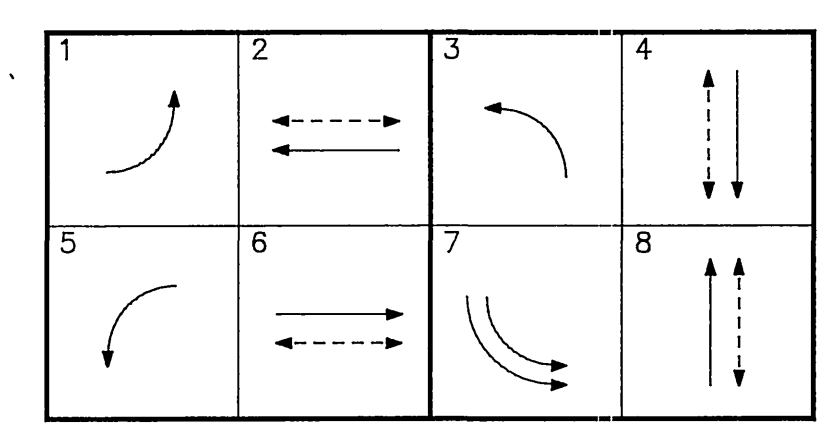
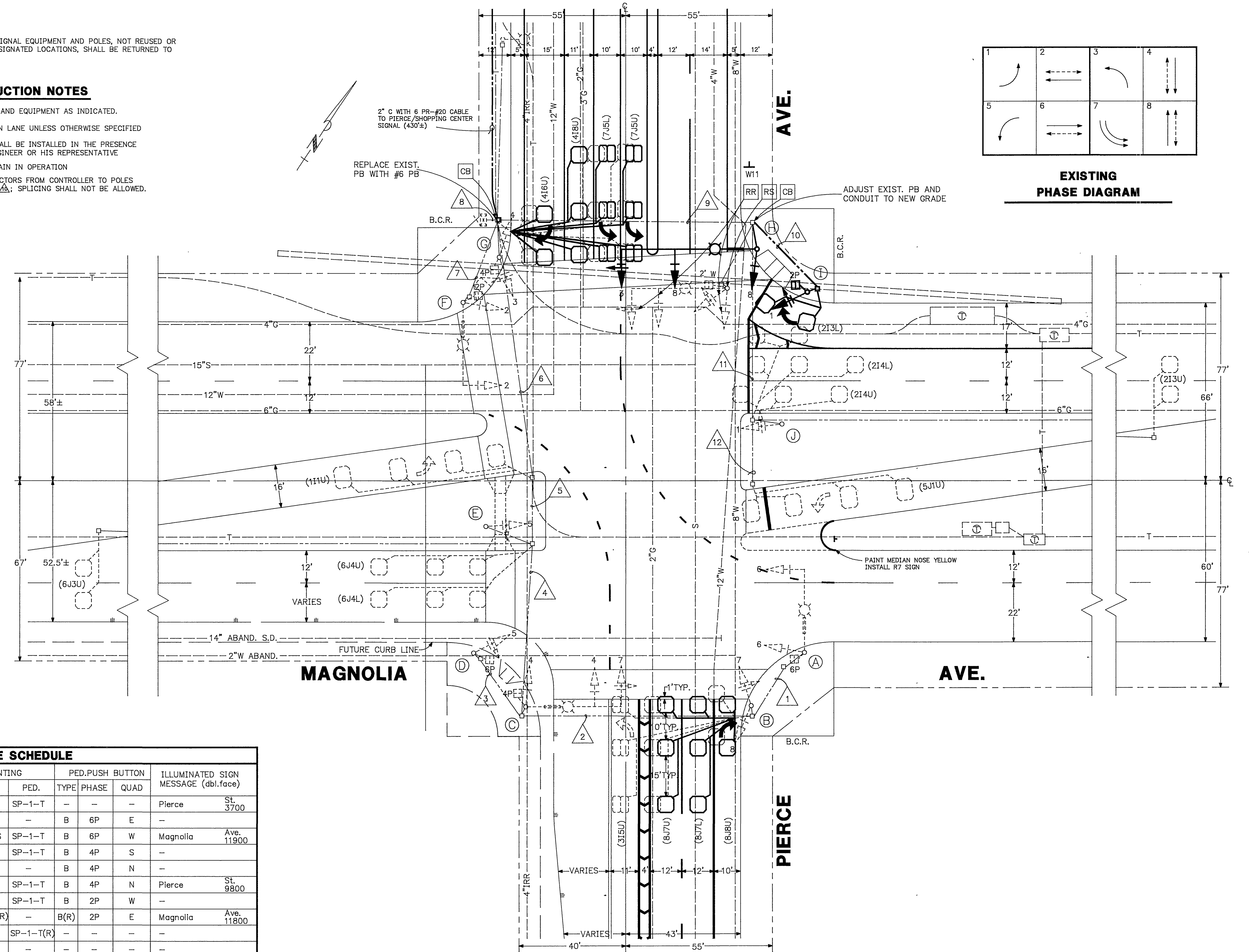

EXISTING PHASE DIAGRAM

INDEXED 12-12-90 GH

EQUIPMENT SCHEDULE										
LOCATION	STANDARD	VEHICLE HEADS			PEDESTRIAN HEADS			LUMINAIRE		REMARKS
		HEAD	MOUNTING	BACK	HEAD	MOUNTING	PPR	WATTAGE	INT ILLUM STREET NAME SIGN	
A	PA-270	1W30C	MAG	1	1W2C	SP-1-T		400W	Pierce Street	
B	(100)	2W30C	TV-2-T	1						
C	PA-170	1W30C	MAG	1	1W2C	SP-1-T		400W	Magnolia	
D	(100)	1W30C	TV-1-T	1	1W2C	SP-1-T				
E	(100)	1W30C	TK-1-T	1						
F	PA-270	1W30C	MAG	1	1W2C	SP-1-T		400W	Pierce	
G	(100)	2W30C	TK-2-T	2	1W2C	SP-1-T				
H	PA-170	1W30C	MAG	1	1W2C	SP-1-T		400W	Magnolia	
I	(100)	1W30C	TK-1-T	1						

* Programmed Visibility Head
 All Type I Signatures shall be Aluminum
 ALL INT. LUM. ST. NAME SIGNS HAVE THEIR OWN PHOTO-ELECTRIC CELL

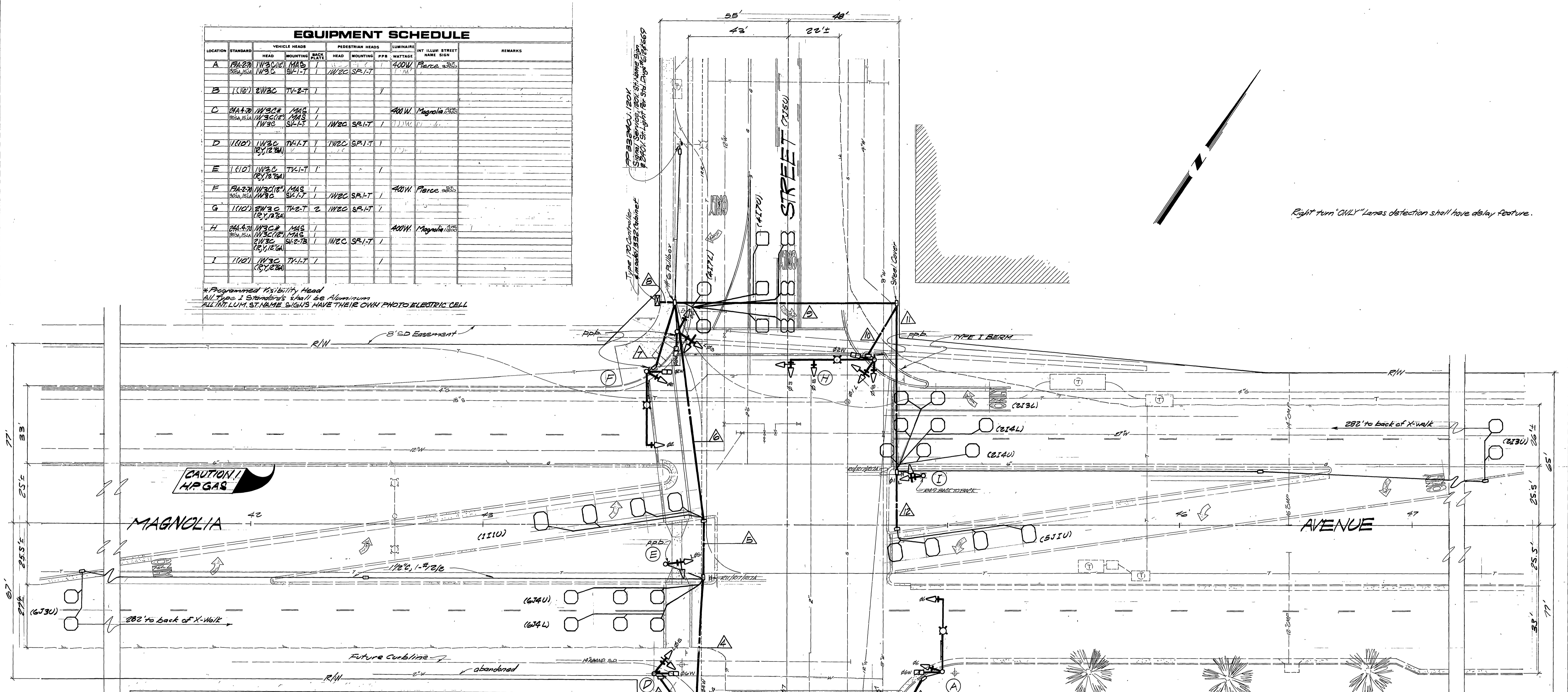

CONDUCTOR SCHEDULE																					
CONTROL FUNCTION	CONDUCTORS	CONDUIT RUN																			
		1	2	3	4	5	6	7	8	9	10	11	12	13	14	15	16	17	18	19	20
Vehicle Head	#14 THW																				
Back Head	#2 THW																				
Red Distribution	#2 THW																				
Green Common	#2 THW																				
Dist. Cables	#10 PE																				
St. Name Sign	#2 THW																				
Signal Support	#2 THW																				
Luminaire	#2 THW																				
Totals		13	13	29	30	32	10	69	20	22	5	2									
Equivalent #12		(215)	(215)	(45)	(45)	(70)	(615)	(161)	(120)	(425)	(93)	(215)	(6)								
CONDUIT SIZE		2"	2"	2"	3"	2"	3"	2"	2"	2"	2"	2"	2"	2"	2"	2"	2"	2"	2"	2"	2"

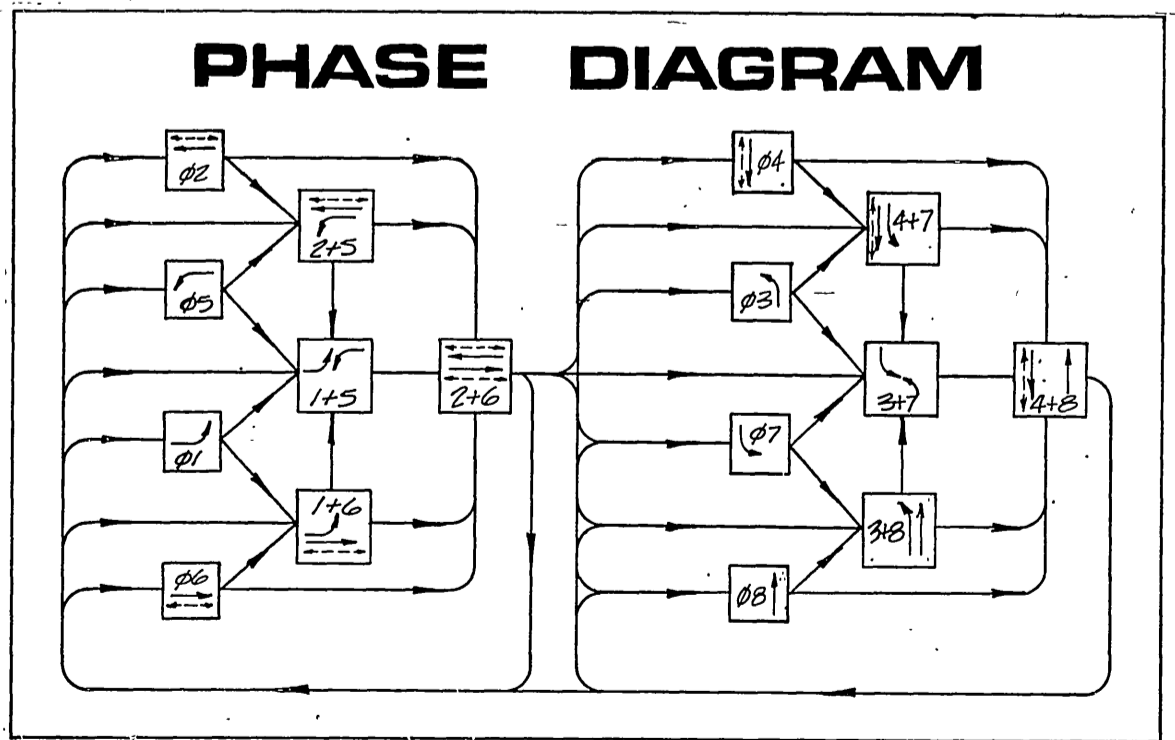

Ret. Pgs: #R-2310, R-2203, R1786

CITY OF RIVERSIDE, CALIFORNIA PUBLIC WORKS DEPARTMENT		TRAFFIC SIGNALS MAGNOLIA AVENUE AT PIERCE STREET		ACCOUNT No. 30-52-226-07 DRAWING NUMBER X-324 SHEET OF
APPROVED BY PRINCIPAL ENGINEER PARK DEPARTMENT TRAFFIC DIVISION CHIEF PUB. WKS. ENGR. DESIGNED BY DRAWN BY CHECKED BY	APPR. DATE 1/11/81	APPROVED BY DIRECTOR OF PUBLIC WORKS DATE APRIL 17, 1981	SCALE: 1" = 20'	