

CONDUCTOR		TABLE							
AWG	CIRCUIT	RUNS							
		1	2	3	4	5	6	7	8
#1				3(N)	3(N)	3(N)			
#2		3	3	3					
#3				3(N)	3(N)	3(N)	3(N)	3(N)	
#4				3					
#5		3(N)	3(N)	6(N)	3(N)	3(N)	3(N)	3(N)	3(N)
#6				3	3	3			
#7			3(N)	6(N)					
#8				3	3	3	3	3	
#2 PED		2	2	4	2				
#4 PED				4	2	2	2		
#6 PED				2	2	2	2	2	2
#8 PED			2	4	2	2	2	2	
#2 PPB			1	2					
#4 PPB				1	1	1			
#6 PPB				1	1	1	1	1	
#8 PPB			1	1	1	1	1	1	1
PPB COMMON		1	1	2	1	1	1	1	1
SPARES		3	3	6	3	3	3	3	3
TOTAL		13	19	58	30	28	21	19	10

DLC		TABLE							
#12/2	CIRCUIT	RUNS							
		1	2	3	4	5	6	7	8
#1	DETECTOR			1	1	1	1	1	1
#2	DETECTOR			2	2				
#3	DETECTOR		1	1					
#4	DETECTOR			2	2	2	2		
#5	DETECTOR			1	1				
#6	DETECTOR			2	2	2	2	2	2
#7	DETECTOR			1	1	1	1		
#8	DETECTOR		3	3					
TOTAL			4	13	9	6	6	3	3

#8	LUMINAIRE	2	2		2	2	2	2	
#10	SIGNAL COMMON	1	1	2	1	1	1	1	1
#12	IISNS	2	2		2	2	2	2	2
#8	SIGNAL SERVICE			2	2				
#20/4	EVPE	2(N)	2(N)	4(N)					

CONDUIT SIZE	2"	2.5"	2-3"(N)	3"	3"	2.5"	2.5"	2"

ALL CONDUIT AND CONDUCTORS ARE EXISTING UNLESS OTHERWISE INDICATED AS (N) NEW. REMOVE ANY UNUSED PHASE CONDUCTORS.

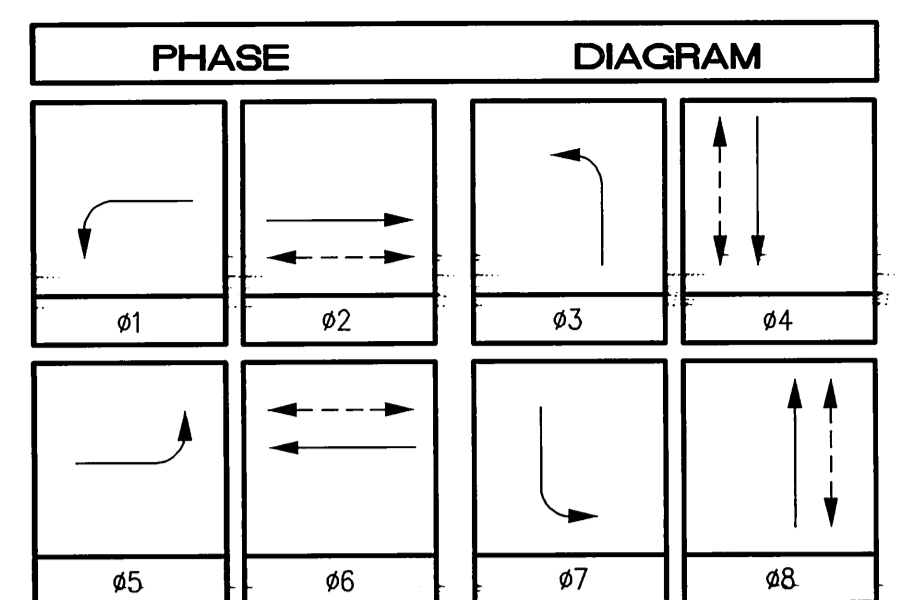

POLE										SCHEDULE			
No.	TYPE	HGT.	SIG. M.A.	LUM. M.A.	LUMINAIRE HPS	IISNS LEGEND	SIGNAL MOUNTING			PPB PHASE	REMARKS		
							VEHICLE	PED	AUDIBLE				
1	24-4-80 (N)	30'	35'(N)	12'(N)	250W(R)	Colorado Ave 4600(R)	MAS(N)	MAS(R)	SV-1-T(R)	SP-1-T(R)	((P))(N)	ø4 (N)	
2	1-A (H)	10'							TV-1-T(N)	SP-1-T(N)	((C))(N)	ø6 (N)	
3	19-4-80 (N)	30'	25'(N)	12'(N)	250W(R)	Jackson St 9000(R)	MAS(N)	MAS(R)	SV-1-T(R)	SP-1-T(R)	((C))(N)	ø6 (N)	
4	1-A	10'							TV-1-T(N)	SP-1-T	((P))(N)	ø8 (N)	
5	26-4-80 (N)	30'	45'(N)	12'(N)	250W(R)	Colorado Ave 4500(R)	MAS(N)	MAS(R)	SV-1-T(R)	SP-1-T(R)	((P))(N)	ø8 (N)	
6	1-A	10'							TV-1-T(N)	SP-1-T	((C))(N)	ø2 (N)	
7	18-4-80 (N)	17'	25'(N)			Jackson St 1000(R)	MAS(N)	MAS(R)	SV-1-T(R)	SP-1-T(R)	((C))(N)	ø2 (N)	
8	1-A	10'							TV-1-T(N)	SP-1-T	((P))(N)	ø4 (N)	

ALL EQUIPMENT IS EXISTING UNLESS OTHERWISE INDICATED AS (N) NEW OR (R) RELOCATE. ((C)) OR ((P)) - INDICATES AUDITORY PEDESTRIAN SIGNAL TO BE INSTALLED: ((C)) INDICATES CUCKOO SOUND; ((P)) INDICATES PEEP-PEEP SOUND.

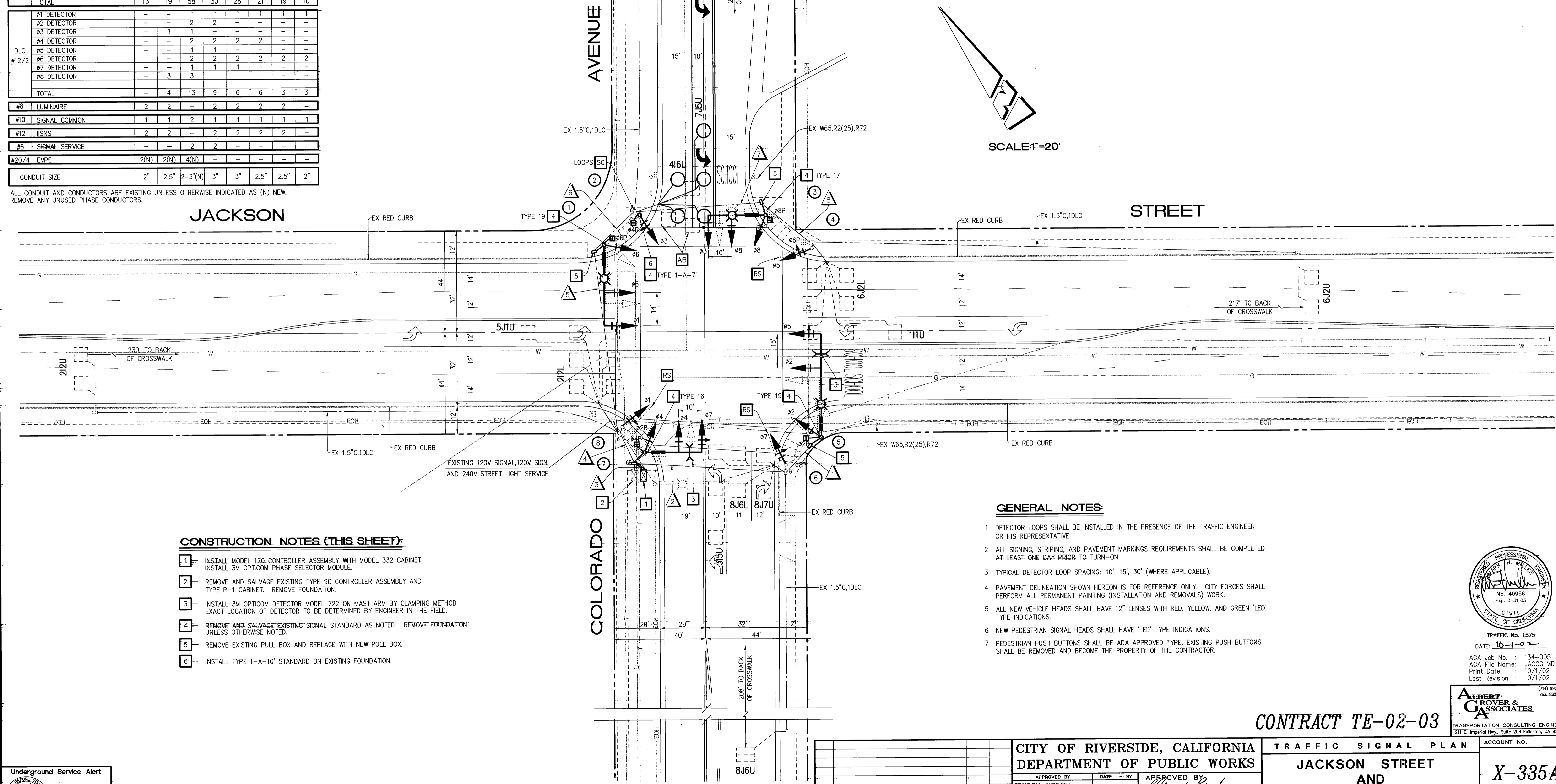

- CONSTRUCTION NOTES (THIS SHEET):**
- INSTALL MODEL 170 CONTROLLER ASSEMBLY WITH MODEL 332 CABINET. INSTALL 3M OPTICOM PHASE SELECTOR MODULE.
 - REMOVE AND SALVAGE EXISTING TYPE 90 CONTROLLER ASSEMBLY AND TYPE P-1 CABINET. REMOVE FOUNDATION.
 - INSTALL 3M OPTICOM DETECTOR MODEL 722 ON MAST ARM BY CLAMPING METHOD. EXACT LOCATION OF DETECTOR TO BE DETERMINED BY ENGINEER IN THE FIELD.
 - REMOVE AND SALVAGE EXISTING SIGNAL STANDARD AS NOTED. REMOVE FOUNDATION UNLESS OTHERWISE NOTED.
 - REMOVE EXISTING PULL BOX AND REPLACE WITH NEW PULL BOX.
 - INSTALL TYPE 1-A-10' STANDARD ON EXISTING FOUNDATION.

- GENERAL NOTES:**
- DETECTOR LOOPS SHALL BE INSTALLED IN THE PRESENCE OF THE TRAFFIC ENGINEER OR HIS REPRESENTATIVE.
 - ALL SIGNING, STRIPING, AND PAVEMENT MARKINGS REQUIREMENTS SHALL BE COMPLETED AT LEAST ONE DAY PRIOR TO TURN-ON.
 - TYPICAL DETECTOR LOOP SPACING: 10', 15', 30' (WHERE APPLICABLE).
 - PAVEMENT DELINEATION SHOWN HEREON IS FOR REFERENCE ONLY. CITY FORCES SHALL PERFORM ALL PERMANENT PAINTING (INSTALLATION AND REMOVALS) WORK.
 - ALL NEW VEHICLE HEADS SHALL HAVE 12" LENSES WITH RED, YELLOW, AND GREEN 'LED' TYPE INDICATIONS.
 - NEW PEDESTRIAN SIGNAL HEADS SHALL HAVE 'LED' TYPE INDICATIONS.
 - PEDESTRIAN PUSH BUTTONS SHALL BE ADA APPROVED TYPE. EXISTING PUSH BUTTONS SHALL BE REMOVED AND BECOME THE PROPERTY OF THE CONTRACTOR.



CITY OF RIVERSIDE, CALIFORNIA DEPARTMENT OF PUBLIC WORKS		TRAFFIC SIGNAL PLAN JACKSON STREET AND COLORADO AVENUE		ACCOUNT NO. X-335A
APPROVED BY PRINCIPAL ENGINEER INSPECTION TRAFFIC DIVISION CHIEF P. W. ENGINEER PUBLIC UTILITIES	DATE 10/7/02	APPROVED BY <i>Tom Bond</i> PUBLIC WORKS DIRECTOR	DATE 10/1/02	SHEET 8 OF 9

HORIZ. SCALE: 1" = 20' VERT. SCALE: 1" = 10'

REGISTERED PROFESSIONAL ENGINEER
 H. MELTZER
 No. 40956
 Exp. 3-31-03
 CIVIL
 STATE OF CALIFORNIA
 TRAFFIC No. 1575
 DATE: 10-1-02
 AGA Job No. : 134-005
 AGA File Name: JACCOLMD
 Print Date : 10/1/02
 Last Revision : 10/1/02

ALBERT GROVER & ASSOCIATES
 TRANSPORTATION CONSULTING ENGINEERS
 271 E. Imperial Hwy., Suite 208 Fullerton, CA 92833
 (714) 992-2900
 FAX 992-2883

CONTRACT TE-02-03

CONDUCTOR SCHEDULE

CONTROL FUNCTION	CONDUCTORS	RUNS								
		SIZE	INSULATION	Δ	Δ	Δ	Δ	Δ	Δ	
VEHICLE HEADS	#14 T.W.			3	3	6	3	3	3	3
PHASE 2				3	3	6	3	3	3	3
PHASE 4				3	3	3	3	3	3	3
PHASE 6				3	3	3	3	3	3	3
PHASE 8				3	3	3	3	3	3	3
PED. HEADS										
PHASE 2		2	2	4	2					
PHASE 4				4	2	2	2			
PHASE 6				2	2	2	2	2	2	2
PHASE 8				2	4	2	2	2	2	2
PED. PUSH BUTTON										
PHASE 2				1	2					
PHASE 4				1	1	1	1			
PHASE 6				1	1	1	1	1	1	1
PHASE 8				1	1	2	1	1	1	1
SPARES				3	3	6	3	3	3	3
12V COMMON				1	1	2	1	1	1	1
DETECTORS	#12/2 P.E.									
PHASE 2						3	3			
PHASE 4						3	3	3	3	
PHASE 6						3	3	3	3	3
PHASE 8						4	4			
I.I.S.N.S.	#12 T.W.	2	2			2	2	2	2	
120V COMMON	#10 T.W.	1	1	2	1	1	1	1	1	1
LUMINAIRES	#8 T.H.W.	2	2			2	2	2	2	
SIGNAL SERVICE	#8 T.H.W.	2	2			2	2			
TOTAL	#14 T.W.	10	16	46	24	22	18	16	10	
	#12/2 P.E.	4	13	9	6	6	3	3		
	#12 T.W.	2	2			2	2	2		
	#10 T.W.	1	1	2	1	1	1	1	1	
	#8 T.H.W.	2	2			2	2	2		
#14 EQUIV. CONDUIT SIZE		18.5	24.5	92.6	64.1	48.5	44.5	33.5	20.5	
		2"	2 1/2"	3"	3"	3"	2 1/2"	2"	2"	

Conduit run #5 depth is 12".

DETECTOR SCHEDULE

CHANNELS	LOOP DESIGNATION	NUMBER OF LOOPS	FEATURES
1	2-N-2	2	
2	3-N-2	4	
1	1-N-2	2	● ■
2	2-E-4	2	
1	3-E-4	1	▲
2	1-E-4	1	● ■
1	2-S-6	3	
2	3-S-6	4	
1	1-S-6	2	● ■
2	2-W-8	3	
1	3-W-8	2	▲
2	4-W-8	2	● ■
1	1-W-8	1	▲

- SAMPLING
- CALL-HOLD(EXTENSION)
- ▲ DELAY

Information in detector schedule is for assignment only.

POLE SCHEDULE

No.	TYPE	STANDARD			LUM. HPSV	I.S.N.S. LEGEND	SIGNAL HEAD	SIGNAL VEHICLE	SIGNAL MOUNTING PED	PPB PHASE	REMARKS
		HGT.	SIG. M.A.	LUM. M.A.							
(A)	19-2-80	30'	25'	12'	250w	Colorado Ave 4600	1W3C	MAS	SV-1-T	SP-1-T	4
(B)	1A	7'					1W3C	TV-1	SP-1-T		6
(C)	17-2-80	30'	20'	12'	250w	Jackson St 9000	1W3C	MAS	SV-1-T	SP-1-T	6
(D)	1A	10'					1W3C	TV-1	SP-1-T		8
(E)	19-2-80	30'	25'	12'	250w	Colorado Ave 4600	1W3C	MAS	SV-1-T	SP-1-T	8
(F)	1A	10'					1W3C	TV-1	SP-1-T		2
(G)	16-2-80	17'	20'			Jackson St 9100	1W3C	MAS	SV-1-T	SP-1-T	2
(H)	1A	10'					1W3C	TV-1	SP-1-T		4

- NOTES: 1. All vehicular heads have 12" lenses.
2. Type 1A poles are aluminum.

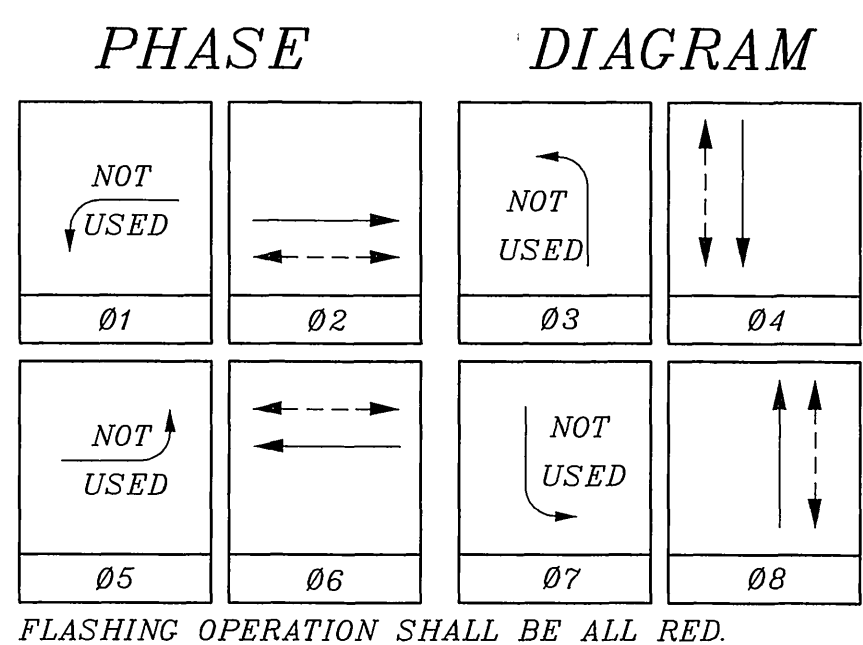
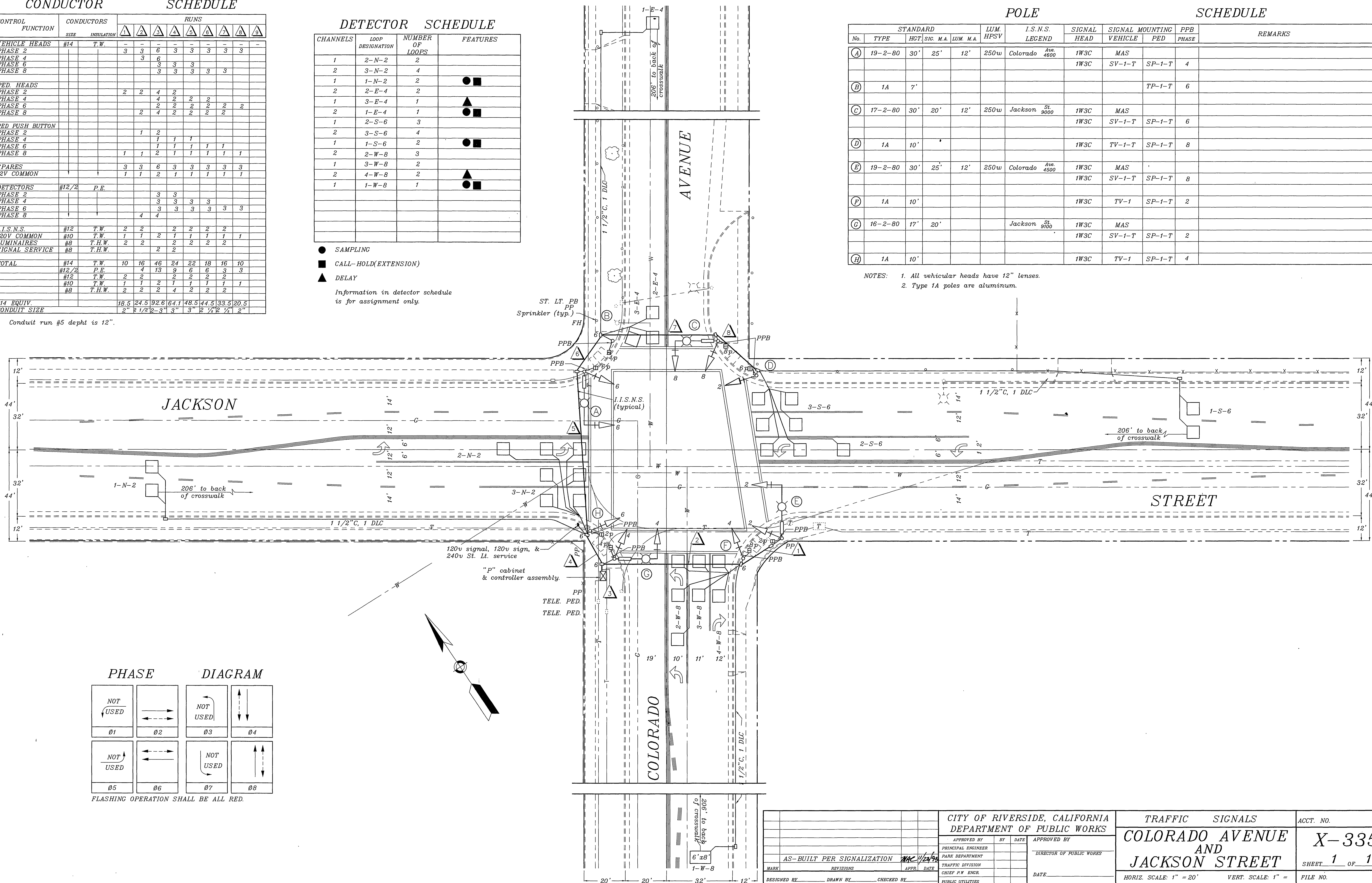

CITY OF RIVERSIDE, CALIFORNIA DEPARTMENT OF PUBLIC WORKS				TRAFFIC SIGNALS		ACCT. NO.
APPROVED BY _____ BY _____ DATE _____				APPROVED BY _____		X-335
AS-BUILT PER SIGNALIZATION				DIRECTOR OF PUBLIC WORKS		
MARK	DESIGNED BY	DRAWN BY	CHECKED BY	TRAFFIC DIVISION	CHIEF P.W. ENGR.	SHEET 1 OF 1
REVISIONS	APPR. DATE					FILE NO.
				DATE _____		
				PUBLIC UTILITIES		

HORIZ. SCALE: 1" = 20' VERT. SCALE: 1" = _____