

**CONDUCTOR SCHEDULE**

CONTROL FUNCTION	CONDUCTORS		RUNS							
	SIZE	INSULATION	1	2	3	4	5	6	7	8
VEHICLE HEADS #14	T.W.	-	-	-	-	-	-	-	-	-
PHASE 2			3	3	6	3	3	3	3	3
PHASE 4					3	3	3	3	3	3
PHASE 6					3	3	3			
PHASE 8				3	3					
PED. HEADS										
PHASE 2					2	2	2	2	2	2
PHASE 4					4	2	2	2		
PHASE 6			2	2	4	2				
PHASE 8			2	2	4	2	2	2		
PED PUSH BUTTON										
PHASE 2					2	2	2	2	1	
PHASE 4					2	2	1			
PHASE 6				1	2					
PHASE 8			1	1	2	1	1	1	1	1
SPARES			3	3	6	3	3	3	3	3
12V COMMON			1	1	2	1	1	1	1	1
DETECTORS #12/2	P.E.					3	3	3		
PHASE 2						1				
PHASE 4						3	3			
PHASE 6						1	1	1	1	1
PHASE 8						1	1	1	1	1
I.S.N.S. #12	T.W.		2		2	2	2	2	2	2
120V COMMON #10	T.W.		1	1	2	1	1	1	1	1
LUMINAIRES #8	T.H.W.		2		2	2	2	2	2	2
SIGNAL SERVICE #6	T.H.W.				2					
INTERCONNECT #20	P.E.		1	1	2	1				
TOTAL #14	T.W.		10	16	45	26	23	19	16	13
#12	T.W.			2	2	2	2	2	2	2
#10	T.W.		1	1	2	1	1	1	1	1
#8	T.H.W.		2		2	2	2	2	2	2
#6	T.H.W.				2					
#12/2	P.E.		3	3	6	4	4	4	4	4
#20	P.E.		1	1	2	1				
#14 EQUIV.			23.5	36.5	82.5	44.9	43.5	30.5	27.5	21.5
CONDUIT SIZE			2"	2 1/2"	2" 3/4"	3"	2 1/2"	2"	2"	2"

Interconnect is 6 pair 20 gauge.

**POLE SCHEDULE**

No.	TYPE	STANDARD			LUM. HPSV	I.S.N.S. LEGEND	SIGNAL HEAD	SIGNAL VEHICLE	MOUNTING PED	PPB PHASE	REMARKS
		HGT	SIG.	M.A. LUM. M.A.							
(A)	19-2-80	30'	30'	12'	250w	PHOENIX AV 6800	1W3C	MAS	SP-1-T	8	
							2W3C	SV-2-TB	SP-1-T	8	
(B)	1A	7'							TP-1-T	2	
(C)	17-2-80	30'	18'	12'	200w	CENTRAL AV 6800	1W3C	MAS	SP-1-T	2	
							1W3C	SV-1-T	SP-1-T	2	
(D)	1A	10'						TV-1-T	SP-1-T	4	
(E)	19-2-80	30'	30'	12'	250w	PHOENIX AV 6800	1W3C	MAS	SP-1-T	4	
							1W3C	SV-1-T	SP-1-T	4	
(F)	1A	7'							TP-1-T	6	
(G)	17-2-80	30'	18'	12'	200w	CENTRAL AV 6800	1W3C	MAS	SP-1-T	6	
							1W3C	SV-1-T	SP-1-T	6	
(H)	1A	10'						TV-1-T	SP-1-T	8	

NOTE: 1. All vehicular heads have 12" lenses.  
2. Luminaires are High Pressure Sodium Vapor.  
3. All 1A standards are aluminum.

**RISER DETAIL PP-18017J**

PP-18017J  
120v signal, 120v sign and 240v St. Lt. service

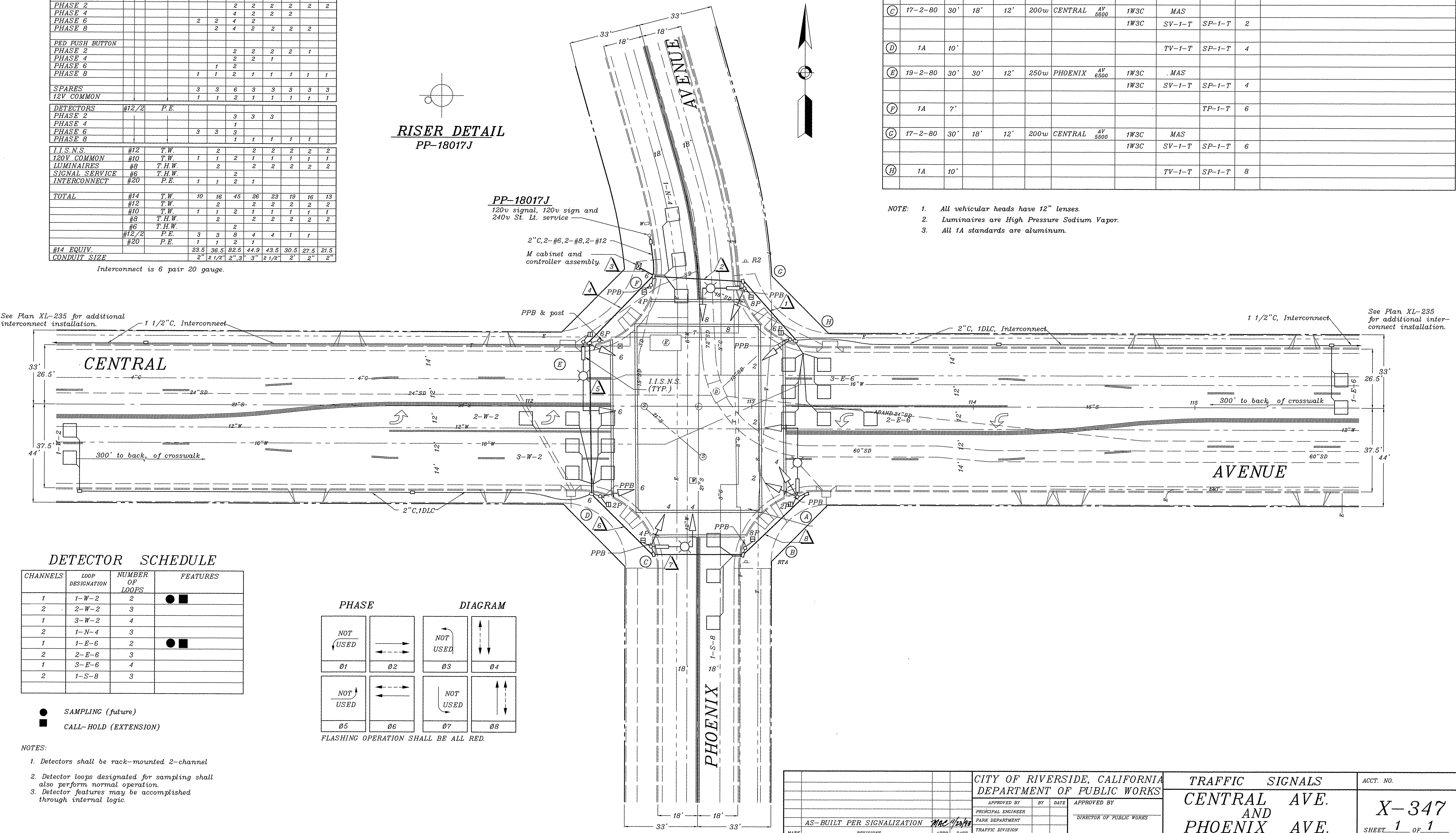

**DETECTOR SCHEDULE**

CHANNELS	LOOP DESIGNATION	NUMBER OF LOOPS	FEATURES
1	1-W-2	2	● ■
2	2-W-2	3	
1	3-W-2	4	
2	1-N-4	3	
1	1-E-6	2	● ■
2	2-E-6	3	
1	3-E-6	4	
2	1-S-8	3	

● SAMPLING (future)  
■ CALL-HOLD (EXTENSION)

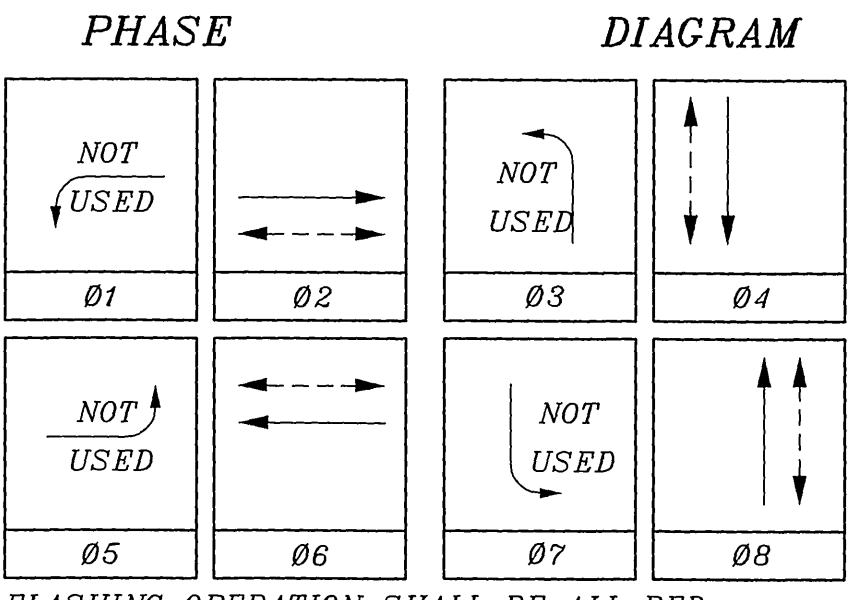

NOTES:  
1. Detectors shall be rack-mounted 2-channel  
2. Detector loops designated for sampling shall also perform normal operation.  
3. Detector features may be accomplished through internal logic.

CITY OF RIVERSIDE, CALIFORNIA DEPARTMENT OF PUBLIC WORKS				TRAFFIC SIGNALS CENTRAL AVE. AND PHOENIX AVE.		ACCT. NO. <b>X-347</b>
APPROVED BY	BY	DATE	APPROVED BY	DATE	FILE NO.	
PRINCIPAL ENGINEER			DIRECTOR OF PUBLIC WORKS			
PARK DEPARTMENT						
TRAFFIC DIVISION						
CHIEF P.W. ENGR.						
PUBLIC UTILITIES						

AS-BUILT PER SIGNALIZATION **MAR 12/2013**

DESIGNED BY: \_\_\_\_\_ DRAWN BY: \_\_\_\_\_ CHECKED BY: \_\_\_\_\_

HORIZ. SCALE: 1" = 20' VERT. SCALE: 1" = \_\_\_\_\_