

CONTROL FUNCTION	CONDUCTORS	CONDUCTOR RUNS																		
		1	2	3	4	5	6	7	8	9	10									
VEHICLE & PEDESTRIAN HEADS, PEDESTRIAN PUSH BUTTONS, SPARES & COMMONS	12 WIRE IMSA 9 WIRE IMSA 5 WIRE IMSA 3 WIRE IMSA	1	1	1	2	1	1	-	-	-	-	-	-	-	-	-	-	-	-	-
DETECTOR CABLE	#16/2	-	-	-	-	-	-	-	-	-	-	-	-	-	-	-	-	-	-	-
PHASE 1		-	-	-	1	1	1	1	1	1	1	-	-	-	-	-	-	-	-	-
PHASE 2		-	-	-	2	2	-	-	-	-	-	-	-	-	-	-	-	-	-	-
PHASE 3 (NOT USED)		-	-	-	-	-	-	-	-	-	-	-	-	-	-	-	-	-	-	-
PHASE 4		-	-	-	2	2	2	2	2	2	2	-	-	-	-	-	-	-	-	-
PHASE 5		-	-	-	1	1	-	-	-	-	-	-	-	-	-	-	-	-	-	-
PHASE 6		-	-	-	2	2	2	2	2	2	2	-	-	-	-	-	-	-	-	-
PHASE 7 (NOT USED)		-	-	-	-	-	-	-	-	-	-	-	-	-	-	-	-	-	-	-
PHASE 8		-	1	1	1	-	-	-	-	-	-	-	-	-	-	-	-	-	-	-
TOTALS		-	1	1	9	8	5	5	5	3	3	-	-	-	-	-	-	-	-	-
PRE-EMPTION CABLE	4#20	1	1	1	2	1	1	-	-	-	-	-	-	-	-	-	-	-	-	-
INTERCONNECT CABLE	6-PAIR #19	-	-	-	-	-	-	-	-	-	-	-	-	-	-	-	-	-	-	-
I.I.S.N.S.	#12	2	2	2	-	2	2	2	2	2	-	-	-	-	-	-	-	-	-	-
LUMINAIRES	#8	2	2	2	-	2	2	2	2	2	-	-	-	-	-	-	-	-	-	-
SIGNAL SERVICE	#6	-	-	-	2	-	-	-	-	-	-	-	-	-	-	-	-	-	-	-
CONDUIT SIZE		2"	2.5"	3"	2-3"	3.5"	3"	3"	2.5"	2"	1.5"	-	-	-	-	-	-	-	-	-

NOTE:
SEE SPECIAL PROVISIONS FOR ADDITIONAL INFORMATION ON EMERGENCY PRE-EMPTION CABLE.

NO.	SIGNAL STANDARD TYPE	HEIGHT	M.A.	LUMINAIRE M.A.	H.P.S.V.	I.I.S.N.S. LEGEND	SIGNAL MOUNTINGS			PPB PHASE	REMARKS	
							VEHICLE	PEDESTRIAN	AUDIBLE			
(A)	17-2-80	30'	20'	12'	200W	LA SIERRA	AVE 4100	MAS SV-1-T	SP-1-T	((IP))	6	
(B)	1A	10'						TV-1-T	SP-1-T	((CI))	8	
(C)	29-5-80	30'	50'	12'	250W	SPAULDING	DR 1100	MAS SV-1-T	SP-1-T	((CI))	8	
(D)	1A	10'						TV-1-T	SP-1-T	((IP))	2	
(E)	17-2-80	30'	20'	12'	200W	LA SIERRA	AVE 4000	MAS SV-1-T	SP-1-T	((IP))	2	
(F)	1A	10'										SERVICE POLE
(G)	1A	10'						TV-1-T	SP-1-T	((CI))	4	
(H)	26-4-80	30'	40'	12'	250W	SPAULDING	DR 1100	MAS SV-1-T	SP-1-T	((CI))	4	
(I)	1A	10'						TV-1-T	SP-1-T	((IP))	6	

- NOTES:
- ALL VEHICULAR HEADS ARE 12" LENSES.
 - ALL LEFT TURN HEADS ARE ALL ARROWS.
 - TYPE 1-A STANDARDS ARE ALUMINUM.
 - ((CI)) OR ((IP)) - INDICATES AUDITORY PEDESTRIAN SIGNAL.
((CI)) INDICATES CUCKOO SOUND; ((IP)) INDICATES PEEP-PEEP SOUND.

CITY OF RIVERSIDE, CALIFORNIA DEPARTMENT OF PUBLIC WORKS		TRAFFIC SIGNAL INSTALLATION		ACCT. NO.
AS-BUILT PER TE-96-1		LA SIERRA AVENUE AND SPAULDING DRIVE		X-385
APPROVED BY	BY DATE	APPROVED BY		SHEET 1 OF 1
PRINCIPAL ENGINEER		DIRECTOR OF PUBLIC WORKS		
P.W. INSPECTION	APPR. DATE			
TRAFFIC DIVISION				
CHIEF P.W. ENGR				
PUBLIC UTILITIES				
DESIGNED BY	DRAWN BY	CHECKED BY		FILE NAME: X385AS.DWG

LOOP DESIGNATION	NUMBER OF LOOPS	COMMENTS
111U	3	
212U	2	
212L	4	
416U	3	
416L	3	
5J1U	3	
6J2U	2	
6J2L	4	
8J6U	3	

GENERAL NOTES

- 1 - DETECTOR LOOPS SHALL BE INSTALLED IN THE PRESENCE OF THE CITY TRAFFIC ENGINEER OR HIS REPRESENTATIVE.
- 2 - TYPICAL DETECTOR LOOP SPACINGS: 10' AND 15'.
- 3 - PAVEMENT DELINEATION SHOWN HEREON IS FOR REFERENCE ONLY.
- 4 - ALL SIGNING, STRIPING AND PAVEMENT MARKING REQUIREMENTS, SHALL BE COMPLETED AT LEAST ONE DAY PRIOR TO TURN-ON.

NOTE:
DETECTORS SHALL BE 2-CHANNEL RACK MOUNTED.

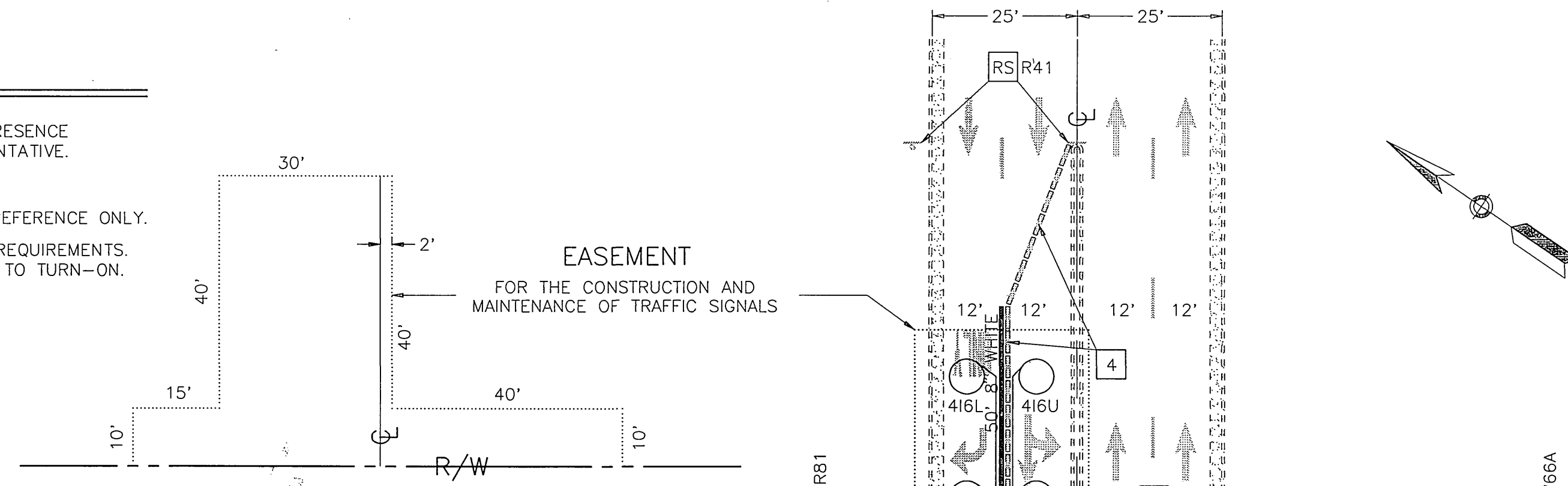

PAVEMENT DELINEATION

- FOR REFERENCE ONLY
- INDICATES STRIPING AND PAVEMENT MARKINGS TO BE INSTALLED.
 - INDICATES STRIPING AND PAVEMENT MARKINGS TO REMAIN UNLESS OTHERWISE INDICATED.
 - INDICATES STRIPING AND PAVEMENT MARKINGS TO BE REMOVED.

NOTE: ALSO SEE CONSTRUCTION NOTE 2.

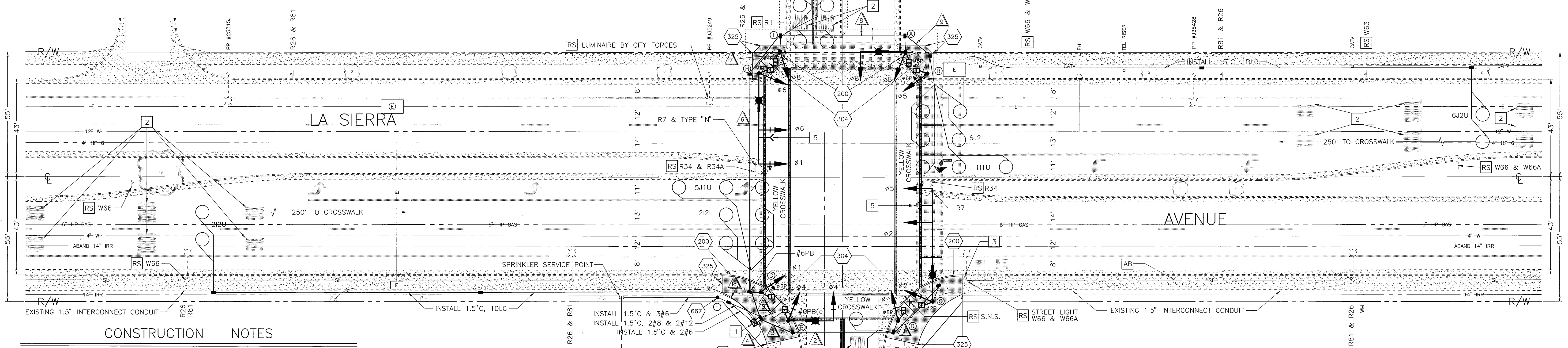
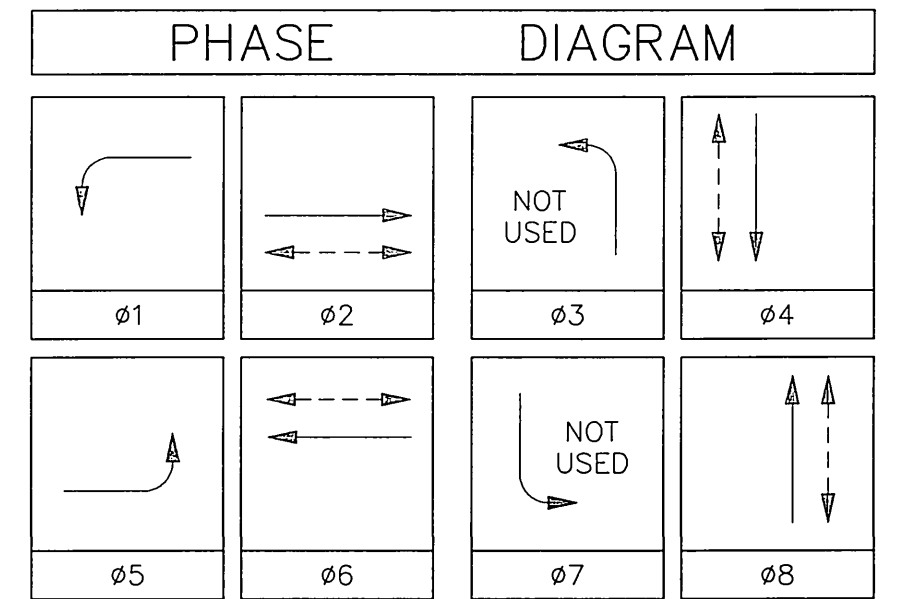

CONSTRUCTION NOTES

- 1 INSTALL MODEL 170 CONTROLLER UNIT HOUSED IN 332 CABINET.
- 2 REMOVE PAVEMENT MARKING BY CITY FORCES.
- 3 RELOCATE AND STRAP R26 & R81 TO POLE LOCATION (C).
- 4 REMOVE AND SALVAGE (21) WHEEL STOPS.
- 5 INSTALL TRAFFIC SIGNAL EMERGENCY PRE-EMPTION DETECTOR.
- 200 CONSTRUCT P.C.C. CURB (6" C.F.) PER C/R STANDARD DRAWING NO. 200.
- 304 CONSTRUCT WHEELCHAIR RAMP PER C/R STANDARD DRAWING NO. 304.
- 325 CONSTRUCT SIDEWALK PER C/R STANDARD DRAWING NO. 325.
- 666 INSTALL SIGN PER C/R STANDARD DRAWING NUMBER 666.
- 667 INSTALL UNDERGROUND SERVICE PER C/R STANDARD DRAWING NUMBER 667.

CONDUCTOR		TABLE																			
CONTROL	FUNCTION	CONDUCTORS	CONDUCTOR RUNS																		
			1	2	3	4	5	6	7	8	9	10									
VEHICLE & PEDESTRIAN HEADS, PEDESTRIAN PUSH BUTTONS, SPARES & COMMONS	12 WIRE IMSA	1	1	1	2	1	1	1	1	1	1	1	1	1	1	1	1	1	1	1	1
	9 WIRE IMSA	1	1	2	6	4	3	3	2	1	1	1	1	1	1	1	1	1	1	1	1
	5 WIRE IMSA	1	1	1	1	1	1	1	1	1	1	1	1	1	1	1	1	1	1	1	1
	3 WIRE IMSA	1	2	3	8	5	4	3	2	1	1	1	1	1	1	1	1	1	1	1	1
DETECTOR CABLE	#16/2	1	1	1	1	1	1	1	1	1	1	1	1	1	1	1	1	1	1	1	1
PHASE 1		1	1	1	1	1	1	1	1	1	1	1	1	1	1	1	1	1	1	1	1
PHASE 2		1	1	1	1	1	1	1	1	1	1	1	1	1	1	1	1	1	1	1	1
PHASE 3 (NOT USED)		1	1	1	1	1	1	1	1	1	1	1	1	1	1	1	1	1	1	1	1
PHASE 4		1	1	1	1	1	1	1	1	1	1	1	1	1	1	1	1	1	1	1	1
PHASE 5		1	1	1	1	1	1	1	1	1	1	1	1	1	1	1	1	1	1	1	1
PHASE 6		1	1	1	1	1	1	1	1	1	1	1	1	1	1	1	1	1	1	1	1
PHASE 7 (NOT USED)		1	1	1	1	1	1	1	1	1	1	1	1	1	1	1	1	1	1	1	1
PHASE 8		1	1	1	1	1	1	1	1	1	1	1	1	1	1	1	1	1	1	1	1
TOTALS		1	1	1	9	8	5	5	3	3	3	3	3	3	3	3	3	3	3	3	3
PRE-EMPTION CABLE	4#20	1	1	1	2	1	1	1	1	1	1	1	1	1	1	1	1	1	1	1	1
INTERCONNECT CABLE	6-PAIR #19	1	1	1	1	1	1	1	1	1	1	1	1	1	1	1	1	1	1	1	1
U.S.N.S.	#12	2	2	2	2	2	2	2	2	2	2	2	2	2	2	2	2	2	2	2	2
LUMINAIRES	#8	2	2	2	2	2	2	2	2	2	2	2	2	2	2	2	2	2	2	2	2
SIGNAL SERVICE	#6	1	1	1	1	1	1	1	1	1	1	1	1	1	1	1	1	1	1	1	1
CONDUIT SIZE		2"	2.5"	3"	2-3"	3.5"	3"	3"	2.5"	2"	1.5"	1.5"	1.5"	1.5"	1.5"	1.5"	1.5"	1.5"	1.5"	1.5"	1.5"

NOTE:
SEE SPECIAL PROVISIONS FOR ADDITIONAL INFORMATION ON EMERGENCY PRE-EMPTION CABLE.

EQUIPMENT		SCHEDULE										
NO.	SIGNAL STANDARD TYPE	H'GHT	M.A.	M.A.	H.P.S.V.	LUMINAIRE	U.S.N.S. LEGEND	SIGNAL MOUNTINGS			PPB PHASE	REMARKS
								VEHICLE	PEDESTRIAN	AUDIBLE		
(A)	17-2-80	30'	20'	12'	200W	LA SIERRA	AVE 4100	MAS SV-1-T	SP-1-T	((IP))	6	
(B)	1A	10'						TV-1-T	SP-1-T	((C))	8	
(C)	29-5-80	30'	50'	12'	250W	SPAULDING	OR 11100	MAS SV-1-T	SP-1-T	((C))	8	
(D)	1A	10'						TV-1-T	SP-1-T	((IP))	2	
(E)	17-2-80	30'	20'	12'	200W	LA SIERRA	AVE 4200	MAS SV-1-T	SP-1-T	((IP))	2	
(F)	1A	10'										SERVICE POLE
(G)	1A	10'						TV-1-T	SP-1-T	((C))	4	
(H)	26-4-80	30'	40'	12'	250W	SPAULDING	OR 11100	MAS SV-1-T	SP-1-T	((C))	4	
(I)	1A	10'						TV-1-T	SP-1-T	((IP))	6	

- NOTES:
1. ALL VEHICULAR HEADS SHALL HAVE 12" LENSES.
 2. ALL LEFT TURN HEADS SHALL HAVE ALL ARROWS.
 3. PEDESTRIAN PUSH BUTTONS SHALL BE INSTALLED ON THE POLE IN THE QUADRANT NEAREST THE CROSSWALK SERVING THE PHASE.
 4. TYPE 1-A STANDARDS SHALL BE ALUMINUM.
 5. LUMINAIRES SHALL BE HIGH PRESSURE SODIUM VAPOR.
 6. ((C)) OR ((IP)) - INDICATES AUDITORY PEDESTRIAN SIGNAL TO BE INSTALLED. ((C)) INDICATES CUCKOO SOUND; ((IP)) INDICATES PEEP-PEEP SOUND.
 7. LOCATION OF THE EMERGENCY PRE-EMPTION DETECTOR ON THE MAST ARM SHALL BE AS DIRECTED IN THE FIELD BY THE CITY TRAFFIC ENGINEER OR HIS REPRESENTATIVE.

CONTRACTOR'S LICENSE REQUIREMENTS "A" OR "C-10"
CONTRACT TE-96-1

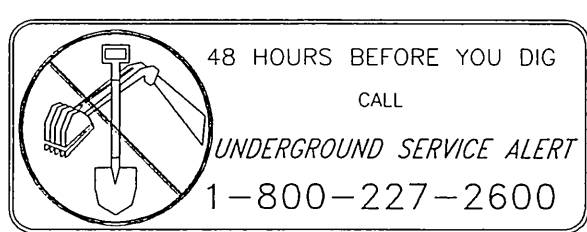

ENGINEER IN RESPONSIBLE CHARGE
Richard D. McGrath
RICHARD D. MCGRATH
R.C.E. NO. 31952 EXPIRES 12-31-96
DATE 2-2-96

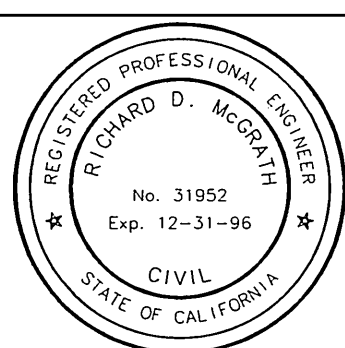

CITY OF RIVERSIDE, CALIFORNIA
DEPARTMENT OF PUBLIC WORKS
APPROVED BY: *[Signature]*
DATE: 2/5/96

TRAFFIC SIGNAL INSTALLATION
LA SIERRA AVENUE AND SPAULDING DRIVE

ACCT. NO. 0430-541600-440222-35076
X-385
SHEET 1 OF 1
FILE NAME: X385.DWG

MARK: _____
REVISIONS: _____
APPR. DATE: _____
DESIGNED BY: *[Signature]*
DRAWN BY: *[Signature]*
CHECKED BY: *[Signature]*