

CONDUCTOR TABLE

CONTROL FUNCTION	CONDUCTORS	CONDUCTOR RUNS								
		1	2	3	4	5	6	7	8	9
VEHICLE & PEDESTRIAN HEADS, PEDESTRIAN PUSH BUTTONS, SPARES & COMMONS	12 WIRE IMSA	1	2	3	4	8	3	2	1	
	3 WIRE IMSA	1	2	3	4	8	3	2	1	
DETECTOR CABLE	#16/2					1	1	1	1	
PHASE 1										
PHASE 2					3	3				
PHASE 3			1	1	1	1				
PHASE 4					1	1				
PHASE 5					1	1				
PHASE 6					2	2	2	2		
PHASE 7					1	1				
PHASE 8			2	2	2	2				
VEHICLE PREEMPTION	#20/4	1	1	2	2	4	1	1		
I.I.S.N.S.	#12	2	2	2	2	2	2	2		
LUMINAIRES	#8	2	2	2	2	2	2	2		
SIGNAL SERVICE	#6					2				
INTERCONNECT	#19					2	1	1	1	1
CONDUIT SIZE		2"(N)	3"	3"	3.5"	2-3"	3.5"	3"	3"	1.5"(N)

NOTE: 1. RUNS 1, 2, 3, 4 SHALL HAVE ALL NEW CABLES AND CONDUCTORS.
 2. SEE SPECIAL PROVISIONS FOR ADDITIONAL INFORMATION ON I.M.S.A. CABLE.
 3. INTERCONNECT CABLE SHALL BE 6 PAIR #19 GAUGE (SEE SPECIAL PROVISIONS).

EQUIPMENT SCHEDULE

NO.	SIGNAL STANDARD		LUMINAIRE		I.I.S.N.S. LEGEND	SIGNAL MOUNTINGS			PPB PHASE		
	TYPE	H'GHT	L.A.	H.P.S.V.		VEHICLE	PEDESTRIAN	AUDIBLE			
(A)	29-5-129(E)	30'	50'(N)	12'(E)	250W(E)	ARIZONA(E)	AV 1100	2-MAS(E) SV-1-T(E)	SP-1-T(E)	((C)) (E)	4(E)
(B)	1A(E)	10'						TV-1-T(E)	SP-1-T(E)	((P)) (E)	6(E)
(C)	19-4-129(E)	30'	30'(E)	12'(E)	250W(E)	LA SIERRA(E)	AV 3400	2-MAS(E) SV-1-T(E)	SP-1-T(E)	((P)) (E)	6(E)
(D)	1A(E)	10'						TV-1-T(E)	SP-1-T(E)	((C)) (E)	8(E)
(E)	29-5-129(N)	30'	50'(N)	12'(R)	250W(R)	ARIZONA(R)	AV 1100	2-MAS(R) SV-1-T(R)	SP-1-T(R)	((C)) (R)	8(R)
(F)	1A(R)	10'						TV-1-T(R)	SP-1-T(R)	((C)) (R)	2(R)
(G)	19-4-129(E)	30'	30'(E)	12'(E)	250W(E)	LA SIERRA(E)	AV 3400	2-MAS(E) SV-1-T(E)	SP-1-T(E)	((P)) (E)	2(E)
(H)	1A(E)	10'						TV-1-T(E)	SP-1-T(E)	((C)) (E)	4(E)

NOTES: 1. ALL VEHICULAR HEADS SHALL HAVE 12" LENSES.
 2. ALL LEFT TURN HEADS SHALL HAVE ALL ARROWS.
 3. ((C)) OR ((P)) - INDICATES AUDITORY PEDESTRIAN SIGNAL TO BE INSTALLED.
 ((C)) INDICATES CUCKOO SOUND; ((P)) INDICATES PEEP-PEEP SOUND.
 4. PEDESTRIAN PUSH BUTTONS SHALL BE INSTALLED ON THE POLE IN THE QUADRANT NEAREST THE CROSSWALK SERVING THE PHASE.

INSTALL 1 1/2" C, INTERCONNECT TO #6(e) N/W CORNER LA SIERRA AND RALPH'S ENTRANCE, SEE PLAN XL-303.

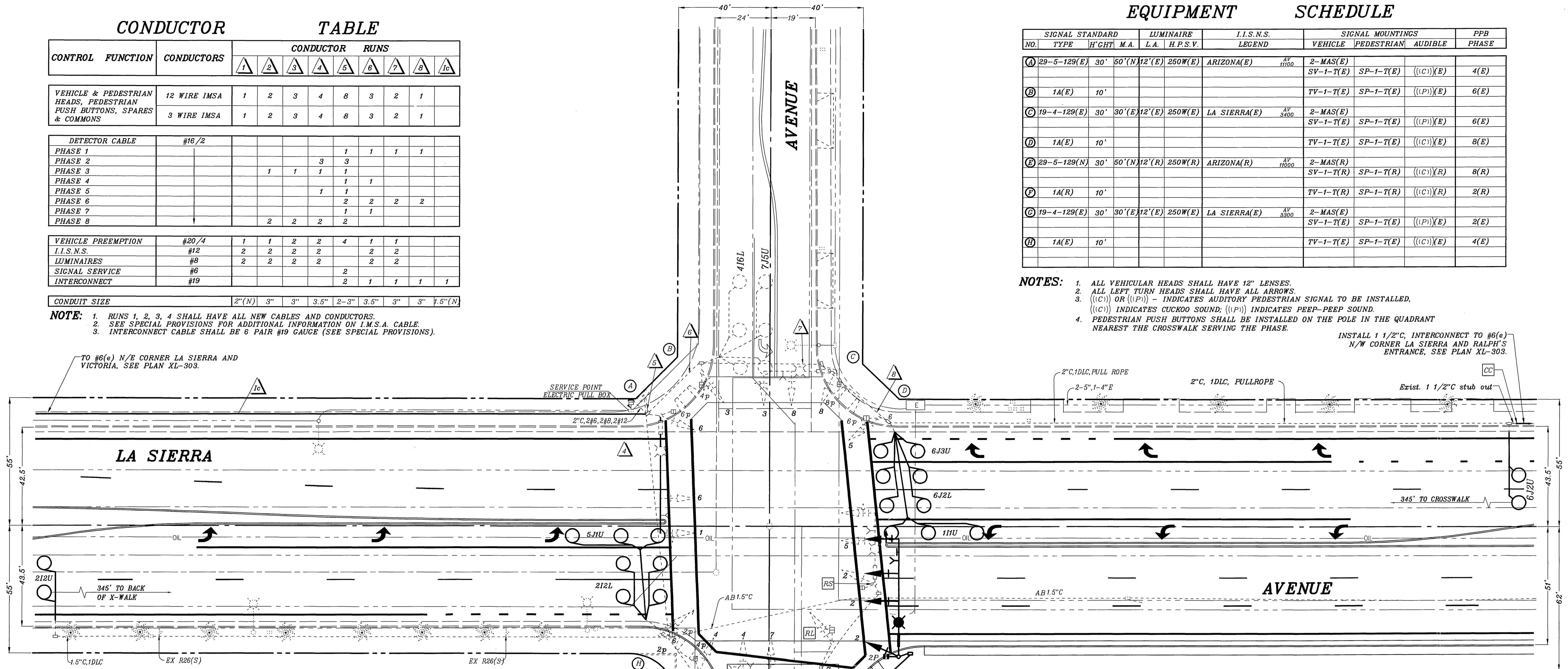

PHASE DIAGRAM

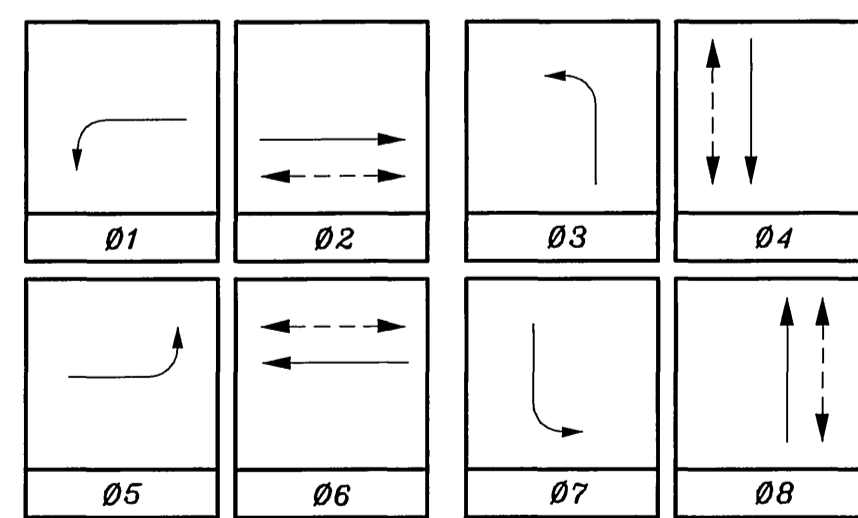

FLASHING OPERATION SHALL BE ALL RED.

PAVEMENT DELINEATION

— INDICATES PAVEMENT DELINEATION TO BE INSTALLED.
 = INDICATES PAVEMENT DELINEATION TO REMAIN.

GENERAL NOTES

- DETECTOR LOOPS SHALL BE INSTALLED IN THE PRESENCE OF THE TRAFFIC ENGINEER OR HIS REPRESENTATIVE.
- ALL PAVEMENT DELINEATION REQUIREMENTS SHALL BE COMPLETED AT LEAST ONE DAY PRIOR TO TURN ON.
- TYPICAL DETECTOR LOOP SPACING: 10' AND 15' (WHERE APPLICABLE).
- SEE PLAN R-3739 FOR STREET IMPROVEMENTS.
- SEE PLAN XL-303 FOR PAVEMENT DELINEATION.

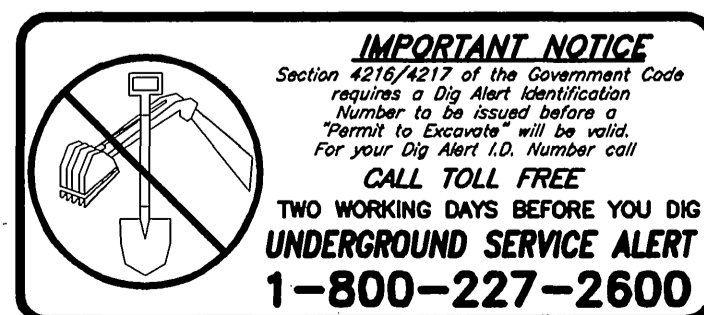

ENGINEER IN RESPONSIBLE CHARGE
 THOMAS JOHN BOYD
 R.C.E. No. 36170 expires 8/30/06
 DATE 9/2/05

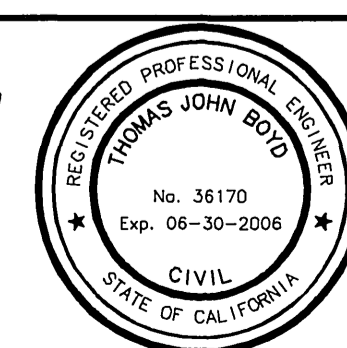

MARK	REVISIONS	APPR	DATE

CITY OF RIVERSIDE, CALIFORNIA
DEPARTMENT OF PUBLIC WORKS
 APPROVED BY: [Signature] DATE: 9/1/05
 TRAFFIC DIVISION: [Signature] DATE: 9/1/05

TRAFFIC SIGNAL MODIFICATION
LA SIERRA AVENUE AND ARIZONA AVENUE
 ACCT. NO. X-391A
 SHEET 1 OF 1
 SCALE: 1" = 20'
 FILE NAME: X391A.DWG

CONDUCTOR		TABLE							
CONTROL FUNCTION	CONDUCTORS	CONDUCTOR RUNS							
		1	2	3	4	8	3	2	1
VEHICLE & PEDESTRIAN HEADS, PEDESTRIAN PUSH BUTTONS, SPARES & COMMONS	12 CONDUCTOR IMSA	1	2	3	4	8	3	2	1
	3 CONDUCTOR IMSA	1	2	3	4	8	3	2	1
DETECTOR CABLE	#16/2					1	1	1	1
PHASE 1									
PHASE 2					3	3			
PHASE 3			1	1	1	1			
PHASE 4						1	1		
PHASE 5						1	1		
PHASE 6						2	2	2	2
PHASE 7						1	1		
PHASE 8						1	1		
TOTALS			2	2	2	6	11	5	3
EVPE CABLE	#20/4	1	1	2	2	4	1	1	
ISNS	#12	2	2	2	2		2	2	
LUMINAIRES	#8	2	2	2	2		2	2	
SIGNAL SERVICE	#6					2			
CONDUIT SIZE		2"	3"	3"	3.5"	2-3.5"	3.5"	3"	3"

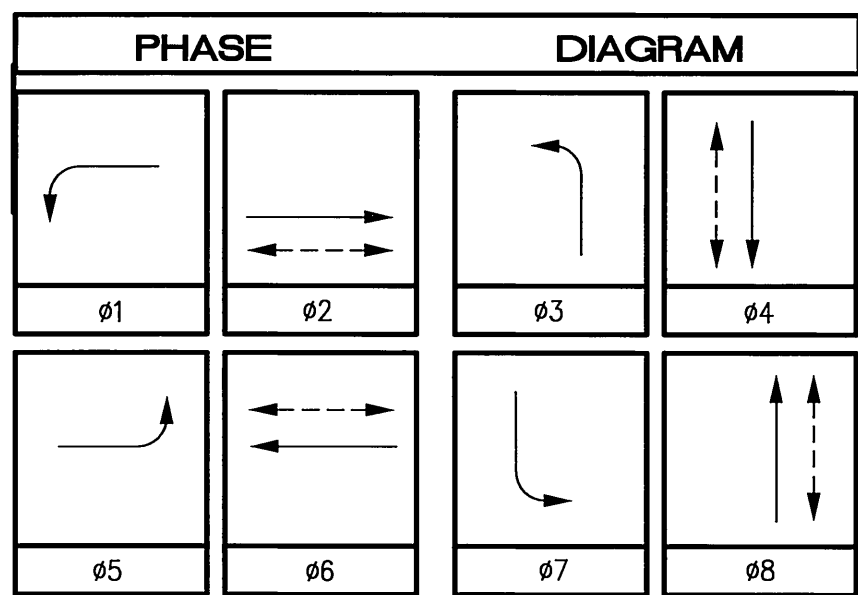

No.	STANDARD TYPE	HGT.	SIG.	M.A.	LUM. M.A.	LUMINAIRE HPS	ISNS LEGEND	SIGNAL MOUNTING			PPB PHASE	REMARKS	
								VEHICLE	PED	AUDIBLE			
1	29-5-129	30'	40'	*	12'	250W	Arizona Ave 11000	MAS	MAS	SV-1-T	SP-1-T	((C))	Ø4
2	1-A	10'								TV-1-T	SP-1-T	((P))	Ø6
3	19-4-129	30'	30'		12'	250W	La Sierra Ave 3400	MAS	MAS	SV-1-T	SP-1-T	((P))	Ø6
4	1-A	10'								TV-1-T	SP-1-T	((C))	Ø8
5	19-4-129	30'	30'		12'	250W	Arizona Ave 11000	MAS	MAS	SV-1-T	SP-1-T	((C))	Ø8
6	1-A	10'								TV-1-T	SP-1-T	((P))	Ø2
7	19-4-129	30'	30'		12'	250W	La Sierra Ave 3300	MAS	MAS	SV-1-T	SP-1-T	((P))	Ø2
8	1-A	10'								TV-1-T	SP-1-T	((C))	Ø4

((C)) OR ((P)) - INDICATES AUDITORY PEDESTRIAN SIGNAL TO BE INSTALLED; ((C)) INDICATES CUCKOO SOUND; ((P)) INDICATES PEEP-PEEP SOUND.
 * FUTURE 50' MAST ARM.

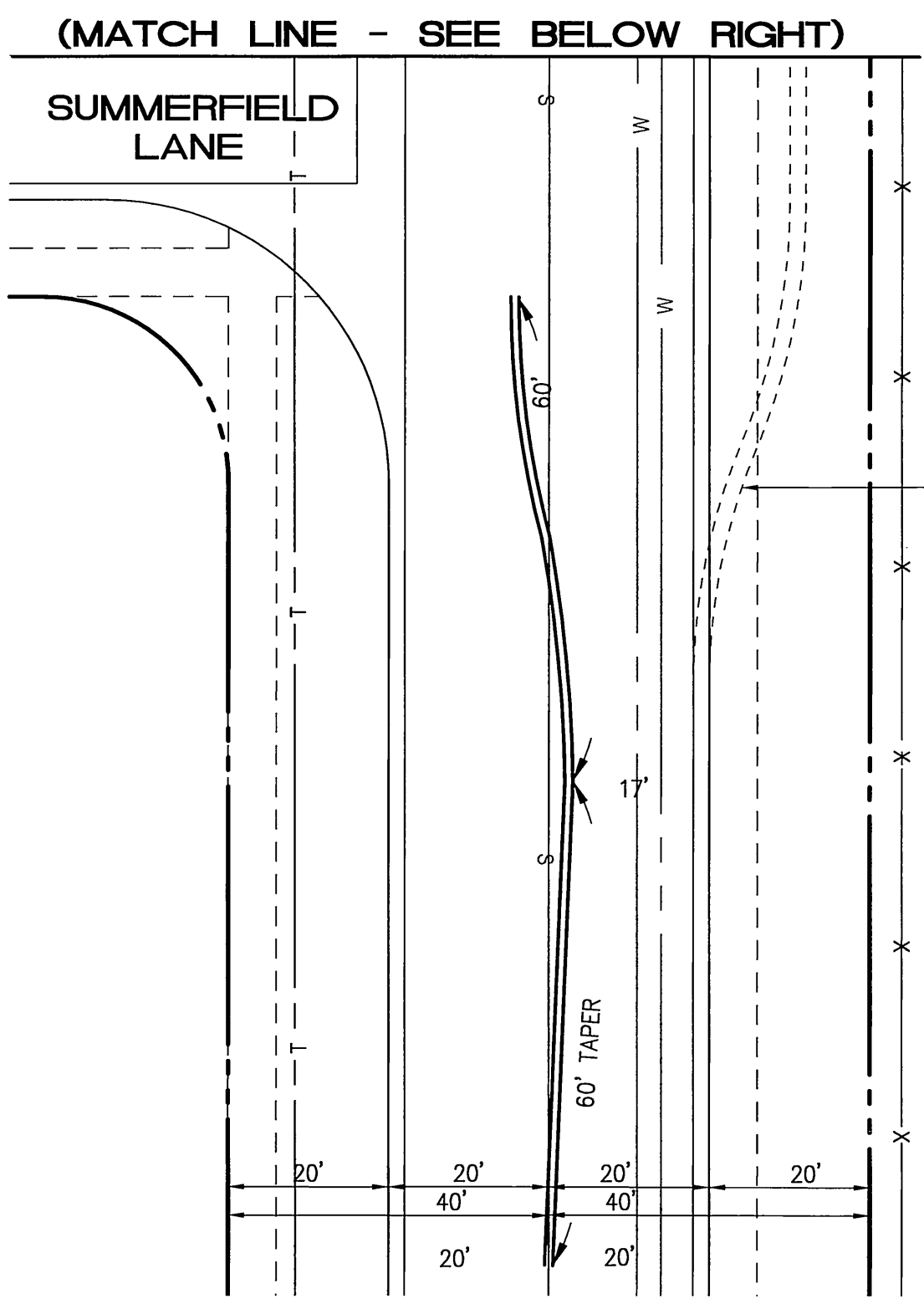
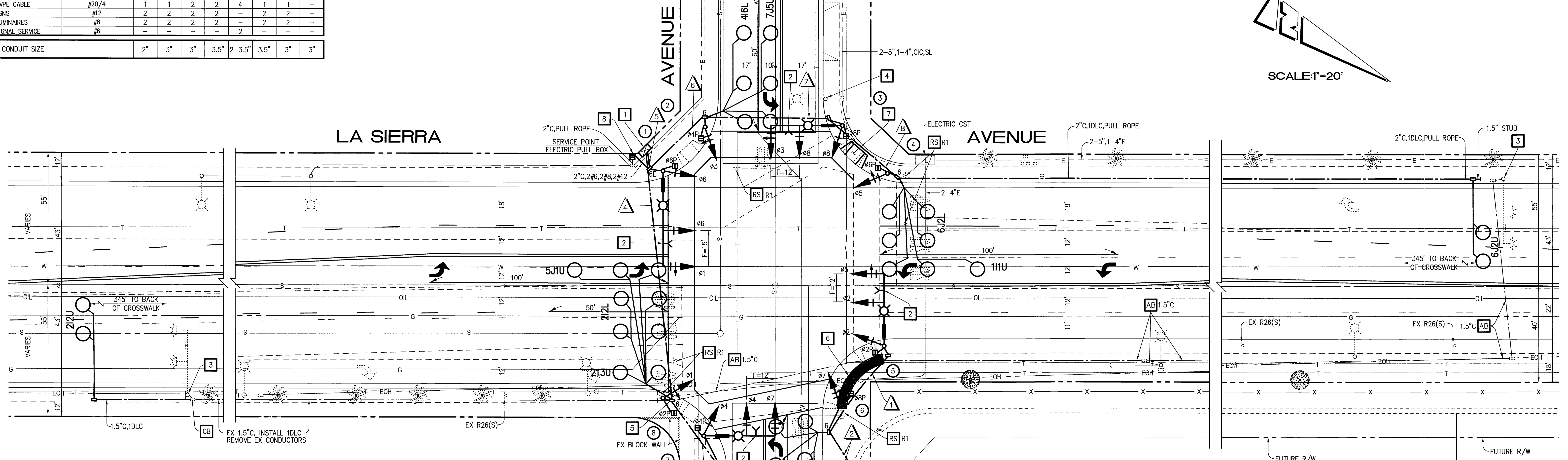
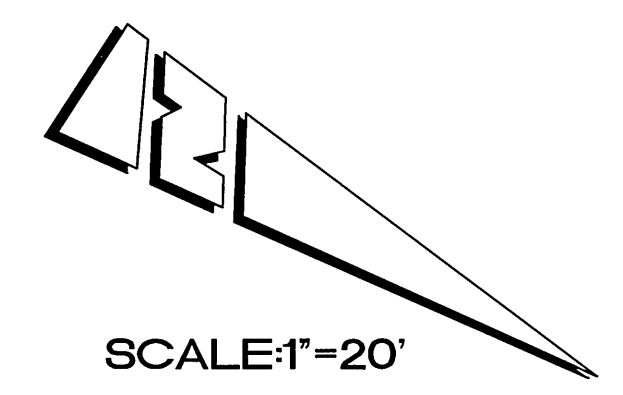

GENERAL NOTES:

- 1 DETECTOR LOOPS SHALL BE INSTALLED IN THE PRESENCE OF THE TRAFFIC ENGINEER OR HIS REPRESENTATIVE.
- 2 ALL SIGNING, STRIPING, AND PAVEMENT MARKINGS REQUIREMENTS SHALL BE COMPLETED AT LEAST ONE DAY PRIOR TO TURN-ON.
- 3 TYPICAL DETECTOR LOOP SPACING: 10', 15', 30' (WHERE APPLICABLE).
- 4 CONTRACTOR SHALL PERFORM ALL PERMANENT PAINTING (INSTALLATION AND REMOVALS) WORK. SEE STRIPING PLAN.
- 5 ALL VEHICLE HEADS SHALL HAVE 12" LENSES WITH RED, YELLOW, AND GREEN 'LED' TYPE INDICATIONS.
- 6 PEDESTRIAN SIGNAL HEADS SHALL HAVE 'LED' TYPE INDICATIONS.
- 7 PEDESTRIAN PUSH BUTTONS SHALL BE ADA APPROVED TYPE.
- 8 OPTICOM PHASE SELECTORS SHALL BE 2 CHANNEL UNITS ONLY.
- 9 AUDIBLE PEDESTRIAN SIGNAL SHALL BE INTERNAL MOUNT ONLY.

CONSTRUCTION NOTES (THIS SHEET):

- 1 - INSTALL MODEL 170 CONTROLLER ASSEMBLY WITH MODEL 332 CABINET. INSTALL 3M OPTICOM PHASE SELECTOR MODULE.
- 2 - INSTALL 3M OPTICOM DETECTOR MODEL 711 ON MAST ARM BY CLAMPING METHOD. EXACT LOCATION OF DETECTOR SHALL BE DETERMINED BY THE MANUFACTURER'S REPRESENTATIVE IN THE FIELD.
- 3 - REMOVE AND SALVAGE EXISTING FLASHING BEACON. REMOVE FOUNDATION.
- 4 - REMOVE AND SALVAGE EXISTING ELECTROLIER. REMOVE FOUNDATION.
- 5 - REMOVE EXISTING PULL BOX AND REPLACE WITH NEW PULL BOX.
- 6 - CONSTRUCT 4' WIDE P.C.C. SIDEWALK PER CITY STD. (±120 S.F.).
- 7 - REMOVE EXISTING CURB RAMP AND CONSTRUCT NEW P.C.C. CURB RAMP PER CITY STD. DWG. NO. 304.
- 8 - INSTALL 120V SIGNAL, 120V ISNS AND 240V STREET LIGHT SERVICE PER CITY STD. DWG. NO. 667.



TRAFFIC No. 1579
 DATE: 6-8-04
 AGA Job No. : 134-006
 AGA File Name: LASIERARIZG
 Print Date : 6/8/04
 Last Revision : 6/2/04

CONTRACT TE-04-03



CITY OF RIVERSIDE, CALIFORNIA DEPARTMENT OF PUBLIC WORKS		TRAFFIC SIGNAL PLAN LA SIERRA AVENUE AT ARIZONA AVENUE		ACCOUNT NO. X-391
APPROVED BY <i>[Signature]</i> PRINCIPAL ENGINEER DATE: 6/10/04	APPROVED BY <i>[Signature]</i> CITY ENGINEER DATE: 6/10/04	HORIZ. SCALE: 1" = 20' VERT. SCALE: 1" = -		SHEET 4 OF 9