

CONDUCTOR		TABLE			
CONTROL FUNCTION	CONDUCTORS	CONDUCTOR RUNS			
		1	2	3	4
VEHICLE & PEDESTRIAN HEADS, PEDESTRIAN PUSH BUTTONS, SPARES & COMMONS	12 CONDUCTOR IMSA	-	-	-	-
	9 CONDUCTOR IMSA	1	1	2	1
	5 CONDUCTOR IMSA	-	1	2	-
	3 CONDUCTOR IMSA	-	1	2	-
DETECTOR CABLE PHASE 2	#16/2	-	-	2	1
EVPE CABLE	#20/4	-	-	1	1
LUMINAIRES	#8	2	2	-	2
SIGNAL SERVICE	#6	-	-	2	-
CONDUIT SIZE		2"	3"	2-3"	2"

PP# 17092J

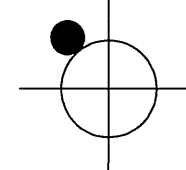

RISER DETAIL

INSTALL 120V SIGNAL, 120V SIGN AND 240V STREET LIGHT SERVICE PER STANDARD DWG. NO. 612. REMOVE EXISTING 120V FLASHING BEACON SERVICE.

PHASE		DIAGRAM	
NOT USED	← →	NOT USED	↑ ↓
ø1	ø2	ø3	ø4
NOT USED	NOT USED	NOT USED	NOT USED
ø5	ø6	ø7	ø8

POLE							SCHEDULE					
No.	TYPE	STANDARD			LUMINAIRE HPS	HISNS LEGEND	SIGNAL MOUNTING			PPB PHASE	REMARKS	
		HGT.	SIG. M.A.	LUM. M.A.			VEHICLE	PED	AUDIBLE			
1	17-2-80	30'	20'	12'	250W	-	-	MAS	SV-1-T	-	-	-
2	1-A	7'	-	-	-	-	-	-	-	TP-1-T	((C))	ø4
3	17-2-80	30'	20'	12'	250W	-	-	MAS	SV-1-T	-	-	-
4	1-A	7'	-	-	-	-	-	-	-	TP-1-T	((C))	ø4

NOTE: ALL POLES AND MAST ARMS WILL BE CITY-FURNISHED. THE CONTRACTOR SHALL PROVIDE ALL ANCHOR BOLTS, HARDWARE AND OTHER APPURTENANCES REQUIRED FOR THE INSTALLATION OF CITY-FURNISHED POLES.
((C)) OR ((P)) - INDICATES AUDITORY PEDESTRIAN SIGNAL TO BE INSTALLED; ((C)) INDICATES CUCKOO SOUND; ((P)) INDICATES PEEP-PEEP SOUND.

SCALE: 1"=20'

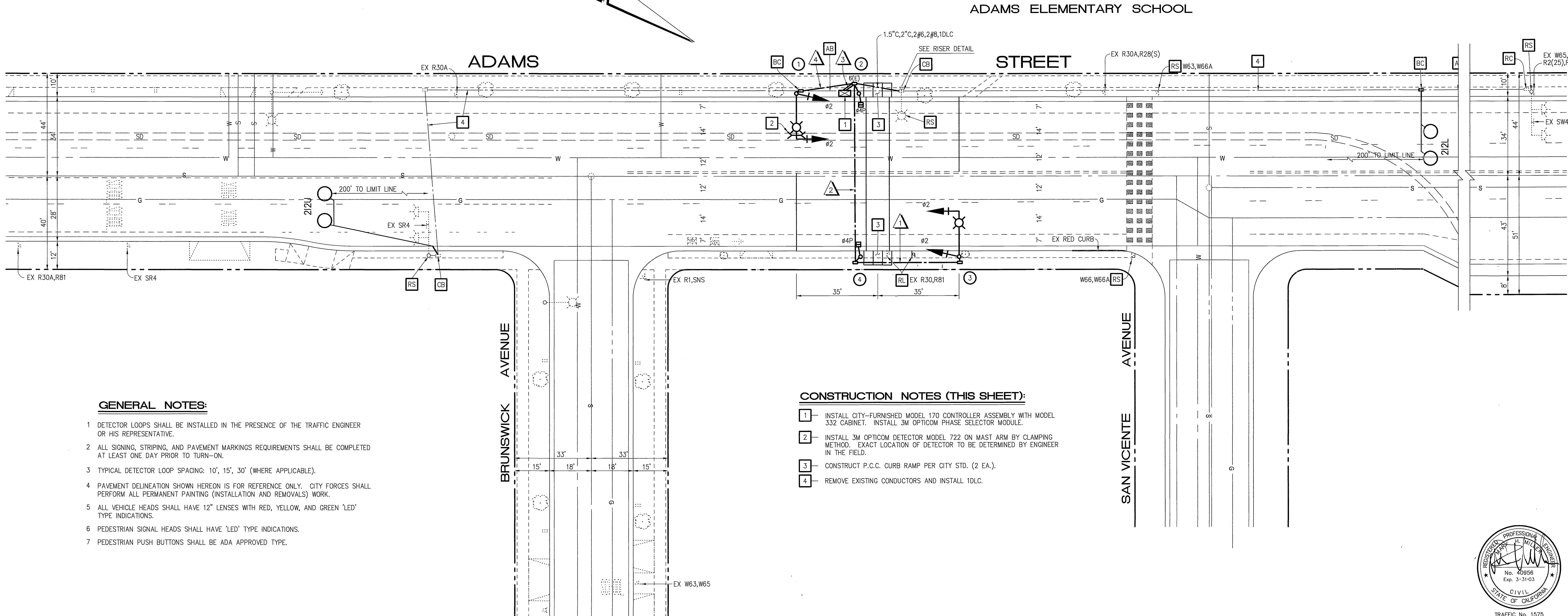
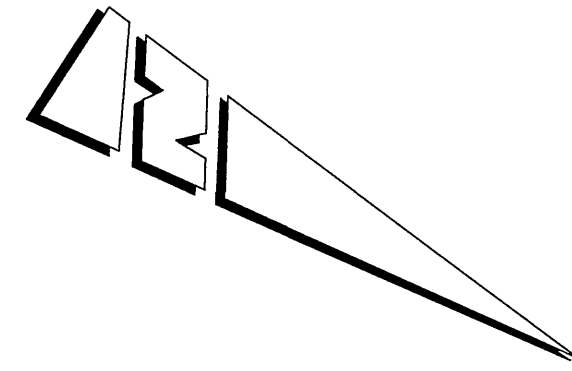

GENERAL NOTES:

- DETECTOR LOOPS SHALL BE INSTALLED IN THE PRESENCE OF THE TRAFFIC ENGINEER OR HIS REPRESENTATIVE.
- ALL SIGNING, STRIPING, AND PAVEMENT MARKINGS REQUIREMENTS SHALL BE COMPLETED AT LEAST ONE DAY PRIOR TO TURN-ON.
- TYPICAL DETECTOR LOOP SPACING: 10', 15', 30' (WHERE APPLICABLE).
- PAVEMENT DELINEATION SHOWN HEREON IS FOR REFERENCE ONLY. CITY FORCES SHALL PERFORM ALL PERMANENT PAINTING (INSTALLATION AND REMOVALS) WORK.
- ALL VEHICLE HEADS SHALL HAVE 12" LENSES WITH RED, YELLOW, AND GREEN 'LED' TYPE INDICATIONS.
- PEDESTRIAN SIGNAL HEADS SHALL HAVE 'LED' TYPE INDICATIONS.
- PEDESTRIAN PUSH BUTTONS SHALL BE ADA APPROVED TYPE.

CONSTRUCTION NOTES (THIS SHEET):

- INSTALL CITY-FURNISHED MODEL 170 CONTROLLER ASSEMBLY WITH MODEL 332 CABINET. INSTALL 3M OPTICOM PHASE SELECTOR MODULE.
- INSTALL 3M OPTICOM DETECTOR MODEL 722 ON MAST ARM BY CLAMPING METHOD. EXACT LOCATION OF DETECTOR TO BE DETERMINED BY ENGINEER IN THE FIELD.
- CONSTRUCT P.C.C. CURB RAMP PER CITY STD. (2 EA.).
- REMOVE EXISTING CONDUCTORS AND INSTALL 1DL.C.



TRAFFIC No. 1575
DATE: 6-13-01

AGA Job No. : 134-003
AGA File Name: ADABRUSG
Print Date : 6/13/01
Last Revision : 6/13/01

ALBERT GROVER & ASSOCIATES
TRANSPORTATION CONSULTING ENGINEERS
211 E. Imperial Hwy., Suite 208 Fullerton, CA 92835

Underground Service Alert
Call: TOLL FREE
1-800
227-2600
TWO WORKING DAYS BEFORE YOU DIG

CITY OF RIVERSIDE, CALIFORNIA DEPARTMENT OF PUBLIC WORKS				TRAFFIC SIGNAL PLAN		ACCOUNT NO.
APPROVED BY	DATE	BY	DATE	APPROVED BY		X-392
PRINCIPAL ENGINEER	6/14/01	R. Mc Brat	6/14/01	PUBLIC WORKS DIRECTOR		
MARK	REVISIONS	APPR. DATE	DATE	DATE		SHEET -- OF --
DESIGNED BY	DRAWN BY	CHECKED BY	DATE	DATE		

**ADAMS STREET N/O
BRUNSWICK AVENUE**

HORIZ. SCALE: 1"= 20' VERT. SCALE: 1"= -