

SIGN DETAIL

G21-2

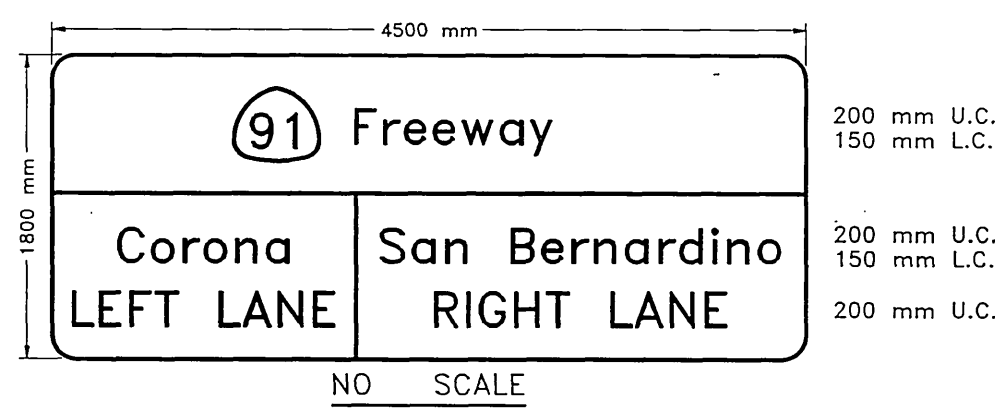

NOTES:

- LEGEND SHALL CONFORM TO CALTRANS STANDARD SIGN SPECIFICATIONS SHEETS.
- INSTALLATION SHALL CONFORM TO CALTRANS STANDARD PLANS.

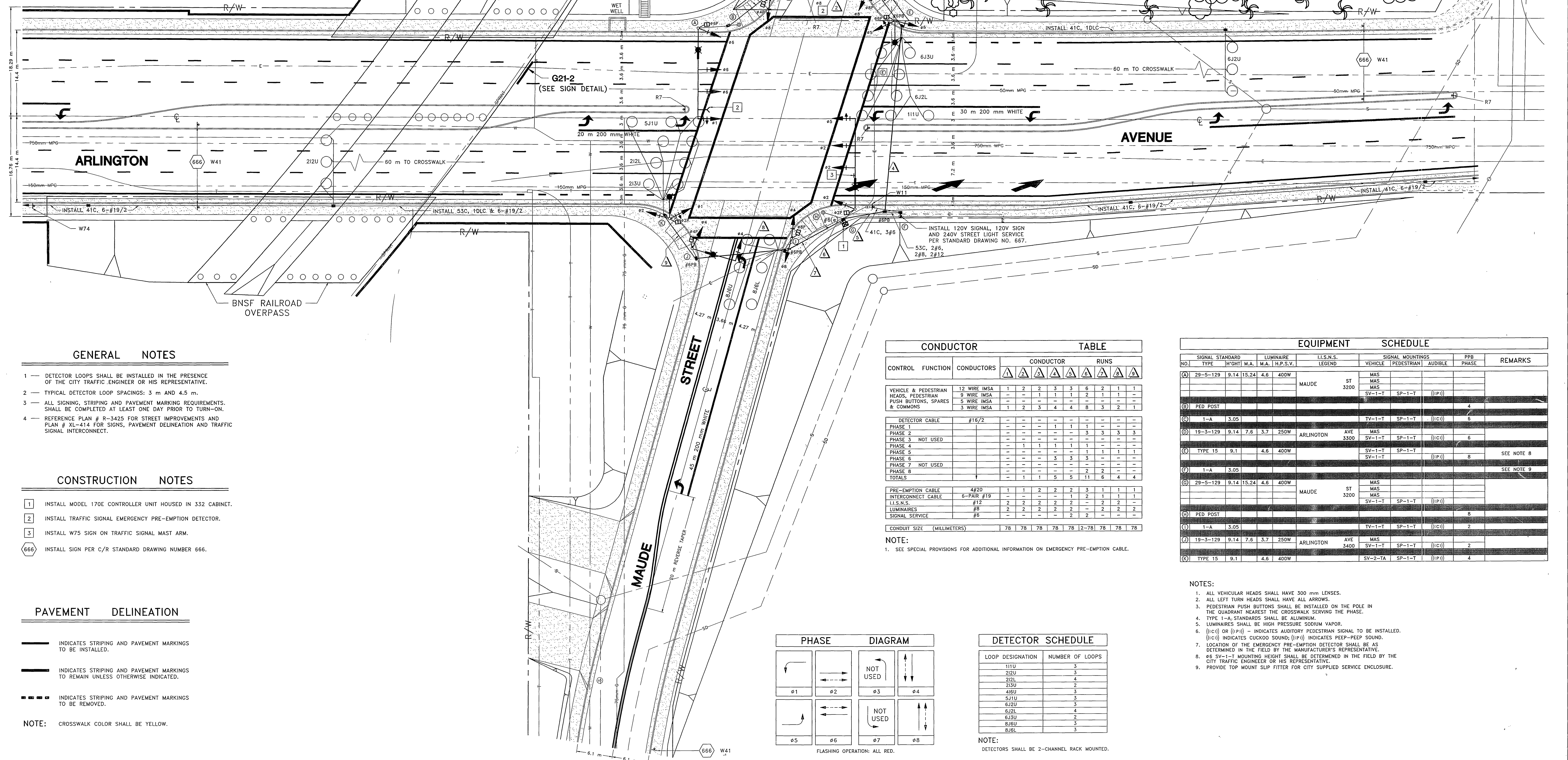

GENERAL NOTES

- DETECTOR LOOPS SHALL BE INSTALLED IN THE PRESENCE OF THE CITY TRAFFIC ENGINEER OR HIS REPRESENTATIVE.
- TYPICAL DETECTOR LOOP SPACINGS: 3 m AND 4.5 m.
- ALL SIGNING, STRIPING AND PAVEMENT MARKING REQUIREMENTS SHALL BE COMPLETED AT LEAST ONE DAY PRIOR TO TURN-ON.
- REFERENCE PLAN # R-3425 FOR STREET IMPROVEMENTS AND PLAN # XL-414 FOR SIGNS, PAVEMENT DELINEATION AND TRAFFIC SIGNAL INTERCONNECT.

CONSTRUCTION NOTES

- INSTALL MODEL 170E CONTROLLER UNIT HOUSED IN 332 CABINET.
- INSTALL TRAFFIC SIGNAL EMERGENCY PRE-EMPTION DETECTOR.
- INSTALL W75 SIGN ON TRAFFIC SIGNAL MAST ARM.
- INSTALL SIGN PER C/R STANDARD DRAWING NUMBER 666.

PAVEMENT DELINEATION

- INDICATES STRIPING AND PAVEMENT MARKINGS TO BE INSTALLED.
- INDICATES STRIPING AND PAVEMENT MARKINGS TO REMAIN UNLESS OTHERWISE INDICATED.
- INDICATES STRIPING AND PAVEMENT MARKINGS TO BE REMOVED.

NOTE: CROSSWALK COLOR SHALL BE YELLOW.

CONDUCTOR TABLE

CONTROL FUNCTION	CONDUCTORS	CONDUCTOR RUNS								
		1	2	3	4	5	6	7	8	
VEHICLE & PEDESTRIAN HEADS, PEDESTRIAN PUSH BUTTONS, SPARES & COMMONS	12 WIRE IMSA 9 WIRE IMSA 5 WIRE IMSA 3 WIRE IMSA	1	2	2	3	3	6	2	1	1
DETECTOR CABLE	#16/2	-	-	-	-	-	-	-	-	-
PHASE 1		-	-	1	1	1	-	-	-	-
PHASE 2		-	-	-	-	3	3	3	3	-
PHASE 3 NOT USED		-	-	-	-	-	-	-	-	-
PHASE 4		1	1	1	1	1	-	-	-	-
PHASE 5		-	-	-	-	1	1	1	1	1
PHASE 6		-	-	-	-	3	3	3	-	-
PHASE 7 NOT USED		-	-	-	-	-	-	-	-	-
PHASE 8		-	-	-	-	-	2	2	-	-
TOTALS		-	1	1	5	5	11	6	4	4
PRE-EMPTION CABLE	4#20	1	1	2	2	2	3	1	1	1
INTERCONNECT CABLE	6-PAIR #19	-	-	-	1	2	1	1	1	1
I.I.S.N.S.	#12	2	2	2	2	2	-	2	2	-
LUMINAIRES	#8	2	2	2	2	2	-	2	2	2
SIGNAL SERVICE	#6	-	-	-	-	2	2	-	-	-
CONDUIT SIZE (MILLIMETERS)		78	78	78	78	78	2-78	78	78	78

NOTE:
1. SEE SPECIAL PROVISIONS FOR ADDITIONAL INFORMATION ON EMERGENCY PRE-EMPTION CABLE.

EQUIPMENT SCHEDULE

NO.	SIGNAL STANDARD	LUMINAIRE	H'GHT	M.A.	I.I.S.N.S.	SIGNAL MOUNTINGS			PPB	PHASE	REMARKS		
						VEHICLE	PEDESTRIAN	AUDIBLE					
(A)	29-5-129	9.14	15.24	4.6	400W	MAUDE	ST 3200	MAS	MAS	SV-1-T	SP-1-T	((IP))	
(B)	PED POST											4	
(C)	1-A	3.05						TV-1-T	SP-1-T			((IC))	6
(D)	19-3-129	9.14	7.6	3.7	250W	ARLINGTON	AVE 3300	MAS	MAS	SV-1-T	SP-1-T	((IC))	6
(E)	TYPE 15	9.1		4.6	400W			SV-1-T	SP-1-T			((IP))	8
(F)	1-A	3.05											SEE NOTE 9
(G)	29-5-129	9.14	15.24	4.6	400W	MAUDE	ST 3200	MAS	MAS	SV-1-T	SP-1-T	((IP))	
(H)	PED POST												8
(I)	1-A	3.05						TV-1-T	SP-1-T			((IC))	2
(J)	19-3-129	9.14	7.6	3.7	250W	ARLINGTON	AVE 3400	MAS	MAS	SV-1-T	SP-1-T	((IC))	2
(K)	TYPE 15	9.1		4.6	400W			SV-2-TA	SP-1-T			((IP))	4

- NOTES:
- ALL VEHICULAR HEADS SHALL HAVE 300 mm LENSES.
 - ALL LEFT TURN HEADS SHALL HAVE ALL ARROWS.
 - PEDESTRIAN PUSH BUTTONS SHALL BE INSTALLED ON THE POLE IN THE QUADRANT NEAREST THE CROSSWALK SERVING THE PHASE.
 - TYPE 1-A STANDARDS SHALL BE ALUMINUM.
 - LUMINAIRES SHALL BE HIGH PRESSURE SODIUM VAPOR.
 - ((IC)) OR ((IP)) - INDICATES AUDITORY PEDESTRIAN SIGNAL TO BE INSTALLED. ((IC)) INDICATES CUCKOO SOUND; ((IP)) INDICATES PREP-PEEP SOUND.
 - LOCATION OF THE EMERGENCY PRE-EMPTION DETECTOR SHALL BE AS DETERMINED IN THE FIELD BY THE MANUFACTURER'S REPRESENTATIVE.
 - #6 SV-1-T MOUNTING HEIGHT SHALL BE DETERMINED IN THE FIELD BY THE CITY TRAFFIC ENGINEER OR HIS REPRESENTATIVE.
 - PROVIDE TOP MOUNT SLIP FITTER FOR CITY SUPPLIED SERVICE ENCLOSURE.

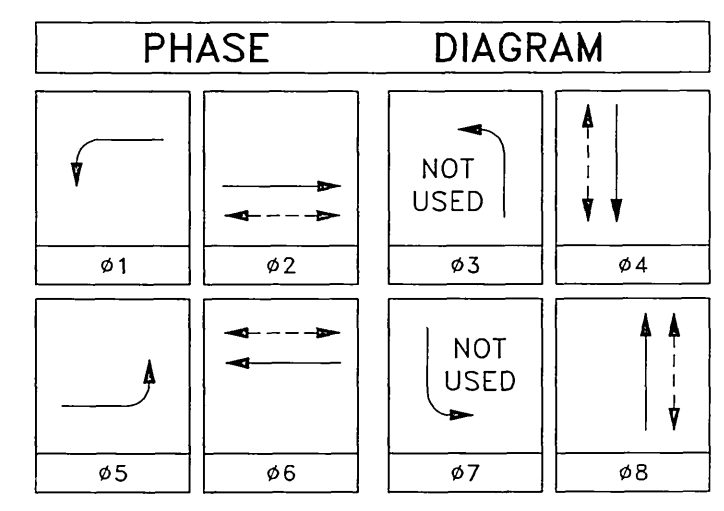

DETECTOR SCHEDULE

LOOP DESIGNATION	NUMBER OF LOOPS
111U	3
212U	3
212L	4
213U	2
416U	3
511U	3
612U	3
612L	4
613U	2
816U	3
816L	3

NOTE: DETECTORS SHALL BE 2-CHANNEL RACK MOUNTED.

ENGINEER IN RESPONSIBLE CHARGE
 RICHARD D. McGRATH
 R.C.E. NO. 31952 EXPIRES 12-31-2000
 DATE 5-7-98

MARK REVISIONS APPR. DATE

NO.	DESCRIPTION	DATE
1	ISSUED FOR CONSTRUCTION	5-7-98

CITY OF RIVERSIDE, CALIFORNIA
 DEPARTMENT OF PUBLIC WORKS
 APPROVED BY: [Signature] DATE: 5-7-98
 P.W. INSPECTOR: [Signature]
 TRAFFIC DIVISION: [Signature]
 CHIEF P.W. ENGR.: [Signature]
 PUBLIC UTILITIES: [Signature]

TRAFFIC SIGNAL INSTALLATION
 ARLINGTON AVENUE AND MAUDE STREET
 SCALE 1:300

ACCT. NO. 0430-541500-440227-30268
 X-408
 SHEET 1 OF 1
 FILE NAME: X408.DWG