

CONDUCTOR SCHEDULE										
AWG SIZE OR CABLE TYPE	POLE OR CIRCUIT									
		1	2	3	4	5	6	7	8	9
12 COND.	POLE - A	-	-	-	-	-	-	-	-	-
	B	-	-	-	-	-	-	-	-	-
	C	-	-	-	-	-	-	-	-	-
	D	1	1	1	1	1	1	1	1	1
	E	-	-	-	-	-	-	-	-	-
3 COND.	F	-	-	-	-	-	-	-	-	-
	G	-	-	-	-	-	-	-	-	-
	H	-	-	-	-	-	-	-	-	-
	I	-	-	-	-	-	-	-	-	-
TOTAL	1	1	2	3	4	1	2	3	7	8
12	IISNS	2	2	2	2	-	2	2	2	-
	TOTAL	2	2	2	2	-	2	2	2	-
8	LUMINAIRES	2	2	2	2	-	2	2	2	-
	TOTAL	2	2	2	2	-	2	2	2	-
6	SIGNAL SERVICE	-	-	-	-	-	-	-	-	2
	Ø1	-	2	2	2	-	-	-	-	2
TYPE "B" DLC	Ø2	-	-	-	-	-	4	4	4	-
	Ø3	-	-	-	-	-	2	2	2	-
	Ø4	-	-	-	5	-	-	-	-	5
	Ø5	-	-	-	-	-	-	2	2	2
	Ø6	-	-	-	-	-	-	-	-	4
	Ø7	-	-	-	2	-	-	-	-	2
	Ø8	-	-	-	-	-	4	4	4	4
	TOTAL	-	6	6	13	6	6	12	25	25
OPTICOM CABLE		-	-	-	-	-	-	-	-	-
CONDUIT SIZE (INCHES)		2"	2.5"	3"	3.5"	2.5"	3.5"	3"	2 1/4"	2 1/4"

ALL CONDUIT EXISTING UNLESS SHOWN (N) = NEW.
ALL CONDUCTORS CABLES SHALL BE NEW.

TRAFFIC SIGNAL GENERAL NOTES:

- ALL ITEMS FURNISHED AND ALL WORK TO BE DONE SHALL CONFORM TO THE REQUIREMENTS OF THE STATE OF CALIFORNIA, DEPARTMENT OF TRANSPORTATION (CALTRANS) STANDARD PLANS AND SPECIFICATIONS, DATED 2010; THE CALIFORNIA MANUAL ON UNIFORM TRAFFIC CONTROL DEVICES ADOPTED 2010; AND THE SPECIAL PROVISIONS.
- UTILITIES SHOWN ON THE PLAN ARE CORRECT AND ACCURATE TO THE EXTENT OF AVAILABLE RECORDS. THE CONTRACTOR IS REQUIRED TO TAKE STEPS TO ASCERTAIN THE EXACT LOCATION OF ALL KNOWN SUBSTRUCTURES PRIOR TO DOING WORK THAT MAY DAMAGE OR INTERFERE WITH SUCH FACILITIES ("UNDERGROUND SERVICE ALERT" (800) 227-2600).
- THE CONTRACTOR SHALL OBTAIN ALL NECESSARY PERMITS TO NOTIFY ALL AFFECTED AGENCIES AND THE RIVERSIDE UTILITY COMPANIES A MINIMUM OF 48 HOURS PRIOR TO START OF CONSTRUCTION.
- UNLESS SHOWN OTHERWISE, INDUCTIVE LOOPS SHALL BE TYPE "D" & "E" WITH 10', 15' AND 30' SPACING IN THE DIRECTION OF TRAVEL NECESSARY STRIPING SHALL BE LOCATED PRIOR TO POSITIONING LOOPS. LOOPS SHALL BE SEALED WITH HOT MELT SEALANT. SEE DETAIL "B".
- TRAFFIC SIGNAL SCHEDULE IS FURNISHED AS AN INSTALLATION GUIDELINE ONLY. IT SHALL BE THE CONTRACTOR'S RESPONSIBILITY TO PROVIDE THE CORRECT CONDUCTORS REQUIREMENT FOR THE INTENDED OPERATION.
- CONDUIT BETWEEN ADJOINING PULL BOXES SHALL BE 2" UNLESS SHOWN OTHERWISE. ALL CONDUIT AND FITTING SHALL BE RIGID METAL, UNLESS SHOWN OTHERWISE (BURIED IN A MINIMUM OF 30" OF COVER IN THE STREET AND PARKWAY).
- TRAFFIC SIGNAL INTERCONNECT (SIC) SHALL BE 2" UNLESS SHOWN OTHERWISE, BURIED IN A MINIMUM OF 30" OF COVER IN THE STREET AND PARKWAY. NO 6 PULL BOXES WITH LIDS LABELED "COMMUNICATIONS" SHALL BE SPACED AT 400' AND THE MAXIMUM SIC BENDING RADIUS SHALL NOT EXCEED 45'. SIC CONDUIT SHALL ONLY INCLUDE SIGNAL INTERCONNECT CONDUCTORS.
- UNDERGROUND SIGNAL CONDUCTORS SHALL NOT BE SPICED.
- PULL BOXES SHALL NOT BE NO. 6 WITH FIBERLITE LIDS "TRAFFIC" UNLESS OTHERWISE NOTED ON THE PLANS.
- PULL BOXES SHALL NOT BE LOCATED IN OR WITHIN 1' OF ANY CURB ACCESS RAMP OR DRIVEWAY.
- THE CONTRACTOR SHALL VERIFY WITH THE ENGINEER THE PRECISE FIELD LOCATIONS OF ALL TRAFFIC SIGNAL EQUIPMENT PRIOR TO THE INSTALLATION.
- ALL LANDSCAPING WHICH IS DAMAGED BY CONSTRUCTION ACTIVITIES SHALL BE REPAIRED OR REPLACED TO THE SATISFACTION OF THE CITY AND THE PROPERTY OWNER.
- NEW MAST ARM MOUNTED SIGNS SHALL BE FABRICATED WITH 3M DG3 (ASTM TYPE XI) REFLECTIVE SHEETING OR APPROVED EQUAL MINIMUM SIGN SIZE SHALL BE 30"x30".
- VEHICLE HEADS SHALL BE 12" LED TYPE. THE HOUSING, BACKPLATES AND VISORS SHALL BE METAL.
- INTERNALLY ILLUMINATED STREET NAME SIGNS (IISNS) SHALL BE TYPE A. STREET NAME LEGENDS SHALL BE UPPER/ LOWER CASE AND SHALL INCLUDE BLOCK NUMBERS AND ROAD NAME SUFFIXES.
- SALVAGED TRAFFIC SIGNAL EQUIPMENT SHALL BE DELIVERED TO THE CITY OF RIVERSIDE TRAFFIC SIGNAL MAINTENANCE YARD.
- DAMAGED SIDEWALK CONCRETE SHALL BE REPLACED PER CITY OF RIVERSIDE STANDARDS.
- THE CONTRACTOR SHALL REMOVE ALL UNUSED PULL BOXES AND RE-PAVE SURROUNDING AREA TO MATCH EXISTING OR PROPOSED GRADE. ALL UNUSED CONDUIT SHALL BE ABANDONED AND CAPPED ONCE UNUSED CONDUCTORS ARE REMOVED.
- ALL CONTRACTORS WORK ON OR AROUND THE CITY OF RIVERSIDE UNDERGROUND ELECTRICAL FACILITIES MUST HAVE THE PROPERLY QUALIFIED PERSONNEL AND EQUIPMENT TO PERFORM THE SPECIFIED WORK. THE CONTRACTOR WILL BE SOLELY RESPONSIBLE TO ESTABLISH AND MAINTAIN A SAFE WORKING ENVIRONMENT INCLUDING, BUT NOT LIMITED TO WORK AROUND ENERGIZED HIGH VOLTAGE FACILITIES, GAS TESTING OF CONFINED SPACES, TRAFFIC AND PROTECTION.
- ALL SIGNAL BACK PLATES SHALL BE REPAINTED OR REPLACED.
- ALL PEDESTRIAN INDICATIONS SHALL HAVE INTERNALLY MOUNTED AUDIBLES.

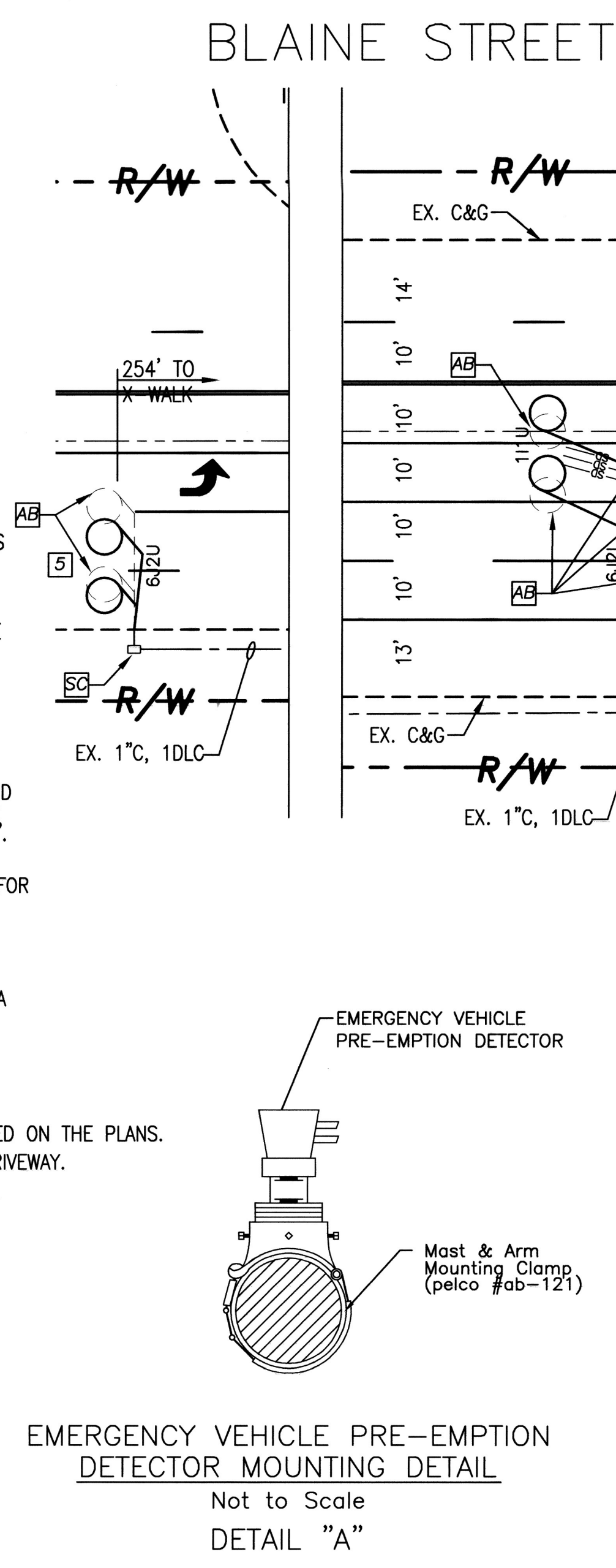
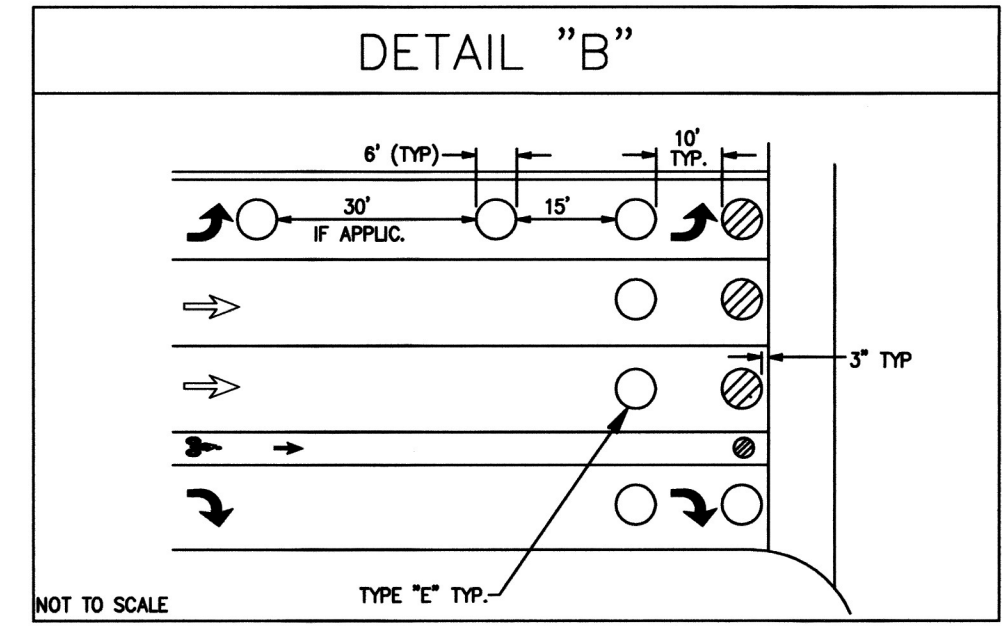

23. TRAFFIC SIGNAL SHUTDOWN(S) SHALL OCCUR ON WEEKEND ONLY

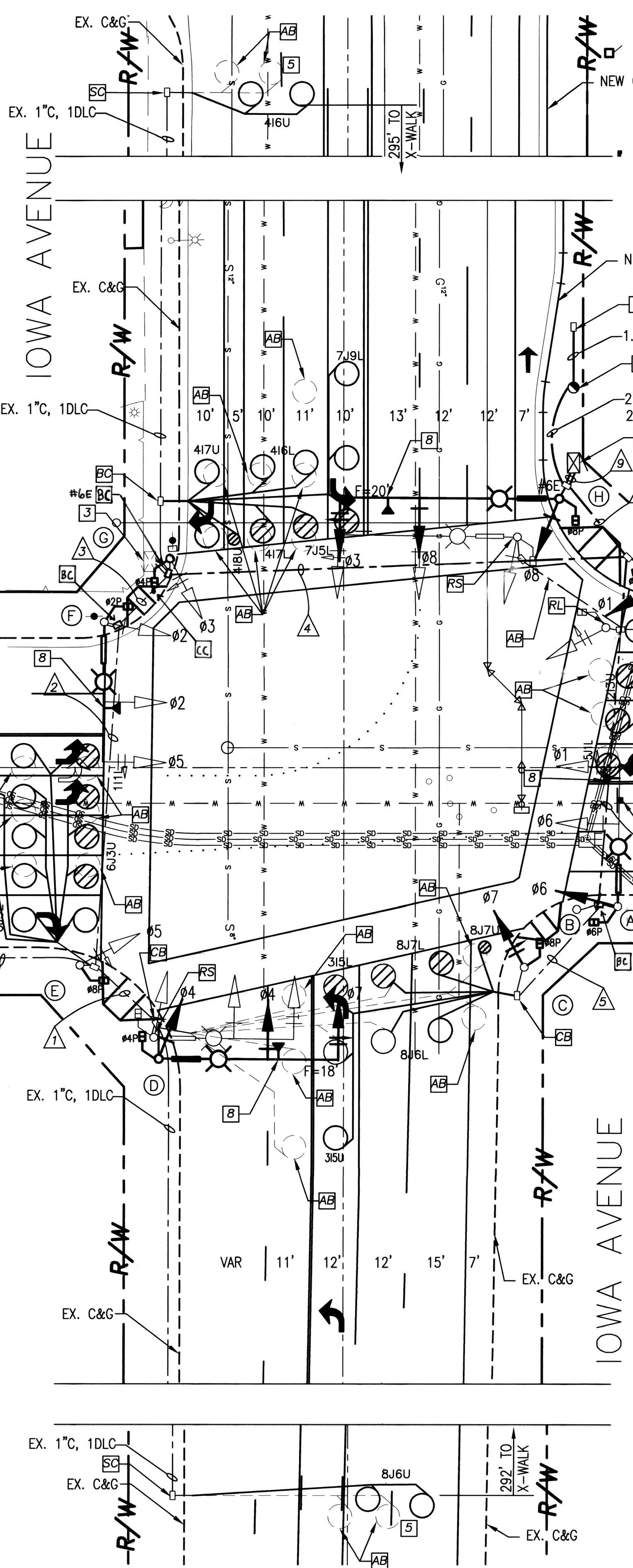

POLE SCHEDULE												
COL	STANDARD TYPE	HT.	SIG.	LUM.	LED	PED. PHASE	PUSH BT.	PED. QUD	PED. AUDIBLE	SIGNAL MOUNTING		I.I.S.N.S. MESSAGE
										VEHICLE	PED.	
(A)	24-4-70	30'	35'	15'(N)	250W(N)	-	-	P	2 MAS, SV-1-T(N)	SP-1-T(N)	low	3300 (N)
(B)	PPB	4'	-	-	-	8	W	-	-	-	-	-
(C)	1A	10'	-	-	-	6	N	C	TV-1-T(N)	SP-1-T(N)	-	-
(D)	26-4-100(N)	30'(N)	45'(N)	15'(N)	250W(N)	6(N)	N	C	2 MAS(N), SV-1-T(N)	SP-1-T(N)	Blaine	3300 (N)
(E)	1A	10'	-	-	-	4	E	P	TV-1-T	SP-1-T(N)	-	-
(F)	24-4-70	30'	35'	15'(N)	250W(N)	4	E	P	2 MAS, SV-1-T	SP-1-T(N)	low	3300 (N)
(G)	1A	10'	-	-	-	2	S	C	TV-1-T	SP-1-T(N)	INTERNAL NEW FOUNDATION SEE NOTE #3	-
(H)	29-5-100(N)	30'(N)	55'(N)	15'(N)	250W(N)	2(N)	S	C	2 MAS(N), SV-1-T(N)	SP-1-T(N)	Blaine	3300 (N)
(I)	1A(RL)	10'	-	-	-	8	W	P	TV-1-T(N)	SP-1-T(N)	-	-

EXACT POLE LOCATIONS DETERMINED BY ENGINEER IN THE FIELD. POTHOLE POLE FOUNDATION LOCATIONS PRIOR TO ORDERING POLES.
 * ALL EQUIPMENT EXISTING UNLESS SHOWN (N)=NEW OR (RL)=RELOCATE
 ** ALL PEDESTRIAN INDICATIONS SHALL HAVE INTERNAL AUDIBLES.
 *** PEDESTRIAN AUDIBLE & C=CLUCKO (NORTH/SOUTH), P=PEEP (EAST/WEST)
 **** ALL EXISTING IISNS ASSEMBLY SHALL BE REPLACED WITH NEW LED RETROFIT KITS.
 THE IISNS ASSEMBLY SHALL BE SHAFT MOUNTED FOR POLES "D" AND "H"
 THE LUMINAIRE ARM FOR POLE "D" SHALL BE STRAIGHT

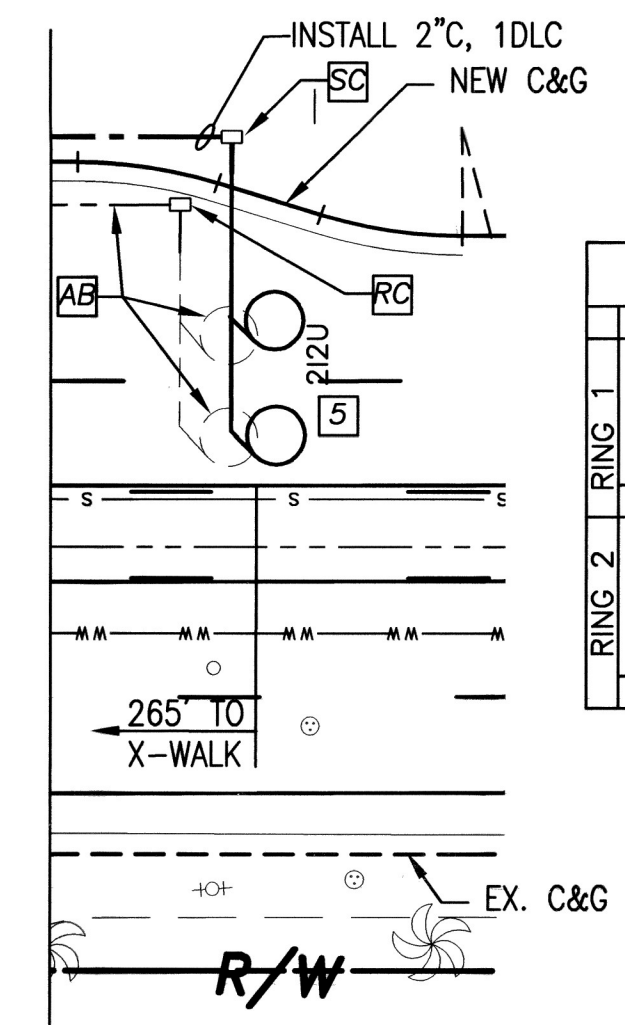

CONSTRUCTION NOTES:

- CONTRACTOR SHALL CONSTRUCT (TYPE 332 CABINET) FOUNDATION. CONTRACTOR SHALL FURNISH AND INSTALL MODEL 170ATC-CF CONTROLLER ASSEMBLY IN MODEL 332 ANODIZED ALUMINUM CABINET, COMPLETE WITH DETECTION SHOWN AND AUXILIARY EQUIPMENT WITHIN A TYPE 332 CABINET PER CITY OF RIVERSIDE SPECIFICATIONS.
 - CONTRACTOR SHALL PROVIDE AND INSTALL AN UNINTERRUPTED POWER SUPPLY (UPS) UNIT PER THE SPECIAL PROVISIONS. THE UPS UNIT AND BATTERIES SHALL BE INSTALLED IN A CABINET, EXTERNALLY MOUNTED TO THE CONTROLLER CABINET.
 - REMOVE AND SALVAGE EXISTING TYPE 90 CONTROLLER ASSEMBLY & FOUNDATION. RECONSTRUCT PEDESTRIAN RAMPS SINCE FOUNDATIONS WITHIN EXISTING RAMPS INSTALL NEW 1A FOUNDATION.
 - INSTALL 1A SERVICE POLE PER CITY STANDARD DRAWING NO.667
 - INSTALL NEW ADVANCED LOOPS.
 - THE SIGNAL SHALL HAVE NEW DETECTOR LOOPS AS SHOWN ON PLAN AND DETAIL "B".
 - CONTRACTOR SHALL COORDINATE WITH RIVERSIDE PUBLIC UTILITIES TO DETERMINE ELECTRICAL SERVICE POINT. AT LEAST TWO WEEKS PRIOR TO WORK.
 - INSTALL ONE(1) GTT MODEL No. 711 (OR CITY- APPROVED EQUAL) EMERGENCY VEHICLE PRE-EMPTION DETECTION ASSEMBLY (INCLUDING MOUNTING HARDWARE AND CABLE) FOR EACH DIRECTION. OR OPTICOM MODEL No. 722 (DUAL DIRECTION) AS SHOWN ON PLAN E.V.P.E. SHALL BE MOUNTED ON THE MAST ARM PER DETAIL "A".
- AB ABANDON
 RC REMOVE COMPLETE. REMOVE FOUNDATION COMPLETELY.
 RS REMOVE & SALVAGE
 CB NEW CONDUIT TO EXISTING PULL BOX.
 BC NEW PULL BOX TO EXISTING CONDUIT.
 SC SPLICE NEW TO EXISTING CONDUCTORS.

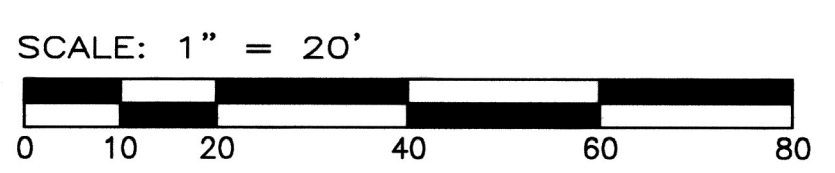

IMPORTANT NOTICE
 Section 4216/4217 of the Government Code requires a Dig Alert Identification Number to be placed before a "Permit to Excavate" will be valid. For your Dig Alert ID, Number call CALL TOLL FREE 48 HOURS BEFORE YOU DIG UNDERGROUND SERVICE ALERT 1-800-227-2600

REGISTERED PROFESSIONAL ENGINEER
 SORUSH KHADEM
 No. 72472
 6/30/12
 CIVIL
 STATE OF CALIFORNIA

TRAMES SOLUTIONS INC.
 100 E SAN MARCOS BLVD
 SUITE 400
 SAN MARCOS, CA 92069
 760-291-1400
 11/22/11 DATE R.C.E. # 72472

CITY OF RIVERSIDE, CALIFORNIA
 PUBLIC WORKS DEPARTMENT
 APPROVED BY: [Signature] DATE: 12/21/11
 CONST. CONTRACT ADMIN. [Signature] DATE: 12/21/11
 TRAFFIC DIVISION PUBLIC UTILITIES [Signature] DATE: 12/21/11
 CITY ENGINEER [Signature] DATE: 12/21/11

TRAFFIC SIGNAL MODIFICATION
IOWA AVENUE AT BLAINE STREET
 HORIZONTAL SCALE: 1" = 20'
 VERTICAL SCALE: 1" = 20'

ACCT. NO.
X-409C
 SHEET 1 OF 1

Indexed 12/21/11 - SE

CONDUCTOR SCHEDULE									
A.W.G. OR D.L.C.	CIRCUIT	CONDUIT RUNS							
		1	2	3	4	5	6	7	8
	#1 VEHICLE				3	3	3	3	
	#2 VEHICLE				3	3			
	#3 VEHICLE					6	3	3	
	#4 VEHICLE		3	3	3	3			
	#5 VEHICLE		3	3	3				
	#6 VEHICLE						3	3	
	#7 VEHICLE		3	3	3	6	3	3	3
	#8 VEHICLE						3	3	
	#2 PEDESTRIAN				2	2	2		
	#6 PEDESTRIAN	2	2	2	4	2	2	2	
	#6 PEDESTRIAN		2	2	2	2	2	2	2
	#6 PEDESTRIAN		2	2	2	2	4	2	2
	#2 P.P.B.				2			1	
	#4 P.P.B.		1	1	1				
	#6 P.P.B.		1	1	1	1	1	1	1
	#8 P.P.B.								
	P.P.B. COMMON	1	1	1	2	1	1	1	1
	SPARES	3	3	3	9	3	3	3	3
	TOTAL #14	12	16	19	53	27	23	18	15
#12	I.L.S.N.S.		2	2	2		2	2	2
#10	SIGNAL COMMON	1	1	1	2	1	1	1	1
	LUMINAIRES		2	2	2		2	2	2
	SERVICE		1	1	1		2	2	2
	TOTAL #10	1	2	2	2	2	2	2	2
	#1 DETECTOR			1	1				
	#2 DETECTOR					3	3	3	
	#3 DETECTOR	1	1	1	1				
	#4 DETECTOR					3			
	#5 DETECTOR				1	1	1		
	#6 DETECTOR		3	3	3				
	#7 DETECTOR				1				
	#8 DETECTOR	1	1	1	3	2	2	2	2
	TOTAL D.L.C.	2	5	6	15	6	6	2	2

(N)=NEW CONDUIT (E)=EXISTING CONDUIT
REMOVE AND INSTALL ALL NEW CONDUCTORS IN RUNS 4, 5, 6, 7, AND 8.

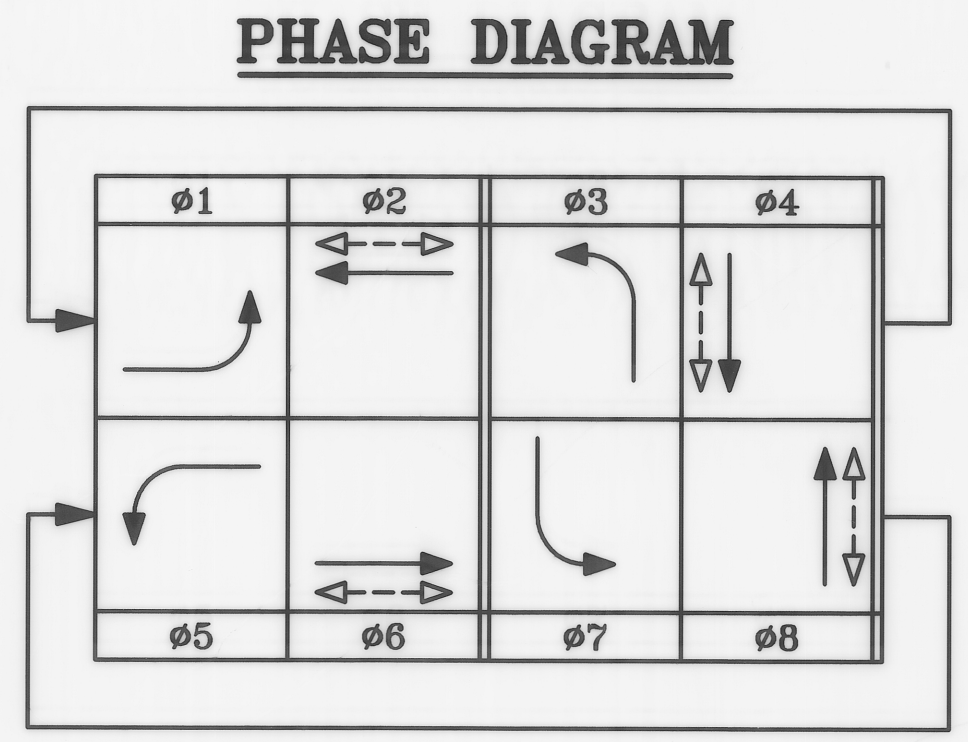

POLE AND EQUIPMENT SCHEDULE											
POLE NO.	DESCRIPTION	SIGNAL STANDARD			HPSV LUMINAIRE	I.L.S.N.S. LEGEND	SIGNAL MOUNTING			PED PUSH BUTTONS	REMARKS
		POLE HEIGHT	SIGNAL MAST ARM	LUMINAIRE MAST ARM			MAST ARM VEHICLE	POLE VEHICLE	POLE PEDESTRIAN		
(A)	1-A	10'	-	-	-	-	-	TV-1-T	SP-1-T	2	EXISTING POLE TO REMAIN
(B)	26-4-70	30'	45'	15'	400W	Blaine St 1200	2-MAS	SV-1-T	SP-1-T	2	EXISTING POLE TO REMAIN
(C)	1-A	10'	-	-	-	-	-	TV-1-T	SP-1-T	8	EXISTING POLE TO REMAIN
(D)	24-4-70	30'	35'	12'	400W	Iowa Ave 3200	2-MAS	SV-1-T	SP-1-T	8	RELOCATE EXISTING POLE
(E)	1-A	10'	-	-	-	-	-	TV-1-T	SP-2-T	6	RELOCATE EXISTING POLE
(F)	26-4-70	30'	40'	15'	400W	Blaine St 1200	2-MAS	SV-1-T	SP-1-T	6	EXISTING POLE TO REMAIN
(G)	1-A	10'	-	-	-	-	-	TV-1-T	SP-1-T	4	EXISTING POLE TO REMAIN
(H)	24-4-70	30'	35'	12'	400W	Iowa Ave 3200	2-MAS	SV-1-T	SP-1-T	4	EXISTING POLE TO REMAIN

CONSTRUCTION NOTES

- 1 - Abandon existing #8 front right loop detectors as shown on the plan.
- 2 - Install new #8 front right loop detectors as shown on the plan.
- 3 - Relocated pole (D) and equipment to new pole location as shown on the plan.
- 4 - Relocated pole (E) and equipment to new pole location as shown on the plan.

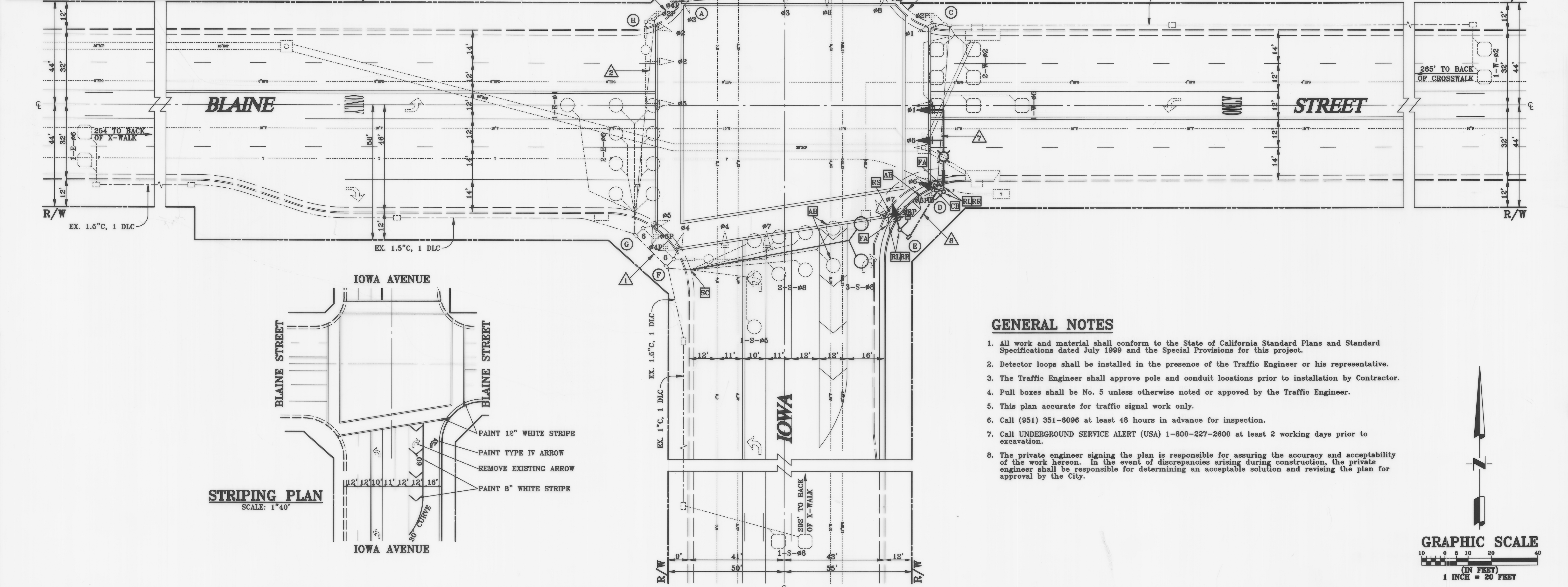

GENERAL NOTES

1. All work and material shall conform to the State of California Standard Plans and Standard Specifications dated July 1999 and the Special Provisions for this project.
2. Detector loops shall be installed in the presence of the Traffic Engineer or his representative.
3. The Traffic Engineer shall approve pole and conduit locations prior to installation by Contractor.
4. Pull boxes shall be No. 5 unless otherwise noted or approved by the Traffic Engineer.
5. This plan accurate for traffic signal work only.
6. Call (951) 351-6096 at least 48 hours in advance for inspection.
7. Call UNDERGROUND SERVICE ALERT (USA) 1-800-227-2600 at least 2 working days prior to excavation.
8. The private engineer signing the plan is responsible for assuring the accuracy and acceptability of the work hereon. In the event of discrepancies arising during construction, the private engineer shall be responsible for determining an acceptable solution and revising the plan for approval by the City.

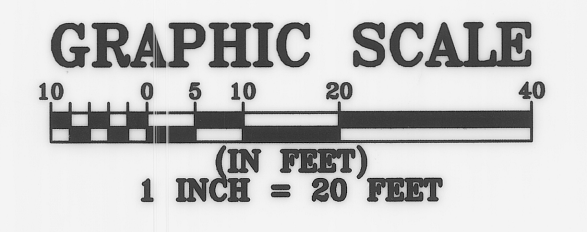

PRIVATE ENGINEERING NOTE
CONSTRUCTION CONTRACTOR AGREES THAT BY ACCORDANCE WITH GENERALLY ACCEPTED CONSTRUCTION PRACTICES, CONSTRUCTION CONTRACTOR WILL BE RESPONSIBLE TO ASSURE SAFE AND COMPLETE RESPONSIBILITY FOR JOB SITE CONDITIONS DURING THE COURSE OF CONSTRUCTION OF THE PROJECT, INCLUDING SAFETY OF ALL PERSONS AND PROPERTY. THAT THIS RESPONSIBILITY SHALL BE HELD TO APPLY CONTINUOUSLY AND NOT BE LIMITED TO NORMAL WORKING HOURS, AND CONSTRUCTION CONTRACTOR FURTHER AGREES TO DEFEND, INDEMNIFY AND HOLD DESIGN PROFESSIONAL HARMLESS FROM ANY AND ALL LIABILITY, REAL OR ALLEGED, IN CONNECTION WITH THE PERFORMANCE OF WORK ON THIS PROJECT, EXCEPTING LIABILITY ARISING FROM THE SOLE NEGLIGENCE OF DESIGN PROFESSIONAL.

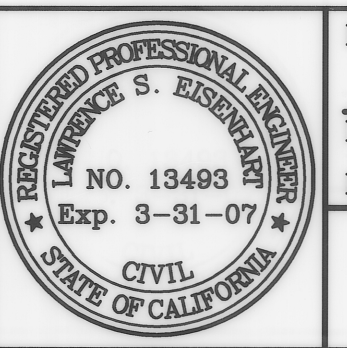

ENGINEER IN RESPONSIBLE CHARGE:
Lawrence S. Eisenhart
LAWRENCE S. EISENHART RCE NO. 13493
EXPIRATION DATE: 3-31-07

LAWRENCE S. EISENHART
CONSULTING ENGINEER
2070 Locust Court
San Bernardino, California 92404
Tel: (909) 864-5406 Fax: (909) 864-5047

SCALE: 1"=20'
DATE: 11/11/05

MARK	REVISIONS	APPR. DATE

DESIGNED BY: L.S.E. DRAWN BY: L.S.E. CHECKED BY:

CITY OF RIVERSIDE
PUBLIC WORKS DEPARTMENT

APPROVED BY: BY DATE
PRINCIPLE ENGR. CH 11/16/05
TRAFFIC DIVISION LA 11/16/05

CITY ENGINEER
DATE 11/16/05

TRAFFIC SIGNAL MODIFICATION PLAN
IOWA AVENUE and BLAINE STREET
SCALE: 1"=20'

PROJECT NO: **X-409B**
SHEET **1** OF **1**
FILE NAME: 409B.DWG

A.W.G. OR D.L.C.	CONDUCTOR SCHEDULE							
	CONDUIT RUNS							
CIRCUIT	1	2	3	4	5	6	7	8
#1 VEHICLE				3	3	3	3	
#2 VEHICLE				3	3			
#3 VEHICLE					6	3	3	
#4 VEHICLE		3	3	3	3			
#5 VEHICLE			3	3	3			
#6 VEHICLE						3	3	3
#7 VEHICLE		3	3	3	6	3	3	3
#8 VEHICLE						3	3	
#2 PEDESTRIAN				2	2	2		
#4 PEDESTRIAN	2	2	2	4				
#6 PEDESTRIAN		2	2	2	2	2	2	2
#8 PEDESTRIAN		2	2	2	2	4	2	2
#2 P.P.B.						2	1	
#4 P.P.B.		1	1	1				
#6 P.P.B.	1	1	1	2				
#8 P.P.B.					1			
P.P.B. COMMON	1	1	1	2	1	1	1	1
SPARES	3	3	3	9	3	3	3	3
TOTAL #14	12	16	19	53	27	23	18	15
#12 I.I.S.N.S.		2	2	2		2	2	2
#10 SIGNAL COMMON	1	1	1	2	1	1	1	1
#8 LUMINAIRES		2	2	2		2	2	2
SERVICE								
TOTAL #10	1	2	2	2	2	2	2	2
#1 DETECTOR				1	1			
#2 DETECTOR					3	3	3	
#3 DETECTOR	1	1	1	1				
#4 DETECTOR						3		
#5 DETECTOR					1	1	1	
#6 DETECTOR			3	3	3			
#7 DETECTOR								
#8 DETECTOR	1	1	1	3	2	2	2	2
TOTAL D.L.C.	2	5	6	15	6	6	2	2

(N)=NEW CONDUIT (E)=EXISTING CONDUIT (X) EXTEND EXISTING CONDUIT
INSTALL ALL NEW CONDUCTORS, CABLES AND D.L.C.'S IN RUNS 1, 2, 3 AND 4.

CONDUIT SIZE (IN)	(N)	(X)	(E)	(E)	(E)	(E)	(E)	(E)
2	2							
2.5		3						
3			2					
2-2.5			2					
2.5				2				
2					2			
2						2		

PHASE DIAGRAM

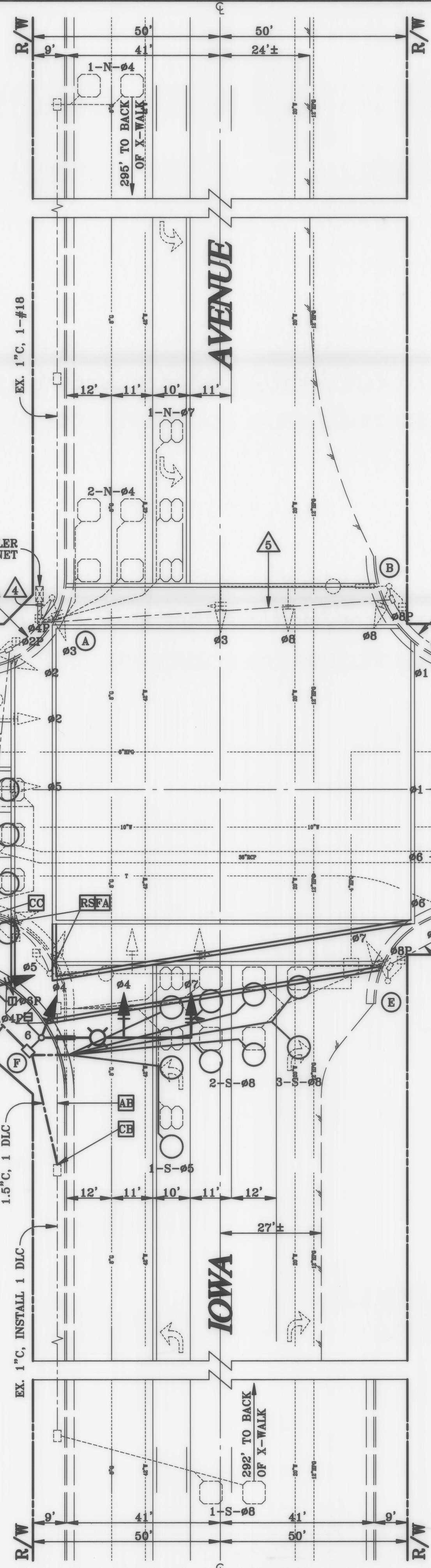
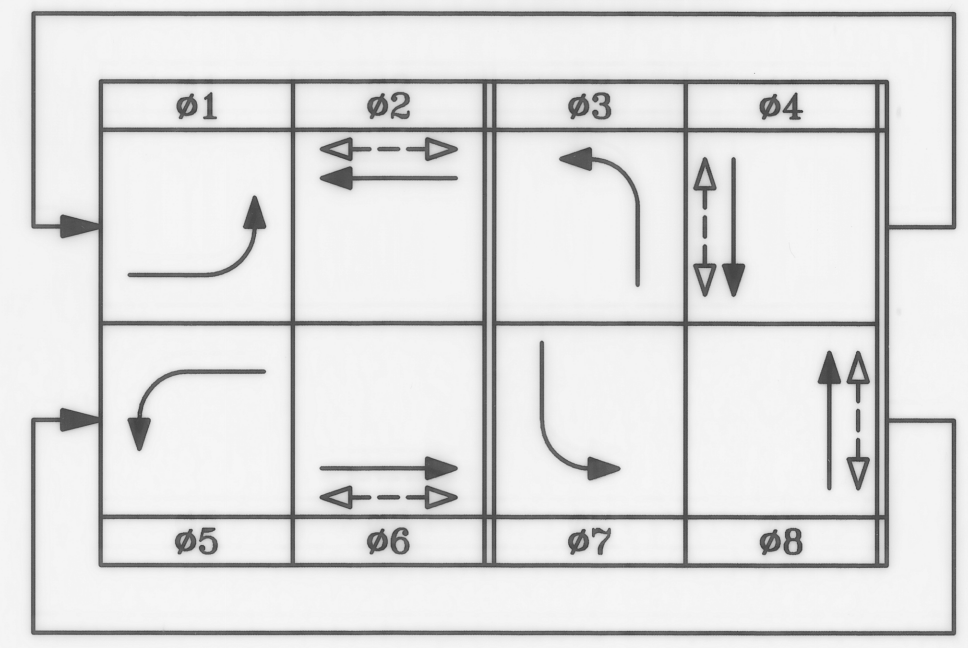

POLE AND EQUIPMENT SCHEDULE												
POLE NO.	DESCRIPTION	SIGNAL STANDARD			HPSV LUMINAIRE	I.I.S.N.S. LEGEND	SIGNAL MOUNTING			PED PUSH BUTTONS	REMARKS	
		POLE HEIGHT	SIGNAL MAST ARM	LUMINAIRE MAST ARM			MAST ARM VEHICLE	POLE VEHICLE	POLE PEDESTRIAN			
A	1-A	10'	-	-	-	-	-	TV-1-T	SP-1-T	2	EXISTING POLE TO REMAIN	
B	26-4-70	30'	45'	15'	400W	Blaine St 1200	-	2-MAS	SV-1-T	SP-1-T	2	EXISTING POLE TO REMAIN
C	1-A	10'	-	-	-	-	-	TV-1-T	SP-1-T	8	EXISTING POLE TO REMAIN	
D	24-4-70	30'	35'	12'	400W	Iowa Ave 3300	-	2-MAS	SV-1-T	SP-1-T	8	EXISTING POLE TO REMAIN
E	1-A	10'	-	-	-	-	-	TV-1-T	SP-1-T	6	EXISTING POLE TO REMAIN	
F	26-4-70	30'	40'	15'	400W	Blaine St 1200	-	2-MAS	SV-1-T	SP-1-T	6	RELOCATE EXISTING POLE
G	1-A	10'	-	-	-	-	-	TV-1-T	SP-1-T	4	RELOCATE EXISTING POLE	
H	24-4-70	30'	35'	12'	400W	Iowa Ave 3200	-	2-MAS	SV-1-T	SP-1-T	4	EXISTING POLE TO REMAIN

CONSTRUCTION NOTES

- Abandon existing all #3 and #8 front loop detectors as shown on the plan.
- Install all new #3 and new #8 front loop detectors as shown on the plan.
- Abandon existing all #1 and #6 front loop detectors as shown on the plan.
- Install all new #1 and new #6 front loop detectors as shown on the plan.

GENERAL NOTES

- All work and material shall conform to the State of California Standard Plans and Standard Specifications dated July 1999 and the Special Provisions for this project.
- Detector loops shall be installed in the presence of the Traffic Engineer or his representative.
- The Traffic Engineer shall approve pole and conduit locations prior to installation by Contractor.
- Pull boxes shall be No. 5 unless otherwise noted or approved by the Traffic Engineer.
- This plan accurate for traffic signal work only.
- Call (951) 351-6096 at least 48 hours in advance for inspection.
- Call UNDERGROUND SERVICE ALERT (USA) 1-800-227-2600 at least 2 working days prior to excavation.
- The private engineer signing the plan is responsible for assuring the accuracy and acceptability of the work hereon. In the event of discrepancies arising during construction, the private engineer shall be responsible for determining an acceptable solution and revising the plan for approval by the City.

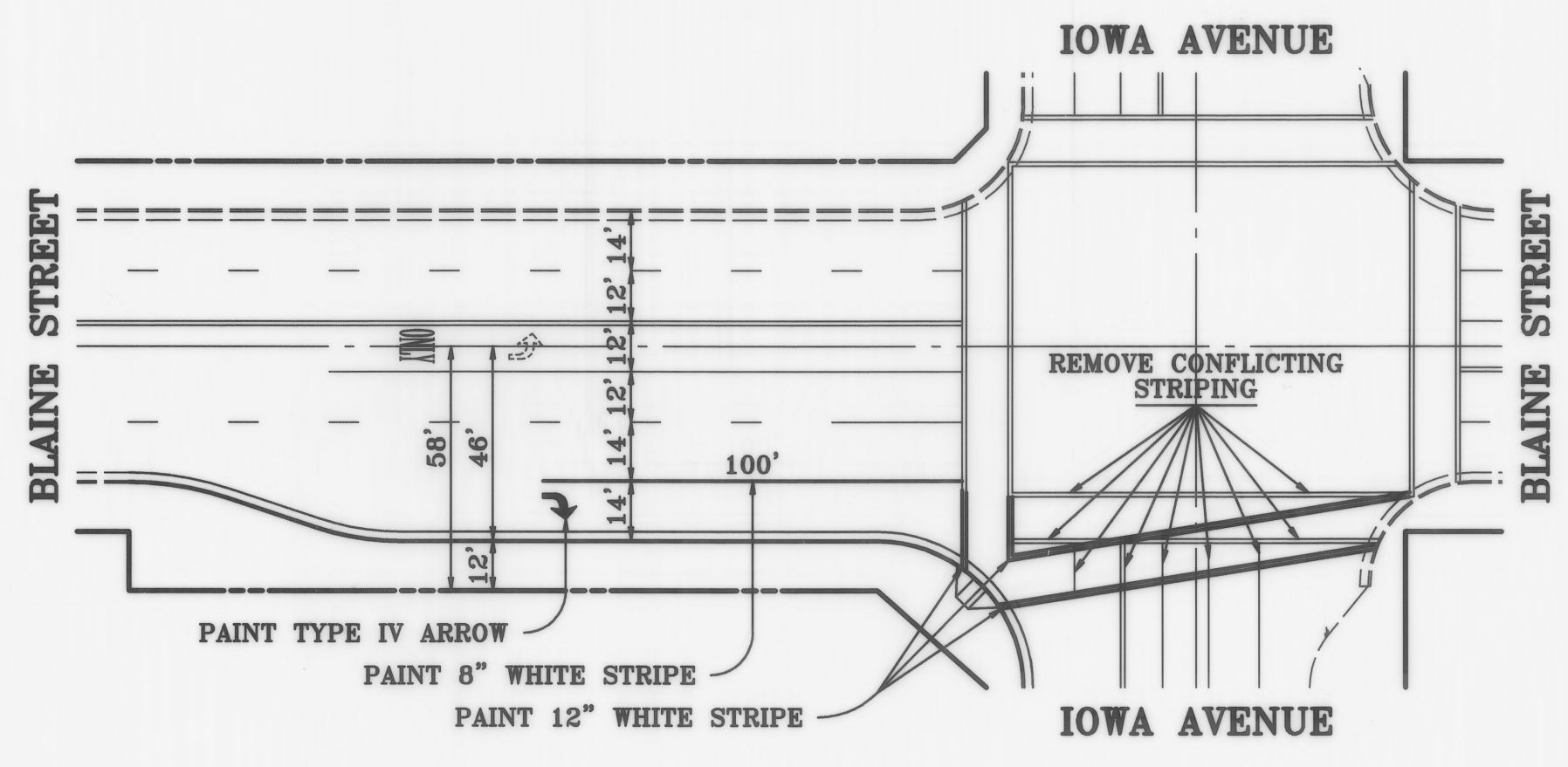

STRIPING PLAN
SCALE: 1"=40'

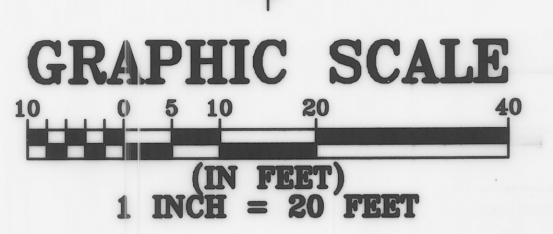

PRIVATE ENGINEERING NOTE
CONTRACTOR AGREES THAT IN ACCORDANCE WITH GENERALLY ACCEPTED CONSTRUCTION PRACTICES, CONTRACTOR SHALL BE RESPONSIBLE FOR THE SAFETY OF ALL PERSONS AND PROPERTY DURING THE COURSE OF CONSTRUCTION OF THIS PROJECT, INCLUDING SAFETY OF ALL PERSONS AND PROPERTY. THAT THE CONTRACTOR SHALL BE RESPONSIBLE FOR THE SAFETY OF ALL PERSONS AND PROPERTY DURING THE COURSE OF CONSTRUCTION OF THIS PROJECT, INCLUDING SAFETY OF ALL PERSONS AND PROPERTY. THAT THE CONTRACTOR SHALL BE RESPONSIBLE FOR THE SAFETY OF ALL PERSONS AND PROPERTY DURING THE COURSE OF CONSTRUCTION OF THIS PROJECT, INCLUDING SAFETY OF ALL PERSONS AND PROPERTY.



ENGINEER IN RESPONSIBLE CHARGE:
Lawrence S. Eisenhart
LAWRENCE S. EISENHART RCE NO. 13493
EXPIRATION DATE: 3-31-07

LAWRENCE S. EISENHART
CONSULTING ENGINEER
2070 Locust Court
San Bernardino, California 92404
Tel: (909) 864-5406 Fax: (909) 864-5047
SCALE: 1"=20'
DATE: 11/11/05

MARK	REVISIONS	APPR. DATE
DESIGNED BY: L.S.E.	DRAWN BY: L.S.E.	CHECKED BY:

CITY OF RIVERSIDE
PUBLIC WORKS DEPARTMENT
APPROVED BY: *[Signature]* BY DATE: 11/22/05
PRINCIPLE ENGR. *[Signature]*
TRAFFIC DIVISION
CITY ENGINEER
DATE: 11/22/05

TRAFFIC SIGNAL MODIFICATION PLAN
IOWA AVENUE and BLAINE STREET
SCALE: 1"=20'

PROJECT NO: **X-409A**
SHEET **1** OF **1**
FILE NAME: X409A.DWG

File No. 05-27

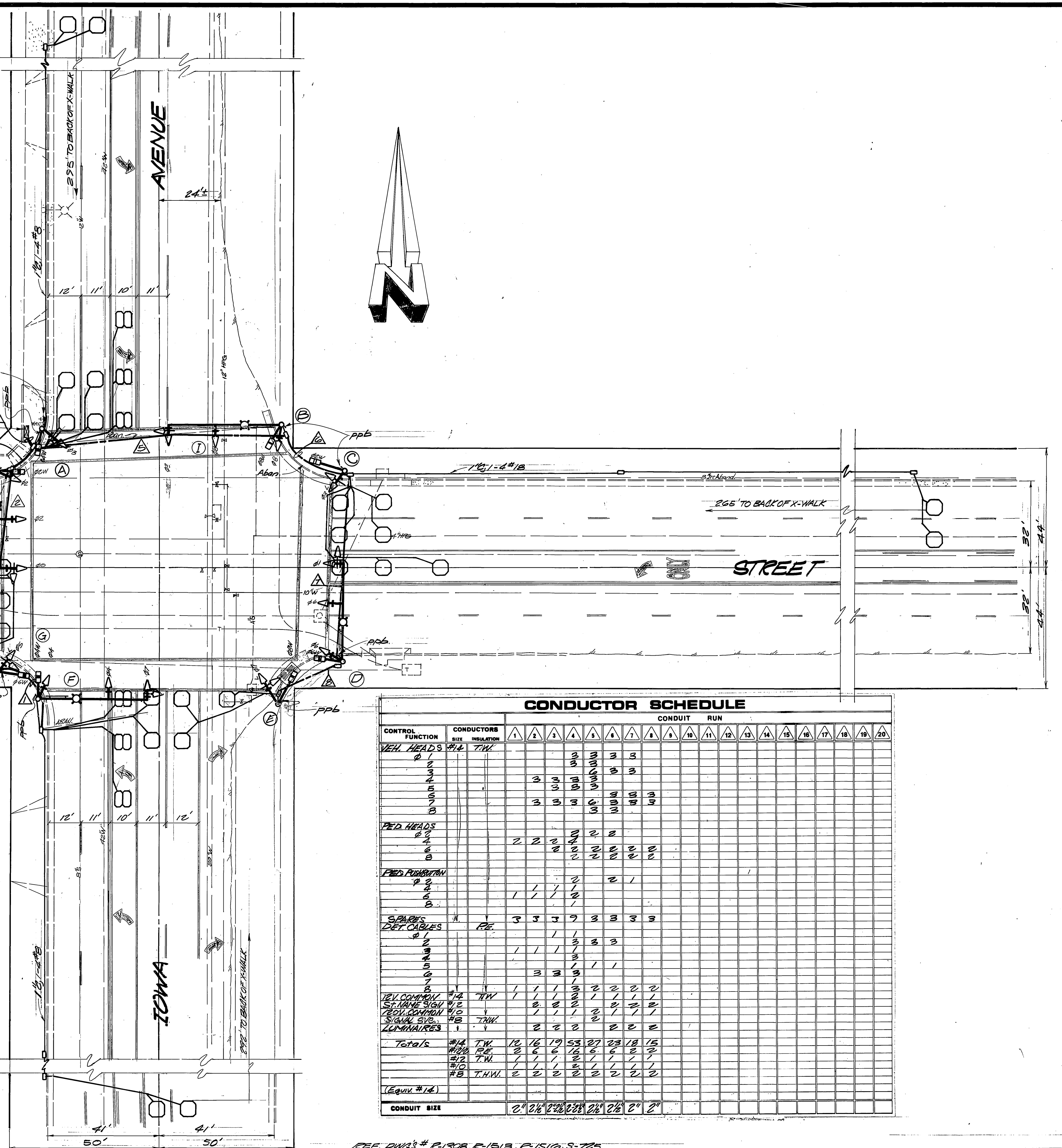
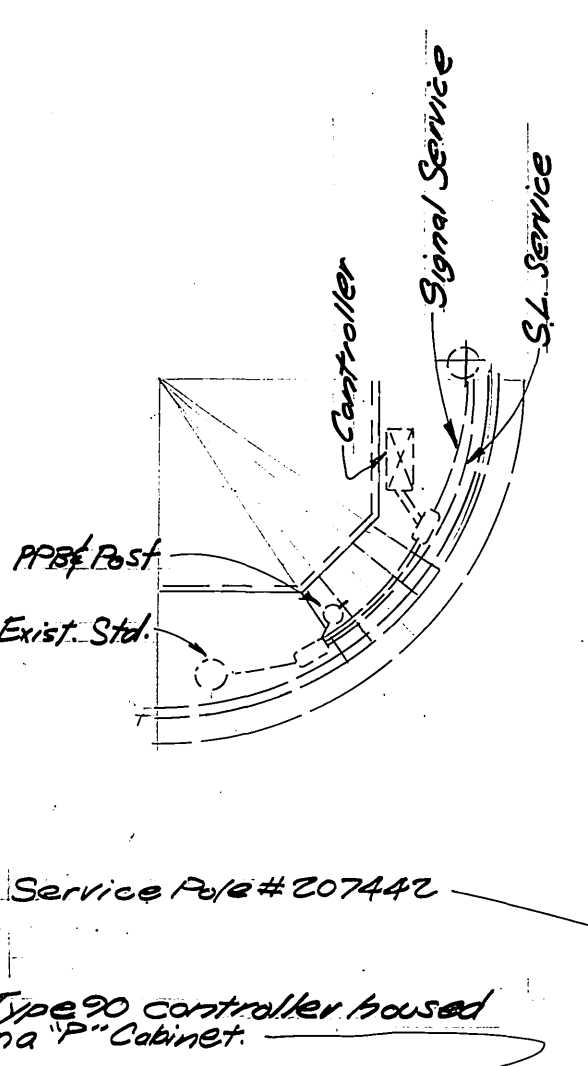
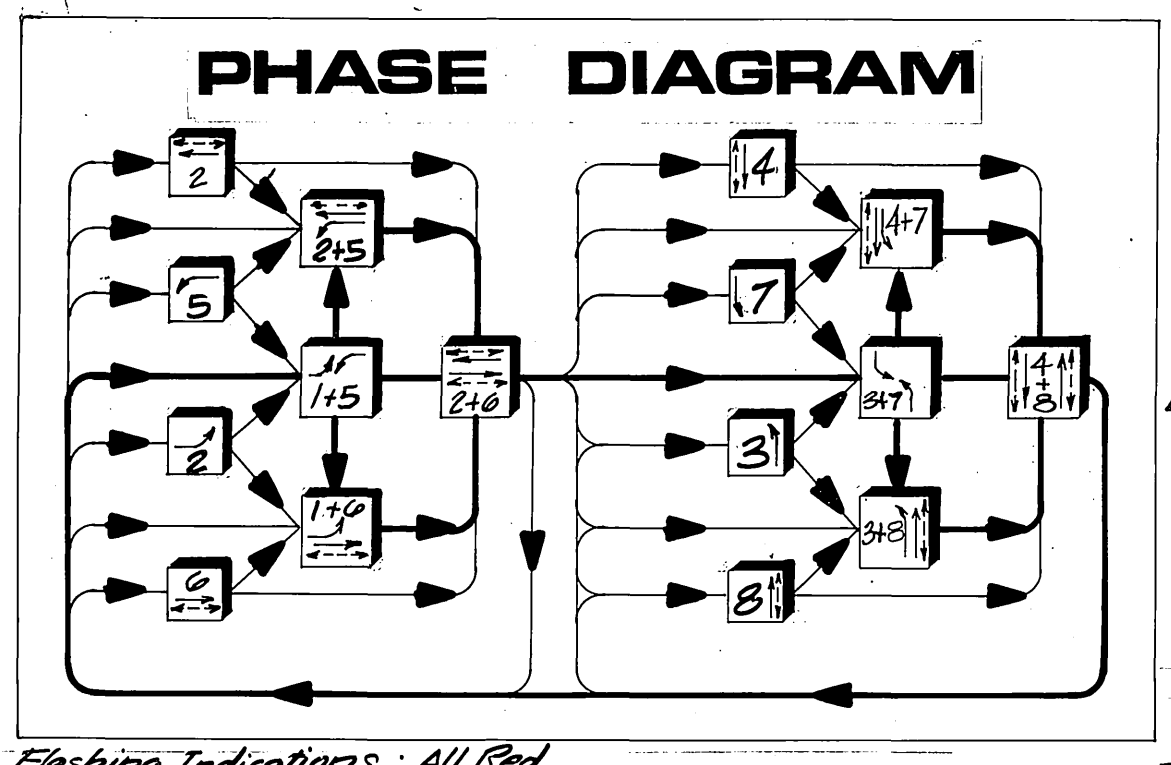

EQUIPMENT SCHEDULE

LOCATION	STANDARD	VEHICLE HEADS			PEDESTRIAN HEADS			LUMINAIRE	INT ILLUM STREET NAME SIGN	REMARKS
		HEAD	MOUNTING	BACK PLATE	HEAD	MOUNTING	PPB			
A	1-(10')	1W3C (R,Y,12BA)	TK-1-T	1	1W2C	SP-1-T	1			
B	24-4-70 405A,161A	1W3C* 1W3C(12')	MAS MAS	1 1				400W	Blaine 1200	
C	1-(10')	1W3C (R,Y,12BA)	TK-1-T	1	1W2C	SP-1-T	1			
D	24-4-70 355A,121A	1W3C* 1W3C(6')	MAS MAS	1 1				400W	Iowa Ave 3350	
E	1-(10')	1W3C (R,Y,12BA)	TK-1-T	1	1W2C	SP-1-T	1			
F	24-4-70 405A,161A	1W3C* 1W3C(12')	MAS MAS	1 1				400W	Blaine 1350	
G	1-(10')	1W3C (R,Y,12BA)	TK-1-T	1	1W2C	SP-1-T	1			
H	24-4-70 355A,161A	1W3C* 1W3C(6')	MAS MAS	1 1				400W	Iowa Ave 3350	
I	Red Post									

All type 1 standards are aluminum.

CONDUCTOR SCHEDULE

CONTROL FUNCTION	CONDUCTORS	SIZE	INSULATION	CONDUIT RUN																			
				1	2	3	4	5	6	7	8	9	10	11	12	13	14	15	16	17	18	19	20
VEH HEADS	#12	TW																					
PED HEADS	#12	TW																					
PED POSITION	#12	TW																					
SPARES	#12	TW																					
DET CABLES	#12	TW																					
12V COMMON	#12	TW																					
SECURITY SIGN	#12	TW																					
SIGNAL SVCS	#12	TW																					
LUMINAIRES	#12	TW																					
Totals	#12	TW		12	16	19	53	27	23	18	15												
	#12	PE		2	6	16	6	6	2	2													
	#12	TW		1	1	1	2	1	1	1													
	#12	PE		1	1	1	2	1	1	1													
	#12	TW		2	2	2	2	2	2	2													
(Equip #12)																							
CONDUIT SIZE				2"	2"	2"	2"	2"	2"	2"	2"	2"	2"	2"	2"	2"	2"	2"	2"	2"	2"	2"	

REF. DWG'S # R-1308, R-1513, R-1510, S-725

CITY OF RIVERSIDE PUBLIC WORKS DEPARTMENT			TRAFFIC SIGNAL IOWA AVENUE AT BLAINE STREET		ACCOUNT NO. 30-576304-07 X-409
APPROVED BY PRINCIPAL ENGINEER <i>[Signature]</i>	APPROVED BY PUBLIC WORKS DIRECTOR <i>[Signature]</i>	DATE 1/19/81	SCALE 1"=20'	SHEET OF	
DESIGNED BY <i>[Signature]</i>	DRAWN BY <i>[Signature]</i>	CHECKED BY <i>[Signature]</i>	REVISIONS 1. 1/19/81 2. 1/19/81	CHIEF P.W. ENGINEER <i>[Signature]</i>	PUBLIC UTILITIES