

**PHASE DIAGRAM**

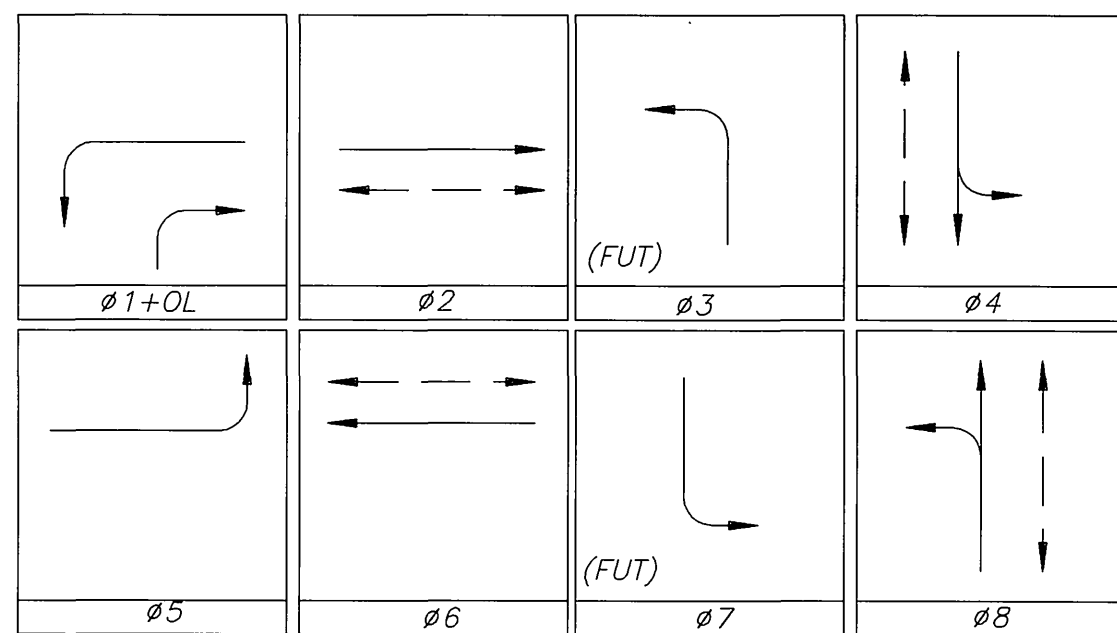

FLASHING OPERATIONS: ALL RED.

CONTRACTOR SHALL FURNISH 2 EA. 2 CHANNEL DETECTORS, SHELF MOUNTED, FOR INSTALLATION BY C/R FORCES (SEE SPECIAL PROVISIONS)

**LEGEND**

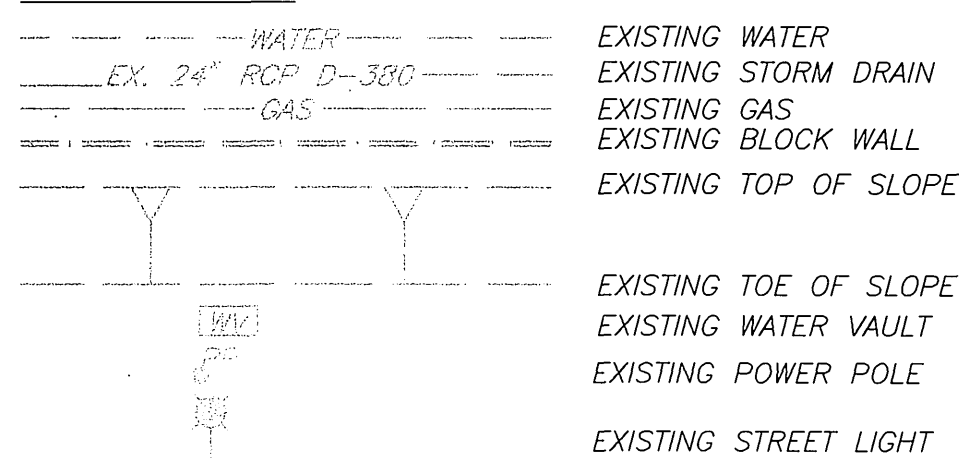

PLACE R61(SPECIAL) SEE DETAIL BELOW

**CONSTRUCTION NOTES**

1. TRAFFIC SIGNAL WORK SHALL CONFORM TO THE PROVISIONS OF SECTION 86 OF THE MOST CURRENT STANDARD SPECIFICATIONS, THE STANDARD PLANS, BOTH PUBLISHED BY CALTRANS, APPLICABLE CITY OF RIVERSIDE STANDARD DRAWINGS, AND THE CONTRACT SPECIAL PROVISIONS.
2. DETECTOR LOOPS SHALL BE 6\"/>

**GENERAL NOTES**

1. THIS PLAN ACCURATE FOR TRAFFIC SIGNAL WORK ONLY.
2. SEE PLAN R-3887 FOR STREET IMPROVEMENTS.
3. A "STREET OPENING" PERMIT ISSUED BY THE CITY OF RIVERSIDE PUBLIC WORKS DEPARTMENT IS REQUIRED FOR THE WORK HEREON; INSPECTION SHALL BE AT THE RATE OF \$29.35 PER HOUR.
4. CALL (909) 351-6096 AT LEAST 48 HOURS IN ADVANCE FOR INSPECTION.
5. CALL UNDERGROUND SERVICE ALERT (U.S.A.) 1-800-422-4133 AT LEAST 2 WORKING DAYS PRIOR TO EXCAVATION.
6. THE PRIVATE ENGINEER SIGNING THE PLANS IS RESPONSIBLE FOR ASSURING THE ACCURACY AND ACCEPTABILITY OF THE WORK HEREON. IN THE EVENT OF DISCREPANCIES ARISING DURING CONSTRUCTION THE PRIVATE ENGINEER SHALL BE RESPONSIBLE FOR DETERMINING AN ACCEPTABLE SOLUTION AND REVISING THE PLANS FOR APPROVAL BY THE CITY.

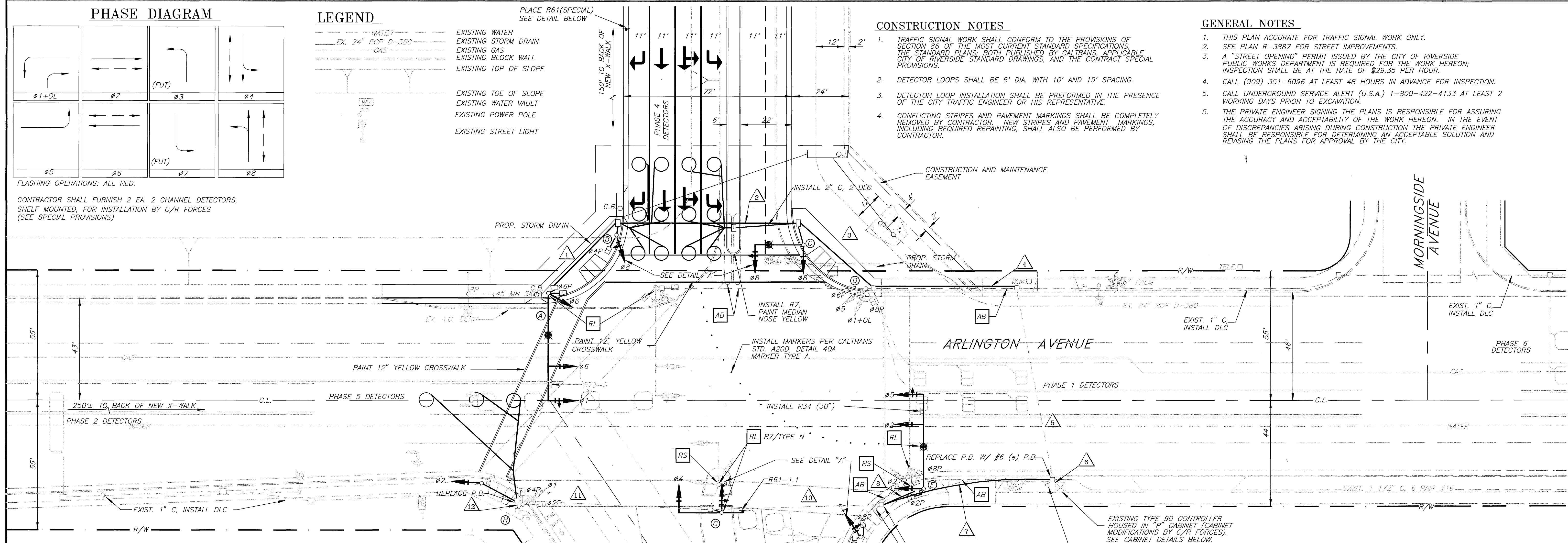

CONDUCTOR		TABLE											
CONTROL FUNCTION	CONDUCTORS I.M.S.A./SIZE INSULATION	CONDUIT RUNS											
		1	2	3	4	5	6	7	8	9	10	11	12
VEHICLE AND PEDESTRIAN HEADS, PEDESTRIAN PUSH BUTTONS, SPARES AND COMMONS	12 P.E.	1	1	1	2	2	4	2	1	1	1	1	1
	9				1	2	5	3			1	2	1
	5	1	2	3	4	4	8	4	1	1	1	1	1
DETECTOR CABLE	#16/2 P.E.				2	2	2						
PHASE 1													
PHASE 2								1	1			1	1
PHASE 3													
PHASE 4			2	4	4	4	4						
PHASE 5								1	1			1	1
PHASE 6								2	2				
PHASE 7													
PHASE 8								3	3			3	
TOTALS	#16/2 P.E.		2	4	6	8	13	5		3	2	2	
INTERCONNECT CABLE	#19							1					
I.I.S.N.S.(FUT.)	#12 T.W.	2	2	2	2	2	2	2	2			2	
LUMINARIES	#8 T.H.W.	2	2	2	2	2	2	2	2				
SIGNAL SERVICE	#6 T.W.												
CONDUIT SIZE		2"	2-1/2"	3"	3"	3"	3-1/2"	3"	2"	1-1/2"	2"	2"	2"
		(N)	(N)	(N)	(N)	(E)	(E)	(N)	(N)	(E)	(E)	(E)	(E)

SEE CONTRACT SPECIAL PROVISIONS FOR ADDITIONAL INFORMATION ON I.M.S.A. SYSTEM SHALL HAVE ALL NEW CONDUCTORS AND CABLES.  
(E) = EXISTING CONDUIT  
(N) = NEW CONDUIT

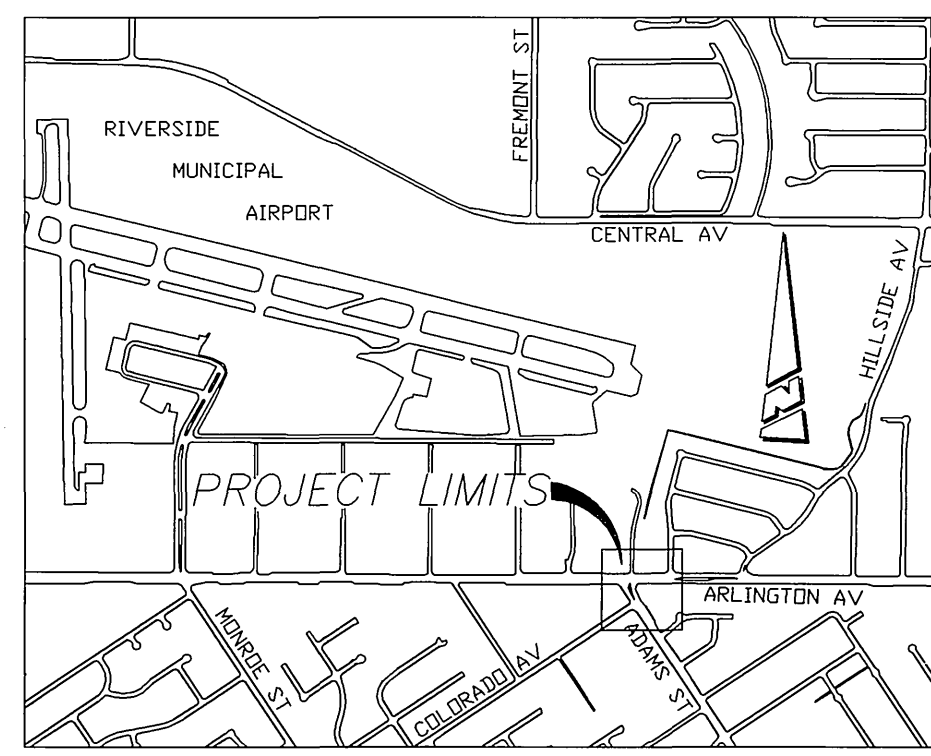

**VICINITY MAP**  
NOT TO SCALE

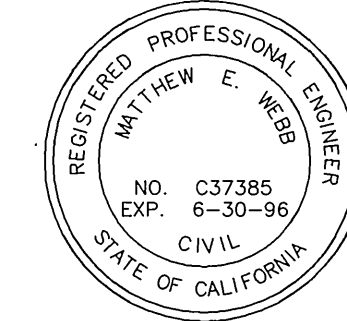

ALBERT A. WEBB ASSOCIATES  
CIVIL ENGINEERS  
3788 McCRAE STREET RIVERSIDE CA 92506  
(909)686-1070  
APPROVED BY: *Matthew E. Webb* DATE: 8/31/95  
R.C.E. NO. 37385

CITY OF RIVERSIDE, CALIFORNIA  
PUBLIC WORKS DEPARTMENT  
APPROVED BY: *[Signature]* DATE: 9/1/95  
INSPECTION: 9-1-95  
TRAFFIC DIV. 9-1-95  
CHIEF P.W. ENGR. 9-1-95  
UTILITIES ENGR. 9/1/95

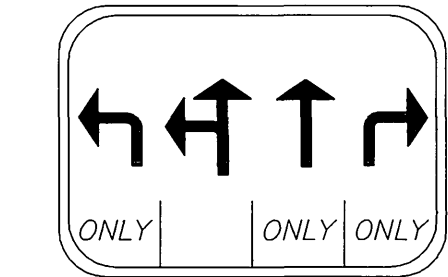

**R61 (SPECIAL)**  
48" X 30" MIN.

POLE		SCHEDULE				REMARKS						
NO.	TYPE	HGT.	SIG.	M.A.	LUM.		HPSV	I.I.S.N.S. LEGEND	SIGNAL HEAD	VEHICLE	PED	PPB PHASE
(A)	26-4-70	30'	45'	15'	250			1W3C MAS(2)	SV-1-T	SP-1-T	4	RL POLE & EQUIPMENT AS SHOWN; RL PPB TO CROSSWALK QUADRANT OF POLE
(B)	1A	10'						1W4C TV-1-T	SP-1-T		6	PROVIDE & INSTALL NEW POLE & EQUIPMENT AS SHOWN
(C)	17-2-80	30'	20'	12'	250			1W4C MAS	SV-1-T		6	PROVIDE & INSTALL NEW POLE & EQUIPMENT AS SHOWN
(D)	1A	10'						1W3C TV-2-T				RS #6 PED. PUSH BUTTON POLE & EQUIPMENT EXISTS.
(E)	26-4-80	30'	40'	12'	250			1W3C MAS(2)	SV-1-T	SP-2-T	8	PROVIDE & INSTALL NEW POLE & EQUIPMENT AS SHOWN
(F)	1A	10'						1W4C TV-1-T	SP-1-T		2	PROVIDE & INSTALL NEW POLE & EQUIPMENT AS SHOWN
(G)	33	18'	10', 15'					1W3C MAS	SV-1-T			PROVIDE & INSTALL NEW POLE & EQUIPMENT AS SHOWN.
(H)	68J10	30'			10'			1W4C SV-1-T	SP-2-T		2, 4	POLE & EQUIPMENT EXISTS.
(I)	1A	10'						1W3C TV-1-T				PROVIDE & INSTALL NEW POLE & EQUIPMENT AS SHOWN

- NOTES:
1. POLE TO BE (RS) AT LOCATION G IS 56J10.
  2. NEW VEHICLE SIGNALS SHALL HAVE 12" LENS.
  3. 1A POLES SHALL BE ALUMINUM.
  4. LUMINARIE SHALL BE HIGH PRESSURE SODIUM VAPOR.
  5. PEDESTRIAN PUSH BUTTONS (PPB) SHALL BE INSTALLED ON THE POLE IN THE QUADRANT NEAREST THE CROSSWALK SERVED.

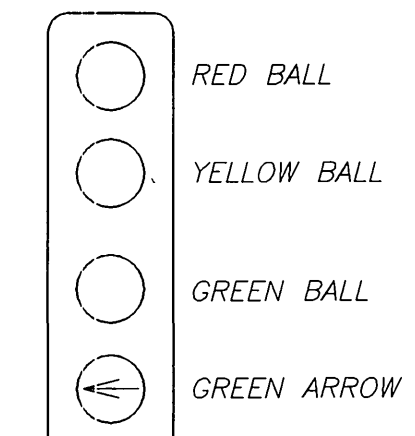

**DETAIL "A"**  
N.T.S.



ACCOUNT NO. CU-030-656  
DRAWING NUMBER X-418A  
TRAFFIC SIGNAL MODIFICATION ARLINGTON AVENUE & ADAMS STREET  
SHEET 1 OF 1  
SCALE: 1" = 20'  
94-366-X

CONDUCTOR RUN	CONDUCTOR SCHEDULE																							
	A				B				C				D				E							
CONDUCTORS	8	10	12	14	8	10	12	14	8	10	12	14	8	10	12	14	8	10	12	14				
ØA C#6				3				3				3				6				3				
ØB C#6				3				3				3				3				3				
ØAP C#6P				2				2				2				4				3				
ØBP C#6P				2				2				2				2				2				
SPACES																				3				
120V. NEUTRAL																								
ØB DET. C#6																2				1				
ØA DET. C#6																4				2				
ØB PFB C#6																2				1				
12V. NEUTRAL																				1				
STREET LIGHTING																				2				
ØB CALL DET.																								
SIGNAL SERVICE																								
ØA PFB C#6																5				3				
S																3				1				
TOTAL CONDUCTORS	2	1	1	16	2	1	1	17	2	1	1	17	6	3	1	10	4	3	1	11				
CONDUIT SIZE	1" 1/2				2"				3"				3"				1" 1/2				2"			

NOTE: RUNS 5 & 6 HAVE A #12/C CABLE USED FOR STREET LIGHTING (MARKED WITH RED TAPE)

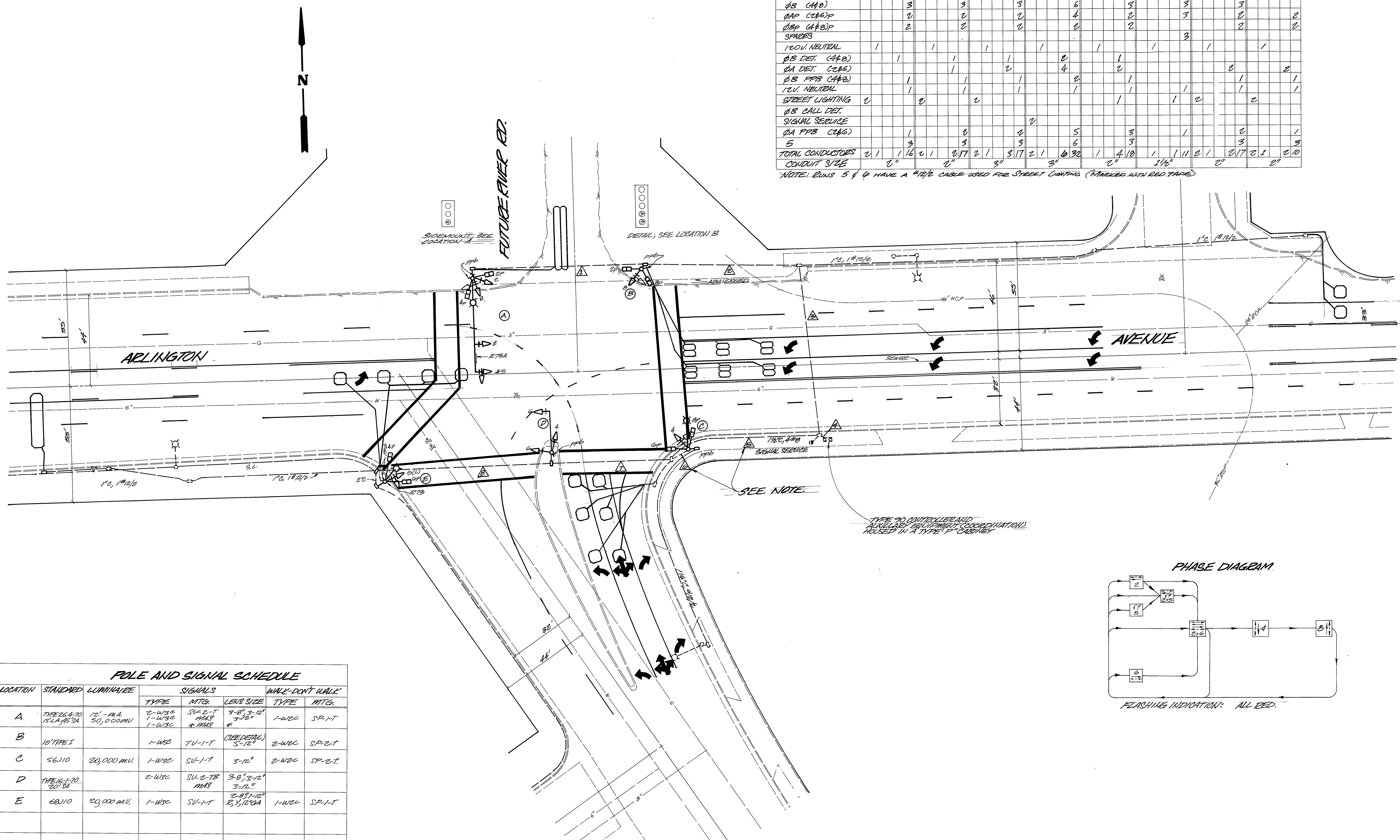

LOCATION	STANDARD	LUMINAIRE	SIGNALS			WALK-DON'T WALK	
			TYPE	MTG.	LEIS SIZE	TYPE	MTG.
A	TYPE 264-70 15' x 45' SA	12' - M.A. 50,000 MV	2-W3C 1-W3C 1-W3C	SU-2-T MAS * MAS	3-8" 3-12" 3-12" *	1-W2C	SP-1-T
B	10' TYPE I		1-W3C	FU-1-T	(SEE DETAIL) 5-12"	2-W2C	SP-2-T
C	56J10	20,000 MV	1-W3C	SU-1-T	3-12"	2-W2C	SP-2-T
D	TYPE 16-170 20' SA		2-W3C	SU-2-TB MAS	3-8" 3-12" 3-12"		
E	68J10	20,000 MV	1-W3C	SU-1-T	2-8" 1-12" 3" 12" GA	1-W2C	SP-1-T

\* PREDETERMINED VISIBILITY HEADS

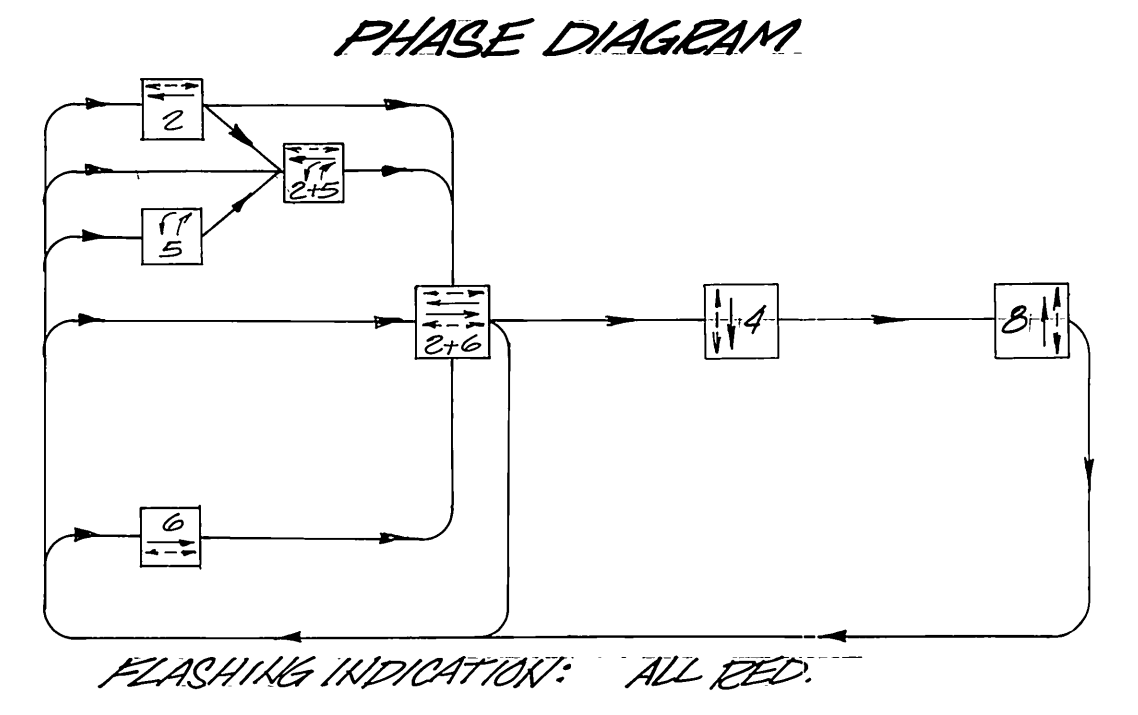

ADDED ØA PER INDICATION AS BUILT PER 83 PERMITS (ØA) SPLIT PHASER 2 ØB CADDING ST AS BUILT PER STORM DRAIN D-300 AS BUILT PER CONTRACT TE-74-1 AS BUILT PER AS BUILT (Signal Installation)		ML 7/9/88 ML 6/16/88 ML 10/28/88 ML 5-14-88 ML 5-5-88 UNW 9/8/77 UNW 7/1/80	<b>CITY OF RIVERSIDE</b> PUBLIC WORKS DEPARTMENT	ARLINGTON AVENUE & ADAMS AVENUE <b>TRAFFIC SIGNALS</b>	ACCOUNT NO. <b>X-418</b> SHEET ____ OF ____
DESIGNED BY: _____ DRAWN BY: _____ CHECKED BY: _____	APPROVED BY: _____ PRINCIPAL ENGINEER PARK DEPARTMENT TRAFFIC DIVISION CHIEF P. W. ENGINEER	APPROVED BY: _____ PUBLIC WORKS DIRECTOR	DATE: _____	HORIZ. SCALE: 1" = 20' VERT. SCALE: 1" = _____	