

CONDUCTOR		TABLE							
CONTROL FUNCTION	CONDUCTORS	CONDUCTOR				RUNS			
		1	2	3	4	5	6	7	8
VEHICLE & PEDESTRIAN HEADS, PEDESTRIAN PUSH BUTTONS, SPARES & COMMONS	12 CONDUCTOR IMSA	1	2	3	4	8	3	2	1
	3 CONDUCTOR IMSA	1	2	3	4	8	3	2	1
DETECTOR CABLE	#16/2								
PHASE 1		-	-	-	1	1	-	-	-
PHASE 2		1	1	1	1	3	2	2	2
PHASE 3		-	-	-	1	1	-	-	-
PHASE 4		-	1	1	1	1	-	-	-
PHASE 5		-	-	-	1	1	1	1	1
PHASE 6		-	-	-	3	3	-	-	-
PHASE 7		-	1	1	1	1	-	-	-
PHASE 8		-	-	-	2	2	-	-	-
TOTALS		1	3	3	7	13	6	3	3
ENVE CABLE	#20/4	1	1	2	2	4	1	1	-
IISNS	#12	2	2	2	2	-	2	2	-
LUMINAIRES	#8	2	2	2	2	-	2	2	-
SIGNAL SERVICE	#8	-	-	-	2	2	-	-	-
CONDUIT SIZE		2"	2"	2.5"	3"	2-3.5" (N)	3"	2.5"	2"

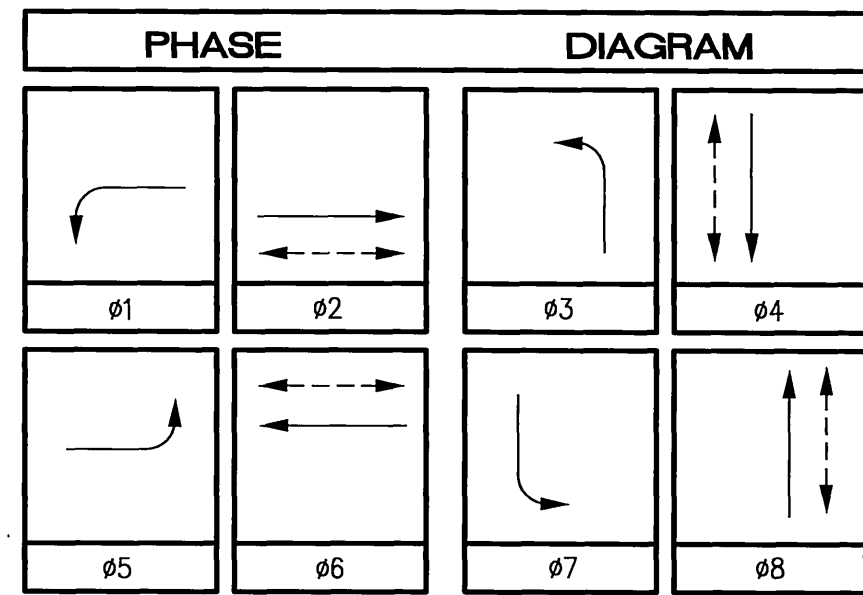

POLE		SCHEDULE											
No.	TYPE	STANDARD HGT.	SIG. M.A.	LUM. M.A.	LUMINAIRE HPS	IISNS LEGEND	SIGNAL MOUNTING				PPB PHASE	REMARKS	
							VEHICLE	PED	AUDIBLE				
1	24-4-129	30'	35'	12'	250W	Linden St 1700	MAS	MAS	SV-1-T	SP-1-T	((C))	#4	
2	1-A	10'	-	-	-	-	-	-	TV-1-T	SP-1-T	((P))	#6	
3	19-4-129	30'	25'	12'	250W	Chicago Ave 3400	MAS	MAS	SV-1-T	SP-1-T	((P))	#6	
4	1-A(E)	10'	-	-	-	-	-	-	TV-1-T	SP-1-T(E)	((C))	#8	
5	29-5-129	30'	50'	12'	250W	Linden St 1600	MAS	MAS	SV-1-T	SP-1-T	((C))	#8	
6	1-A(E)	10'	-	-	-	-	-	-	TV-1-T	SP-1-T(E)	((P))	#2	
7	26-4-129	30'	40'	12'	250W	Chicago Ave 3500	MAS	MAS	SV-1-T	SP-1-T	((P))	#2	
8	1-A(E)	10'	-	-	-	-	-	-	TV-1-T	SP-1-T(E)	((C))	#4	

ALL EQUIPMENT IS NEW UNLESS OTHERWISE INDICATED AS (E) EXISTING.
 ((C)) OR ((P)) - INDICATES AUDITORY PEDESTRIAN SIGNAL TO BE INSTALLED; ((C)) INDICATES CUCKOO SOUND; ((P)) INDICATES PEEP-PEEP SOUND.

ALL CONDUIT IS EXISTING UNLESS OTHERWISE INDICATED AS (N) NEW. ALL CONDUCTORS ARE NEW. EXISTING CONDUCTORS SHALL BE REMOVED AND NOT REUSED UNLESS OTHERWISE NOTED.

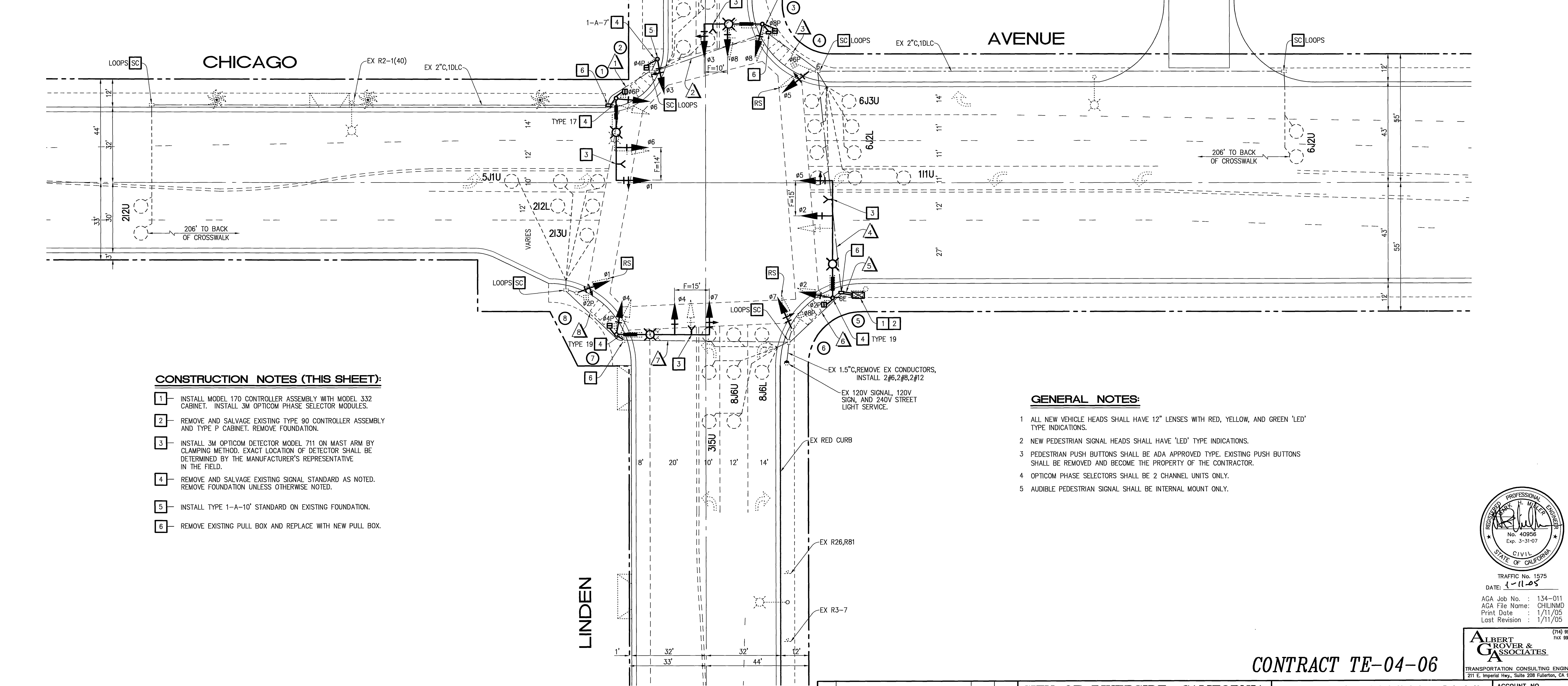

CONSTRUCTION NOTES (THIS SHEET):

- INSTALL MODEL 170 CONTROLLER ASSEMBLY WITH MODEL 332 CABINET. INSTALL 3M OPTICOM PHASE SELECTOR MODULES.
- REMOVE AND SALVAGE EXISTING TYPE 90 CONTROLLER ASSEMBLY AND TYPE P CABINET. REMOVE FOUNDATION.
- INSTALL 3M OPTICOM DETECTOR MODEL 711 ON MAST ARM BY CLAMPING METHOD. EXACT LOCATION OF DETECTOR SHALL BE DETERMINED BY THE MANUFACTURER'S REPRESENTATIVE IN THE FIELD.
- REMOVE AND SALVAGE EXISTING SIGNAL STANDARD AS NOTED. REMOVE FOUNDATION UNLESS OTHERWISE NOTED.
- INSTALL TYPE 1-A-10' STANDARD ON EXISTING FOUNDATION.
- REMOVE EXISTING PULL BOX AND REPLACE WITH NEW PULL BOX.

GENERAL NOTES:

- ALL NEW VEHICLE HEADS SHALL HAVE 12" LENSES WITH RED, YELLOW, AND GREEN 'LED' TYPE INDICATIONS.
- NEW PEDESTRIAN SIGNAL HEADS SHALL HAVE 'LED' TYPE INDICATIONS.
- PEDESTRIAN PUSH BUTTONS SHALL BE ADA APPROVED TYPE. EXISTING PUSH BUTTONS SHALL BE REMOVED AND BECOME THE PROPERTY OF THE CONTRACTOR.
- OPTICOM PHASE SELECTORS SHALL BE 2 CHANNEL UNITS ONLY.
- AUDIBLE PEDESTRIAN SIGNAL SHALL BE INTERNAL MOUNT ONLY.

Underground Service Alert
 Call: TOLL FREE
 1-800-227-2600
 TWO WORKING DAYS BEFORE YOU DIG

CITY OF RIVERSIDE, CALIFORNIA DEPARTMENT OF PUBLIC WORKS		TRAFFIC SIGNAL PLAN		ACCOUNT NO.
APPROVED BY	DATE	BY	DATE	
PRINCIPAL ENGINEER	1/18/05	PH	1/19/05	
TRAFFIC DIVISION		CITY ENGINEER		
MARK	REVISIONS	APPR.	DATE	
DESIGNED BY JAT	DRAWN BY DMS	CHECKED BY JAT		

CONTRACT TE-04-06

CHICAGO AVENUE AND LINDEN STREET

HORIZ. SCALE: 1" = 20' VERT. SCALE: 1" = 20'

X-435A

SHEET 1 OF 1



TRAFFIC No. 1575
 DATE: 1-11-05
 AGA Job No. : 134-011
 AGA File Name: CHILINDM
 Print Date : 1/11/05
 Last Revision : 1/11/05

ALBERT ROVER & ASSOCIATES
 TRANSPORTATION CONSULTING ENGINEERS
 211 E. Imperial Hwy., Suite 208 Fullerton, CA 92635
 (714) 992-2990
 FAX 992-2983

DETECTOR SCHEDULE			
CHANNELS	LOOP DESIGNATION	NUMBER OF LOOPS	FEATURES
1	1-W-4	3	
2	2-W-4	3	●■
1	1-N-6	2	
2	2-N-6	3	
1	3-N-6	4	
2	4-N-6	2	▲
1	1-E-8	3	
2	2-E-8	3	
1	3-E-8	2	▲
2	BLANK		
1	1-S-2	2	●■
2	2-S-2	3	
1	3-S-2	2	
2	4-S-2	1	▲

● Sampling
 ■ Call-Hold (Extension)
 ▲ Delay Information in Detector Schedule is for assignment only.

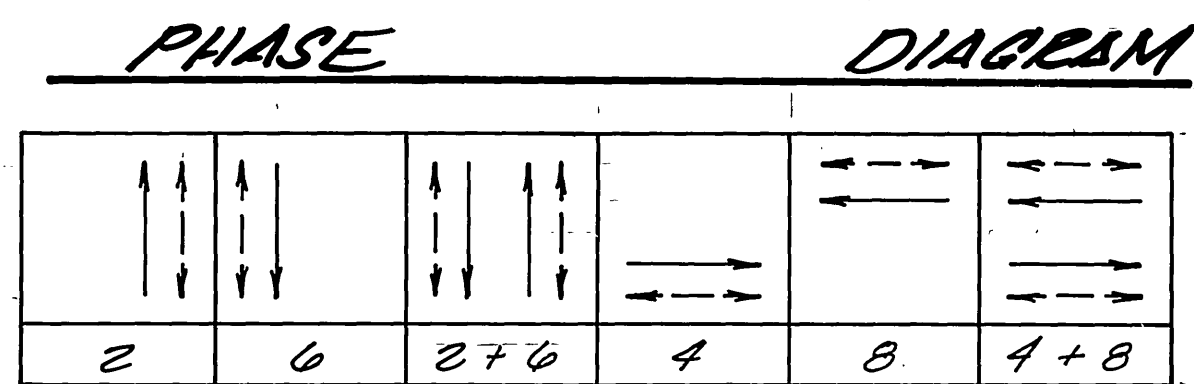

Flashing indication: All Red

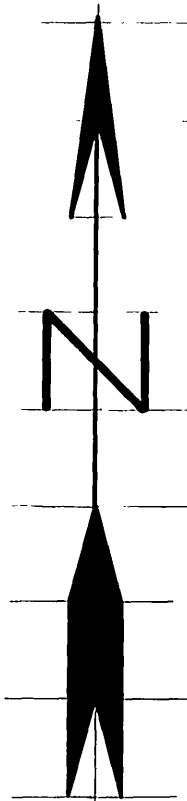

EQUIPMENT SCHEDULE										
LOCATION	STANDARD	VEHICLE HEADS			PEDESTRIAN HEADS			LUMINAIRE WATTAGE	INT ILLUM STREET NAME SIGN	REMARKS
		HEAD	MOUNTING	BACK PLATE	HEAD	MOUNTING	PPB			
A	19-2-80 12/14, 385A	1W3C	MAS	SV-I-T	1W2C	SP-I-T	1	200W	LINDEN 1850	
B	1A(10)	1W3C	TV-I-T	1	1W2C	SP-I-T	1			
C	19-2-80 12/14, 385A	1W3C	MAS	SV-I-T	1W2C	SP-I-T	1	250W	CHICAGO 3500	
D	1A(10)	1W3C	TV-I	1	1W2C	SP-I-T	1			
E	17-2-80 12/14, 385A	1W3C	MAS	SV-I-T	1W2C	SP-I-T	1	250W	LINDEN 1700	
F	1A(7)				1W2C	TP-I-T	1			
G	17-2-80 12/14, 385A	1W3C	MAS	SV-I-T	1W2C	SP-I-T	1	250W	CHICAGO 3500	
H	1A(10)	1W3C	TV-I-T	1	1W2C	SP-I-T	1			

Notes:
 1. All standards, including anchor bolts, shall be City furnished.
 2. Luminaires shall be High Pressure Sodium Vapor.
 3. All vehicular heads shall have 12" lenses.
 4. Left turn head shall have all arrows.
 5. On each pedestrian head an Audible Pedestrian Signal shall be installed. See Special Provisions for details.

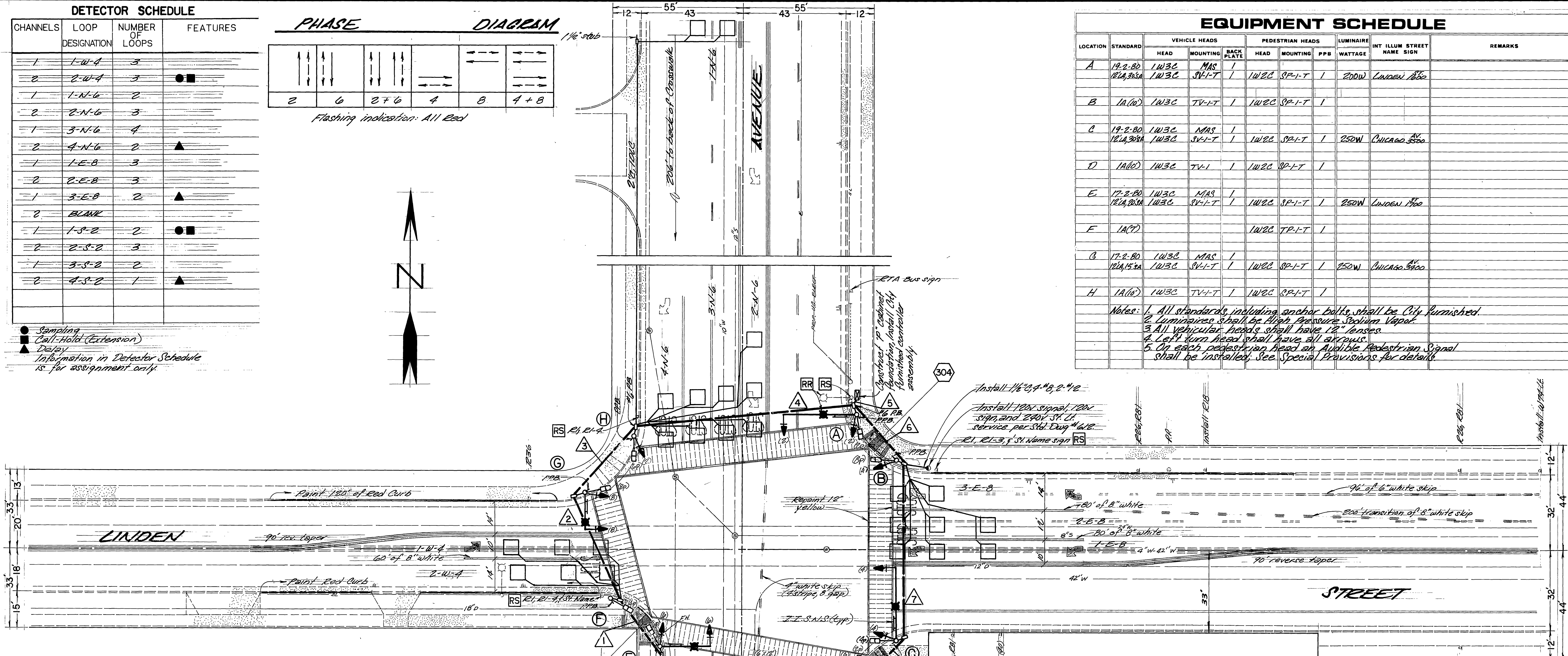

CONDUCTOR SCHEDULE																					
CONTROL FUNCTION	CONDUCTORS	CONDUIT RUN																			
		1	2	3	4	5	6	7	8	9	10	11	12	13	14	15	16	17	18	19	20
Veh. Heads #2	#12 TW				3	6															
Ped. Heads #2	#12 TW	3	3	3	3	3	3	3	3	3	3	3	3	3	3	3	3	3	3	3	3
Ped. Push Button #2	#12 TW																				
Veh Common Spares	#12 PE	3	3	3	3	3	3	3	3	3	3	3	3	3	3	3	3	3	3	3	3
Detectors #2	#12 PE	1	1	1	1	1	1	1	1	1	1	1	1	1	1	1	1	1	1	1	1
T.T.S.A.S. #12	TW	2	2	2	2	2	2	2	2	2	2	2	2	2	2	2	2	2	2	2	2
Luminaires #8	TW	2	2	2	2	2	2	2	2	2	2	2	2	2	2	2	2	2	2	2	2
Signal Service #8	TW	2	2	2	2	2	2	2	2	2	2	2	2	2	2	2	2	2	2	2	2
Totals	#12 TW	10	13	13	13	13	13	13	13	13	13	13	13	13	13	13	13	13	13	13	13
#12 PE		1	1	1	1	1	1	1	1	1	1	1	1	1	1	1	1	1	1	1	1
#12 TW		2	2	2	2	2	2	2	2	2	2	2	2	2	2	2	2	2	2	2	2
#12 PE		2	2	2	2	2	2	2	2	2	2	2	2	2	2	2	2	2	2	2	2

CONSTRUCTION NOTES & LEGEND

1. Detector loops shall be installed in the presence of the Traffic Engineer or his representative.
 2. All signs, striping, and pavement marking requirements must be completed at least 1 day prior to turn-on.
 3. Install pull rope in advance detector conduit.
 4. High Visibility Crosswalks shall be removed as indicated. The Contractor shall repaint all borders as shown.
- 304 Construct Wheelchair Ramp per Std. Dwg. No. 304.
 304 Construct Modified Wheelchair Ramp as shown and as directed in the field.

STRIPING & PAVEMENT MARKINGS LEGEND

- New striping and/or pavement markings to be installed.
- - - Existing striping and/or pavement markings to remain.
- Existing striping and/or pavement markings to be removed.

QUANTITIES

- Removals:
- Installations:

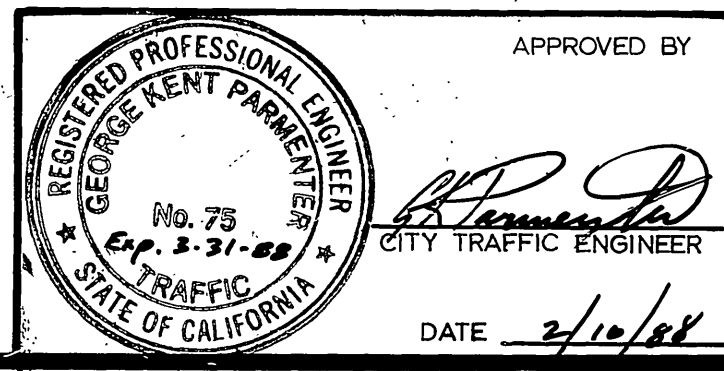

CITY OF RIVERSIDE, CALIFORNIA PUBLIC WORKS DEPARTMENT		TRAFFIC SIGNALS CHICAGO AVENUE AT LINDEN STREET		ACCOUNT No. 30-576-346-02 DRAWING NUMBER X-435 SHEET 2 OF 2
APPROVED BY PRINCIPAL ENGINEER TRAFFIC DIVISION CHIEF PUB. WKS. ENGR.	DATE 2-16-88	APPROVED BY DIRECTOR OF PUBLIC WORKS	DATE 2-16-88	SCALE: 1" = 20'
MARK	REVISIONS	APP'R. DATE	DESIGNED BY: [Signature]	DRAWN BY: [Signature]