

PAVEMENT DELINEATION

- INDICATES STRIPING AND PAVEMENT MARKINGS TO BE INSTALLED.
 - INDICATES STRIPING AND PAVEMENT MARKINGS TO REMAIN.
 - INDICATES STRIPING AND PAVEMENT MARKINGS TO BE REMOVED.
- NOTE: CITY OR ROHR INDUSTRIES FORCES TO PERFORM ALL PAVEMENT DELINEATION WORK.

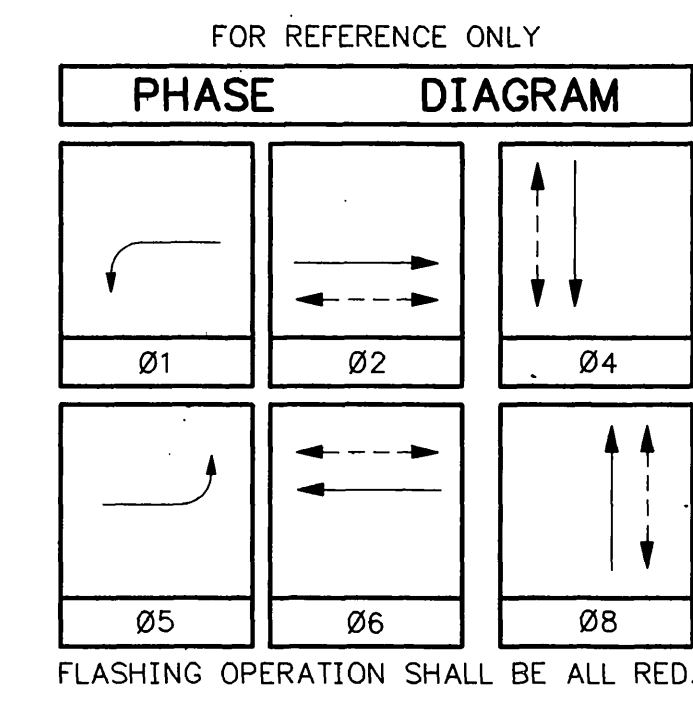

FOR REFERENCE ONLY

DETECTOR SCHEDULE			
CHANNELS	LOOP DESIGNATION	NUMBER OF LOOPS	FEATURES
1	2I2U	2	● ■
2	2I4U	4	★
1	5J1U	3	
2	4I6U	3	
1	4I6L	3	
2	6J2U	2	● ■
1	6J4U	4	★
2	6J4L	2	▲
1	1I1U	3	
2	8J6U	3	
1	8J6L	3	
2	8J7U	3	▲

- Sampling (future)
 - Call-hold (extension)
 - ★ Detector disconnect (see Special Provisions)
 - ▲ Delay
- Detectors shall be 2-channel rack-mounted.
 - Detector timing features shall be accomplished thru internal logic of the controller.
 - Detector loops with special features shall also detect for normal operation.

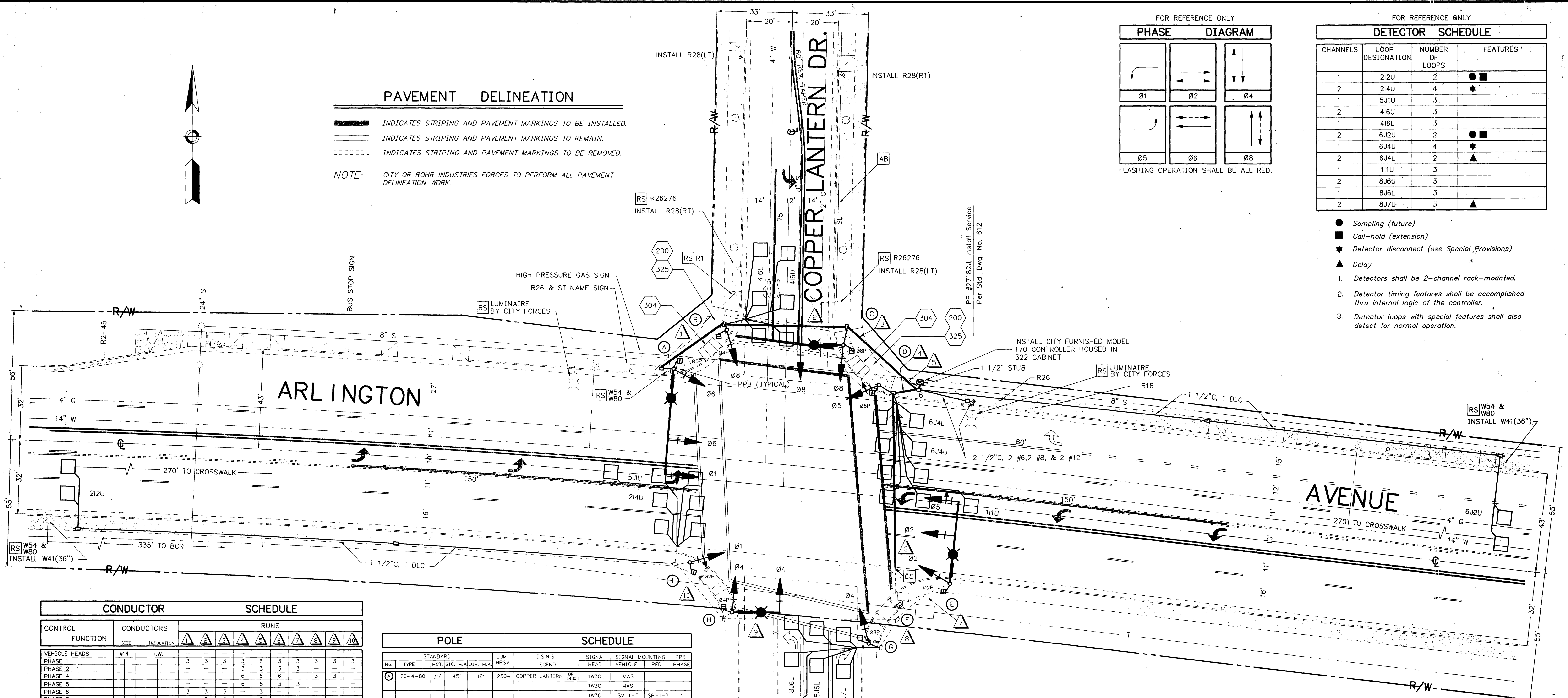

CONDUCTOR		SCHEDULE										
CONTROL FUNCTION	CONDUCTORS	RUNS										
	SIZE	INSULATION	1	2	3	4	5	6	7	8	9	10
VEHICLE HEADS	#14	T.W.	3	3	3	3	6	3	3	3	3	3
PHASE 1			3	3	3	3	3	3	3	3	3	3
PHASE 2			3	3	3	3	3	3	3	3	3	3
PHASE 4			6	6	6	6	3	3	3	3	3	3
PHASE 5			6	6	6	6	3	3	3	3	3	3
PHASE 6			3	3	3	3	3	3	3	3	3	3
PHASE 8			3	6	6	6	6	3	3	3	3	3
PED. HEADS												
PHASE 2			4	4	4	4	2	2	2	2	2	2
PHASE 4			2	2	2	2	4	2	2	2	2	2
PHASE 6			2	2	2	2	4	2	2	2	2	2
PHASE 8			2	2	2	2	4	2	2	2	2	2
PED. PUSH BUTTON												
PHASE 2			2	2	2	2	2	1	1	1	1	1
PHASE 4			1	1	1	1	2	1	1	1	1	1
PHASE 6			1	1	1	1	2	1	1	1	1	1
PHASE 8			2	2	2	2	1	1	1	1	1	1
SPARES			3	6	9	15	24	12	3	3	6	3
12V COMMON			1	2	3	5	8	4	1	1	2	1
DETECTORS	#16/2	P.E.										
PHASE 1			1	1	1	1	1	1	1	1	1	1
PHASE 2			2	2	2	2	2	2	2	2	2	2
PHASE 4			2	2	2	2	2	2	2	2	2	2
PHASE 5			1	1	1	1	1	1	1	1	1	1
PHASE 6			2	2	2	2	2	2	2	2	2	2
PHASE 8			3	3	3	3	3	3	3	3	3	3
I.T.S.N.S.	#12	T.W.	2	2	2	2	2	2	2	2	2	2
120V COMMON	#10	T.W.	1	2	3	5	8	4	1	1	2	1
LUMINAIRES	#8	T.H.W.	2	2	2	2	2	2	2	2	2	2
SIGNAL SERVICE	#8	T.H.W.										
INTERCONNECT	#19/2	P.E.										
TOTAL	#14	T.W.	13	23	35	51	86	43	15	13	20	10
	#12	T.W.	2	2	2	2	2	2	2	2	2	2
	#10	T.W.	1	2	3	5	8	4	1	1	2	1
	#8	T.H.W.	2	2	2	2	2	2	2	2	2	2
	#6	T.H.W.	2	2	2	2	2	2	2	2	2	2
	#6	T.H.W.	2	2	2	2	2	2	2	2	2	2
	#16/2	P.E.	2	5	9	9	6	6	3	3	3	3
#14 EQUIV.			14.5	39	61.5	92.5	133	74	23.5	23.5	39	20.5
CONDUIT SIZE			2"	2 1/2"	3"	3 1/2"	4"	3"	2"	2"	3"	2"

POLE		SCHEDULE												
No.	TYPE	STANDARD	HGT	SIG.	M.A.	LUM.	M.A.	LUM.	M.A.	I.S.N.S. LEGEND	SIGNAL HEAD	SIGNAL MOUNTING VEHICLE	PED	PPB PHASE
A	26-4-80	30'	45'	12"	250w	COPPER LANTERN DR 6400					1W3C	MAS		
B	1-A	10'									1W3C	MAS		
C	17-2-80	30'	18"	12"	250w	ARLINGTON AV 8100					1W3C	SV-1-T	SP-1-T	4
D	1-A	10'									1W3C	TV-1-T	SP-1-T	6
E	24-4-80	30'	35'	12"	250w	COPPER LANTERN DR 6400					1W3C	MAS		
F	17-2-80	30'	20"	12"	250w	ARLINGTON AV 8100					1W3C	MAS		
G	1-A	10'									1W3C	SV-1-T	SP-1-T	2
H	1-A	10'									1W3C	TV-1-T	SP-1-T	4

- NOTE:
- ALL VEHICULAR HEADS SHALL HAVE 12" LENSES
 - LUMINAIRES SHALL BE HIGH PRESSURE SODIUM VAPOR
 - ALL POLES SHALL BE CITY FURNISHED
 - PEDESTRIAN PUSH BUTTONS SHALL BE INSTALLED ON POLE QUADRANT AS SHOWN
 - FOUNDATIONS EXIST AT LOCATIONS E THRU I.

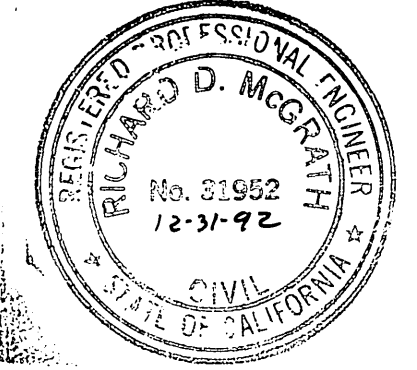

CONSTRUCTION NOTES AND LEGEND

- 200 Constructed curb and gutter as required per std. Dwg. No. 200.
- 304 Construct wheelchair ramp per std. Dwg. No. 304.
- 325 Close existing wheelchair ramps and construct PCC sidewalk per std. Dwg. No. 325.
- 1 Install w41(36") sign and post on Copper Lantern per std. Dwg. No. 666; exact location to be determined in field.

GENERAL NOTES

- DETECTOR LOOPS SHALL BE INSTALLED IN THE PRESENCE OF THE TRAFFIC ENGINEER OR HIS REPRESENTATIVE.
- ALL SIGNING, STRIPING AND PAVEMENT DELINEATION REQUIREMENTS SHALL BE COMPLETED AT LEAST ONE DAY PRIOR TO TURN-ON. SEE SPECIAL PROVISIONS REGARDING STRIPING AND PAVEMENT DELINEATION. ALSO SEE ABOVE LEGEND.
- TYPICAL DETECTOR LOOP SPACING: 10' AND 15'.
- LAWN SPRINKLERS EXIST IN THE PARKWAY AND BEHIND THE SIDEWALK; SEE SPECIAL PROVISIONS.

I.M.S.A. CABLE IS REQUIRED (SEE SPECIAL PROVISIONS)

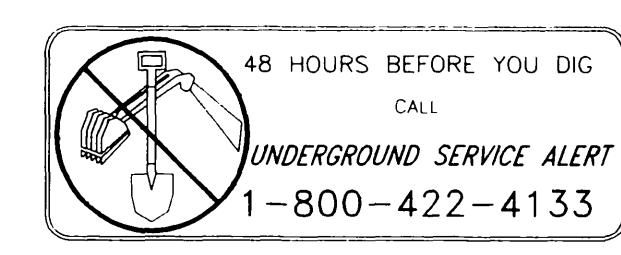

ENGINEER IN RESPONSIBLE CHARGE
 Richard D. McGrath
 RICHARD D. MCGRATH
 R.C.E. No. 31952 expires 12-31-92
 DATE 5/29/92

DESIGNED BY BRM DRAWN BY BDM CHECKED BY [Signature]

CITY OF RIVERSIDE, CALIFORNIA
 DEPARTMENT OF PUBLIC WORKS
 APPROVED BY [Signature] DATE 5/29/92
 P.W. INSPECTION [Signature] DATE 5/29/92
 TRAFFIC DIVISION [Signature] DATE 5/29/92
 PUBLIC UTILITIES [Signature] DATE 5/29/92

TRAFFIC SIGNALS
 ARLINGTON AVENUE AND COPPER LANTERN DR.
 HORIZ. SCALE: 1" = 20'

ACCT. NO. 30-576-335-30
 X-444
 SHEET 1 OF 1
 FILE NO.

CONTRACT TE-92-1