

FLASHING OPERATION SHALL BE ALL RED.

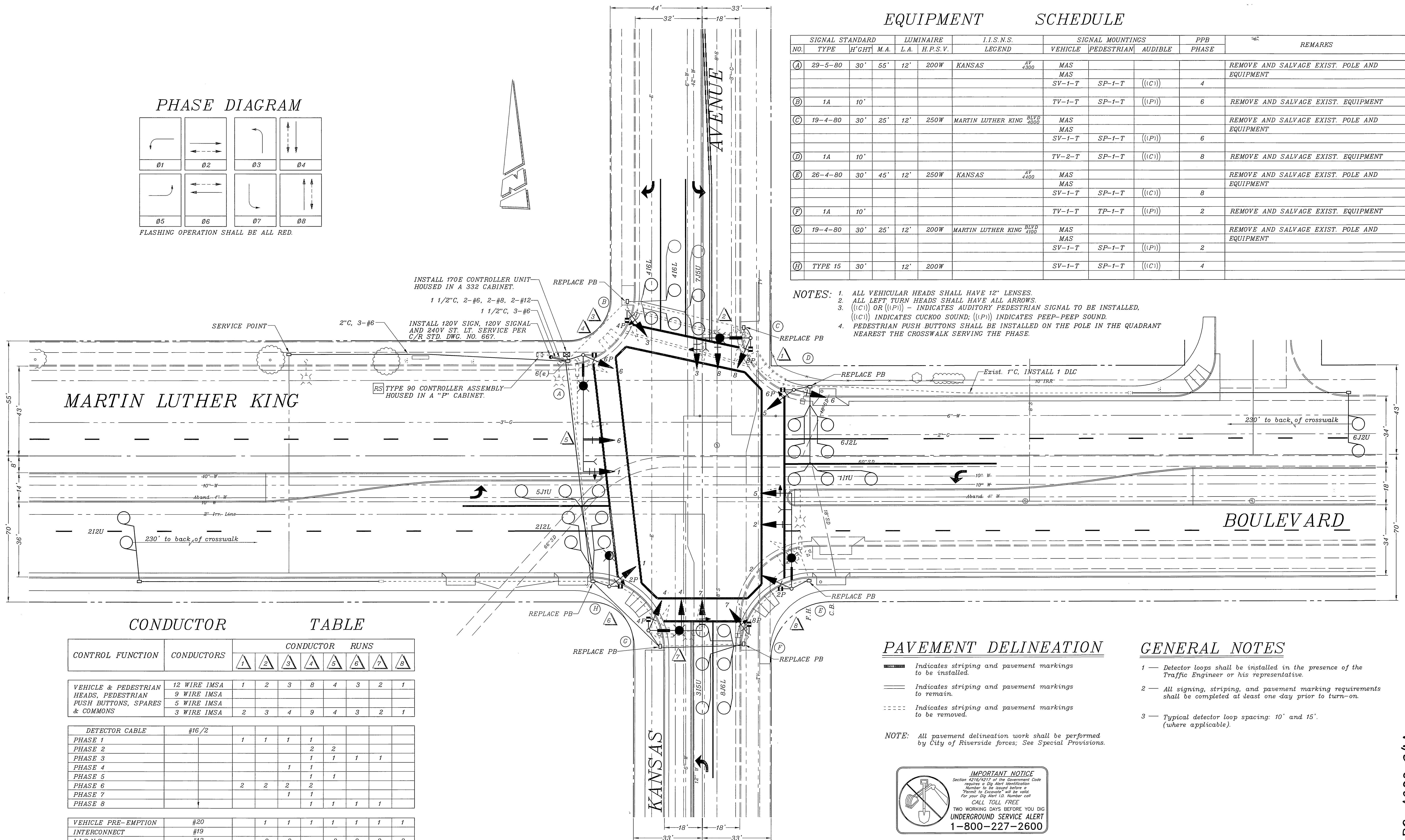

EQUIPMENT SCHEDULE

SIGNAL STANDARD NO.	TYPE	H'GHT	M.A.	L.A.	H.P.S.V.	I.I.S.N.S. LEGEND	SIGNAL MOUNTINGS			PPB PHASE	REMARKS
							VEHICLE	PEDESTRIAN	AUDIBLE		
(A)	29-5-80	30'	55'	12'	200W	KANSAS	MAS				REMOVE AND SALVAGE EXIST. POLE AND EQUIPMENT
							MAS				
							SV-1-T	SP-1-T	((C1))	4	
(B)	1A	10'					TV-1-T	SP-1-T	((P1))	6	REMOVE AND SALVAGE EXIST. EQUIPMENT
(C)	19-4-80	30'	25'	12'	250W	MARTIN LUTHER KING BLVD	MAS				REMOVE AND SALVAGE EXIST. POLE AND EQUIPMENT
							MAS				
							SV-1-T	SP-1-T	((P1))	6	
(D)	1A	10'					TV-2-T	SP-1-T	((C1))	8	REMOVE AND SALVAGE EXIST. EQUIPMENT
(E)	26-4-80	30'	45'	12'	250W	KANSAS	MAS				REMOVE AND SALVAGE EXIST. POLE AND EQUIPMENT
							MAS				
							SV-1-T	SP-1-T	((C1))	8	
(F)	1A	10'					TV-1-T	TP-1-T	((P1))	2	REMOVE AND SALVAGE EXIST. EQUIPMENT
(G)	19-4-80	30'	25'	12'	200W	MARTIN LUTHER KING BLVD	MAS				REMOVE AND SALVAGE EXIST. POLE AND EQUIPMENT
							MAS				
							SV-1-T	SP-1-T	((P1))	2	
(H)	TYPE 15	30'		12'	200W		SV-1-T	SP-1-T	((C1))	4	

- NOTES:
- ALL VEHICULAR HEADS SHALL HAVE 12" LENSES.
 - ALL LEFT TURN HEADS SHALL HAVE ALL ARROWS.
 - ((C1)) OR ((P1)) - INDICATES AUDITORY PEDESTRIAN SIGNAL TO BE INSTALLED.
 - ((C1)) INDICATES CUCKOO SOUND; ((P1)) INDICATES PEEP-PEEP SOUND.
 - PEDESTRIAN PUSH BUTTONS SHALL BE INSTALLED ON THE POLE IN THE QUADRANT NEAREST THE CROSSWALK SERVING THE PHASE.

CONDUCTOR TABLE

CONTROL FUNCTION	CONDUCTORS	CONDUCTOR RUNS							
		1	2	3	4	5	6	7	8
VEHICLE & PEDESTRIAN HEADS, PEDESTRIAN PUSH BUTTONS, SPARES & COMMONS	12 WIRE IMSA	1	2	3	8	4	3	2	1
	9 WIRE IMSA								
	5 WIRE IMSA								
	3 WIRE IMSA	2	3	4	9	4	3	2	1
DETECTOR CABLE	#16/2								
PHASE 1		1	1	1	1				
PHASE 2					2	2			
PHASE 3					1	1	1	1	
PHASE 4					1				
PHASE 5					1	1			
PHASE 6		2	2	2	2				
PHASE 7				1	1				
PHASE 8				1	1	1	1		
VEHICLE PRE-EMPTION	#20		1	1	1	1	1	1	1
INTERCONNECT	#19								
I.I.S.N.S.	#12		2	2		2	2	2	2
LUMINAIRES	#8		2	2		2	2	2	2
SIGNAL SERVICE	#6				2				

CONDUIT SIZE	2"	2.5"	2.5"	2-3"	3"	3"	3"	2"
	(E)	(E)	(E)					(E)

NOTE: SIGNAL SYSTEM SHALL HAVE NEW CABLE AND CONDUCTORS.

PAVEMENT DELINEATION

- Indicates striping and pavement markings to be installed.
- Indicates striping and pavement markings to remain.
- Indicates striping and pavement markings to be removed.

NOTE: All pavement delineation work shall be performed by City of Riverside forces; See Special Provisions.

GENERAL NOTES

- Detector loops shall be installed in the presence of the Traffic Engineer or his representative.
- All signing, striping, and pavement marking requirements shall be completed at least one day prior to turn-on.
- Typical detector loop spacing: 10' and 15' (where applicable).

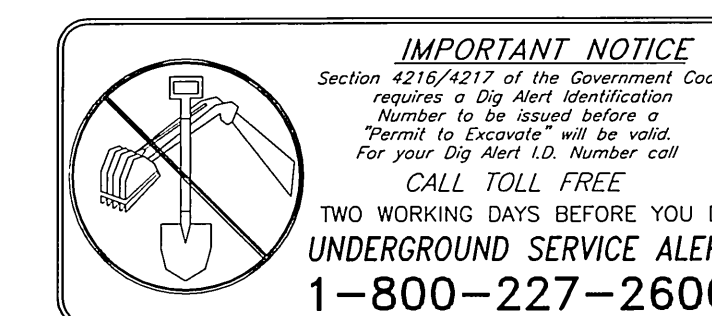

ENGINEER IN RESPONSIBLE CHARGE
THOMAS JOHN BOYD
R.C.E. No. 36179 expires 6/30/00
DATE 5/25/00

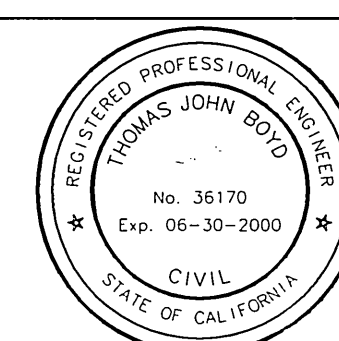

MARK	REVISIONS	APPR	DATE

CITY OF RIVERSIDE, CALIFORNIA DEPARTMENT OF PUBLIC WORKS			
APPROVED BY	BY	DATE	APPROVED BY
ENGINEERING MANAGER	DRB	5/25/00	R. Mc Brath
PRINCIPAL ENGINEER			DIRECTOR OF PUBLIC WORKS
P.W. INSPECTION			
TRAFFIC DIVISION			
PUBLIC UTILITIES			

TRAFFIC SIGNAL MODIFICATION		ACCT. NO.
MARTIN LUTHER KING BOULEVARD AT KANSAS AVENUE		9535330214-44030200
X-452A		
SHEET 1 OF 1		
SCALE: 1" = 20'		FILE NAME: X452A.DWG

INOKRED 6/20/2001 GH

PC-4289-S/M

PHASE DIAGRAM

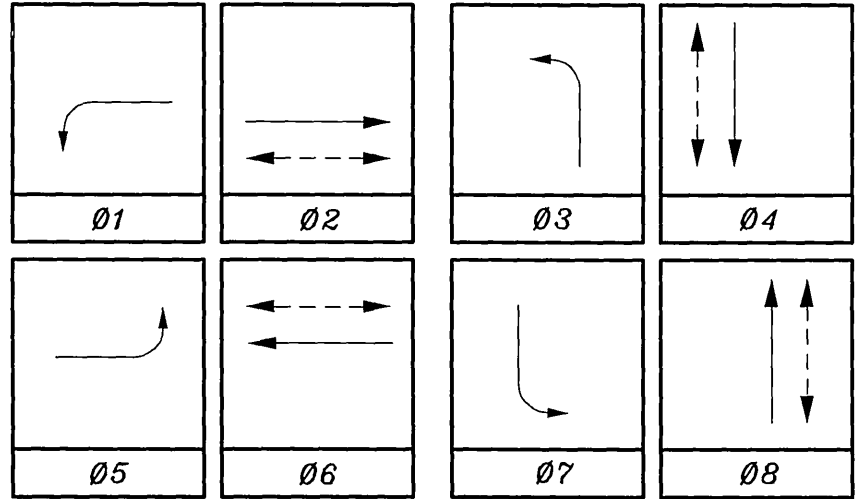

FLASHING OPERATION SHALL BE ALL RED.

EQUIPMENT SCHEDULE

NO.	SIGNAL STANDARD			LUMINAIRE		I.I.S.N.S. LEGEND	SIGNAL MOUNTINGS			PPB PHASE
	TYPE	H'GHT	M.A.	L.A.	H.P.S.V.		VEHICLE	PEDESTRIAN	AUDIBLE	
A	29-5-80	30'	55'	12'	200W	KANSAS	MAS			
							MAS			
							SV-1-T	SP-1-T	((C))	4
B	1A	10'					TV-1-T	SP-1-T	((P))	6
C	19-4-80	30'	25'	12'	250W	MARTIN LUTHER KING BLVD	MAS			
							MAS			
							SV-1-T	SP-1-T	((P))	6
D	1A	10'					TV-2-T	SP-1-T	((C))	8
E	26-4-80	30'	45'	12'	250W	KANSAS	MAS			
							MAS			
							SV-1-T	SP-1-T	((C))	8
F	1A	10'					TV-1-T	TP-1-T	((P))	2
G	19-4-80	30'	25'	12'	200W	MARTIN LUTHER KING BLVD	MAS			
							MAS			
							SV-1-T	SP-1-T	((P))	2
H	TYPE 15	30'		12'	200W		SV-1-T	SP-1-T	((C))	4

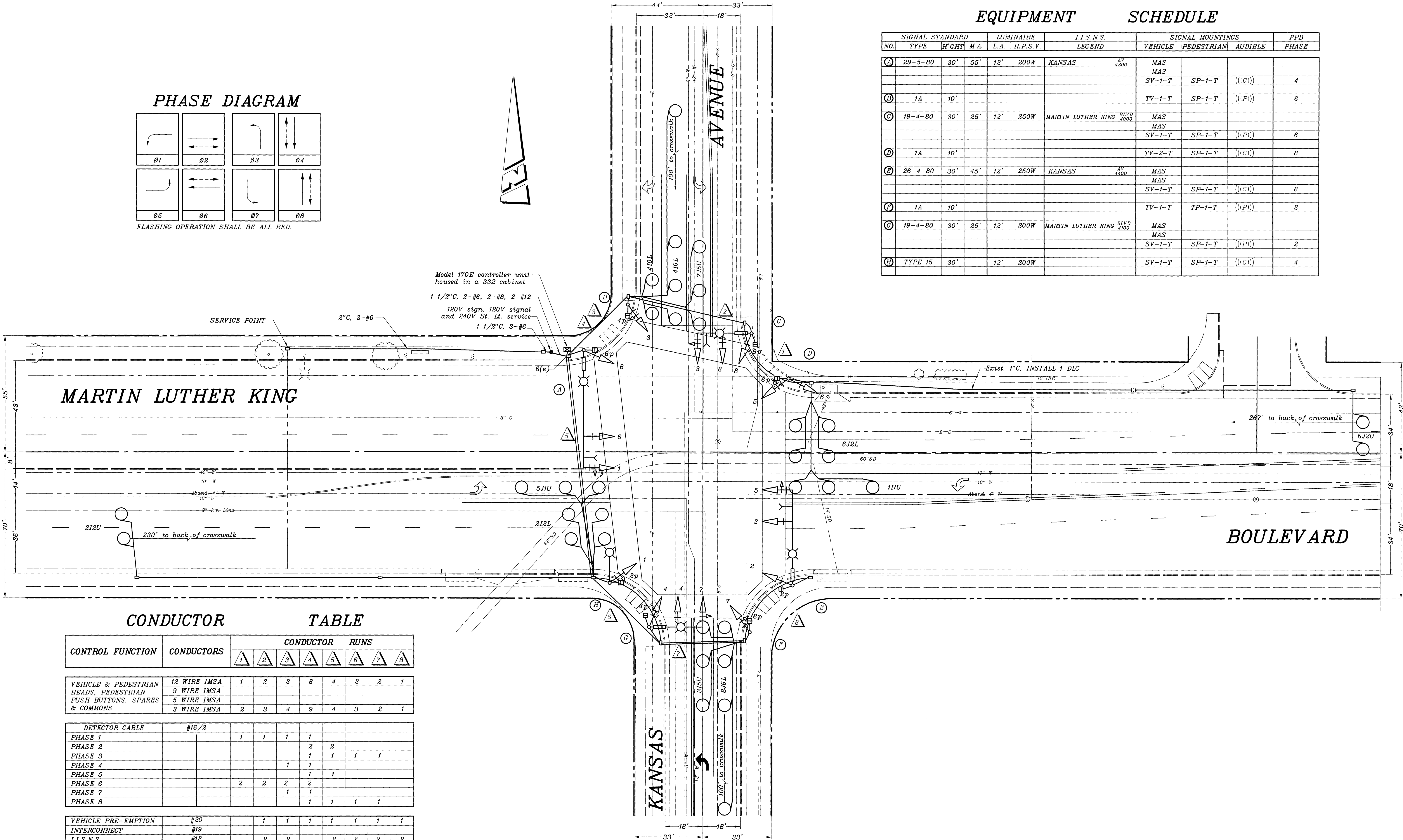

CONDUCTOR TABLE

CONTROL FUNCTION	CONDUCTORS	CONDUCTOR RUNS							
		1	2	3	4	5	6	7	8
VEHICLE & PEDESTRIAN HEADS, PEDESTRIAN PUSH BUTTONS, SPARES & COMMONS	12 WIRE IMSA	1	2	3	8	4	3	2	1
	9 WIRE IMSA								
	5 WIRE IMSA								
	3 WIRE IMSA	2	3	4	9	4	3	2	1
DETECTOR CABLE		#16/2							
PHASE 1		1	1	1	1				
PHASE 2					2	2			
PHASE 3					1	1	1	1	
PHASE 4					1				
PHASE 5					1	1			
PHASE 6		2	2	2	2				
PHASE 7				1	1				
PHASE 8					1	1	1	1	
VEHICLE PRE-EMPTION INTERCONNECT		#20							
I.I.S.N.S.		#19							
LUMINAIRES		#12							
SIGNAL SERVICE		#8							
CONDUIT SIZE		2"	2.5"	2.5"	2-3"	3"	3"	3"	2"

CITY OF RIVERSIDE, CALIFORNIA DEPARTMENT OF PUBLIC WORKS				TRAFFIC SIGNAL		ACCT. NO.
APPROVED BY _____ BY _____ DATE _____				APPROVED BY _____		X-452
AS-BUILT PER ST. IMPROV. _____ MAC 8/04				DIRECTOR OF PUBLIC WORKS		
AS-BUILT PER CONTRACT TE-76-4 _____ JS 8/77						SHEET 1 OF 1
MARK _____ REVISIONS _____ APPR _____ DATE _____						
DESIGNED BY _____ MAC _____ DRAWN BY _____ MAC _____ CHECKED BY _____				TRAFFIC DIVISION PUBLIC UTILITIES		FILE NAME: X452AS.DWG

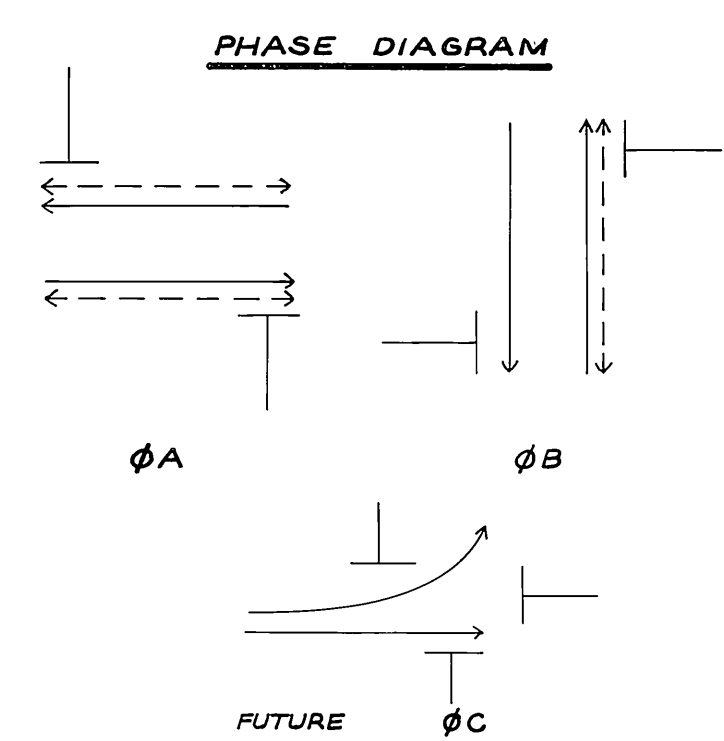
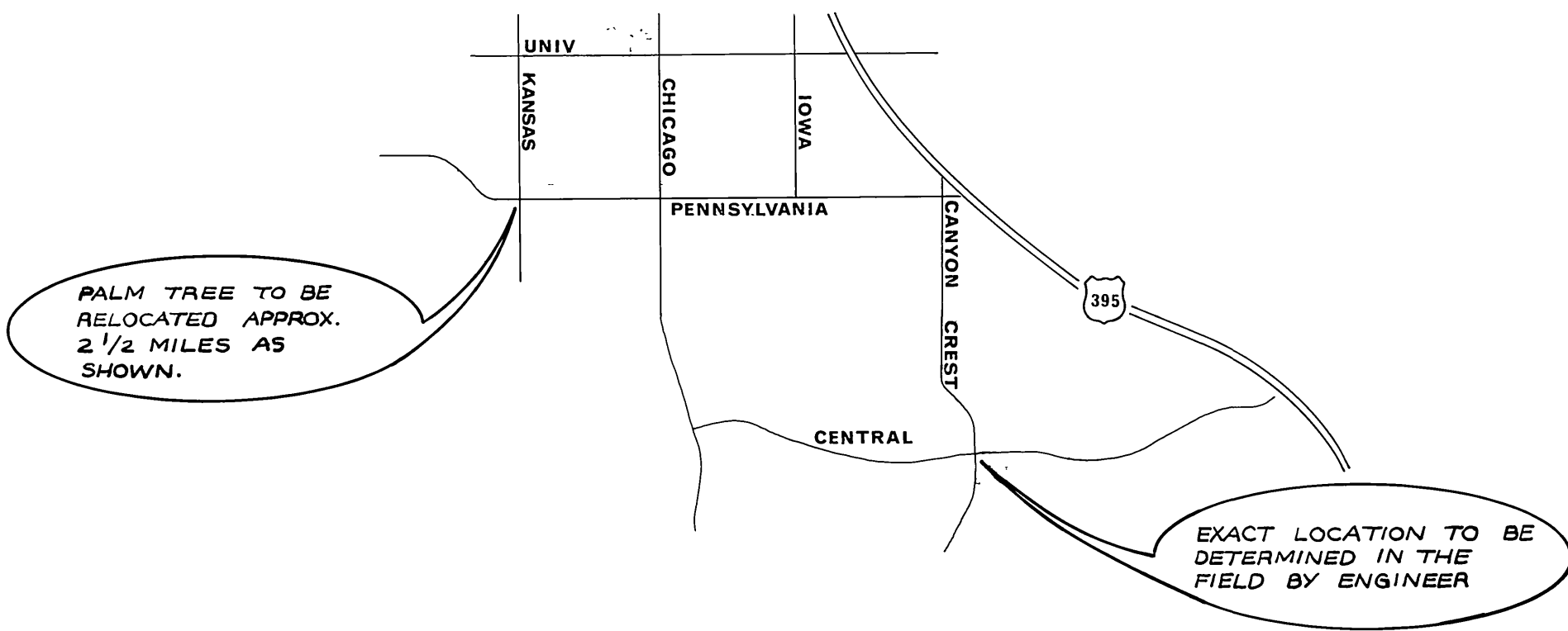

FLASHING INDICATIONS: ALL RED
ΦA - TYPE "DP" MODULES
ΦB - TYPE "SP" MODULES

TYPE 90 CONTROLLER
HOUSED IN "M" CABINET

PP# 774803 H;
120 V SIGNAL AND SIGN
SERVICE AND 240 V ST. NAME
SERVICE PER STD. DRAWINGS
NO. 612 A AND 669

#6 PULLBOX
(SEE NOTE 2)

INTERNALLY
ILLUMINATED
ST. NAME SIGN

AVENUE

Kansas Ave

4400

TYPICAL SIGN LAYOUT
(FOR INTERNALLY ILLUMINATED STREET NAME SIGNS)
SCALE 1" = 5'

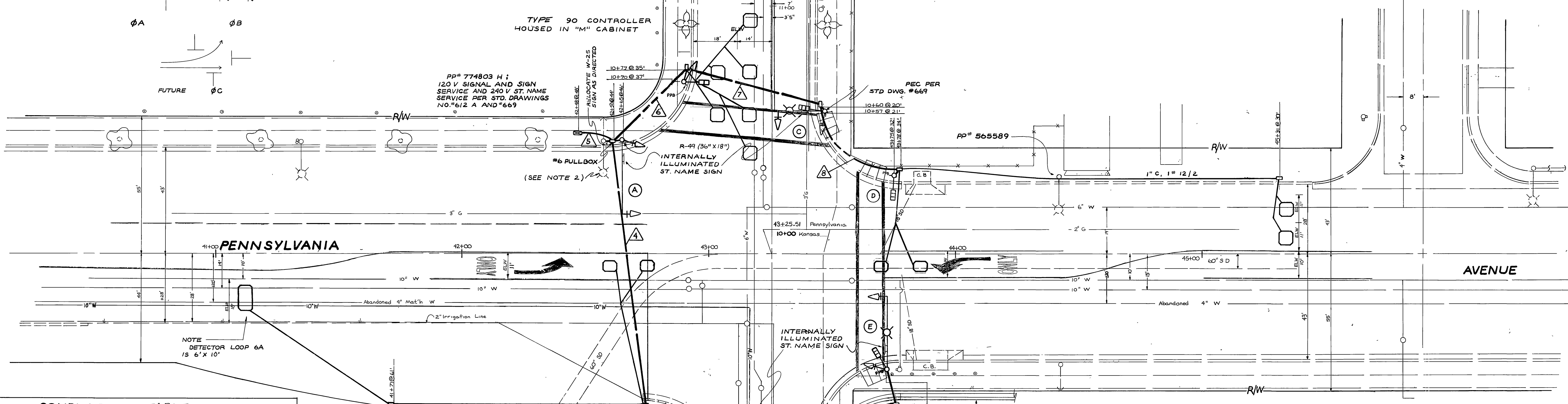

NOTE
DETECTOR LOOP 6A
IS 6' X 10'

FUTURE CURB AND GUTTER
NOTE:
5' X 10' LOOPS IN LEFT TURN LANES

CONDUCTOR TABLE		RUNS							
AWG	CIRCUIT	1	2	3	4	5	6	7	8
#14	ΦA	3	3	3	3	3	3	3	3
UF	ΦB	3	3	3	3	6	3	3	3
	ΦC (FUTURE)	3	3	3	3	6	3	3	3
	ΦAW		2	2	2	4	2	2	
	ΦBW	2	2	2	2	4	2	2	2
	ΦA PPB		1	2	2	4	2	1	
	ΦB PPB	1	1	1	2	4	1	1	1
	12 V COMMON	1	1	1	1	2	1	1	1
	SPARES	3	3	3	3	6	3	3	3
	TOTALS	13	19	20	21	39	17	16	10
#12	FUT. DET. CABLE				1	2	1	1	1
	ΦA DET. CABLE				2	4	2	2	2
PE	ΦB DET. CABLE	1	1	1	2	1			
	TOTALS	1	1	4	8	4	3	3	
#12	ILLUM. SIGN	2	2	2	2		4	4	
UF	TOTAL	2	2	2	2		4	4	
#10	120 V COMMON	1	1	1	1	2	1	1	1
UF	TOTAL	1	1	1	1	2	1	1	1
#8	SIGNAL SERVICE					2			
THW	LUMINAIRE	2	2	2	2		2	2	
	TOTALS	2	2	2	2	2	2	2	
	CONDUIT SIZE	2"	2"	2"	2 1/2"	3 1/2"	2 1/2"	2 1/2"	2"

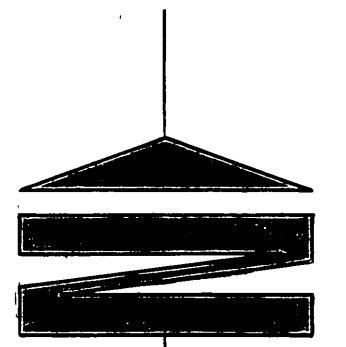

PP# 18647 J

TYPE L MARKERS

POLE		SCHEDULE							
STANDARD		LUMINAIRE		I.S. N.S. LEGEND		SIGNAL MTG		PPB	
NO.	TYPE	HEIGHT	SIG. M.A.	LUM. M.A.		VEHICLE	PED	TYPE	PHASE
(A)	18 (Special)	17'-0"	30'-0"		KANSAS AVE 4400	MAS	SV-I-T		
(B)	1A	10'-0"				TV-I-T	SP-I-T	B	A
(C)	17A-S	35'-9"	20'-0"	15'-0"	400W H.P.S. PENNSYLVANIA AVE 2000	MAS	SV-I-T	SP-I-T	B A
(D)	1A	10'-0"					SP-I-T	B	B
(E)	19A-S	35'-9"	30'-0"	15'-0"	400W H.P.S. KANSAS AVE 2500	MAS	SV-I-T	SP-I-T	B B
(F)	1A	10'-0"				TV-I-T	SP-I-T	B	A
(G)	17A-S	35'-9"	20'-0"	15'-0"	400W H.P.S. PENNSYLVANIA AVE 2000	MAS	SV-I-T	SP-I-T	B A

- NOTE:
1) ALL TYPE 1A STANDARDS ARE ALUMINUM
2) PP# 774803 - 400 W H.P.S. LUMINAIRE.
3) TYPE 18 (SPECIAL) SHALL BE MANUFACTURED TO ACCOMMODATE INTERNALLY ILLUMINATED STREET NAME SIGN.
4) LOCATION (C) AND (E) - ALL VEHICULAR INDICATIONS SHALL HAVE 12" LENS; ALL MAST ARM INDICATIONS SHALL HAVE 12" LENS.
5) DETECTORS 1B SHALL HAVE AN ADJUSTABLE DELAY TIMER OF 0-30 SECONDS.
1B DETECTORS TO BE SPACED @ 10' INTERVALS IN LIEU OF THAT SHOWN ON PLAN X-501.
6) FOR STREET IMPROVEMENTS THIS PROJECT SEE PLAN R-1912.

Contract TE-76-4

CITY OF RIVERSIDE
PUBLIC WORKS DEPARTMENT

DESIGNED BY: *AS* DRAWN BY: *AS* CHECKED BY: *AS*

APPROVED BY: *AS*
PRINCIPAL ENGINEER
TRAFFIC DIVISION
DATE: 12-6-76

APPROVED BY: *AS*
PUBLIC WORKS DIRECTOR
DATE: 12-6-76

TRAFFIC SIGNALS
Pennsylvania Avenue
and
Kansas Avenue

ACCOUNT NO. 15-550-463
X-452
SHEET 2 OF 2
FILE NO.