

CONDUCTOR TABLE

CONTROL FUNCTION	CONDUCTORS	CONDUCTOR RUNS								
		1	2	3	4	5	6	7	8	9
VEHICLE & PEDESTRIAN HEADS, PEDESTRIAN PUSH BUTTONS, SPARES & COMMONS	12 WIRE IMSA	1	2	3	8	5	4	3	2	1
	9 WIRE IMSA									
	5 WIRE IMSA									
DETECTOR CABLE	#16/2									
PHASE 1		1	1	1	1					
PHASE 2					3	3	3			
PHASE 3 (FUTURE)										
PHASE 4				3	3					
PHASE 5					1	1	1			
PHASE 6		3	3	3	3					
PHASE 7 (FUTURE)										
PHASE 8 (FUTURE)										
PRIORITY PRE-EMPT	4#20			1	4	3	1	1		
INTERCONNECT CABLE	#19	1	1	1	1					
I.I.S.N.S.	#12		2	2	2	2	2	2	2	2
LUMINAIRES	#8		2	2	2	2	2	2	2	2
SERVICE	#6			2						
CONDUIT SIZE		3"	3"	3"	2-3"	3"	3"	3"	3"	3"

SEE CONTRACT SPECIAL PROVISIONS FOR ADDITIONAL INFORMATION ON I.M.S.A.

PHASE DIAGRAM

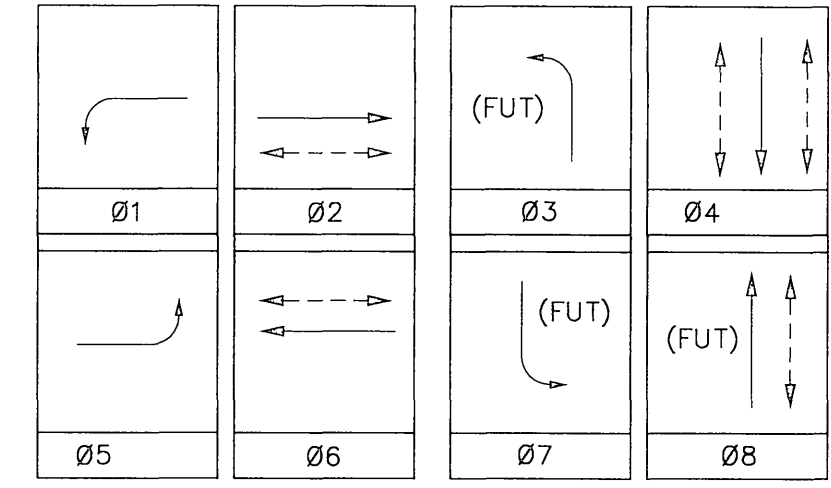

POLE SCHEDULE

NO.	POLE	HEIGHT	MAST ARM LENGTH		SIGNAL MOUNTING			PPB	H.P.S.V. LUMINAIRE	I.I.S.N.S. LEGEND	REMARKS	
			SIGNAL	LUMINAIRE	MA	POLE	PED*					
A	26-4-80	30'	45'	15'	2-MAS	SV-1-T	SP-1-T	4	2	250 W	Pierce St 11800	F=20'
B	1-A	10'	-	-	-	TV-1-T	SP-1-T	6	3			
C	19-4-80	30'	30' (FUT)	15'	-	-	SP-1-T	6	3	250 W	Riverwalk Pkwy 4100 (FUT)	INSTALL WEATHER TIGHT COVER FOR MAST ARM MOUNT.
D	1-A	10'	-	-	-	TV-2-T	SP-1-T	8	4			
E	26-4-80	30'	45'	15'	2-MAS	SV-1-T	SP-1-T	8	4	250 W	Pierce St 11700	F=16'
F	1-A	10'	-	-	-	TV-1-T	SP-1-T	2	1			
G	19-4-80	30'	30'	15'	MAS	SV-1-T	SP-1-T	2	1	250 W	Riverwalk Pkwy 4000	F=15'
H	1-A	10'	-	-	-	TV-2-T	SP-1-T	4	2			
I	1-A	10'	-	-	-	-	-					INSTALL EMERGENCY VEHICLE PRE-EMPTION ON TOP OF POLE

EXACT POLE LOCATION TO BE DETERMINED BY THE ENGINEER IN THE FIELD
 TYPE 1-A SHALL BE SPUN ALUMINUM
 NEW VEHICLE SIGNAL SHALL HAVE 12" LENS (GLASS) AND 12" RED AND GREEN LEDS PER CONTRACT SPECIAL PROVISIONS.

- * INSTALL AUDIBLE PED HEAD
- PEEP-PEEP FOR EAST-WEST DIRECTIONS
- CUCKOO FOR NORTH SOUTH DIRECTIONS

GENERAL NOTES:

- TRAFFIC SIGNAL WORK SHALL CONFORM TO THE PROVISIONS OF SECTION 86 OF THE MOST CURRENT STANDARD SPECIFICATIONS, THE STANDARD PLANS: BOTH PUBLISHED BY CALTRANS APPLICABLE CITY OF RIVERSIDE STANDARD DRAWINGS, AND THE CONTRACT SPECIAL PROVISIONS.
- THIS TRAFFIC SIGNAL WORK REQUIRE A "STREET OPENING PERMIT" OBTAINED AT THE PUBLIC DEPARTMENT'S COUNTER ON THE THIRD FLOOR OF CITY HALL.
- ALL EQUIPMENT AND LOOP LOCATIONS SHALL BE APPROVED BY THE TRAFFIC ENGINEER OR HIS REPRESENTATIVE PRIOR TO INSTALLATION BY CONTRACTOR.
- ALL STRIPING, PAVEMENT MARKINGS AND SIGN REQUIREMENTS (REMOVAL OR INSTALLATIONS) SHALL BE COMPLETED AT LEAST ONE DAY PRIOR TO THE SCHEDULE TURN ON.
- IT SHALL BE THE RESPONSIBILITY OF THE CONTRACTOR TO VERIFY THE EXISTENCE AND LOCATION OF ALL UNDERGROUND UTILITIES, PUBLIC OR PRIVATE, AND TO PROTECT THEM FROM DAMAGE. THE CONTRACTOR SHALL BEAR THE TOTAL EXPENSE OF REPAIR OR REPLACEMENT OF ANY UNDERGROUND FACILITY DAMAGE BY HIS OPERATIONS.
- THE PRIVATE ENGINEER SIGNING THESE PLANS IS RESPONSIBLE FOR ASSURING THE ACCURACY AND ACCEPTABILITY OF THE WORK HEREON. IN THE EVENT OF DISCREPANCIES ARISING DURING CONSTRUCTION, THE PRIVATE ENGINEER SHALL BE RESPONSIBLE FOR DETERMINING AN ACCEPTABLE SOLUTION AND REVISING THESE PLANS FOR APPROVAL OF THE CITY TRAFFIC ENGINEER.
- UNLESS SHOWN OTHERWISE, ALL INDUCTIVE LOOPS SHALL BE 6' ROUND WITH 10', 15' SPACINGS IN THE DIRECTION OF TRAVEL. NECESSARY STRIPING SHALL BE LOCATED PRIOR TO POSITIONING DETECTORS. ALL CONDUIT SIZE SHALL BE 2" MINIMUM UNLESS OTHERWISE NOTED.
- SPLICING OF THE CONDUCTORS IS NOT ALLOWED.
- ALL DETECTOR LOOPS SHALL BE INSTALLED IN THE PRESENCE OF THE CITY TRAFFIC ENGINEER'S INSPECTOR.
- PIPE-TENONS FOR MAST ARM MOUNTINGS SHALL BE PERPENDICULAR TO THE ARM.
- INSPECTION FEE WILL BE AT THE RATE OF \$55.00 PER HOUR.
- FOR ROADWAY CONSTRUCTION DETAILS SEE STREET IMPROVEMENT PLAN R-3516
- FOR SIGNING AND STRIPING DETAILS SEE SIGNING AND STRIPING PLAN XL-441
- CALL (909) 351-6096 AT LEAST 48 HOURS IN ADVANCE FOR INSPECTION.

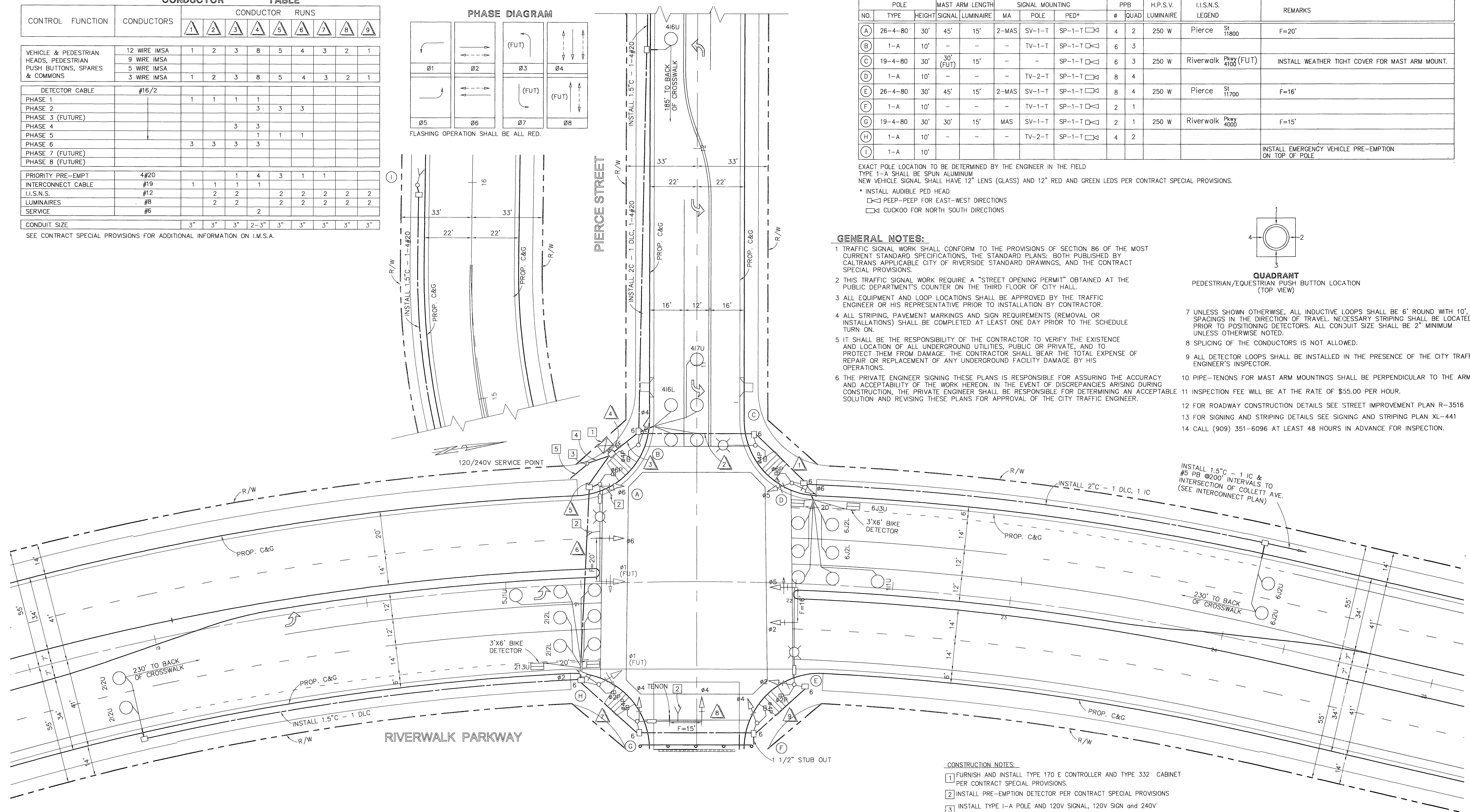
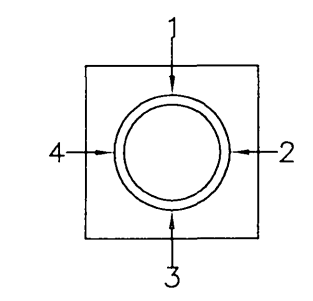

- CONSTRUCTION NOTES:**
- FURNISH AND INSTALL TYPE 170 E CONTROLLER AND TYPE 332 CABINET PER CONTRACT SPECIAL PROVISIONS.
 - INSTALL PRE-EMPTION DETECTOR PER CONTRACT SPECIAL PROVISIONS
 - INSTALL TYPE 1-A POLE AND 120V SIGNAL, 120V SIGN and 240V ST. LT. SERVICE PER STD. DWG. No. 667.
 - INSTALL 2" C - 2#6, 2#8 & 2#12
 - INSTALL 1 1/2" C - 3#6

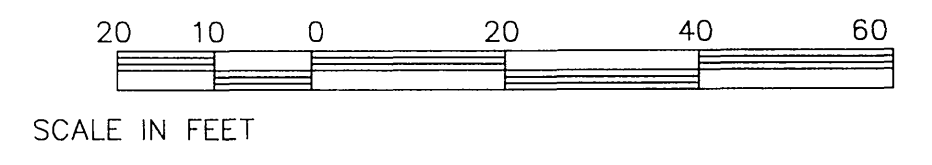

Underground Service Alert Call: TOLL FREE 1 - 800 227-2600 TWO WORKING DAYS BEFORE YOU DIG	PRIVATE ENGINEERING NOTE CONSTRUCTION CONTRACTOR AGREES THAT IN ACCORDANCE WITH GENERALLY ACCEPTED CONSTRUCTION PRACTICES, CONSTRUCTION CONTRACTOR WILL BE REQUIRED TO ASSUME SOLE AND COMPLETE RESPONSIBILITY FOR JOB SITE CONDITIONS DURING THE COURSE OF CONSTRUCTION OF THE PROJECT, INCLUDING SAFETY OF ALL PERSONS AND PROPERTY, THAT THIS REQUIREMENT SHALL BE MADE TO APPLY CONTINUOUSLY AND NOT BE LIMITED TO NORMAL WORKING HOURS, AND CONSTRUCTION CONTRACTOR FURTHER AGREES TO DEFEND, INDEMNIFY AND HOLD DESIGN PROFESSIONAL HARMLESS FROM ANY AND ALL LIABILITY, REAL OR ALLEGED, IN CONNECTION WITH THE PERFORMANCE OF WORK ON THIS PROJECT, EXCEPTING LIABILITY ARISING FROM THE SOLE NEGLIGENCE OF DESIGN PROFESSIONAL	PREPARED UNDER THE DIRECTION OF: REGISTERED CIVIL ENGINEER NO 60896 EXPIRATION DATE: 12-31-04 DATE: 02/28/01	CANTY ENGINEERING GROUP, INC. CIVIL ENGINEERING - PLANNING - SURVEYING 2020 IOWA AVENUE, SUITE 102, P.O. BOX 52050, RIVERSIDE, CA 92517 TEL (909) 683 - 5234 FAX (909) 683 - 5301 CITY OF RIV BUSINESS TAX ACCT NO 69372 EXP. DATE 04-07-01	CITY OF RIVERSIDE, CALIFORNIA DEPARTMENT OF PUBLIC WORKS	IN THE CITY OF RIVERSIDE LA SIERRA UNIVERSITY TRAFFIC SIGNAL PLAN RIVERWALK PARKWAY AND PIERCE STREET FOR: GRIFFIN INDUSTRIES	PROJECT NO. X-507 SHEET 1 OF 5 FILE NO.: 1104-001