

RIVERSIDE

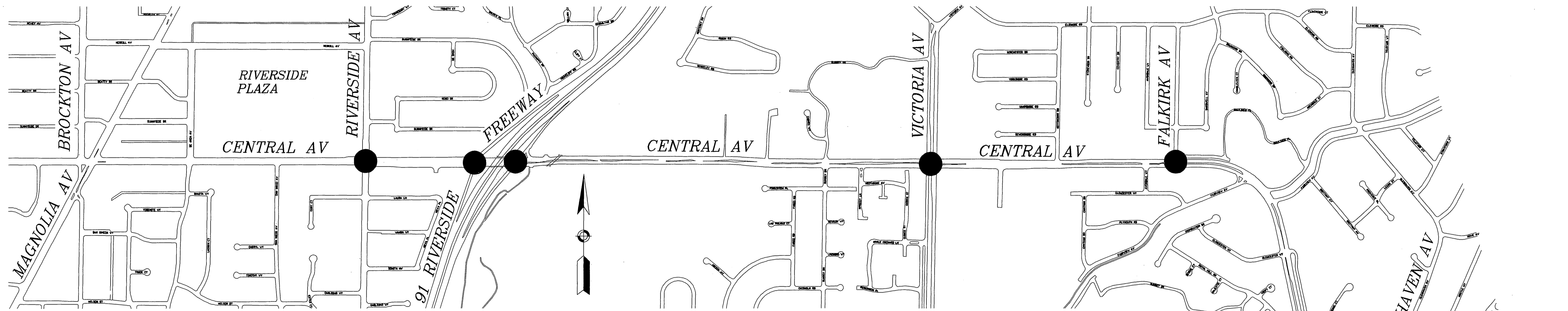

CALIFORNIA

PUBLIC WORKS DEPARTMENT TRAFFIC ENGINEERING DIVISION



CENTRAL AV./ALESSANDRO BL. - RIVERSIDE AV. TO ARLINGTON AV./CHICAGO AV.

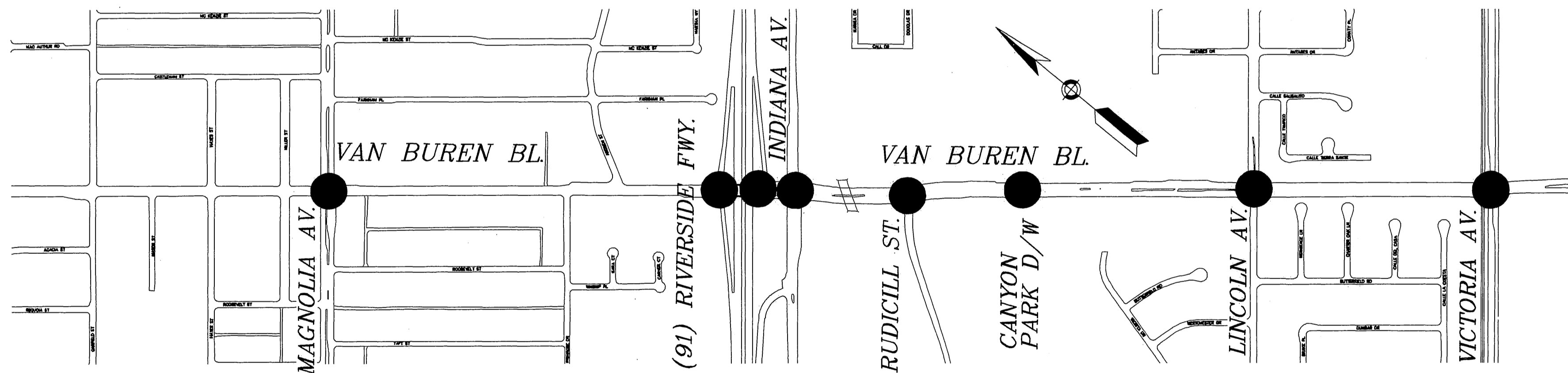

VAN BUREN BL. - MAGNOLIA AV. TO VICTORIA AV.

INDEX OF SHEETS

DRAWING NO.	LOCATION	SHEET
X-055	COVER SHEET	1
X-055	CENTRAL AV./ALESSANDRO BL. - RIVERSIDE AV. TO ARLINGTON AV./CHICAGO AV. (TRAFFIC SIGNAL SYSTEM INTERCONNECT)	2
X-055	CENTRAL AV./ALESSANDRO BL. - RIVERSIDE AV. TO ARLINGTON AV./CHICAGO AV. (TRAFFIC SIGNAL SYSTEM DETAILS)	3
X-055	CENTRAL AV./ALESSANDRO BL. - RIVERSIDE AV. TO ARLINGTON AV./CHICAGO AV. (TRAFFIC SIGNAL SYSTEM DETAILS)	4
X-405A	CENTRAL AV. @ VICTORIA AV. (TRAFFIC SIGNAL MODIFICATION)	5
X-057	VAN BUREN BL. - MAGNOLIA AV. TO VICTORIA AV. (TRAFFIC SIGNAL SYSTEM INTERCONNECT)	6
X-057	VAN BUREN BL. - MAGNOLIA AV. TO VICTORIA AV. (TRAFFIC SIGNAL SYSTEM DETAILS)	7
X-057	VAN BUREN BL. - MAGNOLIA AV. TO VICTORIA AV. (TRAFFIC SIGNAL SYSTEM DETAILS)	8

PROJECT SITES

● - INDICATES PROJECT SITE

PROJECT LOCATION MAP

SCALE: 1"=500'

CONTRACT TE-04-02

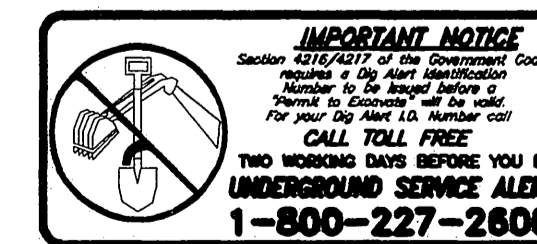

STATE ENCROACHMENT PERMIT NO.: 08-05-N-MC-0376

THE FOLLOWING PLAN IS FOR REFERENCE ONLY:

DRAWING NO.	LOCATION	SHEET
X-054, SHT. 7 OF 8	ALESSANDRO BL. @ ARLINGTON AV./CHICAGO AV.	9

ENGINEER IN RESPONSIBLE CHARGE
Patricia Lynn Castillo
 PATRICIA LYNN CASTILLO
 TR. NO. 22793
 DATE 8/18/05

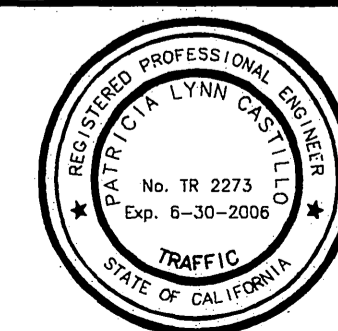

MARK	REVISIONS	APPR.	DATE

**CITY OF RIVERSIDE, CALIFORNIA
DEPARTMENT OF PUBLIC WORKS**
 APPROVED BY: *[Signature]* DATE: 8/18/05
 PRINCIPAL ENGINEER: *[Signature]*
 TRAFFIC DIVISION: *[Signature]*
 DATE: 8/18/05

TRAFFIC SIGNAL COORDINATED SYSTEMS
**CENTRAL AV./ALESSANDRO BL.
AND VAN BUREN BL.
TRAFFIC SIGNAL SYSTEMS**

ACCT. NO. 9576530216-44030200
X-055
 SHEET 1 OF 4
 FILE NAME: X055CVR.DWG

SCALE: 1"=500'

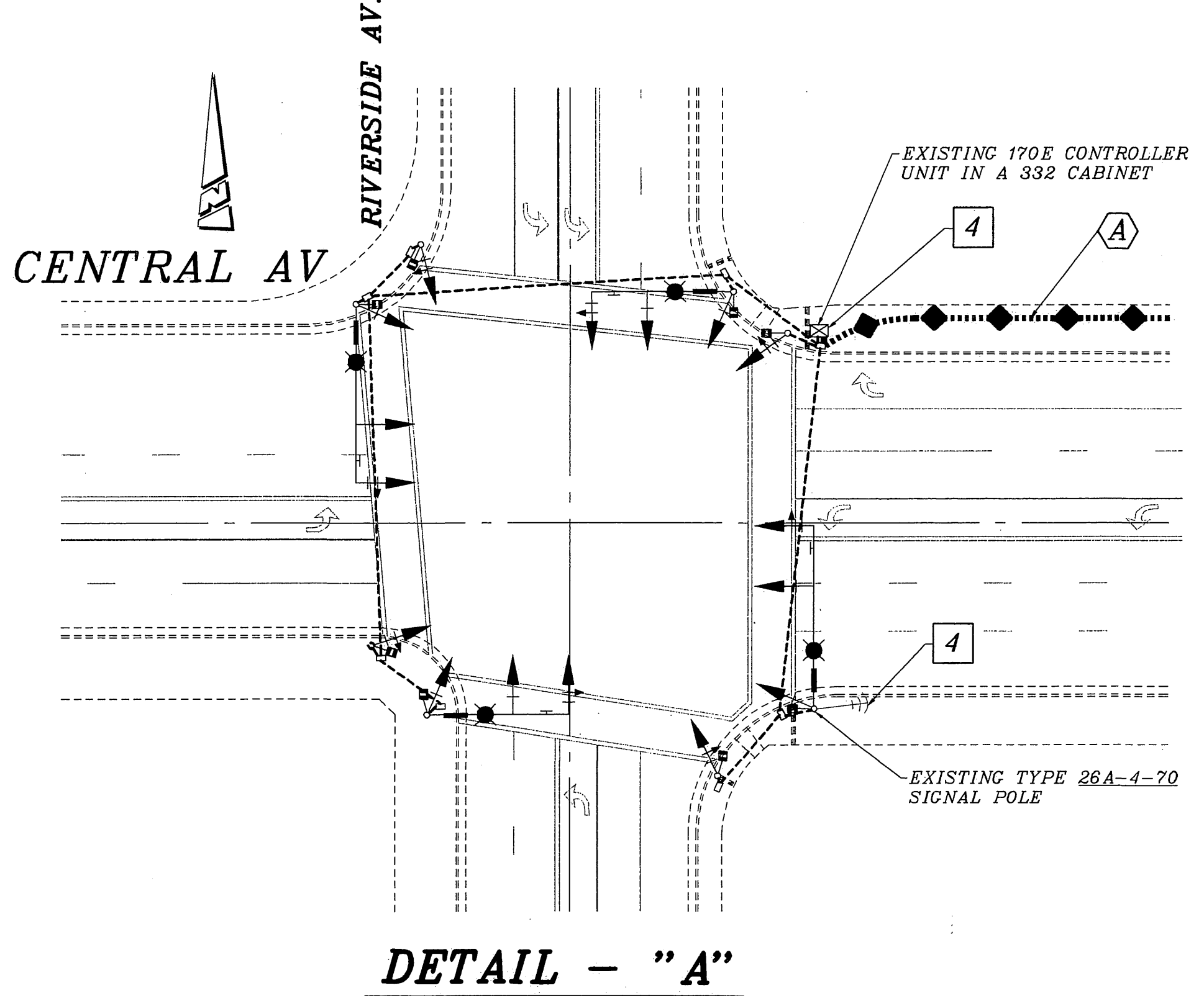
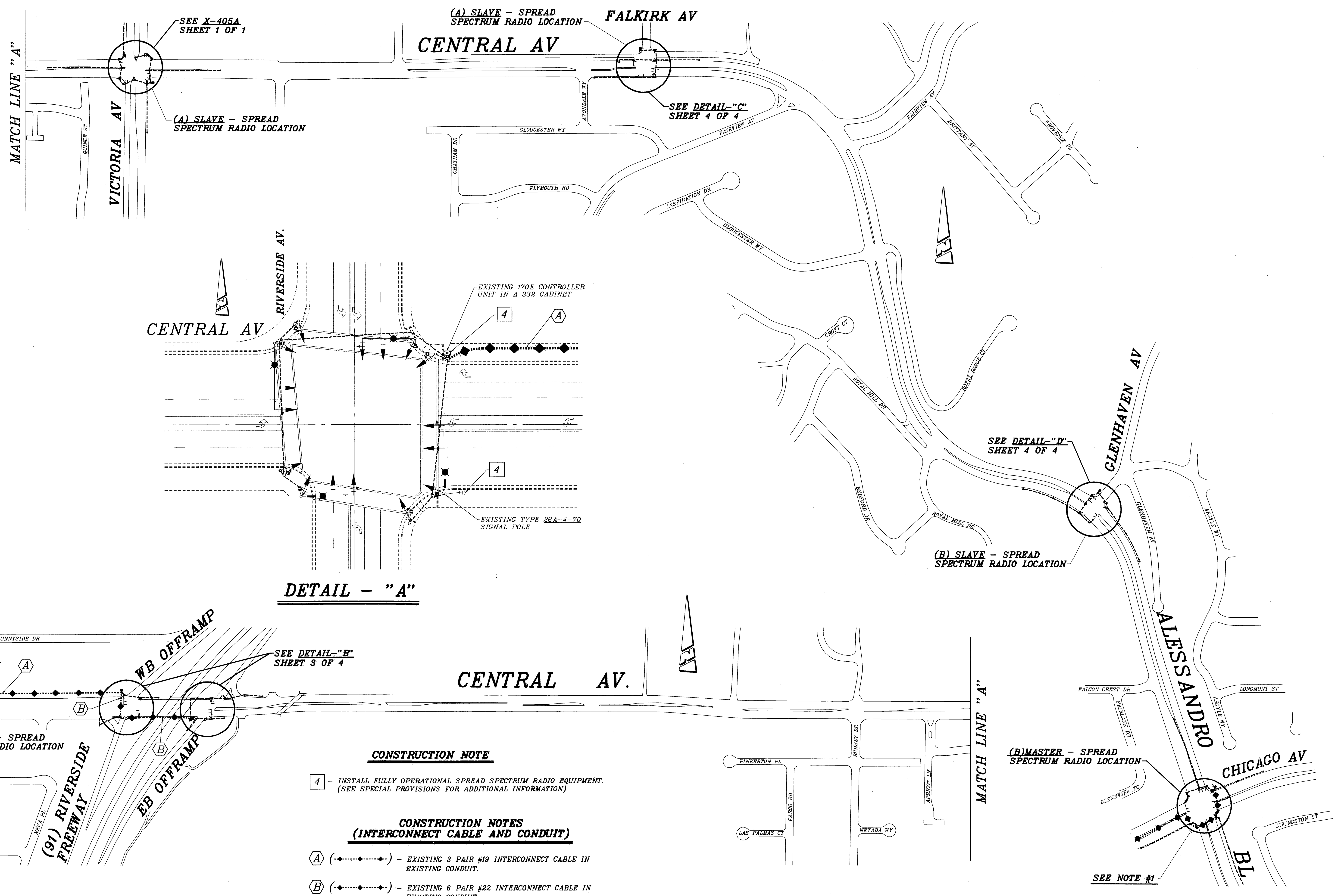

CONSTRUCTION NOTE

4 - INSTALL FULLY OPERATIONAL SPREAD SPECTRUM RADIO EQUIPMENT. (SEE SPECIAL PROVISIONS FOR ADDITIONAL INFORMATION)

CONSTRUCTION NOTES (INTERCONNECT CABLE AND CONDUIT)

- A (---◆---◆---◆) - EXISTING 3 PAIR #19 INTERCONNECT CABLE IN EXISTING CONDUIT.
- B (---◆---◆---◆) - EXISTING 6 PAIR #22 INTERCONNECT CABLE IN EXISTING CONDUIT.

NOTE:
 1. EXISTING 170E CONTROLLER IN A 332 CABINET, SEE CITY PLAN X-054, SHEET 7 OF 8, FOR MORE INFORMATION ON EXISTING CONDUIT RUNS. THE EXISTING SPREAD SPECTRUM RADIO EQUIPMENT AT THIS LOCATION, CONSISTS OF YAGI ANTENNA AND A COAXIAL CABLE RUNNING FROM ANTENNA TO CONTROLLER CABINET.

ENGINEER IN RESPONSIBLE CHARGE
Patricia Lynn Castillo
 PATRICIA LYNN CASTILLO
 TR. NO. 2273
 DATE 8/18/05

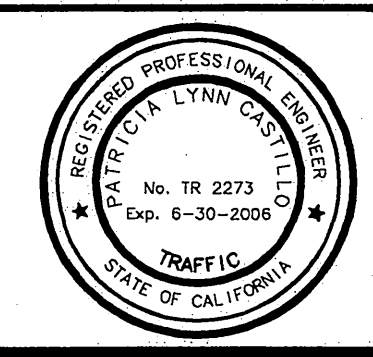

MARK	REVISIONS	APPR	DATE

**CITY OF RIVERSIDE, CALIFORNIA
 DEPARTMENT OF PUBLIC WORKS**

APPROVED BY: *[Signature]* DATE: 8/18/05
 PRINCIPAL ENGINEER
 TRAFFIC DIVISION

APPROVED BY: *[Signature]* DATE:
 CITY ENGINEER

TRAFFIC SIGNAL SYSTEM INTERCONNECT

**CENTRAL AVENUE/
 ALESSANDRO BOULEVARD**
 RIVERSIDE AV. TO
 ARLINGTON AVENUE/CHICAGO AVENUE

SCALE: 1" = 200'

ACCT. NO. 9576530214-44030200
X-055
 SHEET 2 OF 4
 FILE NAME: X055-1.DWG

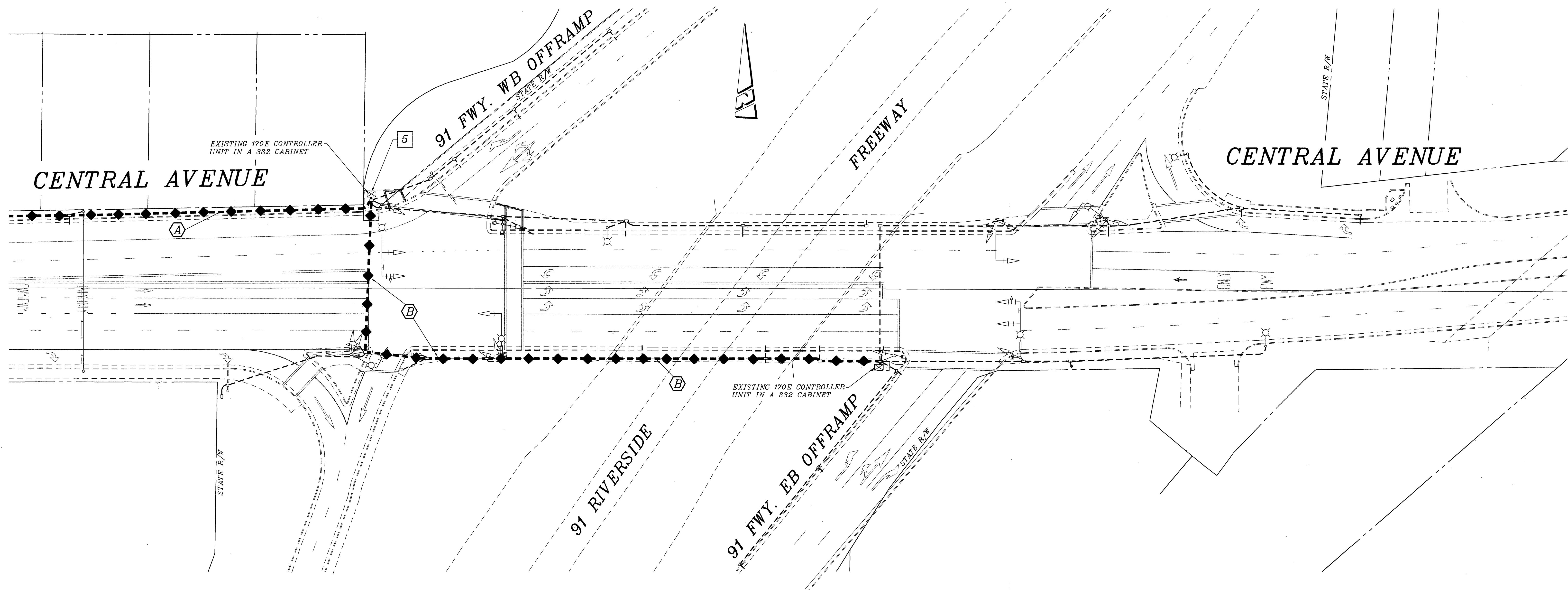

DETAIL - "B"

CONSTRUCTION NOTE

5 - INSTALL 1 EA. MODEL 170E/TRFM CONTROLLER UNIT (PURCHASED FROM CALTRANS) IN THE EXISTING 332 CABINET.

CONSTRUCTION NOTES (INTERCONNECT CABLE AND CONDUIT)

- A (---) - EXISTING 3 PAIR #19 INTERCONNECT CABLE IN EXISTING CONDUIT.
- B (---) - EXISTING 6 PAIR #22 INTERCONNECT CABLE IN EXISTING CONDUIT.

GENERAL NOTES (SHEET 3 OF 4 ONLY)

1. ALL WORK WITHIN THE STATE RIGHT OF WAY SHALL CONFORM TO THE STATE OF CALIFORNIA, DEPARTMENT OF TRANSPORTATION (CALTRANS) STANDARD SPECIFICATIONS DATED (JULY 1999 EDITION), AND STANDARD PLANS DATED (JULY 2004 EDITION), AND ALSO THE SPECIAL PROVISIONS OR AS DIRECTED BY THE STATE'S REPRESENTATIVE.
2. NO VEHICLES OR EQUIPMENT SHALL BE STORED, CLEANED, MAINTAINED OR FUELED WITHIN THE STATE RIGHT-OF-WAY.
3. NO WASTE OR MATERIALS SHALL BE STORED WITHIN STATE RIGHT-OF-WAY.
4. WHERE DAMAGE IS CAUSED BY THE CONTRACTOR'S OPERATION, THE CONTRACTOR SHALL AT HIS EXPENSE, REPAIR OR REPLACE DAMAGED FACILITIES PROMPTLY IN ACCORDANCE WITH STATE SPECIFICATIONS.

ENGINEER IN RESPONSIBLE CHARGE
Patricia Lynn Castillo
 PATRICIA LYNN CASTILLO
 TR. NO. 2273
 DATE 8/18/05



MARK	REVISIONS	APPR.	DATE

**CITY OF RIVERSIDE, CALIFORNIA
 DEPARTMENT OF PUBLIC WORKS**

APPROVED BY	BY	DATE	APPROVED BY
PRINCIPAL ENGINEER	PC	8/18/05	<i>[Signature]</i>
TRAFFIC DIVISION			CITY ENGINEER

DESIGNED BY: R.C.C. DRAWN BY: R.C.C. CHECKED BY: *[Signature]*

TRAFFIC SIGNAL SYSTEM DETAILS

**CENTRAL AVENUE/
 ALESSANDRO BOULEVARD**

RIVERSIDE AV. TO
 ALESSANDRO BOULEVARD/CHICAGO AVENUE

SCALE: 1" = 30'

ACCT. NO.
 9576530214-44030200

X-055

SHEET 3 OF 4

FILE NAME: X055-2A.DWG

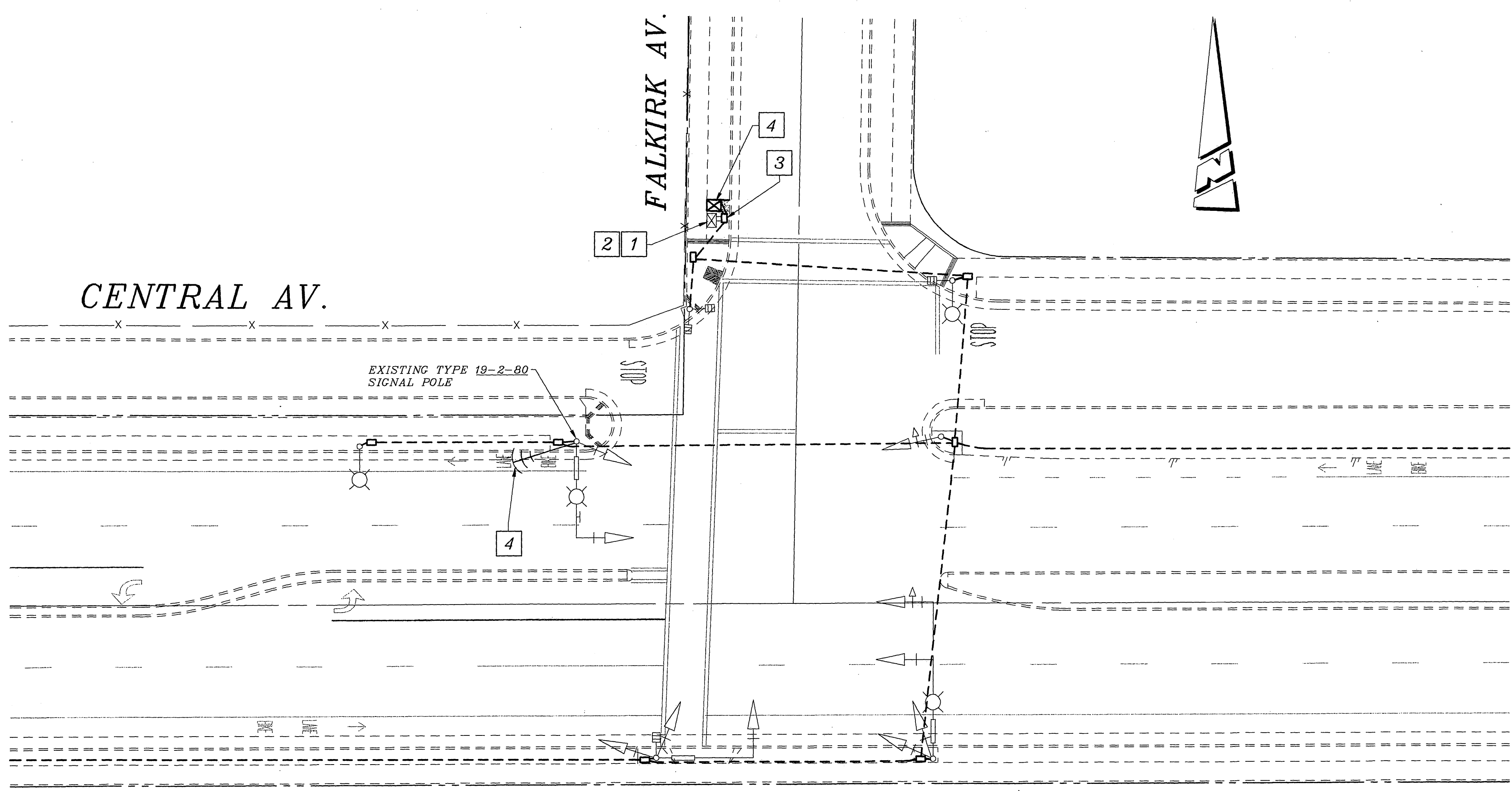

DETAIL - "C"

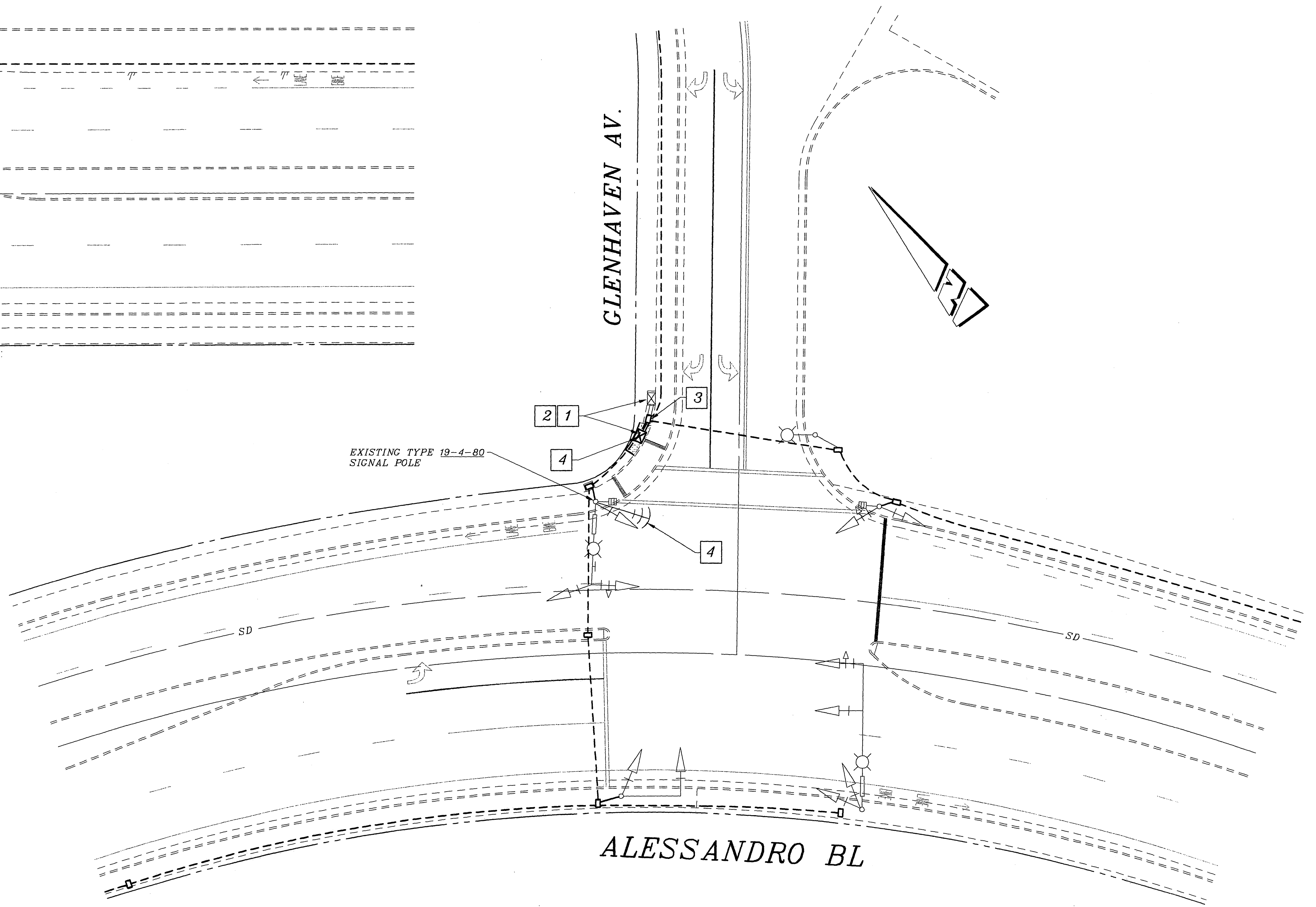

DETAIL - "D"

CONSTRUCTION NOTES

- 1 - REMOVE AND SALVAGE EXISTING TYPE 90 CONTROLLER ASSEMBLY. REMOVE FOUNDATION. INSTALL MODEL 170E/332 CABINET ASSEMBLY ON NEW FOUNDATION.
- 2 - WITHDRAW EXISTING CABLES AND CONDUCTORS FROM EXISTING CONDUIT RUN, AND INSTALL EXISTING CABLES AND CONDUCTORS IN NEW CONDUIT RUN (2-3" CONDUIT), FROM #6(E) FULL BOX TO CONTROLLER CABINET.
- 3 - REPLACE EXISTING #6 FULL BOX WITH NEW #6(E) FULL BOX.
- 4 - INSTALL FULLY OPERATIONAL SPREAD SPECTRUM RADIO EQUIPMENT. (SEE SPECIAL PROVISIONS FOR ADDITIONAL INFORMATION)

ENGINEER IN RESPONSIBLE CHARGE
Patricia Lynn Castillo
 PATRICIA LYNN CASTILLO
 TR. NO. 2273
 DATE: 8/19/05



MARK	REVISIONS	APPR.	DATE

**CITY OF RIVERSIDE, CALIFORNIA
 DEPARTMENT OF PUBLIC WORKS**

APPROVED BY	BY	DATE	APPROVED BY
PRINCIPAL ENGINEER	PC	8/21/05	<i>Patricia Lynn Castillo</i>
TRAFFIC DIVISION			CITY ENGINEER

DESIGNED BY: R.C.C. DRAWN BY: R.C.C. CHECKED BY: *Patricia Lynn Castillo*
 DATE: 8/22/05

TRAFFIC SIGNAL SYSTEM DETAILS
**CENTRAL AVENUE/
 ALESSANDRO BOULEVARD**
 RIVERSIDE AV. TO
 ALESSANDRO BOULEVARD/CHICAGO AVENUE

ACCT. NO. 9576530214-44030200
X-055
 SHEET 4 OF 4
 FILE NAME: X055-3.DWG

SCALE: 1" = 20'