

PHASE	DIAGRAM
ø1	
ø2	
ø3	
ø4	
ø5	
ø6	
ø7	
ø8	

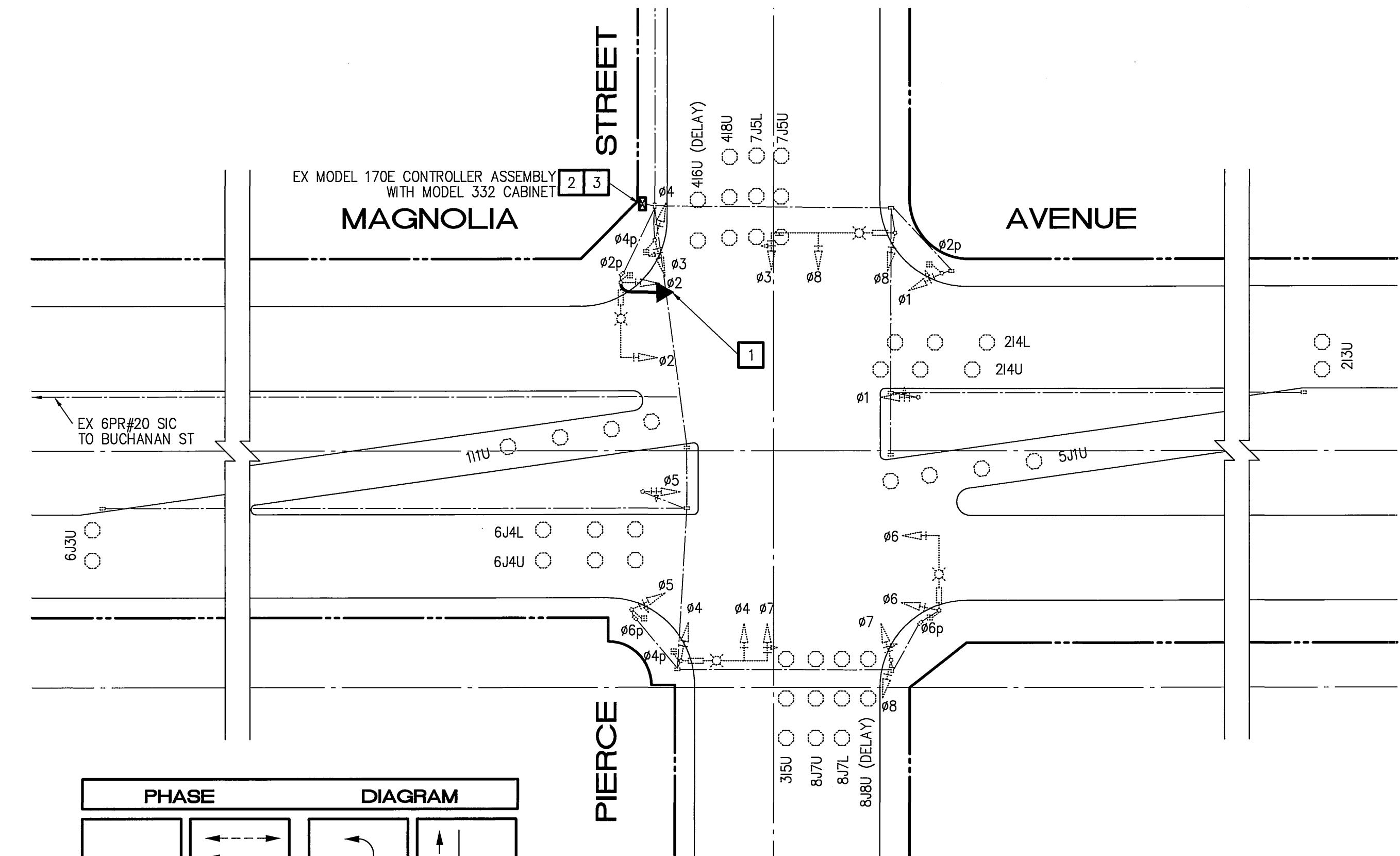

PHASE	DIAGRAM
ø1	
ø2	
ø3	
ø4	
ø5	
ø6	
ø7	
ø8	

SCALE: 1"=40'

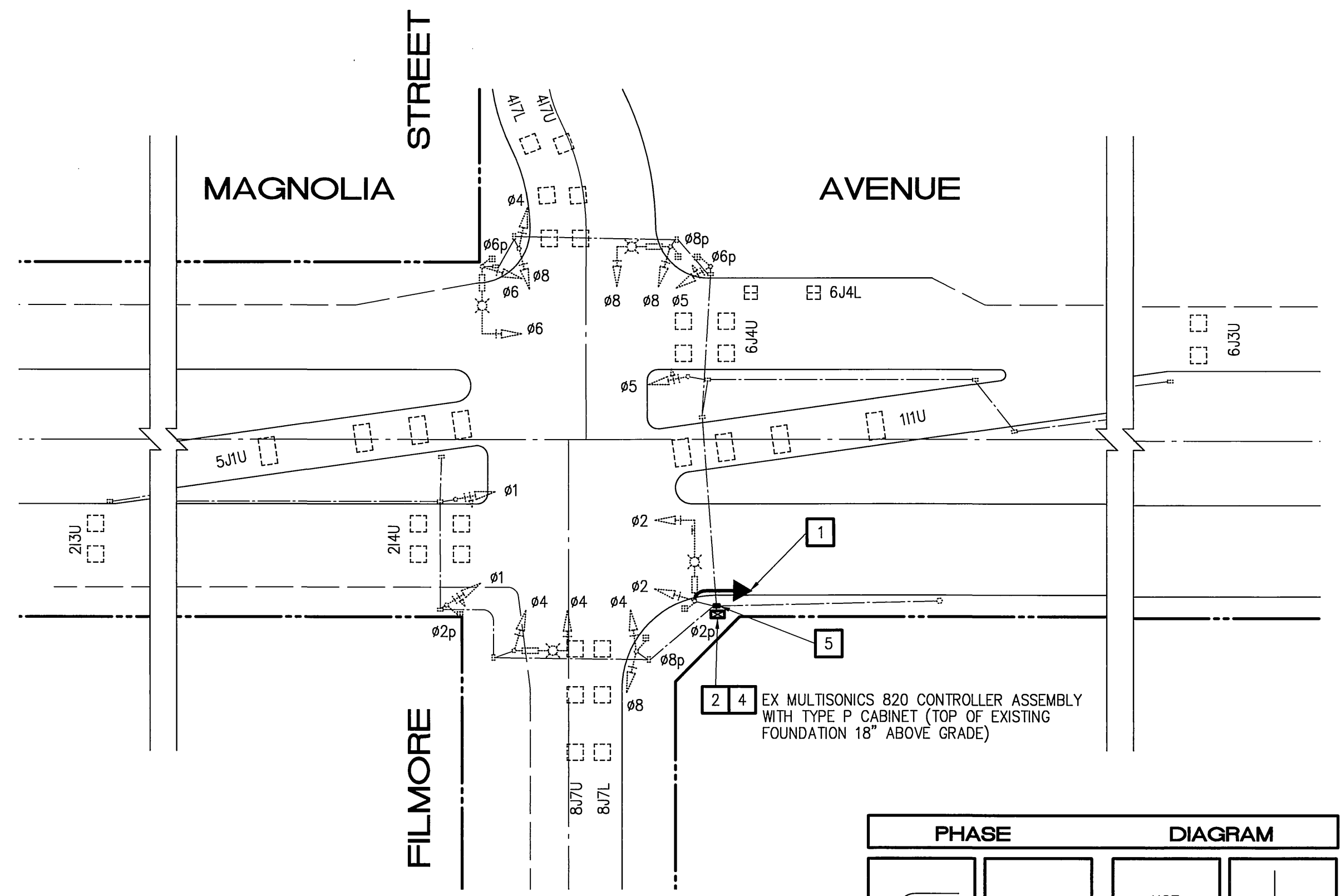

PHASE	DIAGRAM
ø1	
ø2	
ø3	NOT USED
ø4	
ø5	
ø6	
ø7	NOT USED
ø8	

CONSTRUCTION NOTES (THIS SHEET):

- INSTALL PANEL ANTENNA WITH ENCOM 2.4 GHz EP-COMMPAKB2.4-INT RADIO ON SIGNAL POLE. EXACT PLACEMENT OF ANTENNA SHALL BE DETERMINED BY THE RADIO MANUFACTURER'S REPRESENTATIVE IN THE FIELD. RUN CAT-5E CABLE IN EXISTING CONDUIT TO CONTROLLER CABINET.
- INSTALL MCCAIN SERIAL TERMINAL SERVER AND RADIO POWER SUPPLY WITH LIGHTNING AND SURGE PROTECTION.
- REMOVE AND SALVAGE EXISTING MODEL 332 CABINET AND AUXILIARY EQUIPMENT. INSTALL NEW MODEL 332 CABINET AND NECESSARY AUXILIARY EQUIPMENT ON EXISTING FOUNDATION. REUSE EXISTING MODEL 170E CONTROLLER UNIT.
- REMOVE AND SALVAGE EXISTING CONTROLLER ASSEMBLY. REMOVE FOUNDATION. INSTALL NEW MODEL 170E CONTROLLER ASSEMBLY WITH MODEL 332 CABINET, BI TRAN 233 PROGRAM AND 3M OPTICOM PHASE SELECTOR MODULES (2 CHANNEL UNITS ONLY) ON NEW FOUNDATION. REMOVE EXISTING CONDUITS INTO CONTROLLER CABINET AND INSTALL TWO (2) NEW 3.5" CONDUITS.
- REMOVE EXISTING PULL BOX AND REPLACE WITH NEW NO. 6E PULL BOX. *(SEE SPECIAL PROVISIONS)*



TRAFFIC No. 1575
 DATE: 3-2-07
 AGA Job No. : 134-014
 AGA File Name: Magnolia WiFi
 Print Date : 3/2/07
 Last Revision : 2/26/07

ALBERT GROVER & ASSOCIATES
 TRANSPORTATION CONSULTING ENGINEERS
 211 E. Imperial Hwy., Suite 208 Fullerton, CA 92835
 (714) 992-2980
 FAX 992-2883

CONTRACT TE-06-01

CITY OF RIVERSIDE, CALIFORNIA DEPARTMENT OF PUBLIC WORKS		TRAFFIC SIGNAL INTERCONNECT PLAN		ACCOUNT NO.
APPROVED BY: <i>[Signature]</i> DATE: 5-7-07		APPROVED BY: <i>[Signature]</i>		X-059
PRINCIPAL ENGINEER		CITY ENGINEER		
TRAFFIC DIVISION		DATE: 5/14/07		SHEET 7 OF 12
DESIGNED BY: RPH DRAWN BY: RPH CHECKED BY: JAT		HORIZ. SCALE: 1"= 40' VERT. SCALE: N/A		

Underground Service Alert
 Call TOLL FREE
 1-800
 227-2600
 TWO WORKING DAYS BEFORE YOU DIG

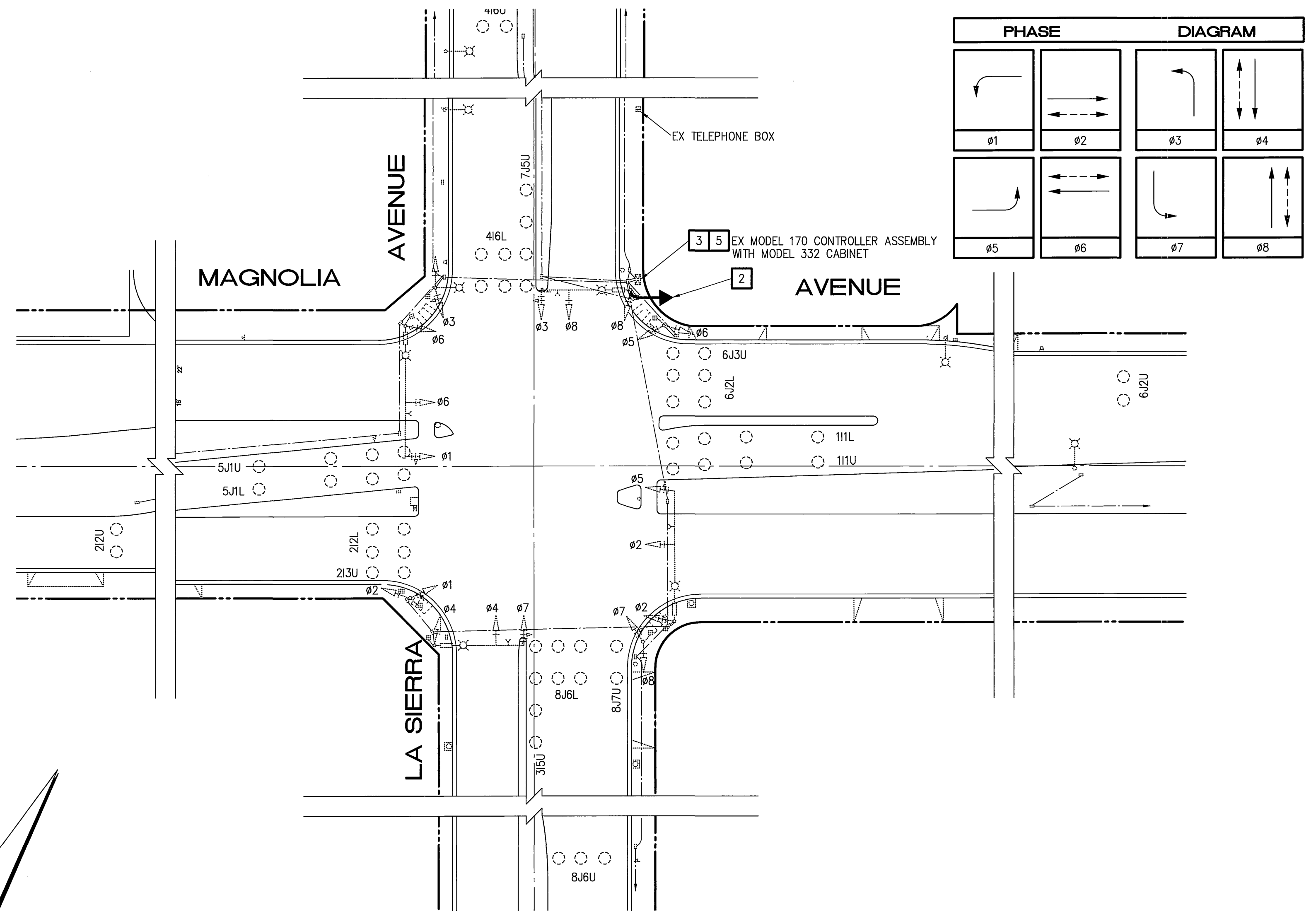
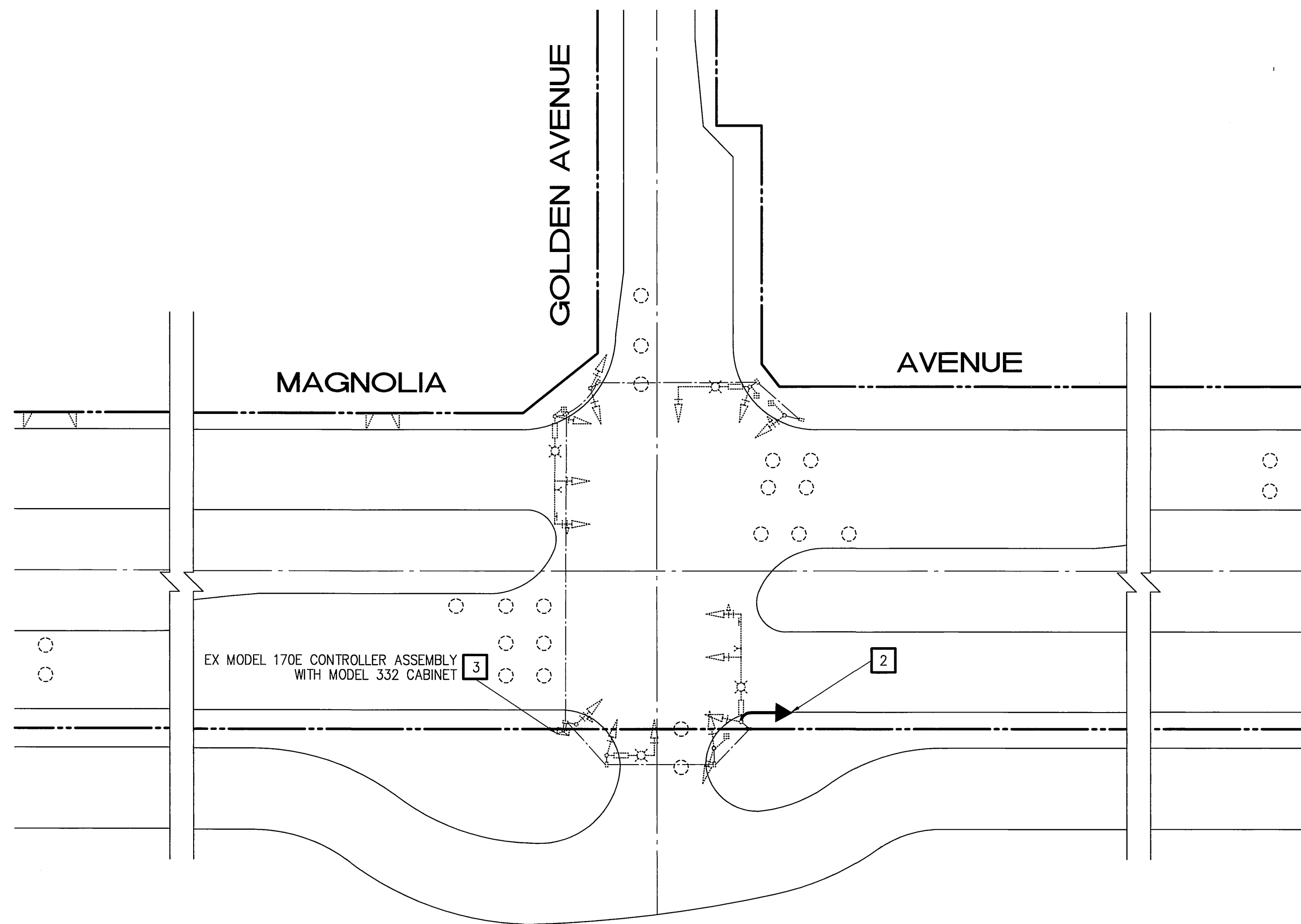

PHASE		DIAGRAM	
ø1	ø2	ø3	ø4
ø5	ø6	ø7	ø8

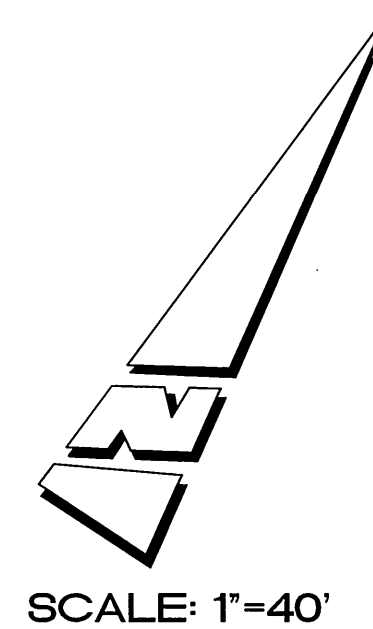

SCALE: 1"=40'

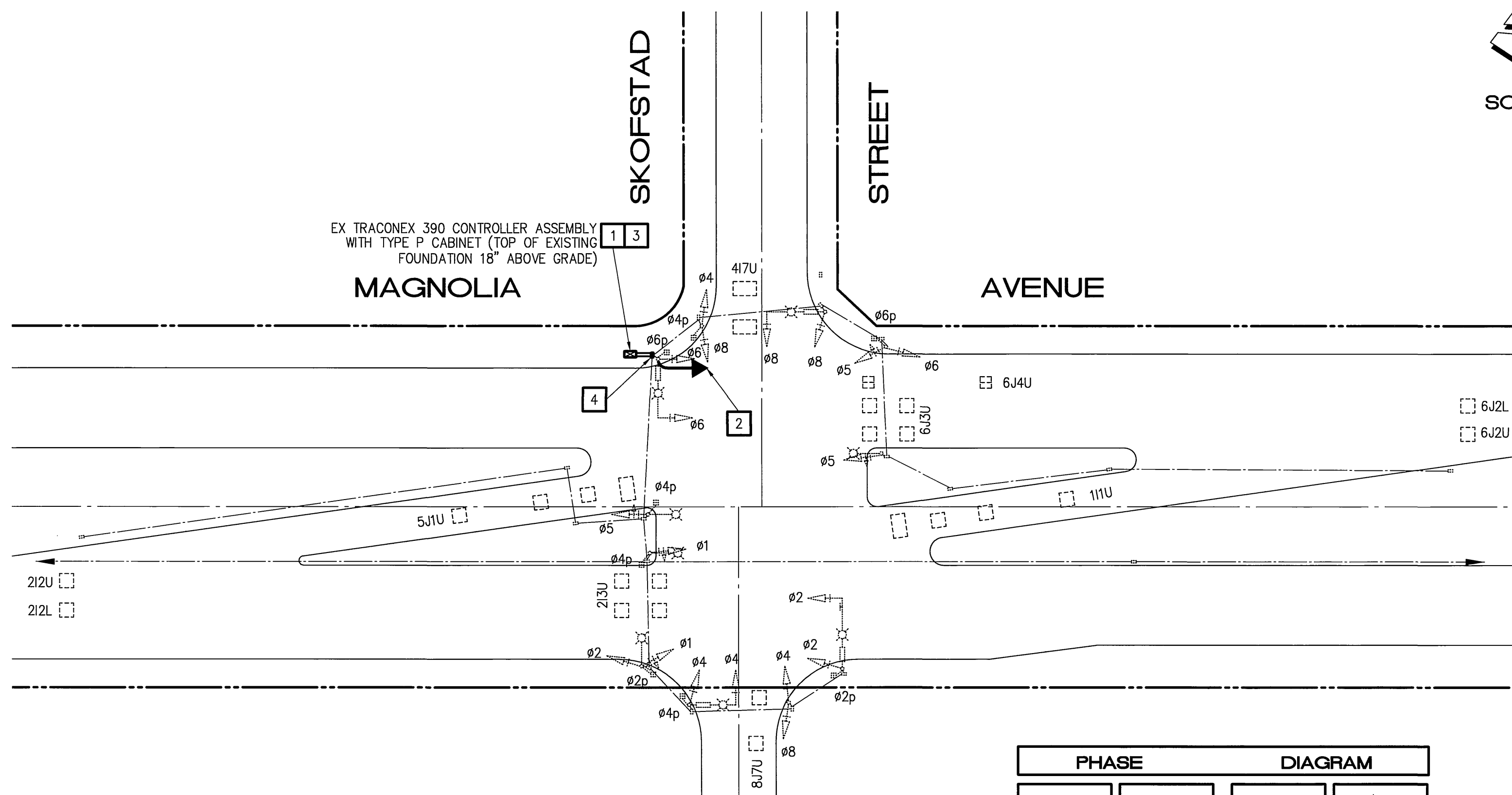

CONSTRUCTION NOTES (THIS SHEET):

- 1- REMOVE AND SALVAGE EXISTING CONTROLLER ASSEMBLY. REMOVE FOUNDATION. INSTALL NEW MODEL 170E CONTROLLER ASSEMBLY WITH MODEL 332 CABINET, BI TRAN 233 PROGRAM AND 3M OPTICOM PHASE SELECTOR MODULES (2 CHANNEL UNITS ONLY) ON NEW FOUNDATION. REMOVE EXISTING CONDUITS INTO CONTROLLER CABINET AND INSTALL TWO (2) NEW 3.5" CONDUITS.
- 2- INSTALL PANEL ANTENNA WITH ENCOM 2.4 GHz EP-COMPAKBB2.4-INT RADIO ON SIGNAL POLE. EXACT PLACEMENT OF ANTENNA SHALL BE DETERMINED BY THE RADIO MANUFACTURER'S REPRESENTATIVE IN THE FIELD. RUN CAT-5E CABLE IN EXISTING CONDUIT TO CONTROLLER CABINET.
- 3- INSTALL MCCAIN SERIAL TERMINAL SERVER AND RADIO POWER SUPPLY WITH LIGHTNING AND SURGE PROTECTION.
- 4- REMOVE EXISTING PULL BOX AND REPLACE WITH NEW NO. 6E PULL BOX. (SEE SPECIAL PROVISIONS)
- 5- REMOVE AND SALVAGE EXISTING MODEL 170 CONTROLLER UNIT. INSTALL NEW MODEL 170E CONTROLLER UNIT WITH BI TRAN 233 PROGRAM AND 3M OPTICOM PHASE SELECTOR MODULES (2 CHANNEL UNITS ONLY) IN EXISTING CONTROLLER CABINET.

PHASE		DIAGRAM	
		NOT USED	
ø1	ø2	ø3	ø4
		NOT USED	
ø5	ø6	ø7	ø8



TRAFFIC No. 1575
 DATE: 3-2-07
 AGA Job No. : 134-014
 AGA File Name: Magnolia WiFi
 Print Date : 3/2/07
 Last Revision : 2/26/07

ALBERT ROVER & ASSOCIATES
 TRANSPORTATION CONSULTING ENGINEERS
 211 E. Imperial Hwy., Suite 208 Fullerton, CA 92835
 (714) 992-2980
 FAX 992-2883

CONTRACT TE-06-01

CITY OF RIVERSIDE, CALIFORNIA DEPARTMENT OF PUBLIC WORKS		TRAFFIC SIGNAL INTERCONNECT PLAN		ACCOUNT NO.
APPROVED BY: [Signature] DATE: 3-2-07		APPROVED BY: [Signature]		X-059
PRINCIPAL ENGINEER		CITY ENGINEER		
MARK: [Signature]		DATE: 3-2-07		SHEET 8 OF 12
DESIGNED BY: RPM DRAWN BY: RPM CHECKED BY: JAT		HORIZ. SCALE: 1" = 40' VERT. SCALE: N/A		

Underground Service Alert
 Call TOLL FREE
 1-800-227-2600
 TWO WORKING DAYS BEFORE YOU DIG

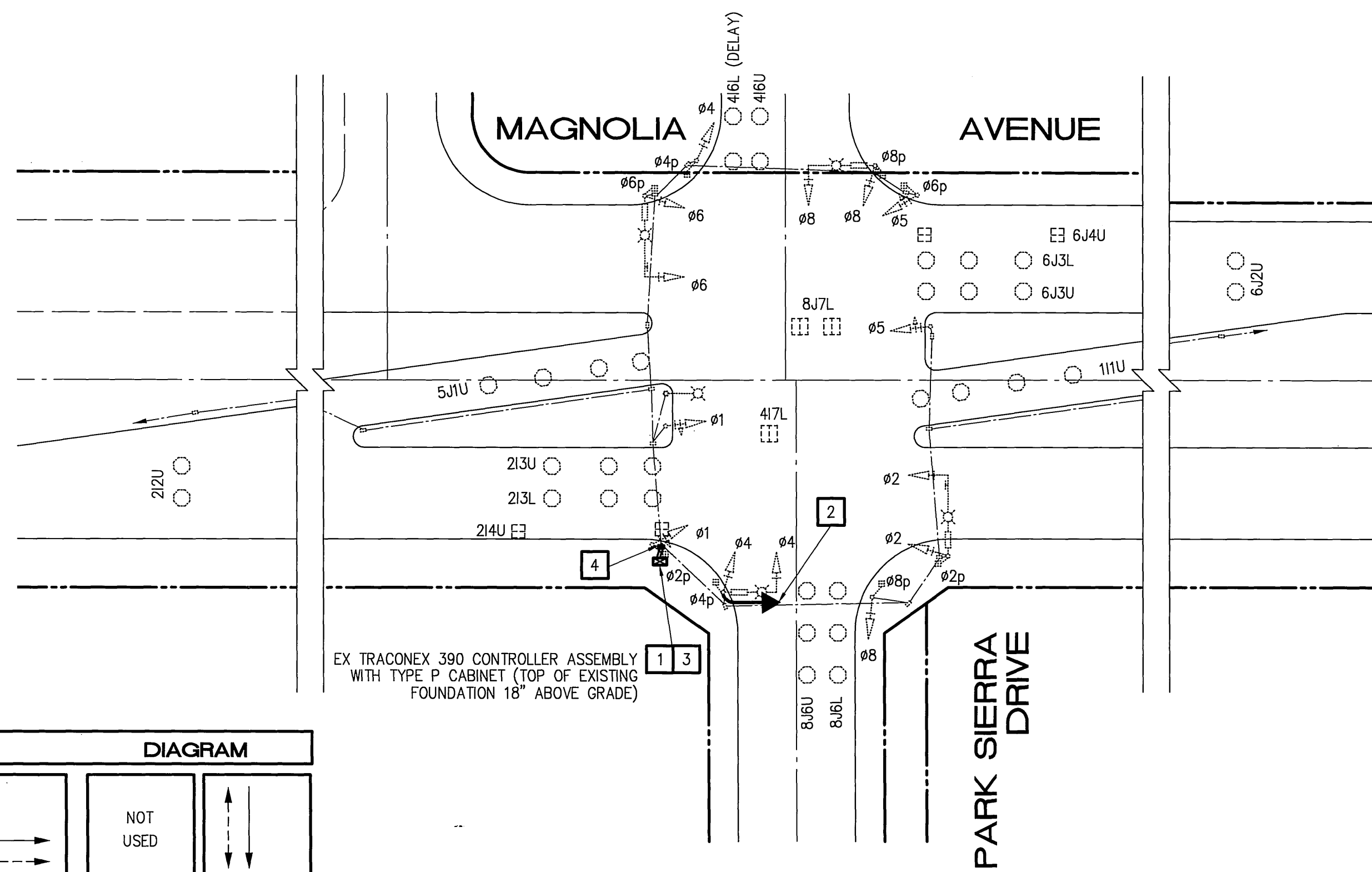

PHASE		DIAGRAM	
ø1	ø2	NOT USED	ø4
ø5	ø6	NOT USED	ø8

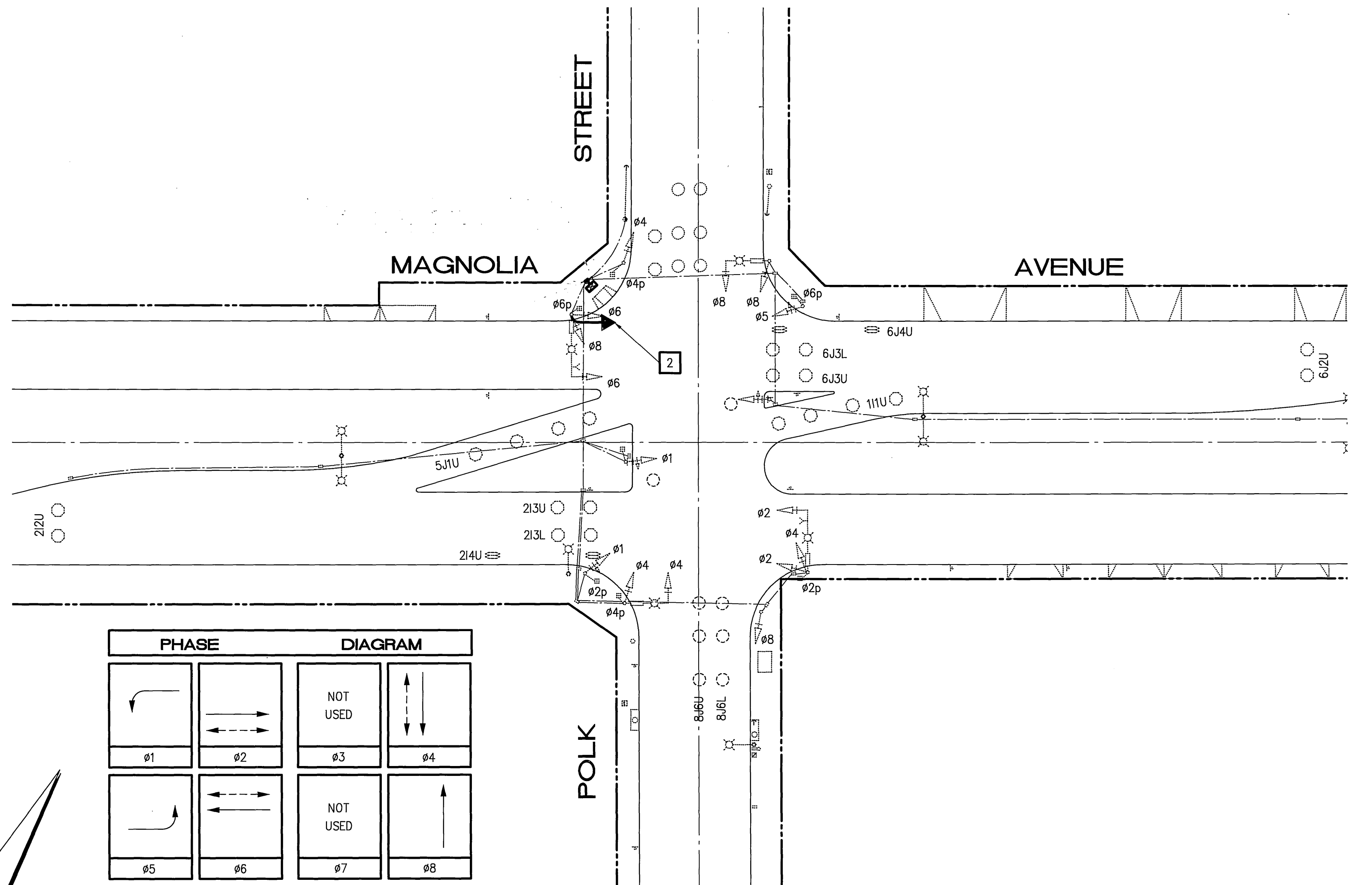

PHASE		DIAGRAM	
ø1	ø2	NOT USED	ø4
ø5	ø6	NOT USED	ø8

SCALE: 1"=40'

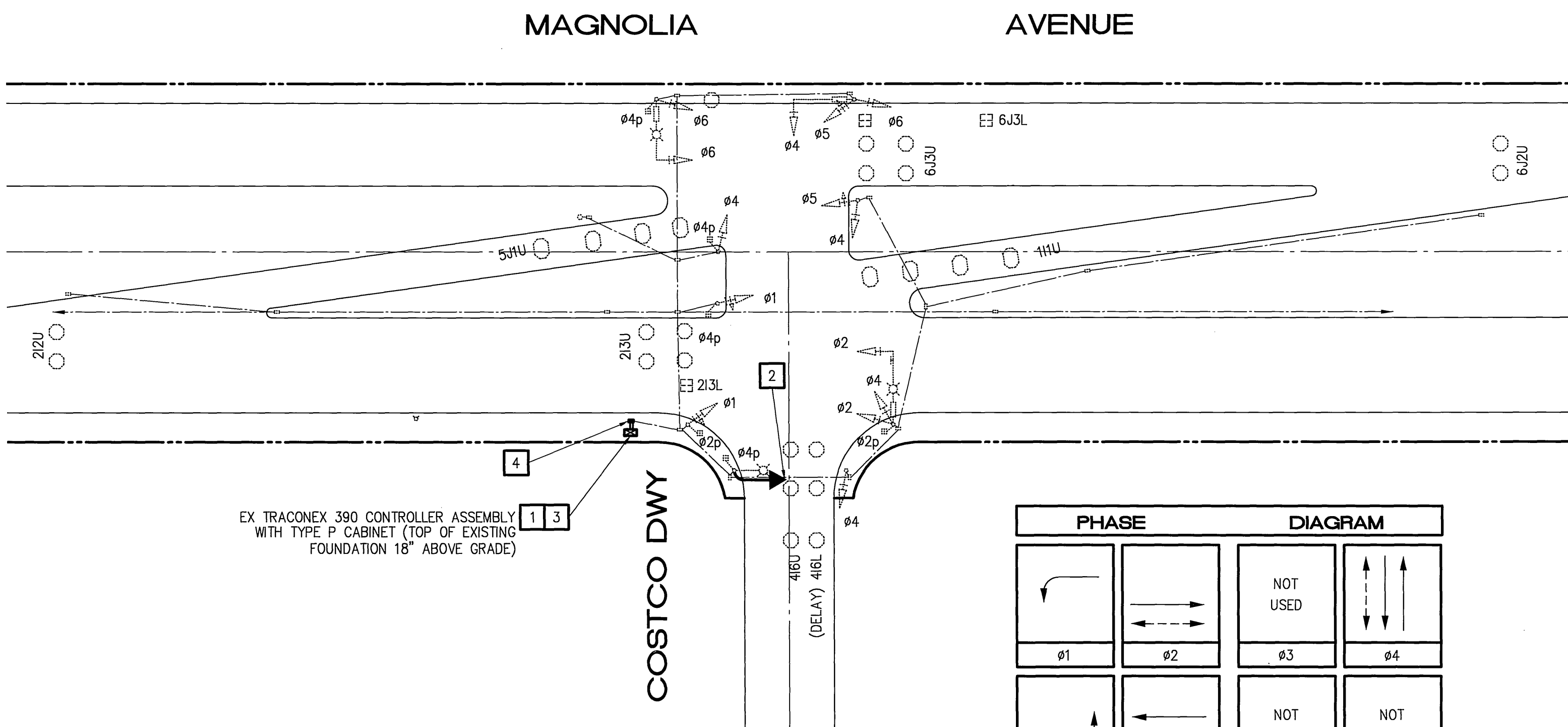

PHASE		DIAGRAM	
ø1	ø2	NOT USED	ø4
ø5	ø6	NOT USED	ø8

CONSTRUCTION NOTES (THIS SHEET):

- 1- REMOVE AND SALVAGE EXISTING CONTROLLER ASSEMBLY. REMOVE FOUNDATION. INSTALL NEW MODEL 170E CONTROLLER ASSEMBLY WITH MODEL 332 CABINET, BI TRAN 233 PROGRAM AND 3M OPTICOM PHASE SELECTOR MODULES (2 CHANNEL UNITS ONLY) ON NEW FOUNDATION. REMOVE EXISTING CONDUITS INTO CONTROLLER CABINET AND INSTALL TWO (2) NEW 3.5" CONDUITS.
- 2- INSTALL PANEL ANTENNA WITH ENCOM 2.4 GHz EP-COMPAKBB2.4-INT RADIO ON SIGNAL POLE. EXACT PLACEMENT OF ANTENNA SHALL BE DETERMINED BY THE RADIO MANUFACTURER'S REPRESENTATIVE IN THE FIELD. RUN CAT-5E CABLE IN EXISTING CONDUIT TO CONTROLLER CABINET.
- 3- INSTALL MCCAIN SERIAL TERMINAL SERVER AND RADIO POWER SUPPLY WITH LIGHTNING AND SURGE PROTECTION.
- 4- REMOVE EXISTING PULL BOX AND REPLACE WITH NEW NO. 6E PULL BOX. (SEE SPECIAL PROVISIONS)



TRAFFIC No. 1575
 DATE: 3-2-07
 AGA Job No. : 134-014
 AGA File Name: Magnolia WiFi
 Print Date : 3/2/07
 Last Revision : 2/26/07

ALBERT GROVER & ASSOCIATES
 TRANSPORTATION CONSULTING ENGINEERS
 211 E. Imperial Hwy., Suite 208 Fullerton, CA 92835
 (714) 992-2990
 FAX 992-2883

CONTRACT TE-06-01

**CITY OF RIVERSIDE, CALIFORNIA
 DEPARTMENT OF PUBLIC WORKS**

TRAFFIC SIGNAL INTERCONNECT PLAN

ACCOUNT NO.

APPROVED BY	DATE	BY
PRINCIPAL ENGINEER	3-2-07	JH
TRAFFIC DIVISION	3-3-07	JH
DESIGNED BY	EDWARD MARRAS	5/2/07
DRAWN BY		
CHECKED BY	JAT	

**MAGNOLIA AVENUE
 BUCHANAN STREET TO
 BANBURY DRIVE**

X-059
 SHEET 9 OF 12

HORIZ. SCALE: 1"= 40' VERT. SCALE: N/A

MARK	REVISIONS	APPR. DATE
DESIGNED BY	RPH	DRAWN BY
DRAWN BY	RPH	CHECKED BY
CHECKED BY	JAT	DATE
DATE	5/2/07	

Underground Service Alert
 Call: TOLL FREE
 1-800
 227-2600
 TWO WORKING DAYS BEFORE YOU DIG

PHASE		DIAGRAM	
		NOT USED	
ø1	ø2	ø3	ø4
		NOT USED	
ø5	ø6	ø7	ø8

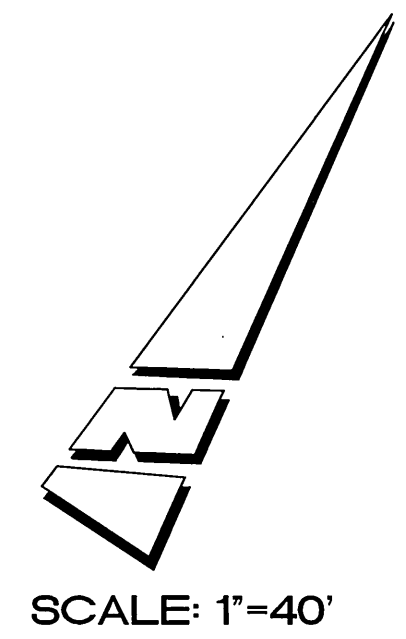
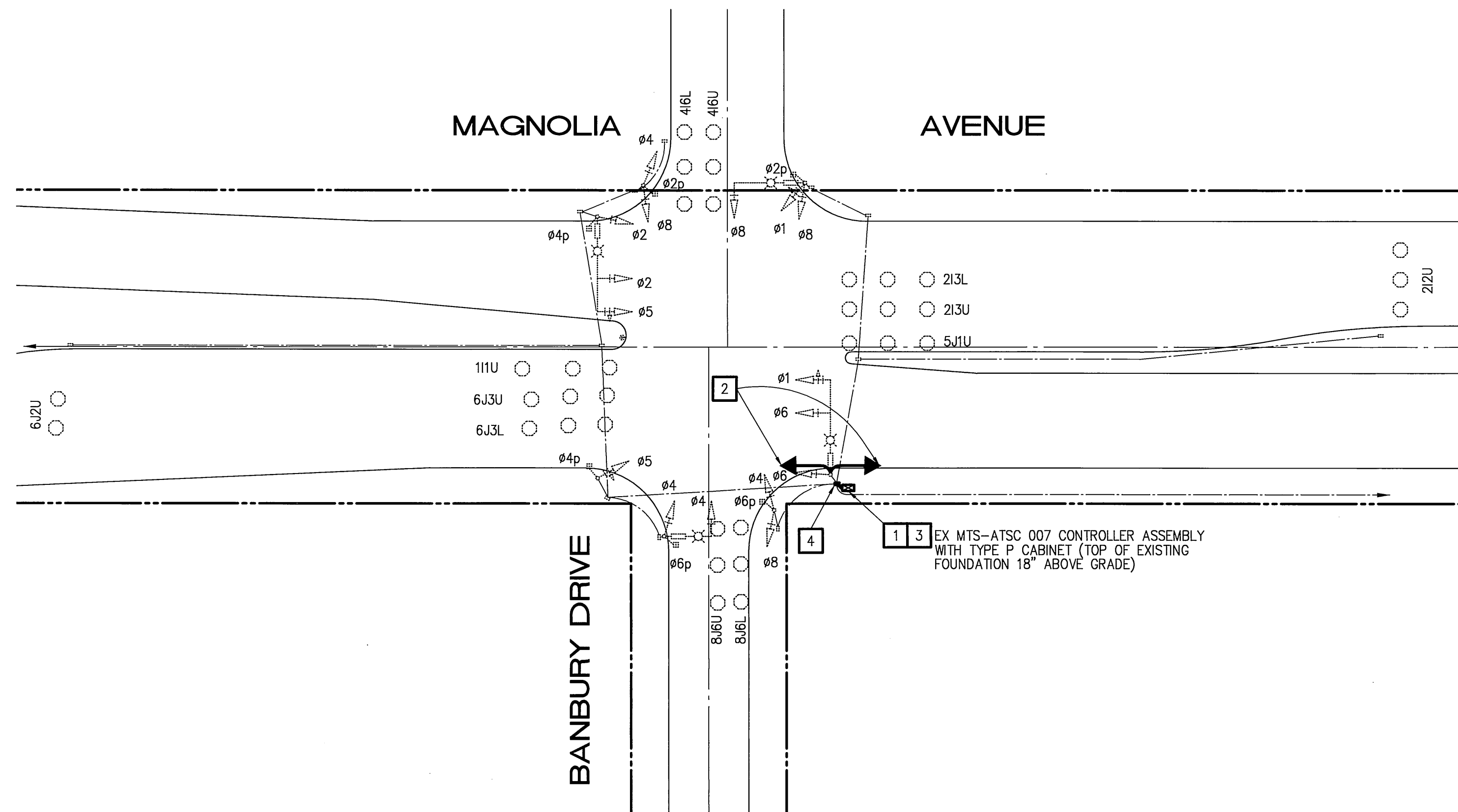

CONSTRUCTION NOTES (THIS SHEET):

- 1- REMOVE AND SALVAGE EXISTING CONTROLLER ASSEMBLY. REMOVE FOUNDATION. INSTALL NEW MODEL 170E CONTROLLER ASSEMBLY WITH MODEL 332 CABINET, BI TRAN 233 PROGRAM AND 3M OPTICOM PHASE SELECTOR MODULES (2 CHANNEL UNITS ONLY) ON NEW FOUNDATION. REMOVE EXISTING CONDUITS INTO CONTROLLER CABINET AND INSTALL TWO (2) NEW 3.5" CONDUITS.
- 2- INSTALL DUAL EP-COMPAKBB2.4/4.9 RADIO WITH (2)-23 DBI 2.4GHZ PANEL ANTENNAS ON SIGNAL POLE. EXACT PLACEMENT OF ANTENNAS SHALL BE DETERMINED BY THE RADIO MANUFACTURER'S REPRESENTATIVE IN THE FIELD. RUN CAT-5E CABLE IN EXISTING CONDUIT TO CONTROLLER CABINET.
- 3- INSTALL MCCAIN SERIAL TERMINAL SERVER AND RADIO POWER SUPPLY WITH LIGHTNING AND SURGE PROTECTION.
- 4- REMOVE EXISTING PULL BOX AND REPLACE WITH NEW NO. 6E PULL BOX. (SEE SPECIAL PROVISIONS)



TRAFFIC No. 1575
 DATE: 3-2-07
 AGA Job No. : 134-014
 AGA File Name: Magnolia WiFi
 Print Date : 3/2/07
 Last Revision : 2/26/07

ALBERT GROVER & ASSOCIATES
 TRANSPORTATION CONSULTING ENGINEERS
 211 E. Imperial Hwy., Suite 208 Fullerton, CA 92835
 (714) 992-2990
 FAX 992-2883

CONTRACT TE-06-01

CITY OF RIVERSIDE, CALIFORNIA DEPARTMENT OF PUBLIC WORKS		TRAFFIC SIGNAL INTERCONNECT PLAN	ACCOUNT NO.
APPROVED BY: DATE: 3-7-07 TRAFFIC DIVISION: ENCLAVE/BERNARD MARALON 5/2/07		MAGNOLIA AVENUE BUCHANAN STREET TO BANBURY DRIVE	X-059 SHEET 10 OF 12
APPROVED BY: DATE: 5/14/07			
DESIGNED BY: RPH DRAWN BY: RPH CHECKED BY: JAT		HORIZ. SCALE: 1" = 40' VERT. SCALE: N/A	

Underground Service Alert
 Call TOLL FREE
 1-800-227-2600
 TWO WORKING DAYS BEFORE YOU DIG