

Match Line

La Sierra High School

Install W17 signs and Stop Ahead Markings 470' from Cochran Stop

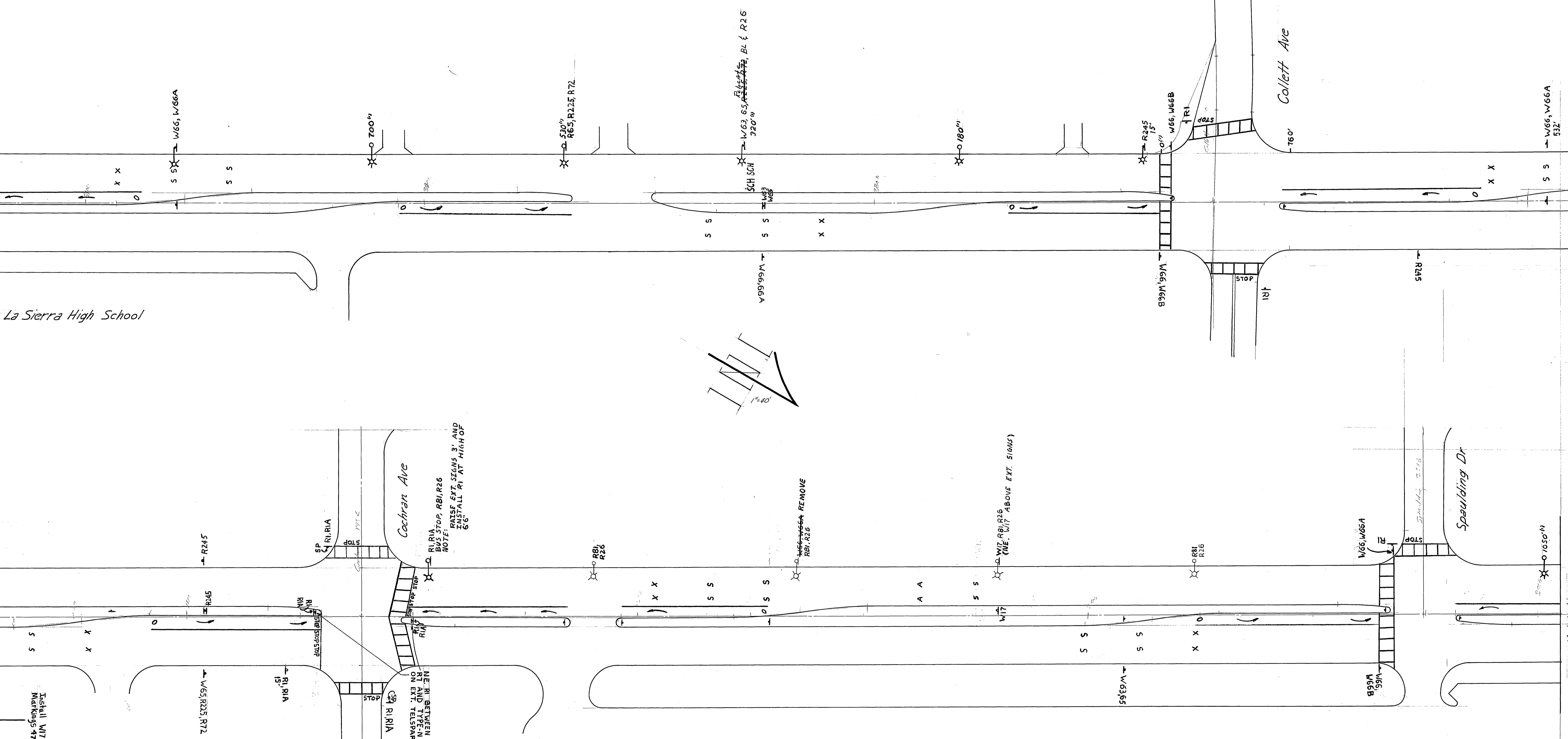

ADD =  
REMOVE =

La Sierra High School

City of Riverside  
 Traffic Engineering Division  
 3900 Main Street  
 Riverside, California 92522

**LA SIERRA AVENUE**  
 S/4 COCHRAN to N/4 COLLETT  
 D. Ray 3/28/79

- MAJOR WORK ITEMS
- 1) INSTALL SIGNS AND MARKINGS FOR 4-WAY STOP AT COCHRAN.
  - 2) REPAINT ALL CROSSWALKS AND "SLOW SCHOOL X-ING" PAVEMENT MARKINGS.
  - 3) ADD ON THE SPOT STRIPING FOR CROSSWALKS AT COLLETT AND SPAULDING.
  - 4) ADD LEFT TURN LANE MARKINGS AT MERIAN OPENINGS AT CLARKSDALE SPAULDING AND THE CHURCH DRIVEWAY SOUTH OF COLLETT.

XL-102

Match Line