

12.90
10.55
14.80

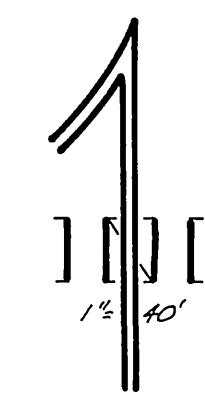
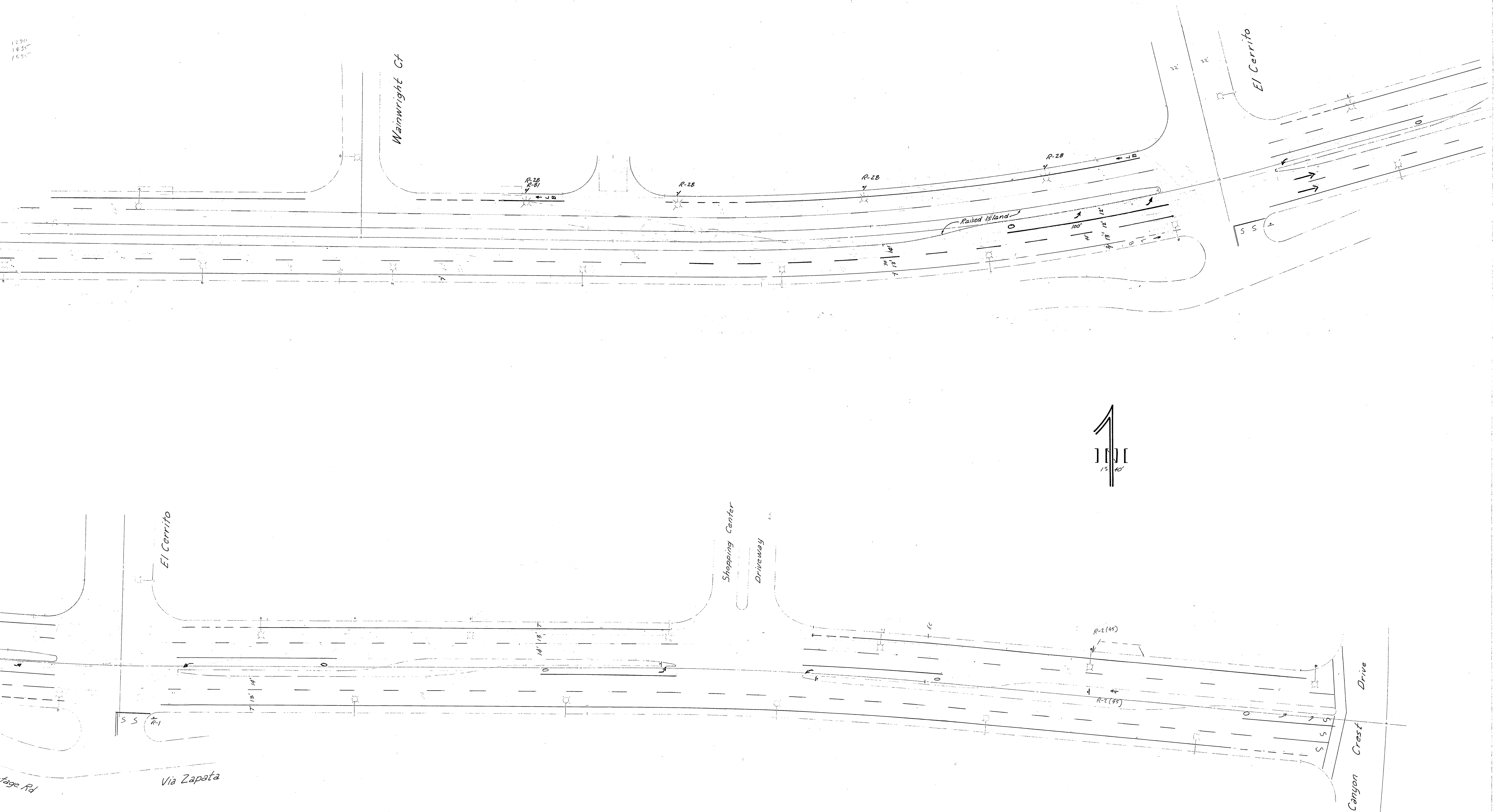

City of Riverside
Traffic Engineering Division

**Central Avenue Striping
Canyon Crest to Chapala**

Date: 7/24/80, By: D. Ray, Approved: _____

XL-107

Work Orders 80-S-119, 80-P-76, 80-P-77 & 80-M-62
 (1) Revised per WO 80-S-145 9/18/80 D. Ray
 Revised 8/23/81: W'Ly, Barrel, El Cerrito to Wainwright
 for sandblasting & striping & signing revisions
 Revised Per Plan (Jib) R-2428 3/82

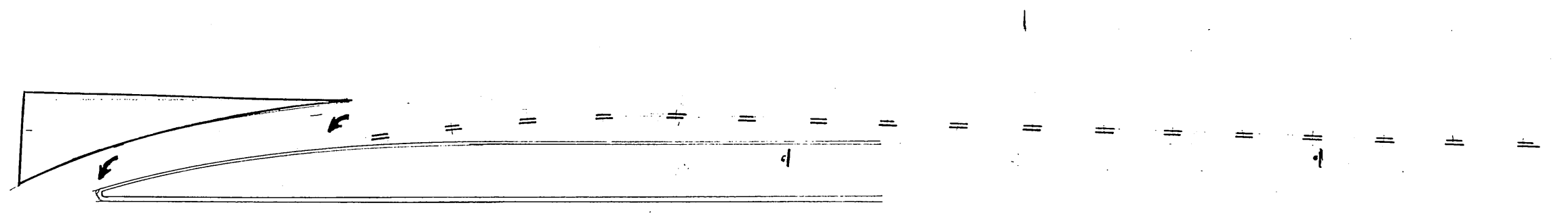
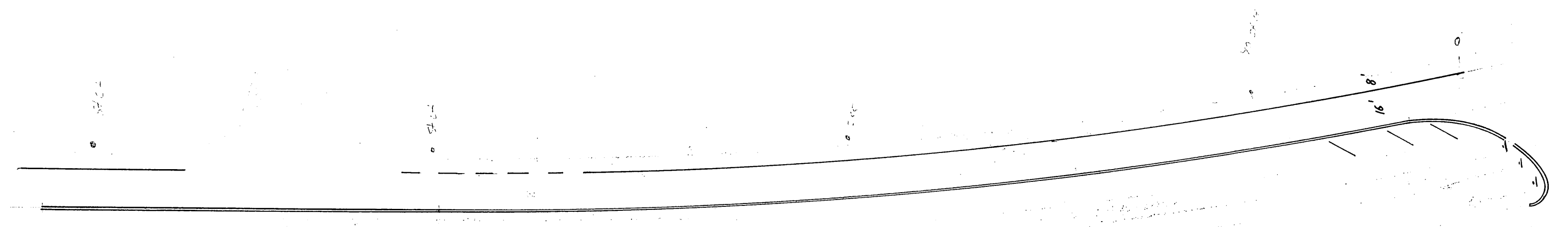

107
 107
 107