

CORRECTED EXISTING STRIPING ALL ST MARKS EXIST (1/20/12)		<b>CITY OF RIVERSIDE</b>		<b>STRIPING PLAN</b>		ACCOUNT NO. 30-575-37-000	
DESIGNED BY _____		DRAWN BY G.J.		CHECKED BY _____		<b>JURUPA AVE</b>	
						<b>XL-121</b>	

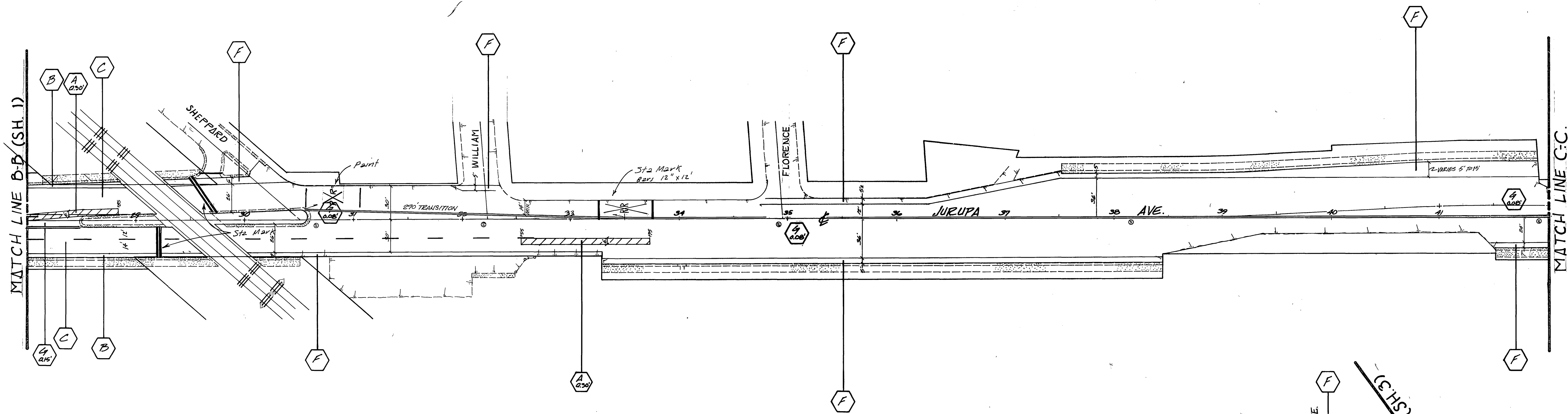

Note: \*  
Striping is on Q except in transition.

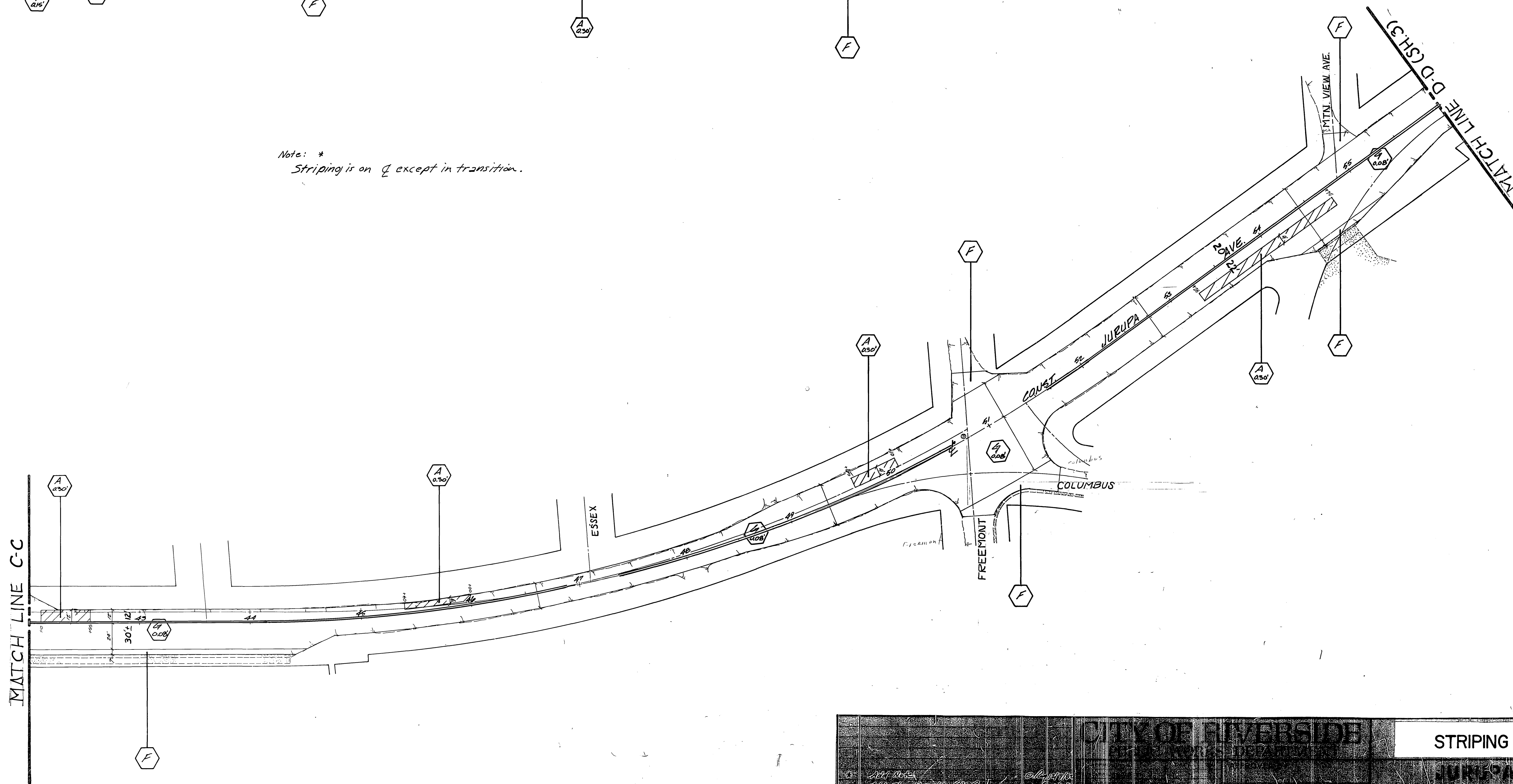

DESIGNED BY: <i>[Signature]</i> DRAWN BY: <i>[Signature]</i> CHECKED BY: <i>[Signature]</i>	COUNTY NO. 30-575-077-09	STRIPING PLAN	XL-121
		JURUPA AVE	

Sta Mark 445

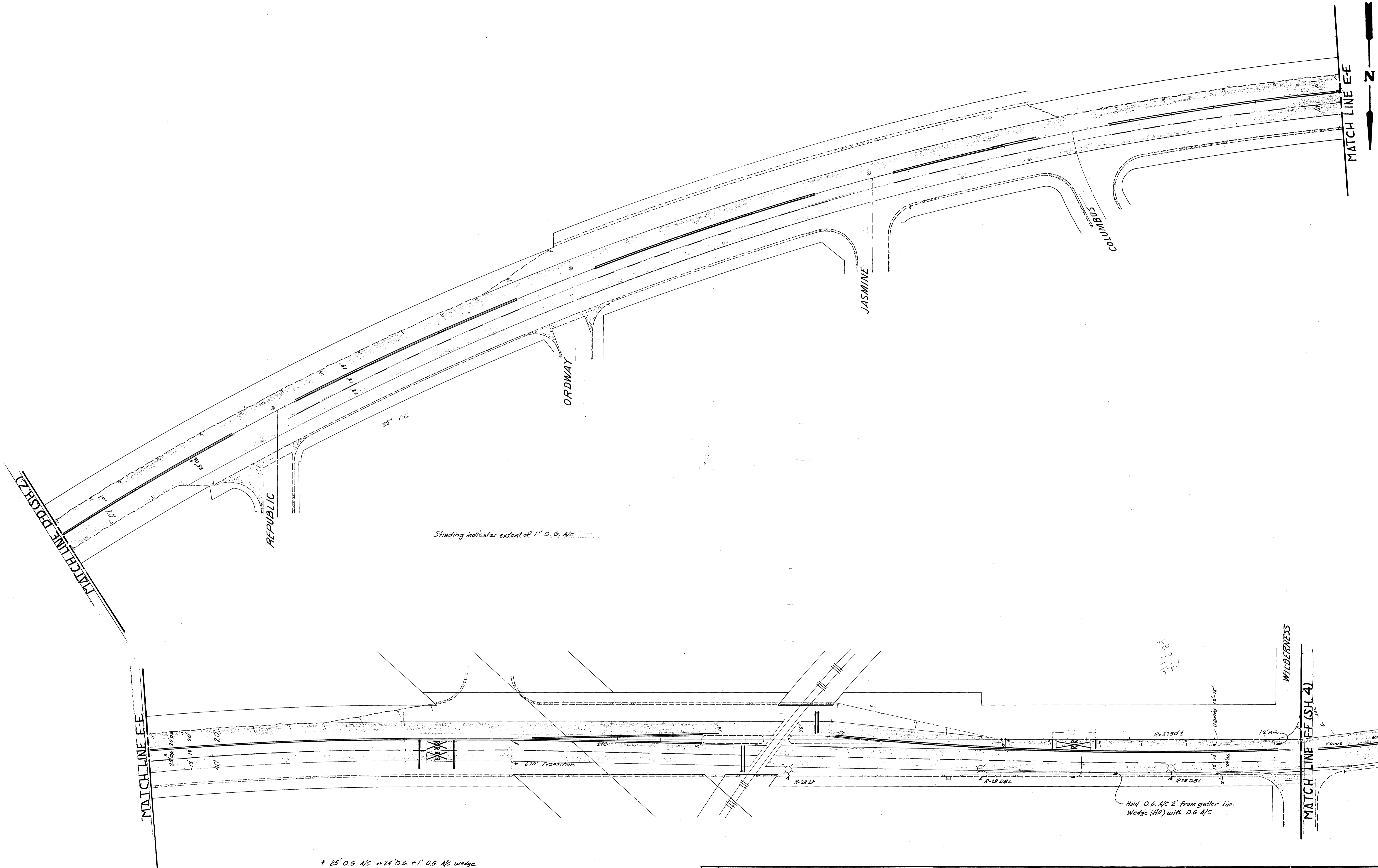

<b>CITY OF RIVERSIDE</b> PUBLIC WORKS DEPARTMENT			<b>STRIPING PLAN</b> <b>JURUPA AVE.</b> DEERFIELD TO VAN BUREN		ACCOUNT NO. 30-575-377-09 <b>XL-121</b> SHEET <u>3</u> OF <u>4</u>
APPROVED BY PRINCIPAL ENGINEER		DATE	APPROVED BY PUBLIC WORKS DIRECTOR		
Add 2nd westbound Lane		12/2/82	DATE 12/2/82		
MARK	REVISIONS	APPR. DATE	DESIGNED BY: <u>D. Ray</u> DRAWN BY: <u>D. Ray</u> CHECKED BY: <u>D. Ray</u>		
TRAFFIC DIVISION		CHIEF P. W. ENGINEER			
HORIZ. SCALE: 1" = 50' 50'			VERT. SCALE: 1" = 5'		

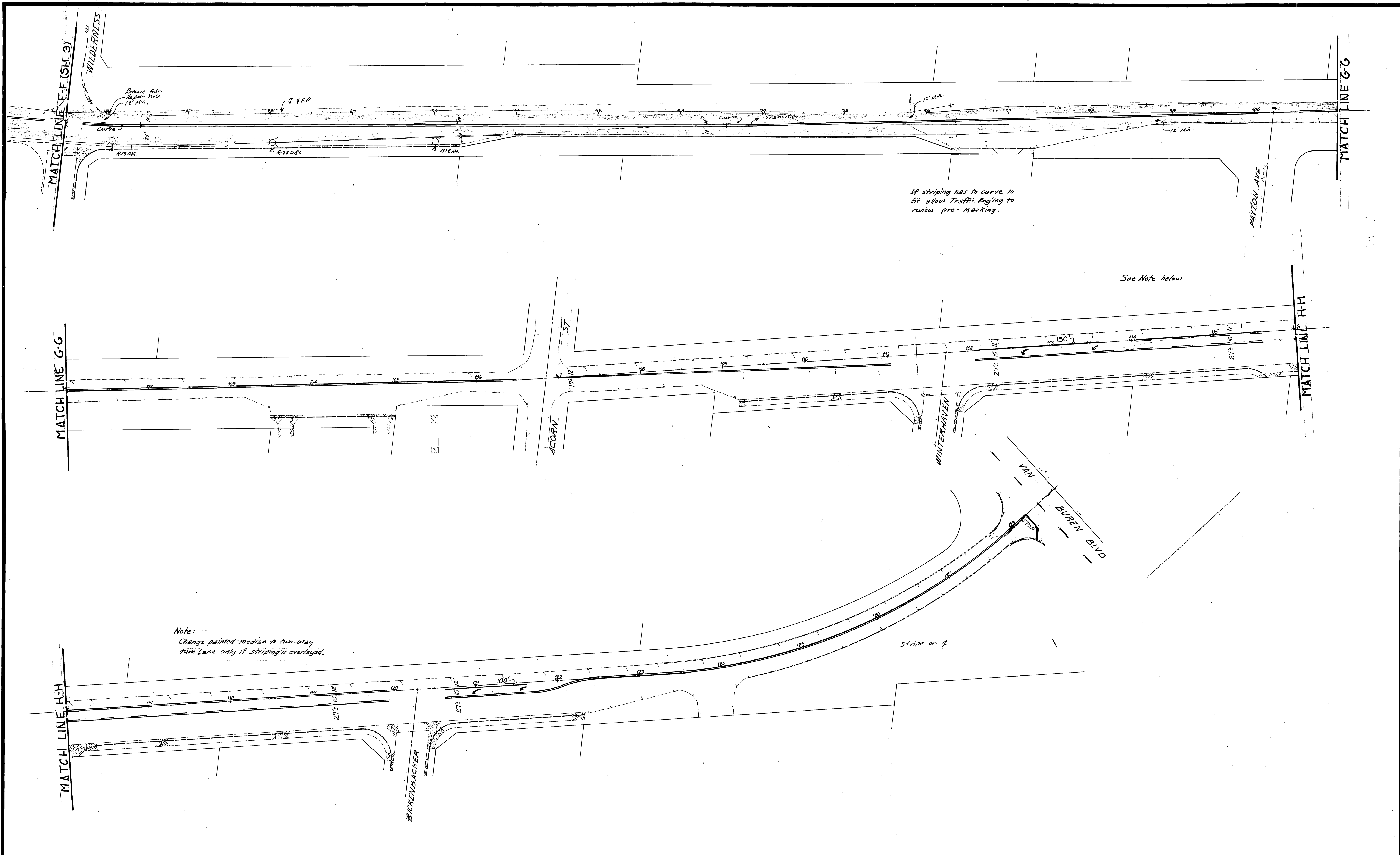

If striping has to curve to fit allow Traffic Eng'g to review pre-Marking.

See Note below

Note:  
Change painted median to two-way turn Lane only if striping is overlaid.

Stripe on  $\phi$

<b>CITY OF RIVERSIDE</b> PUBLIC WORKS DEPARTMENT				<b>STRIPING PLAN</b> <b>JURUPA AVE.</b> DEERFIELD TO VAN BUREN		ACCOUNT NO. 30-575-377-09  <b>XL-121</b> SHEET 4 OF 4
APPROVED BY _____ DATE _____ BY _____		APPROVED BY _____		PUBLIC WORKS DIRECTOR		
PRINCIPAL ENGINEER		DATE 12/2/02		HORIZ. SCALE: 1" = 50' 50 VERT. SCALE: 1" = 0'		
PARK DEPARTMENT		CHIEF P. W. ENGINEER		DESIGNED BY <i>D. R. M.</i> DRAWN BY <i>G. J.</i> CHECKED BY <i>D. R. M.</i>		