

**TRAFFIC CONTROL QUANTITIES**

<u>Striping</u>	
Double Yellow, 2-4"	3540 L.F.
Two-way Turn Lane, 2-4"	0 L.F.
Single Yellow, 4"	0 L.F.
White Lane line, 4" skip	1844 L.F.
Solid White, 4"	2010 L.F.
8" White Barrier	270 L.F.
<u>Pavement Markings</u>	
12" White or Yellow (x-walks, etc)	700 ft <sup>2</sup>
Arrow Stencils (4 ea)	64 ft <sup>2</sup>
Word Stencils (0 ea)	0 ft <sup>2</sup>
High Visibility x-walks (0 ea)	0 ft <sup>2</sup>
<b>Total</b>	<b>764 ft<sup>2</sup></b>
<u>Raised Reflective Pavement Markers</u>	
2-way Amber	0 ea
1-way Amber	0 ea
1-way Clear	0 ea
Signs - new installations	0 ea
<u>Striping Removal</u>	0 ft <sup>2</sup>

**NOTE:**  
 SPEED LIMIT 35 MPH 7' PAINT  
 17' GAP  
 TRAFFIC SIGNS SHOWN ARE EX-  
 ISTING.

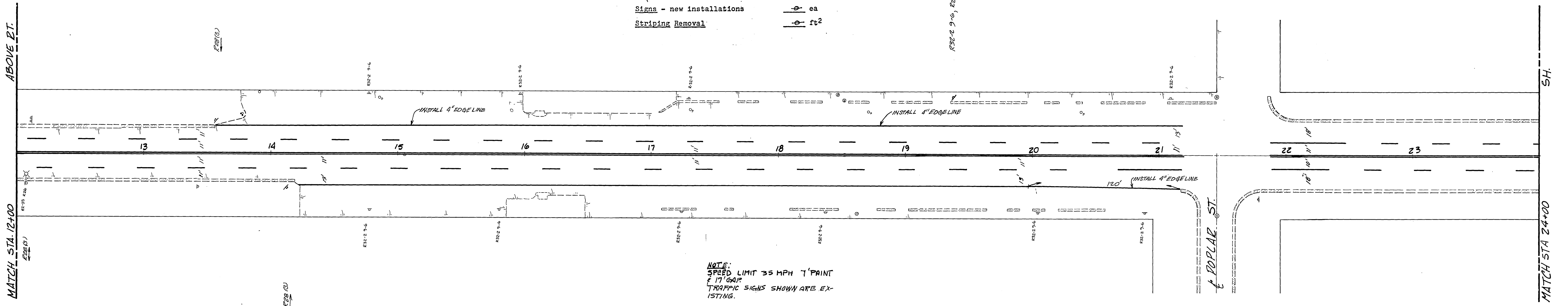

<b>CITY OF RIVERSIDE</b>		STRIPING PLAN	ACCOUNT NO. 30-575-205-07
<b>PUBLIC WORKS DEPARTMENT</b>		<b>MAIN ST.</b>	
APPROVED BY PRINCIPAL ENGINEER DATE: 7/18/83		APPROVED BY PUBLIC WORKS DIRECTOR DATE: 8/1/83	
DESIGNED BY: <i>M.W.D.</i> DRAWN BY: <i>W.C.C.</i> CHECKED BY: <i>D.P.K.</i>		THIRD ST. TO FWY. 60	
REVISIONS		HORIZ. SCALE: 1" = 40' VERT. SCALE: 1" =	
MARK		SHEET 1 OF 2	

R-7489 23 1 40

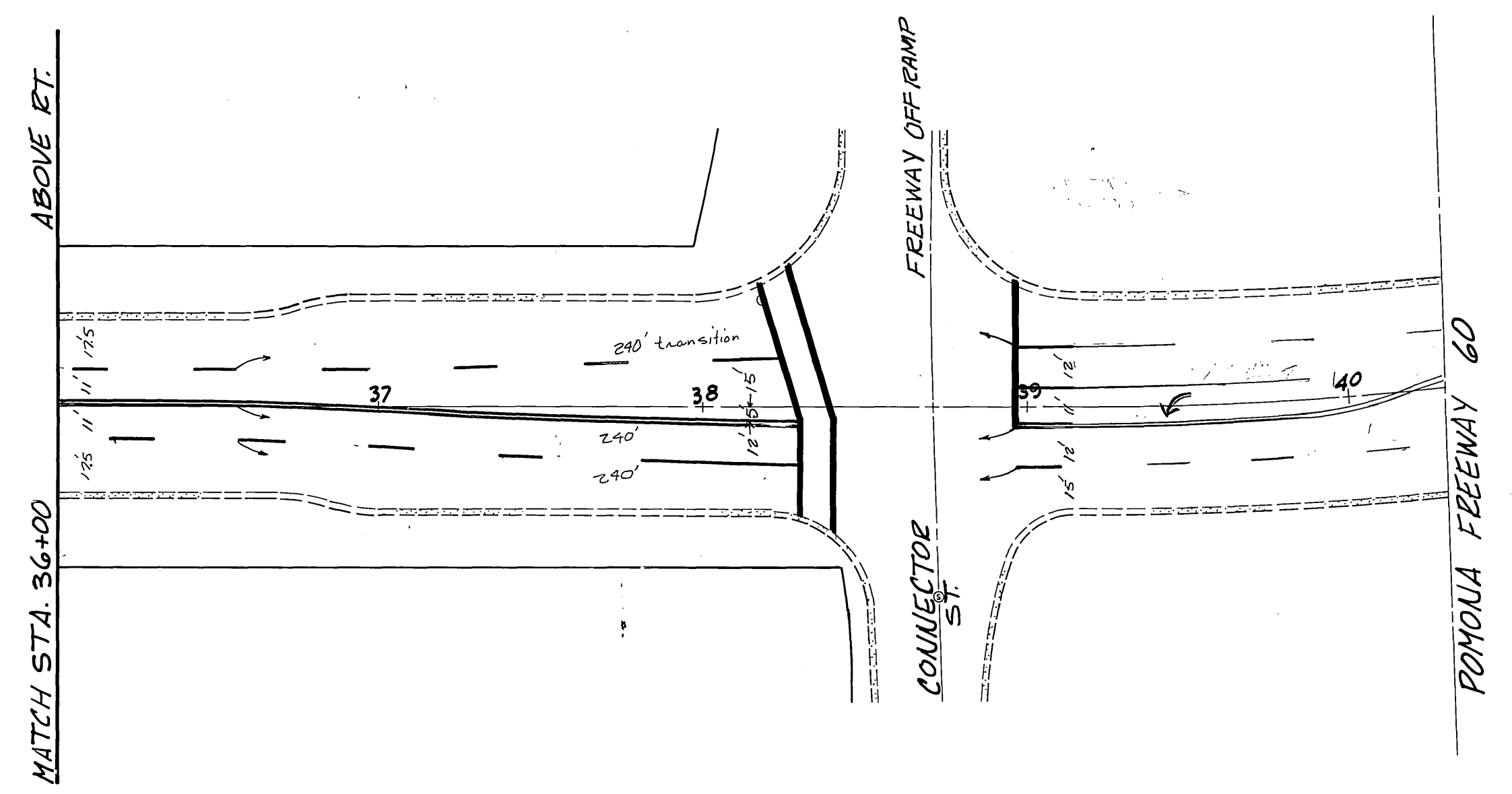
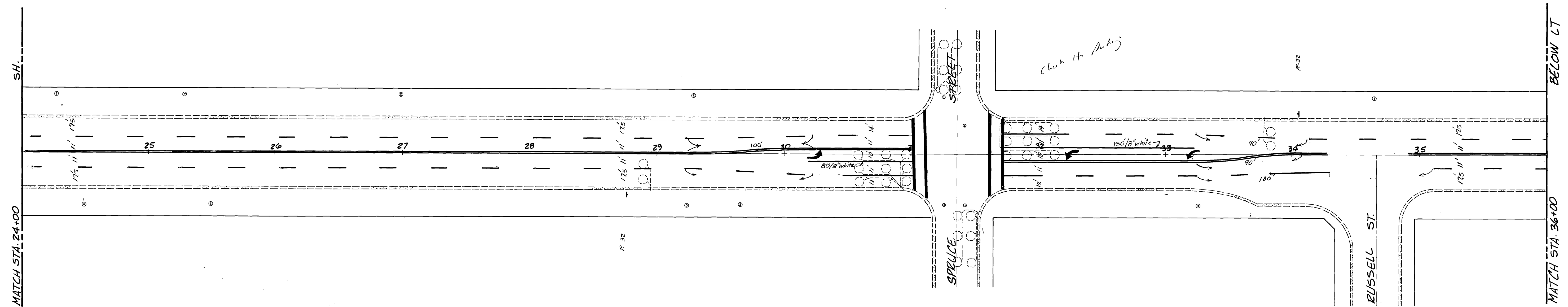
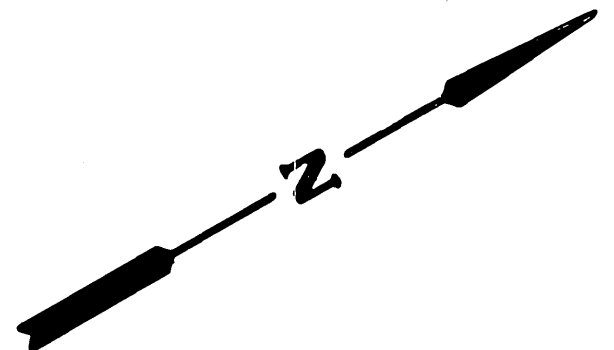

		<b>CITY OF RIVERSIDE</b>		STRIPING PLAN		ACCOUNT NO. 30-575-205-07
		PUBLIC WORKS DEPARTMENT		<b>MAIN ST.</b>		XL-126
		APPROVED BY PRINCIPAL ENGINEER DATE 8/16/83 TRAFFIC DIVISION CHIEF P.W. ENGINEER		APPROVED BY PUBLIC WORKS DIRECTOR DATE 8/1/83		SHEET 2 OF 2
DESIGNED BY M4/O2		DRAWN BY G24		CHECKED BY		HORIZ. SCALE: 1" = 40' VERT. SCALE: 1" =