

PROFILE	SUBMITTED	DATE
NO.	BY	
NOTE BOOK	PLOTTED	
STATIONING	GRADES CHECKED	
CHICAGO & OTTAWA CHRD.	BY	

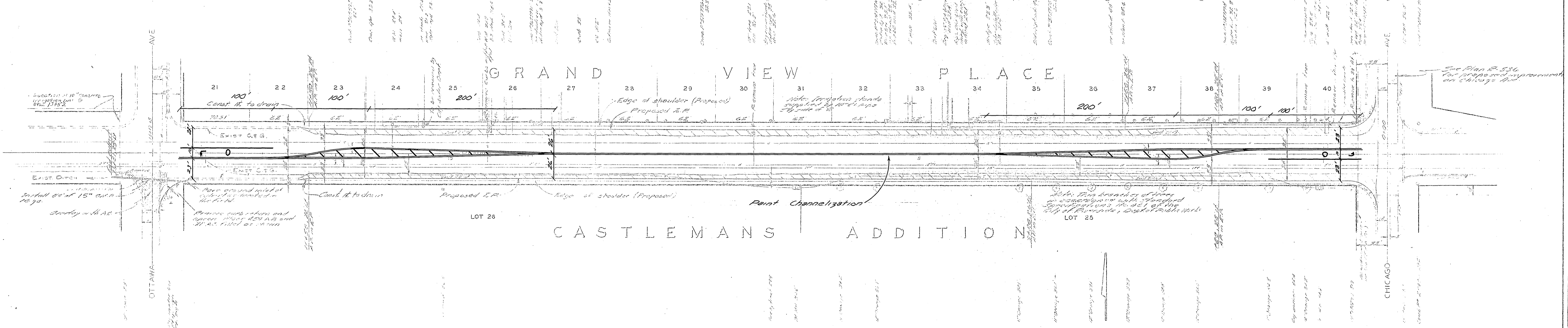

PLAN	SUBMITTED	DATE
NO.	BY	
NOTE BOOK	PLOTTED	
ALIGNMENT CHECKED	BY	
HT. OF W.V. CHECKED	DATE	

NOTE
1. WATER METERS AND BOXES TO BE RELOCATED BY WATER DEPT., CITY OF RIVERSIDE.
2. RELOCATE ROAD SIGNS AND MAIL BOXES AS DIRECTED BY ENGINEER.

REVISIONS			CITY OF RIVERSIDE, CALIFORNIA DEPARTMENT OF PUBLIC WORKS
MARK	DATE	DESCRIPTION	
			PENNSYLVANIA AVENUE WIDENING CHICAGO AVE TO OTTAWA AVE

DESIGNED BY	SUBMITTED BY	APPROVED BY	PROJ. NO. 3052
DRAWN BY	PARK DEPT. TRAFFIC DIV.	<i>[Signature]</i>	XL-75
CHECKED BY	RECOMMENDED BY	DATE 5-20-63	

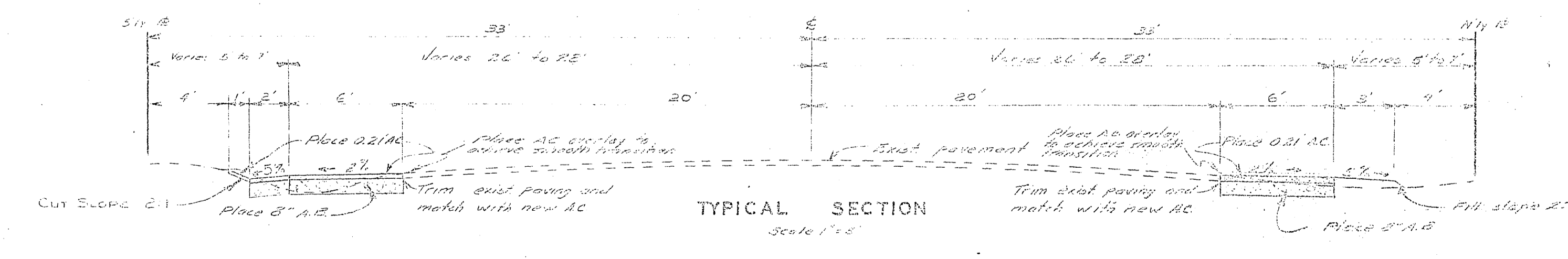

TYPICAL SECTION
Scale 1"=5'

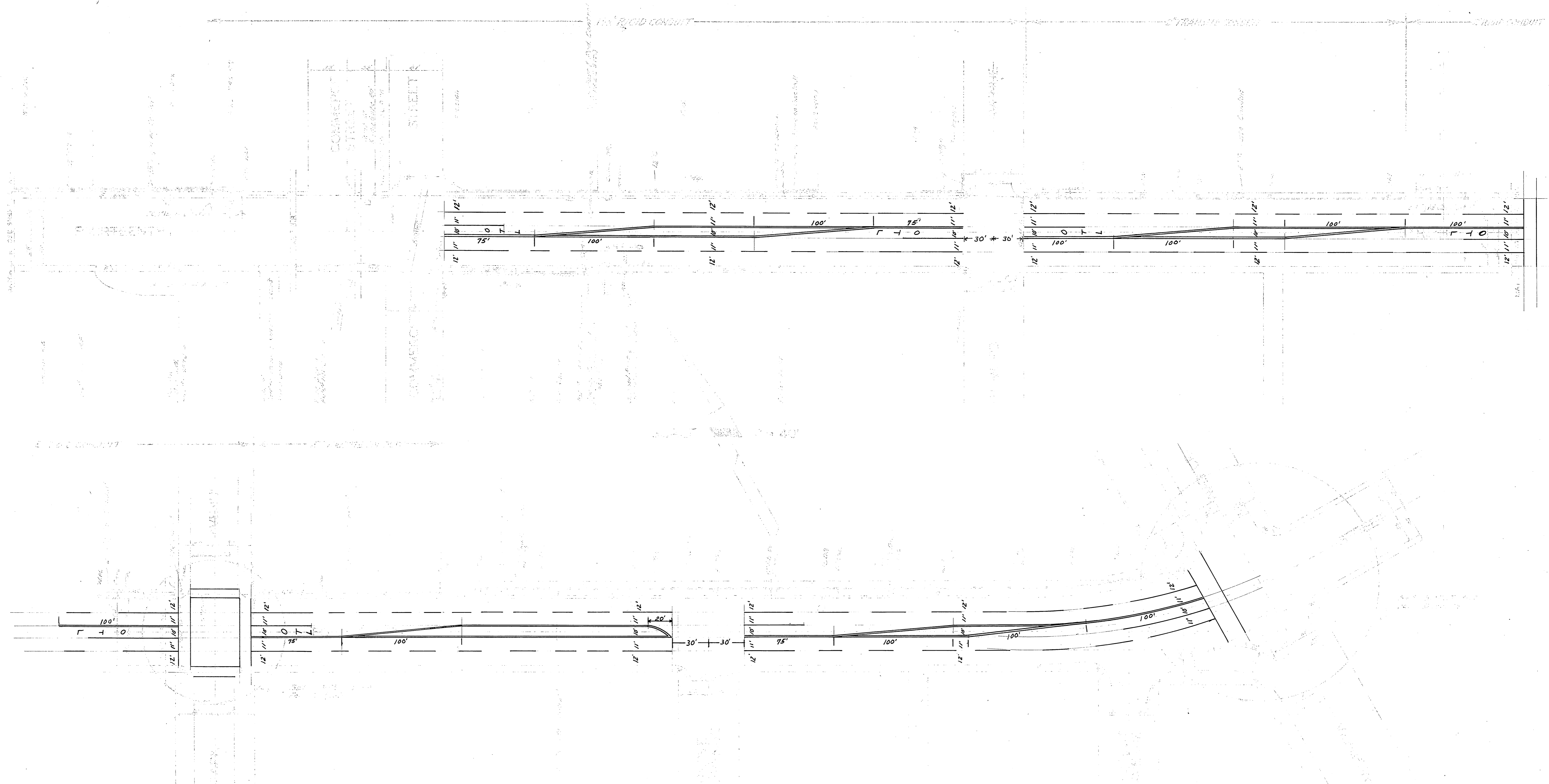

STRIPING PLAN

XL-15

2 of 5

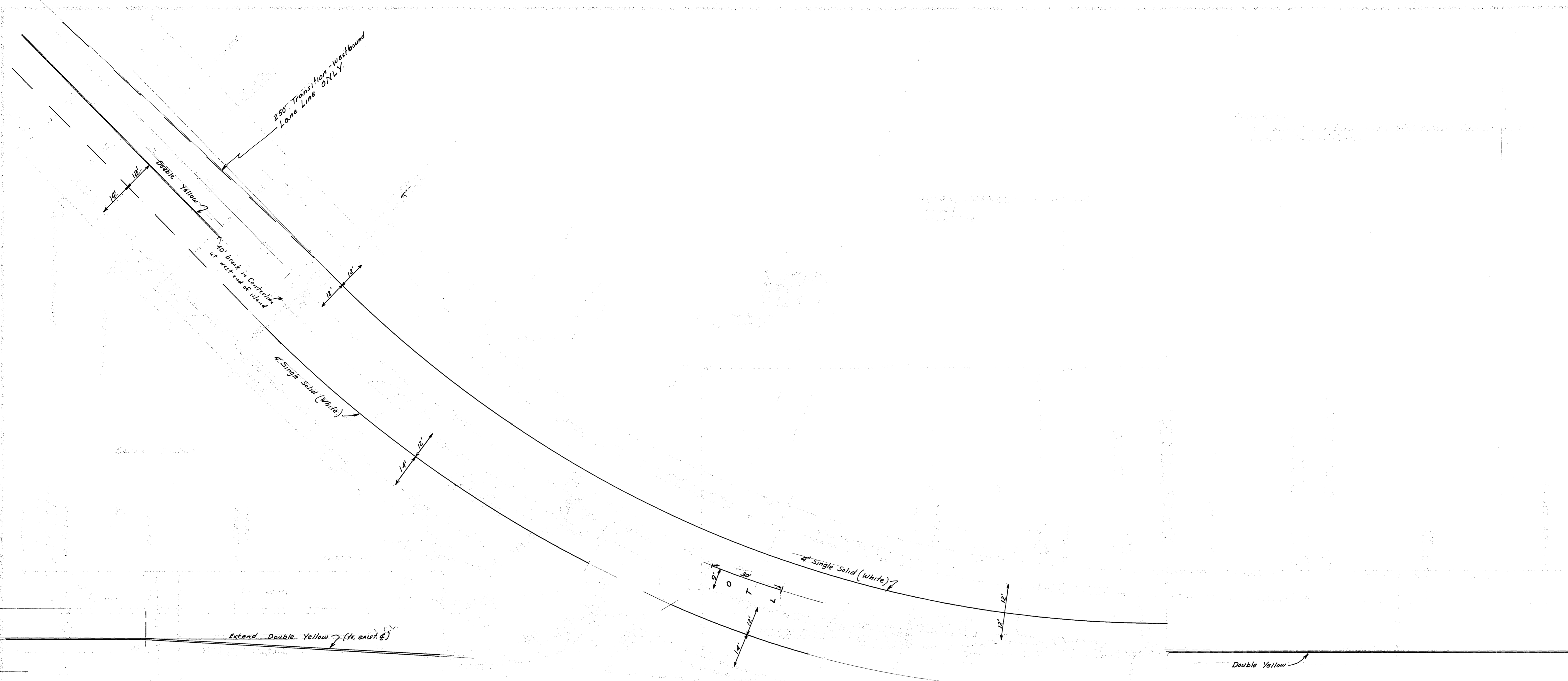

STRIPING PLAN

XL-15

4 5

See New Sheet ↴

See Work Order for all striping
East of Chicago Ave.

400' No Passing yellow line
for west bound traffic

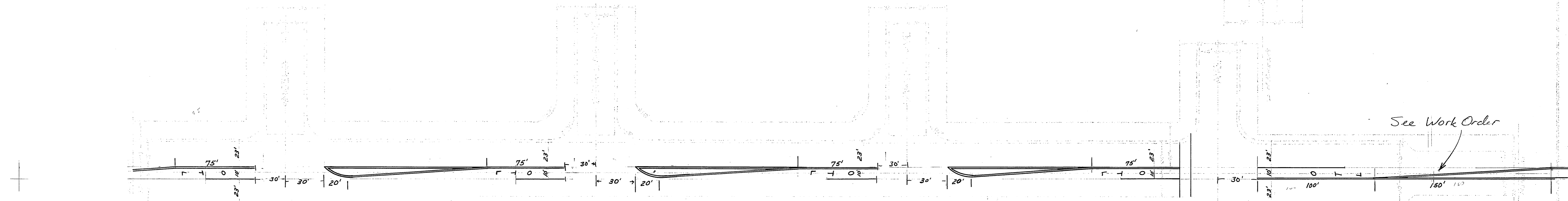
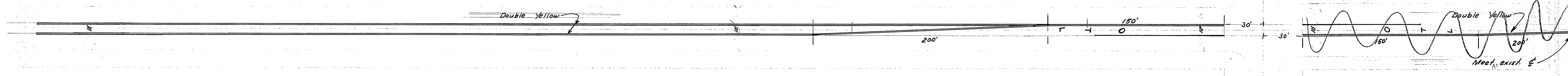

NOTE:
All double lines to be solid yellow.

SCALE: 1" = 30'

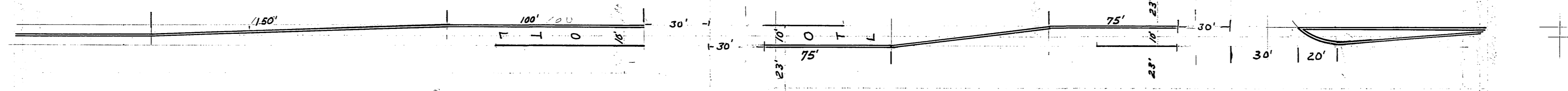

73
23
66'

PROJECT NO.	CITY OF CHICAGO
DATE	ENGINEER
HIGH STREET KANSAS AVE CHICAGO, ILL.	
STRIPING PLAN	
PROJECT NO.	21-15
DATE	5 5