

See Notes Sheet 2

STRIPING PLAN

REHABILITATION OF MAJOR CITY STREETS 1984

MARKET STREET
FIRST TO 1,450' N OF RIVERA

ACCOUNT NO. 30-875-344-07

XL-150

SHEET 1 OF 2

CITY OF RIVERSIDE
PUBLIC WORKS DEPARTMENT

APPROVED BY	DATE	APPROVED BY	DATE
PRINCIPAL ENGINEER	8/8/84	PUBLIC WORKS DIRECTOR	8/8/84
PARK DEPARTMENT			
TRAFFIC DIVISION			
CHIEF P.W. ENGINEER			

MARK	REVISIONS	APPR. DATE

DESIGNED BY *D. Pen.* DRAWN BY *St. Lab.* CHECKED BY *D. Pen.*

HORIZ. SCALE: 1" = 40' VERT. SCALE: 1" =

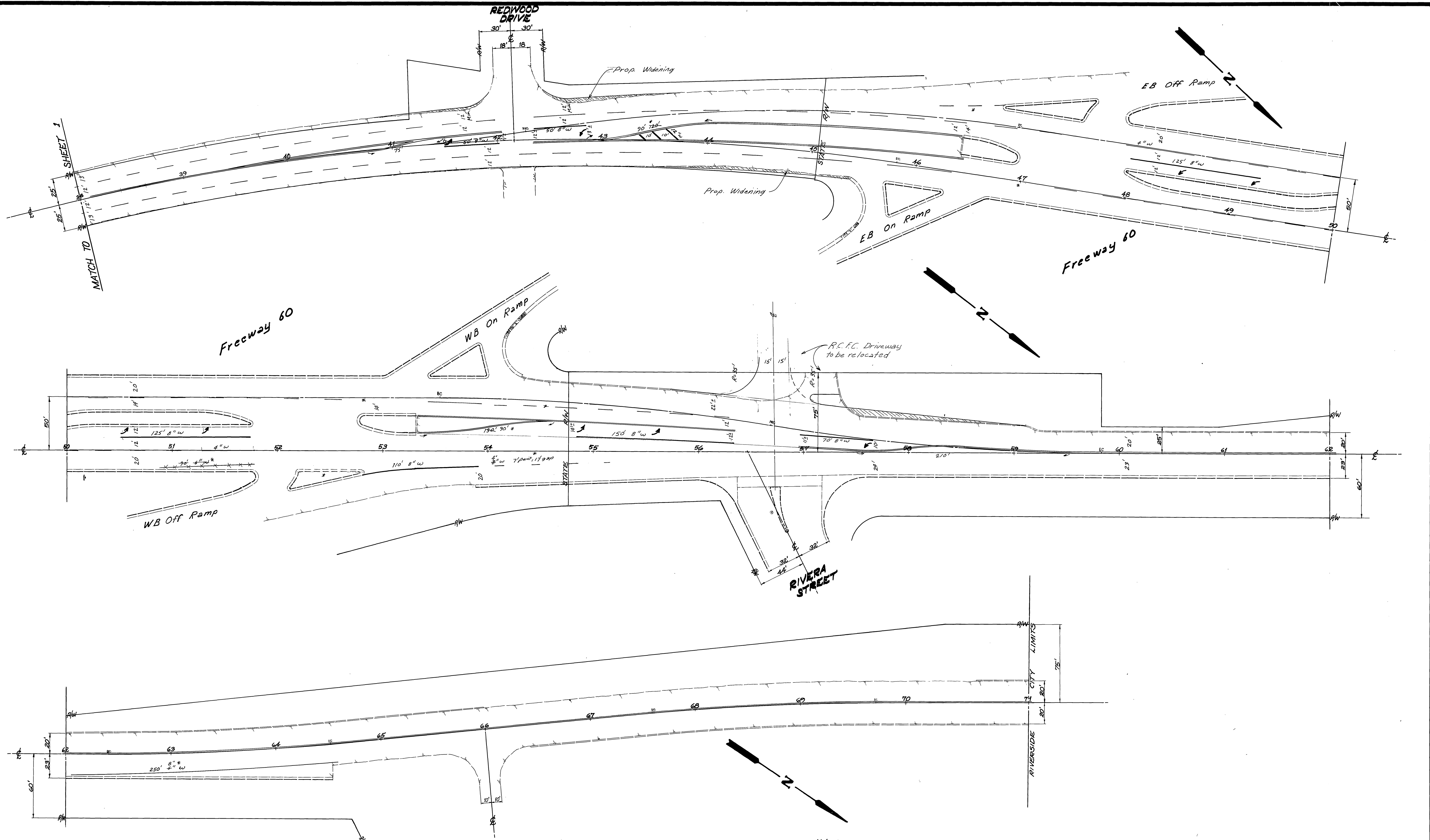

- Notes:
- Speed Limit 45 M.P.H.
Stripe 12' gap 36'
 - Raised Reflective Pavement Markers:
Double yellow - 2-way lane bow 24' O.C.
White dash & 8" white - 1 way clear 24' O.C.
8" white - 1 way clear 12' O.C.

DESIGNED BY <i>D. Rey</i> DRAWN BY <i>[Signature]</i> CHECKED BY <i>D. Rey</i>		CITY OF RIVERSIDE PUBLIC WORKS DEPARTMENT		STRIPING PLAN REHABILITATION OF MAJOR CITY STREETS 1984 MARKET STREET FIRST TO 1450' N OF RIVERA		ACCOUNT NO. 30-875-244-01 XL-150 SHEET <u>2</u> OF <u>2</u> <i>formerly R-2539</i>	
APPROVED BY	DATE	BY	APPROVED BY	DATE	BY	DATE <i>8/17/84</i>	
PRINCIPAL ENGINEER	<i>8/17/84</i>	<i>[Signature]</i>	PUBLIC WORKS DIRECTOR			HORIZ. SCALE: 1" = 40' VERT. SCALE: 1" =	
REVISIONS	APPR.	DATE	TRAFFIC DIVISION	8-2-84	RLS		
			CHIEF P. W. ENGINEER	<i>[Signature]</i>	<i>[Signature]</i>		