

MATCH LINE

STA. 5+50

MATCH LINE

STA. 5+50

- Striping Plan Notes**
- Remove existing striping & markings not removed or covered by paving operations except as shown "repaint" or "exist." Overlay is from sta. -2+00 to 10+10, gutter lip to gutter lip.
 - Lane lines are 7" paint, 17" gap.
 - R11/R11A signs shall be reinstalled permanently or temporarily immediately when removed to preserve the integrity of the wrong way sign package.

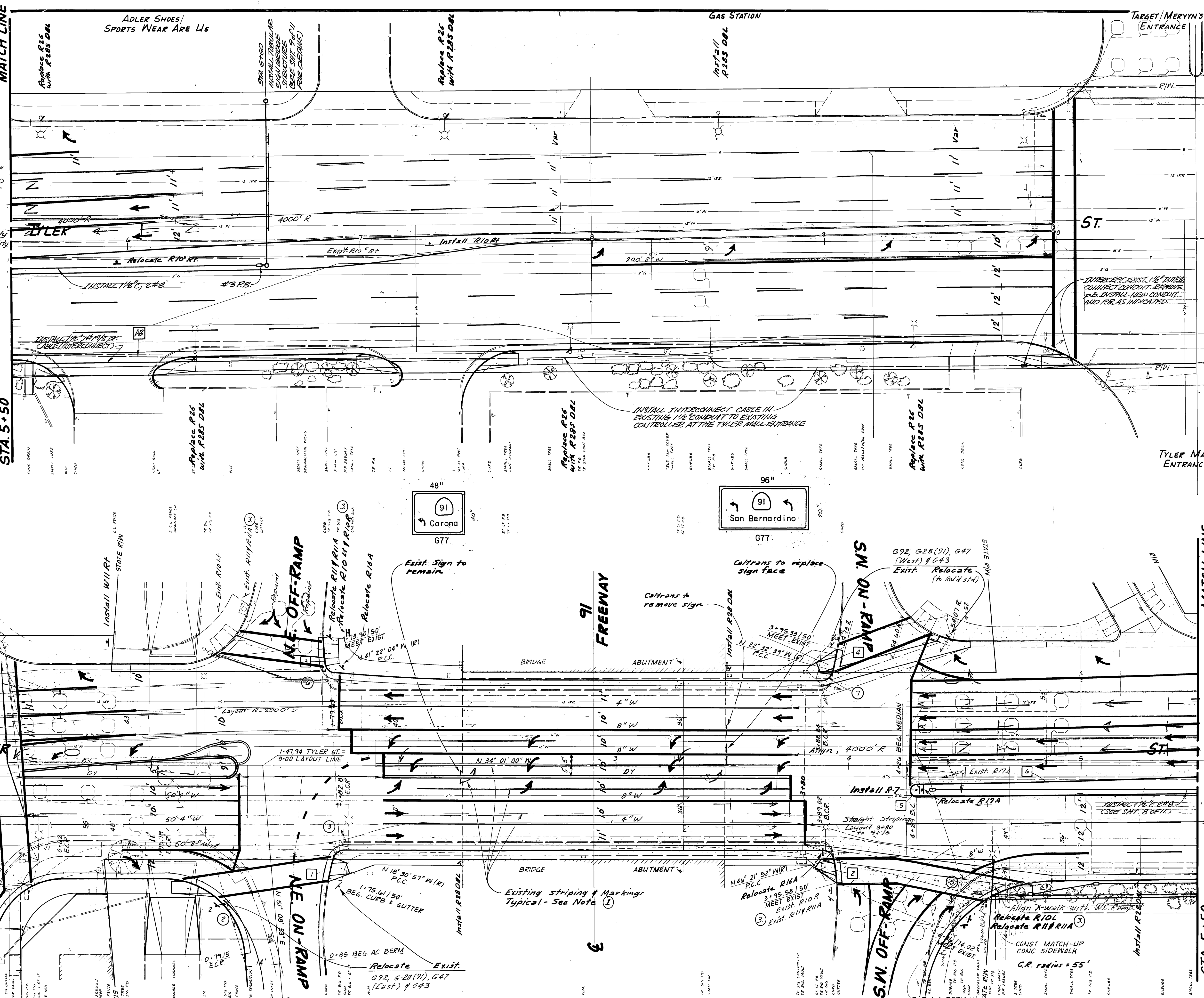

CURVE DATA

No.	R	Δ	L	T
1	120'	05° 03' 57"	10.61'	5.31'
2	100'	05° 51' 04"	10.21'	5.11'
3	100'	05° 32' 35"	9.67'	4.84'
4	120'	04° 50' 01"	10.12'	5.06'
5	3'	90° 00' 00"	4.71'	3'
6	4000'	2° 31' 25"	176.18'	88.10'

CURB RETURN DATA

No.	R	Δ	L	T
1	30'	90° 00' 03"	47.12'	30.00'
2	35'	85° 09' 53"	52.02'	32.16'
3	5'	74° 29' 57"	6.50'	3.80'
4	5'	79° 39' 08"	6.78'	4.02'
5	35'	72° 45' 38"	44.45'	29.74'
6	5'	82° 38' 56"	7.21'	4.40'
7	5'	78° 31' 39"	6.85'	4.09'

SEE SHEET 9
N.E. FREEWAY ON-RAMP

This plan accurate
for striping, markings
and signing only

<p>CITY OF RIVERSIDE PUBLIC WORKS DEPARTMENT</p>		<p>TYLER STREET WIDENING AND MEDIAN RELOCATION PHASE II STRIPING - TYLER STREET</p>	
<p>APPROVED BY PRINCIPAL ENGINEER PARK DEPARTMENT TRAFFIC DIVISION CHIEF P.W. ENGINEER</p>	<p>DATE APPR. DATE</p>	<p>APPROVED BY <i>William D. Gardner</i> PUBLIC WORKS DIRECTOR</p>	<p>DATE JUNE 3, 1985</p>
<p>DESIGNED BY: <i>D.P.</i> DRAWN BY: <i>D.P.</i> CHECKED BY:</p>		<p>HORIZ. SCALE: 1" = 20' VERT. SCALE: 1" = 4'</p>	
		<p>ACCOUNT NO. 30 573-309 06 XL-156 (R-2665) SHEET 1 OF 2</p>	

TRAFFIC CONTROL QUANTITIES

Striping	
Double Yellow, 2-4"	665 L.F.
Two-way Turn Lane, 2-4"	0 L.F.
Single Yellow, 4"	1775 L.F.
White Lane line, 4" skip	785 L.F.
Solid White, 4"	2360 L.F.
8" White Barrier	1870 L.F.
Pavement Markings	
12" White or Yellow (x-walks, etc)	1350 ft ²
Arrow Stencils (53ea)	820 ft ²
Word Stencils (0 ea)	0 ft ²
High Visibility x-walks (0 ea)	0 ft ²
Total	2170 ft²
Raised Reflective Pavement Markers	
2-way Amber	0 ea
1-way Amber	33 ea
1-way Clear	11 ea
Signs - new installations (0)	0 ea
Striping Removal	300 ft²
Type G Delineators	9 ea.

(1) Not including sign bridge and freeway bridge.

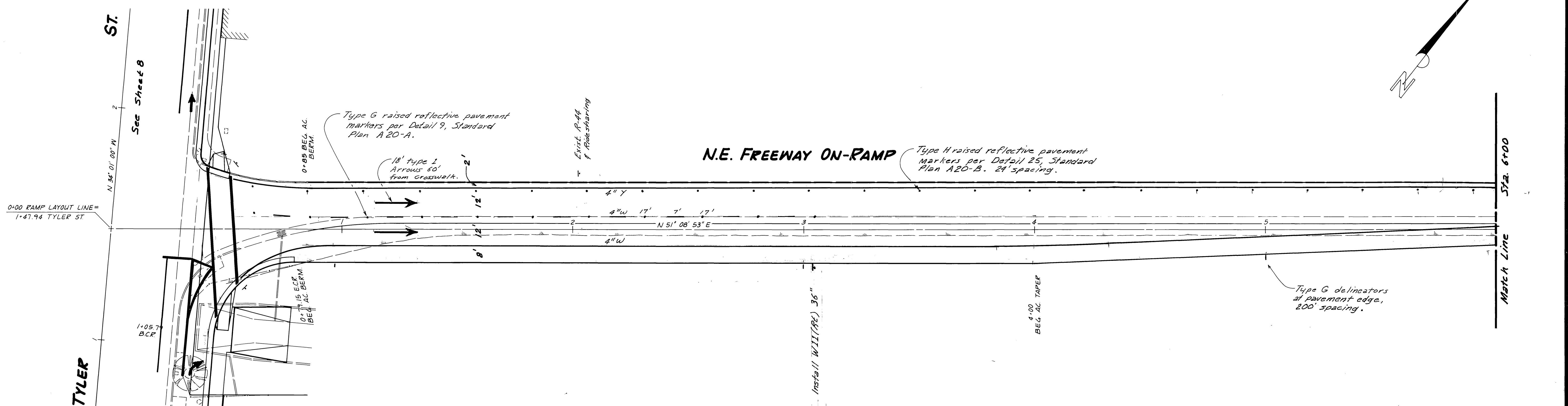
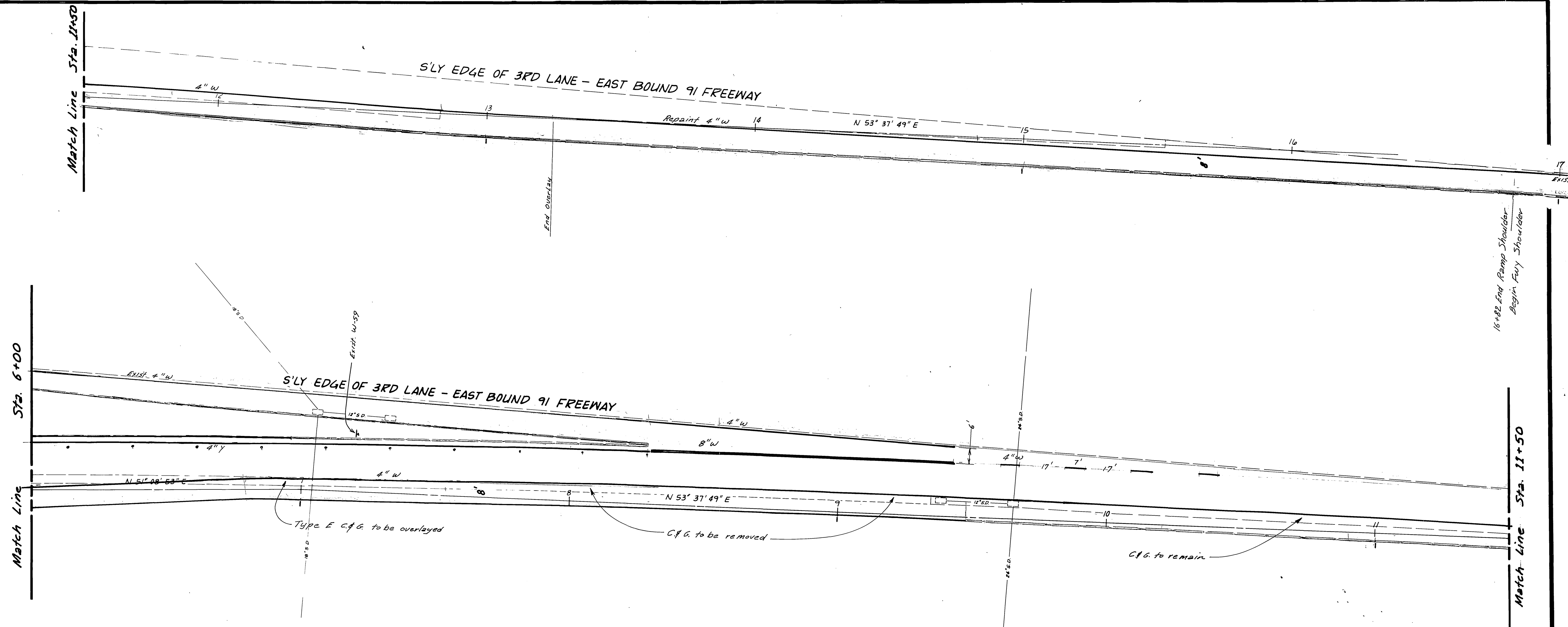

CITY OF RIVERSIDE PUBLIC WORKS DEPARTMENT		TYLER STREET WIDENING AND MEDIAN RELOCATION PHASE II STRIPING - N.E. ON-RAMP		ACCOUNT NO. 30-575-301-00 XL-156 (R-2665) SHEET 2 OF 2
APPROVED BY PRINCIPAL ENGINEER MARK DEPARTMENT TRAFFIC DIVISION CHIEF P.W. ENGINEER	DATE -- -- -- -- -- --	APPROVED BY William D. Gardner PUBLIC WORKS DIRECTOR	DATE JUNE 3, 1985	HORIZ. SCALE: 1" = 20' VERT. SCALE: 1" = 4'
DESIGNED BY <i>D. Rep</i> DRAWN BY <i>Dan/DR</i> CHECKED BY	REVISIONS APPR. DATE	INDEX UP		