

EUCALYPTUS AVENUE

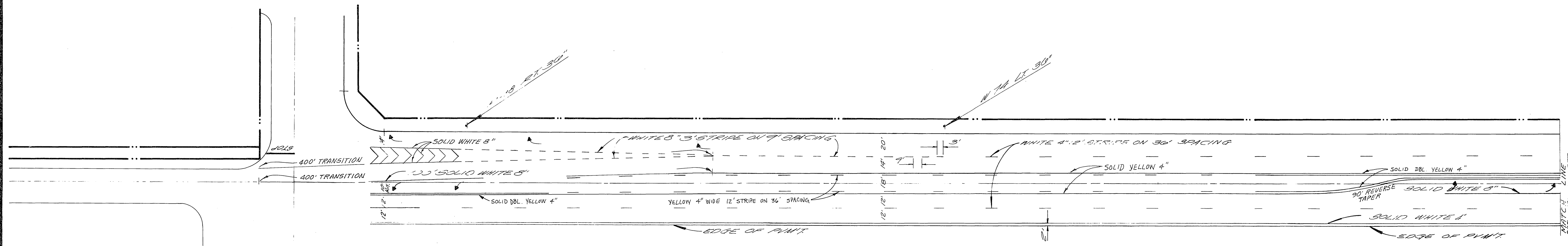

GATEWAY DRIVE

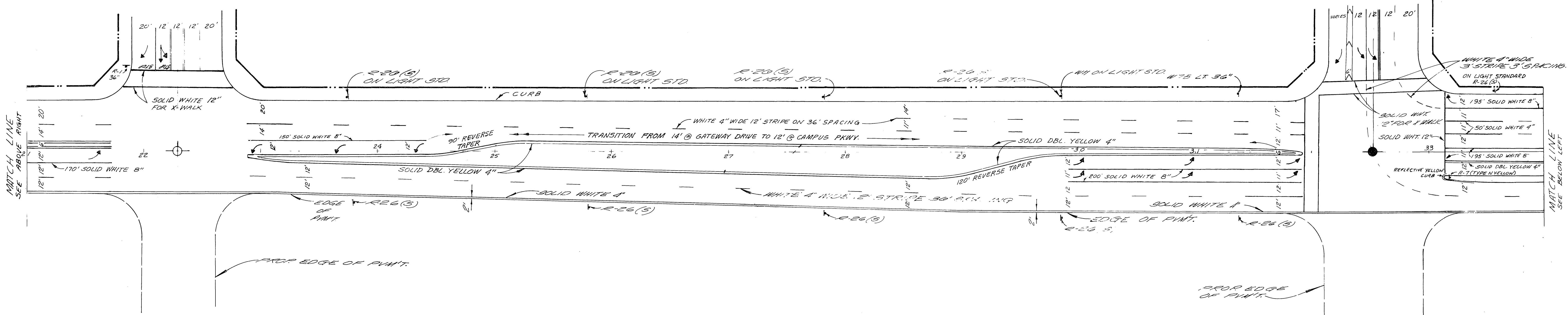

CAMPUS PARKWAY

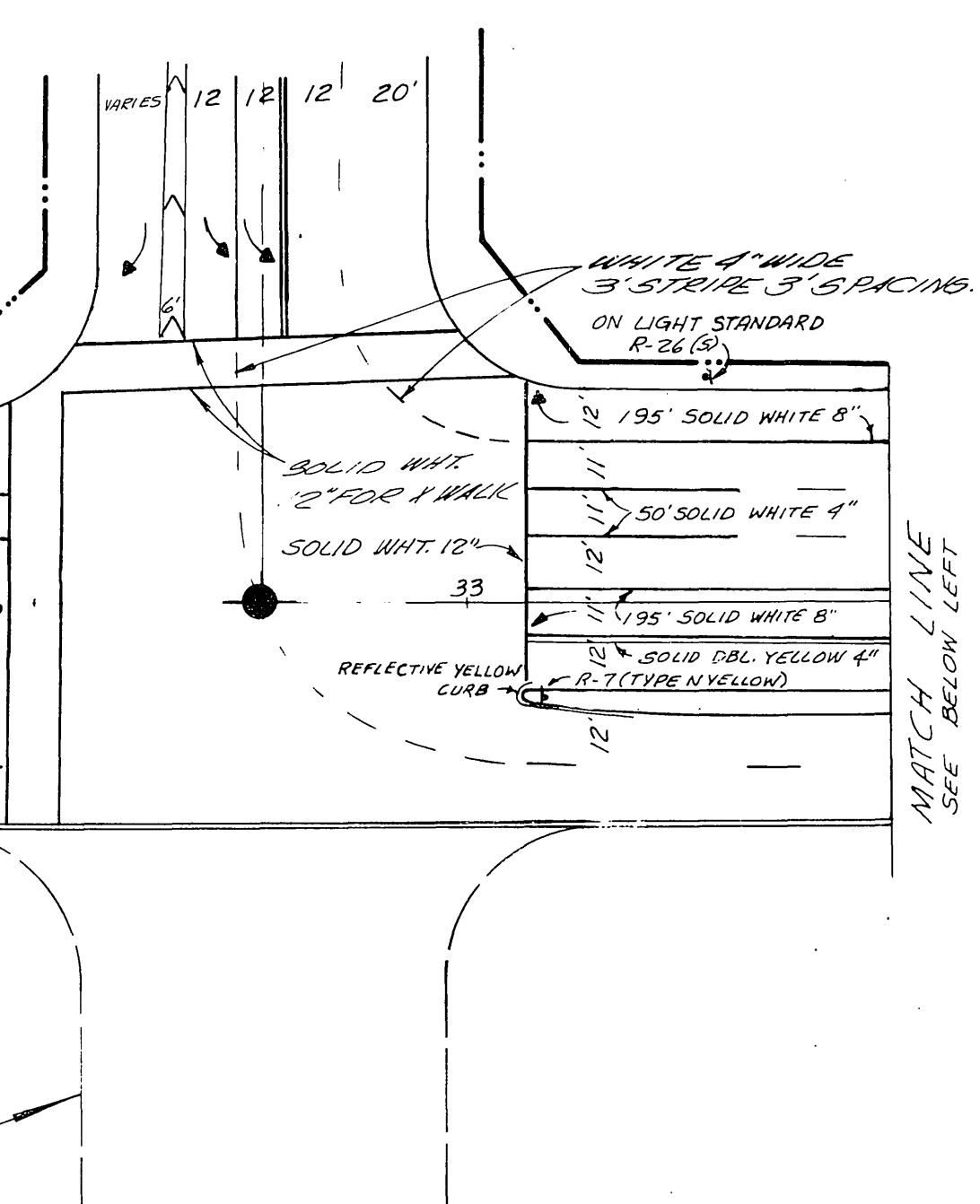

CANYON SPRINGS PARKWAY

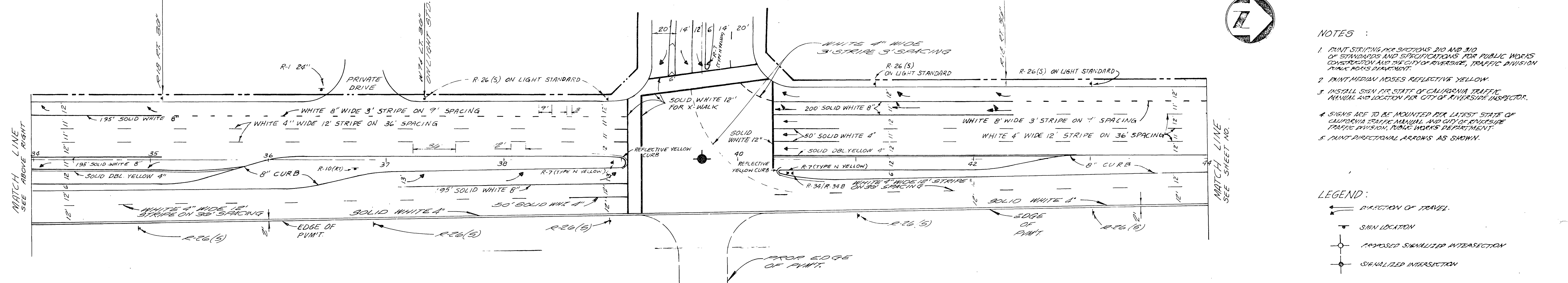

NOTES:

1. PAINT STRIPING PER SECTIONS 310 AND 311 OF STANDARDS AND SPECIFICATIONS FOR PUBLIC WORKS CONSTRUCTION AND THE CITY OF RIVERSIDE, TRAFFIC DIVISION PUBLIC WORKS DEPARTMENT.
2. PAINT MEDIUM NOSES REFLECTIVE YELLOW.
3. INSTALL SIGN PER STATE OF CALIFORNIA TRAFFIC MANUAL AND LOCATION PER CITY OF RIVERSIDE INSPECTOR.
4. SIGNS ARE TO BE MOUNTED PER LATEST STATE OF CALIFORNIA TRAFFIC MANUAL AND CITY OF RIVERSIDE TRAFFIC DIVISION, PUBLIC WORKS DEPARTMENT.
5. PAINT DIRECTIONAL ARROWS AS SHOWN.

LEGEND:

- ➔ DIRECTION OF TRAVEL
- ⊙ SIGN LOCATION
- ⊙ COMBINED SIGNALIZED INTERSECTION
- ⊙ SIGNALIZED INTERSECTION

**Greiner**  
 Greiner Engineering of California  
 5225 Canyon Crest Drive  
 Bldg 200, Suite 253  
 Riverside, California 92507  
 (714) 351-8328  
 (714) 788-7746  
 A Greiner Engineering, Inc. Company

PLANS PREPARED UNDER THE DIRECTION OF:  
 R.C.E. NO. 33747 DATE 12/30/86  
 DESIGNED BY: DRAWN BY: CHECKED BY:

**CITY OF RIVERSIDE**  
**PUBLIC WORKS DEPARTMENT**

APPROVED BY	DATE	BY	APPROVED BY
PRINCIPAL ENGINEER			PUBLIC WORKS DIRECTOR
PARK DEPARTMENT			
TRAFFIC DIVISION			
CHIEF P.W. ENGINEER			

**STRIPING PLAN**  
 DAY STREET  
 STA. 8+00.00 TO STA. 44+00.00  
 PARCEL MAP No. 19617

HORIZ. SCALE: 1" = 40' VERT. SCALE: 1" =

ACCOUNT NO.  
**XL-192**  
 SHEET **1** OF **2**

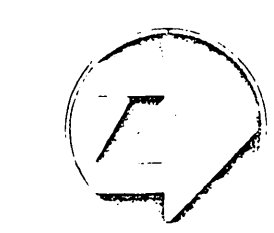
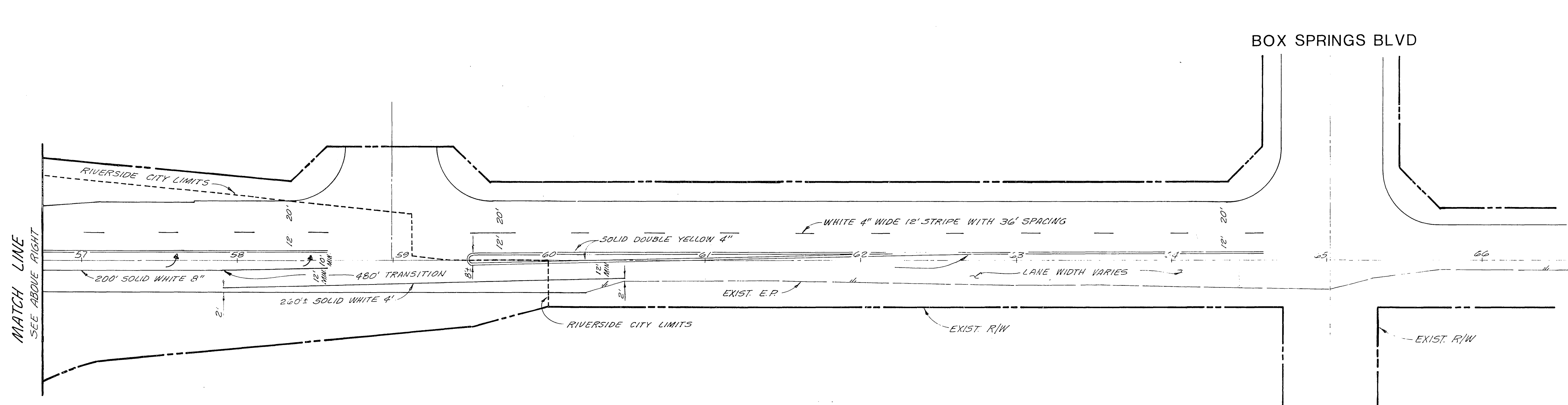
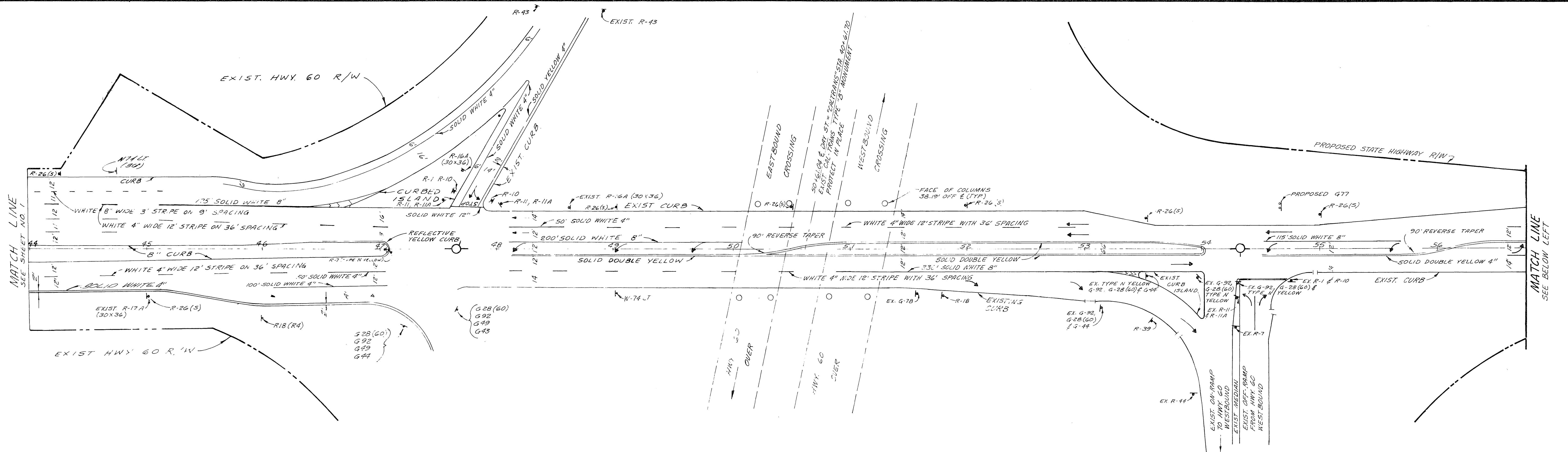

- NOTES:**
1. ALL STRIPING SHALL BE DONE IN ACCORDANCE WITH THE CALIFORNIA MUTUAL AID ACT AND THE MUTUAL AID ACT FOR PUBLIC WORKS.
  2. ALL STRIPING SHALL BE DONE IN ACCORDANCE WITH THE MUTUAL AID ACT FOR PUBLIC WORKS, TRAFFIC DIVISION.
  3. ALL STRIPING SHALL BE DONE IN ACCORDANCE WITH THE MUTUAL AID ACT FOR PUBLIC WORKS, TRAFFIC DIVISION.
  4. ALL STRIPING SHALL BE DONE IN ACCORDANCE WITH THE MUTUAL AID ACT FOR PUBLIC WORKS, TRAFFIC DIVISION.
  5. ALL STRIPING SHALL BE DONE IN ACCORDANCE WITH THE MUTUAL AID ACT FOR PUBLIC WORKS, TRAFFIC DIVISION.
  6. ALL STRIPING SHALL BE DONE IN ACCORDANCE WITH THE MUTUAL AID ACT FOR PUBLIC WORKS, TRAFFIC DIVISION.

- LEGEND:**
- ➔ DIRECTION OF TRAVEL
  - ⊥ SIGN LOCATION
  - ⊙ APPROX. SIGNAL INTERSECTION
  - ⊙ SIGNAL INTERSECTION

	Greiner Engineering of California 5225 Canyon Crest Drive Bldg 200, Suite 253 Riverside, California 92507 (714) 351-9338 (714) 788-7746 A Greiner Engineering, Inc. Company	<b>CITY OF RIVERSIDE</b> <b>PUBLIC WORKS DEPARTMENT</b>	<b>STRIPING PLAN</b> <b>DAY STREET</b> STA. 44+00.00 TO STA. 65+00	ACCOUNT NO. <b>XL-192</b> SHEET <b>2</b> OF <b>2</b>
	PLANS PREPARED UNDER THE DIRECTION OF: R.C.E. NO. <b>33747</b> DATE <b>12/30/86</b>	MARK REVISIONS APPR. DATE DESIGNED BY _____ DRAWN BY _____ CHECKED BY _____	APPROVED BY _____ DATE _____ BY _____ PRINCIPAL ENGINEER PARK DEPARTMENT TRAFFIC DIVISION CHIEF P.W. ENGINEER	APPROVED BY _____ PUBLIC WORKS DIRECTOR DATE _____