

4" SKIP DBL. YELLOW  
(6' STRIPE, 6' GAP)  
REMOVE ANY CONFLICTING STRIPING  
AND MARKINGS

LANE LINE STRIPING TO MEET EXISTING  
LANE LINE STRIPING W/O WICKHAM DR.  
(14' NO. 1 LANE AND 20' CURB LANE)

ARIZONA STREET CHANNEL

INDIANA AVENUE

LA SIERRA AVENUE

REFERENCES:  
TRAFFIC SIGNAL CITY OF RIVERSIDE PLAN NO. X-493  
STREET IMPROVEMENT " " " R-2625

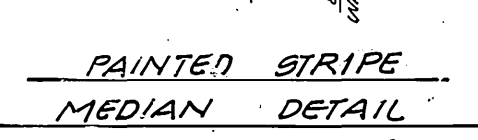
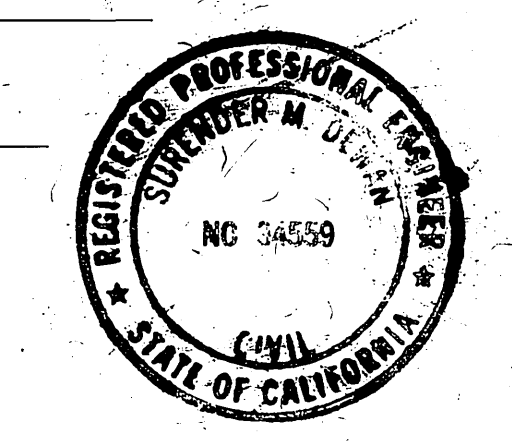
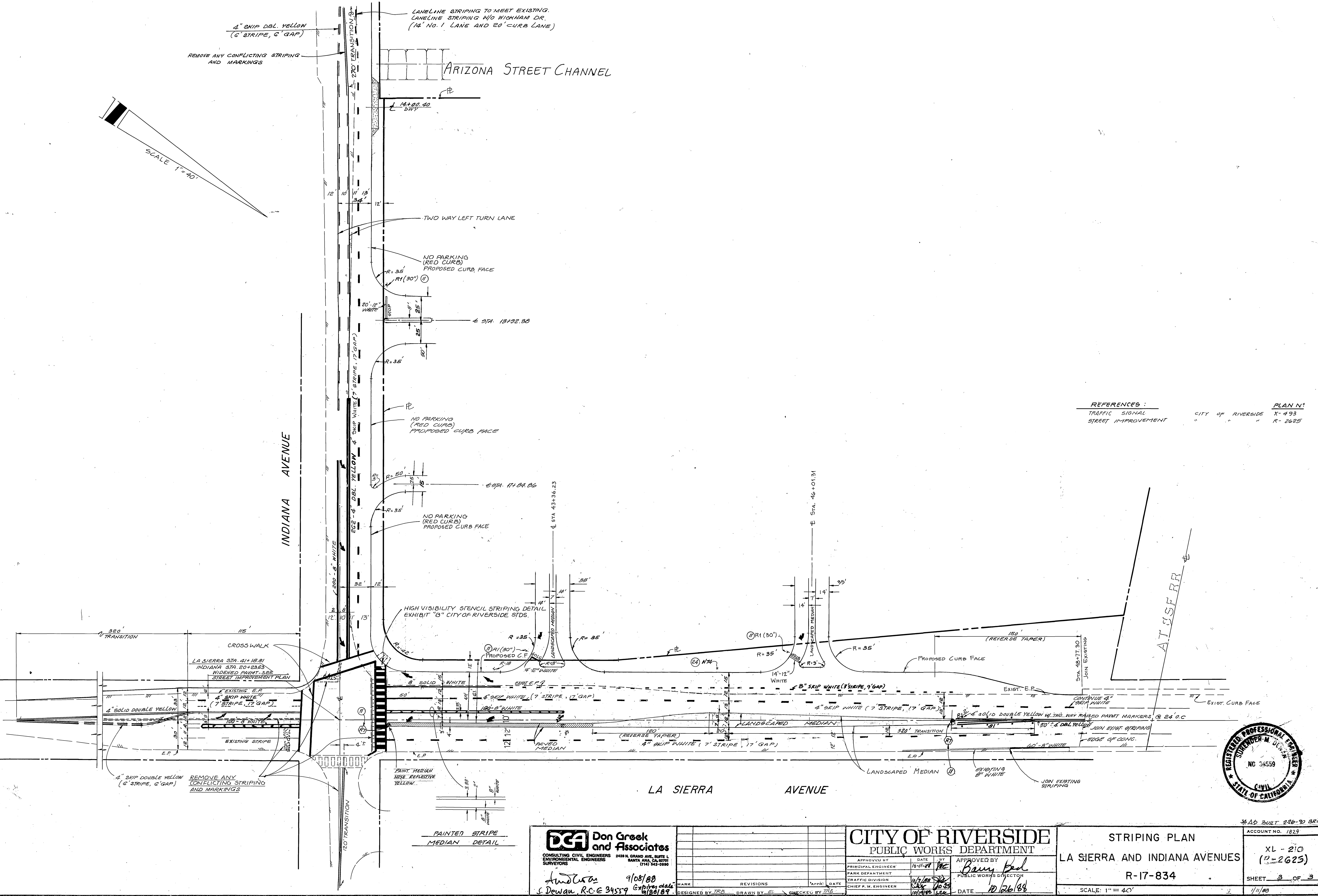

**DCA Don Greek and Associates**  
CONSULTING CIVIL ENGINEERS  
2428 N. GRAND AVE. SUITE L  
SANTA ANA, CA 92701  
(714) 943-0890

9/08/88  
S. Dewan, R.C.E. 34559

MARK	REVISIONS	APPR. DATE

DESIGNED BY TRB DRAWN BY EL CHECKED BY TRB

**CITY OF RIVERSIDE**  
PUBLIC WORKS DEPARTMENT

APPROVED BY	DATE	BY
PRINCIPAL ENGINEER	10-11-88	RE
PARK DEPARTMENT		
TRAFFIC DIVISION	10/11/88	
CHIEF P.W. ENGINEER	10/11/88	

APPROVED BY  
BARRY BOED  
PUBLIC WORKS DIRECTOR

DATE: 10/26/88

STRIPING PLAN  
LA SIERRA AND INDIANA AVENUES  
R-17-834

ACCOUNT NO. 1829  
XL-210  
(P-2625)  
SHEET 3 OF 3  
SCALE: 1" = 40'  
INDEXED 10/14/88