

- STREET LIGHT CONSTRUCTION NOTES**
1. INSTALL ALL STREET LIGHT FACILITIES AS SHOWN IN ACCORDANCE WITH THE PLANS AND THE LATEST REVISION OF THE CITY OF RIVERSIDE PUBLIC UTILITIES DEPARTMENT STREET LIGHT SPECIFICATION NO. 119.
  2. CONTACT PUBLIC UTILITIES INSPECTOR (PHONE 782-5429) FOR REQUIRED INSPECTIONS.
  3. INSTALL A WATERPROOF "IN LINE" FUSE HOLDER IN BOTH BRANCH CONDUCTORS IN THE BASE OF EACH STREET LIGHT STANDARD. FUSE HOLDER TO BE "BUSSMAN TRON" #HEB, COMPATIBLE WITH SIZE AND TYPE OF WIRE USED WITH A "BUSSMAN" FMSG AMP 250 VOLT FUSE OR APPROVED EQUAL.
  4. ALL SERVICE POINTS TO BE CONNECTED BY CITY OF RIVERSIDE. ALL STREET LIGHTS TO BE CONNECTED 240V.
  5. MARK INSTALLATION DATE ON PHOTO CONTROLS AND LAMPS AS PROVIDED FOR BY MANUFACTURERS.
  6. STREET LIGHT FOUNDATIONS, PULLBOXES AND CONDUITS HAVE BEEN INSTALLED BY PUBLIC UTILITIES DEPARTMENT CONTRACTOR. SEE PLAN NO. U/L5-8401.

**STREET LIGHT STRUCTURE SCHEDULE**

SYMBOL	DESCRIPTION	SIZE	NO. REQ'D	NO.	ITEM
	CONCRETE ELECTROLIER STD. HORIZONTAL LUMINAIRE-H.P.S. LAMP-HPS PHOTO CONTROL	313" 200W 200W 1000W	157 157 157	UGS-800 UGS-800 UGS-800	S8 H4 HL4 PC2
	EXISTING CONCRETE PULLBOX	10"x17"x12"		UGS-800	P1
	EXISTING 1" DB CONDUIT INSTALL 2x#8 CU 600V CABLES		PER SPEC. NO. 119		
	EXISTING 1" DB CONDUIT NO CABLE REQUIRED				
	EXISTING 1" DB CONDUIT INSTALL #3-#8 CU 600V CABLES				

\*INCLUDES 120 V CIRCUIT FOR IRRIGATION CONTROLLERS.

- SIGNING, STRIPING, AND MARKING LEGEND**
- P PAINT
  - I INSTALL
  - IP INSTALL SIGN AND POST (TYP.) & PER CITY OF RIV. STD. DWG. No. 666
  - IS INSTALL SIGN

1. 4" DASH WHITE-12' STRIPE-36' GAP (DETAIL 12)
2. 4" SOLID WHITE
3. 4" SOLID YELLOW (DETAIL 25)
4. 8" SOLID WHITE (DETAIL 38)
5. 4" DOUBLE YELLOW (DETAIL 22)
6. 12" SOLID WHITE
7. "SIGNAL" PAVEMENT MARKING
8. "STOP" PAVEMENT MARKING
9. "AHEAD" PAVEMENT MARKING
10. ARROW MARKING-LEFT, RIGHT, OR STRAIGHT
11. 6" SOLID WHITE MARKING
12. 6" SKIP WHITE-4' STRIPE-8' GAP (96 L.F.)
13. "BIKE" PAVEMENT MARKING
14. "LANE" PAVEMENT MARKING
16. 4" SKIP WHITE-1' STRIPE, 6' GAP

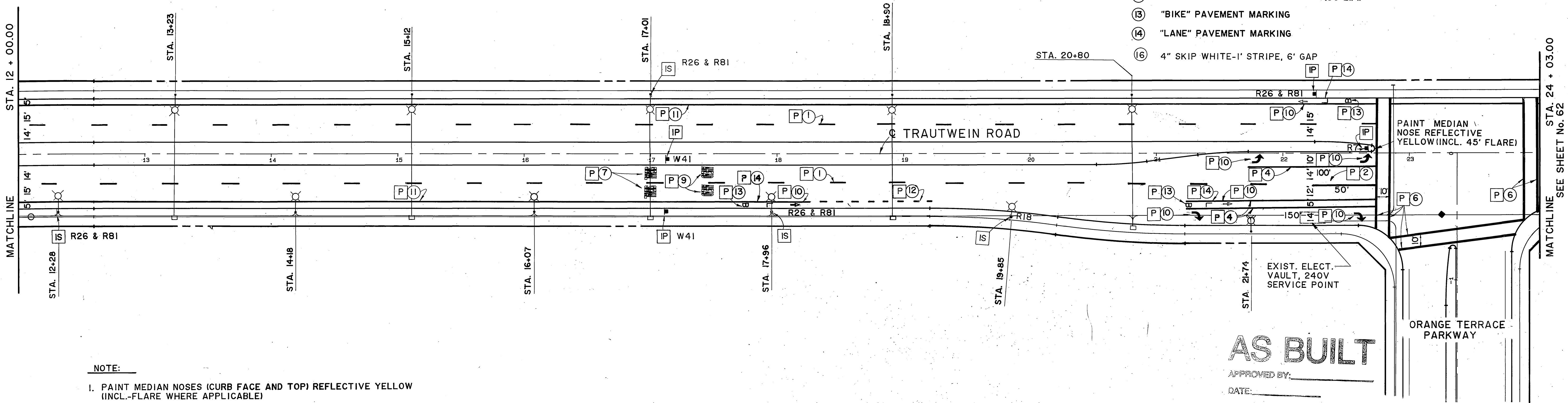

**NOTE:**  
1. PAINT MEDIAN NOSES (CURB FACE AND TOP) REFLECTIVE YELLOW (INCL.-FLARE WHERE APPLICABLE)

**AS BUILT**  
APPROVED BY: \_\_\_\_\_  
DATE: \_\_\_\_\_

FILE WITH R-2971

<p>Underground Service Alert Call: TOLL FREE 1-800 422-4133 TWO WORKING DAYS BEFORE YOU DIG</p>	<p><b>PRIVATE ENGINEERING NOTE</b></p> <p>CONSTRUCTION CONTRACTOR AGREES THAT IN ACCORDANCE WITH GENERALLY ACCEPTED CONSTRUCTION PRACTICES, CONSTRUCTION CONTRACTOR WILL BE REQUIRED TO ASSUME SOLE AND COMPLETE RESPONSIBILITY FOR JOB SITE CONDITIONS DURING THE COURSE OF CONSTRUCTION OF THE PROJECT, INCLUDING THE SAFETY OF ALL PERSONS AND PROPERTY. THAT THIS REQUIREMENT SHALL BE MADE TO APPLY CONTINUOUSLY AND NOT BE LIMITED TO NORMAL WORKING HOURS, AND CONSTRUCTION CONTRACTOR FURTHER AGREES TO DEFEND, INDEMNIFY AND HOLD DESIGN PROFESSIONAL HARMLESS FROM ANY AND ALL LIABILITY, REAL OR ALLEGED, IN CONNECTION WITH THE PERFORMANCE OF WORK ON THIS PROJECT, EXCEPTING LIABILITY ARISING FROM THE SOLE NEGLIGENCE OF DESIGN PROFESSIONAL.</p>	<p>PREPARED UNDER THE DIRECTION OF: <i>Johnny W. Sam</i> REGISTERED CIVIL ENGINEER NO. 35458 EXPIRATION DATE 9/30/91 DATE: 2/12/89</p>	<p><b>J.F. DAVIDSON ASSOCIATES, INC.</b> CIVIL ENGINEERS • SURVEYORS • PLANNERS</p> <p>P.O. BOX 483 11200 SO. MT. VERNON AVE. #D 73-680 EL PASO, #103 RIVERSIDE, CA 92502 COLTON, CA 92324 PALM DESERT, CA 92260 (714) 686-0844 (714) 825-1082 (619) 346-5691</p>		<p>CITY OF RIVERSIDE, CALIFORNIA DEPARTMENT OF PUBLIC WORKS</p>		<p>CFD 86-1 <b>STRIPING, SIGNING &amp; LIGHTING PLANS</b></p>	<p>PROJECT NO. <b>XL-222</b> SHEET <b>61</b> OF <b>106</b> FILE NO. 87-10058</p>
					<p>APPROVED BY: _____ DATE: _____</p>	<p>APPROVED BY: _____ DATE: 3/23/89</p>		

SCALE: 1" = 40'

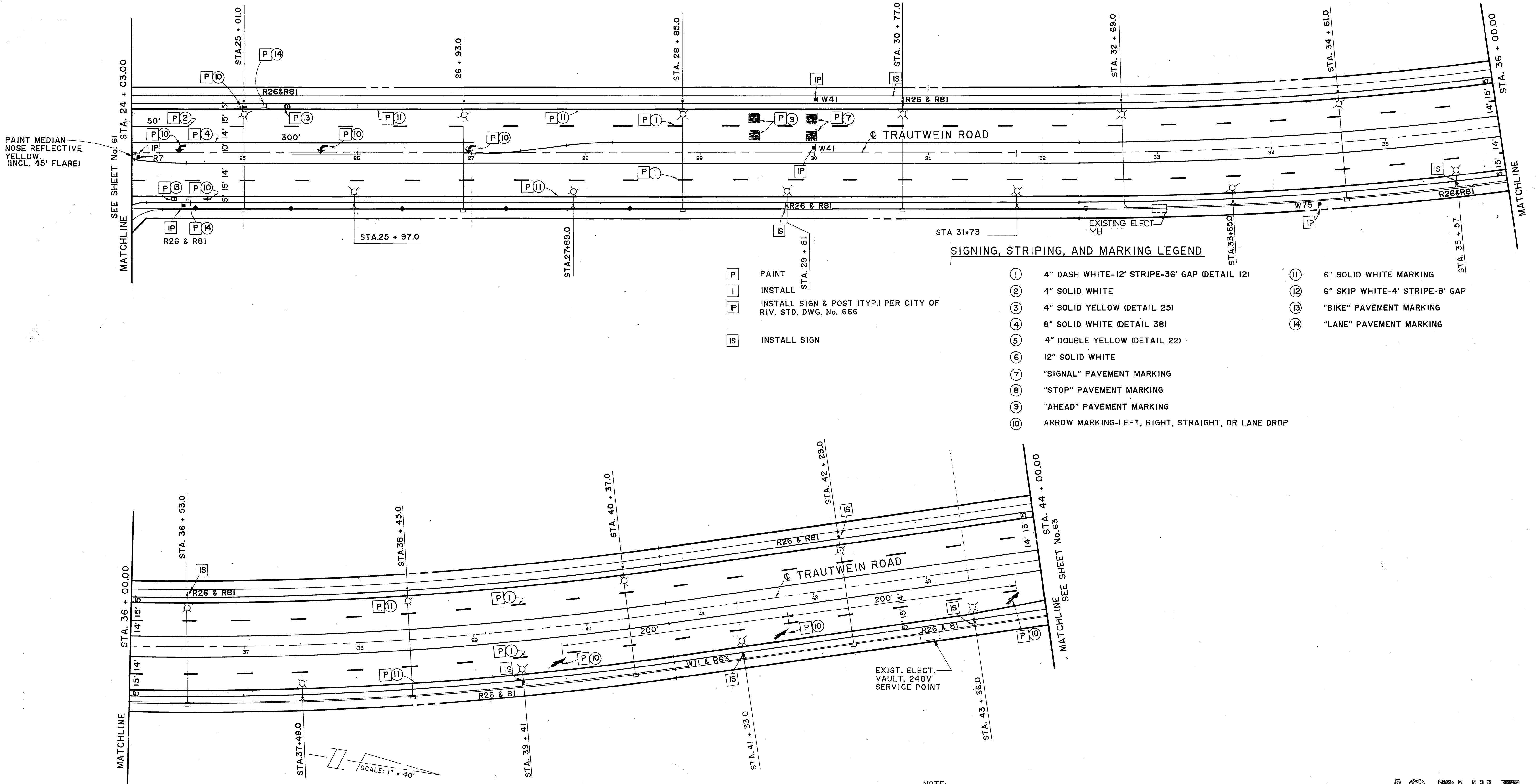

**SIGNING, STRIPING, AND MARKING LEGEND**

- |   |   |  |
|---|---|--|
| <ul style="list-style-type: none"> <li><b>P</b> PAINT</li> <li><b>I</b> INSTALL</li> <li><b>IP</b> INSTALL SIGN &amp; POST (TYP.) PER CITY OF RIV. STD. DWG. No. 666</li> <li><b>IS</b> INSTALL SIGN</li> </ul> | <ul style="list-style-type: none"> <li>① 4" DASH WHITE-12' STRIPE-36' GAP (DETAIL 12)</li> <li>② 4" SOLID WHITE</li> <li>③ 4" SOLID YELLOW (DETAIL 25)</li> <li>④ 8" SOLID WHITE (DETAIL 38)</li> <li>⑤ 4" DOUBLE YELLOW (DETAIL 22)</li> <li>⑥ 12" SOLID WHITE</li> <li>⑦ "SIGNAL" PAVEMENT MARKING</li> <li>⑧ "STOP" PAVEMENT MARKING</li> <li>⑨ "AHEAD" PAVEMENT MARKING</li> <li>⑩ ARROW MARKING-LEFT, RIGHT, STRAIGHT, OR LANE DROP</li> </ul> | <ul style="list-style-type: none"> <li>⑪ 6" SOLID WHITE MARKING</li> <li>⑫ 6" SKIP WHITE-4' STRIPE-8' GAP</li> <li>⑬ "BIKE" PAVEMENT MARKING</li> <li>⑭ "LANE" PAVEMENT MARKING</li> </ul> |
|---|---|--|

PAINT MEDIAN NOSE REFLECTIVE YELLOW (INCL. 45° FLARE)

- NOTE:**
- SEE SHEET 61 FOR STREET LIGHT STRUCTURE SCHEDULE AND STREET LIGHT CONSTRUCTION NOTES.
  - PAINT MEDIAN NOSES (CURB FACE AND TOP) REFLECTIVE YELLOW (INCL.-FLARE WHERE APPLICABLE)

**AS BUILT**

APPROVED BY: \_\_\_\_\_  
DATE: \_\_\_\_\_

File With R-2971

**Underground Service Alert**  
Call: TOLL FREE  
1-800-422-4133  
TWO WORKING DAYS BEFORE YOU DIG

**PRIVATE ENGINEERING NOTE**  
CONSTRUCTION CONTRACTOR AGREES THAT IN ACCORDANCE WITH GENERALLY ACCEPTED CONSTRUCTION PRACTICES, CONSTRUCTION CONTRACTOR WILL BE REQUIRED TO ASSUME SOLE AND COMPLETE RESPONSIBILITY FOR JOB SITE CONDITIONS DURING THE COURSE OF CONSTRUCTION OF THE PROJECT, INCLUDING SAFETY OF ALL PERSONS AND PROPERTY. THAT THIS REQUIREMENT SHALL BE MADE TO APPLY CONTINUOUSLY AND NOT BE LIMITED TO NORMAL WORKING HOURS, AND CONSTRUCTION CONTRACTOR FURTHER AGREES TO DEFEND, INDEMNIFY AND HOLD DESIGN PROFESSIONAL HARMLESS FROM ANY AND ALL LIABILITY, REAL OR ALLEGED, IN CONNECTION WITH THE PERFORMANCE OF WORK ON THIS PROJECT, EXCEPTING LIABILITY ARISING FROM THE SOLE NEGLIGENCE OF DESIGN PROFESSIONAL.

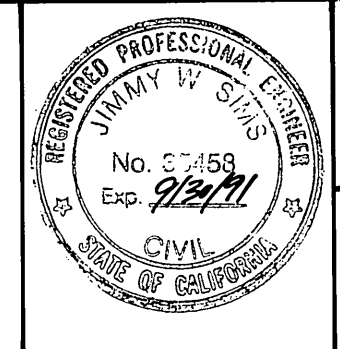

PREPARED UNDER THE DIRECTION OF:  
*Jimmy W. Som*  
REGISTERED CIVIL ENGINEER No. 35458  
EXPIRATION DATE 3/30/91 DATE: 7/1/88  
APPROVED BY: \_\_\_\_\_

**J.F. DAVIDSON ASSOCIATES, INC.**  
CIVIL ENGINEERS • SURVEYORS • PLANNERS  
P.O. BOX 493 RIVERSIDE, CA 92502 (714) 686-0844  
11200 SO. MT. VERNON AVE. #D COLTON, CA 92324 (714) 825-1082  
73-080 EL PASO, #103 PALM DESERT, CA 92260 (619) 346-5691

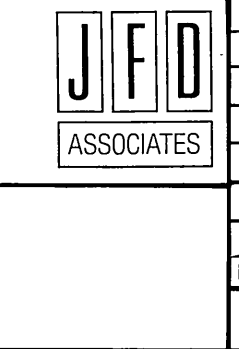

MARK	REVISIONS	APPR.	DATE
DESIGNED BY _____	DRAWN BY _____	CHECKED BY _____	

**CITY OF RIVERSIDE, CALIFORNIA**  
**DEPARTMENT OF PUBLIC WORKS**  
APPROVED BY: \_\_\_\_\_  
PRINCIPAL ENGINEER  
TRAFFIC DIVISION  
CHIEF P.W. ENGR.  
DATE: 3/23/89

CFD 86-1  
**STRIPING, SIGNING & LIGHTING PLANS**  
**TRAUTWEIN ROAD**

PROJECT NO. **XL-222**  
SHEET **62** OF **106**  
FILE NO. 87-10058

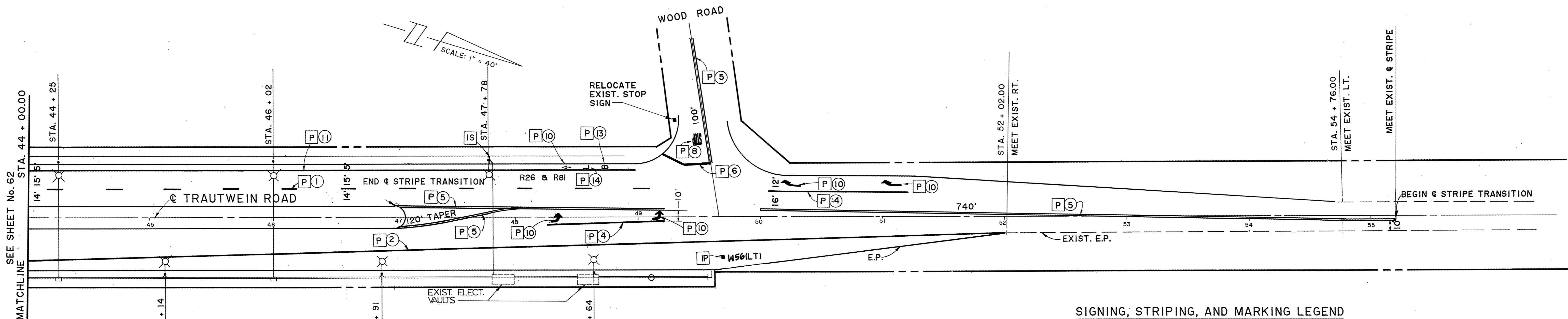

**SIGNING, STRIPING, AND MARKING LEGEND**

- |   |   |  |
|---|---|--|
| <p><b>P</b> PAINT</p> <p><b>I</b> INSTALL</p> <p><b>IS</b> INSTALL SIGN</p> | <p><b>P</b> INSTALL SIGN AND POST (TYP.) PER CITY OF RIV. STD. DWG. No. 666</p> | <p>① 4" DASH WHITE- 12' STRIPE 36' GAP (DETAIL 12)</p> <p>② 4" SOLID WHITE</p> <p>③ 4" SOLID YELLOW (DETAIL 25)</p> <p>④ 8" SOLID WHITE (DETAIL 38)</p> <p>⑤ 4" DOUBLE YELLOW (DETAIL 22)</p> <p>⑥ 12" SOLID WHITE</p> <p>⑦ "SIGNAL" PAVEMENT MARKING</p> <p>⑧ "STOP" PAVEMENT MARKING</p> <p>⑨ "AHEAD" PAVEMENT MARKING</p> <p>⑩ ARROW MARKING-LEFT, RIGHT, OR STRAIGHT</p> <p>⑪ 6" SOLID WHITE MARKING</p> <p>⑫ 6" SKIP WHITE-4' STRIPE-8' GAP</p> <p>⑬ "BIKE" PAVEMENT MARKING</p> <p>⑭ "LANE" PAVEMENT MARKING</p> |
|---|---|--|

**NOTE:**

- SEE SHEET 61 FOR STREET LIGHT STRUCTURE SCHEDULE AND STREET LIGHT CONSTRUCTION NOTES.
- PAINT MEDIAN NOSES (CURB FACE AND TOP) REFLECTIVE YELLOW (INCL.-FLARE WHERE APPLICABLE)

**AS BUILT**

APPROVED BY: \_\_\_\_\_  
DATE: \_\_\_\_\_

File With R-2971

<p><b>Underground Service Alert</b> Call: TOLL FREE 1-800-422-4133 TWO WORKING DAYS BEFORE YOU DIG</p>	<p><b>PRIVATE ENGINEERING NOTE</b> CONSTRUCTION CONTRACTOR AGREES THAT IN ACCORDANCE WITH GENERALLY ACCEPTED CONSTRUCTION PRACTICES, CONSTRUCTION CONTRACTOR WILL BE REQUIRED TO ASSUME SOLE AND COMPLETE RESPONSIBILITY FOR JOB SITE CONDITIONS DURING THE COURSE OF CONSTRUCTION OF THE PROJECT, INCLUDING SAFETY OF ALL PERSONS AND PROPERTY. THAT THIS REQUIREMENT SHALL BE MADE TO APPLY CONTINUOUSLY AND NOT BE LIMITED TO NORMAL WORKING HOURS, AND CONSTRUCTION CONTRACTOR FURTHER AGREES TO DEFEND, INDEMNIFY AND HOLD DESIGN PROFESSIONAL HARMLESS FROM ANY AND ALL LIABILITY, REAL OR ALLEGED, IN CONNECTION WITH THE PERFORMANCE OF WORK ON THIS PROJECT EXCEPTING LIABILITY ARISING FROM THE SOLE NEGLIGENCE OF DESIGN PROFESSIONAL.</p>		<p>PREPARED UNDER THE DIRECTION OF: <i>J.F. Davidson</i> REGISTERED CIVIL ENGINEER NO. 35458 EXPIRATION DATE 9/30/94 DATE: 2/23/88</p>	<p><b>J.F. DAVIDSON ASSOCIATES, INC.</b> CIVIL ENGINEERS • SURVEYORS • PLANNERS</p> <p>P.O. BOX 493 11200 SO. MT. VERNON AVE. #D 73-080 EL PASO, #103 RIVERSIDE, CA 92502 COLTON, CA 92324 PALM DESERT, CA 92260 (714) 698-0844 (714) 825-1082 (619) 346-5691</p>		<p>CITY OF RIVERSIDE, CALIFORNIA DEPARTMENT OF PUBLIC WORKS</p> <table border="1" style="width: 100%; border-collapse: collapse;"> <tr> <td>APPROVED BY</td> <td>BY</td> <td>DATE</td> <td>APPROVED BY</td> </tr> <tr> <td>PRINCIPAL ENGINEER</td> <td><i>[Signature]</i></td> <td>11/23/84</td> <td><i>Barry Bed</i></td> </tr> <tr> <td>PARK DEPARTMENT</td> <td></td> <td></td> <td>DIRECTOR OF PUBLIC WORKS</td> </tr> <tr> <td>TRAFFIC DIVISION</td> <td><i>[Signature]</i></td> <td>12/23/84</td> <td></td> </tr> <tr> <td>CHIEF P.W. ENGR.</td> <td><i>[Signature]</i></td> <td>3-22</td> <td></td> </tr> <tr> <td>PUBLIC UTILITIES</td> <td><i>[Signature]</i></td> <td>1/23/84</td> <td></td> </tr> </table>	APPROVED BY	BY	DATE	APPROVED BY	PRINCIPAL ENGINEER	<i>[Signature]</i>	11/23/84	<i>Barry Bed</i>	PARK DEPARTMENT			DIRECTOR OF PUBLIC WORKS	TRAFFIC DIVISION	<i>[Signature]</i>	12/23/84		CHIEF P.W. ENGR.	<i>[Signature]</i>	3-22		PUBLIC UTILITIES	<i>[Signature]</i>	1/23/84		<p>CFD 86-1 <b>STRIPING, SIGNING &amp; LIGHTING PLANS</b></p> <p><b>TRAUTWEIN ROAD</b></p>	<p>PROJECT NO. <b>XL-222</b></p> <p>SHEET <b>63</b> OF <b>106</b></p>
APPROVED BY	BY	DATE	APPROVED BY																													
PRINCIPAL ENGINEER	<i>[Signature]</i>	11/23/84	<i>Barry Bed</i>																													
PARK DEPARTMENT			DIRECTOR OF PUBLIC WORKS																													
TRAFFIC DIVISION	<i>[Signature]</i>	12/23/84																														
CHIEF P.W. ENGR.	<i>[Signature]</i>	3-22																														
PUBLIC UTILITIES	<i>[Signature]</i>	1/23/84																														



TRAUTWEIN ROAD

FUTURE SILK OAK DRIVE

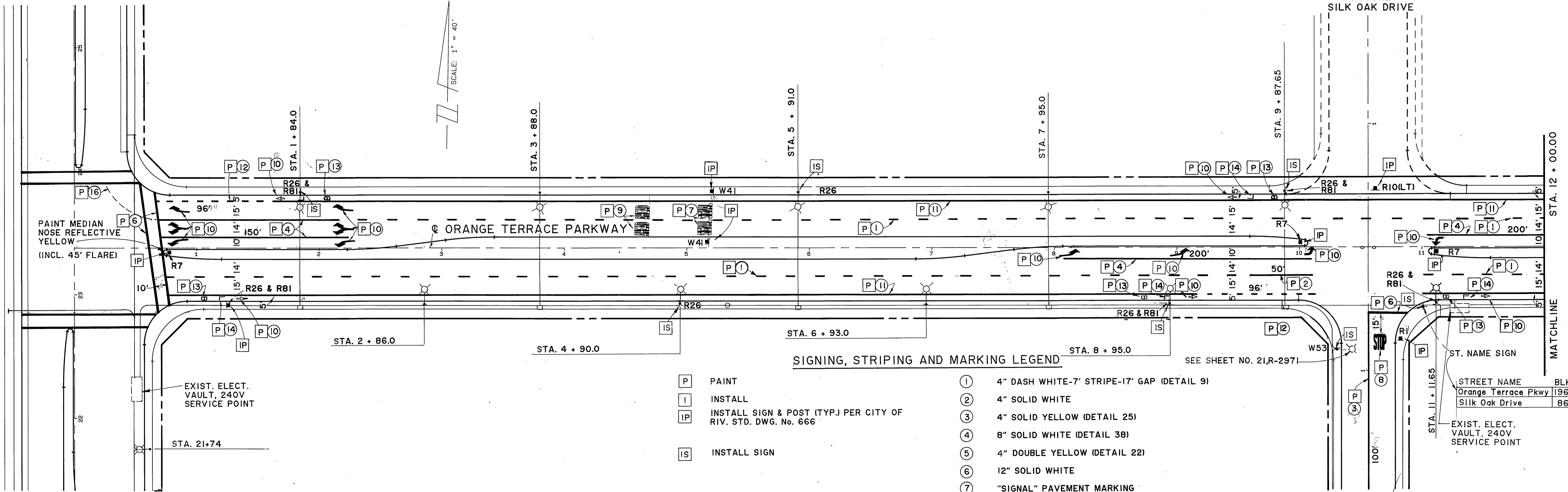

SIGNING, STRIPING AND MARKING LEGEND

- |    |   |    |  |
|----|---|----|--|
| P  | PAINT   | 1  | 4" DASH WHITE-7' STRIPE-17' GAP (DETAIL 9) |
| I  | INSTALL   | 2  | 4" SOLID WHITE                             |
| IP | INSTALL SIGN & POST (TYP.) PER CITY OF RIV. STD. DWG. No. 666 | 3  | 4" SOLID YELLOW (DETAIL 25)                |
| IS | INSTALL SIGN  | 4  | 8" SOLID WHITE (DETAIL 38)                 |
|    |   | 5  | 4" DOUBLE YELLOW (DETAIL 22)               |
|    |   | 6  | 12" SOLID WHITE                            |
|    |   | 7  | "SIGNAL" PAVEMENT MARKING                  |
|    |   | 8  | "STOP" PAVEMENT MARKING                    |
|    |   | 9  | "AHEAD" PAVEMENT MARKING                   |
|    |   | 10 | ARROW MARKING-LEFT, RIGHT OR STRAIGHT      |
|    |   | 11 | 6" SOLID WHITE MARKING                     |
|    |   | 12 | 6" SKIP WHITE-4' STRIPE-8' GAP (96 L.F.)   |
|    |   | 13 | "BIKE" PAVEMENT MARKING                    |
|    |   | 14 | "LANE" PAVEMENT MARKING                    |
|    |   | 16 | 4" SKIP WHITE (1' STRIPE 6' GAP)           |

SEE SHEET NO. 21,R-2971

STREET NAME	BLK. No.
Orange Terrace Pkwy	19600
Silk Oak Drive	8600

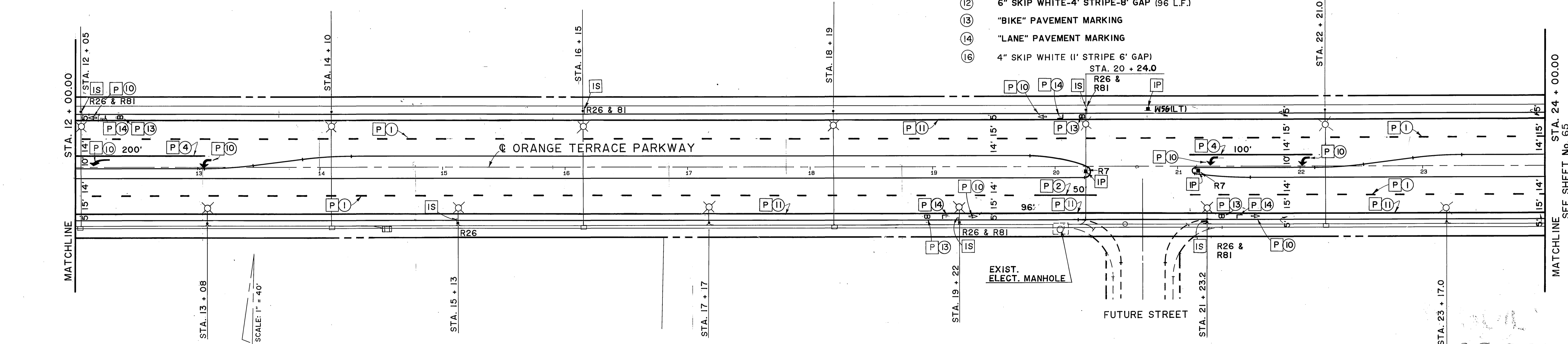

- NOTE:
- SEE SHEET 61 FOR STREET LIGHT STRUCTURE SCHEDULE AND STREET LIGHT CONSTRUCTION NOTES.
  - PAINT MEDIAN NOSES (CURB FACE AND TOP) REFLECTIVE YELLOW (INCL.-FLARE WHERE APPLICABLE)

AS BUILT

**Underground Service Alert**  
 Call: TOLL FREE  
 1-800-422-4133  
 TWO WORKING DAYS BEFORE YOU DIG

PRIVATE ENGINEERING NOTE  
 CONSTRUCTION CONTRACTOR AGREES THAT IN ACCORDANCE WITH GENERALLY ACCEPTED CONSTRUCTION PRACTICES, CONSTRUCTION CONTRACTOR WILL BE REQUIRED TO ASSUME SOLE AND COMPLETE RESPONSIBILITY FOR JOB SITE CONDITIONS DURING THE COURSE OF CONSTRUCTION OF THE PROJECT, INCLUDING SAFETY OF ALL PERSONS AND PROPERTY; THAT THIS REQUIREMENT SHALL BE MADE TO APPLY CONTINUOUSLY AND NOT BE LIMITED TO NORMAL WORKING HOURS, AND CONSTRUCTION CONTRACTOR FURTHER AGREES TO DEFEND, INDEMNIFY AND HOLD DESIGN PROFESSIONAL HARMLESS FROM ANY AND ALL LIABILITY, REAL OR ALLEGED, IN CONNECTION WITH THE PERFORMANCE OF WORK ON THIS PROJECT, EXCEPTING LIABILITY ARISING FROM THE SOLE NEGLIGENCE OF DESIGN PROFESSIONAL.

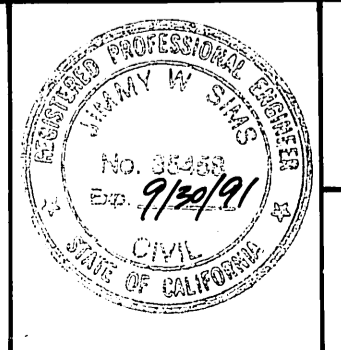

PREPARED UNDER THE DIRECTION OF:  
*J.F. Davidson*  
 REGISTERED CIVIL ENGINEER No. 35458  
 EXPIRATION DATE 9/30/91 DATE: 7/12/88  
 APPROVED BY:

**J.F. DAVIDSON ASSOCIATES, INC.**  
 CIVIL ENGINEERS • SURVEYORS • PLANNERS  
 P.O. BOX 493 11200 SO. MT. VERNON AVE. #D 73-080 EL PASO, #103  
 RIVERSIDE, CA 92502 COLTON, CA 92324 PALM DESERT, CA 92260  
 (714) 686-0844 (714) 825-1082 (619) 346-5691

MARK	REVISIONS	APPR	DATE
DESIGNED BY	DRAWN BY	CHECKED BY	

CITY OF RIVERSIDE, CALIFORNIA  
 DEPARTMENT OF PUBLIC WORKS  
 APPROVED BY: *Barry Ford*  
 DIRECTOR OF PUBLIC WORKS  
 DATE: 3/23/89

CFD 86-1  
 STRIPING, SIGNING & LIGHTING PLANS  
 ORANGE TERRACE PARKWAY

PROJECT NO.  
**XL-222**  
 SHEET **64** OF **106**  
 FILE NO. 8710058

INDEXED 12-9-92 FH 64



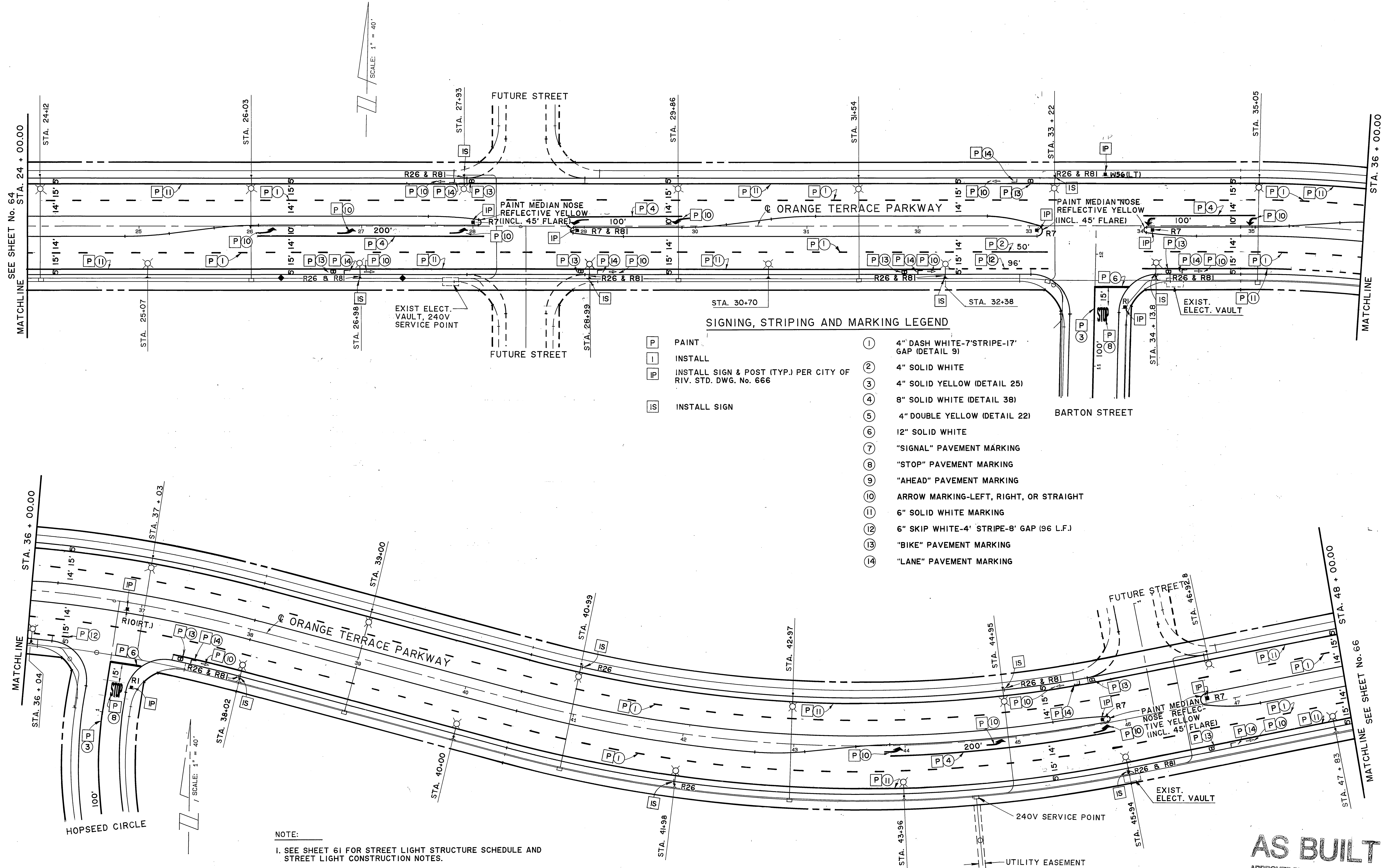

**NOTE:**

- SEE SHEET 61 FOR STREET LIGHT STRUCTURE SCHEDULE AND STREET LIGHT CONSTRUCTION NOTES.
- PAINT MEDIAN NOSES (CURB FACE AND TOP) REFLECTIVE YELLOW (INCL.-FLARE WHERE APPLICABLE)

**AS BUILT**  
 APPROVED BY: \_\_\_\_\_  
 DATE: \_\_\_\_\_

**Underground Service Alert**  
 Call: TOLL FREE  
 1-800-422-4133  
 TWO WORKING DAYS BEFORE YOU DIG

**PRIVATE ENGINEERING NOTE**  
 CONSTRUCTION CONTRACTOR AGREES THAT IN ACCORDANCE WITH GENERALLY ACCEPTED CONSTRUCTION PRACTICES, CONSTRUCTION CONTRACTOR WILL BE REQUIRED TO ASSUME SOLE AND COMPLETE RESPONSIBILITY FOR JOB SITE CONDITIONS DURING THE COURSE OF CONSTRUCTION OF THE PROJECT, INCLUDING SAFETY OF ALL PERSONS AND PROPERTY. THAT THIS REQUIREMENT SHALL BE MADE TO APPLY CONTINUOUSLY AND NOT BE LIMITED TO NORMAL WORKING HOURS, AND CONSTRUCTION CONTRACTOR FURTHER AGREES TO DEFEND, INDEMNIFY AND HOLD DESIGN PROFESSIONAL HARMLESS FROM ANY AND ALL LIABILITY, REAL OR ALLEGED, IN CONNECTION WITH THE PERFORMANCE OF WORK ON THIS PROJECT, EXCEPTING LIABILITY ARISING FROM THE SOLE NEGLIGENCE OF DESIGN PROFESSIONAL.

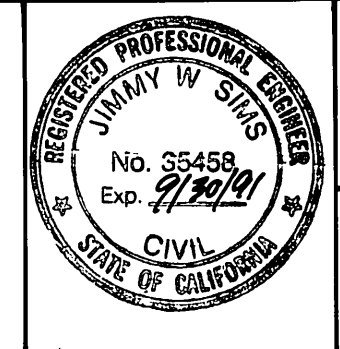

PREPARED UNDER THE DIRECTION OF:  
*Jimmy W. Davis*  
 REGISTERED CIVIL ENGINEER NO. 35458  
 EXPIRATION DATE 3/30/91 DATE: 7/12/88

APPROVED BY: \_\_\_\_\_  
 DATE: \_\_\_\_\_

**J.F. DAVIDSON ASSOCIATES, INC.**  
 CIVIL ENGINEERS • SURVEYORS • PLANNERS

P.O. BOX 493 11200 SO. MT. VERNON AVE. #D 73-080 EL PASO, #103  
 RIVERSIDE, CA 92502 COLTON, CA 92324 PALM DESERT, CA 92260  
 (714) 686-0844 (714) 825-1082 (619) 346-5691

SCALE: \_\_\_\_\_ BENCH MARK: \_\_\_\_\_  
 DATE: \_\_\_\_\_

MARK	REVISIONS	APPR.	DATE
DESIGNED BY	DRAWN BY	CHECKED BY	

**CITY OF RIVERSIDE, CALIFORNIA**  
**DEPARTMENT OF PUBLIC WORKS**

APPROVED BY: \_\_\_\_\_ BY DATE: 12/21/87  
 PRINCIPAL ENGINEER  
 TRAFFIC DIVISION  
 CHIEF P.W. ENGR. DATE: 3/23/89

CFD 86-1  
**STRIPING, SIGNING & LIGHTING PLANS**  
**ORANGE TERRACE PARKWAY**

PROJECT NO. **XL-222**  
 SHEET **65** OF **106**  
 FILE NO. 87-10058

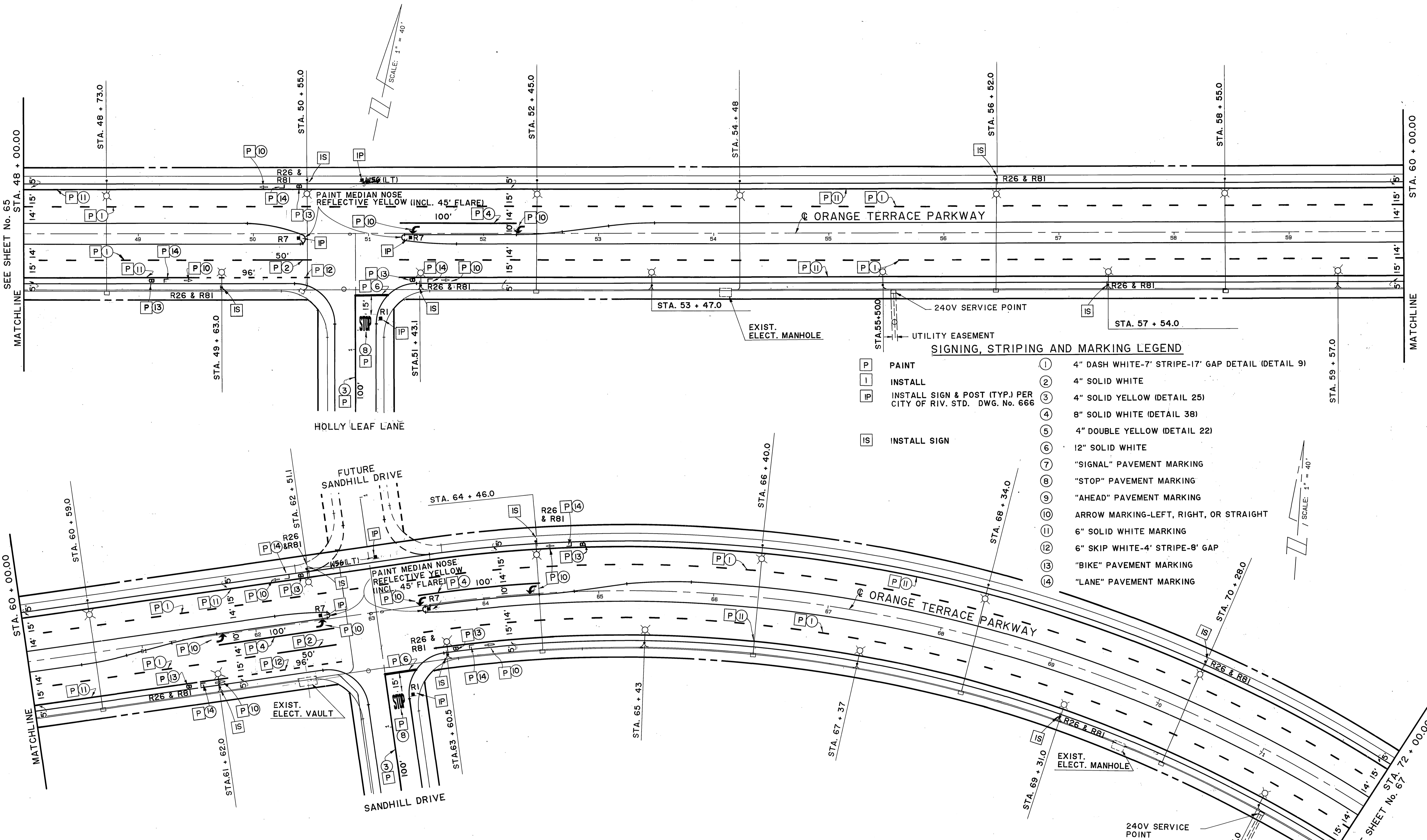

<b>Underground Service Alert</b> Call: TOLL FREE <b>1-800-422-4133</b> <small>TWO WORKING DAYS BEFORE YOU DIG</small>	<b>PRIVATE ENGINEERING NOTE</b> <small>CONSTRUCTION CONTRACTOR AGREES THAT IN ACCORDANCE WITH GENERALLY ACCEPTED CONSTRUCTION PRACTICES, CONSTRUCTION CONTRACTOR WILL BE REQUIRED TO ASSUME SOLE AND COMPLETE RESPONSIBILITY FOR JOB SITE CONDITIONS DURING THE COURSE OF CONSTRUCTION OF THE PROJECT, INCLUDING SAFETY OF ALL PERSONS AND PROPERTY. THAT THIS REQUIREMENT SHALL BE MADE TO APPLY CONTINUOUSLY AND NOT BE LIMITED TO NORMAL WORKING HOURS, AND CONSTRUCTION CONTRACTOR FURTHER AGREES TO DEFEND, INDEMNIFY AND HOLD DESIGN PROFESSIONAL HARMLESS FROM ANY AND ALL LIABILITY, REAL OR ALLEGED, IN CONNECTION WITH THE PERFORMANCE OF WORK ON THIS PROJECT, EXCEPTING LIABILITY ARISING FROM THE SOLE NEGLIGENCE OF DESIGN PROFESSIONAL.</small>		PREPARED UNDER THE DIRECTION OF: <i>Jimmy W. Sosa</i> REGISTERED CIVIL ENGINEER NO. 35458 EXPIRATION DATE 9/30/91 DATE: <i>1/1/99</i>	<b>J.F. DAVIDSON ASSOCIATES, INC.</b> <small>CIVIL ENGINEERS • SURVEYORS • PLANNERS</small> P.O. BOX 483 11200 SO. MT. VERNON AVE. #D 73-080 EL PASO, #103 RIVERSIDE, CA 92502 COLTON, CA 92324 PALM DESERT, CA 92260 (714) 886-0844 (714) 825-1082 (619) 346-5691		CITY OF RIVERSIDE, CALIFORNIA DEPARTMENT OF PUBLIC WORKS APPROVED BY: <i>[Signature]</i> DATE: <i>2/23/99</i> TRAFFIC DIVISION CHIEF P.W. ENGR. <i>[Signature]</i> DATE: <i>3/23/99</i> PUBLIC UTILITIES <i>[Signature]</i> DATE: <i>3/23/99</i>	CFD 86-1 <b>STRIPING, SIGNING &amp; LIGHTING PLANS</b> <b>ORANGE TERRACE PARKWAY</b> PROJECT NO. <b>XL-222</b> SHEET <b>66</b> OF <b>106</b> FILE NO. 67-10058
			APPROVED BY: _____ DATE: _____ <small>FILE WITH R-2971</small>	DESIGNED BY: _____ DRAWN BY: <i>[Signature]</i> CHECKED BY: _____	INDEXED 12-9-92 <i>LFH/66</i>		



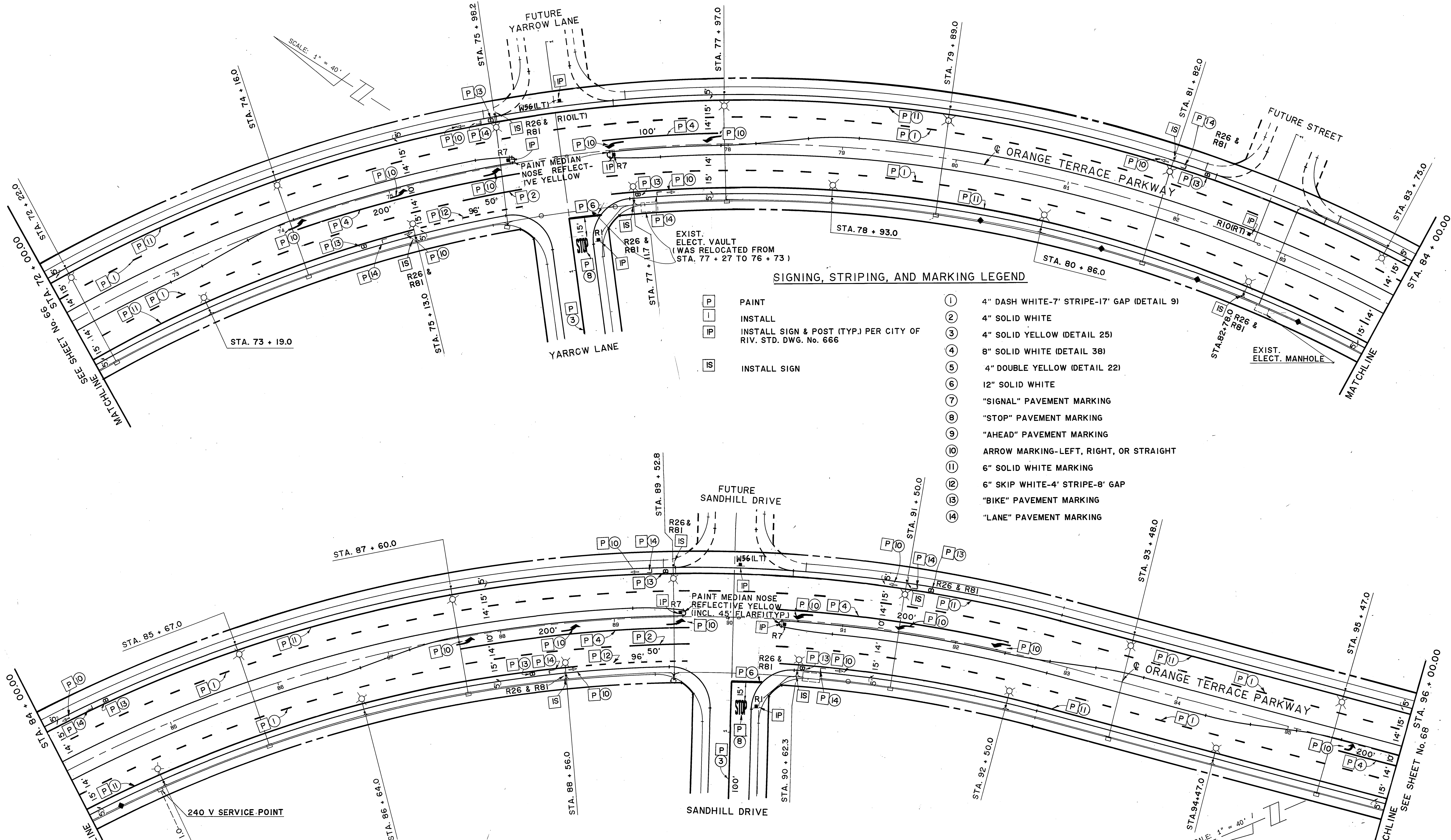

**SIGNING, STRIPING, AND MARKING LEGEND**

- |   |   |
|---|---|
| <ul style="list-style-type: none"> <li><b>P</b> PAINT</li> <li><b>I</b> INSTALL</li> <li><b>IP</b> INSTALL SIGN &amp; POST (TYP.) PER CITY OF RIV. STD. DWG. No. 666</li> <li><b>IS</b> INSTALL SIGN</li> </ul> | <ul style="list-style-type: none"> <li><b>1</b> 4" DASH WHITE-7' STRIPE-17' GAP (DETAIL 9)</li> <li><b>2</b> 4" SOLID WHITE</li> <li><b>3</b> 4" SOLID YELLOW (DETAIL 25)</li> <li><b>4</b> 8" SOLID WHITE (DETAIL 38)</li> <li><b>5</b> 4" DOUBLE YELLOW (DETAIL 22)</li> <li><b>6</b> 12" SOLID WHITE</li> <li><b>7</b> "SIGNAL" PAVEMENT MARKING</li> <li><b>8</b> "STOP" PAVEMENT MARKING</li> <li><b>9</b> "AHEAD" PAVEMENT MARKING</li> <li><b>10</b> ARROW MARKING-LEFT, RIGHT, OR STRAIGHT</li> <li><b>11</b> 6" SOLID WHITE MARKING</li> <li><b>12</b> 6" SKIP WHITE-4' STRIPE-8' GAP</li> <li><b>13</b> "BIKE" PAVEMENT MARKING</li> <li><b>14</b> "LANE" PAVEMENT MARKING</li> </ul> |
|---|---|

**NOTE:**

- SEE SHEET 61 FOR STREET LIGHT STRUCTURE SCHEDULE AND STREET LIGHT CONSTRUCTION NOTES.
- PAINT MEDIAN NOSES (CURB FACE AND TOP) REFLECTIVE YELLOW (INCL. FLARE WHERE APPLICABLE)

**AS BUILT**

APPROVED BY: \_\_\_\_\_  
DATE: \_\_\_\_\_ *File With R-2971*

<p><b>Underground Service Alert</b> Call: TOLL FREE 1-800-422-4133</p>	<p><b>PRIVATE ENGINEERING NOTE</b> CONSTRUCTION CONTRACTOR AGREES THAT IN ACCORDANCE WITH GENERALLY ACCEPTED CONSTRUCTION PRACTICES, CONSTRUCTION CONTRACTOR WILL BE REQUIRED TO ASSUME SOLE AND COMPLETE RESPONSIBILITY FOR JOB SITE CONDITIONS DURING THE COURSE OF CONSTRUCTION OF THE PROJECT, INCLUDING SAFETY OF ALL PERSONS AND PROPERTY. THAT THIS REQUIREMENT SHALL BE MADE TO APPLY CONTINUOUSLY AND NOT BE LIMITED TO NORMAL WORKING HOURS, AND CONSTRUCTION CONTRACTOR FURTHER AGREES TO DEFEND, INDEMNIFY AND HOLD DESIGN PROFESSIONAL HARMLESS FROM ANY AND ALL LIABILITY, REAL OR ALLEGED, IN CONNECTION WITH THE PERFORMANCE OF WORK ON THIS PROJECT, EXCEPTING LIABILITY ARISING FROM THE SOLE NEGLIGENCE OF DESIGN PROFESSIONAL.</p>	<p>PREPARED UNDER THE DIRECTION OF: <i>Summa J. G.</i> REGISTERED CIVIL ENGINEER NO. 35458 EXPIRATION DATE: 8/30/91 DATE: 7/12/88</p>	<p><b>J.F. DAVIDSON ASSOCIATES, INC.</b> CIVIL ENGINEERS • SURVEYORS • PLANNERS P.O. BOX 493 11200 SO. MT. VERNON AVE. #D 73-080 EL PASO, CA 92502 (714) 686-0844 (714) 825-1082 (714) 346-5691</p>	<p><b>JF D ASSOCIATES</b></p>	<p>CITY OF RIVERSIDE, CALIFORNIA DEPARTMENT OF PUBLIC WORKS</p> <p>APPROVED BY: _____ BY DATE: 12-23-87 PRINCIPAL ENGINEER TRAFFIC DIVISION CHIEF P.W. ENGR. DATE: 3/23/89 PUBLIC UTILITIES</p>	<p>CFD 86-1 <b>STRIPING, SIGNING &amp; LIGHTING PLANS</b></p>	<p>PROJECT NO. <b>XL-222</b> SHEET <b>67</b> OF <b>106</b> FILE NO. 87-10058</p>
--	--	---	---	-------------------------------	---	---	--





TRAUTWEIN RD.  
SEE SHEET No. 61

EXIST. ELECT. VAULT, 240V SERVICE POINT

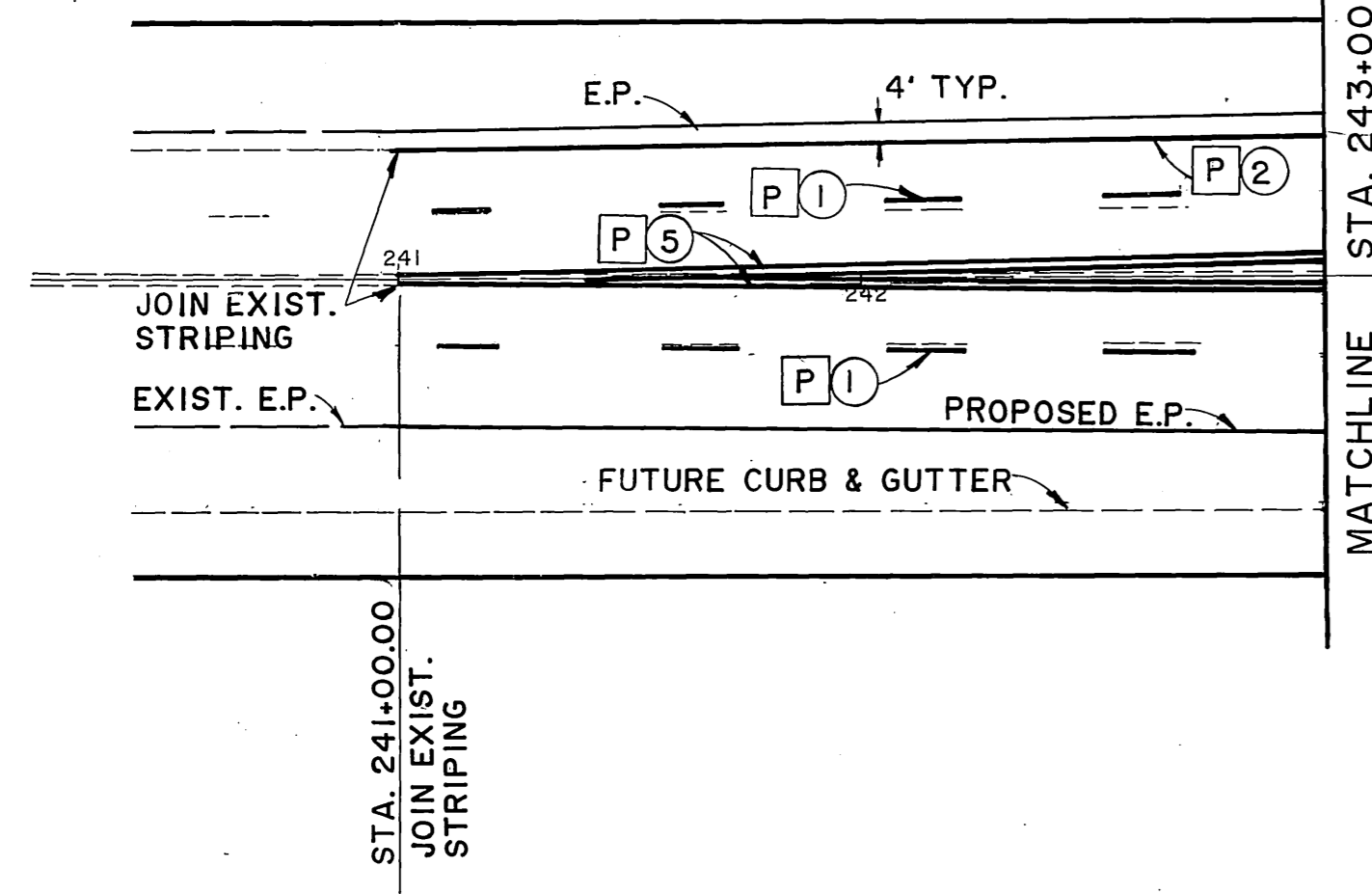
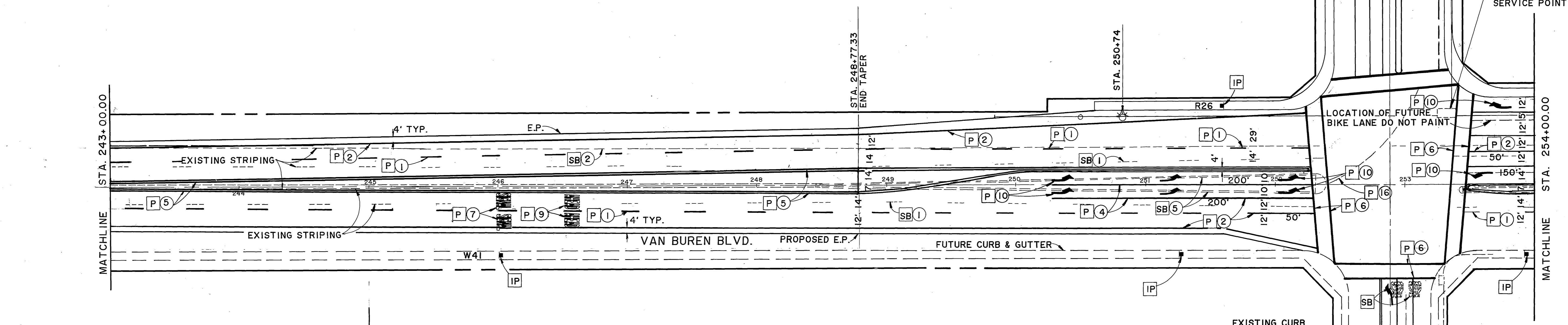

SIGNING, STRIPING, AND MARKING LEGEND

- |           |   |           |  |
|-----------|---|-----------|--|
| <b>P</b>  | PAINT   | <b>1</b>  | 4" DASH WHITE-12' STRIPE-36' GAP (DETAIL 12) |
| <b>I</b>  | INSTALL   | <b>2</b>  | 4" SOLID WHITE                               |
| <b>2P</b> | INSTALL SIGN AND POST (TYP.) & PER CITY OF RIV. STD. DWG. No. 666 | <b>3</b>  | 4" SOLID YELLOW (DETAIL 25)                  |
| <b>IS</b> | INSTALL SIGN  | <b>4</b>  | 8" SOLID WHITE (DETAIL 38)                   |
| <b>SB</b> | WET SANDBLAST EXISTING STRIPING AND/OR PAVEMENT MARKING           | <b>5</b>  | 4" DOUBLE YELLOW (DETAIL 22)                 |
|           |   | <b>6</b>  | 12" SOLID WHITE                              |
|           |   | <b>7</b>  | "SIGNAL" PAVEMENT MARKING                    |
|           |   | <b>8</b>  | "STOP" PAVEMENT MARKING                      |
|           |   | <b>9</b>  | "AHEAD" PAVEMENT MARKING                     |
|           |   | <b>10</b> | ARROW MARKING-LEFT, RIGHT, OR STRAIGHT       |
|           |   | <b>11</b> | 6" SOLID WHITE MARKING                       |
|           |   | <b>12</b> | 6" SKIP WHITE-4" STRIPE-8' GAP (96 L.F.)     |
|           |   | <b>13</b> | "BIKE" PAVEMENT MARKING                      |
|           |   | <b>14</b> | "LANE" PAVEMENT MARKING                      |
|           |   | <b>16</b> | 4" SKIP WHITE-1' STRIPE, 6' GAP.             |

NOTE:

- SEE SHEET 61 FOR STREET LIGHT STRUCTURE SCHEDULE AND STREET LIGHT CONSTRUCTION NOTES.
- PAINT MEDIAN NOSES REFLECTIVE YELLOW (INCL.-FLARE WHERE APPLICABLE).

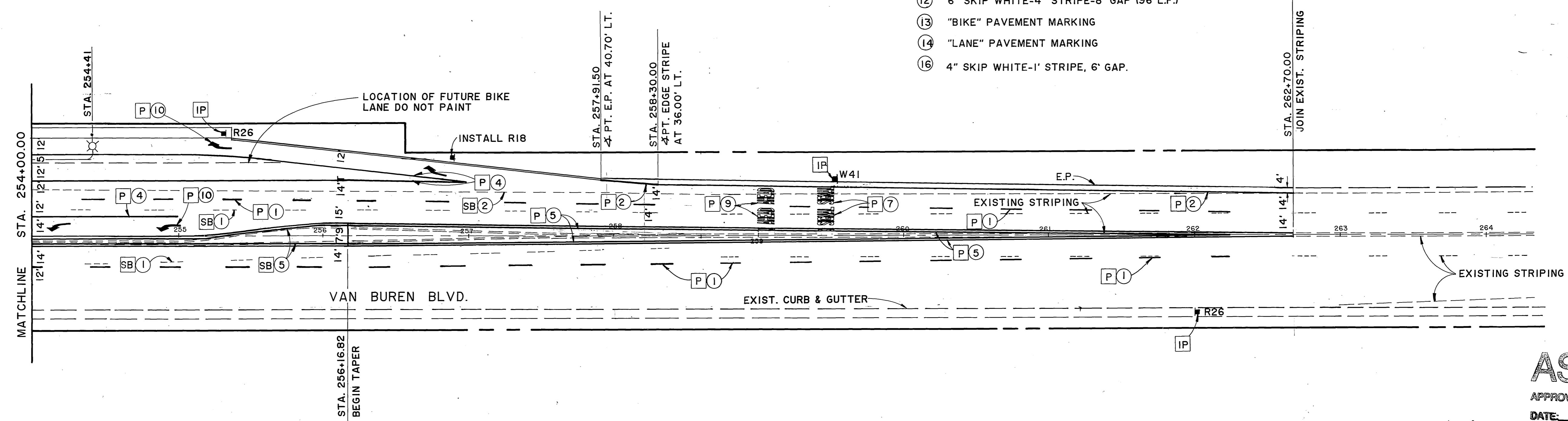
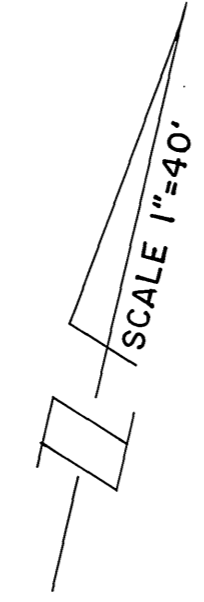

**AS BUILT**

APPROVED BY: \_\_\_\_\_  
DATE: \_\_\_\_\_

File With R-297

**Underground Service Alert**  
Call: TOLL FREE  
1-800-422-4133  
TWO WORKING DAYS BEFORE YOU DIG

**PRIVATE ENGINEERING NOTE**  
CONSTRUCTION CONTRACTOR AGREES THAT IN ACCORDANCE WITH GENERALLY ACCEPTED CONSTRUCTION PRACTICES, CONSTRUCTION CONTRACTOR WILL BE REQUIRED TO ASSUME SOLE AND COMPLETE RESPONSIBILITY FOR JOB SITE CONDITIONS DURING THE COURSE OF CONSTRUCTION OF THE PROJECT, INCLUDING SAFETY OF ALL PERSONS AND PROPERTY. THAT THIS REQUIREMENT SHALL BE MADE TO APPLY CONTINUOUSLY AND NOT BE LIMITED TO NORMAL WORKING HOURS, AND CONSTRUCTION CONTRACTOR FURTHER AGREES TO DEFEND, INDEMNIFY AND HOLD DESIGN PROFESSIONAL HARMLESS FROM ANY AND ALL LIABILITY, REAL OR ALLEGED, IN CONNECTION WITH THE PERFORMANCE OF WORK ON THIS PROJECT, EXCEPTING LIABILITY ARISING FROM THE SOLE NEGLIGENCE OF DESIGN PROFESSIONAL.

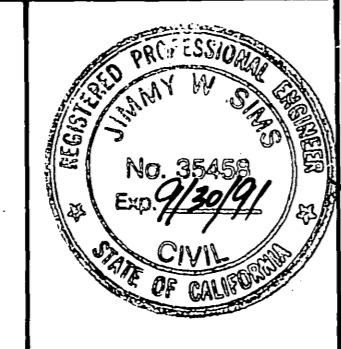

PREPARED UNDER THE DIRECTION OF:  
*J.F. Davidson*  
REGISTERED CIVIL ENGINEER NO. 35458  
EXPIRATION DATE: 9/30/91 DATE: 4/3/88  
APPROVED BY: \_\_\_\_\_

**J.F. DAVIDSON ASSOCIATES, INC.**  
CIVIL ENGINEERS • SURVEYORS • PLANNERS  
P.O. BOX 493 11200 SQ. MT. VERNON AVE. #D 73-980 EL PASO, #103  
RIVERSIDE, CA 92502 COLTON, CA 92324 PALM DESERT, CA 92260  
(714) 886-0844 (714) 825-1082 (619) 346-5691

SCALE	BENCH MARK
DATE	OCT. 1987
MARK	REVISIONS
DESIGNED BY	E.F.
DRAWN BY	CB
CHECKED BY	

**CITY OF RIVERSIDE, CALIFORNIA**  
**DEPARTMENT OF PUBLIC WORKS**

APPROVED BY	BY	DATE	APPROVED BY
PRINCIPAL ENGINEER	<i>[Signature]</i>	4-22-89	<i>[Signature]</i>
PARK DEPARTMENT			
TRAFFIC DIVISION			
CHIEF P.W. ENGR.			
PUBLIC UTILITIES			

CFD 86-1  
**STRIPING, SIGNING & LIGHTING PLANS**  
**VAN BUREN BLVD.**

PROJECT NO. **XL-222**  
SHEET **68A** OF **106**  
FILE NO. **87-10058**

STA. 308+00.00  
JOIN EXIST. &  
STRIPING

STA. 319+00.00  
MATCHLINE  
SEE BELOW LEFT

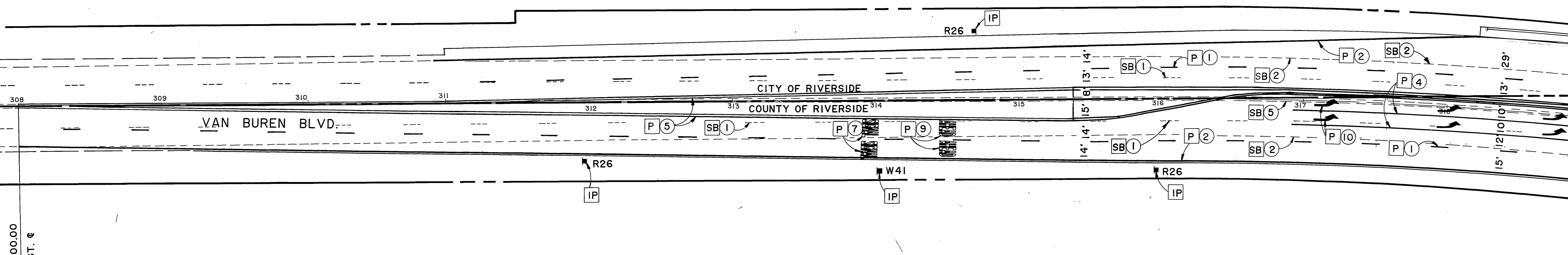

**SIGNING, STRIPING, AND MARKING LEGEND**

- |           |  |           |  |
|-----------|--|-----------|--|
| <b>P</b>  | PAINT  | <b>1</b>  | 4" DASH WHITE-12' STRIPE-36' GAP (DETAIL 12) |
| <b>I</b>  | INSTALL  | <b>2</b>  | 4" SOLID WHITE                               |
| <b>2P</b> | INSTALL SIGN AND POST (TYP.) & PER CITY OF RIV.<br>STD. DWG. No. 666 | <b>3</b>  | 4" SOLID YELLOW (DETAIL 25)                  |
| <b>IS</b> | INSTALL SIGN   | <b>4</b>  | 8" SOLID WHITE (DETAIL 38)                   |
| <b>SB</b> | WET SANDBLAST EXIST. STRIPING AND/OR<br>PAVEMENT MARKING             | <b>5</b>  | 4" DOUBLE YELLOW (DETAIL 22)                 |
|           |  | <b>6</b>  | 12" SOLID WHITE                              |
|           |  | <b>7</b>  | "SIGNAL" PAVEMENT MARKING                    |
|           |  | <b>8</b>  | "STOP" PAVEMENT MARKING                      |
|           |  | <b>9</b>  | "AHEAD" PAVEMENT MARKING                     |
|           |  | <b>10</b> | ARROW MARKING-LEFT, RIGHT, OR STRAIGHT       |
|           |  | <b>11</b> | 6" SOLID WHITE MARKING                       |
|           |  | <b>12</b> | 6" SKIP WHITE-4' STRIPE-8' GAP (96 L.F.)     |
|           |  | <b>13</b> | "BIKE" PAVEMENT MARKING                      |
|           |  | <b>14</b> | "LANE" PAVEMENT MARKING                      |
|           |  | <b>16</b> | 4" SKIP WHITE-1' STRIPE, 6' GAP              |

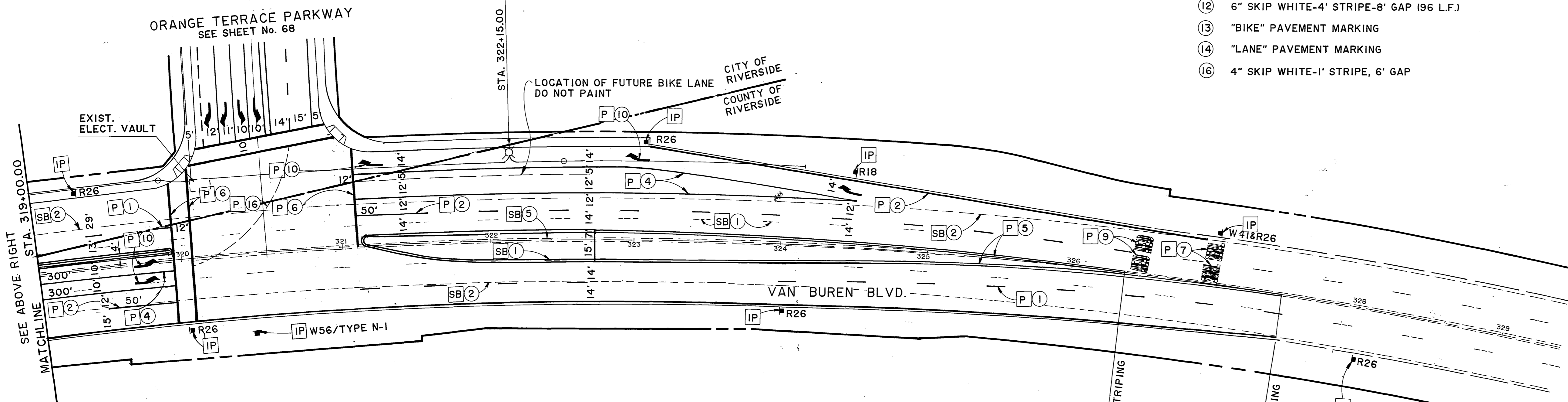
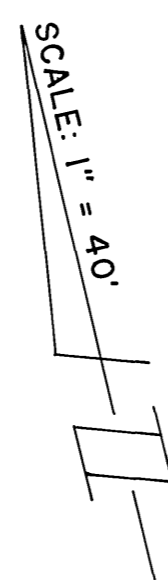

- NOTE:**
- SEE SHEET 61 FOR STREET LIGHT STRUCTURE SCHEDULE AND STREET LIGHT CONSTRUCTION NOTES.
  - PAINT MEDIAN NOSES REFLECTIVE YELLOW (INCL.-FLARE WHERE APPLICABLE).
  - A COUNTY OF RIVERSIDE ENCROACHMENT PERMIT IS REQUIRED PRIOR TO THE START OF WORK.

**AS BUILT**

APPROVED BY: \_\_\_\_\_  
DATE: \_\_\_\_\_

**REVIEWED FOR ENCROACHMENT PERMIT**

APR 20 1989

RIVERSIDE COUNTY ROAD DEPT. PLAN CHECK

*[Signature]*

<p><b>Underground Service Alert</b></p> <p>Call: TOLL FREE 1-800-422-4133</p> <p>TWO WORKING DAYS BEFORE YOU DIG</p>	<p><b>PRIVATE ENGINEERING NOTE</b></p> <p>CONSTRUCTION CONTRACTOR AGREES THAT IN ACCORDANCE WITH GENERALLY ACCEPTED CONSTRUCTION PRACTICES, CONSTRUCTION CONTRACTOR WILL BE REQUIRED TO ASSUME SOLE AND COMPLETE RESPONSIBILITY FOR JOB SITE CONDITIONS DURING THE COURSE OF CONSTRUCTION OF THE PROJECT, INCLUDING SAFETY OF ALL PERSONS AND PROPERTY. THAT THIS REQUIREMENT SHALL BE MADE TO APPLY CONTINUOUSLY AND NOT BE LIMITED TO NORMAL WORKING HOURS, AND CONSTRUCTION CONTRACTOR FURTHER AGREES TO DEFEND, INDEMNIFY AND HOLD DESIGN PROFESSIONAL HARMLESS FROM ANY AND ALL LIABILITY, REAL OR ALLEGED, IN CONNECTION WITH THE PERFORMANCE OF WORK ON THIS PROJECT, EXCEPTING LIABILITY ARISING FROM THE SOLE NEGLIGENCE OF DESIGN PROFESSIONAL.</p>	<p>REGISTERED PROFESSIONAL ENGINEER</p> <p><b>JIMMY W. SHERMAN</b></p> <p>No. 35458</p> <p>9/30/91</p>	<p>PREPARED UNDER THE DIRECTION OF:</p> <p><i>[Signature]</i></p> <p>REGISTERED CIVIL ENGINEER NO. 35458</p> <p>EXPIRATION DATE 9/30/91 DATE: 6/3/89</p>	<p><b>J.F. DAVIDSON ASSOCIATES, INC.</b></p> <p>CIVIL ENGINEERS • SURVEYORS • PLANNERS</p> <p>P.O. BOX 483 11200 SO. MT. VERNON AVE. #D 73-080 EL PASO, #103 RIVERSIDE, CA 92502 COLTON, CA 92324 PALM DESERT, CA 92260 (714) 886-0844 (714) 825-1082 (619) 346-5691</p>	<p><b>J.F.D.</b></p> <p>ASSOCIATES</p>	<p>CITY OF RIVERSIDE, CALIFORNIA DEPARTMENT OF PUBLIC WORKS</p>		<p>CFD-86-1 <b>STRIPING, SIGNING &amp; LIGHTING PLANS</b></p>	<p>PROJECT NO. <b>XL-222</b></p>
						<p>SCALE: 1" = 40'-0"</p> <p>DATE: OCT. 1987</p>	<p>DESIGNED BY: E.F. DRAWN BY: CB CHECKED BY: _____</p>		



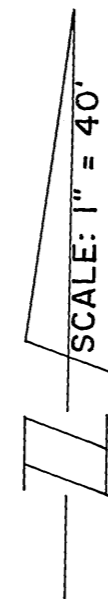
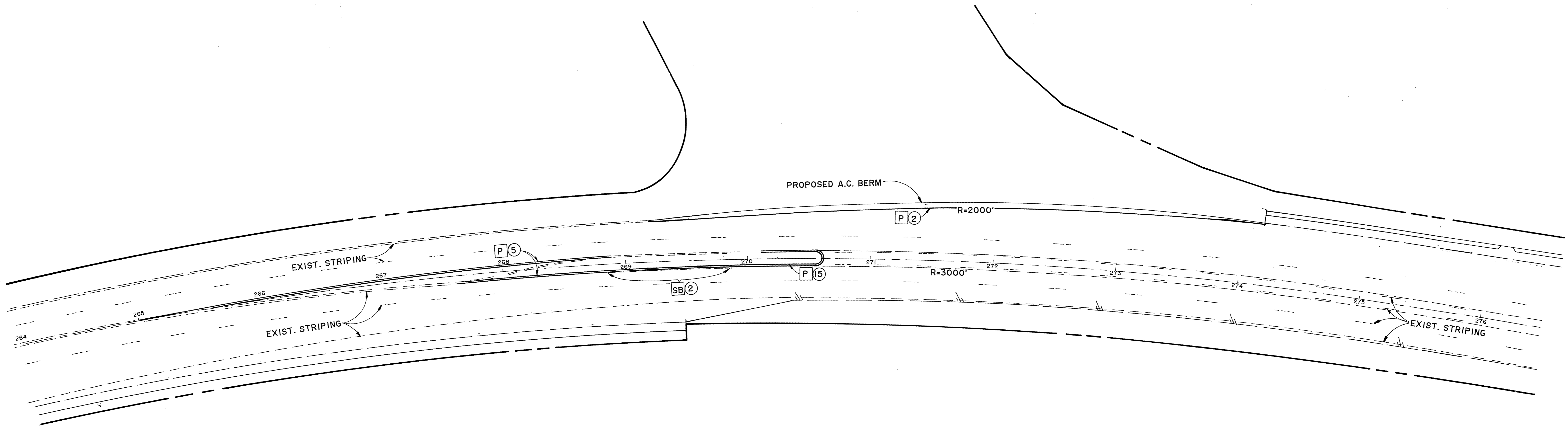

**SIGNING, STRIPING, AND MARKING LEGEND**

<p><b>P</b> PAINT</p> <p><b>I</b> INSTALL</p> <p><b>IP</b> INSTALL SIGN AND POST (TYP.) &amp; PER CITY OF RIV. STD. DWG. No.666</p> <p><b>IS</b> INSTALL SIGN</p> <p><b>SB</b> WET SAND BLAST EXISTING STRIPING AND/OR PAVEMENT MARKING</p>	<p><b>1</b> 4" DASH WHITE-12' STRIPE-36' GAP (DETAIL 12)</p> <p><b>2</b> 4" SOLID WHITE</p> <p><b>3</b> 4" SOLID YELLOW (DETAIL 25)</p> <p><b>4</b> 8" SOLID WHITE (DETAIL 38)</p> <p><b>5</b> 4" DOUBLE YELLOW (DETAIL 22)</p> <p><b>6</b> 12" SOLID WHITE</p> <p><b>7</b> "SIGNAL" PAVEMENT MARKING</p> <p><b>8</b> "STOP" PAVEMENT MARKING</p> <p><b>9</b> "AHEAD" PAVEMENT MARKING</p> <p><b>10</b> ARROW MARKING-LEFT, RIGHT, OR STRAIGHT</p> <p><b>11</b> 6" SOLID WHITE MARKING</p> <p><b>12</b> 6" SKIP WHITE-4' STRIPE-8' GAP (96 L.F.)</p> <p><b>13</b> "BIKE" PAVEMENT MARKING</p> <p><b>14</b> "LANE" PAVEMENT MARKING</p> <p><b>15</b> TWO-WAY LEFT TURN LANE (DETAIL 35A)</p>
---	---

**AS BUILT**

APPROVED BY: \_\_\_\_\_  
DATE: \_\_\_\_\_

File With R 2971

**Underground Service Alert**  
Call: TOLL FREE  
**1-800-422-4133**  
TWO WORKING DAYS BEFORE YOU DIG

**PRIVATE ENGINEERING NOTE**  
CONSTRUCTION CONTRACTOR AGREES THAT IN ACCORDANCE WITH GENERALLY ACCEPTED CONSTRUCTION PRACTICES, CONSTRUCTION CONTRACTOR WILL BE REQUIRED TO ASSUME SOLE AND COMPLETE RESPONSIBILITY FOR JOB SITE CONDITIONS DURING THE COURSE OF CONSTRUCTION OF THE PROJECT, INCLUDING SAFETY OF ALL PERSONS AND PROPERTY; THAT THIS REQUIREMENT SHALL BE MADE TO APPLY CONTINUOUSLY AND NOT BE LIMITED TO NORMAL WORKING HOURS, AND CONSTRUCTION CONTRACTOR FURTHER AGREES TO DEFEND, INDEMNIFY AND HOLD DESIGN PROFESSIONAL HARMLESS FROM ANY AND ALL LIABILITY, REAL OR ALLEGED, IN CONNECTION WITH THE PERFORMANCE OF WORK ON THIS PROJECT, EXCEPTING LIABILITY ARISING FROM THE SOLE NEGLIGENCE OF DESIGN PROFESSIONAL.

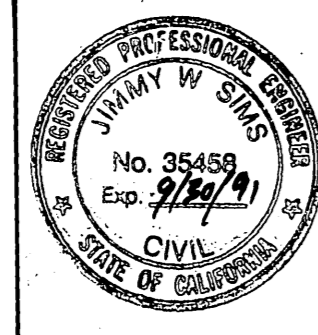

PREPARED UNDER THE DIRECTION OF:  
*Jimmy W. Sines*  
REGISTERED CIVIL ENGINEER NO. 35458  
EXPIRATION DATE 9/30/91 DATE: 03/00  
APPROVED BY: \_\_\_\_\_

**J.F. DAVIDSON ASSOCIATES, INC.**  
CIVIL ENGINEERS • SURVEYORS • PLANNERS  
P.O. BOX 493 11200 SO. MT. VERNON AVE. #D 73-080 EL PASEO, #103  
RIVERSIDE, CA 92502 COLTON, CA 92324 PALM DESERT, CA 92260  
(714) 688-0844 (714) 825-1082 (619) 346-5691

SCALE: \_\_\_\_\_ BENCH MARK: \_\_\_\_\_  
DATE: OCT. 1987



MARK: \_\_\_\_\_ REVISIONS: \_\_\_\_\_ APPR. DATE: \_\_\_\_\_  
DESIGNED BY: E.F. DRAWN BY: CB CHECKED BY: \_\_\_\_\_

**CITY OF RIVERSIDE, CALIFORNIA**  
**DEPARTMENT OF PUBLIC WORKS**  
APPROVED BY: \_\_\_\_\_ BY DATE: 11-23-89  
PRINCIPAL ENGINEER  
PARK DEPARTMENT  
TRAFFIC DIVISION  
CHIEF P.W. ENGR. 3.22  
APPROVED BY: *Barry Bred*  
DIRECTOR OF PUBLIC WORKS  
DATE: 3/23/89

CFD 86-1  
**STRIPING, SIGNING & LIGHTING PLANS**  
**VAN BUREN BLVD.**

PROJECT NO. **XL-222**  
SHEET **68C** OF **106**  
FILE NO. 87-10058

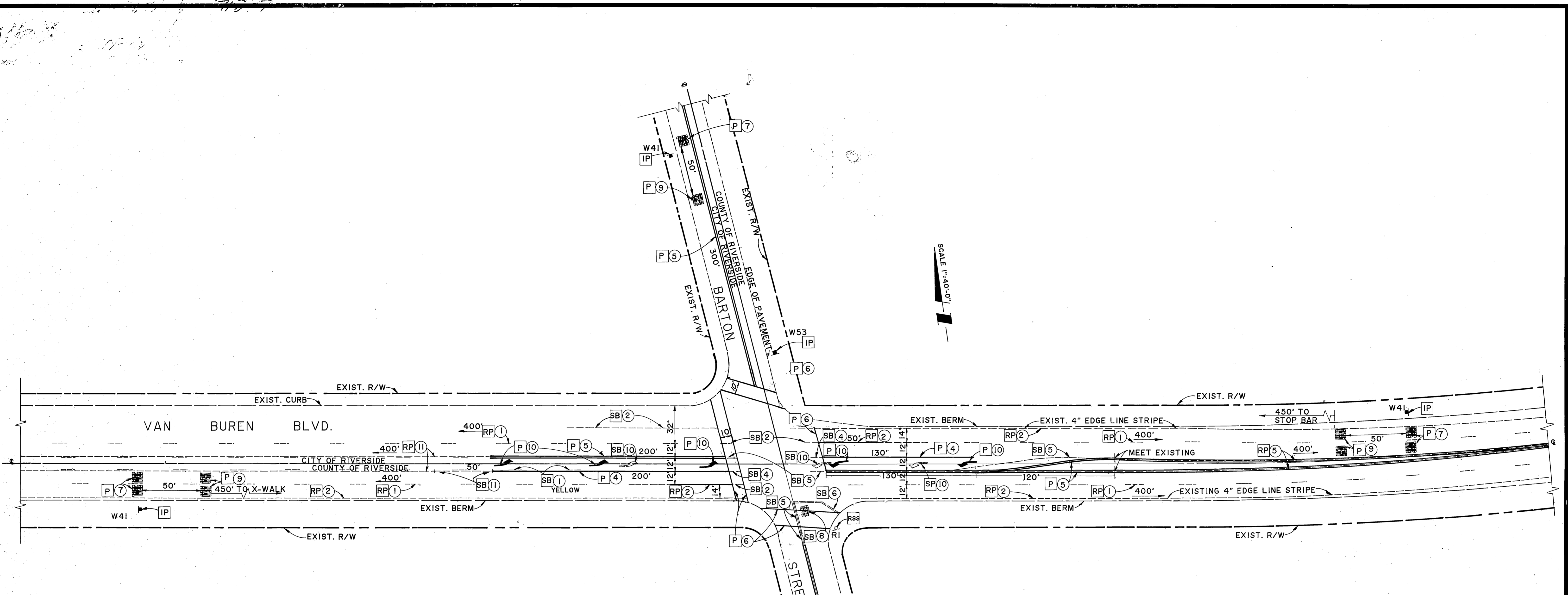

**SIGNING, STRIPING, AND MARKING LEGEND**

- |   |   |
|---|---|
| <b>P</b> PAINT  | <b>①</b> 4" DASH WHITE-12' STRIPE-36" GAP (DETAIL 12) |
| <b>I</b> INSTALL  | <b>②</b> 4" SOLID WHITE                               |
| <b>IP</b> INSTALL SIGN AND POST (TYP.) & PER CITY OF RIV. STD. DWG. No. 666 | <b>③</b> 4" SOLID YELLOW (DETAIL 25)                  |
| <b>IS</b> INSTALL SIGN  | <b>④</b> 8" SOLID WHITE (DETAIL 38)                   |
| <b>SB</b> WET SANDBLAST EXIST. STRIPING AND/OR PAVEMENT MARKING             | <b>⑤</b> 4" DOUBLE YELLOW (DETAIL 22)                 |
| <b>RP</b> REPAINT EXISTING  | <b>⑥</b> 12" SOLID WHITE                              |
| <b>RSS</b> REMOVE AND SALVAGE SIGN.   | <b>⑦</b> "SIGNAL" PAVEMENT MARKING                    |
|   | <b>⑧</b> "STOP" PAVEMENT MARKING                      |
|   | <b>⑨</b> "AHEAD" PAVEMENT MARKING                     |
|   | <b>⑩</b> ARROW MARKING-LEFT, RIGHT, OR STRAIGHT       |
|   | <b>⑪</b> TWO-WAY LEFT TURN LANE (DETAIL 32)           |

**NOTES**

- STRIPING DETAILS ARE PER SHEETS A-20A, B, & C OF THE CALTRANS STANDARD PLANS (JANUARY, 1988)
- THE ENGINEER SIGNING THESE PLANS IS RESPONSIBLE FOR ASSURING THE ACCURACY AND ACCEPTABILITY OF THE WORK HEREON. IN THE EVENT OF DISCREPANCIES ARISING DURING CONSTRUCTION, THE ENGINEER SHALL BE RESPONSIBLE FOR DETERMINING AN ACCEPTABLE SOLUTION AND REVISING THE PLANS FOR APPROVAL BY THE CITY.
- A COUNTY OF RIVERSIDE ENCROACHMENT PERMIT IS REQUIRED PRIOR TO THE START OF WORK.

**REVIEWED FOR ENCROACHMENT PERMIT**  
**APR 20 1989**  
**RIVERSIDE COUNTY ROAD PLAN CHECK**  
*[Signature]*

FILE WITH R-2971

<p><b>Underground Service Alert</b></p> <p>Call: TOLL FREE <b>1-800-422-4133</b></p> <p>TWO WORKING DAYS BEFORE YOU DIG</p>	<p><b>PRIVATE ENGINEERING NOTE</b></p> <p>CONSTRUCTION CONTRACTOR AGREES THAT IN ACCORDANCE WITH GENERALLY ACCEPTED CONSTRUCTION PRACTICES CONSTRUCTION CONTRACTOR WILL BE REQUIRED TO ASSUME SOLE AND COMPLETE RESPONSIBILITY FOR JOB SITE CONDITIONS DURING THE COURSE OF CONSTRUCTION OF THE PROJECT, INCLUDING SAFETY OF ALL PERSONS AND PROPERTY. THAT THIS REQUIREMENT SHALL BE MADE TO APPLY CONTINUOUSLY AND NOT BE LIMITED TO NORMAL WORKING HOURS, AND CONSTRUCTION CONTRACTOR FURTHER AGREES TO DEFEND, INDEMNIFY AND HOLD DESIGN PROFESSIONAL HARMLESS FROM ANY AND ALL LIABILITY REAL OR ALLEGED, IN CONNECTION WITH THE PERFORMANCE OF WORK ON THIS PROJECT, EXCEPTING LIABILITY ARISING FROM THE SOLE NEGLIGENCE OF DESIGN PROFESSIONAL.</p>	<p>PREPARED UNDER THE DIRECTION OF:</p> <p><i>[Signature]</i>  <b>REGISTERED CIVIL ENGINEER NO. 35458</b>          EXPIRATION DATE: <b>9-30-91</b> DATE: <b>10/14/88</b></p> <p>APPROVED BY:</p>	<p><b>J.F. Davidson Associates, Inc.</b>          ENGINEERING PLANNING SURVEYING ARCHITECTURE LANDSCAPE ARCHITECTURE</p> <p>3880 Lemon Street, Suite 300 P.O. Box 493 Riverside, CA 92502 (714) 686-0844 FAX 714-686-9954</p> <p>11200 S. Mt. Vernon Ave., Suite "D" Colton, CA 92324 (714) 926-1082</p> <p>73-080 El Paseo, Suite 106 Palm Desert, CA 92260 (919) 346-6691 FAX 619-340-0529</p>	<p><b>CITY OF RIVERSIDE, CALIFORNIA DEPARTMENT OF PUBLIC WORKS</b></p> <table border="1" style="width: 100%; border-collapse: collapse;"> <tr> <td>APPROVED BY</td> <td>BY</td> <td>DATE</td> <td>APPROVED BY</td> </tr> <tr> <td>PRINCIPAL ENGINEER</td> <td><i>[Signature]</i></td> <td>12-23-88</td> <td><i>[Signature]</i></td> </tr> <tr> <td>PARK DEPARTMENT</td> <td></td> <td></td> <td>DIRECTOR OF PUBLIC WORKS</td> </tr> <tr> <td>TRAFFIC DIVISION</td> <td><i>[Signature]</i></td> <td></td> <td></td> </tr> <tr> <td>CHIEF P.W. ENGR.</td> <td><i>[Signature]</i></td> <td>3/23/89</td> <td></td> </tr> </table>	APPROVED BY	BY	DATE	APPROVED BY	PRINCIPAL ENGINEER	<i>[Signature]</i>	12-23-88	<i>[Signature]</i>	PARK DEPARTMENT			DIRECTOR OF PUBLIC WORKS	TRAFFIC DIVISION	<i>[Signature]</i>			CHIEF P.W. ENGR.	<i>[Signature]</i>	3/23/89		<p><b>SIGNING, STRIPING &amp; MARKING PLAN</b></p> <p><b>VAN BUREN BLVD. AND BARTON STREET</b></p> <p>HORIZ. SCALE: 1" VERT. SCALE: 1"</p>	<p>PROJECT NO.</p> <p><b>XL-222</b></p> <p>SHEET <b>68D</b> OF <b>106</b></p> <p>FILE NO.</p>
APPROVED BY	BY	DATE	APPROVED BY																							
PRINCIPAL ENGINEER	<i>[Signature]</i>	12-23-88	<i>[Signature]</i>																							
PARK DEPARTMENT			DIRECTOR OF PUBLIC WORKS																							
TRAFFIC DIVISION	<i>[Signature]</i>																									
CHIEF P.W. ENGR.	<i>[Signature]</i>	3/23/89																								
<p>SCALE: 1"=40'-0"</p> <p>DATE: <b>AUG.-1988</b></p>			<p>DESIGNED BY <b>B.D.</b> DRAWN BY <b>C.M.M.</b> CHECKED BY _____</p>		<p>MARK REVISIONS APPR. DATE</p>																					

INDEXED 12-23-88