

BLAINE STREET

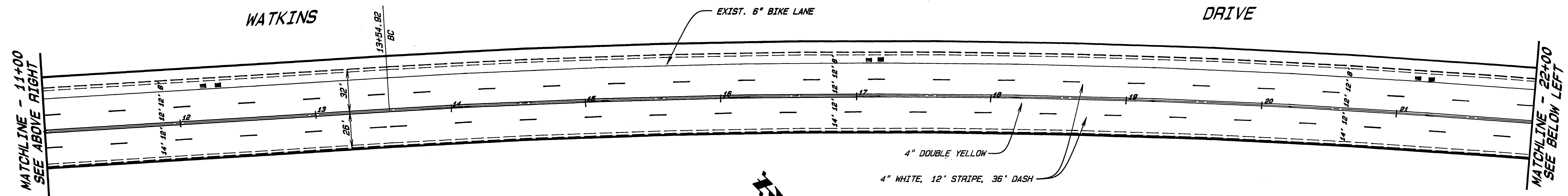

**NOTE:**  
CONTRACTOR SHALL INSTALL  
REG & RBL SIGN & EVERY OTHER  
STREET LIGHT BETWEEN SPRUCE  
AND CANYON CREST.

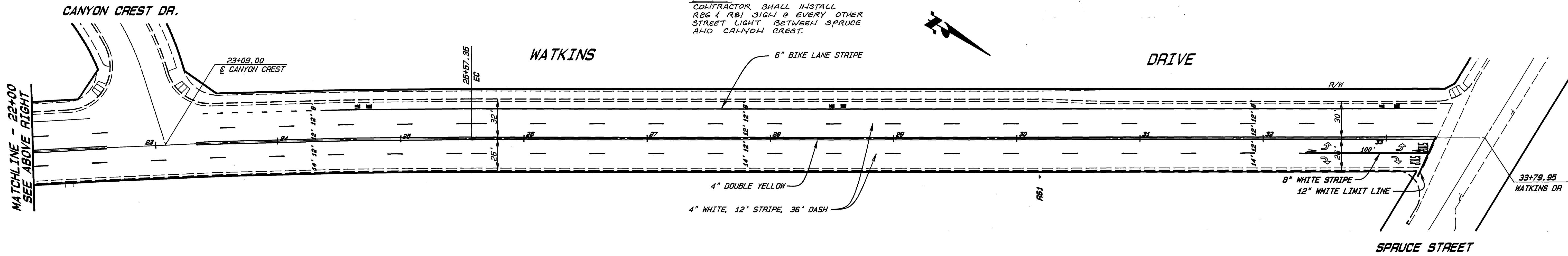

**CITY OF RIVERSIDE**  
**PUBLIC WORKS DEPARTMENT**

**WATKINS DRIVE WIDENING**  
**BLAINE ST. to SPRUCE ST.**  
**Striping Plan**

ACCOUNT NO. 30-575-300-07

APPROVED BY	DATE	BY	APPROVED BY
DEPUTY P. W. ENGINEER	8-16-89	[Signature]	[Signature]
PRINCIPAL ENGINEER	8-16-89	[Signature]	[Signature]
SURVEYOR	8/16/89	[Signature]	[Signature]
CHIEF P. W. INSPECTOR	8/16/89	[Signature]	[Signature]
TRAFFIC DIVISION	8/16/89	[Signature]	[Signature]
PARK & RECREATION	8/16/89	[Signature]	[Signature]

XL-234  
SHEET 1 OF 1

HORIZ. SCALE: 1" = 40' VERT. SCALE: 1" =