

**GENERAL NOTES:**

1. TRAFFIC STRIPES, PAVEMENT LEGENDS AND RAISED PAVEMENT MARKERS PER CALTRANS TRAFFIC MANUAL, MAINTENANCE MANUAL, STANDARD PLANS AND STANDARD SPECIFICATIONS SECTION 84, JANUARY 1988.
2. ALL STRIPES, SIGNS AND LEGENDS SHALL BE REFLECTORIZED. PAVEMENT LEGENDS AND MARKINGS SHALL MATCH CALTRANS STENCILS.
3. ALL REMOVED SIGNS IN GOOD CONDITION SHALL BE SALVAGED AND DELIVERED TO THE STATE MAINTENANCE YARD.
4. ALL SIGNS TO BE INSTALLED ON 4" X 4" WOOD POSTS PER CALTRANS STANDARD PLAN S42-15, JANUARY 88 EDITION. ALL POST SHALL BE SET IN 1.0 CUBIC FOOT OF CONCRETE.
5. ALL STRIPING SHOWN INCLUDES RAISED PAVEMENT MARKERS PER APPLICABLE CALTRANS DETAILS.

**STRIPING AND PAVEMENT MARKING LEGEND**

- ① INSTALL 4" LANE LINE SKIP WHITE (7" STRIPE - 17" GAP) (DETAIL 9) (THERMOPLASTIC)
- ② INSTALL 4" EDGE LINE OR LANE LINE SOLID WHITE (THERMOPLASTIC)
- ③ INSTALL 4" EDGE LINE SOLID YELLOW (DETAIL 25) (THERMOPLASTIC)
- ④ INSTALL 12" SOLID WHITE CROSSWALK (THERMOPLASTIC)
- ⑤ INSTALL STD. "SIGNAL" "AHEAD" PAVEMENT MARKING @ 50' C-C (THERMOPLASTIC)
- ⑥ INSTALL "ARROW" MARKING (TYPE III (L OR R) OR TYPE IIB) (THERMOPLASTIC)
- ⑦ INSTALL "ARROW" MARKING (TYPE IV (L OR R) OR VIII) (THERMOPLASTIC)
- ⑧ INSTALL TYPE "A" NON-REFLECTIVE WHITE BUTTON @ 4' O.C. (DETAIL 40A)

**Underground Service Alert**  
 Call: TOLL FREE  
 1 - 800  
 422 - 4133  
 TWO WORKING DAYS BEFORE YOU DIG

**PRIVATE ENGINEERING NOTE**  
 CONSTRUCTION CONTRACTOR AGREES THAT IN ACCORDANCE WITH GENERALLY ACCEPTED CONSTRUCTION PRACTICES, CONSTRUCTION CONTRACTOR WILL BE REQUIRED TO ASSUME SOLE AND COMPLETE RESPONSIBILITY FOR JOB SITE CONDITIONS DURING THE COURSE OF CONSTRUCTION OF THE PROJECT, INCLUDING SAFETY OF ALL PERSONS AND PROPERTY; THAT THIS REQUIREMENT SHALL BE MADE TO APPLY CONTINUOUSLY AND NOT BE LIMITED TO NORMAL WORKING HOURS, AND CONSTRUCTION CONTRACTOR FURTHER AGREES TO DEFEND INDEMNIFY AND HOLD DESIGN PROFESSIONAL HARMLESS FROM ANY AND ALL LIABILITY, REAL OR ALLEGED, IN CONNECTION WITH THE PERFORMANCE OF WORK ON THIS PROJECT, EXCEPTING LIABILITY ARISING FROM THE SOLE NEGLIGENCE OF DESIGN PROFESSIONAL.

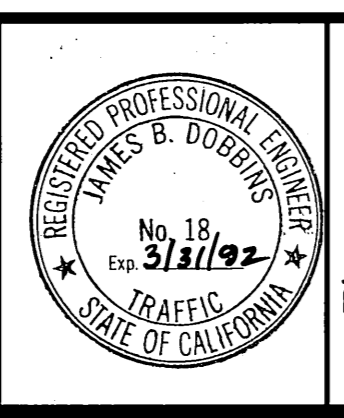

PREPARED UNDER THE DIRECTION OF  
*James B. Davidson*  
 REGISTERED TRAFFIC ENGINEER NO: 18  
 EXPIRATION DATE: 3/31/92 DATE: 11/4/91

**J.F. Davidson Associates, Inc.**  
 ENGINEERING PLANNING SURVEYING LANDSCAPE ARCHITECTURE  
 MUNICIPAL ENGINEERING DIVISION  
 3426 TENTH STREET  
 P.O. BOX 493  
 RIVERSIDE, CA 92502  
 (714) 683-0209 FAX (714) 686-5807

SCALE: 1" = 40'-0"  
 DATE: NOVEMBER, 91

MARK	REVISIONS	APPR.	DATE
DESIGNED BY	KTO	DRAWN BY	KTO
CHECKED BY	OMA	DATE	11/4/91

**CITY OF RIVERSIDE, CALIFORNIA**  
**DEPARTMENT OF PUBLIC WORKS**

APPROVED BY	BY	DATE	APPROVED BY
PRINCIPAL ENGINEER	[Signature]	11/4/91	[Signature]
INSPECTION			
TRAFFIC DIVISION			
CHIEF P.W. ENGINEER	[Signature]	11/4/91	
DATE		11/21/92	

TYLER MALL EXPANSION  
 C.F.D. # 90-2 IMPROVEMENTS  
 SIGNING, STRIPING & MARKING PLAN  
**91 EB OFFRAMP**  
 HORIZ SCALE: 1" VERT. SCALE: 1"

PERMIT NO.  
 08-90-N-1348  
 08-RIV-91-12.91

PROJECT NO.  
**XL-262**

SHEET 1 OF 1

FILE NO:  
 8911175

REVISED PLANS

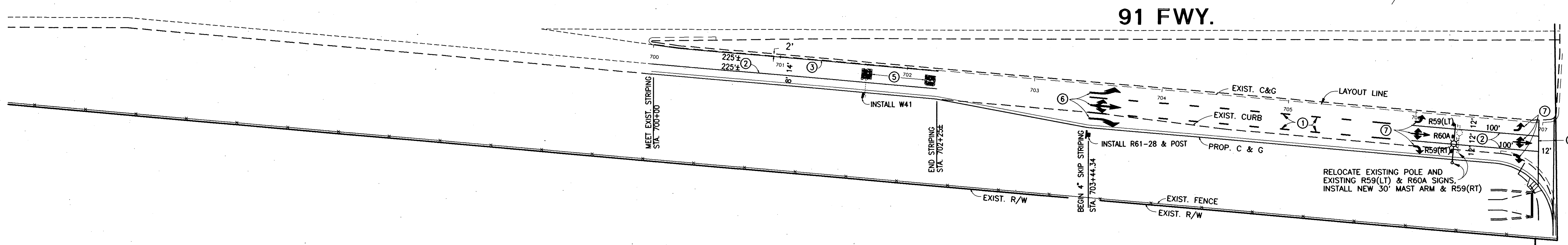

91 FWY.

TYLER ST.

**GENERAL NOTES:**

1. TRAFFIC STRIPES, PAVEMENT LEGENDS AND RAISED PAVEMENT MARKERS PER CALTRANS TRAFFIC MANUAL, MAINTENANCE MANUAL, STANDARD PLANS AND STANDARD SPECIFICATIONS SECTION 84, JANUARY 1988.
2. ALL STRIPES, SIGNS AND LEGENDS SHALL BE REFLECTORIZED. PAVEMENT LEGENDS AND MARKINGS SHALL MATCH CALTRANS STENCILS.
3. ALL CONFLICTING LINES, MARKINGS AND RAISED PAVEMENT MARKERS SHALL BE REMOVED BY SANDBLASTING.
4. TRAFFIC STRIPES AND MARKINGS SHALL BE APPLIED IN TWO COATS.
5. ALL REMOVED SIGNS IN GOOD CONDITION SHALL BE SALVAGED AND DELIVERED TO THE CITY YARD.
6. ALL SIGNS TO BE INSTALLED ON 4" X 4" WOOD POSTS PER CALTRANS STANDARD PLAN S42-15, JANUARY 88 EDITION. ALL POST SHALL BE SET IN 1.0 CUBIC FOOT OF CONCRETE.
7. ALL STRIPING SHOWN INCLUDES RAISED PAVEMENT MARKERS PER APPLICABLE CALTRANS DETAILS.

**STRIPING AND PAVEMENT MARKING LEGEND**

- ① INSTALL 4" SKIP WHITE (7' STRIPE - 17' GAP) (DETAIL 9) (THERMOPLASTIC)
- ② INSTALL 4" SOLID WHITE (THERMOPLASTIC)
- ③ INSTALL 4" SOLID YELLOW (THERMOPLASTIC)
- ④ INSTALL 12" SOLID WHITE CROSSWALK (THERMOPLASTIC)
- ⑤ INSTALL STD. "SIGNAL" "AHEAD" PAVEMENT MARKING (THERMOPLASTIC)
- ⑥ INSTALL "ARROW" MARKING (TYPE III (L OR R) OR TYPE IIB) (THERMOPLASTIC)
- ⑦ INSTALL "ARROW" MARKING (TYPE IV (L OR R) OR VIII)) (THERMOPLASTIC)

**Underground Service Alert**  
Call: TOLL FREE  
1 - 800  
422 - 4133  
TWO WORKING DAYS BEFORE YOU DIG

**PRIVATE ENGINEERING NOTE**  
CONSTRUCTION CONTRACTOR AGREES THAT IN ACCORDANCE WITH GENERALLY ACCEPTED CONSTRUCTION PRACTICES, CONSTRUCTION CONTRACTOR WILL BE REQUIRED TO ASSUME SOLE AND COMPLETE RESPONSIBILITY FOR JOB SITE CONDITIONS DURING THE COURSE OF CONSTRUCTION OF THE PROJECT, INCLUDING SAFETY OF ALL PERSONS AND PROPERTY; THAT THIS REQUIREMENT SHALL BE MADE TO APPLY CONTINUOUSLY AND NOT BE LIMITED TO NORMAL WORKING HOURS, AND CONSTRUCTION CONTRACTOR FURTHER AGREES TO DEFEND INDEMNIFY AND HOLD DESIGN PROFESSIONAL HARMLESS FROM ANY AND ALL LIABILITY, REAL OR ALLEGED, IN CONNECTION WITH THE PERFORMANCE OF WORK ON THIS PROJECT, EXCEPTING LIABILITY ARISING FROM THE SOLE NEGLIGENCE OF DESIGN PROFESSIONAL.

PREPARED UNDER THE DIRECTION OF  
*James B. Dobson*  
REGISTERED TRAFFIC ENGINEER NO. 18  
EXPIRATION DATE: 3/31/92 DATE: 12-19-90  
APPROVED BY:

**J.F. Davidson Associates, Inc.**  
ENGINEERING PLANNING SURVEYING  
ARCHITECTURE LANDSCAPE ARCHITECTURE  
MUNICIPAL ENGINEERING DIVISION  
3426 TENTH STREET  
RIVERSIDE, CA 92502  
(714) 683-0209 FAX (714) 686-5807

SCALE: 1" = 40'-0"  
BENCH MARK:  
DATE: DECEMBER, 90

MARK	REVISIONS	APPR.	DATE
DESIGNED BY	DRAWN BY	CHECKED BY	

CITY OF RIVERSIDE, CALIFORNIA  
DEPARTMENT OF PUBLIC WORKS

APPROVED BY	BY	DATE
PRINCIPAL ENGINEER		
INSPECTION		
TRAFFIC DIVISION		
CHIEF P.W. ENGINEER		

APPROVED BY: *James B. Dobson*  
DIRECTOR OF PUBLIC WORKS  
DATE: 12/21/90

TYLER MALL EXPANSION  
C.F.D. # 90-2 IMPROVEMENTS  
SIGNING, STRIPING & MARKING PLAN  
**91 EB OFFRAMP**

HORIZ SCALE: 1" VERT. SCALE: 1"

PROJECT NO.  
**XL-262**  
SHEET 1 OF 1  
FILE NO: