

STRIPING & MARKING LEGEND

- 1 4" SOLID DOUBLE YELLOW STRIPE
- 3 YELLOW TWO-WAY TURN LANE
- 4 YELLOW HIGH VISIBILITY CROSSWALK
- 5 12" SOLID YELLOW MARKING
- 6 4" SOLID WHITE STRIPE
- 7 4" SKIP WHITE STRIPE (7' STRIPE, 17' GAP)
- 8" SOLID WHITE STRIPE
- 12" SOLID WHITE MARKING
- 13 SOLID WHITE ARROW MARKING
- 17 SOLID YELLOW "SLOW, SCHOOL, XING" MARKING
- 23 SOLID WHITE "STOP" MARKING
- 24 PAINT CURB RED

CITY OF RIVERSIDE		REHABILITATION OF MAJOR CITY STREETS 1990-1991		ACCOUNT NO. 30-575-329-15
PUBLIC WORKS DEPARTMENT		DATE: 2/16/92 BY: R.M.G.		XL-271
APPROVED BY: <i>[Signature]</i>		DATE: 2/19/92		
DESIGNED BY: TRC		DRAWN BY: CS, BLM		SHEET 1 OF 2

BROCKTON AVENUE
JURUPA AVE TO TEQUESQUITE

HORIZ. SCALE: 1" = 40' VERT. SCALE: 1" = 4'

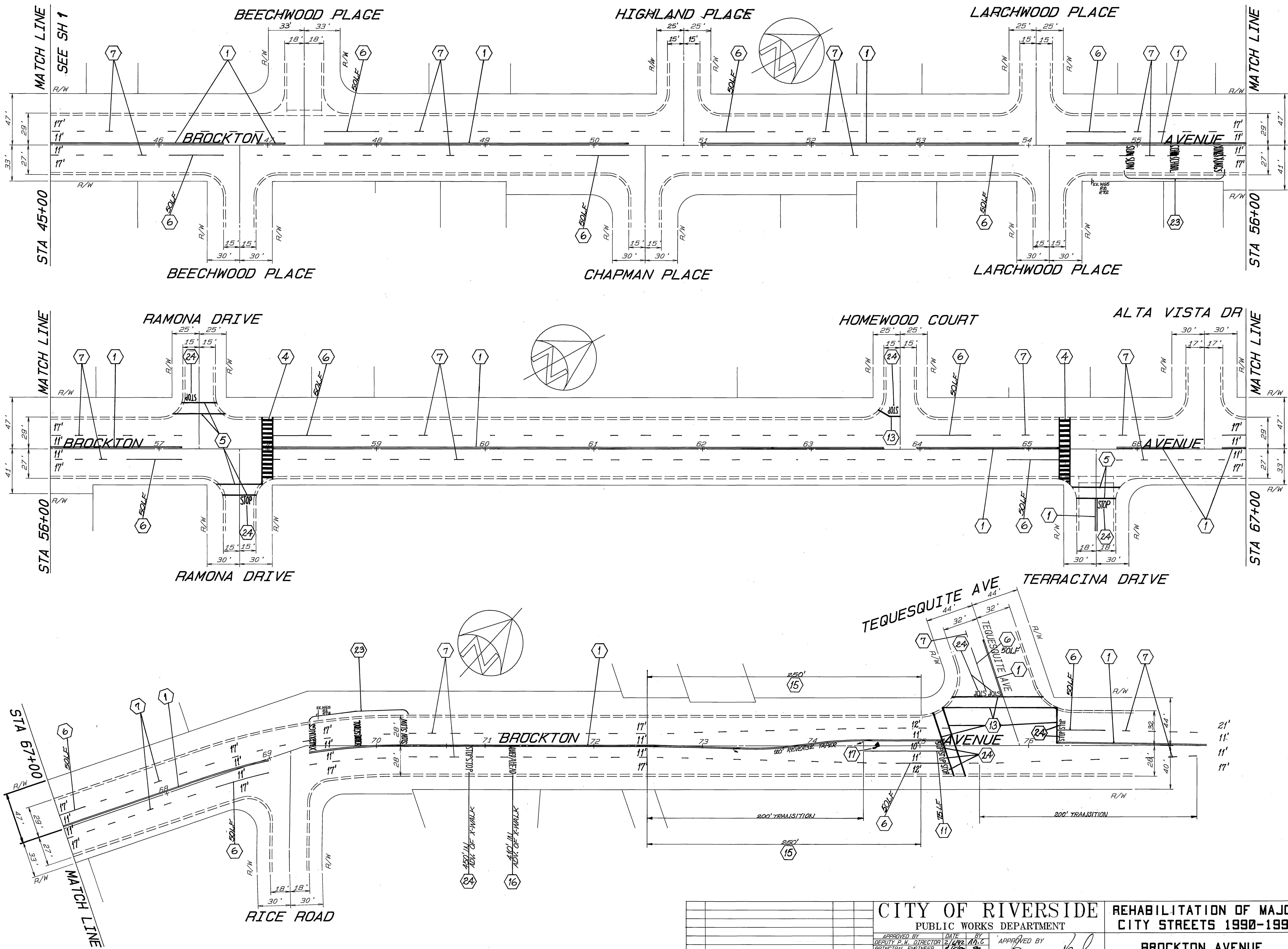

CITY OF RIVERSIDE PUBLIC WORKS DEPARTMENT			REHABILITATION OF MAJOR CITY STREETS 1990-1991		ACCOUNT NO. 30-575-329-15
APPROVED BY: _____ DATE: 2/1/92 BY: _____ DEPUTY P. M. DIRECTOR: _____ PRINCIPAL ENGINEER: _____ CHIEF P. M. INSPECTOR: _____ SURVEYOR: _____ TRAFFIC DIVISION: _____ PARKS DEPARTMENT: _____ STREET SERVICES: _____			APPROVED BY: <i>Danny Paul</i> PUBLIC WORKS DIRECTOR DATE: 2/1/92		XL-271 SHEET 2 OF 2
DESIGNED BY: TRC DRAWN BY: C.S. RUM CHECKED BY: _____			BROCKTON AVENUE JURUPA AVE TO TEQUESQUITE		HORIZ. SCALE: 1" = 40' VERT. SCALE: 1" = 4'