

PAVEMENT DELINEATION

- Indicates striping and pavement markings to be installed.
- - - - - Indicates striping and pavement markings to remain.
- Indicates striping and pavement markings to be removed.

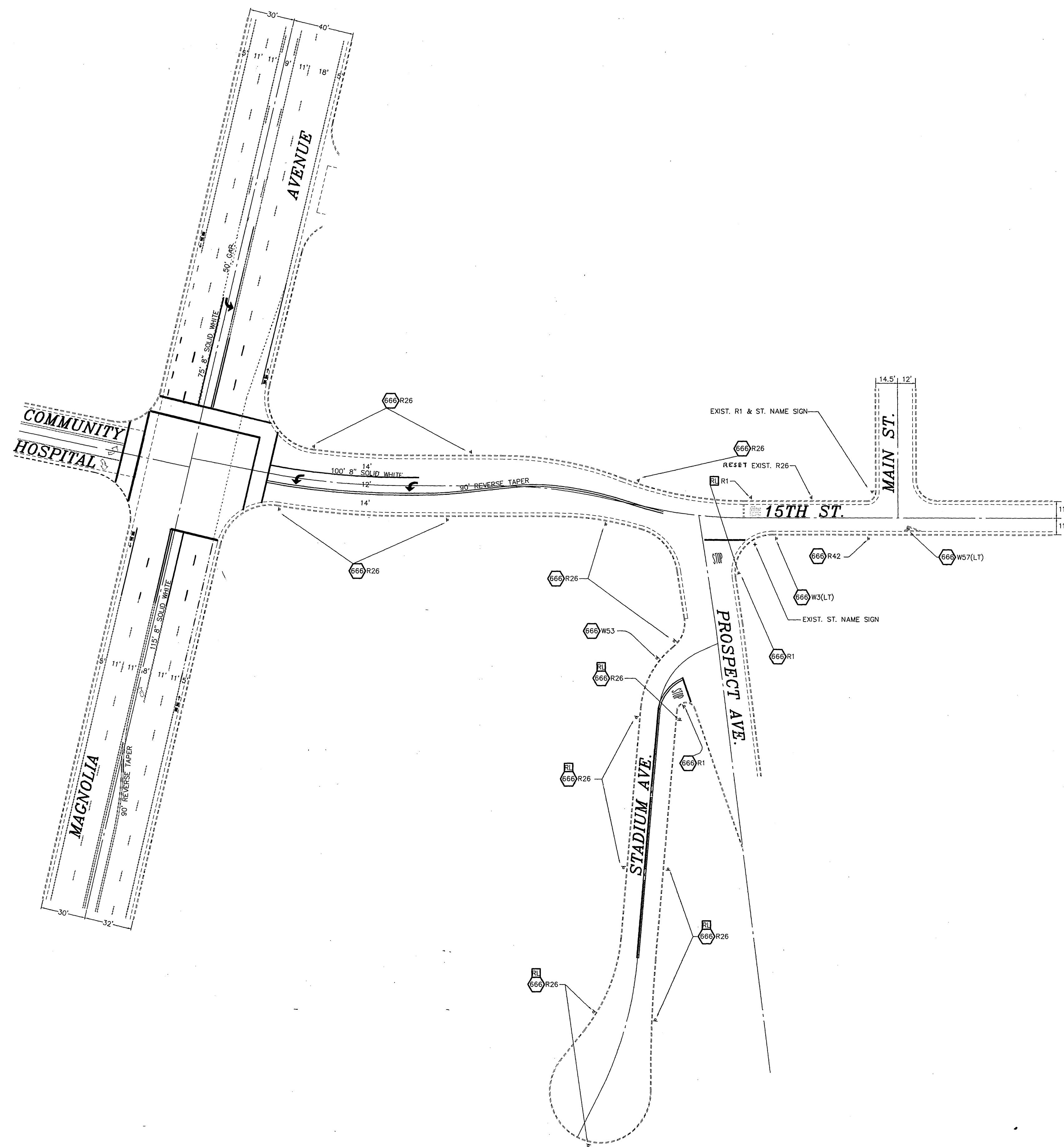

NOTES:

1. Install sign per City Standard Drawing No. 666.
2. Remove and relocate sign.
3. See Special Provisions regarding the relocation of existing signs.
4. Existing RCC signs (on posts and fence) shall be relocated as directed in field.
5. Salvage W58 and Type "N" signs mounted on street name sign post.
6. Pavement delineation shall be performed by City Forces; see Special Provisions.

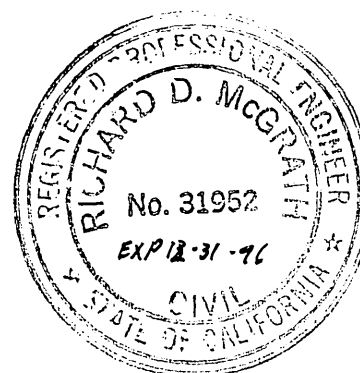

ENGINEER IN RESPONSIBLE CHARGE <i>Richard D. McGrath</i> RICHARD D. McGRATH R.C.E. No. 31952 expires 12-31-96 DATE 2-11-93		CITY OF RIVERSIDE, CALIFORNIA DEPARTMENT OF PUBLIC WORKS		PAVEMENT DELINEATION AND SIGNING FIFTEENTH STREET EXTENSION MAGNOLIA TO MAIN		ACCT. NO. 30-575-395-07 XL-314 SHEET 1 OF 1 FILE NO.	
APPROVED BY _____ BY DATE _____ PRINCIPAL ENGINEER <i>R. McGrath</i>		APPROVED BY _____ BY DATE _____ DIRECTOR OF PUBLIC WORKS <i>Ray Bell</i>		TRAFFIC DIVISION _____ DATE <i>2/11/93</i> CHIEF P.W. ENGR. _____ PUBLIC UTILITIES _____ STREET SERVICES _____		HORIZ. SCALE: 1" = 40' DESIGNER BY _____ DRAWN BY <i>JRC</i> CHECKED BY _____	

