

- STRIPING & MARKING LEGEND**
- (A) 4" SKIP WHITE STRIPE (12' STRIPE, 36" GAP), WITH TYPE G ONE-WAY CLEAR REFLECTIVE MARKERS.
  - (B) 4" SOLID WHITE STRIPE (50 L.F.), WITH TYPE G ONE-WAY CLEAR REFLECTIVE MARKERS.
  - (C) 8" SOLID WHITE STRIPE, WITH TYPE G ONE-WAY CLEAR REFLECTIVE MARKERS.
  - (D) 6" SOLID WHITE STRIPE.
  - (E) 6" SKIP WHITE STRIPE (4" STRIPE, 8" GAP) 96 L.F.
  - (F) SOLID WHITE "BIKE, LANE, →" MARKING, APPROXIMATELY EVERY 300 FEET.
  - (G) 12" SOLID WHITE MARKING.
  - (H) SOLID WHITE ARROW

- SIGN LEGEND**
- [AA] INSTALL R26(12" X 18") & R81(12" X 8") SIGNS ON NEW POST, APPROXIMATELY EVERY 500 FEET.
  - [BB] INSTALL R81 SIGN BELOW EXISTING R26 SIGN.
  - [CC] REMOVE AND SALVAGE EXISTING R81 SIGN AND POST.

CITY OF RIVERSIDE DEPARTMENT OF PUBLIC WORKS TRAFFIC ENGINEERING DIVISION		STRIPING & SIGNING PLAN	SCALE: 1" = 40'
DESIGN: Bob G. DRAWN: Bob G. CHECKED: Bob G. REVISIONS:		APPROVED BY: <i>[Signature]</i> CITY TRAFFIC ENGINEER DATE 4/2/93	CENTRAL AV. WIDENING CANYON CREST DRIVE TO BOX SPRINGS BLVD.
			XL-321 SHEET 1 OF 3

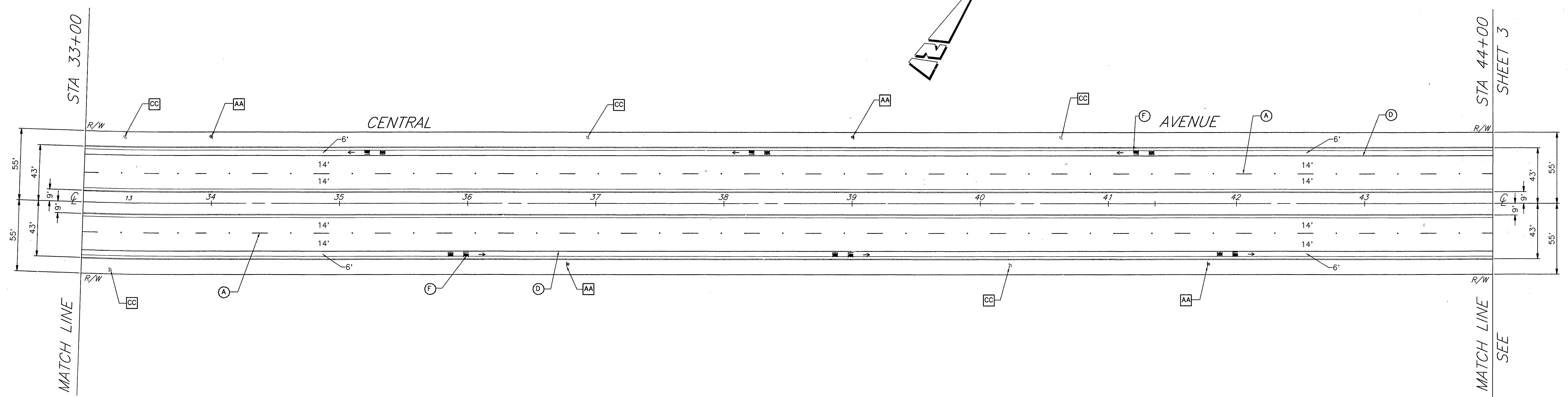
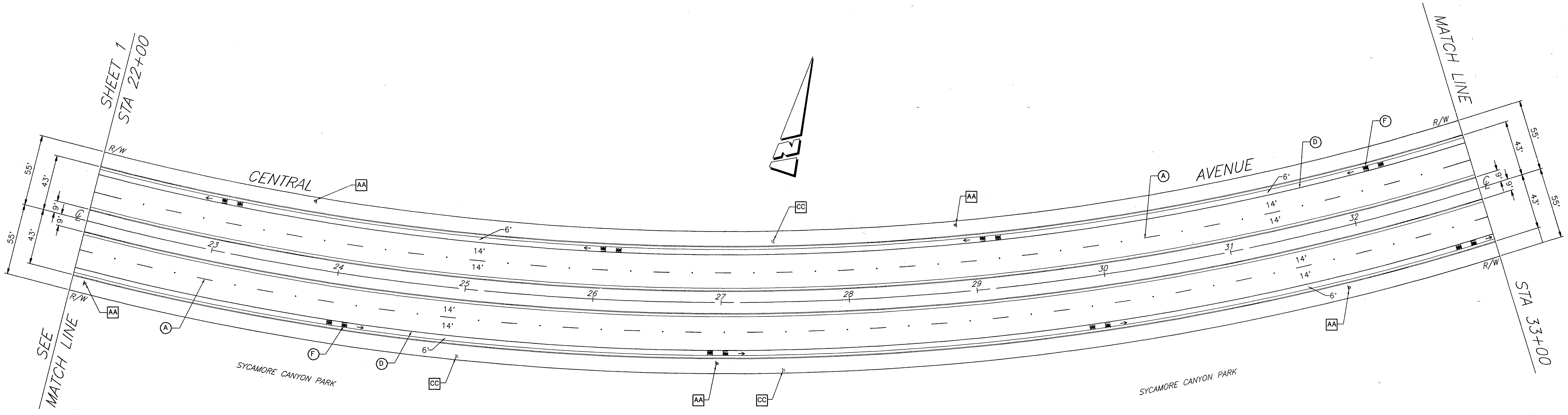

- STRIPING & MARKING LEGEND**
- (A) 4" SKIP WHITE STRIPE (12' STRIPE, 36" GAP), WITH TYPE G ONE-WAY CLEAR REFLECTIVE MARKERS.
  - (B) 4" SOLID WHITE STRIPE (50 L.F.), WITH TYPE G ONE-WAY CLEAR REFLECTIVE MARKERS.
  - (C) 8" SOLID WHITE STRIPE, WITH TYPE G ONE-WAY CLEAR REFLECTIVE MARKERS.
  - (D) 6" SOLID WHITE STRIPE
  - (E) 6" SKIP WHITE STRIPE (4' STRIPE, 8' GAP) 96 L.F.
  - (F) SOLID WHITE "BIKE, LANE, ->" MARKING, APPROXIMATELY EVERY 300 FEET.
  - (G) 12" SOLID WHITE MARKING
  - (H) SOLID WHITE ARROW

- SIGN LEGEND**
- AA INSTALL R26(12" X 18") & R81(12" X 8") SIGNS ON NEW POST, APPROXIMATELY EVERY 500 FEET.
  - BB INSTALL R81 SIGN BELOW EXISTING R26 SIGN.
  - CC REMOVE AND SALVAGE EXISTING R81 SIGN AND POST.

CITY OF RIVERSIDE DEPARTMENT OF PUBLIC WORKS TRAFFIC ENGINEERING DIVISION		STRIPING & SIGNING PLAN	SCALE: 1" = 40'
CENTRAL AV. WIDENING CANYON CREST DRIVE TO BOX SPRINGS BLVD.		XL-321	
DESIGN: Bob G.	APPROVED BY:	SHEET 2 OF 3	
DRAWN: Bob G.	CITY TRAFFIC ENGINEER		
CHECKED: Bob G.	DATE: 4/23		
REVISIONS:			

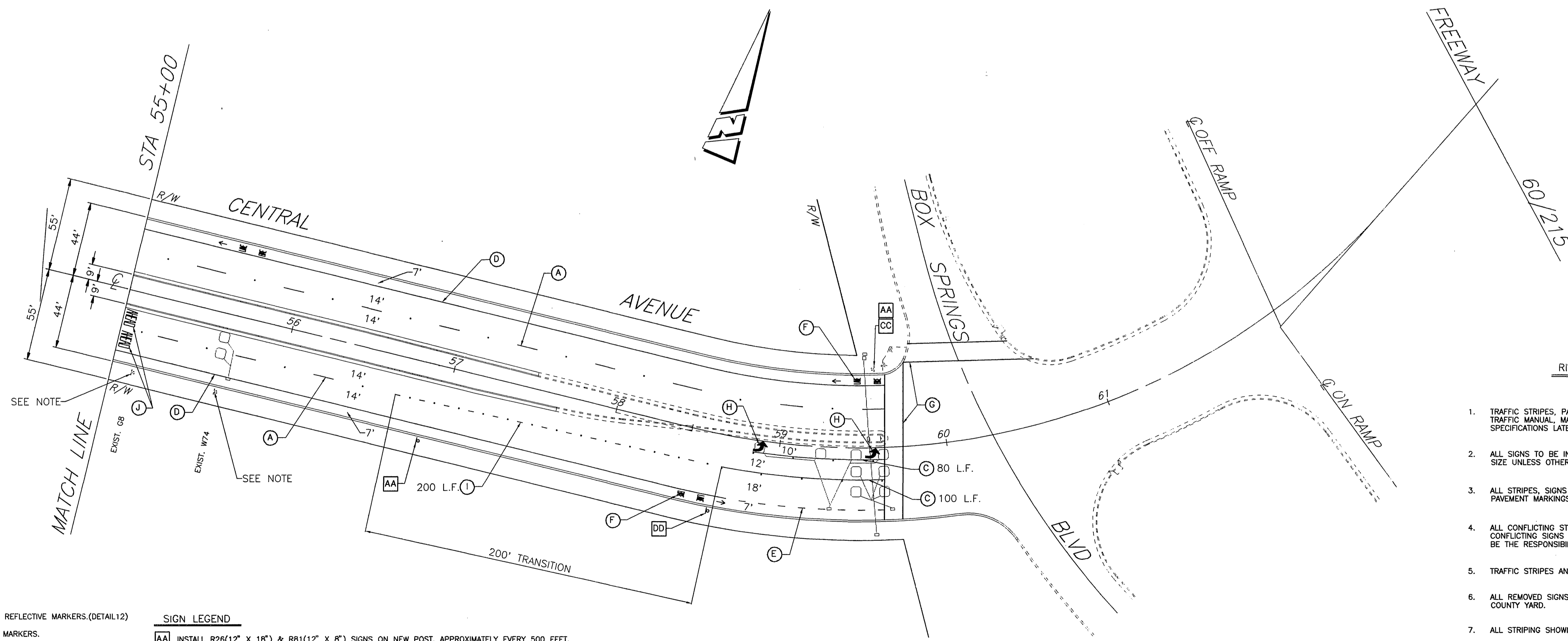
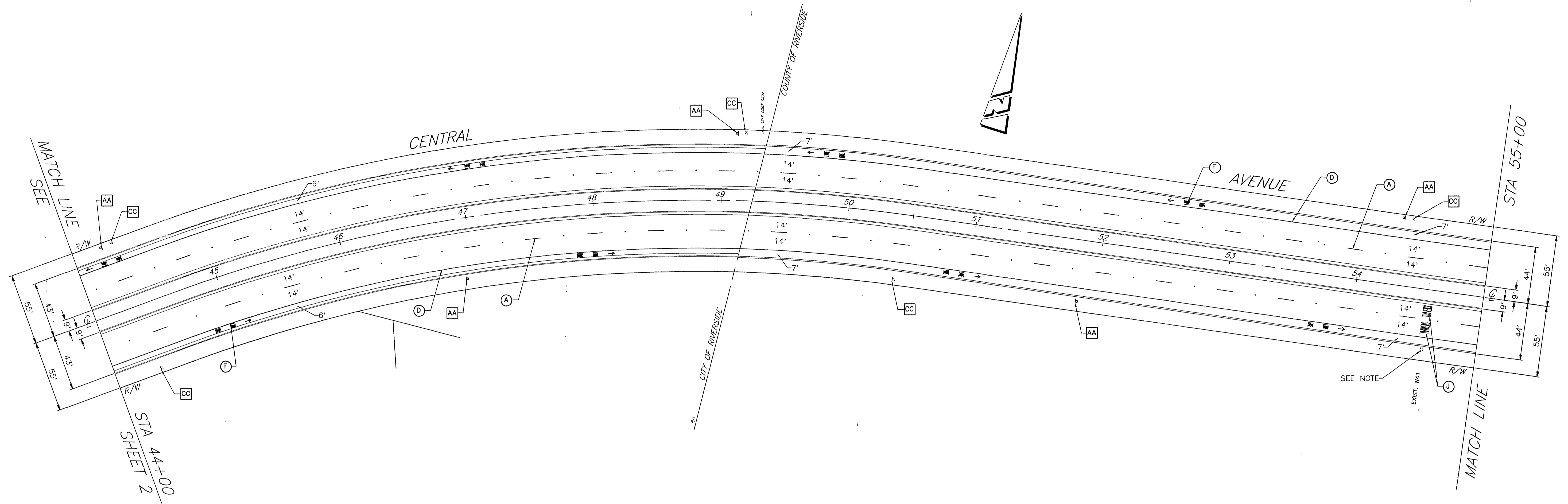

RIVERSIDE COUNTY -- ROAD DEPARTMENT  
GENERAL NOTES

1. TRAFFIC STRIPES, PAVEMENT MARKINGS & RAISED PAVEMENT MARKERS PER CALTRANS TRAFFIC MANUAL, MAINTENANCE MANUAL, STANDARD PLANS AND STANDARD SPECIFICATIONS LATEST EDITION.
2. ALL SIGNS TO BE INSTALLED ON 4" X 4" WOOD POSTS. ALL SIGNS SHALL BE STANDARD SIZE UNLESS OTHERWISE NOTED ON PLANS.
3. ALL STRIPES, SIGNS AND PAVEMENT MARKINGS SHALL BE REFLECTORIZED. STENCILS FOR PAVEMENT MARKINGS SHALL MATCH COUNTY STENCILS.
4. ALL CONFLICTING STRIPES AND PAVEMENT MARKINGS SHALL BE REMOVED BY SANDBLASTING. CONFLICTING SIGNS AND RAISED PAVEMENT MARKERS SHALL BE REMOVED. REMOVAL SHALL BE THE RESPONSIBILITY OF THE CONTRACTOR.
5. TRAFFIC STRIPES AND MARKERS SHALL BE APPLIED IN TWO COATS.
6. ALL REMOVED SIGNS IN GOOD CONDITION SHALL BE SALVAGED AND DELIVERED TO THE COUNTY YARD.
7. ALL STRIPING SHOWN PER APPLICABLE CALTRANS DETAILS.

- STRIPING & MARKING LEGEND**
- (A) 4" SKIP WHITE STRIPE (12" STRIPE, 36" GAP), WITH TYPE G ONE-WAY CLEAR REFLECTIVE MARKERS.(DETAIL 12)
  - (B) 4" SOLID WHITE STRIPE (50 L.F.), WITH TYPE G ONE-WAY CLEAR REFLECTIVE MARKERS.
  - (C) 8" SOLID WHITE STRIPE, WITH TYPE G ONE-WAY CLEAR REFLECTIVE MARKERS.
  - (D) 6" SOLID WHITE STRIPE.(DETAIL 39)
  - (E) 6" SKIP WHITE STRIPE (4" STRIPE, 8" GAP) 96 L.F.(DETAIL 39A)
  - (F) SOLID WHITE "BIKE LANE, ->" MARKING, APPROXIMATELY EVERY 300 FEET.
  - (G) 12" SOLID WHITE MARKING
  - (H) SOLID WHITE ARROW (TYPE IV)
  - (I) 8" SKIP WHITE STRIPE (3" STRIPE, 12" GAP), WITH TYPE G ONE-WAY CLEAR REFLECTIVE MARKERS.(DETAIL 37B)
  - (J) SOLID WHITE "SIGNAL, AHEAD" MARKING.

- SIGN LEGEND**
- AA INSTALL R26(12" X 18") & R81(12" X 8") SIGNS ON NEW POST, APPROXIMATELY EVERY 500 FEET.
  - BB INSTALL R81 SIGN BELOW EXISTING R26 SIGN.
  - CC REMOVE AND SALVAGE EXISTING R81 SIGN AND POST.
  - DD INSTALL R26(12" X 18"), R81(12" X 8") & R81B(8" X 5") SIGNS ON NEW POST.

NOTE: SIGNS ARE TO BE REPLACED IF DAMAGED DURING ROAD CONSTRUCTION.

CITY OF RIVERSIDE DEPARTMENT OF PUBLIC WORKS TRAFFIC ENGINEERING DIVISION		STRIPING & SIGNING PLAN	SCALE: 1" = 40'
CENTRAL AV. WIDENING CANYON CREST DRIVE TO BOX SPRINGS BLVD.		XL-321	
DESIGN: Bob G. DRAWN: Bob G. CHECKED: Bob G. REVISIONS:	APPROVED BY: <i>[Signature]</i> CITY TRAFFIC ENGINEER DATE: 6/4/93		SHEET 3 OF 3