

PAVEMENT	DELINEATION
	INDICATES STRIPING AND PAVEMENT MARKINGS TO BE INSTALLED.
	INDICATES STRIPING AND PAVEMENT MARKINGS TO REMAIN.
	INDICATES STRIPING AND PAVEMENT MARKINGS TO BE REMOVED.

NOTE: ALL PAVEMENT DELINEATION WORK SHALL BE PERFORMED BY CITY OF RIVERSIDE FORCES.

PAVEMENT MARKING, AND DELINEATION LEGEND

- | | |
|------------------------------------------------------|--------------------------------------------------------|
| (A) PAINT 4" SOLID DOUBLE YELLOW STRIPE | (G) INSTALL SOLID WHITE RAILROAD CROSSING SYMBOL |
| (B) PAINT 4" SKIP WHITE STRIPE (7' STRIPE, 17' GAP) | (H) INSTALL 12" SOLID WHITE MARKING |
| (C) PAINT 8" SOLID WHITE STRIPE | (I) INSTALL WHITE "STOP" SYMBOL |
| (D) INSTALL SOLID WHITE ARROW | (J) INSTALL SOLID WHITE LANE DROP ARROW |
| (E) REVERSE TAPER | (L) TWO-WAY YELLOW REFLECTIVE MARKERS (AT 24' SPACING) |
| (F) PAINT 4" SOLID WHITE STRIPE | (M) ONE-WAY CLEAR RELECTIVE MARKERS (AT 24' SPACING) |

GENERAL NOTES

- SEE ALSO PLAN NO. R-3355 FOR STREET IMPROVEMENT WORK.
 - SEE ALSO PLAN NO. X-323 FOR TRAFFIC SIGNAL WORK.
 - REMOVE ANY CONFLICTING EXISTING STRIPING.
- INSTALL SIGN PER CITY OF RIVERSIDE STD DWG NO 666.

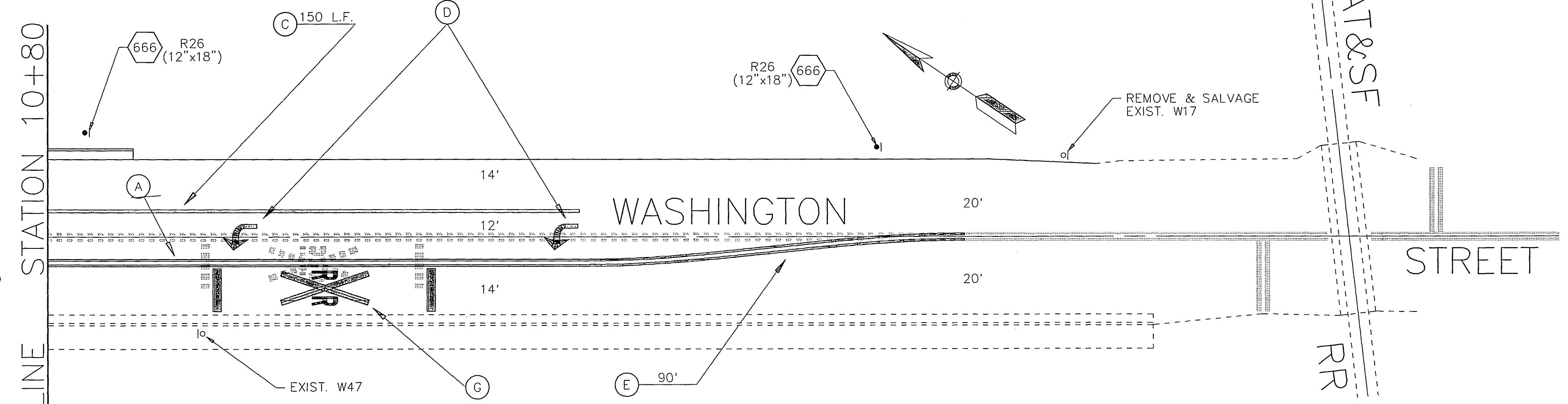

ENGINEER IN RESPONSIBLE CHARGE

 RICHARD D. McGRATH
 R.C.E. No. 31952 expires 12-31-96
 DATE 5-5-95

MARK	REVISIONS	APPR.	DATE

CITY OF RIVERSIDE, CALIFORNIA
 DEPARTMENT OF PUBLIC WORKS
 APPROVED BY:
 PRINCIPAL ENGINEER:
 P.W. INSPECTION:
 TRAFFIC DIVISION:
 CHIEF P.W. ENGR.:
 STREET SERVICES:

PAVEMENT DELINEATION & SIGN PLAN
 INDIANA AVENUE @ WASHINGTON STREET IMPROVEMENTS
 SCALE: 1" = 20'

ACCT. NO. 230-541500-440223-30338
 XL-338 (R-3355)
 SHEET 1 OF 1
 FILE NAME: XL338.DWG