

PAVEMENT DELINEATION

- Indicates striping and pavement markings to be installed.
- - - - - Indicates striping and pavement markings to remain.
- □ □ □ □ Indicates striping and pavement markings to be removed.

Note: All pavement delineation work shall be performed by City of Riverside forces.

PAVEMENT MARKING, AND DELINEATION LEGEND

- (A) Paint curb Red
- (B) Paint 4" wide skip White stripes (7' stripe, 17' gap)
- (C) Paint 4" wide solid White stripes
- (D) Remove 4" wide skip White stripes(7' stripe, 17' gap)
- (E) Remove 8" wide solid White stripes
- (F) Remove 8" wide skip white stripes (3' stripe, 12' gap)
- (G) Remove White Arrow Marking

GENERAL NOTES

1. Remove any conflicting striping.

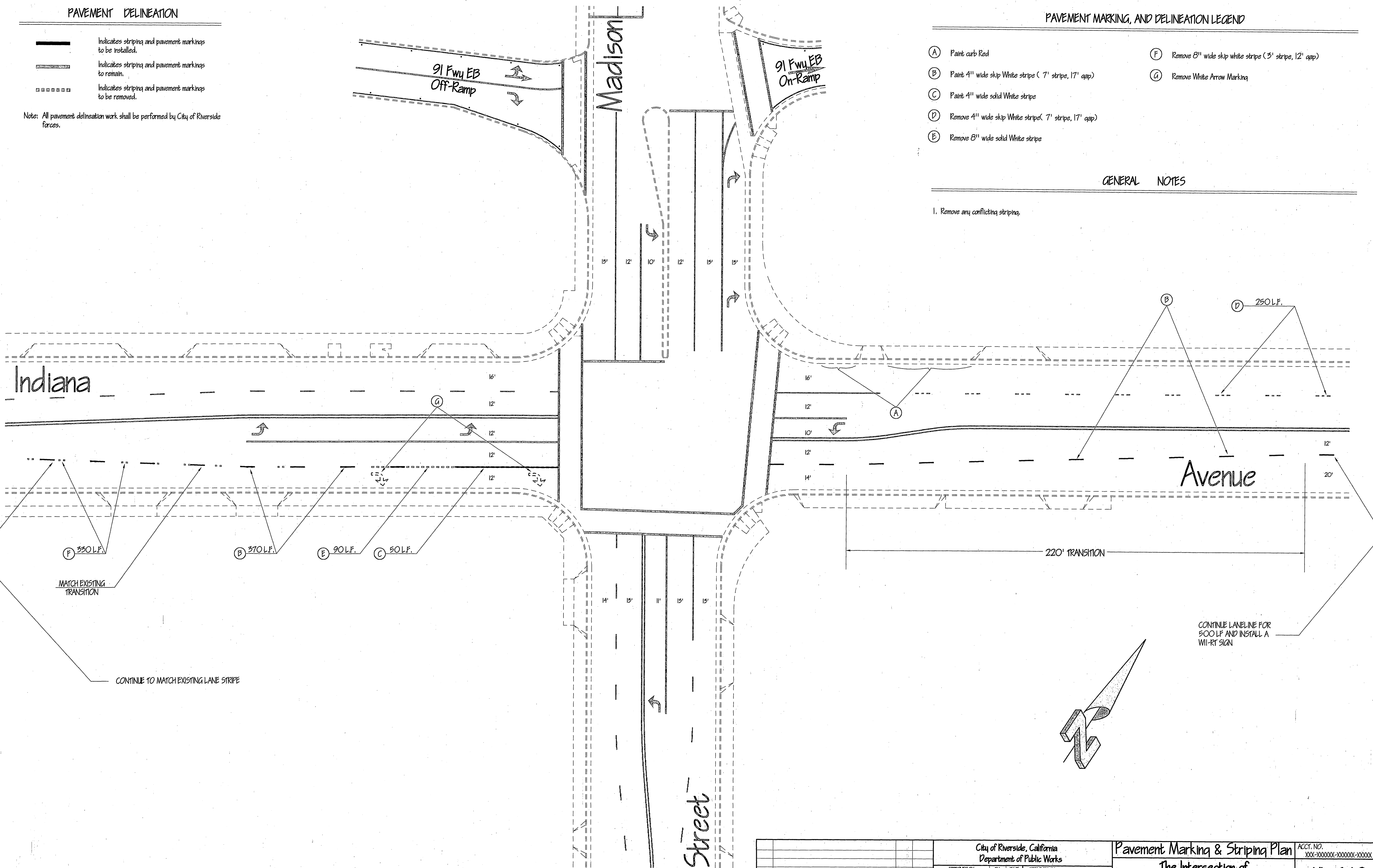

(F) 350 L.F. (B) 370 L.F. (E) 90 L.F. (C) 50 L.F.

MATCH EXISTING TRANSITION

CONTINUE TO MATCH EXISTING LANE STRIPE

220' TRANSITION

CONTINUE LANE LINE FOR 500 L.F. AND INSTALL A W11-R1 SIGN

City of Riverside, California Department of Public Works				Pavement Marking & Striping Plan		ACCT. NO. XXXX-XXXXXX-XXXXXX-XXXXXX
APPROVED BY	BY	DATE	APPROVED BY	The Intersection of Indiana Avenue and Madison Street		XL-340
PRINCIPAL ENGINEER			DIRECTOR OF PUBLIC WORKS			SHEET 1 OF 1
P.W. INSPECTION						File Name: XL340.DWG
TRAFFIC ENGINEERING						
CHIEF P.W. ENGINEER						
PUBLIC UTILITIES						
DESIGNED BY: JIBC	DRAWN BY: JIBC	CHECKED BY:		Scale: 1" = 20'		