

STRIPING & MARKING LEGEND

- (A) 4" SKIP YELLOW STRIPE (7' STRIPE, 17' GAP) WITH TWO-WAY YELLOW REFLECTIVE MARKERS AT 48' SPACING.
- (B) 4" SOLID DOUBLE YELLOW STRIPE WITH TWO-WAY YELLOW REFLECTIVE MARKERS AT 24' SPACING.
- (B1) 4" SOLID DOUBLE YELLOW STRIPE WITH ONE-WAY YELLOW REFLECTIVE MARKERS AT 24' SPACING.
- (C) 8" SOLID WHITE STRIPE WITH ONE-WAY CLEAR REFLECTIVE MARKERS AT 24' SPACING.
- (D) 12" SOLID WHITE MARKING
- (E) SOLID WHITE ARROW MARKING
- (F) 4" SOLID WHITE MARKING
- (G) 4" SOLID YELLOW MARKING WITH ONE-WAY YELLOW REFLECTIVE MARKERS AT 48' SPACING.
- (H) 8" SOLID WHITE MARKING.
- (I) WHITE "STOP AHEAD" PAVEMENT MARKING
- (J) 8" SKIP WHITE STRIPE (3' STRIPE, 9' GAP)
- (K) WHITE "STOP" PAVEMENT MARKING

NOTE:

ANY STRIPING OR MARKINGS OBLISCURED OR OBLITERATED BY ADJACENT REPAVING SHALL BE REPAINTED.

ENGINEER IN RESPONSIBLE CHARGE

 RONALD C. MUELLER
 R.C.E. No. 29510 expires 3/31/99
 DATE _____

CITY OF RIVERSIDE, CALIFORNIA PUBLIC WORKS DEPARTMENT			
APPROVED BY	BY	DATE	APPROVED BY
DEPUTY P.W. DIRECTOR	<i>[Signature]</i>	6/27/95	<i>[Signature]</i>
PRINCIPAL ENGINEER	<i>[Signature]</i>	6/27/95	PUBLIC WORKS DIRECTOR
CHIEF P.W. INSPECTOR	<i>[Signature]</i>	6/27/95	
STREET SERVICES	<i>[Signature]</i>	6/27/95	
SURVEYOR	<i>[Signature]</i>	6/27/95	
TRAFFIC DIVISION	<i>[Signature]</i>	6/27/95	
PARKS DEPARTMENT			

DESIGNED BY TRC DRAWN BY TRC CHECKED BY *[Signature]*

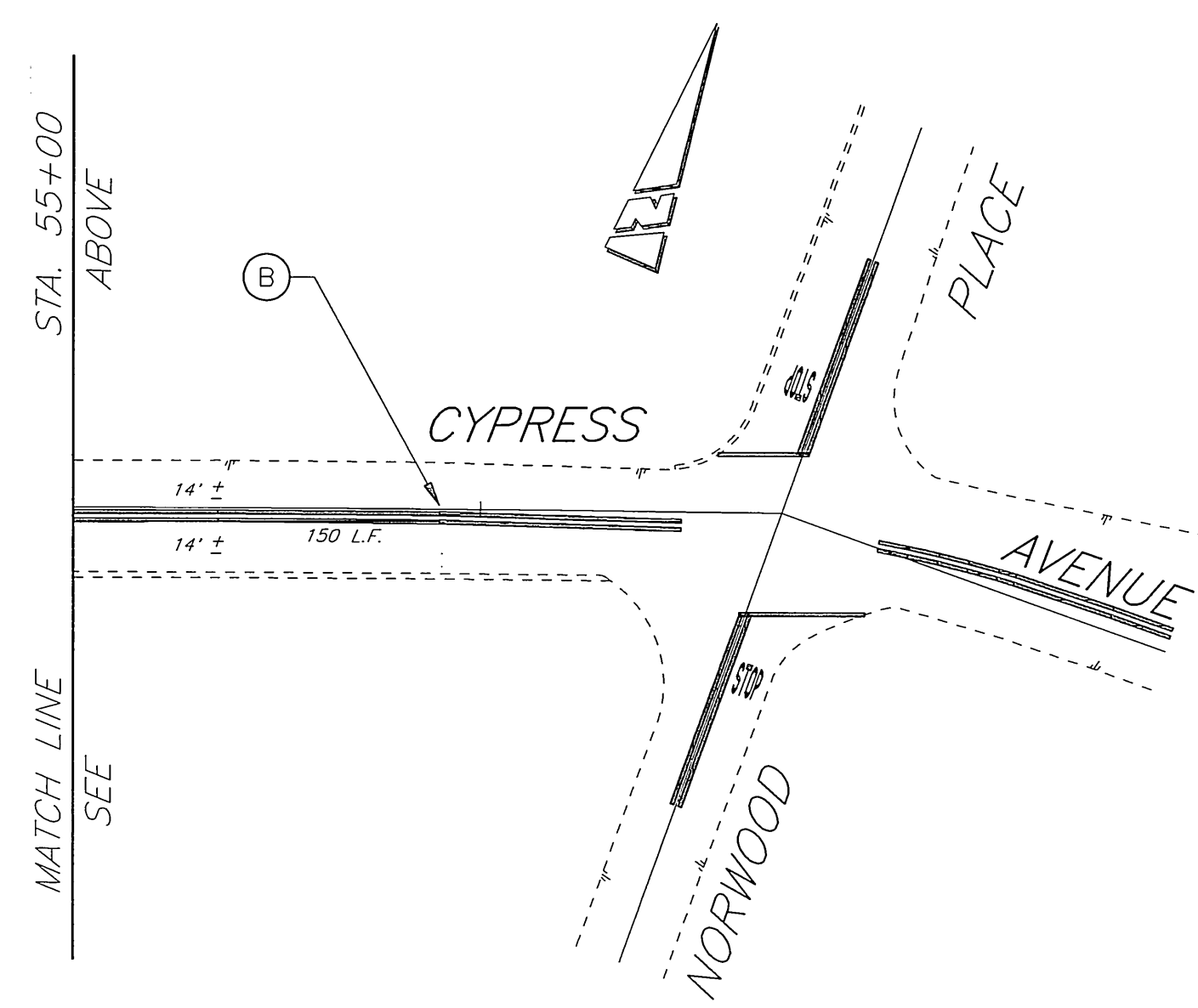
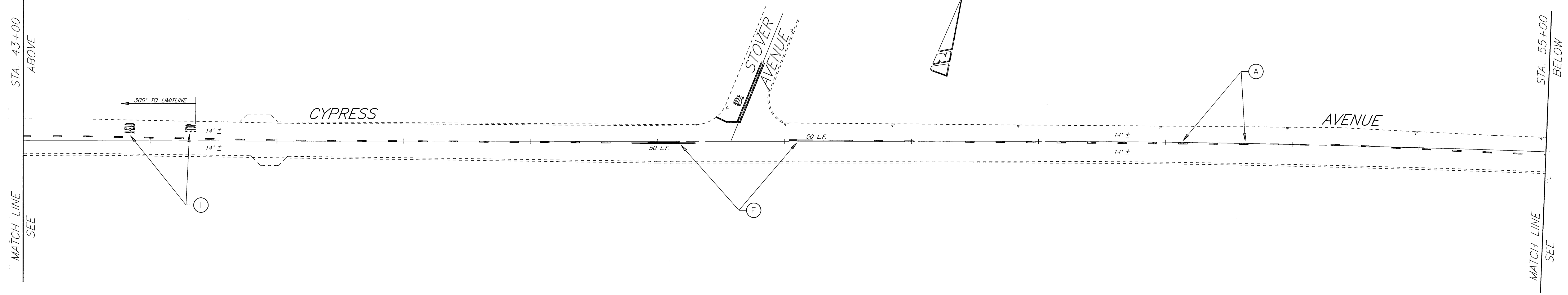
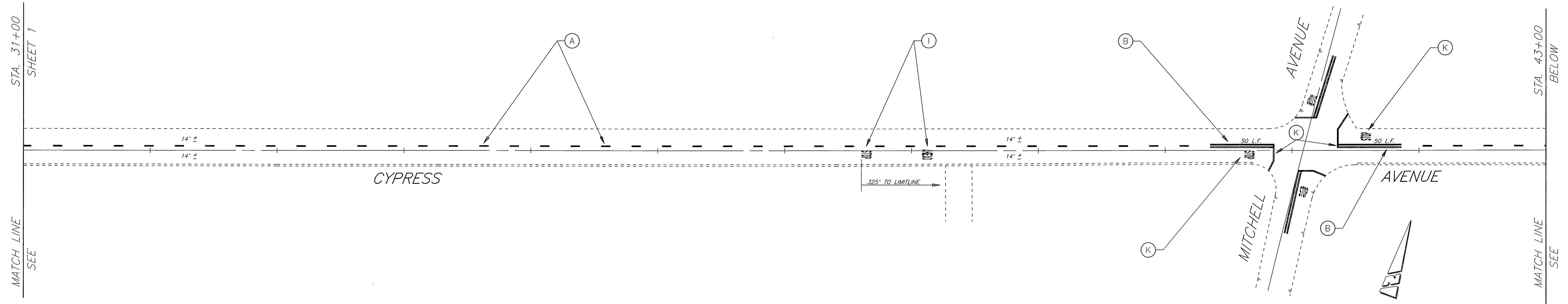
REHABILITATION OF ARTERIAL STREETS (CITY FUNDED) 94-95		ACCT. NO. 432-541500-440302-30036
CYPRESS AVENUE STRIPING PLAN ALHAMBRA AVE TO NORWOOD PL		XL-355
SCALE: 1" = 40'		SHEET 1 OF 2



- NOTES:
- SEE SHEET 1 FOR STRIPING LEGEND
 - ANY STRIPING OR MARKINGS OBLISCURED OR OBLITERATED BY ADJACENT REPAVING SHALL BE REPAINTED.

<p>ENGINEER IN RESPONSIBLE CHARGE</p> <p>RONALD C. MUELLER R.C.E. No. 29510 expires 3/31/99</p>	<p>CITY OF RIVERSIDE, CALIFORNIA PUBLIC WORKS DEPARTMENT</p>		<p>REHABILITATION OF ARTERIAL STREETS (CITY FUNDED) 94-95 CYPRESS AVENUE STRIPING PLAN ALHAMBRA AVE TO NORWOOD PL</p>		<p>ACCT. NO. 432-541500-440302-30036</p>
	<p>APPROVED BY: [Signature] DATE: 8/7/95</p> <p>DEPUTY P.W. DIRECTOR: [Signature] DATE: 8/7/95</p> <p>PRINCIPAL ENGINEER: [Signature] DATE: 8/7/95</p> <p>CHIEF P.W. INSPECTOR: [Signature] DATE: 8/7/95</p> <p>STREET SERVICES: [Signature] DATE: 8/7/95</p> <p>SURVEYOR: [Signature] DATE: 8/7/95</p> <p>TRAFFIC DIVISION: [Signature] DATE: 8/7/95</p> <p>PARKS DEPARTMENT: [Signature] DATE: 8/7/95</p>		<p>APPROVED BY: [Signature] DATE: 8/7/95</p> <p>PUBLIC WORKS DIRECTOR</p>		<p>XL-355</p> <p>SHEET 2 OF 2</p>
<p>DESIGNED BY: TRC DRAWN BY: TRC CHECKED BY: [Signature]</p>		<p>SCALE: 1" = 40'</p>			