

GOLDEN AVE.

STONEWALL DR.

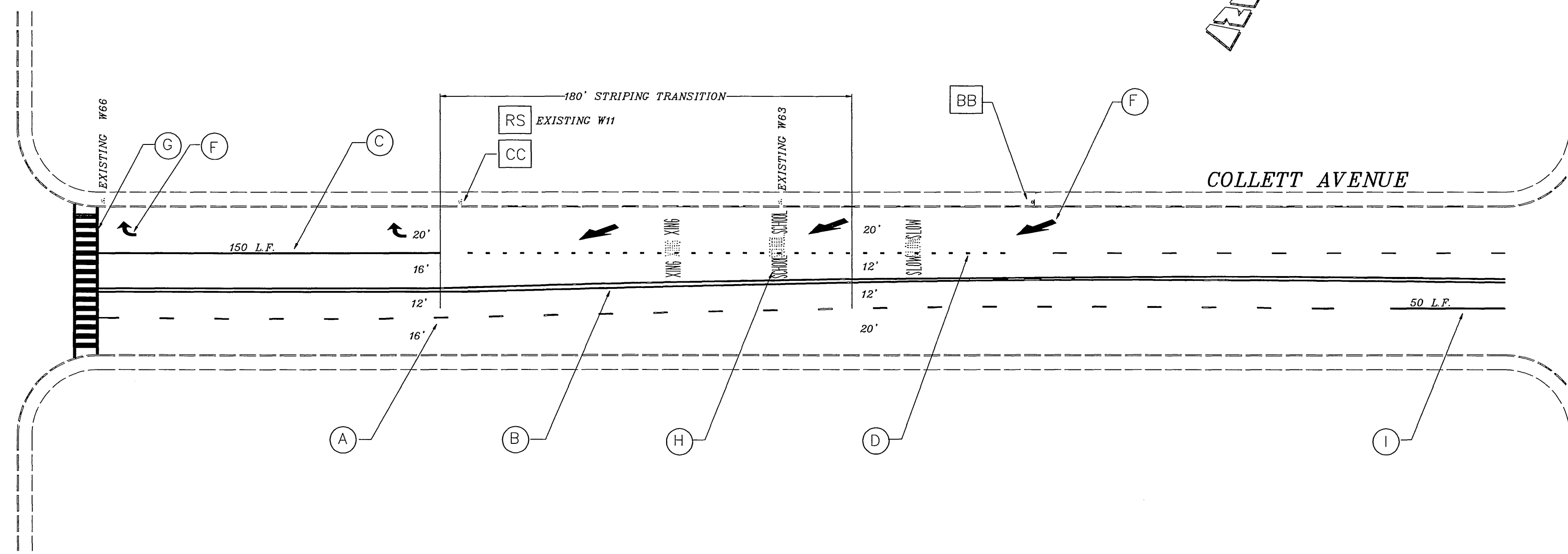

STONEWALL DR.

LA SIERRA AVENUE

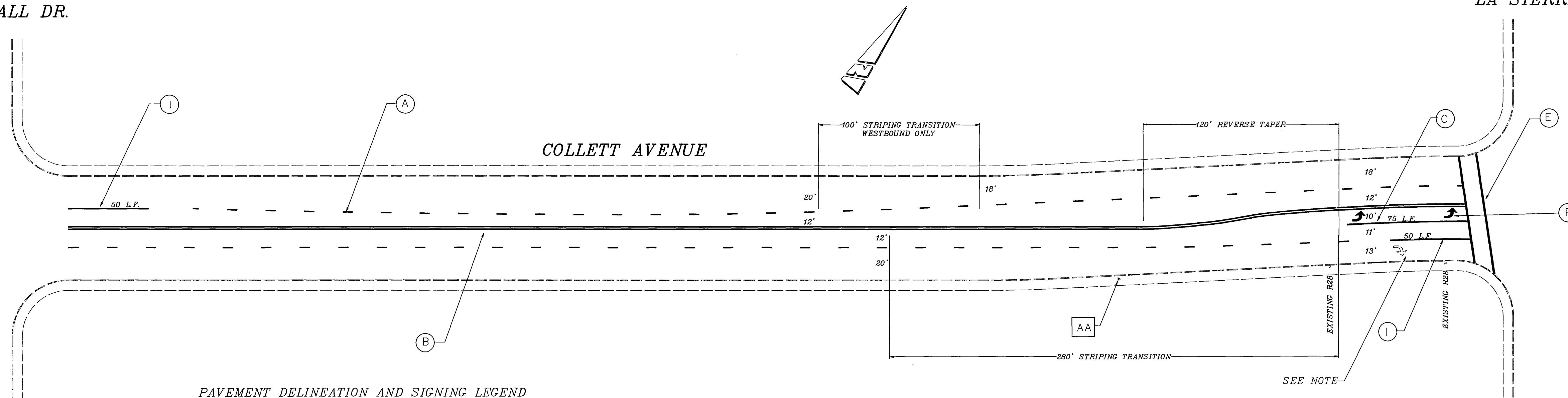

**PAVEMENT DELINEATION AND SIGNING LEGEND**

- (A) 4" SKIP WHITE STRIPE (12' STRIPE, 36' GAP)
- (B) 4" SOLID DOUBLE YELLOW STRIPE
- (C) 8" SOLID WHITE STRIPE
- (D) 8" SKIP WHITE STRIPE (3' STRIPE, 12' GAP) 250 L.F.
- (E) 12" SOLID WHITE MARKING
- (F) SOLID WHITE ARROW MARKING
- (G) YELLOW HIGH VISIBILITY CROSSWALK
- (H) YELLOW SCHOOL MARKINGS
- (I) 4" SOLID WHITE STRIPE
- AA INSTALL R28 (NO PARKING ANY TIME) 12" x 18" AND POST
- BB INSTALL W74 (THROUGH TRAFFIC MERGE LEFT) 36" AND POST
- CC INSTALL R18-1 20" x 32" ON EXISTING POST

NOTE:  
REMOVE ANY CONFLICTING EXISTING STRIPING.

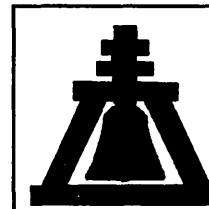

ENGINEER IN RESPONSIBLE CHARGE

FRAN DUNAJSKI  
DATE \_\_\_\_\_

| MARK | REVISIONS | APPR | DATE |
|------|-----------|------|------|
|      |           |      |      |
|      |           |      |      |
|      |           |      |      |

DESIGNED BY: DH DRAWN BY: DH CHECKED BY: \_\_\_\_\_

CITY OF RIVERSIDE, CALIFORNIA  
DEPARTMENT OF PUBLIC WORKS

| APPROVED BY | BY | DATE | APPROVED BY | DATE |
|-------------|----|------|-------------|------|
|             |    |      |             |      |
|             |    |      |             |      |

PAVEMENT DELINEATION AND SIGNS

**COLLETT AVENUE**  
LA SIERRA AVENUE TO  
GOLDEN AVENUE

SCALE: 1" = 40'

ACCT. No.  
0000-000000-000000

**XL-391**  
SHEET 1 OF 1

FILE NAME: XL391.DWG